

FREESPIRIT
RECREATION

FOUNDATION SERIES
HUB V2

INSTRUCTION MANUAL

DEAR FREESPIRIT FAMILY,

As a family owned and operated business, it is our hope that as you get out there and use the Freespirit products, you feel like a part of our extended family and feel like we are all out there exploring this great planet *together.*

Our goal at Freespirit Recreation has always been to re-invent the rooftop tent from the ground up. We work hard to create the best designs using the best products that allow for a fast and easy set-up. We want you spending more time *exploring and enjoying life.*

At FSR, our goal is to listen to you-our customers. Thank you for your feedback and insight as we developed this Foundation Series HUB V2 tent. We are excited for you to experience the all-new HUB V2!

You have asked us to be innovative, to provide the best quality, to provide great customer service, and to keep creating products that *Elevate Your Adventure* so stay in touch with us!

Follow us on social media and on our website, www.gofsr.com.
Have questions for us?
Reach out, we are here to help!
sales@gofsr.com

Oh, and because we have to put this in here...
PLEASE REVIEW THIS INSTRUCTION MANUAL BEFORE USING
YOUR HUB V2.

**From our Freespirit family to you, THANK YOU for your purchase.
We hope that it really will *Elevate Your Adventure!***



Renee Tewes, President
Tanner Tewes, Head of Marketing and E-Commerce
Kristine Sewell, Wholesale Director
Ben Tewes,
Head of Business Development & Product Innovation

TABLE OF CONTENTS:

PRODUCT OVERVIEW (PAGE 4)

PRODUCT SPECIFICATIONS (PAGE 5-6)

WHAT IS INCLUDED IN THE BAG (PAGE 6)

SETTING UP AND TEARING DOWN YOUR HUB V2 TENT (PAGE 7-8)

CARE INSTRUCTIONS AND IMPORTANT INFORMATION (PAGE 8)

PRODUCT OVERVIEW:

founda·tion (noun): a body or ground upon which something is built up or overlaid

and : an underlying base or support

The creation of the Foundation Series HUB Tents brought Freespirit Recreation into the world of ground tents. We developed and enhanced the HUB tents to be a ground tent, a beach to mountains tent, an ice fishing tent, late season elk hunting tent, a tent for tailgates and sporting events, a separate living area when out with your rooftop tent, or a separate sleeping area for friends or kids when they join you on a trip and you are sleeping in your rooftop tent.

The Foundation Series HUB Tents started with two sizes, but we have really found the all-new HUB V2 is the sweet spot for size, it is not too big and not too small.

The HUB V2 really is *The Anywhere for Anyone Tent*.

Grab an Aircore Mattress, a Readylight, and a car connect...and go camping!

Key Features:

Fast + Easy Pull-Tab Set Up: It's never been this easy to set up camp. Simply pull fast on each side's tab and watch the HUB pop out into place!

Stove Jack: You can safely and quickly heat your tent without the hassle or danger of running an extension cord to your tent with the HUB's integrated, fire-resistant stove jack.

Tri-Layer Tent Body: All four Tri-Layer walls keep the tent insulated and warm. They can also be rolled up, exposing a bug mesh, to allow for maximum airflow.

Lightweight, Fiberglass Construction: Weighing in at 42 pounds, it can go anywhere.

Integrated LED Lighting: A thin, luminous LED light strip runs along the ceiling of your spacious HUB.

Versatility: The HUB can function as a stand-alone tent, be attached to your car or your Evolution rooftop tent.

HUB V2 SPECIFICATIONS:

Floor Size:	96" x 96"
Interior Middle Height:	80"
Interior Side Wall Height:	70"
Weight:	42 lbs
Box Dimensions:	64" x 10" x 10"
Sleeping Capacity:	2-4 people
Frame:	11mm Diameter Solid Fiberglass Poles, HUB Mechanism
Tent Fabric:	Roof 210D Ripstop- Oxford, Clear PU Coating 1500mm, Water Resistance [WR], Fire Resistance [CPA] Tri-Layer Panels- 150D (150D oxford+60g/m2 polyfill+150D oxford)
Rainfly Material:	150D Ripstop- Oxford, Clear PU Coating

	1000mm, Water Resistance [WR], Fire Resistance [CPA]
Floor Material:	210D oxford, PU2000mm, W/R
Mesh Wall:	80g/m2
Carry Bag:	66 in x12 in x12 / 600D Oxford Fabric

INCLUDED IN THE BAG:

- + HUB V2
- + Front Door Poles x2 (each side of main door)
- + Rain Fly x1 (to be used during wet climates)
- + HUB V2 Floor x1 (use loops and hooks on each corner of floor, attach to the HUB tent, then velco to side walls)
- + LED Light Strip x1 (use two ways, around the back on velcro, in the ceiling rods with clips to create a circle)
- + 14 Ground stakes (One for each corner grommet, three for guide rope)
- + 3 guide ropes

SETTING UP AND TEARNING DOWN FOUNDATION SERIES **HUB V2 TENT:**

INSTRUCTION MANUAL FOR HUB TENT

PATENTED

Set Up



Fold Down

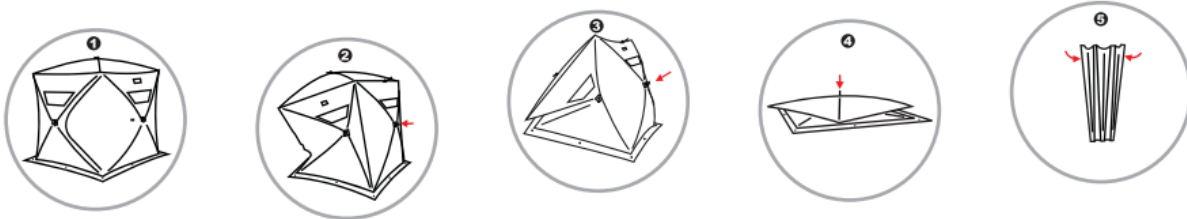

STEPS:

1. Remove all components from bags.
2. Place tent in vertical position with bottom feet facing up.
 3. Drop each leg down so the tent is fully expanded flat on the ground.
4. Pull loops on each side until the tent pops out.
5. Continue all sides. Go inside and push up on the middle roof of the tent to pop up the roof.
6. Attach floor, it is optional depending on use.
7. Line up the rain fly over the top of the HUB tent, it is optional use depending on weather. Line up the corners and the rain fly should be over each HUB tent window.
8. Secure ropes for tent rainfly and tent floor with stakes provided. Stake into the ground.
9. Turn on LED light strip as needed.

10. Foundation Series HUB V2 Tent set-up is now complete.

11. To tear down the dome tent, reverse the steps and store in provided carrying bags.

CARE INSTRUCTIONS:

+ Do not wash. Wipe with a damp cloth and let air dry.

IMPORTANT INFORMATION:

+ Keep all flame and heat sources away from the tent fabric. This HUB tent meets the flammability requirements of CPAI-84. This tent is made of flame-resistant fabric. It is not fireproof. The fabric will burn if left in continuous contact with a flame source. The application of any foreign substance to the tent fabric may render the flame-resistant properties ineffective.

+ The HUB tent is in the most secure position when the corners and ropes are properly staked down. Exercise caution when moving tent parts. Adult supervision is required. Do not leave assembled for prolonged periods of time or in extreme weather. Keep all body parts clear of pole joints when in operation.