

VACUUM TO WASTE

V2W

OWNER'S MANUAL

The
VacDaddy
POWERFUL
PORTABLE POOL VAC





The VacDaddy V2W is a small but powerful tool allowing you to discharge fine debris and sediment such as dead algae, green to clean, DE spill, sulfates, and other tiny particles which are left behind by your other vacuum filter bags. The V2W also works great, depending upon your region, for light openings, dust storms, pollen or any other situation where you have a super-fine layer of sediment which no other portable vacuum system can remove.

Don't dirty up the pools filters, the VacDaddy's **60 gallons per minute of suction and up to 18' of lift** will allow you to move that fine mess up and out of the pool **in minutes.**

The VacDaddy V2W comes with everything you see here:

V2W Attachment

Leaf Filter Bag

Hex Head driver bit

Hose Clamp



1

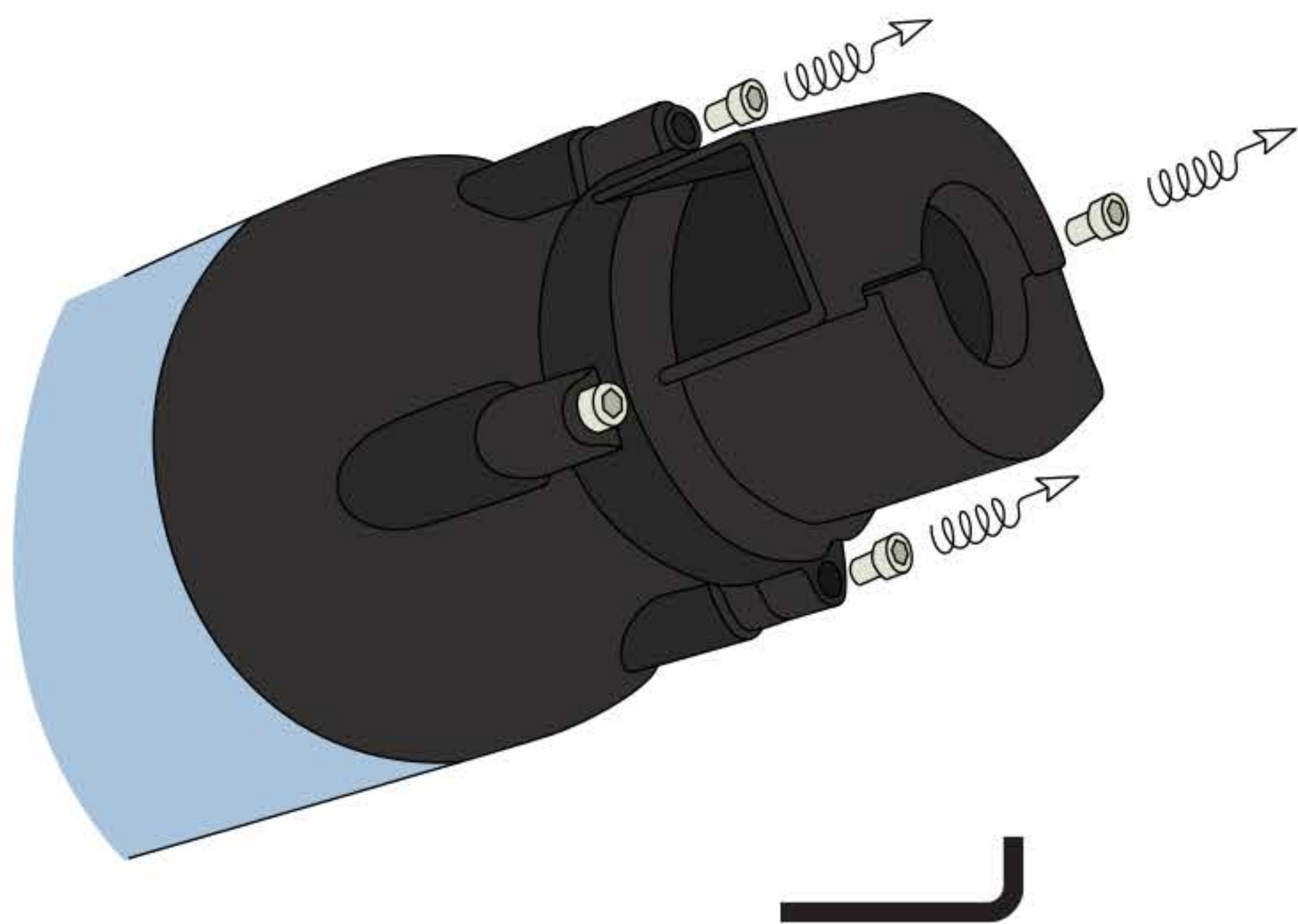

Used hex head driver (included)
to loosen (tighten) screws

2

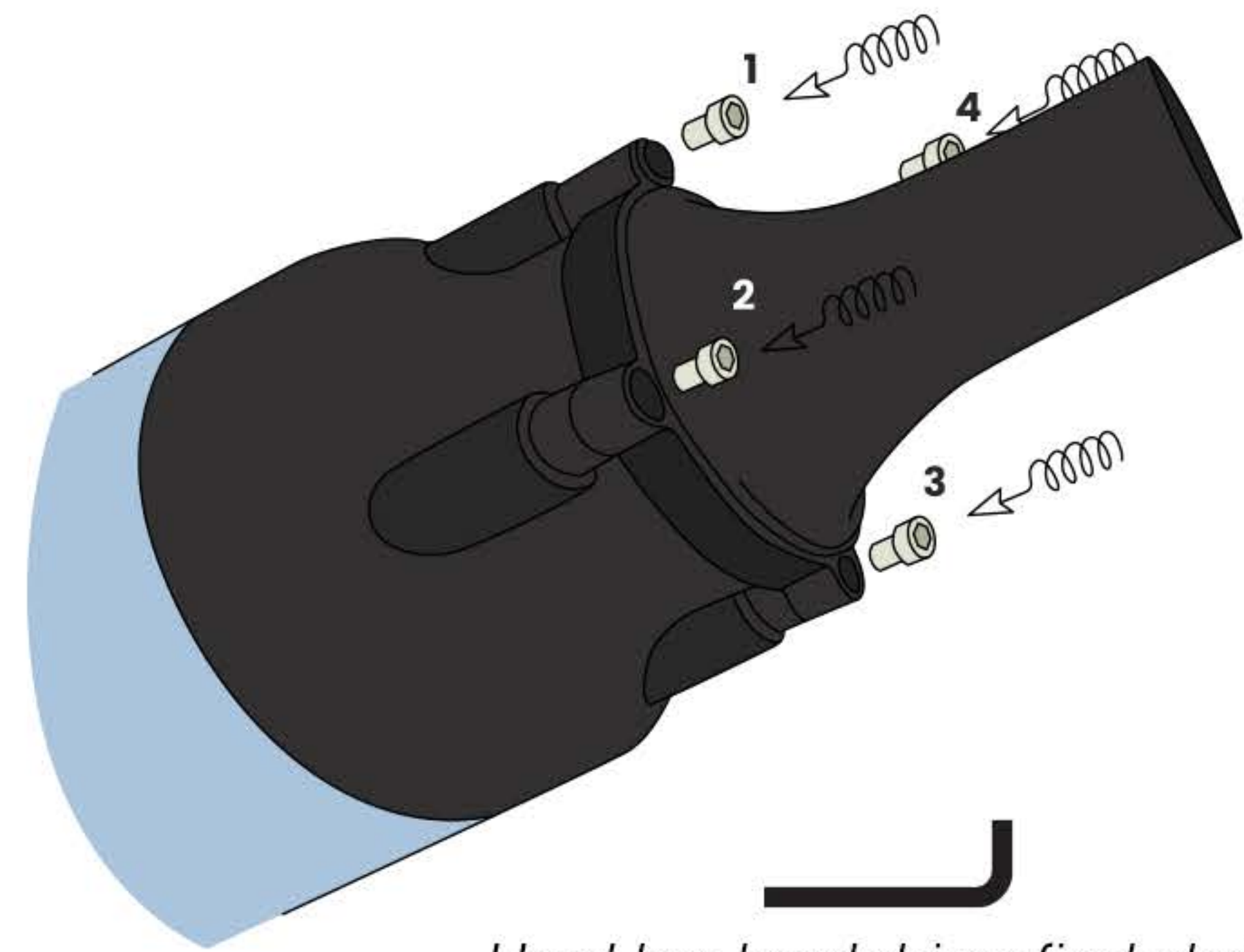

Used hex head driver (included)
to loosen (tighten) screws

Remove 4 hex head screws and remove the diffuser cap. Carefully set screws and washers aside.

Put V2W Cap in place and insert/tighten hex head screws. Do not over tighten.

3

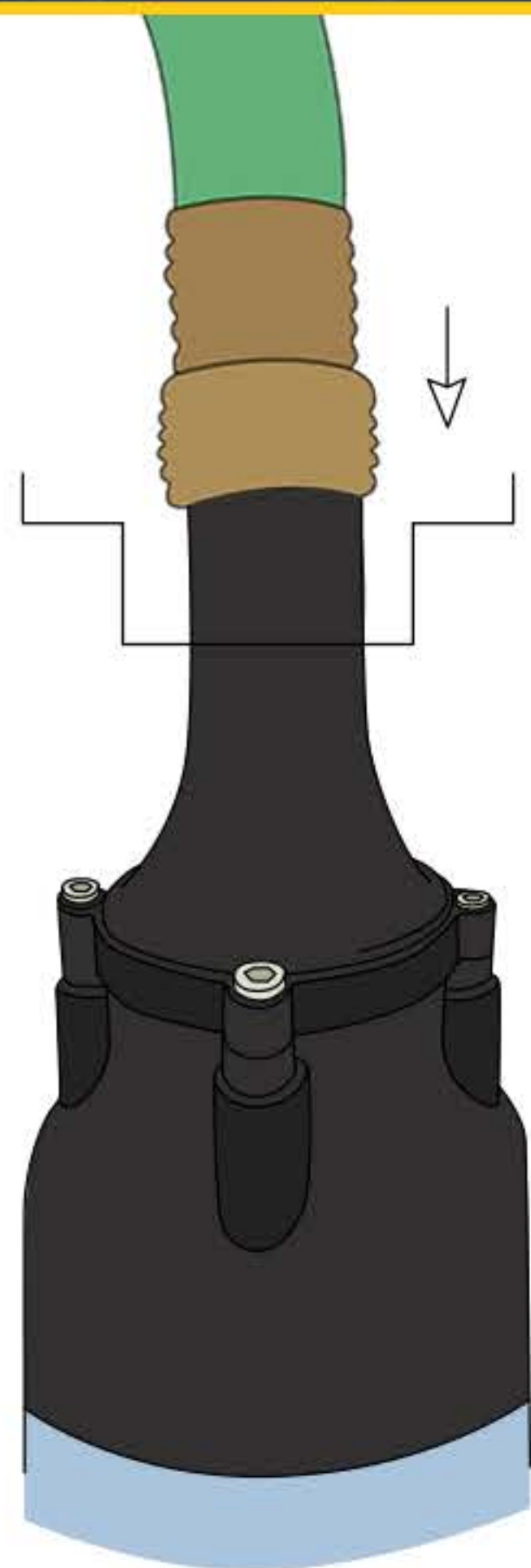

Attach Rubber Hose Cuff firmly to V2W Cone.

4

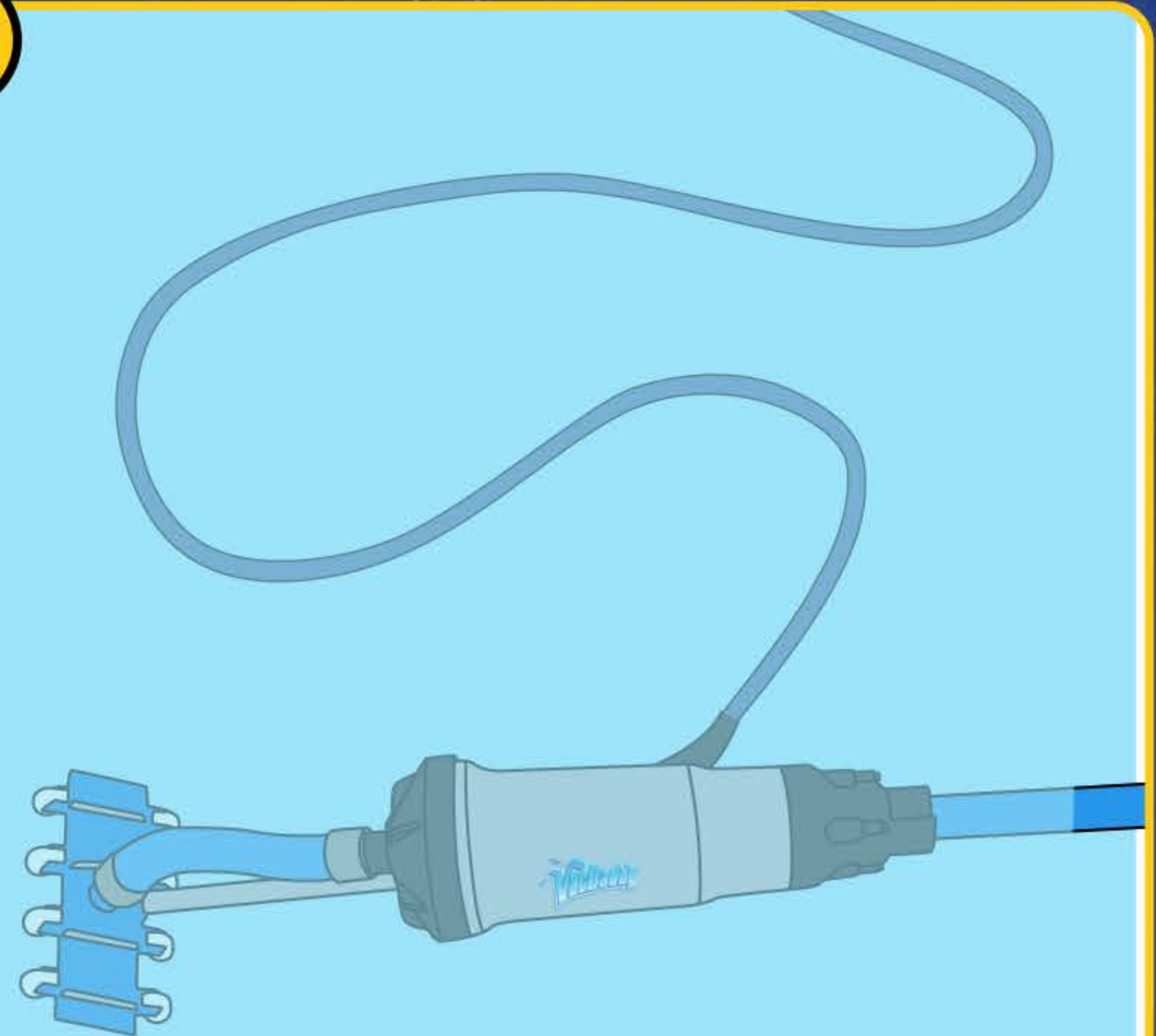

Allow Vac Hose to float freely on the pool surface with 5' of vac hose on the pool deck.

5

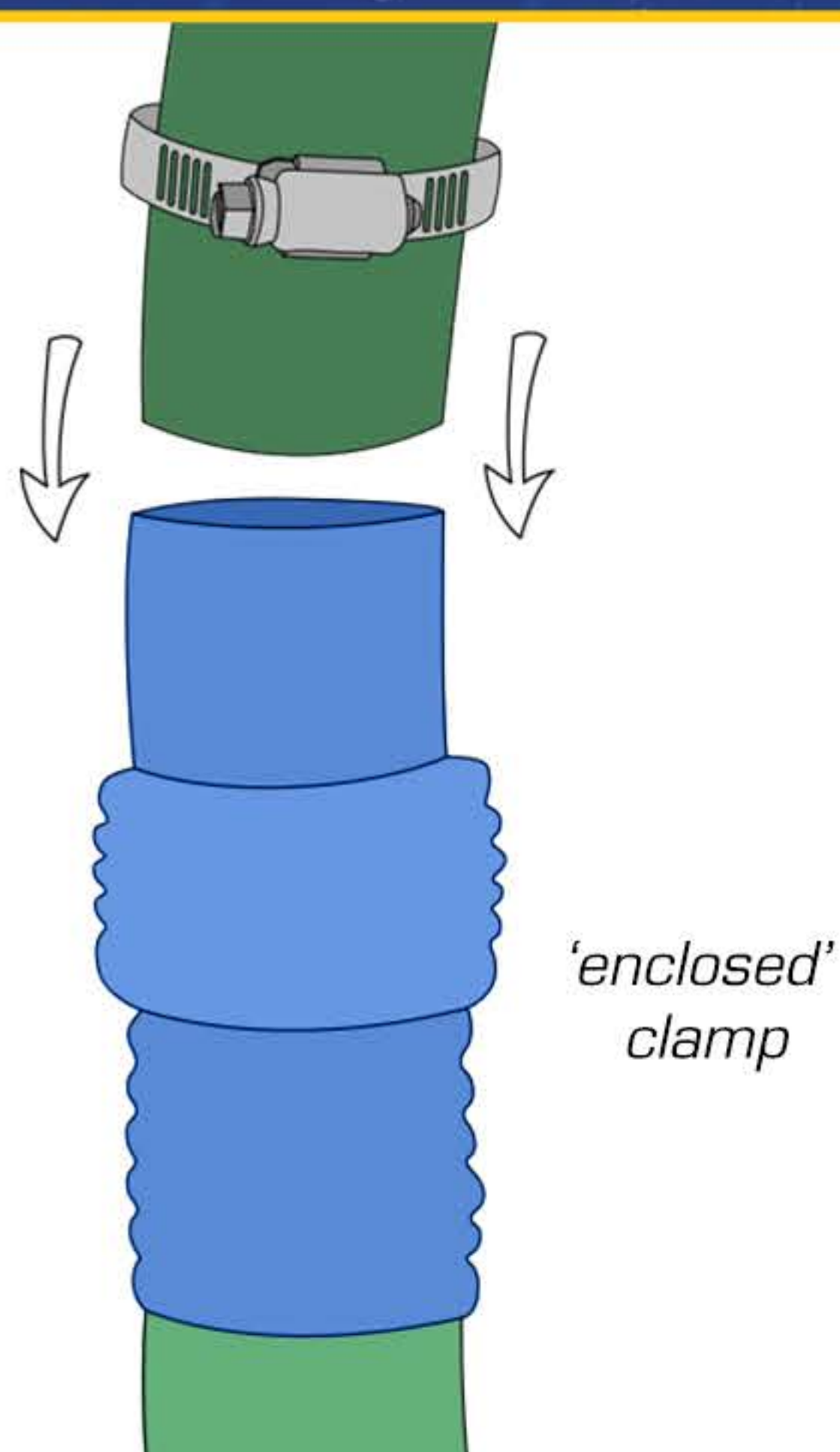

Use clamp to attach backwash hose to end of Vac Hose.

6

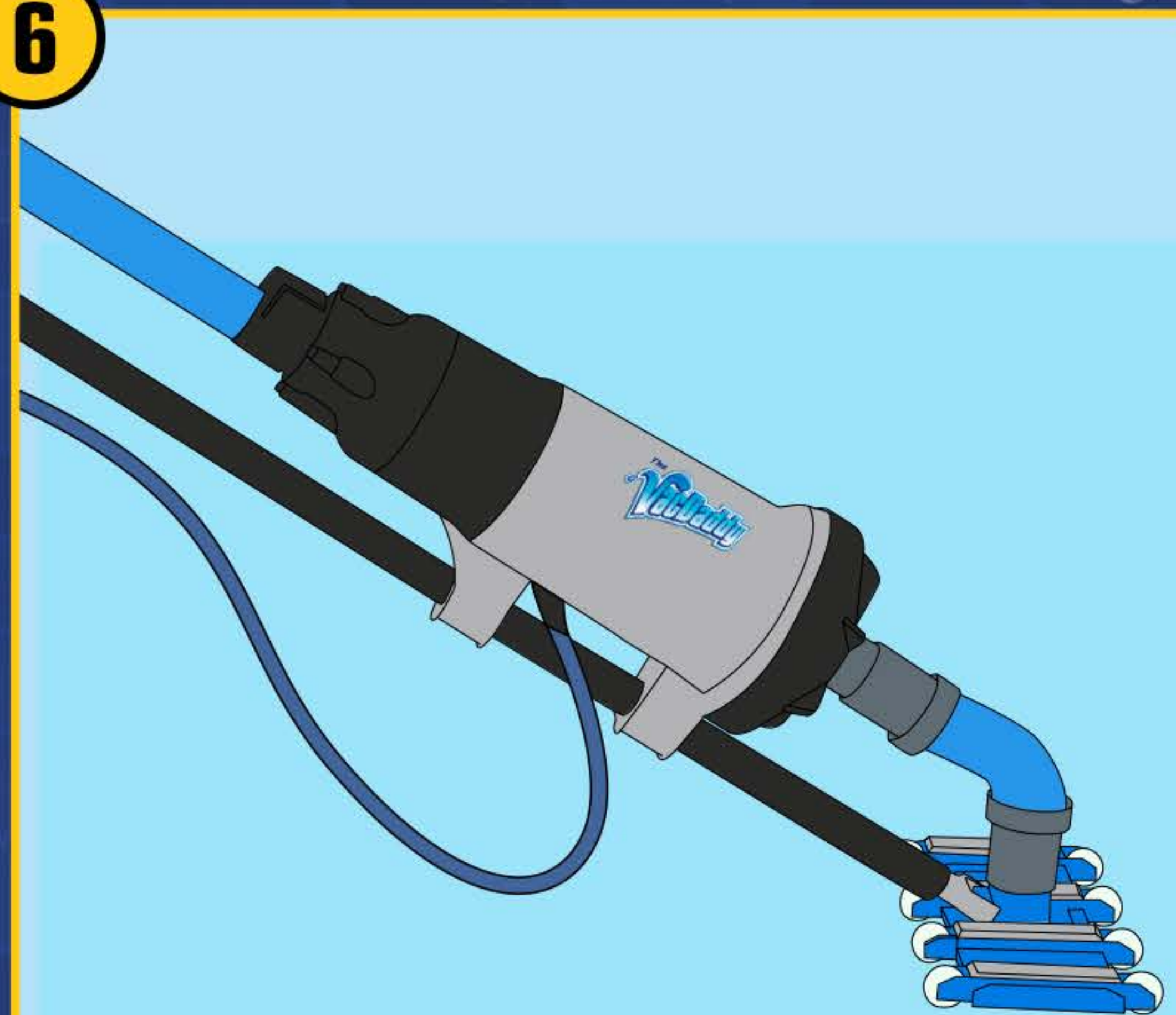

Direct water to drain on safe location.
Begin Vacuum to Waste!

INSTALLATION OF V2W CAP

1

Place the VacDaddy carefully on a workbench or other solid surface to begin installation of the V2W cap.

2

Use 5/32" hex head driver to remove four screws holding diffuser cap in place.

3

Set screws and washers carefully to one side.

4

Remove diffuser cap.

5

Place V2W cap in place and insert screws with washers.

6

Tighten screws firmly – DO NOT OVERTIGHTEN – you do not need to crank these down super tight and doing so may damage the plastics around the molded insert.

7

Carefully store the diffuser cap in a safe place while not in operation.

VACUUM TO WASTE OPERATION

1

Use leaf filter bag which will stop large debris from getting trapped in the impeller but which will allow sand/silt/sediment to pass through.

2

Attach one end of your standard 1 ½" vacuum hose firmly to the V2W cap. The rubber cuff of the hose should seat firmly onto the V2W cap and not slip off.

"If you are using a 2" vacuum hose, the VacDaddy vac head adapter may be used to connect hose cuff to the V2W cap."

3

Allow the vacuum hose to trail, floating on the surface of the pool, behind the VacDaddy.

4

Attach a flexible rubber waste hose or backwash hose to the far end of the vacuum hose using the hose clamp provided.

5

Allow a minimum of 4-5' of the vacuum hose to lie on the pool deck, which when full of water, will anchor the hose into place. Then direct the length of backwash hose to the location where you want the waste water and debris to drain.

(depending upon your location be aware of local ordinances with regards to water draining down the street or into neighboring yards – choose a safe place for the water to drain).

6

Turn on the VacDaddy and begin vacuuming as normal to clean the bottom of the pool. Silt, sand, super fine debris and other small particles will exit the pool.

7 You may wish to begin refilling water prior to operation. The VacDaddy cleans quickly so, unless you are performing a more complicated pool opening, there should be only minimal water depth loss and you can refill quickly.

8 Complete vacuuming to waste. Once fine debris is removed from the pool, turn off the VacDaddy and remove from pool.

9 Disassemble backwash hose from vac hose, roll and store in a protected area.

10 Remove vac hose from VacDaddy, coil and store.

11 If using the VacDaddy for additional vacuum to waste situations, leave V2W cap on and store the VacDaddy comfortably in your VacBaggy or other carry case. Be careful of the V2W unit which now extends a few extra inches off the end of your VacDaddy

12 See Installation steps above to remove V2W cap and replace Diffuser Cap. Keep V2W cap, hex head driver and hose clamp stored in a safe and protected location until next use. Reverse installation steps.



Advanced Pool Technologies, LLC

1200 Port Washington Blvd.

Port Washington, NY 11050

Phone: 888-536-8186

Email: info@thevacdaddy.com

f  @thevacdaddy