

# Operation Manual

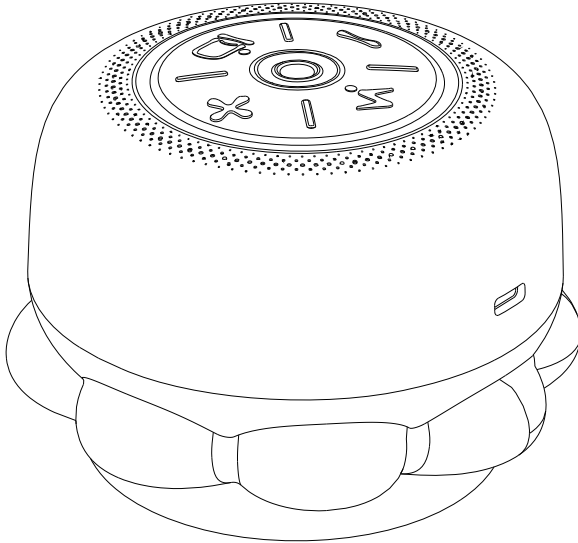

## Intelligent Breathing Cupping and Massage Instrument

Before using the product, please read the manual carefully and keep it properly for future reference.

## Product Introduction

Intelligent breathing cupping and massage instrument is a health care instrument developed by combining modern technology and traditional medicine. The product is centered on the Shu acupoints or local area as the central (one) point and the meridians as the dimension, with a number of physical massage functions as a means (additional external function products can be used with), with comprehensive conditioning and multiple effect, which can help to meet the needs of consumers on health care.

The product integrates functions such as intelligent breathing cupping, hot compress, vibration, magnetic energy, etc. Through intelligent monitoring of the pressure in the cup and real-time adjustment of the vacuum negative pressure, achieve dynamic breathing cupping, which is suitable for working at home, gifting and own use.

### Four conditioning functions



Cupping  
Moxibustion



Hot Pack  
Moxibustion



Vibration  
Moxibustion



Magnetic  
Moxibustion

### External products can be attached (Must use with guidance)

+



Essential Oil  
Moxibustion  
(External Option)



Medicine  
Moxibustion  
(External Option)



Moxa Paste  
Moxibustion  
(External Option)



Function  
Moxibustion  
(External Option)

### Product Feature

++



Essential Oil  
Moxibustion  
(External Option)



Medicine  
Moxibustion  
(External Option)



Moxa Paste  
Moxibustion  
(External Option)



Function  
Moxibustion  
(External Option)

++

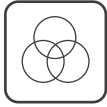
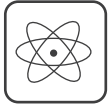

Scientific Heritage Multiple Functions Deep Specialization Obvious Experience Simple Operation

### Product Diagram

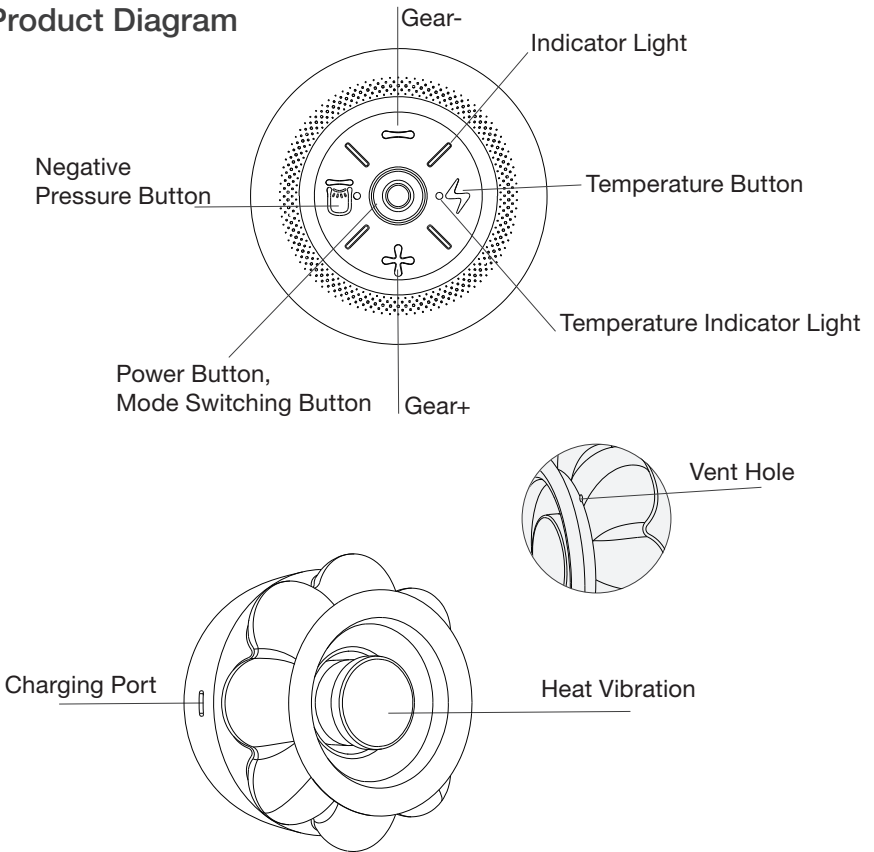

## Technical Parameters

Product Name	Intelligent Breathing Cupping and Massage Instrument		
Product Model	CM1	Product Net Weight	360g
Product Dimension	Φ103*73mm	Charging Voltage	5V 1A
Suction Strength	-60~0kPa	Charging Time	About 3.5hrs
Red Light Band	N/A	Battery Capacity	3.7V/1800mAh
Temperature Range	About 38~48C	Rated Power	7W
Carried Standard	GB4706.1-2005 GB4706.10-2008		

## Button Function Description

Power Button	<ol style="list-style-type: none"> <li>1.Press and hold for 3 seconds to turn on/off</li> <li>2.Short press to switch four suction modes at power on</li> </ol>
Adsorption Mode Button	<ol style="list-style-type: none"> <li>1.Press lightly the adsorption mode, and then press "+" or "-" to adjust the strength of suction</li> <li>Press and hold the negative pressure button for 3 seconds to close/open the massage function</li> </ol>
Temperature Control Button	<ol style="list-style-type: none"> <li>1.Short press the temperature control mode, then press "+" or "-" to adjust the temperature</li> <li>2. Long press to turn off/on the temperature function</li> </ol>
+ Button	Short press to increase suction or raise temperature
- Button	Press lightly to reduce suction or lower temperature

# Operation Guide

## 01 Preparation

1. Please read the safety caution (page 8~10 of the manual) carefully when using cupping moxibustion. The product is prohibited for those who do not meet the conditions.
2. It is recommended to use wipes or sprays to clean and moisturize the skin to improve the experience.
3. Tighten and install the transparent cup (clean it with wipes before and after using the instrument).
4. Check if the instrument is complete and normal.

Please pay attention to the installation of protection rope, use under the protection rope, prevent the product from falling damage

## 02 Power Button

1. Press and hold the power button for about 3 seconds to turn on/off (intelligent shutdown after continuous work for about 12 minutes).
2. After turning on, suction function and vibration massage function automatically start.
3. Short press the power button in the power-on state to switch between different suction cupping modes (the default is "mode 1" state when power-on).

4. The product has four suction modes:

- 一: Active mode (Mode light is green)
- 二: Slow mode (Mode light is blue)
- 三: Deep mode (Mode light is red)
- 四: Professional mode (Mode light is multi-color)

## 03 Adsorption Mode Button

1. The default suction strength is first gear.
2. Short press "+" "-" to adjust the strength (1~5 files), accompanied by the corresponding note prompts.
3. When the suction indicator light flashes, the instrument is in operation.
4. When using for the first time or the skin is not adapted to it, please start from "first gear".

Note:

\*During initial use, please pay attention to the gradual adjustment finding the mode and intensity that suits you.

\*The human body experience varies due to differences in parts and conditions, subject to our laboratory test data.

## 04 Temperature Control Button

Short press the temperature control button at power on, the temperature can be adjusted, the default temperature strength is first gear. The temperature gear indicator light corresponds to different temperature gears.

Gear		1Gear	2Gear	3Gear	4Gear	5Gear
Temperature		About 38°C	About 40°C	About 42°C	About 45°C	About 48°C

\*Adjust the temperature according to the physical difference, please prevent low temperature burns.

\*Due to the different environment, the actual temperature may have difference, subject to our laboratory test data.

## 05 Alternate Function Button

1.Short press the power button (during the cupping process, if you want to stop or remove the product, it can be used) to pause the cupping adsorption function at power on.

2.Vibration function on/off

Press and hold the adsorption mode button for 3 seconds to turn on/off the vibration massage function at power on

## 06 Cupping Observation

According to the theory of traditional Chinese medicine, different changes in skin after cupping can provide early warning of physical discomfort.

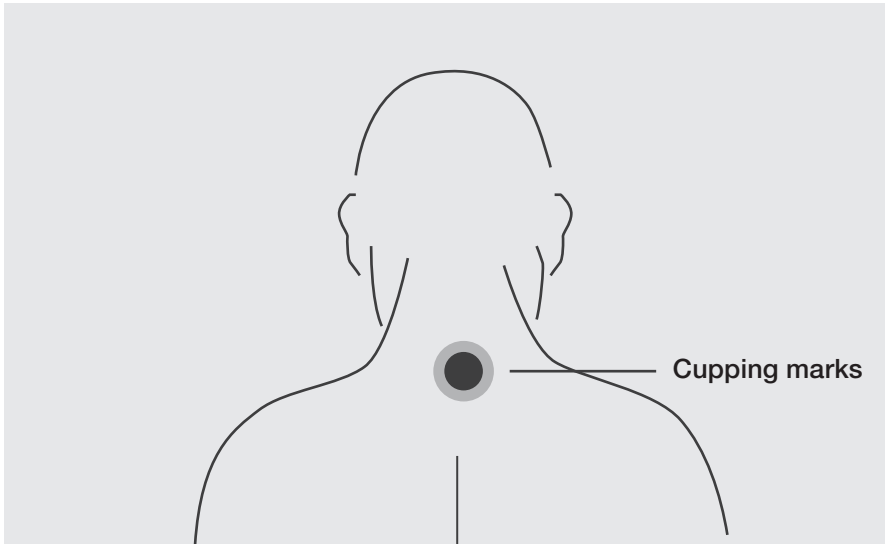

\*Please refer to the traditional Chinese medicine books or consult an expert for advice on how to judge different cupping marks.

## 07 Additional Peripherals Description

### 1.Liquid Peripheral Products

When using the product with liquid peripheral products such as essential oil, be sure to apply the essential oil evenly on the surface of skin without the presence of obvious liquid, and then adsorb the product to the desired area.

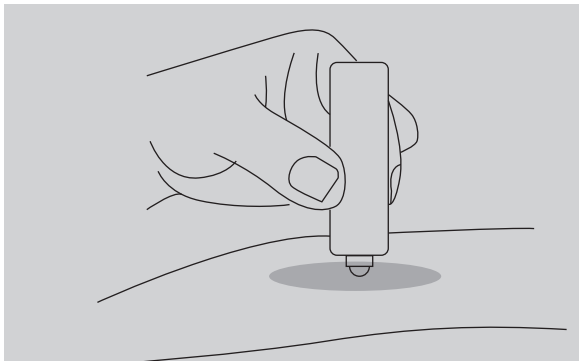

Apply evenly without visible liquid

\*Special note: The Company does not guarantee the damage to the air pump due to improper use of liquid products such as essential oil.

## 08 Additional Peripherals Description

The machine is designed with a filter device, which can filter out most of the granular or liquid impurities during the use of the product, and can protect the internal cleanliness of the machine and maintain the service life of the product. Please check and replace the cotton filter regularly according to the frequency of use.

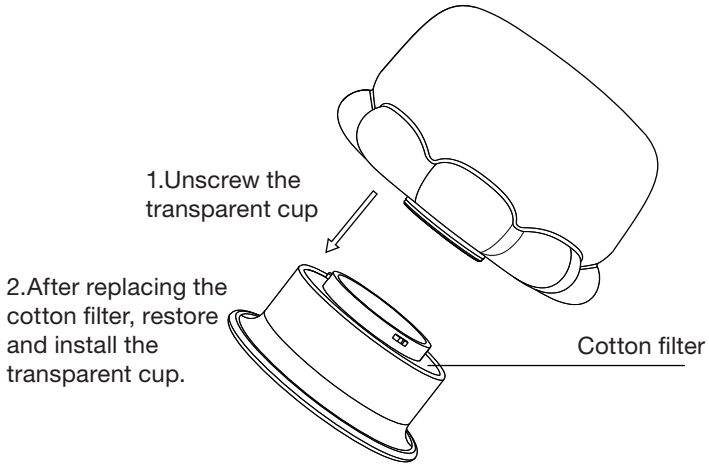

## Product Qualification Certificate

Production Date	
Product Name	
Product Number	
Inspector	

The product has been inspected and approved for delivery.

Please refer to the actual product. Subject to change without notice.



# Product Qualification Certificate

- 1.Connect the Type-C charging cable to the adapter socket, and the other end to the product charging port for charging. Adapter specification is 5V - 1A.
- 2.When charging, please keep the Type-C charging port dry and clean. The charging time is about 3 hours, which may vary slightly due to environmental conditions, subject to the actual time. Do not charge for more than 8 hours.
- 3.The charging indicator light shows red during charging, and green when fully charged.
- 4.During the charging state, the product cannot be used.
- 5.Low power alarm: when the battery voltage is too low, the red light flashes 5 times, then automatically turn off.

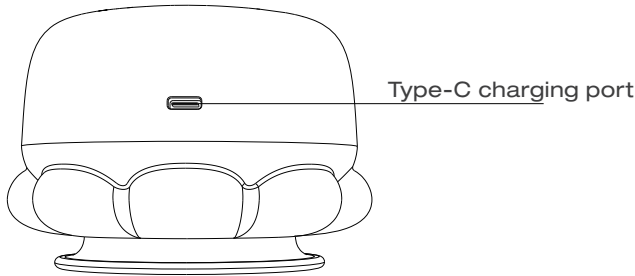

## Cleaning and Maintenance

### ► Please follow the cleaning and maintenance methods to keep the service life of the instrument:

- 1.Please wipe the instrument body with dry non-woven fabrics. Please do not use acid and alkaline cleaning agent, alcohol, thinner, gasoline, nail polish remover and other solvents to clean.
- 2.Please turn off the power after each use and then clean it (with wipes).
- 3.Please store the product in a safe and dry place.
- 4.Do not use hard brushes or stainless steel balls to avoid damaging the surface.
- 5.Do not use water or other liquids to rinse directly into the instrument.

### ► Please follow the cleaning and maintenance methods to keep the service life of the instrument:

Places susceptible to vibration shock; places under direct sunlight; places with high temperature and humidity; places with water; places with strong electromagnetic fields; places near smoke and fire, etc.

# Fault Analysis and Removal

Fault Phenomenon	Fault Diagnosis and Solution
Unable to turn on	1.Press and hold the power button for more than 3 seconds to turn on. Please charge the instrument for 3 hours and then try again.
Unable to charge	1.Replace the adapter with extension socket and try again. 2.Please pull out the charging plug and plug it in again to make sure it is in place. 3.Please check the charging plug and charging port for any dirt or debris, if so, please clean it. Replace the adapter or charging cable.
Weak suction	1.Remove the transparent cup and re-tighten for installation. 2.Check if the air intake and exhaust holes are blocked. 3.Check if the power button cannot be reset. Check if the cotton filter needs to be replaced.
Weak temperature sense	1.Check whether the temperature function is on, the temperature indicator light is on. If the ambient temperature is affected, please increase the temperature level. If the battery power is low, please charge.

\*If the problem cannot be solved, do not disassemble the instrument personally, please contact the dealer to deal with it.

## Safety Caution

**Danger (Content related to wrong operation that may lead to serious personal injury)**

► Please do not use with the following medical electronic equipment at the same time, it may cause medical equipment failure or damage, even serious life-threatening situations!

- 1.Cardiac pacemakers and other implantable medical electronic devices;
- 2.Artificial heart lung and other life-sustaining medical electronic devices;
- 3.Electrocardiographs and other medical electronic devices;
- 4.Other implantable medical instruments.

## Fault Analysis and Removal

- ▶ In use, the transparent tank should avoid contact with wounds and scars.
- ▶ If there is any discomfort during or after use, please stop immediately and consult a doctor. When using the product, the transparent cup should be closely and evenly applied to the skin. Do not use near the heart to prevent an increased risk of atrial fibrillation.
- ▶ It is recommended for one user. For cross-user use, please clean the transparent cup before use.
- ▶ During use, if you want to give the instrument to another user, please be sure to turn off the instrument after use to avoid discomfort caused by excessive suction or temperature. The product contains lithium battery, please do not disassemble, soak or throw the product into the fire to prevent damage and explosion.
- ▶ It may cause low-temperature burns or skin strains when the product is used to a same part for a long time (more than 12 minutes), please observe carefully. Do not press the internal organs when using to prevent accidents or cause discomfort. Do not use a chipped or damaged transparent cup. Do not use for the purpose of medical effects.
- ▶ In the following circumstances, please consult a doctor before use to prevent accidents or discomfort.
  - 1.Allergic people;
  - 2.Patients with infectious diseases;
  - 3.Patients with body temperature over 38° C;
  - 4.Patients who are taking medicines;
  - 5.Patients whose skin is allergic to metal and red light;
  - 6.Patients with heart, cranial nerve and blood pressure abnormality;
  - 7.Patients who are unable to express their will freely;
  - 8.Patients with skin perception disorders or skin abnormalities;
  - 9.Patients who are under medical treatment or feel physically abnormal;
  - 10.Patients with perceptual disorders due to high peripheral circulatory disturbances such as diabetes.

Prohibited in the following circumstances:

1. Pregnant women and menstruating women;
2. Patients with malignant tumors or local ulcers, traumatic fractures, varicose veins, acute purulent inflammation, or loss of skin elasticity;
3. People with severe heart disease, heart failure, respiratory failure and severe edema;
4. Patients with poor blood clotting mechanism, spontaneous bleeding tendency or bleeding after injury;
5. Patients with severe skin allergy or infectious skin diseases should not be cupped;
6. Patients with severe nervousness, high fever, convulsion, spasm and mania;
7. Area near the heart, five sense organs, private parts or large blood vessels on the body surface, etc.

## **Caution (Content related to wrong operation that may lead to serious personal injury)**

- ▶ Please follow the operation manual to use the product properly.
- ▶ It is normal for the surface to become hot when the product works for a long time.
- ▶ It is normal for redness or ecchymosis to appear after using the product, and will dissipate gradually within 2 days (depending on each person's skin type).
- ▶ Do not plug and unplug the USB charging cable with wet hands to prevent electric shock or accidents. Do not use it for children or people without the ability to express themselves to prevent accidents. Do not use the product while driving.
- ▶ Do not leave the product on the affected part for a long time to prevent dermatitis.
- ▶ If there is any discomfort on the body or skin, please stop using it immediately. In case of abnormalities, please remove it immediately.
- ▶ Do not use in places with high humidity such as bathrooms.

## **Advice**

- ▶ The battery power is depleted when the product is left for a long time, please charge it according to the manual to ensure that it can work properly.
- ▶ When the product contains battery, please separate the product from other types of waste at the end of its service life, and recycle the product to promote sustainable use of material resources.
- ▶ It is recommended for people who are 16 years old and above.

## Maintenance Service Assurance

If the product is faulty, please contact our designated repair center or customer service center. Our products have a one-year warranty. The start date of the warranty period is based on the invoice date. Please bring the warranty card and valid invoice when repairing. The warranty does not cover any of the following circumstances:

- 1.Damage due to user's improper handling, use, storage and maintenance, or man-made damage;
- 2.Repair by the non-designated maintenance center, or the user's own installation, disassembly or maintenance;
- 3.Damage due to the use of gifts and accessories that are not covered in standard configuration of our products;
- 4.The model number on the invoice does not match with the model number of repaired product or is altered;
- 5.Gifts and accessories;
- 6.Out of warranty period;
- 7.No valid invoice;
- 8.Damage caused by force majeure.
- 9.If it is a product enjoys seven days of no reason to return, it shall not affect the secondary sale.

For products that are not covered by the warranty, paid repair services will be offered, and our customer service center serves you with passion.

## Caution (Content related to wrong operation that may lead to serious personal injury)

This logo applies to the production, sale and import of electrical and electronic products in China. According to the Management Measures for Restriction of Hazardous Substances in Electrical and Electronic Products announced, and SJ/T11364-2014 Marking for the Restriction of Use of Hazardous Substances in Electrical and Electronic Product on January 6, 2016, it indicates that the product is recyclable. The number indicates the product's environmental protection use period. As long as the safety and usage precautions related to the product are observed, the product will not cause serious pollution to the environment or serious damage to the user's body or property during normal use within the years





This logo applies to the production, sale and import of electrical and electronic products in China. According to the Management Measures for Restriction of Hazardous Substances in Electrical and Electronic Products announced, and SJ/T11364-2014 Marking for the Restriction of Use of Hazardous Substances in Electrical and Electronic Product on January 6, 2016, it indicates that the product is recyclable. The number indicates the product's environmental protection use period. As long as the safety and usage precautions related to the product are observed, the product will not cause serious pollution to the environment or serious damage to the user's body or property during normal use within the years indicated by the numbers from the date of production.

## Warranty | the product has a one-year warranty

Relevant Information	Customer Name		TEL	
	Address			
	Product Model		Product Number	
	Purchased from		Purchased On	
	Repair Center		Invoice Number	

Repair Record	Repair Date		Repair Bill	
	Fault Content		Repairman's Signature	
	Processing Details			