

UPGRADED

# piurify™

# HYDROGENATOR®

USER MANUAL



**DO YOU PREFER VIDEO INSTRUCTIONS?**

Scan code for a brief video on how to get your **Water Hydrogenator®** set up.

OR GO TO: [www.piurify.com/instructions](http://www.piurify.com/instructions)



piurify™

**HYDROGENATOR®**

**USER MANUAL**

[www.piurify.com](http://www.piurify.com)

# SAFETY GUARD/CAUTION

Please review the safety guards and cautions below carefully to ensure the proper performance of this product and your safety.

To safely and correctly use this product, please read the following tips:



## WARNINGS FOR YOUR SAFETY

Don't place or use it around or near fire or under direct sunlight.

Don't set it on fire.

Don't pour flammable liquid in.

Do not place in microwave and hand-wash only.

Don't use wet hands to touch the pitcher while it's charging.

If there is water vapor around the charge port, wipe and dry before charging.

Please clean dirt and dust around the port before charging.

Keep the connection fastened between the pitcher and the cord, do not tie, flex, stretch, or twist the cable while in use.

\*All the above behaviors are forbidden because these could lead to glass fracture, battery explosion, electric shock, short circuit and even fire.

Drinking hydrogen-rich water is forbidden for pacemaker carriers or people with tech equipment in their bodies. This is due to the subtle current within hydrogen. Water can influence equipment on the human body.

Drink hydrogen-rich water must not be reserved. Drink it right after it's generated.

Put the pitcher out of infants' reach to prevent them from swallowing pitcher parts.

Don't drop the pitcher or enforce it too much. These may cause deformation and damage to it.

Don't freeze the pitcher. It could lead to malfunction and glass fracture.

Refresh and clean the pitcher before first use.

Don't pour other liquid in the pitcher except water. Other liquids could stain the electrode plate.

Don't use pitchers underwater. This leads to the malfunction of the product.



### HYGIENIC USE

Frequently clean the inner pitcher to keep hygienic use.



Never use chlorine bleach nor scrub brush when cleaning this product.

Don't drink long reserved water (Try not reserve water).

\*If you compare it with normal water, hydrogen rich water is easier to breed bacteria.

# PRODUCT PARAMETERS

Product Name	PIRUIFY Water HydroGenerator® H2 Water Generator
Voltage	DC12V/2A
Power	15W
Net Weight	4.8 lbs.
Pitcher Capacity	50oz (1500ml)
Product Size	8.3 x 7.1 x 13.2 Inch
Pitcher Size	4.9 x 8 x 9.8 Inch
Hot/Cold	N/A
Material	<ul style="list-style-type: none"><li>• PC - Polycarbonate (Pitcher)</li><li>• PP - Polypropylene (Filter's housing)</li><li>• Titanium platinum (Generator)</li><li>• ABS (enclosure)</li><li>• Silica Gel (Sealing element)</li></ul>
Liquid Temperature	41~100°F (5~38°C)
Water Source	Direct Drinking Water

# COMPONENTS

## INCLUDED IN THE BOX

- 1x HydroGenerator® Stander
- 1x Water Pitcher
- 1x Calcium Sulfitite Filter
- 1x Power Adapter with US Plug
- 1x User Manual



Water Pitcher



HydroGenerator® Stander



Calcium Sulfitite Filter



Power Adapter

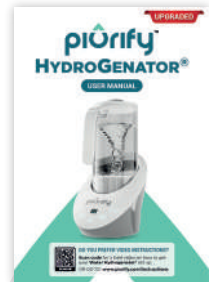

User Manual

# PRECAUTIONS



## **The water quality requirement of water source**

The water quality is complied with "Standards for Drinking water Quality."



## **Use for the first time**

When used for the first time or not used after a long period, please wash properly before using it.



## **Environment and temperature**

Please use it at a temperature of 5 to 45° and in dry condition



## **Storing of hydrogen water**

Place and freeze the hydrogen water in the refrigerator after it is sealed properly; by doing so, the active level of the hydrogen water can be preserved longer. It is suggested that the water should be consumed as soon as possible.



## **Avoid direct sunlight**

Please do not place the product under direct sunlight.



## **Freezing prevention**

Do not keep or expose the product in an environment under 0°.



## **Prohibit to drink**

Do not drink the water generated from self-cleaning.

# FUNCTIONS

## Magnetic Water

The Vortex motion aerates the water and causes:

- **Balanced Oxygen**
- **Raised pH levels**
- **Released VOCs**
- **Helps retain the H<sub>2</sub>** for up to 3x times longer.

Use this function right before H<sub>2</sub> Infusion for maximum benefits

## Self-cleaning

Maintain the pitcher always fresh and clean. Use this function once after every 10 cycles of hydrogen infusion.



## H<sub>2</sub> Water Standard

Standard infusion of pure hydrogen into the drinking water (8 min).

**Hydrogen Concentration  
700ppb - 900ppb**

## H<sub>2</sub> Water Higher

Strong infusion of pure hydrogen into the drinking water (13 min).

**Hydrogen concentration  
over 1300ppb**



# MAGNETIC WATER

## Innovative Vortex Technology



### Infusion of oxygen

The vortex allows atmospheric oxygen to enter, and dissolved oxygen to exit. Just like breathing.



### Raised pH levels

The swirling motion increases the evaporation of dissolved volatile compounds (such as chlorine and CO2); this outgassing of CO2 from the water reflects in increased pH levels.



### Helps retain the H2

for up to 3x times longer.

Use the 'Magnetic Water' function right before H2 Infusion for maximum benefits.



# INSTRUCTIONS



DO YOU PREFER VIDEO INSTRUCTIONS?

Scan code for a brief video on how to get your **Water Hydrogenator®** set up.

OR GO TO: [www.piurify.com/instructions](http://www.piurify.com/instructions)

1



**Rinse with water:** Take the pitcher, open the lid and rinse the pitcher thoroughly with water. Do not rinse the connecting latch at the bottom of the pitcher with water. Take out the filter and rinse it under running tap water for one minute, and then use clean water to rinse it one more time before putting it into the pitcher, which is already cleaned with water.

2



**Fill the pitcher with drinking water:**

Fill with household drinking water until MAX level with "Standards for Drinking Water Quality." Pure water or mineral water can also be used.

3



**Place into position:**

Place the pitcher into the position on the base and close the lid.

4



**Connect with power:**

Connect the output socket of the power adapter into the machine and plug in the power cable; the buzzer will then provide an audible signal.

5



**Power on the product:**

When the product is in standby mode, press the

power key and then the buzzer will beep once, the power indicator and the other buttons light will turn on, the product enters function to set up waiting mode.

6

**Function selection:** when product is switched on

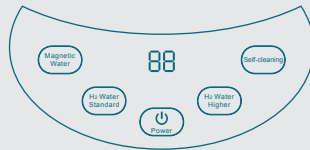

**6.1 H2 Water Higher over 1300ppb hydrogen concentration:**

When this key is pressed, the buzzer beeps once. The indicator light under the H2 Water Higher over 1300ppb hydrogen concentration key is turned on, and "13" is shown on the digital display at the same time. The machine enters strong hydrogen production mode with the blue color LED turned on.

After every minute, the digital display will be cut down by one. When "00" is reached on the digital display, the buzzer beeps six times, and the color light will turn off.

The machine returns to standby mode.

**6.1 H2 Water Standard 700ppb - 900ppb hydrogen concentration:**

When this key is pressed, the buzzer will beep once. The indicator light under the H2 Water Standard 700ppb - 900ppb hydrogen concentration key is turned on, and "08" is shown on the digital display at the same time.

The machine enters standard hydrogen production mode with the blue color LED light turned on. After every minute, the digital display will be cut down by one. When "00" is reached on the digital display, the buzzer will beep six times and the color light will turn off. The machine returns to stand by mode.

**6.2 Magnet Water:** When this key is pressed, the buzzer beeps once, the indicator light under the Magnet Water key is turned on, and "10" is displayed on the digital display at the same time. The machine enters oxygen production mode with the blue color LED light turned on.

After every minute, the digital display will be cut down by one. When "00" is reached on the digital display, the buzzer beeps six times, and the color light turns off. The machine returns to standby mode.

**6.3 Self-cleaning:** After this key is pressed, the buzzer beeps once, the indicator light under the Self-cleaning key is turned on, and "01" is displayed on the digital display at the same time. The machine enters flush mode with the blue color LED light turned on. After every one minute, the buzzer beeps six times with the color light turned off. The machine enters standby mode.

7



**Switching functions:** If the user wants to switch to another function from the current function, the current function key must be pressed to stop the current function. After that, press the function key that the user wants to switch to.

8



**In operation:** The bottom of the pitcher starts generating bubbles, and blue color light displays to indicate that the machine is operating.

9



**End of operation:** When the time reaches what it is set for, the product will stop operating. The blue color light turns off and the machine enters standby mode.

Pressing the power key when the machine is in operation can force it to stop immediately.



When you notice that it gives off hydrogen bubbles less than usual, clean the generator according to the guidelines stipulated in this manual below.

#### CLEANING

Do not directly wash or soak the product in water in order to prevent water damage to the machine.



#### USE OF POWER ADAPTER

The power adapter is only suitable for this product.

Our company will not be responsible for any consequences that result from using it for other products or applications.

# MAINTENANCE

- Do not use volatile solvents such as detergent, thinner, etc. to clean the pitcher.
- Do not fill the pitcher with drinks other than drinking water.
- The machine should be flushed once after every 10 electrolytic processes.
- If there is fewer bubble than usual generated when the machine operates, there could be dirt built up at the electrodes. It can be cleaned by taking out the filter in the machine and then pouring in edible vinegar. After two hours, shake it for two minutes, then pour out the vinegar and wash it with clean water.

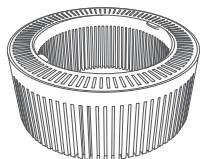

Please replace cartridge every  
3 (three) months of daily use.

# YOUR HARDWARE WARRANTY



## PIURIFY One (1) Year Limited Warranty

for your Water Hydrogen Infuser  
PIURIFY Branded Products Only

### WHAT IS COVERED BY THIS WARRANTY?

PIURIFY warrants the water softener product and accessories contained in the original packaging against defects in materials and workmanship when used normally in accordance with this user manual. The standard warranty is valid for ONE (1) YEAR from the date of original retail purchase by the end-user purchaser ("Warranty Period"). PIURIFY's guidelines include but are not limited to information contained in technical specifications, user manuals, and service communications.



You can **extend** your warranty to  
**18 MONTHS** by registering your  
product on [www.piurify.com/warranty](http://www.piurify.com/warranty).

**piurify™**

[www.piurify.com](http://www.piurify.com)



piurify™

[www.piurify.com](http://www.piurify.com)