

POWERPLAY



How to charge the Overtimepack





Language	Version	Notes
English	1.0	<ul style="list-style-type: none">• Only use the dedicated Rocky Mountain chargers for your Overtimepack.• Before using the Overtimepack for the first time, charge it to 100%.• Charge every three months to avoid damage. For more information visit bikes.com/overtimepack.

Step 1**Step 2**

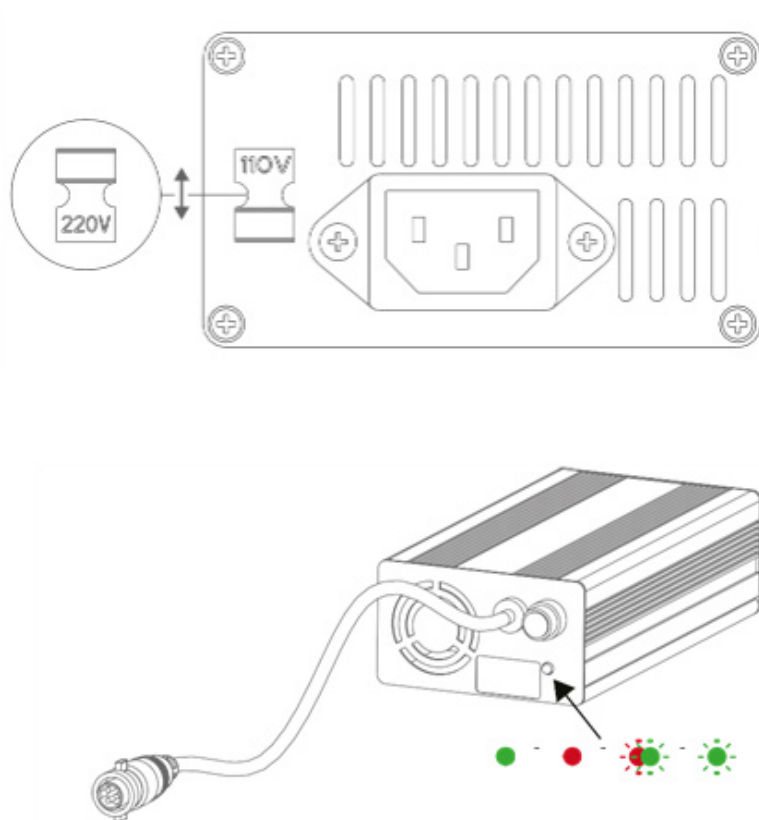
Getting started

- 1.1** The chargers have been designed to function in 240V or 120V depending on your location. Prior to plugging in the charger, ensure you are using the correct setting to avoid damaging your charger. Use the switch at the end of the unit to select the correct input voltage.



-  **Charger OK, ready to use**
Overtimepack at 100%
-  **Charging**
-  **Rebalancing cells**
Charge for 4 hours. If the Overtimepack is not fully charged in 4 hours, see an authorized dealer.
-  **Protection mode**
Unplug the charger from the Overtimepack and socket, and start over to reset.

Step 1

Step 2

1.2 Three charging options:

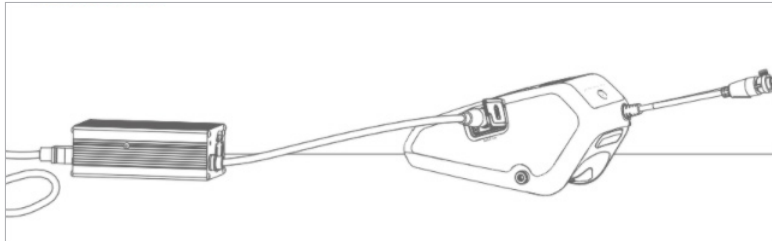

1. Overtimepack only.

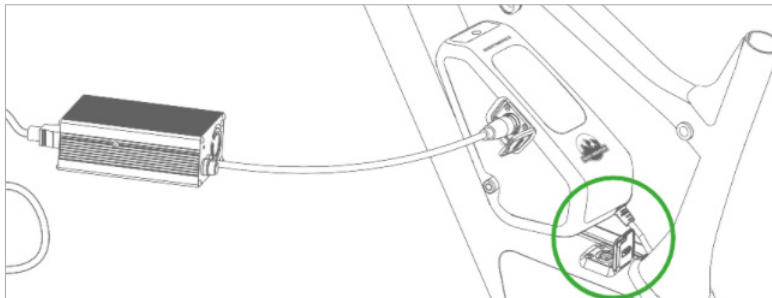

2. Overtimepack disconnected from bike.

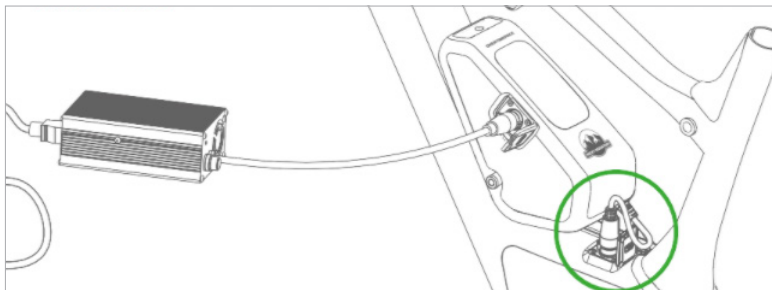

3. Overtimepack connected to bike.

Step 1**Step 2****1.3 Warnings:**

- Do not leave the charger in direct sunlight, especially during charging.
- Do not leave the Overtimepack connected to the charger or Powerplay bike for a period longer than 12 hours.
- Charge your Overtimepack in an open area with clear access to an outside exit.
- As with all bikes and equipment with lithium-ion batteries, it is recommended to never leave a charging bike unattended.
- If the Overtimepack is cold (below 0°C) or hot (above 30°C), allow 1 hour for the Overtimepack to readjust to room temperature before charging.
- The Overtimepack does not need to be fully charged, but we recommend fully charging it once every 10 charges.
- It is recommended to charge the Overtimepack after each ride.
- Charging time will vary depending on remaining energy in the Overtimepack. Charging time is illustrated on the graph to the right.

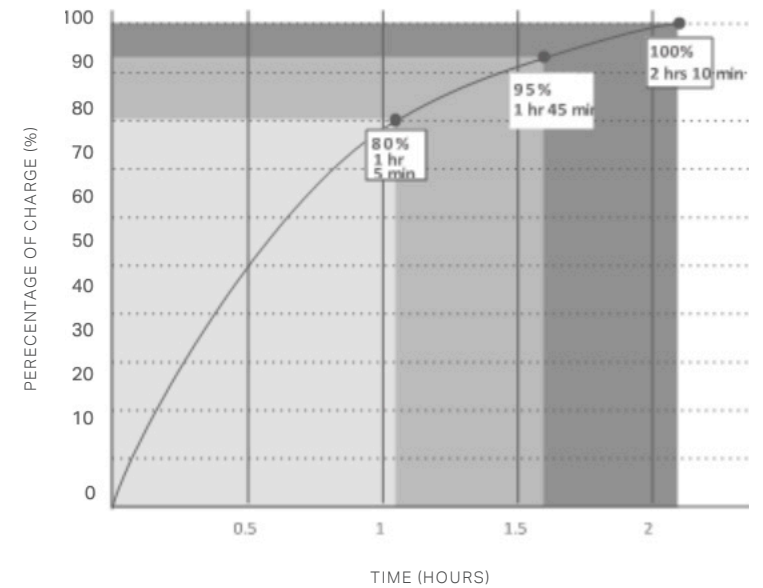

Step 1**Step 2**

Charging the Overtimepack

- 2.1** Plug the charger into an electrical source.
The green LED will illuminate.



- 2.2** Find the charging port on the Overtimepack and open it.

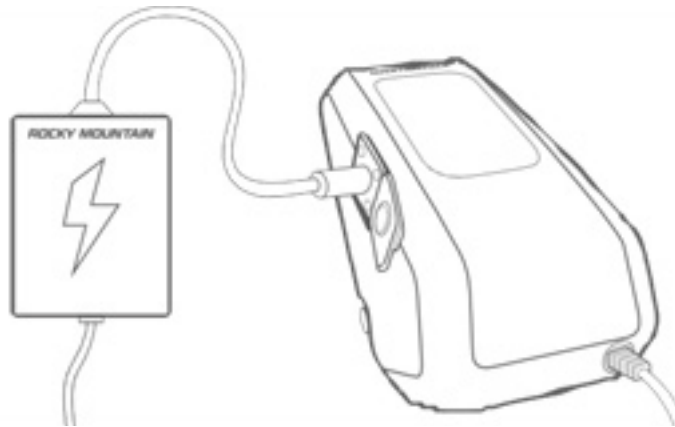

Step 1**Step 2**

2.3 Connect the charger to the Overtimepack and ensure that the locking system on the port is engaged by screwing down the locking collar. The green LED will turn red to indicate that the Overtimepack is charging.

2.4 Once charging is complete, the LED will turn green. It is not mandatory to disconnect the charger as soon as charging is complete; however, you should not leave the charger plugged in for a period longer than 12 hours.



LOVE THE RIDE

Development Centre

1225 East Keith Road, Unit #10
North Vancouver, BC Canada, V7J 1J3
T. 604-980-9938 F. 604-980-9975

Head Office

9095, 25th Avenue,
Saint-Georges, QC Canada G6A 1A1
T. 1-800-663-2512 F. 1-800-570-8356