



Kitchen Composter User Manual



Download the
Vegö App to get started!



Contents

Vego Kitchen Composter

•
02

Safety
Instructions

•
04

Power
Cord Notice

•
05

Product
Specifications

•
06

Vego
Composter Parts

•
07

Buttons
and Lights

•
09

How to Start
Using the Device

•
11

Vego
Composter Modes

•
14

Operating
Your Composter

•
19

Tips for
Effective Composting

•
21

What Can I Put in
My Vego Composter

•
23

Vego Meal
Usage Guide

•
24

How to Maintain
My Vego Composter

•
25

Troubleshooting

•
28

Frequently
Asked Questions

Safety Instructions

- Please read this manual and follow the directions before using the Vego Composter for the first time.
- Children should only use this product under supervision.
- Before using the composter, make sure your device's voltage matches that of your power socket.
- Make sure your composter is on a flat surface when operating. To allow proper airflow, ensure it is at least 6 inches away from walls and backsplashes.
- Do not place the power cord in water, or any other liquids to avoid electrical shock.
- Do not let the power cord hang over the side of a counter or table or come into contact with hot surfaces.
- Keep the Vego Composter out of direct sunlight, and away from appliances that produce heat like ovens and stoves.
- To prevent burns, please do not touch the inner bucket while the machine is operating, even though opening the lid during operation is allowed.
- Do not use your hands or fingers when trying to clear a jam, and always ensure the composter is turned off and unplugged before inserting your hands into the device.
- Unplug and wipe the device's exterior with a soft dry cloth when cleaning. Do not wipe the exterior with strong acid or alkaline solid cleaners to avoid corrosion or discoloration.
- Always unplug the unit when not in use and when adding or removing parts (such as filters.)
- When the composter is idle, always keep it stored away from a dirty environment and ensure the lid stays closed to prevent items from falling into it.
- Activated carbon with a diameter of 4mm or more is recommended for use with this device. If activated carbon below a diameter of 4mm is used, it may cause damage to the fan or lead to device failure.

- Do not use the Vego Composter for anything other than its intended use, and do not alter or adapt it in any way.
- Do not use any attachments that are not recommended or sold by other manufacturers, as these could damage the machine. Damage caused from using such accessories will affect warranty service for the device.
- If the device is malfunctioning or damaged, please contact us for assistance via email at hello@vego.com



Scan the QR code above
or visit vego.com to learn more about
your Vego Composter in the simplest way.

Power Cord Notice

A. A short power supply cord is provided with the device to prevent accidents from tangling or tripping.

B. Extension cords should be used with discretion. When using an extension cord:

1. The rated voltage should be the same as that of the device - 120 volts
2. Use a grounded 3-prong cord
3. Longer cords should not drape over counters or tabletops as they could cause hazards



Scan the QR code above
or visit vego.com to learn more about
your Vego Composter in the simplest way.

Product Specifications

Modes	Vego. Express. Fertilize. Grass. Clean
Rated Input	120Vac 60Hz
Rated Power	400W
Wi-Fi	IEEE 802.11b/g/n 2.4GHz
Bluetooth	BLE (Bluetooth 5)
Power Consumption	Vego: Less than 1.5 KWh Express: Less than 1 KWh Fertilize: Less than 1.5 KWh Grass: Less than 1.5 KWh Clean: Less than 0.2 KWh
Processing Duration	Vego: 9-24 hrs Express: 2-8 hrs Fertilize: 9-22 hrs Grass: 11-24 hrs Clean: 0.5 hrs
Capacity	4L
Waste Volume Reduction	85% - 95%
Noise Level	< 50 dB
Product Dimensions	14.37 x 11.22 x 12.63 inches
Product Weight	16.64 lb (7.55kg)
Package Dimensions	17.13 x 14.17 x 15.75 inches
Package Weight	20.1 lbs (9.1kg)
Safety Regulation & Certifications	ETL & CETL, FCC, IC

Vego Composter Parts

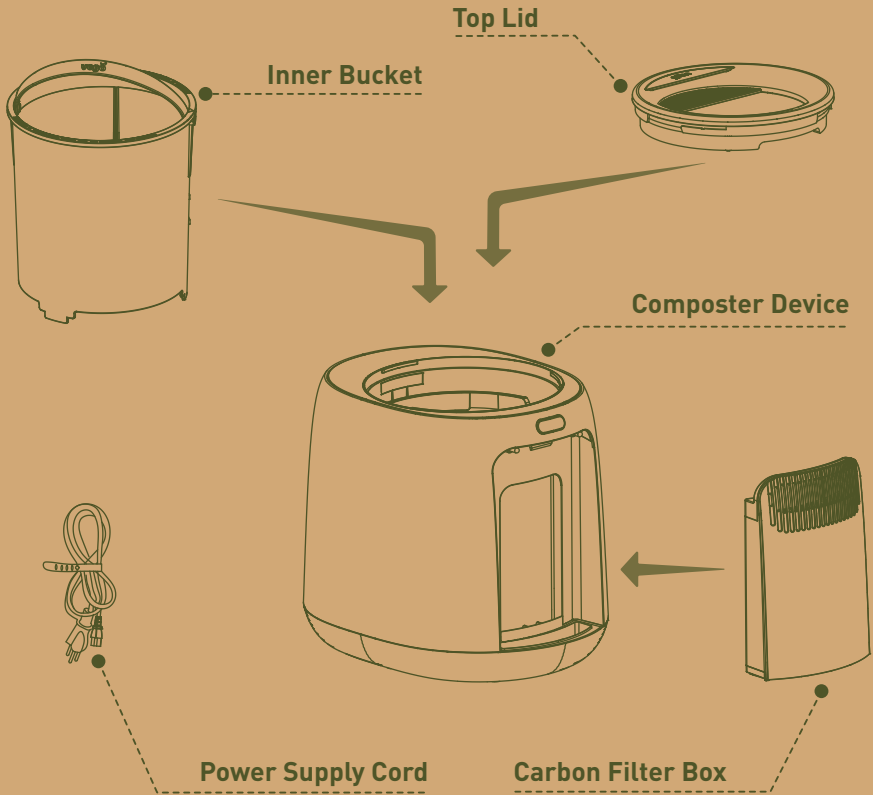

Carbon Filter Refill Kit



VegoTabs

Buttons and Lights

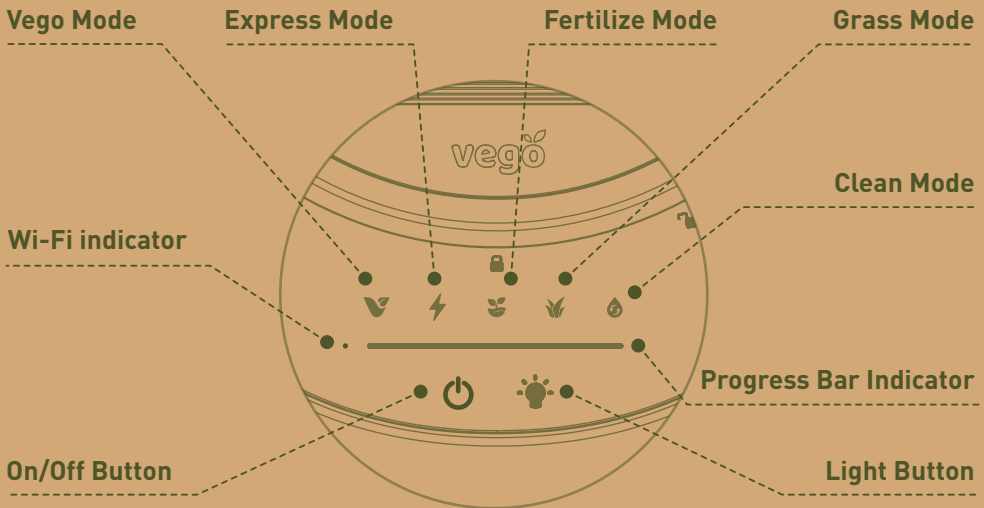

On/Off Button:

Press the button to turn on the device and press for three seconds to turn off.

Light Button:

Press once to turn the light on or off. The light will turn off after one minute.

Wi-Fi Indicator:

When the light flashes, this indicates the device is not connected to Wi-Fi. When the light is steady, the device is connected to Wi-Fi.

Progress Bar Indicator:

The Progress Bar lights represent the status of the Express, Fertilize, Grass, and Clean modes. When the bar is fully lit, this means a cycle is complete.

Selecting A Mode:

With the device turned on, press the mode button for your desired mode.

Pause Modes:

To pause an active cycle, press the mode button. The mode light will flash. If no action is taken within a minute, the current mode will automatically resume.

Stop and Change Modes:

To stop an active cycle, press and hold the mode button for 3 seconds. Then press any mode button to switch modes.

Vego Mode Cycle Completion:

When the Vego mode light is on, and the on/off and Wi-Fi lights are on - this means a Vego Mode cycle has finished.

Standby Mode:

After a cycle ends and if there are no further cycles to run, the device will automatically enter standby power-saving mode after 3 minutes. All lights will be turned off apart from the Wi-Fi light. Any further action will reactivate the device from standby mode.

- If the device was in Vego Mode before standby, it will remain in Vego Mode upon reactivation.
- If the device was in another mode before standby, you can select the desired mode again to resume operation.

Error & Weight Reset:

For Errors

- Press and hold the Clean button for 3 seconds to clear an error during the cycle.

For Weight Reset

- Press and hold the Clean button for 3 seconds to reset the scale when the cycle is not running and the inner bucket is removed.

Factory Reset:

Press and hold the Clean button for 10 seconds when the cycle isn't running. All lights will flash three times, indicating factory reset. Reconnect Wi-Fi afterward.



Scan the QR code above
or visit vego.com to learn more about
your Vego Composter in the simplest way.

How to Start Using the Device



How-To Video

1. Find a perfect location for your Vego Composter

- Unbox and check whether the product is intact. Place your composter on a flat and dry surface close to a power source.
- Be sure to place the device at least 6 inches away from walls to maintain sufficient airflow during operation.

2. Install the Carbon Filter Refill kit and the Power Cord

- Remove the top lid and take out the Carbon Filter Refill Kit and power cord from the inner bucket.
- Install and secure the Carbon Filter Refill Kit to prevent odors.

1. Remove the Carbon Box

Press the release button to remove the carbon box.

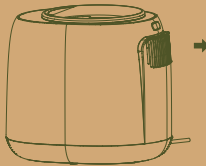

2. Add Carbon Filter Refill Kit

- Slide open the bottom
- Add activated carbon
- Place filter pad on top

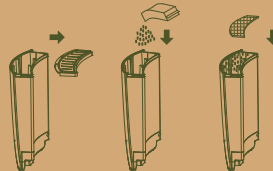

3. Replace the Cover

Slide the cover back into place, ensuring it is sealed securely.

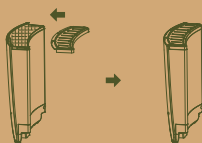

4. Install the Carbon Box

Place the carbon box into the slot, and press down to secure it in place.

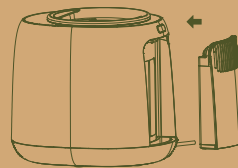

- Plug in the power cord and press the on/off button to turn your device on.

3. Download & install the app on your smartphone to manage your composter easily

● Scan the QR code using your phone or download the iOS/Android app from the App Store or Google Play.



- Create your account in the app by following the instructions.
- Enable Bluetooth access for the Vego App
- Click “Add Devices”
- Find & select the name of your device
- Click “Connect” to pair the device

Note:

If your composter does not pair properly, check that the wifi and bluetooth lights are on. If you continue to experience issues pairing, refer to page 26, or contact us at

hello@vego.com



Scan the QR code above
or visit **vego.com** to learn more about
your Vego Composter in the simplest way.

Vego Composter Modes



Moderated temperature processing helps preserve beneficial nutrients, creating a rich, biologically active garden amendment. (9-24 hrs/cycle)

Benefits of using Vego Mode:

Vego Mode is a special setting that enables continuous loading of kitchen scraps to create a rich soil amendment. You can open the lid to add kitchen scraps at any time, without needing to remove the contents after the cycle is done. This mode maximizes your composting time with a unique program that maintains internal temperature, humidity, and ventilation, processing every 2 hours, ensuring optimal end product maturity. The device can remain on standby for up to 10 days, ensuring that Vego Mode can operate autonomously even while you are away.

What can you put in:

From a composting perspective, we highly recommend referring to the chart on Vego.com to determine what types of green waste can be processed. These materials produce Vego Meal that is more beneficial for plant nutrition needs. For a detailed list, please refer to [page 21](#).

VegoTab:

Add one VegoTab and 2.7oz of water into the bucket with your scraps to help accelerate the breakdown of organic matter, and boost overall compost quality for better gardening. Remember, add only one tab per cycle.

What to do with your Vego Meal:

Mix it with soil in a **1:10 ratio**, or toss it into your outdoor composter for secondary composting.



Express

Rapid drying and grinding mode that efficiently reduces waste volume. (2-8 hrs/cycle)

Benefits of using Express Mode:

This is a non-compost mode designed to quickly process your kitchen waste, offering an eco-friendly solution for green waste.

What can you put in:

We highly recommend referring to the chart on Vego.com to determine what types of green waste can be processed. For a detailed list, please refer to **page 21**.

What to do with your Vego Meal:

Toss it into your outdoor composting bin, or Vego Worm Composter for secondary composting.



Fertilize

Produces semi-composted material quickly and efficiently for garden use. (9-22 hrs/cycle)

Benefits of using Fertilize Mode:

Produces semi-composted material quickly and efficiently for garden use.

What can you put in :

From a composting perspective, we highly recommend referring to the chart on Vego.com to determine what types of green waste can be processed. These materials produce Vego Meal that is more beneficial for plant nutrition needs. For a detailed list, please refer to **page 21**.

VegoTab:

Add one VegoTab and 2.7oz of water into the bucket with your scraps to help accelerate the breakdown of organic matter, and boost overall compost quality for better gardening. Remember, add only one tab per cycle.

What to do with your Vego Meal:

Mix it with soil in a **1:10 ratio**, or toss it into your outdoor composter for secondary composting.



Additional grinding speeds up biodegradation, creating nutrient-rich, ready-to-use organic matter for your lawn. (11-24 hrs/cycle)

Benefits of using Grass Mode:

Recommended for lawn nutrition, and specifically designed to boost the nutrition of your lawn. No additional steps are required—simply spread the produced compost on your lawn.

What can you put in:

From a composting perspective, we highly recommend referring to the chart on [Vego.com](https://vego.com) to determine what types of green waste can be processed. These materials produce Vego Meal that is more beneficial for plant nutrition needs. For a detailed list, please refer to **page 21**.

VegoTab:

Add one VegoTab and 2.7oz of water into the bucket with your scraps to help accelerate the breakdown of organic matter, and boost overall compost quality for better gardening. Remember, add only one tab per cycle.

What to do with your Vego Meal:

Sprinkle it on your lawn, mix it with soil in a **1:10 ratio**, or toss it into your outdoor composter for secondary composting.



Add water to clean the bucket, or use without water to quickly dry the bucket and internal filter. (0.5 hrs/cycle)

Tip: The Maintenance mode is specifically designed for maintaining your device. Add water to soften any hardened grime that may have accumulated after long-term use, making it easier to clean the inner bucket. When used without adding water, the inner bucket and filter will be quickly dried.

Operating Your Composter

1. Plug in your device and press the on/off button to turn on your device

Your Vego Composter comes with a built in scale. To activate, please make sure the device is turned on before adding kitchen waste.

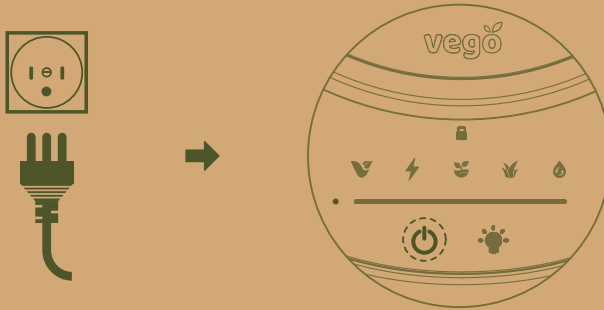

2. Open the lid by turning it towards the arrow and remove the bucket

Hold the handle and turn it counterclockwise until the triangle symbol on the lid aligns with the “unlocked” position. Then, lift the lid up to open. Next, pull the bucket straight up. Or you can opt to not remove the inner bucket, and just add kitchen waste directly into it.

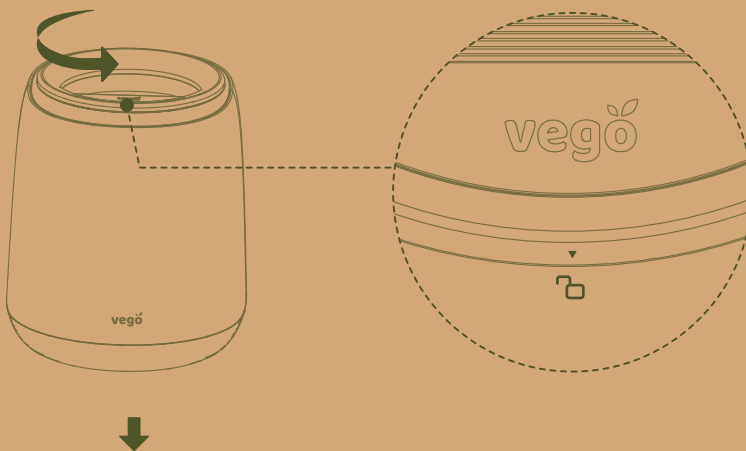

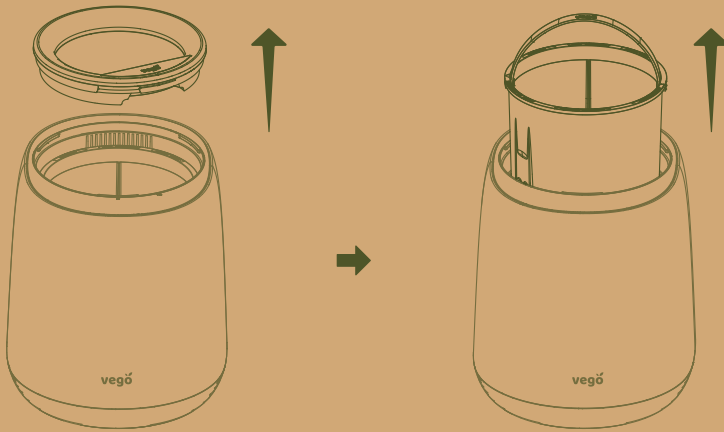

3. Add kitchen waste and VegoTabs into the bucket

Based on the mode you wish to run, add the corresponding kitchen waste into the bucket. For reference on different types of kitchen waste, please refer to **page 21**. You can also choose whether or not to add VegoTab. Then, insert the inner bucket into the device. When putting the inner bucket in place, ensure that the triangle symbol on the bucket aligns with the triangle symbol on the left side of the device.

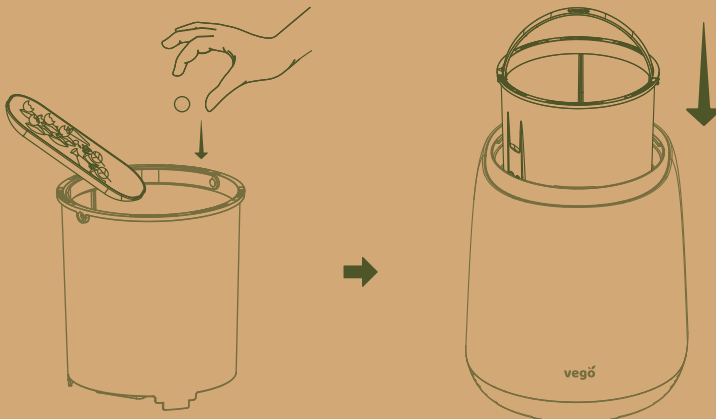

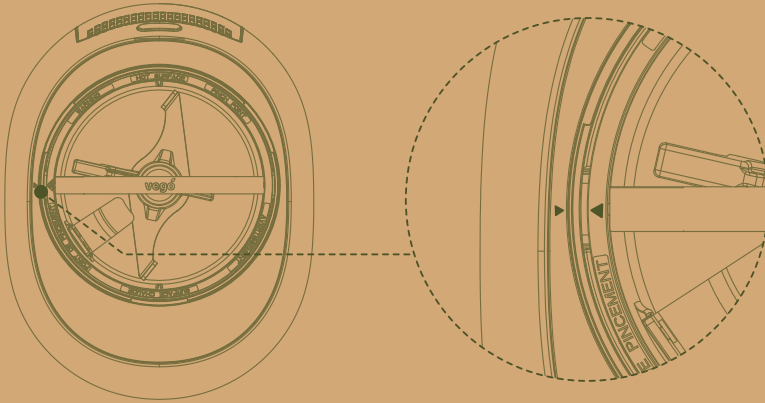
**Note :**

When placing the bucket into the device as shown in Step 3, Turn it slightly clockwise and then counterclockwise. And push it down to the bottom with a bit of force to ensure it is completely secured in the right position after it is aligned with the “▲” icon. If the lid does not close properly, remove the inner bucket and reinstall it.



Scan the QR code above
or visit vego.com to learn more about
your Vego Composter in the simplest way.

4. Close the lid and start your selected mode

Align the triangle symbol on the lid with the "unlocked" icon on the device. Turn the lid to the left until the triangle symbol is aligned with the "locked" icon. Then, press the button of the mode you'd like to select. The corresponding light will flash for 3 seconds. During these 3 seconds, if you wish to switch to another mode, you can press and select the desired mode again. Once the flashing stops, the mode cannot be changed, and the composting cycle will begin.



Tip:

You can add more kitchen waste even when your device is operating within a specific mode. Just press the selected mode button to pause the process and open the lid. The cycle duration will be rescheduled according to the new weight. After closing the lid, the cycle will resume automatically. If you want to change the mode during a cycle, just press the mode button for 3 seconds to stop the current cycle and select a new one.

5. Completion of Cycles

Vego Mode:

When the cycle is complete, you will hear a beeping sound from the device, and the Vego light will remain lit. If there are no further cycles, the device will enter standby power-saving mode after three minutes, and all lights will be turned off apart from the Wi-Fi indicator.

Other modes:

The progress bar indicator will be fully lit, and the corresponding mode light will remain lit as well. If there are no further cycles, the device will enter standby power-saving mode after three minutes, and all lights will be turned off apart from the Wi-Fi indicator.

Note :

After a cycle is finished, the bucket will still be hot. If you want to clean it immediately, wear heat-resistant gloves to avoid burns.



Scan the QR code above
or visit vego.com to learn more about
your Vego Composter in the simplest way.

Tips For Effective Composting

Use the Right Food Scraps

It is recommended to use fruit and vegetable scraps for composting, and to minimize the use of oily and sugary foods. When putting scraps into the inner bucket, make sure they are cut into small pieces first. This will ensure output that better supports plant health.

Excess Moisture

If your kitchen waste is very wet, pour out excess water first before processing.

Capacity of the Inner Bucket

To ensure optimal operation, do not exceed the **max line** in the inner bucket when adding kitchen waste. When using the Clean Mode, do not exceed the **water line** when adding water.

VegoTabs

VegoTabs speed up the breakdown of organic matter and boost overall compost quality for better gardening. They can be used with the Vego, Fertilize and Grass modes to process kitchen waste into composted materials for gardens.

Weighing Function

Make sure the device is turned on before adding kitchen waste. If you remove the inner bucket, the device will reset the weight to 0 after 3 seconds to ensure accuracy.

Extended Composting

If you need to keep the contents in the bucket for more than 24 hours, it is advised to use Vego Mode. This will ensure effective composting while you are away.

Vego Mode's Automatic Recurring Cycle

After the completion of a cycle, Vego Mode will automatically run for a minute every 2 hours. This intelligent feature helps maintain the optimal composting environment in the inner bucket and prevents molding. Rest assured that this is a normal part of our smart system.

Preventing Odor and Mold in Your Composter

Try not to leave food scraps in the bucket for more than one day. If you need to continuously add food scraps or will be away, switch to Vego Mode.

Carbon Filter Refill Kit

Use this to eliminate odors and keep your kitchen smelling fresh. If you notice odors or receive a replacement notice via the app, replace the activated carbon in your filter following the steps on **page 09**.

Cleaning

If residue sticks to the bucket after a cycle ends, you can use the Clean Mode to remove it. Additionally, you may hand wash it or wash the inner bucket in the dishwasher. Make sure to dry the bucket completely before use.



Scan the QR code above
or visit **vego.com** to learn more about
your Vego Composter in the simplest way.

What Can I Put in My Vego Composter

Please refer to below list when refilling your composter, or visit <https://vego.com/pages/what-goes-in-vego> to download the Vego App for details.

Always

Fruit/Vegetable Scraps:

Banana peels, apple peels, tomato tops, onion bottoms, potato peels, avocado skins, carrot tops, vegetable & fruit ends, broccoli & cauliflower stems, apple cores, etc.

Tea & Coffee:

Loose tea and coffee grounds.

Meal Leftovers:

Small quantities of prepared foods like grains, egg shells, fish scraps, meat scraps, sauces, & dairy products (cheese, yogurt, etc.)

Herbaceous Houseplants:

Herbaceous plants (as opposed to woody varieties) have soft stems, leaves & flowers (under 2 in.)

Starches:

Bread, pasta, rice, potatoes, cereals, oats and other grains.

Limited

Fibrous Waste:

Chopped up corn husks & nut shells.

Sticky Foods:

Honey, maple syrup, jams, nut butters, etc. (in very small amounts.)

Biodegradable Materials:

Unbleached: Food-soiled paper napkins, tea bags, coffee filters.

⊗ Never

Meats & Dairy:

Large amounts of chicken, beef, pork, & lamb, excessive cheeses & yogurts.

Fats & Oils:

Solid fats (butter, margarine, lard), cooking oils.

Hard Waste:

Woody plant matter (sticks & branches), salt, hard bones (chicken, beef, pork, lamb, etc), fruit pits, pineapple heads, walnut shells (toxic to plants.)

Synthetic Waste:

Soaps, shampoo & conditioner, packaging, diapers, baby wipes, feminine hygiene products, pet feces, cigarettes, styrofoam, synthetic chemicals (including cleaners, disinfectants, etc.)

Recyclable Waste:





Paper, envelopes, paper boxes, metal, plastics, glass.

Tip:

- For optimal composting, please break down food waste into small pieces before putting it in. If the waste contains too much liquid, please filter out the water first
- For the sake of plant nutrition, please follow the list to fill your composter, and keep sugary and oily scraps to a minimum for Vego, Fertilize, and Grass modes

Vego Meal Usage Guide

Vego Meal, the nutrient-rich output from our Kitchen Composter, can be used as a soil amendment, reducing waste and closing the "garden to table & back again" loop. Here are some recommended uses for each mode:

Mode	Usage	Details
 Vego	Indoor Plants, Outdoor Plants, Garden Beds, Planters, Lawns	Add to potting soil or use as a topdressing. Mix Vego Meal with soil in a 1:10 ratio. Higher maturity reduces pest attraction.
 Fertilize	Outdoor Plants, Garden Beds, Planters	Topdress using a 1:10 ratio of Vego Meal to soil. Adjust the ratio based on plant stages for optimal growth.
 Grass	Lawn, Outdoor Plants, Garden Beds, Planters	Use as a topdressing. Apply in the morning or evening, during rainy or dry days. Use a 1:10 ratio of Vego Meal to soil. Grass mode output is ideal.
 Express	Garden Composter, Worm Composter, Storage, Green Bin	Add excess to compost piles to stimulate composting, or in airtight containers for later use. Reduced volume and odor make it ideal for composting.

We recommend spreading your Vego Meal evenly, rather than applying it all in one area. While pets are unlikely to consume Vego Meal, if swallowed and your pets show discomfort after consumption, discontinue use in areas they can access. Additionally, used activated carbon can be added to your kitchen composter with food scraps, or mixed into soil as an additive at a 1:5 ratio.

For more details, please refer to the comprehensive guide on our website:

<https://vego.com/blogs/composting-knowledge>

How to Maintain My Vego Composter

Cleaning your Vego Composter

To maintain and upkeep your composter, it is important to keep it clean. We recommend cleaning the exterior of your device once a month or as frequently as your other kitchen appliances. To ensure optimal performance, clean your inner bucket every time it is emptied.

- Unplug the power cord before cleaning.
- Please use a soft, damp cloth to wipe the exterior surfaces of the Vego Composter, including detachable parts such as the lid, inner bucket surface, and carbon filter box. If heavily soiled, you may use a small amount of dish soap. After cleaning, ensure to dry the surfaces thoroughly.
- Do not submerge your device in water as it contains electrical components that could be damaged by water and may cause electric shock.

Cleaning your bucket

Different types of kitchen waste may leave residue on the inner walls or blades. After cleaning out the Vego Meal, you can remove the residue as follows:

- Clean the inner surface and any food residue using a brush and soap right away.
- For stubborn residue, add water to the waterline inside the bucket, cover with the lid, and activate Clean Mode. After the mode ends, pour out the dirty water and wipe clean.
- The inner bucket is dishwasher safe. Run a hot cycle, and after it completes, allow the bucket to cool before placing it back in the machine.
- Ensure the inner bucket is dry and cool before reinserting it into the device.

The Carbon Filter Refill Kit

The Carbon Filter Kit helps absorb odors produced during the composting process. You need to replace this periodically. Your device will notify you when it's time to replace the filter, or you can replace it every three months or whenever you notice strong odors.

Purchase a Carbon Filter Refill Kit at the following link:

<https://vego.com/pages/installation>

Troubleshooting

Heating Error



Cycle will pause. The progress light 2 will blink. To resolve, press and hold the Clean Mode button for 3 seconds or power off and restart the device. If neither resolves the error, please contact: hello@vego.com

Grinder Jam



Cycle will pause. The progress light 3 will blink. To resolve, press and hold the Clean Mode button for 3 seconds or power off and restart the device. If neither resolves the error, please contact: hello@vego.com

Internal Communication Error



Cycle will pause. The progress light 4 will blink. To resolve, press and hold the Clean Mode button for 3 seconds or power off and restart the device. If neither resolves the error, please contact: hello@vego.com

Ventilation Error



Cycle will pause. The progress light 5 will blink. To resolve, press and hold the Clean Mode button for 3 seconds or power off and restart the device. If neither resolves the error, please contact: hello@vego.com

WiFi Error



If your Vego Composter loses Wi-Fi connection, the Wi-Fi indicator will flash and attempt to reconnect. If it doesn't reconnect, check if your phone's Wi-Fi is off; if so, turn it on. Your Vego Composter will try to reconnect again. If the issue persists, please contact: hello@vego.com

Open Lid During Cycle



The corresponding mode light will flash when the lid is removed from the device, pausing the cycle. Once the lid is back in place, the mode light will remain steady, and the cycle will resume.

Change Filter



When all 5 progress lights flash, replace the carbon filter. After replacing, press and hold the Clean Mode button for 3 seconds to reset the reminder.

Inner Bucket is Misaligned



If the inner bucket is not properly seated, all 5 mode lights will flash simultaneously. Ensure the inner bucket is correctly positioned to resolve this.

Inner Bucket is Misaligned

If you open the lid during the cycle and the bucket gets stuck:

1. Close the lid
2. Start any mode to rotate the bucket
3. Pause the cycle by pressing the corresponding mode button
4. Open the lid and try removing the bucket again

Note: The bucket may be hot during operation. To avoid burns, wear heat-resistant gloves or allow the bucket to cool before removal.

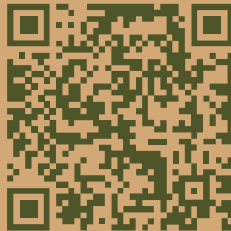

Scan the QR code above
or visit vego.com to learn more about
your Vego Composter in the simplest way.

Frequently Asked Questions

1. Why does Vego Mode continue to run automatically for one minute every two hours after entering standby mode?

Vego Mode is designed as a continuous composting mode. Despite the completion of the pre-composting cycle, we continue to provide temperature control, ventilation, and occasional agitation to maintain optimal composting conditions within the bucket. This ensures a continuous composting process and prevents the Vego Meal from molding. If left uninterrupted, this process can last for up to 10 days before the device enters final standby mode.

2. How can I tell if the composted material is too dry or too wet

A general rule of thumb is that the moisture level should be that of a well squeezed sponge. However, due to variations in moisture content of different kitchen waste, if you find your output too wet, we recommend starting a new cycle.

For more questions, please go to <https://vego.com/pages/faq>

Changes or modifications to this unit not expressly approved by the party responsible for compliance could void the user's authority to operate the equipment.

NOTE: This equipment has been tested and found to comply with the limits for a Class B digital device, pursuant to Part 15 of the FCC Rules. These limits are designed to provide reasonable protection against harmful interference in a residential installation. This equipment generates, uses, and can radiate radio frequency energy and, if not installed and used in accordance with the instructions, may cause harmful interference to wifi communications.

However, there is no guarantee that interference will not occur in a particular installation. If this equipment does cause harmful interference to radio or television reception, which can be determined by turning the equipment off and on, the user is encouraged to try to correct the interference by one or more of the following measures:

- Increase the separation between the equipment and receiver.
- Connect the equipment into an outlet on a circuit different from that to which the receiver is connected.
- Consult the dealer or an experienced technician for help.

This equipment complies with FCC radiation exposure limits set forth for an uncontrolled environment. This equipment should be installed and operated with a minimum distance of 20cm between the radiator & your body. This transmitter must not be co-located or operating in conjunction with any other antenna or transmitter.

This device contains license-exempt transmitter(s)/receiver(s) that comply with Innovation, Science and Economic Development Canada's license-exempt RSS(s). Operation is subject to the following two conditions:

(1) This device may not cause interference.

(2) This device must accept any interference, including interference that may cause undesired operation of the device.

L'émetteur/récepteur exempt de licence contenu dans le présent appareil est conforme aux CNR d'Innovation, Sciences et Développement économique Canada applicables aux appareils radio exempts de licence. L'exploitation est autorisée aux deux conditions suivantes :

1) L'appareil ne doit pas produire de brouillage;

2) L'appareil doit accepter tout brouillage radioélectrique subi, même si le brouillage est susceptible d'en compromettre le fonctionnement.

This equipment complies with FCC's and IC's RF radiation exposure limits set forth for an uncontrolled environment. The antenna(s) used for this transmitter must be installed and operated to provide a separation distance of at least 20 cm from all persons and must not be collocated or operating in conjunction with any other antenna or transmitter. Installers must ensure that 20cm separation distance will be maintained between the device (excluding its handset) and users.

Cet appareil est conforme aux limites d'exposition au rayonnement RF stipulées par la FCC et l'IC pour une utilisation dans un environnement non contrôlé. Les antennes utilisées pour cet émetteur doivent être installées et doivent fonctionner à au moins 20 cm de distance des utilisateurs et ne doivent pas être placées près d'autres antennes ou émetteurs ou fonctionner avec ceux-ci. Les installateurs doivent s'assurer qu'une distance de 20 cm sépare l'appareil (à l'exception du combiné) des utilisateurs.

***From
Garden
to
Table***
and back again



Scan the QR code above
or visit vego.com to learn more about
your Vego Composter in the simplest way.