



Battery Bank Installation User's MANUAL

Table of Contents

Chapter 1.	Important Safety Instructions	2
Chapter 2.	Introduction to the Rear Panel	4
2.1.	Rear Panel Descriptions	4
Chapter 3.	Installation and Operation	5
3.1.	Unpacking	5
3.2.	Selecting Installation Position	6
3.3.	Installation of Casters Cover and Rack/Tower kits	6
3.4.	Installation Instructions.....	7
3.5.	Storage Instruction	9
Chapter 4.	Specification	10

Chapter 1. Important Safety Instructions

SAVE THESE INSTRUCTIONS

This manual contains important instructions that should be followed during installation and maintenance of the battery bank and batteries.

An Important Notice

- This battery bank is connected to an UPS. There will be over 240 DC voltage at the output terminals if the UPS or DC breaker is turned on.
- Do not try to repair the unit yourself, contact your local supplier or your warranty will be void.
- To eliminate any overheating of the battery bank, keep all ventilation openings free from obstruction and do not place any foreign objects on top of the battery bank. Keep the battery bank 20 cm away from the wall.
- Make sure the battery bank is installed within the proper environment as specified. (0-40° C and 30-90% non-condensing humidity)
- Do not install the battery bank under direct sunlight. Your warranty will be void if the batteries fail due to overheating.
- This battery bank is designed for indoor use only.
- This battery bank is not designed for use in dusty, corrosive and salty environment .
- The warranty for this battery bank will be void if water or other liquid is spilt or poured directly onto the battery bank. Similarly we do not warrant any damage to the battery bank if foreign objects are deliberately or accidentally inserted into the battery bank enclosure.
- The battery will discharge naturally if the system is unused for a period of time.
- It should be recharged every 2-3 months if unused. If this is not done, then the warranty will be null and void. During normal operation, the batteries will be automatically remained in charged condition.

- Servicing of Batteries Should be Performed or Supervised by Trained Personnel with Knowledge of Batteries and the Required Precautions
- When Replacing Batteries, Replace With the Same Quantity, Type & Capacity.
- CAUTION – Do Not Dispose of Battery or Batteries in an open fire. The Battery May Explode.
- CAUTION – Do not open or mutilate the batteries. The electrolyte from the batteries is toxic and harmful to the skin and eyes.
- CAUTION – Risk of Electric Shock – Battery Circuit is not isolated from AC, hazardous Voltage may exist between battery terminals and ground. Test before touching with bare hands.
- CAUTION – A Battery can present a Risk of Electrical Shock and High Short Circuit Current. The Following Precaution Should be Observed When Working on Batteries:
 - A. Remove watches, rings, or other metal objects.
 - B. Use tools with insulated handles.
 - C. Wear rubber gloves and boots.
 - D. Do not lay tools or metal parts on top of batteries.
 - E. Disconnect charging source prior to connecting or disconnecting battery terminals.

Chapter 2. Introduction to the Rear Panel

2.1. Rear Panel Descriptions

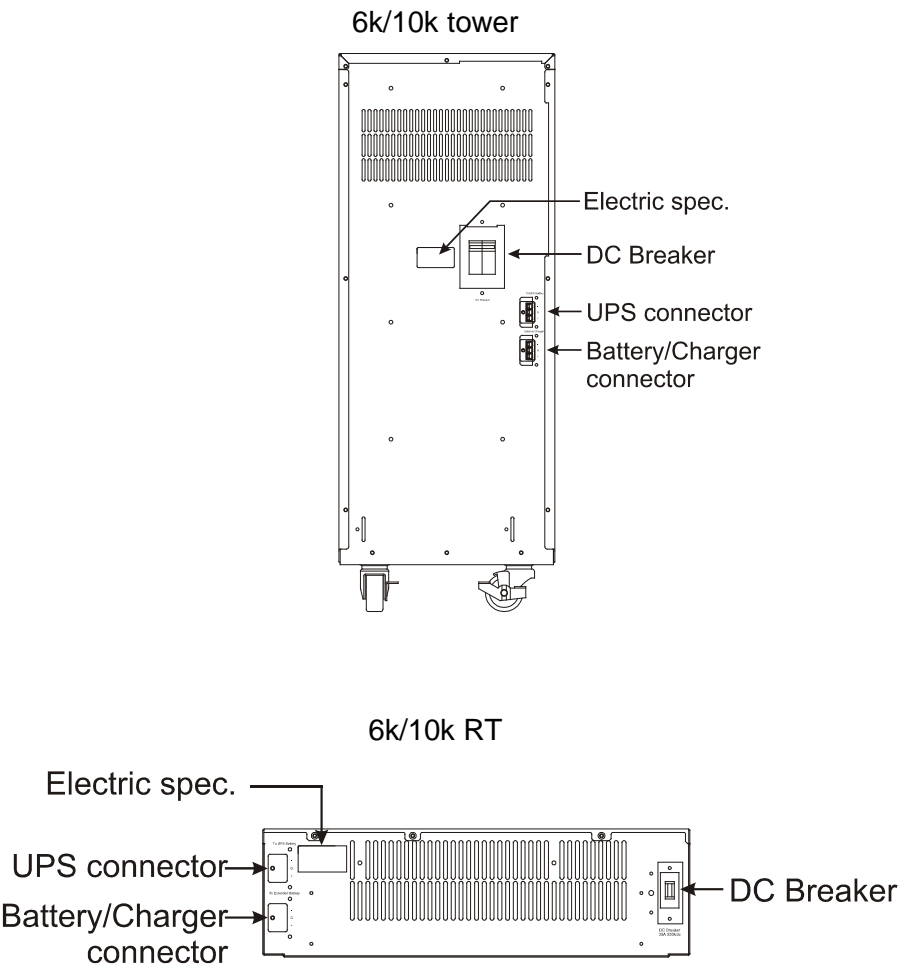

Chapter 3. Installation and Operation

Note: The packing condition and the external outlook of the unit should be inspected carefully before installation. Retain the packing material for future use.

3.1. Unpacking

3.1.1. Take the battery bank out of the PE foam.

3.1.2. Remove the packing materials.

Note: The battery bank module is approx. 120 kgs, be cautious when unpacking and lifting the unit to avoid injury.









3.1.3. Standard Package includes:

3.1.3.1. User's Manual

3.1.3.2. DC connect cable (C1 or ) .

3.1.3.3. A pair of kits to fix DC connect cable (A4 or ) .

3.1.3.4. The casters cover kits A1~A3 and S1 for Tower model.

3.1.3.5. The Rack/Tower kits  ~  ,  ~  ,  ~  and  ~  for RT model.

(Optional) A1  X 2

(Optional) A2  X 2

(Optional) A3  X 1

A4  X 2

(Optional) S1  X 4

C1  X 1

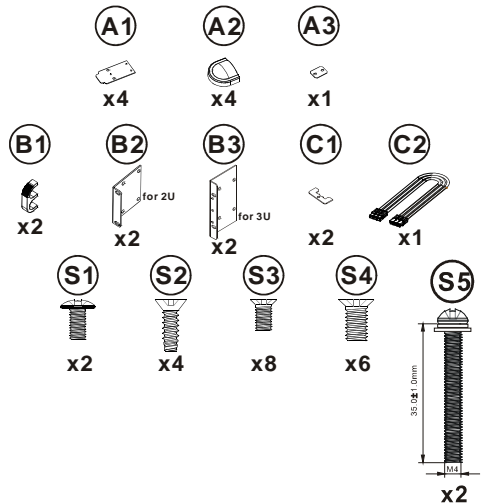

3.2. Selecting Installation Position

It is necessary to select a proper environment to install the unit, in order to minimize the possibility of damage to the battery bank and extend the life of the batteries. Please follow the instructions below:

- 3.2.1. Keep at least 20cm(8 inches) clearance from the rear panel of the battery bank from the wall or other obstructions.
- 3.2.2. Do not block the air-flow to the ventilation openings of the unit.
- 3.2.3. Please ensure the installation site environmental conditions are in accordance with the battery bank working specifications to avoid overheat and excessive moisture.
- 3.2.4. Do not place the battery bank in a dusty or corrosive environment or near any flammable objects.
- 3.2.5. This battery bank is not designed for outdoor use.

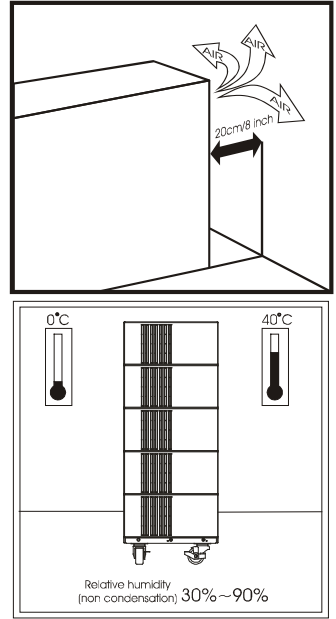

3.3. Installation of Casters Cover and Rack/Tower kits

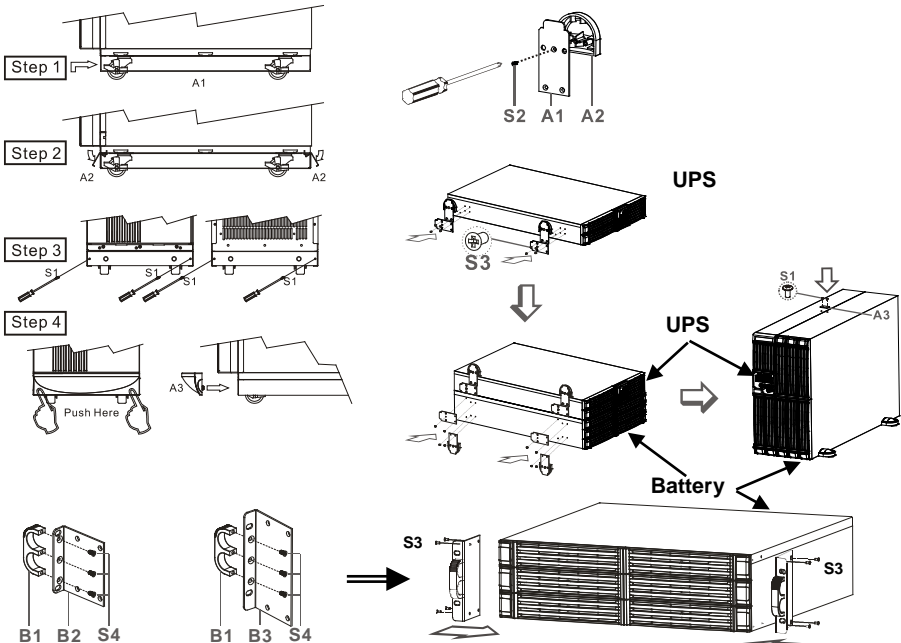

3.4. Installation Instructions

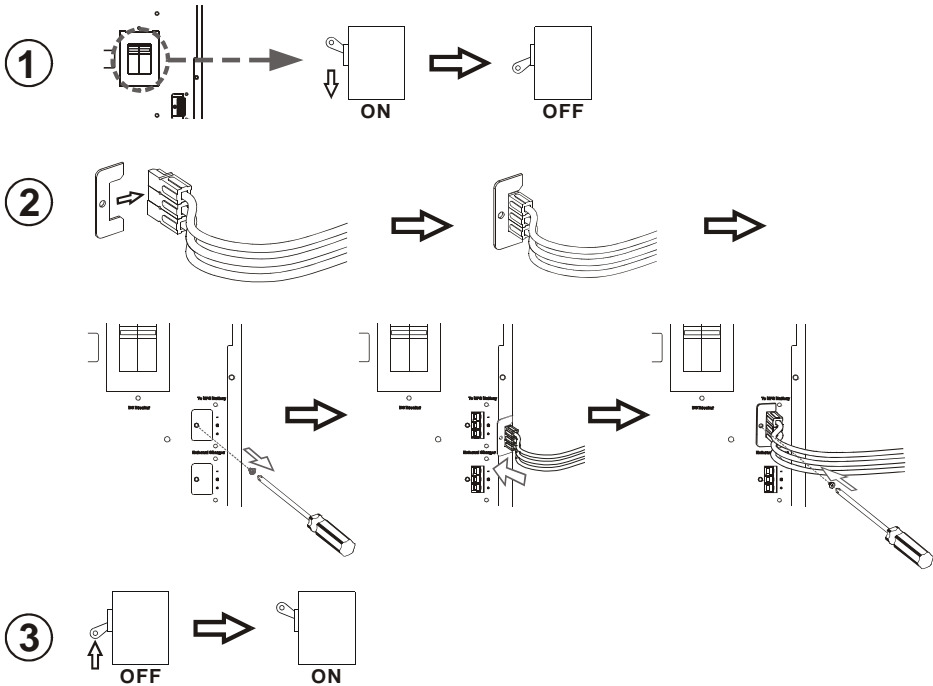

6k/10k tower

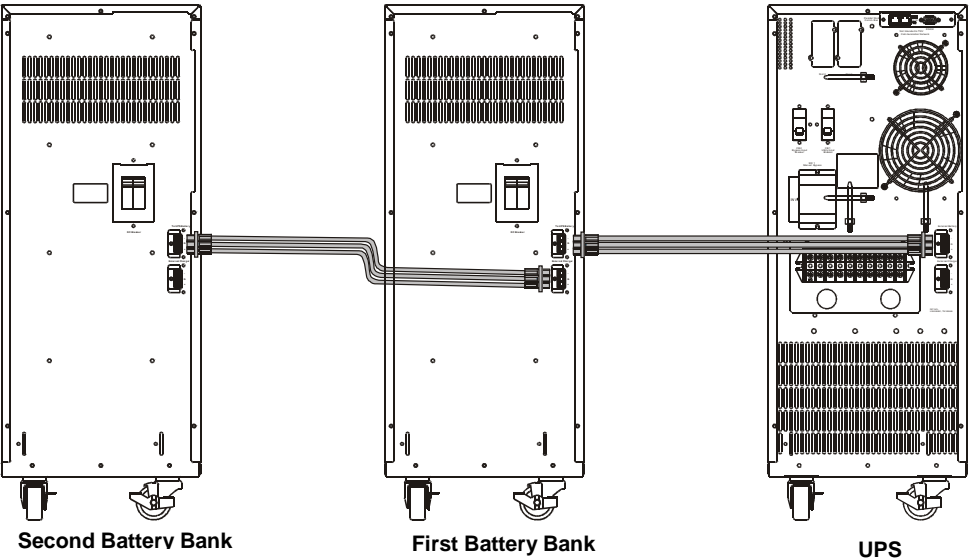

6k/10k RT

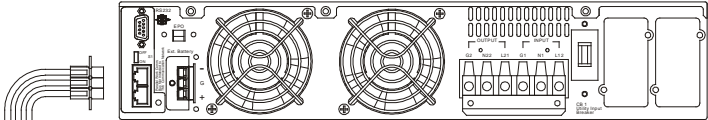

UPS

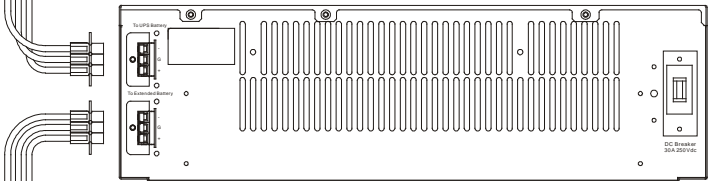

First Battery Bank

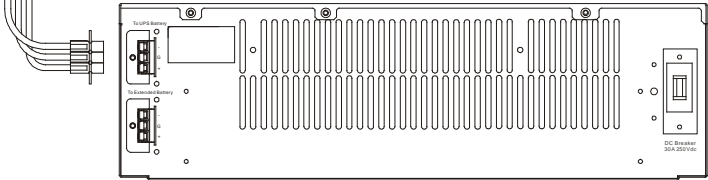

Second Battery Bank

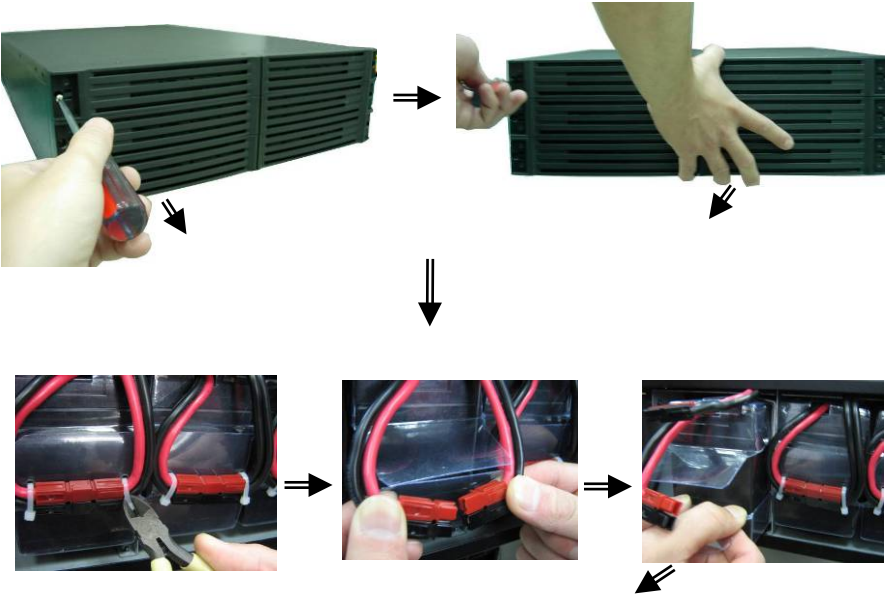

3.5. Storage Instruction

For extended storage through moderate climate(-15 to +30 °C / +5 to +86 °F), the batteries should be charged for 12 hours every 6 months by plugging the UPS power cord into the wall receptacle. Repeat this every 3 months under high temperature (+30 to +45 °C / +86 to +113 °F) environment.

Chapter 4. Specification

	BBP-AR-6000RM-PSW-ONL-EBP	BBP-AR-10000RM-PSW-ONL-EBP	BBP-AR-6000-PSW-ONL-EBPWC	BBP-AR-10000-PSW-ONL-EBPWC
Dimensions W x D x H, mm				
Unit	440 x 680 x 132		290 x 631 x 748	
Shipping	560 x 804 x 272		468 x 810 x 961	
Weight, kg				
Unit	54.2	65.2	166	196
Shipping	57.2	68.2	182	214



192321752069000