



***EZ FINISH***  
**OUTDOOR SYSTEMS**

# CATALOG

716.725.0236 | [info@EZFinishSystems.com](mailto:info@EZFinishSystems.com)  
[www.EZFinishSystems.com](http://www.EZFinishSystems.com)

# EZ Finish Outdoor Systems

EZ Finish Outdoor Systems are designed as ready-to-finish structures. Outdoor kitchens, fireplaces and fire pits are now even easier to install. They are simply veneer and can be operational in less time and with less labor than competitive products. Our revolutionary bolt-together system allows you to offer customers custom designs and assemble on site in just hours—not days or weeks.

In-stock cabinets allow quick turn around, from order to job site.

We also offer a full line of custom-made seating walls, pillars and water features. These are all custom built to your specifications to meet your customers exact layout design.



- ✓ Ready-to-Assemble Structures
- ✓ Custom-Built Structures
- ✓ Design Services
- ✓ Consulting
- ✓ Technical Support



# About Our Structures

All of our structures are welded 6061-T6 aircraft grade aluminum bar stock. This keeps your structures light weight without losing any structural strength, allowing you to install your structures on multiple surfaces including decks, patios and pavers blocks to name just a few.

Noncombustible material is used for all of our structures, eliminating the need for insulated jackets or liners. 6061 aluminum will not rust and needs no special coating to maintain corrosion resistance. All of our structures are finished with 1/4" Hardie backer board. Additional material available upon request.

## Benefits of Aluminum vs. Steel, Galvanized and Wood Structures:

	Aluminum	Steel	Galvanized Studs	Wood
Light Weight	yes	no	yes	no
Rust	no	yes	yes	no
Rotting	no	no	no	yes
Combustible	no	no	no	yes
Welded Frame	yes	yes	no	no
Yield Strength	40k	36k	n/a	n/a
Flex and Deflection	minimal	moderate	high	high

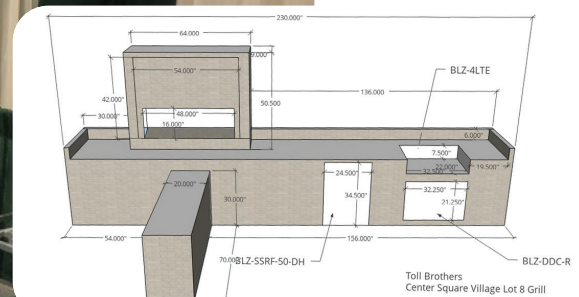
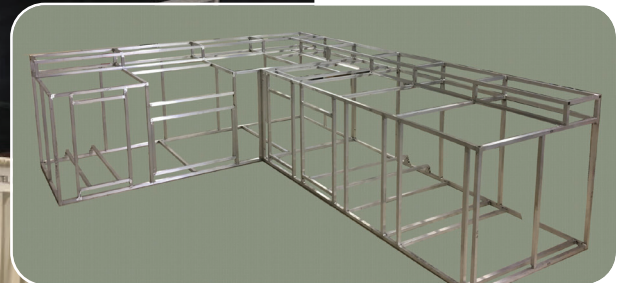

# Assembly Instructions

- 1) Set up cabinets in desired location
- 2) Align bolt holes and loosely secure washers and nuts in all locations (hardware included)
- 3) Tighten bolts starting at top while aligning cabinets. Tighten bolts from top to bottom on all cabinets.
- 4) Level entire structure after assembly and before veneer installation. (we recommend a slight pitch for water run off)
- 5) Test fit all components prior to veneer and counter top installation
- 6) Fiber tape all seams and corners. (2 layers) one on structure and one embedded in scratch coat.
- 7) Please consult with veneer manufacture for any specific installation instructions.
- 8) Verify counter top thickness prior to veneer installation
- 9) Technical support available for any questions or concerns
- 10) Level Legs and level bolts are for leveling unit prior finish ONLY! Unit must be shimmed accordingly before finish veneer installation.
- 11) Verify all components fit unit before veneer installation. We must be notified before veneer installation if any discrepancy's exists.

---

## CABINET SHEATHING OPTIONS

All of our stock ready to assemble cabinets come standard with 1/4" Hardie Backer board glued and fastened to cabinet frame. Additional options are available.

- Frame Only—No sheathing
- Frame with 1/4" Hardie Backer Board
- Frame with 1/4" Cement Board
- Frame with 1/2 Cement Board

Please Consult with your Veneer manufacturer when deciding what type of sheathing is best for you project.



# **CUSTOM-BUILT OUTDOOR STRUCTURES**

***EZ FINISH***  
**OUTDOOR SYSTEMS**

716.725.0236 | [info@EZFinishSystems.com](mailto:info@EZFinishSystems.com) | [www.EZFinishSystems.com](http://www.EZFinishSystems.com)

# CUSTOM ISLANDS

Our made-to-order structure division is designed to build your custom outdoor structure down to the inch for your dream outdoor living area.

Whether you are designing around a specific area, or have a specific layout for your outdoor living needs, our custom-build department is here to assist you every step of the way.

Simply supply us with a sketch of you dream outdoor living area and we will begin the design process.

From fitting precisely into you outdoor living area, to exact component placement, we are happy to build your exact outdoor living space.

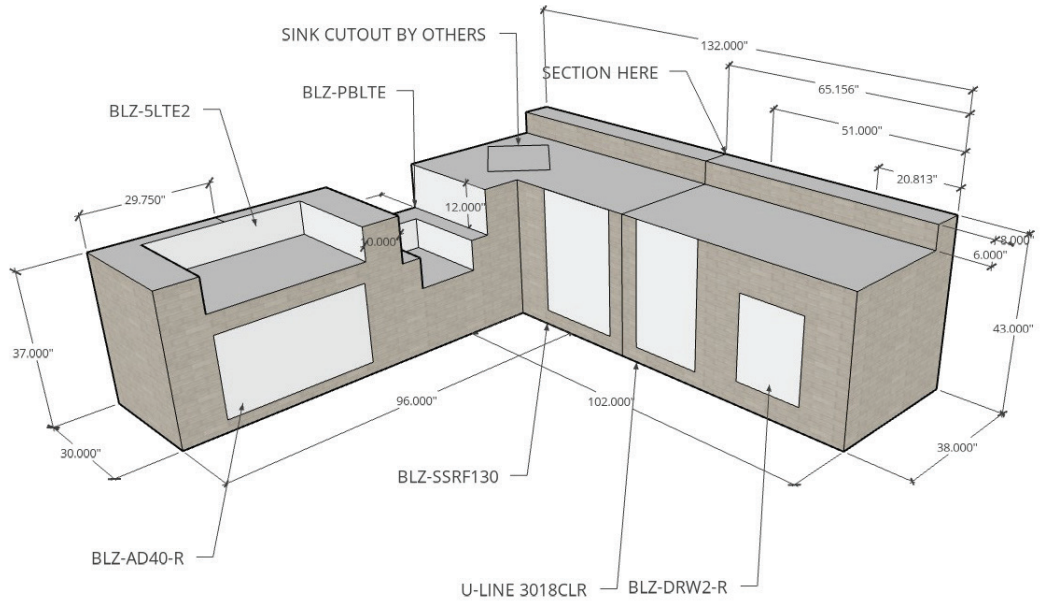



# Island Systems

## Custom Made Outdoor Kitchens



### 4 Easy Steps

**Step One)** Send us a sketch of your dream outdoor structure.

**Step Two)** We make a complete computer rendering of your order, including dimensions.

**Step Three)** With your seal of approval, we construct your order.

**Step Four)** After construction, we ship your completed frames to you!

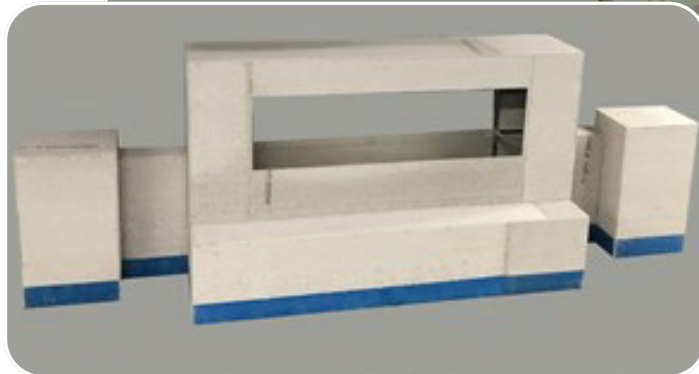
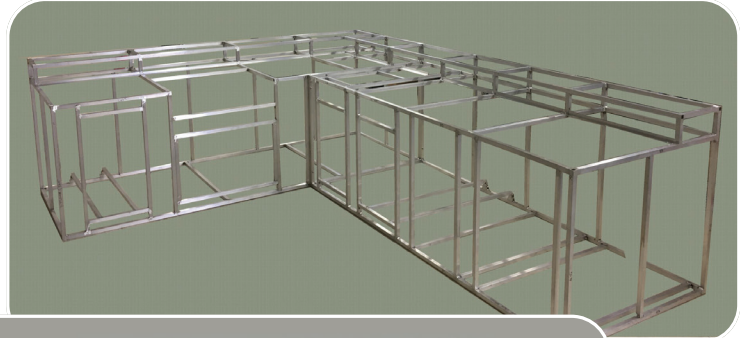

#### Straight Cabinets

ITEM#	DESCRIPTION	DIMENSIONS
EZF-SC	Straight Cabinet with 1/4" Hardie Backer Board	30"Dx 36"H
EZF-SC-FO	Straight Cabinet, Frame Only	
EZF-SCWBS	Straight Cabinet with Backsplash	34"Dx 42"H
EZFSCWBS-FO	Straight Cabinet with Backsplash, Frame Only	(to top of backsplash)
EZF-SCWB	Straight Cabinet with Bar	34"Dx 42"H
EZF-SCWB-FO	Straight Cabinet with Bar, Frame Only	(Bar Top 12" D)
EZF-SCWBFR	Straight Cabinet with Bar and Footrest	37"Dx 42"H
EZF-SCWBFR-FO	Straight Cabinet with Bar and Footrest, Frame Only	(Bar Top 12" D)

#### Accessories

ITEM#	DESCRIPTION	
EZF-EB	Electrical BOX, Outdoor Rated (Factory Installed) (Includes 14/2 outdoor rated wire)	
ISL-LEVEL	Extra Strength Leveling Legs (Qty 2)	

#### Specifications

- Constructed with 6061 welded aluminum frame (.125 thick) for stability and longevity
- 6" Water Proof membrane on bottom
- Wrapped in Hardy Board — additional substraight available upon request; pricing may differ
- Optional leveling legs and welded electrical boxes
- 10 Year Warranty
- Please allow 3— 4 weeks for delivery
- 50% deposit required and remaining amount due before shipment

Curved Cabinets,  
Outdoor Fireplaces,  
and Firepits -  
Call for Pricing

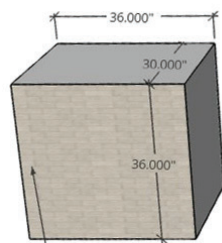

Straight Cabinet

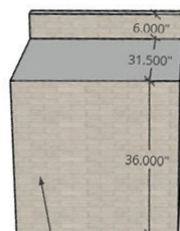

Straight Cabinet with Backspalsh

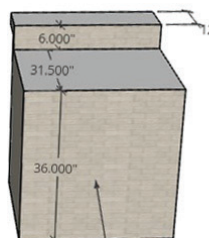

Straight Cabinet With Raised Bar Top

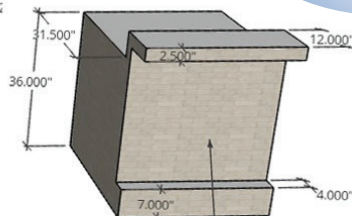

Straight Cabinet With Raised Bar Top and Foot Rest





# **STANDARD DESIGN OUTDOOR STRUCTURES**

***EZ FINISH***  
**OUTDOOR SYSTEMS**

716.725.0236 | [info@EZFinishSystems.com](mailto:info@EZFinishSystems.com) | [www.EZFinishSystems.com](http://www.EZFinishSystems.com)

# STANDARD DESIGN STRUCTURES

## Why wait to enjoy your backyard?

Our Standard Design Structures are premade to take the guess work out of your design process.

Choose from any of our premade outdoor kitchens, fireplaces and firepits to complete your outdoor living area.

All of our structures are designed to fit popular outdoor living components, simplifying your outdoor design process, while giving you some of our most popular and practical designs with a fast turn around time.

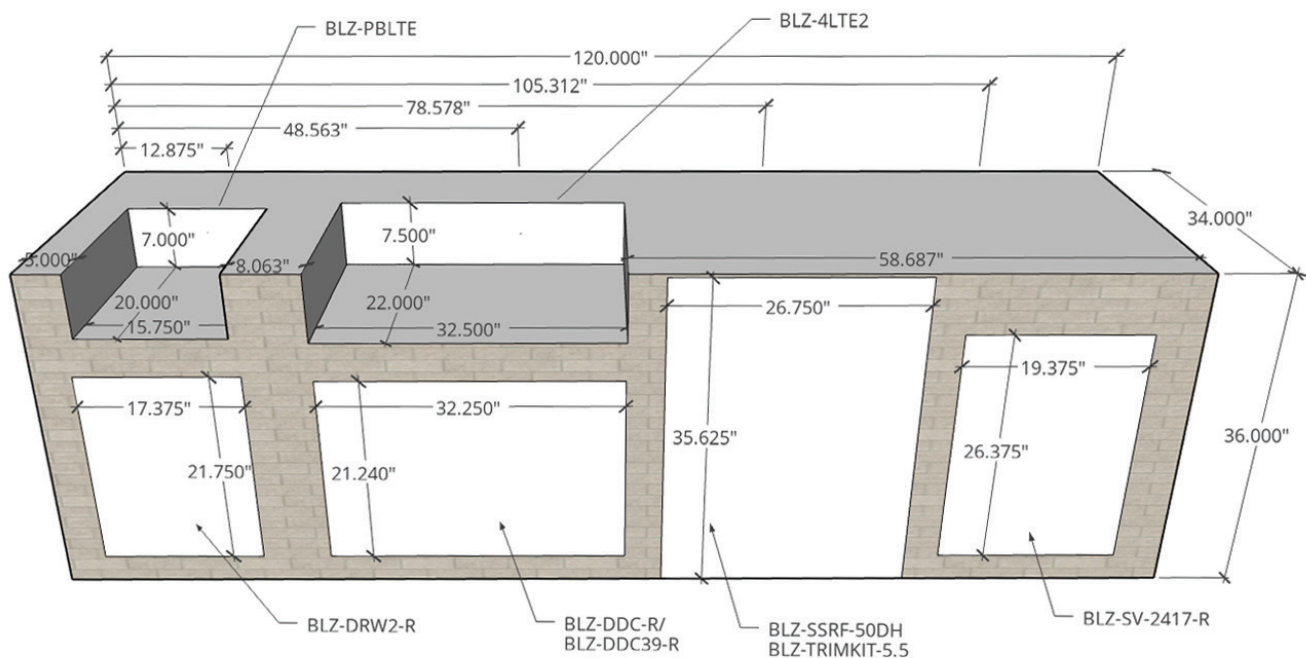

# 6-FOOT READY-TO-FINISH ISLAND

Shown with  
Blaze brand  
components.  
Can be  
manufactured  
for any grill  
line.

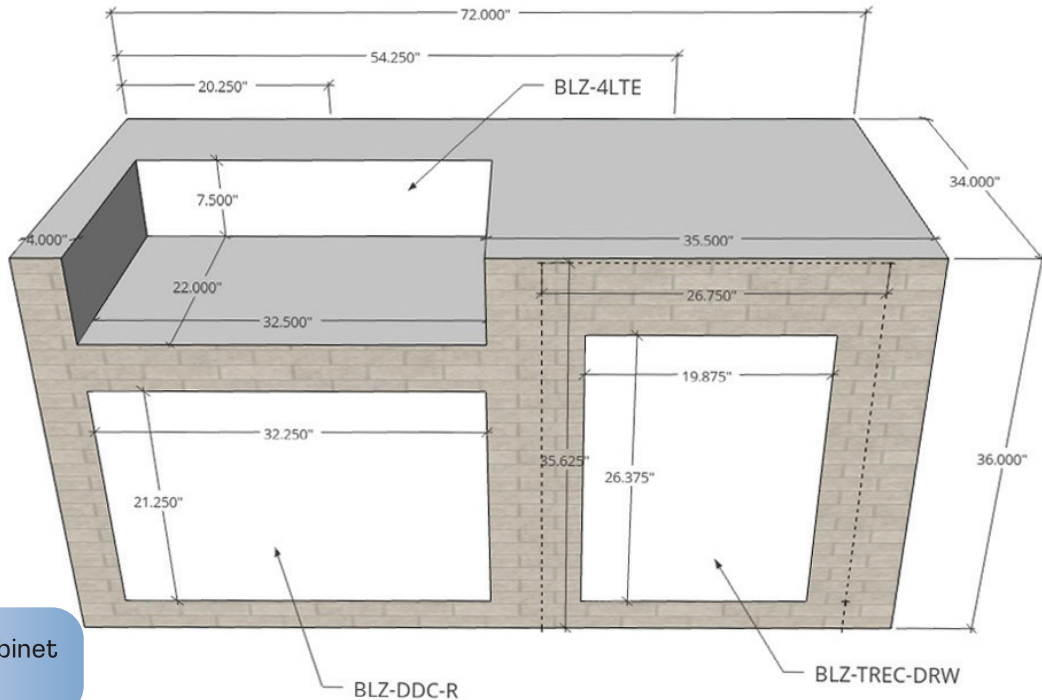

72" Standard Cabinet  
(SCD72)



**Optional Outdoor Rated Fridge**  
Cut Out. Remove Trash framing to Insert  
(BLZ-SSRF-5.5DH) with Trim Kit (BLZ-TRIMKIT-5.5)



716-725-0236  
www.EZFinishSystems.com

# 8-FOOT READY-TO-FINISH ISLAND

Shown with Blaze brand components. Can be manufactured for any grill line.

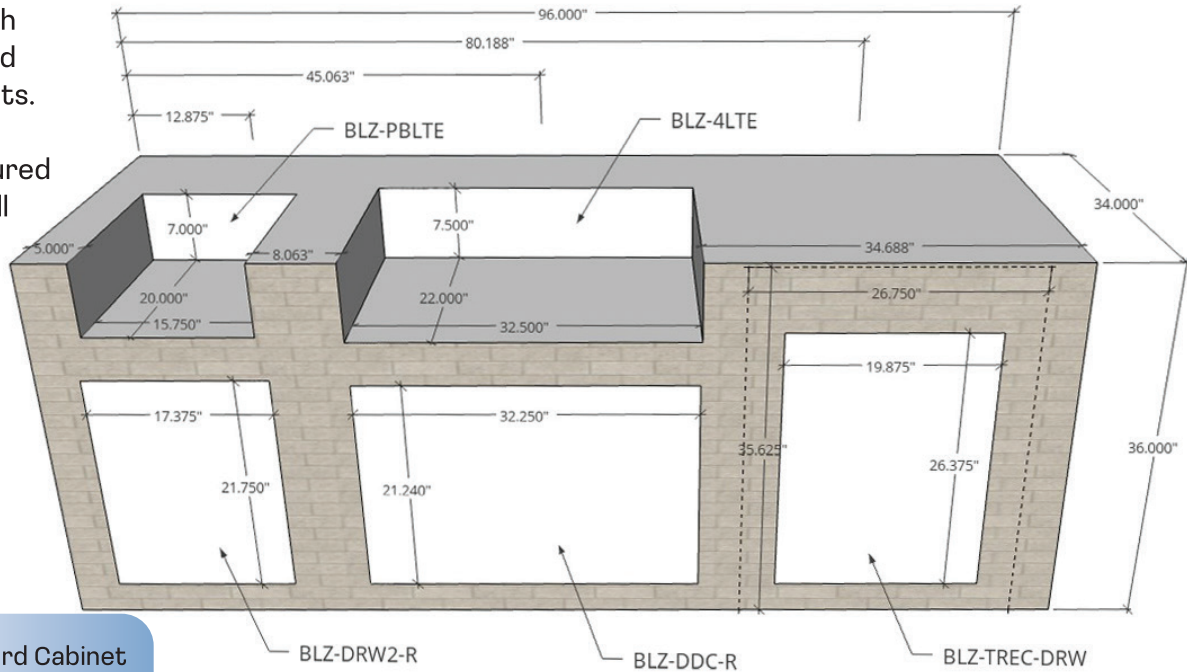

96" Standard Cabinet (SCD96SB)



**Optional Outdoor Rated Fridge**  
Cut Out. Remove Trash framing to Insert (BLZ-SSRF-5.5DH) with Trim Kit (BLZ-TRIMKIT-5.5)



716-725-0236  
www.EZFinishSystems.com

# 8-FOOT READY-TO-FINISH ISLAND

Shown with Blaze brand components. Can be manufactured for any grill line.

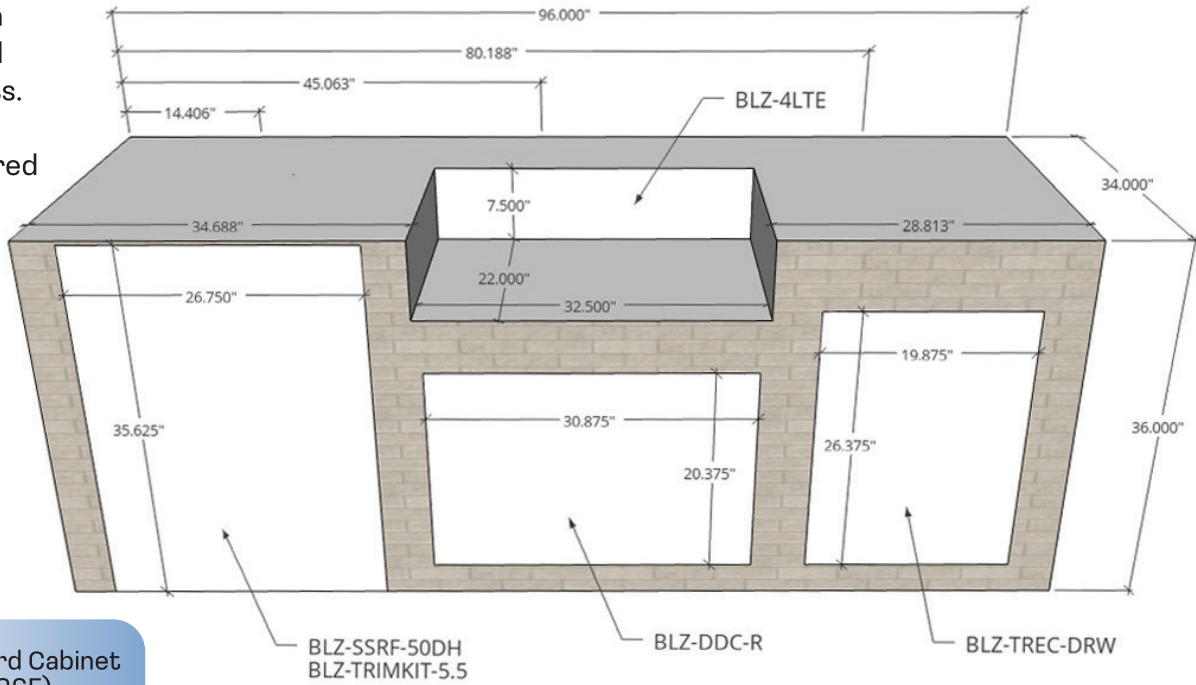

96" Standard Cabinet (SCD96F)



716-725-0236  
www.EZFinishSystems.com

# 10-FOOT READY-TO-FINISH ISLAND

Shown with Blaze brand components. Can be manufactured for any grill line.

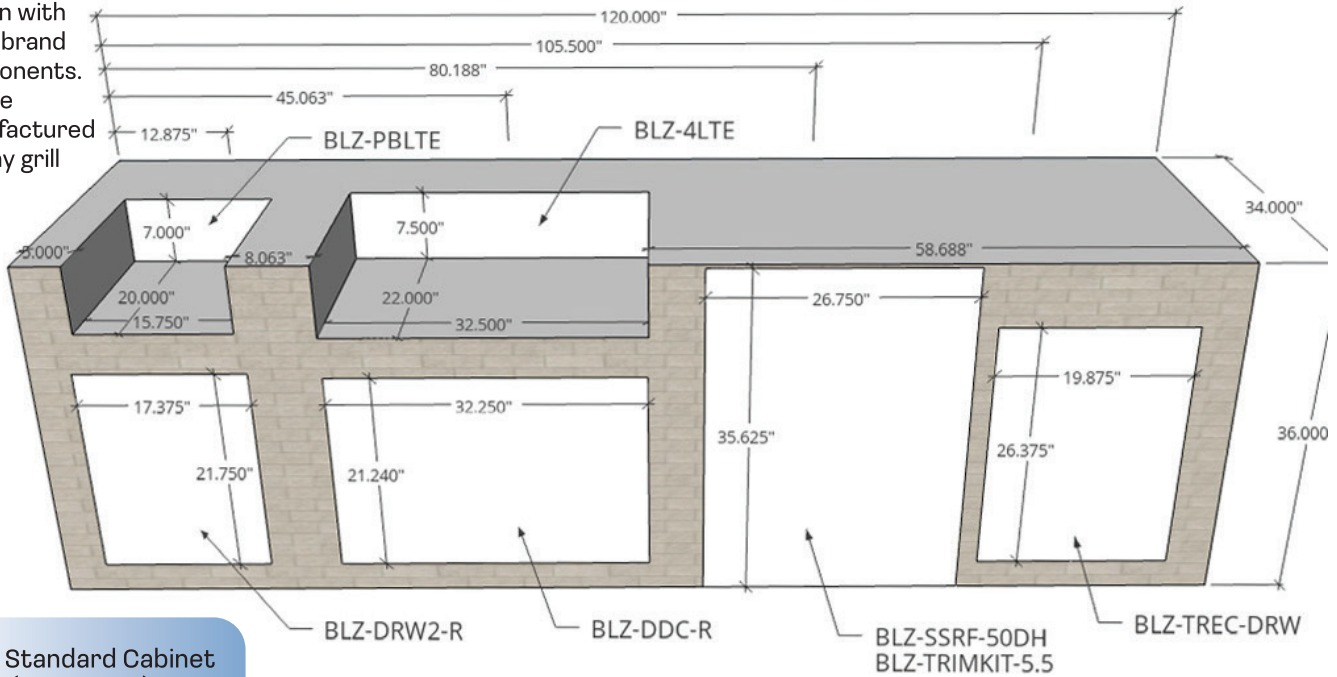

120" Standard Cabinet (SCD120SB)



[14]



716-725-0236  
www.EZFinishSystems.com



# READY-TO-FINISH ACCESSORIES

## Bolt on Backsplash and Raised Bar Options

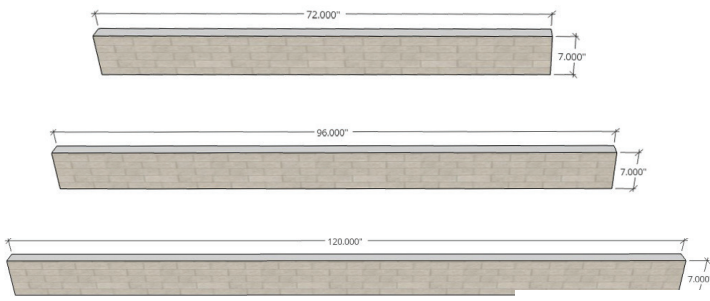

72" Bolt on Backsplash  
96" Bolt on Backsplash  
120" Bolt On Backsplash

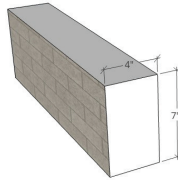

72" Bolt on Raised Bar  
96" Bolt on Raised Bar  
120" Bolt On Raised Bar

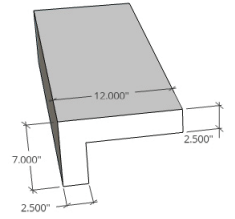

## Powder Coated Foot Railings

Add a bar foot railing to your setup with this durable metal tubing. This Matte Black-finished 304 stainless steel pipe is available in a variety of tube sizes from 2-feet through 8-feet to fit the size of your bar. The contemporary, easy-to-maintain Matte Black finish of this bar rail tubing makes for an attractive look with either indoor or outdoor bar foot rails. (Additional finishes available)

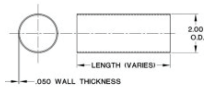

Call for prices.



## Installed Electrical Boxes

I Gang Aluminum Weather Proof  
Electrical boxes welded in place  
(No Wiring)



716-725-0236  
[www.EZFinishSystems.com](http://www.EZFinishSystems.com)



# READY-TO-FINISH BAR ISLAND

84" Bar Cabinet  
(BARD84)

Bolt on or Stand  
Alone System  
Available

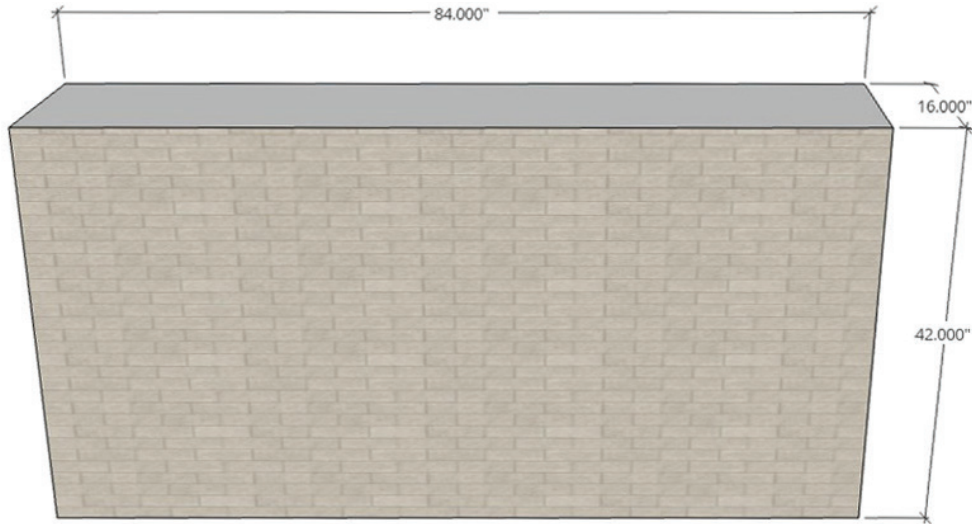

114" Bar Cabinet  
(BARD114)

Bolt on

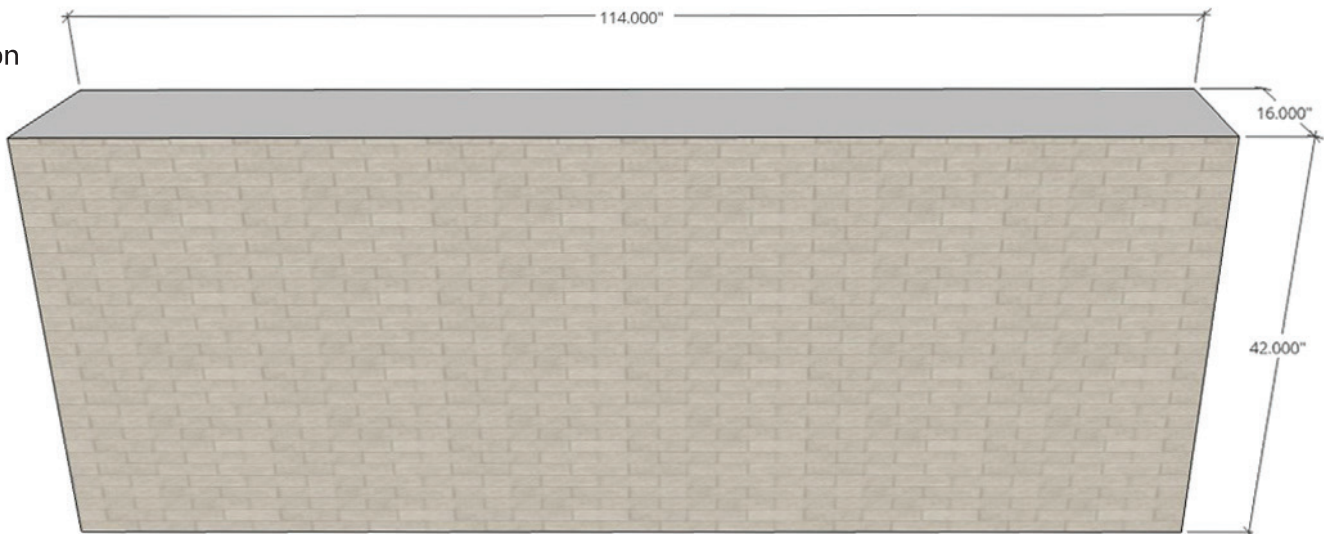

Optional Bolt  
on Bar Island  
Foot Rest

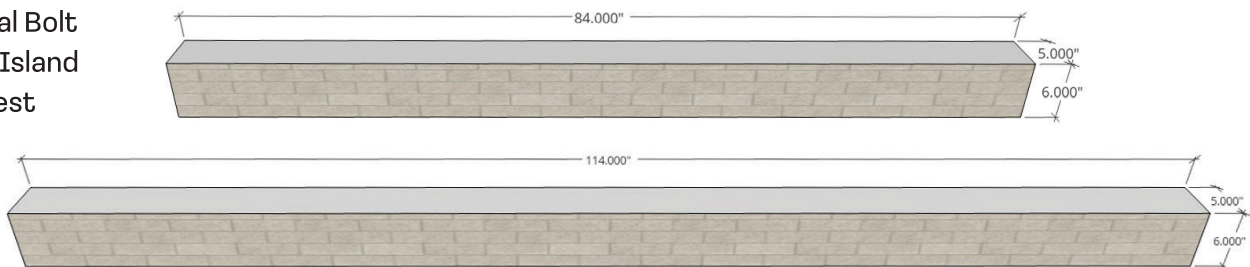

716-725-0236  
[www.EZFinishSystems.com](http://www.EZFinishSystems.com)

# READY-TO-FINISH BUFFET ISLAND

Shown with Blaze brand components. Can be manufactured for any grill line.

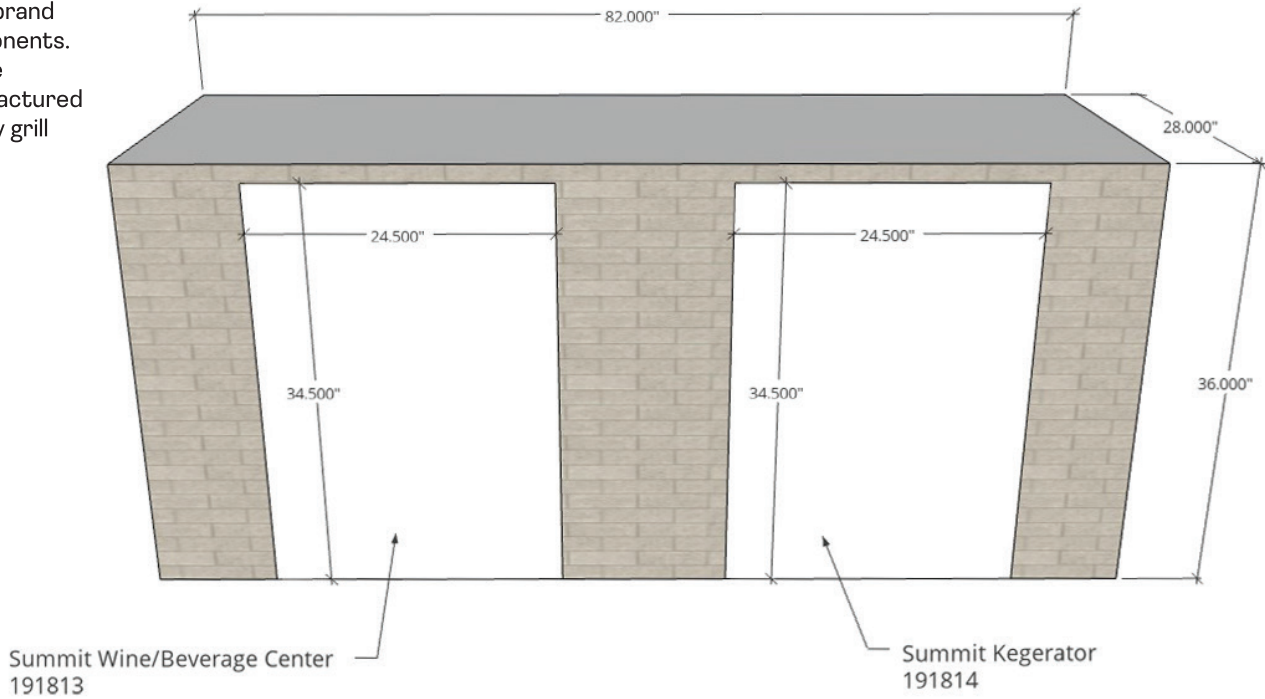

**82" Buffet Island (BID82)**  
Bolt on or Stand Alone System Available

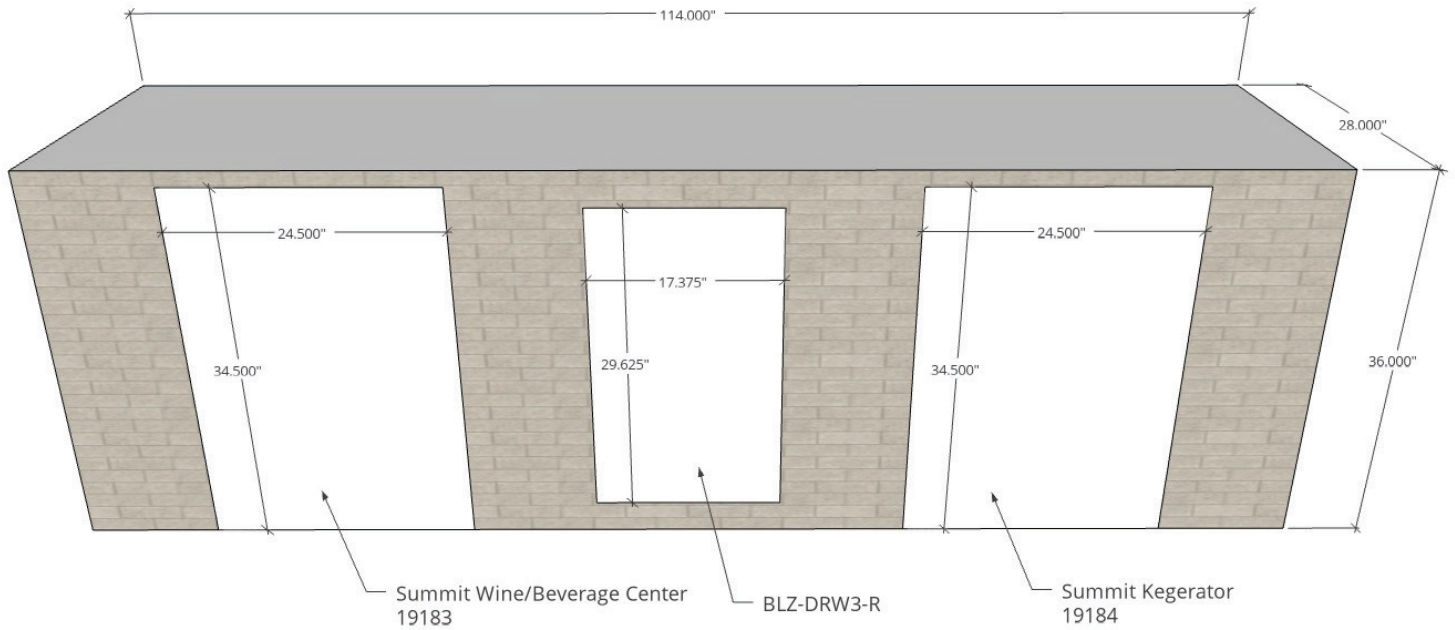

**114" Buffet Island (BID114)**  
Bolt on or Stand Alone System Available

Shown with Blaze brand components. Can be manufactured for any grill line.



716-725-0236  
www.EZFinishSystems.com

# CORNER CABINETS

## BAR ISLAND CORNER CABINETS

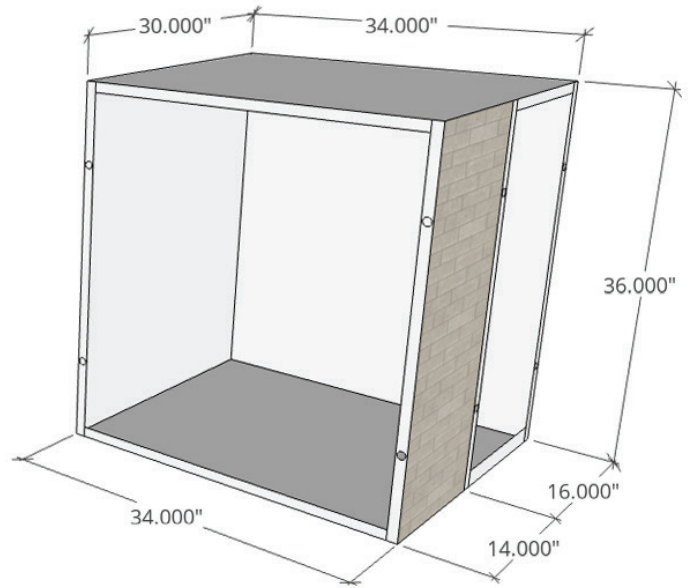
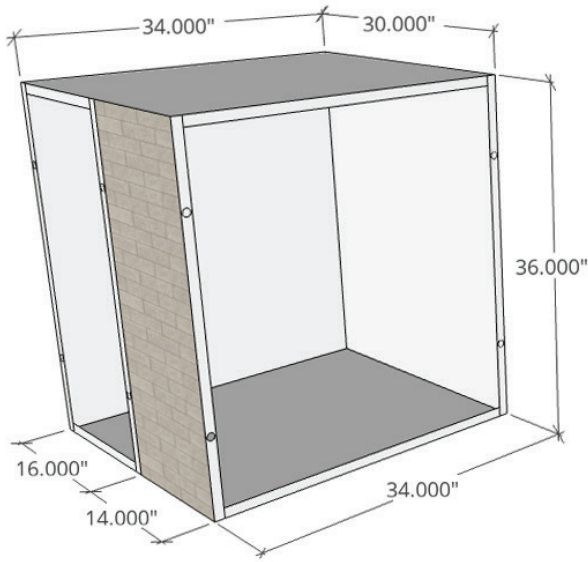

## BUFFET ISLAND CORNER CABINETS

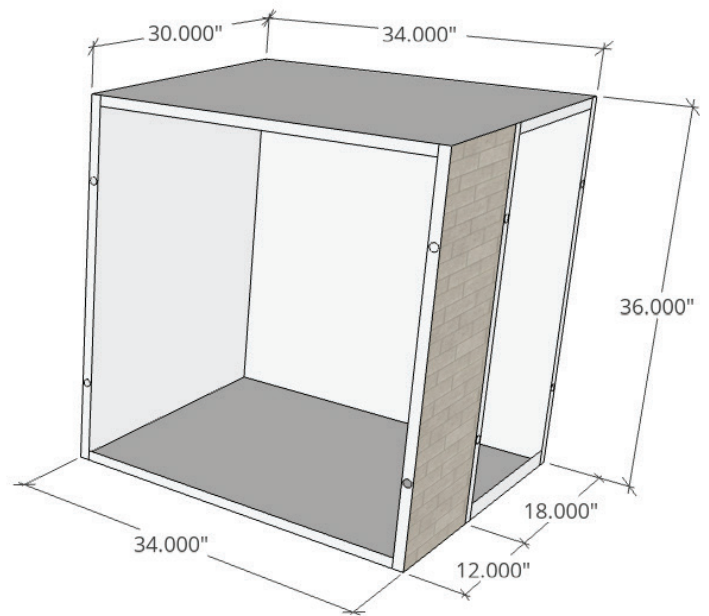
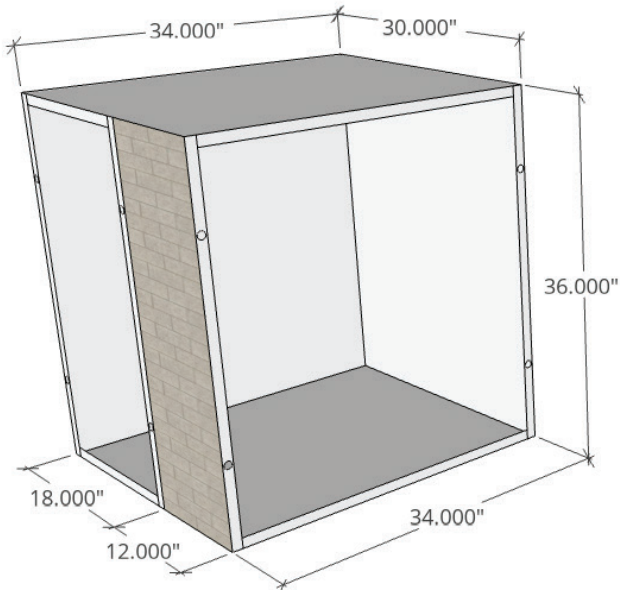

716-725-0236  
[www.EZFinishSystems.com](http://www.EZFinishSystems.com)

# READY-TO-FINISH FIREPLACES & TV WALL

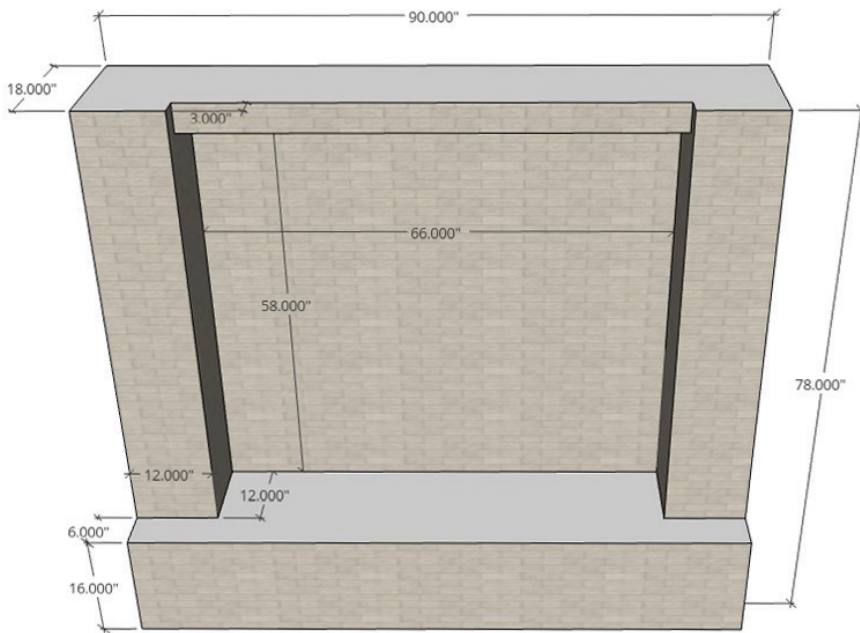

## Outdoor TV Wall (OTV90)

Blaze Double Access Door BLZ-AD25  
16" high centered on back of unit

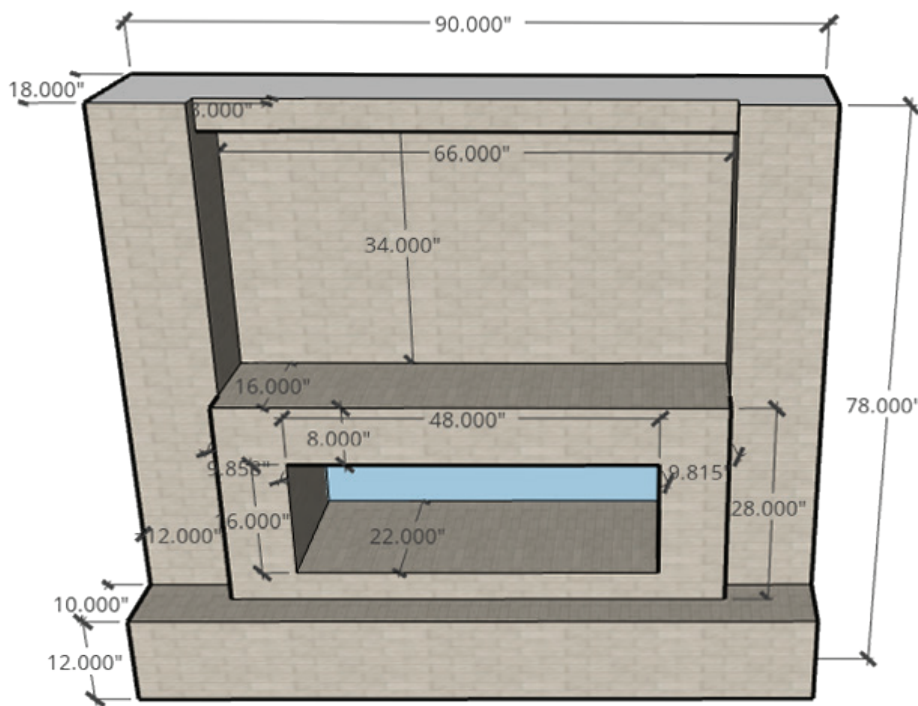

## Fireplace with TV Mount (OTV90)

Blaze Double Access Door BLZ-AD25  
16" high centered on back of unit



**EZ FINISH**  
OUTDOOR SYSTEMS

716-725-0236  
www.EZFinishSystems.com

# READY-TO-FINISH FIREPLACES

## 72" Bolt-on-Hearth Option

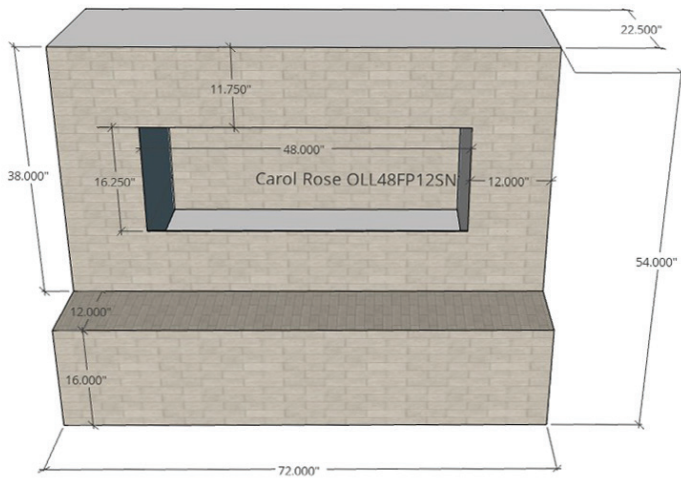

Optional Hearth  
**One Sided** (OFP721S)  
12" X 16" X 72"

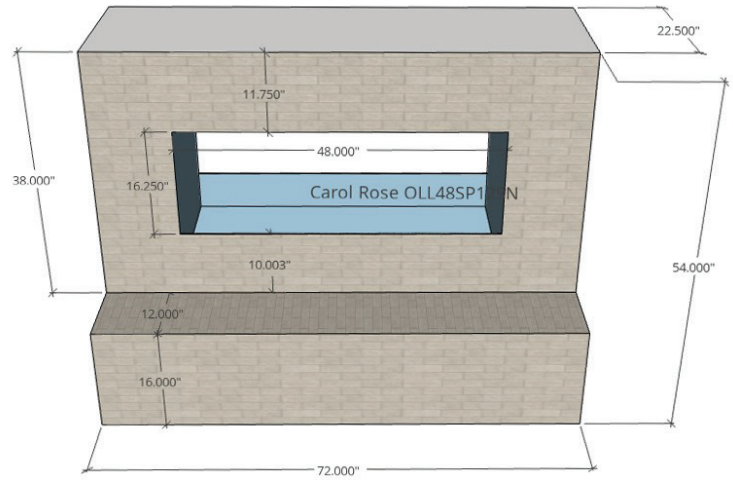

Optional Hearth  
**Two Sided** (OFP722S)  
12" X 16" X 72"



## 84" Bolt-on-Hearth Option

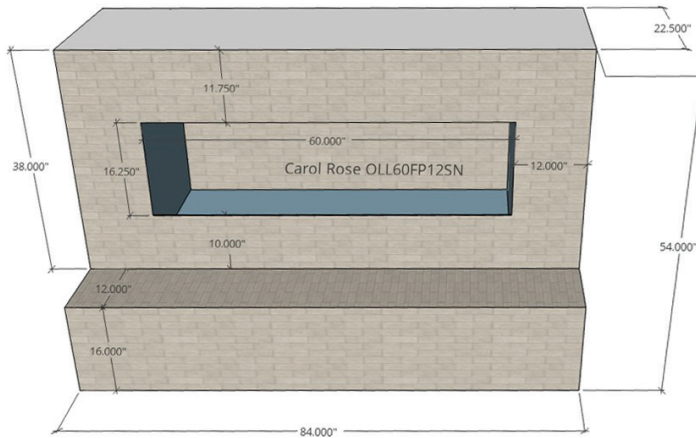

Optional Hearth  
**One Sided** (OFP841S)  
12" X 16" X 84"

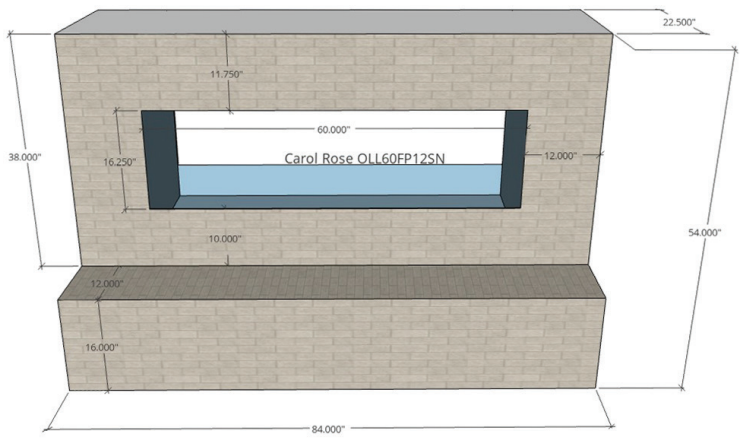

Optional Hearth  
**Two Sided** (OFP842S)  
12" X 16" X 84"



\* All fireplaces can be made to fit all manufacture units.



716-725-0236  
www.EZFinishSystems.com

# READY-TO-FINISH FIREPLACES & TV WALL

\* All fireplaces can be made to fit all manufacture units.

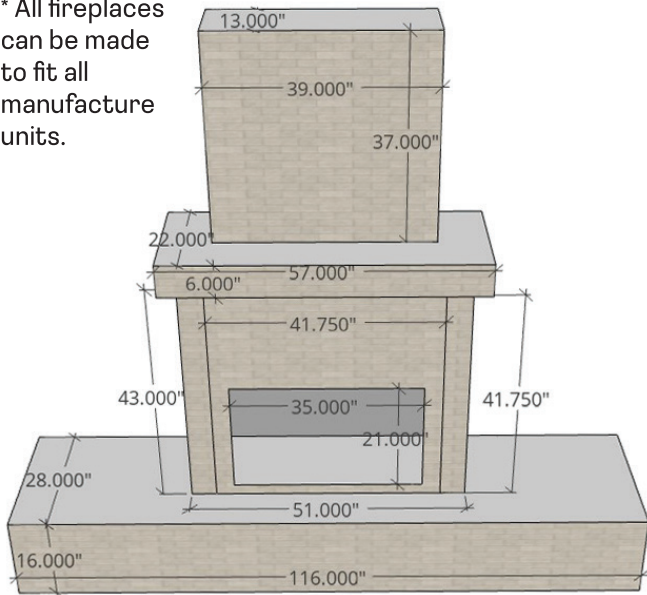

Superior Outdoor  
Vent-Free Gas Fireplace  
Insert  
(Model VRE3036ZMN)

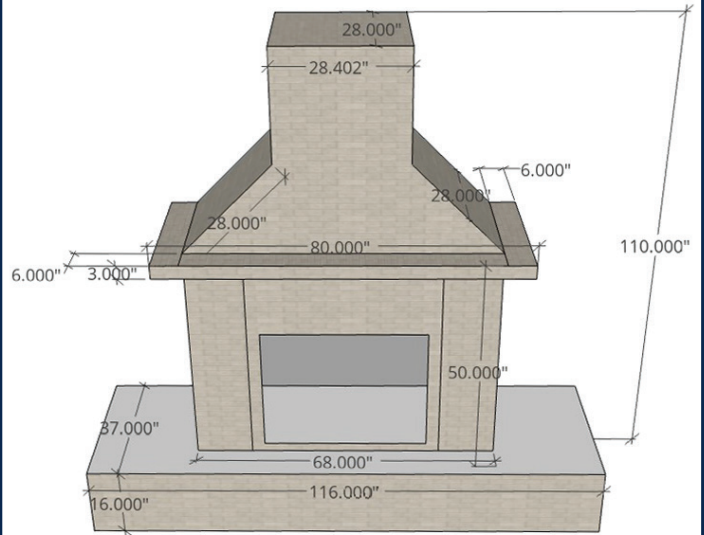

Superior Outdoor  
Vent-Free Gas Fireplace  
Insert  
(Model VRE3036ZMN)

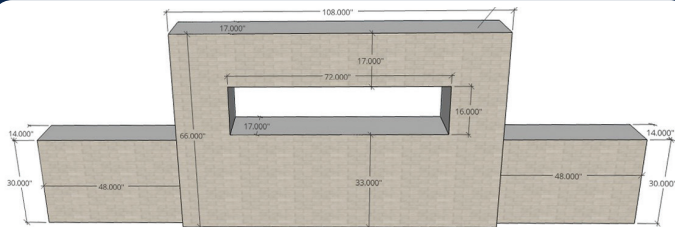

Superior Vent-Free Single  
Sided/See Through Fireplace  
Model VRE4672ZEN  
Optional Bolt On Hearth  
Extensions

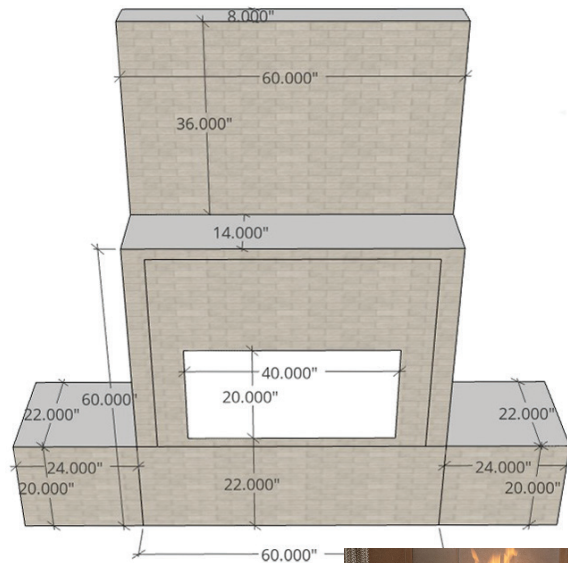

Superior Outdoor  
Vent-Free Outdoor Fireplace  
(Model OFP108ST)



716-725-0236  
www.EZFinishSystems.com

# READY-TO-FINISH ROUND FIREPITS

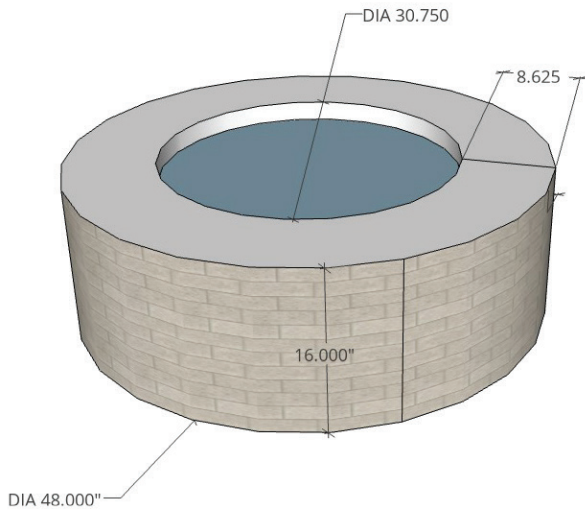

## 48" ROUND FIREPIT

- 30" Drop in Pan (ALPAN30C)
- Crossfire Burner, 120,000BTU (CFB120)
- Match Light Key Valve FPKV Vent (2) (FVKV12)

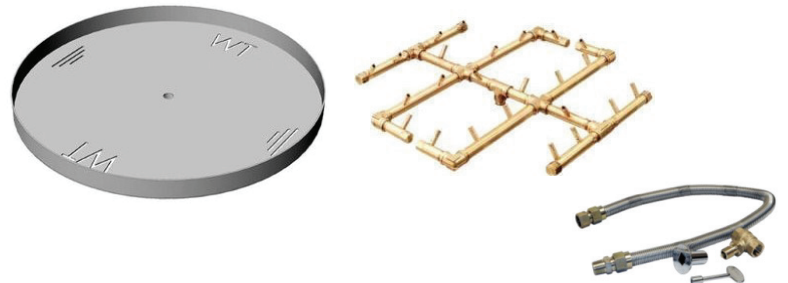
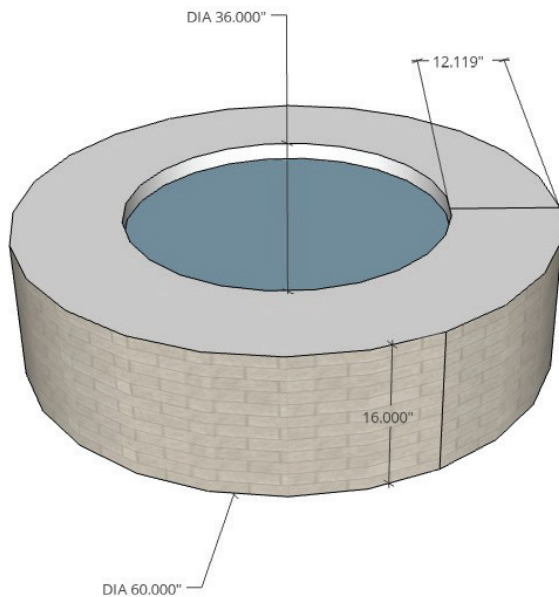

## 60" ROUND FIREPIT

- 36" Drop in Pan (ALPAN36C)
- Crossfire Burner, 290,000BTU (CFB290)
- Match Light Key Valve FPKV Vent (2) (DFLKV34-U)

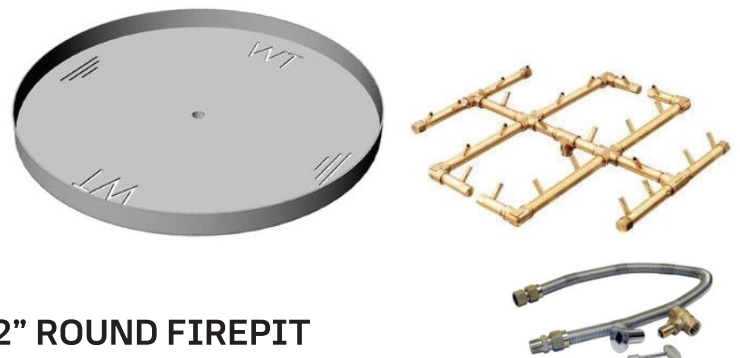
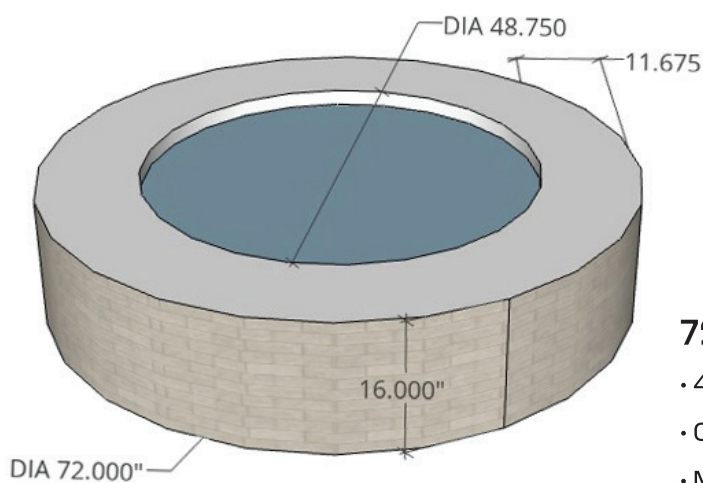

## 72" ROUND FIREPIT

- 48" Drop in Pan (ALPAN48C)
- Crossfire Burner, 350,000BTU (CFB350)
- Match Light Key Valve FPKV Vent (2) (DFLKV34-U)

# READY-TO-FINISH RECTANGLE FIREPITS

## 48" RECTANGLE FIREPIT

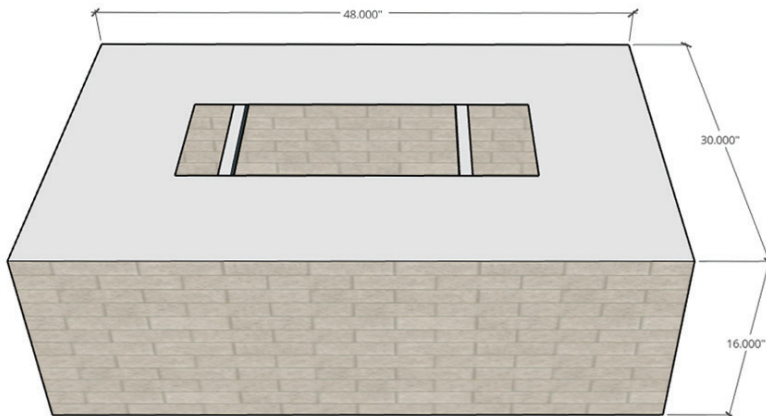

- 28"X10" Drop in Pan (ALPAN4818)
- Crossfire Burner Tre Style, 170,000BTU (CFBT170)
- FPVK Vent (2)
- FK1 Match Light Key Valve Kit

## 60" RECTANGLE FIREPIT

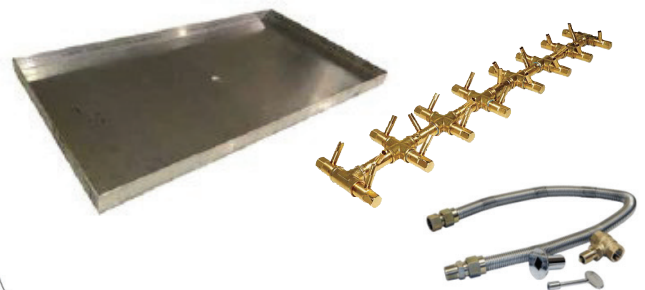
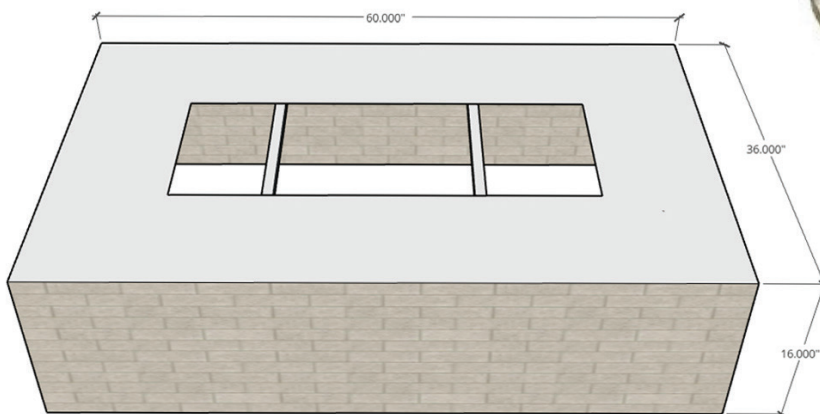

- 38"X14" Drop in Pan (ALPAN4824)
- Crossfire Burner Tre Style, 230,000BTU (CFBT230)
- FPVK Vent (2)
- FK1 Match Light Key Valve Kit

## 72" RECTANGLE FIREPIT

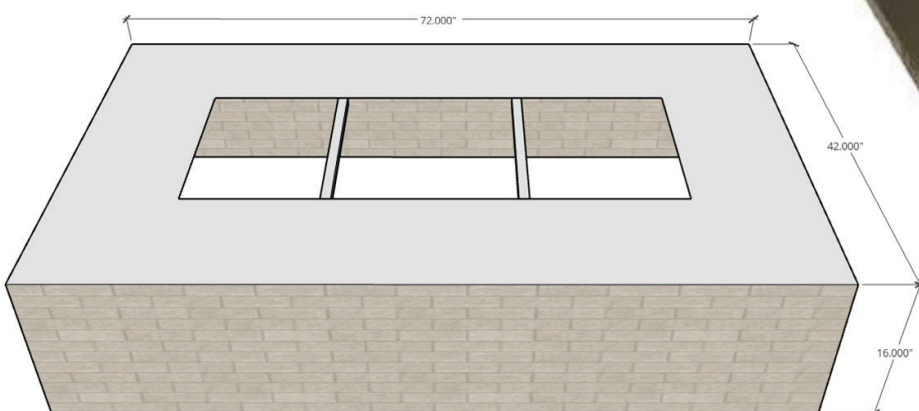

- 48"X18" Drop in Pan (ALPAN6018)
- Crossfire Burner Tre Style, 290,000BTU (CFBT290)
- FPVK Vent (2)
- FK1 Match Light Key Valve Kit



# READY-TO-FINISH SQUARE FIREPITS

## 36" SQUARE FIREPIT

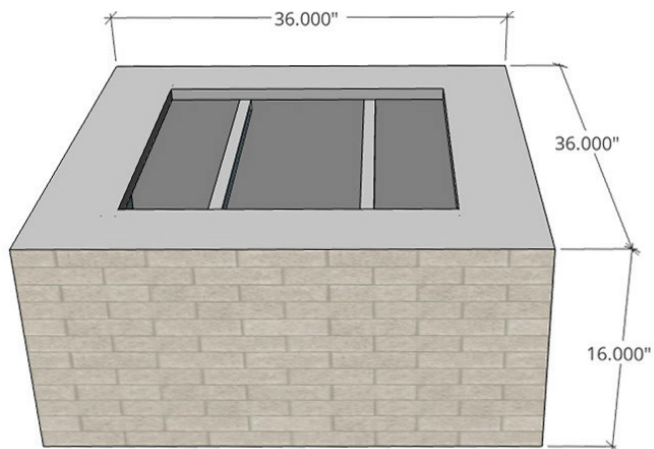

- 24"X24" Drop in Pan (ALPAN24S)
- Crossfire Burner, 120,000BTU (CFB120)
- FPVK Vent (2)
- FK1 Match Light Key Valve Kit

## 48" SQUARE FIREPIT

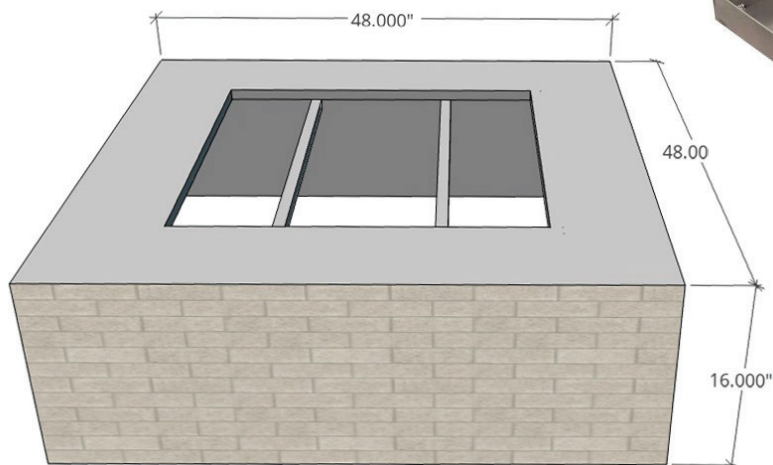

- 30"X30" Drop in Pan (ALPAN30S)
- Crossfire Burner, 180,000BTU (CFB180)
- FPVK Vent (2)
- FK1 Match Light Key Valve Kit

## 54" SQUARE FIREPIT

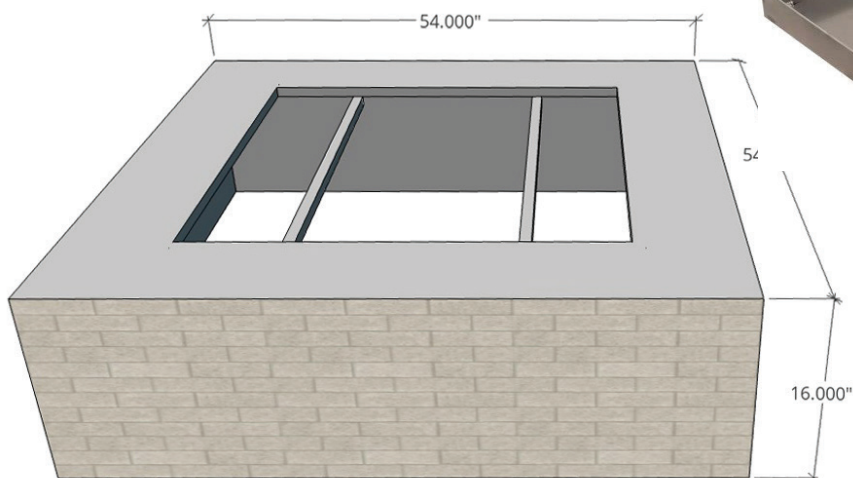

- 36"X36" Drop in Pan (ALPAN36S)
- Crossfire Burner, 290,000BTU (CFB290)
- FPVK Vent (2)
- FK1 Match Light Key Valve Kit



# **READY-TO- ASSEMBLE OUTDOOR STRUCTURES**

***EZ FINISH***  
**OUTDOOR SYSTEMS**

716.725.0236 | [info@EZFinishSystems.com](mailto:info@EZFinishSystems.com) | [www.EZFinishSystems.com](http://www.EZFinishSystems.com)

# READY-TO-ASSEMBLE STRUCTURES

Our Ready-to-Assemble Cabinets are premade and ready to be installed.

Similar to our standard designs, this system allows you to change the design and placement of all your components. With smaller sections, you simply need to arrange your outdoor kitchen any way you desire, and then bolt the sections together.

All cabinets come with pre-drilled bolt holes and hardware to make your custom outdoor living space your own.

All of our structures come premade to fit popular outdoor living components, simplifying your outdoor design process, while giving you the option to change your design on site to meet your specific needs.

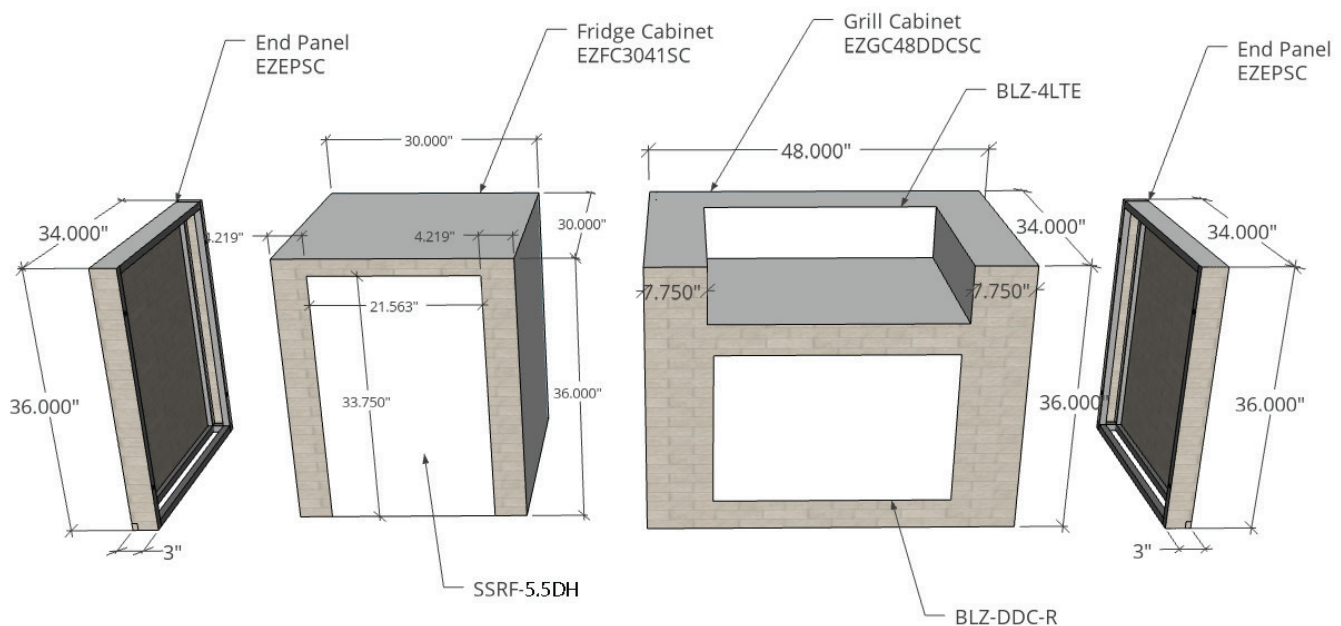

# READY-TO-ASSEMBLE OUTDOOR KITCHEN

## 48" and 60" Grill Cabinets

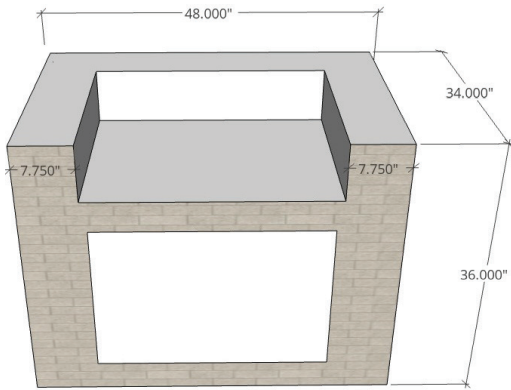

Cabinet, 48" wide - Easy Finish (EZCC48SC)  
Grill—Blaze (BLZ-4LTE-LP/NC)  
Door—Blaze (AD32-R)

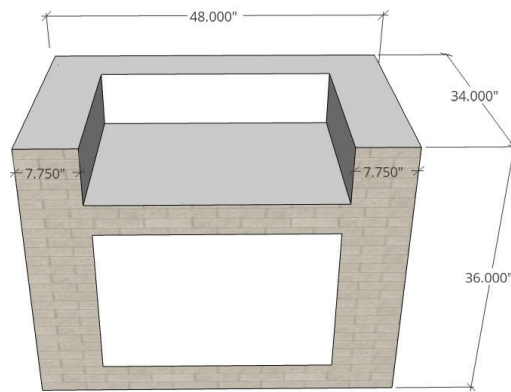

Cabinet, 48" wide - Easy Finish (EZCC48SC)  
Grill—Blaze (BLZ-4LTE-LP/NC)  
Door—Blaze (BLZ-DDC-R)

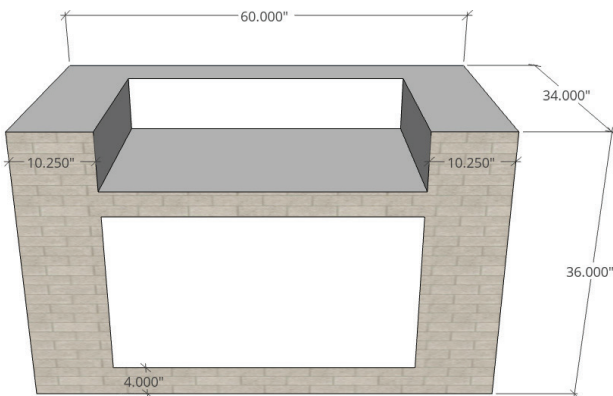

Cabinet, 60" wide - Easy Finish (EZCC60SC)  
Grill—Blaze (BLZ-5LTE-LP/NC)  
Door—Blaze (AD40-R)

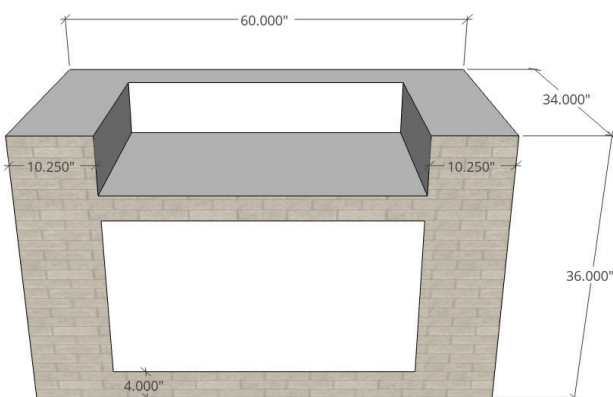

Cabinet, 60" wide - Easy Finish (EZCC60SC)  
Grill—Blaze (BLZ-5LTE-LP/NC)  
Door—Blaze (BLZ-DDC39-R)



# READY-TO-ASSEMBLE OUTDOOR KITCHEN

## Griddle, Burner & Power Burner Cabinets

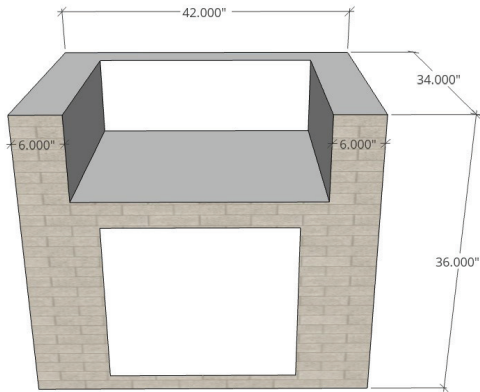

Cabinet, 42" wide - Easy Finish (EZGRC42SC)

Griddle - Blaze BLZ (GRID-LTE-NC/LP)

25" Double Door (BLZ-AD25-R)

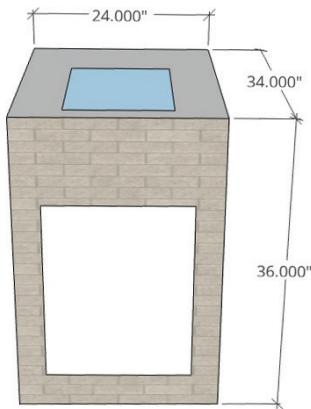

Cabinet, 24" wide - Easy Finish (EZBC241SC)

Single Drop in Burner - Blaze BLZ (SB1-NC/LP)

16" Double Drawer (BLZ-DRW2-R)

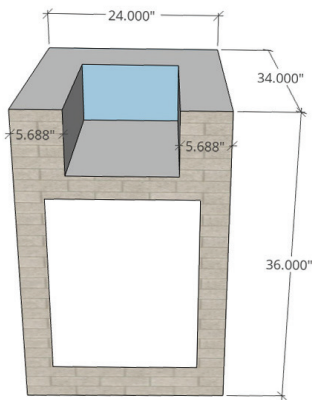

Cabinet, 24" wide - Easy Finish (EZBC242SC)

Side Burner - Blaze BLZ (SB2LTE)

16" Double Drawer (BLZ-DRW2-R)

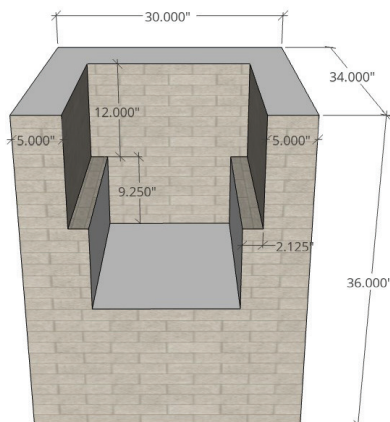

Cabinet, 30" wide - Easy Finish (EZPB30SC)

Professional Built-in Power Burner - Blaze BL (PROPB-NC/LP)

# READY-TO-ASSEMBLE OUTDOOR KITCHEN

## Trash & Recycling and Drawer Cabinets & Beverage Center

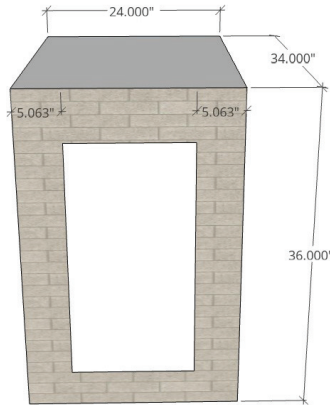

Cabinet, 24" wide - Easy Finish (EZTC24SC)  
Narrow Trash Drawer - Blaze BLZ (TRNW-DRW)

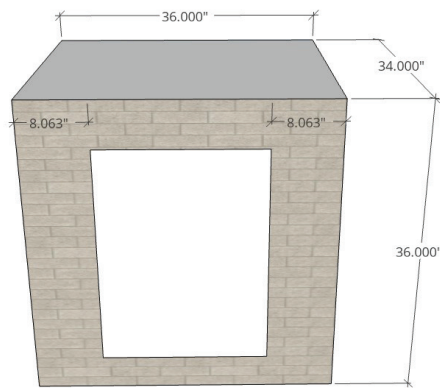

Cabinet, 36" wide - Easy Finish (EZTC36SC)  
Double Trash/Recycle Drawer—Blaze (BLZ-TREC-DRW)

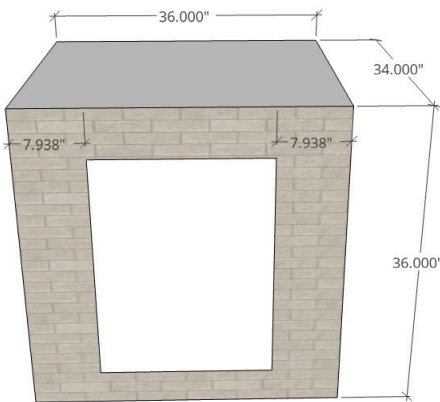

Cabinet, 36" wide - Easy Finish (EZTC362SC)  
Trash/Recycle Drawer - Blaze (BLZ-TRLP-DRW)

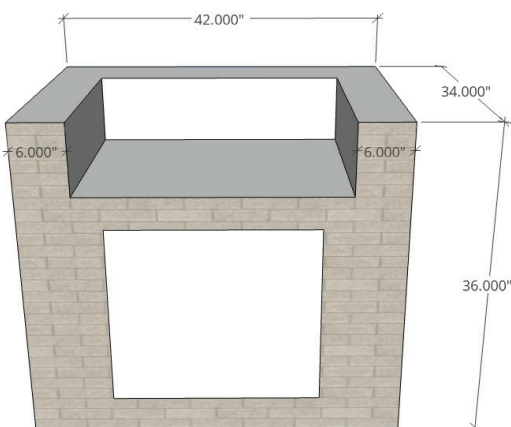

Cabinet, 42" wide - Easy Finish (EZSC42SC)  
Beverage Center (BLZ-3OCKT-SNK)  
25" Access Doors (BLZ-AD25-R)



# READY-TO-ASSEMBLE OUTDOOR KITCHEN

## Door & Drawer Cabinets

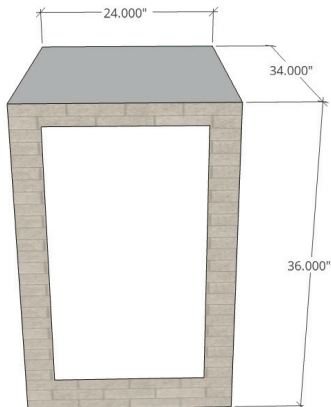

Cabinet, 24" wide - Easy Finish (EZDD24SC)  
16" Triple Access Door - Blaze BLZ (DRW3-R)

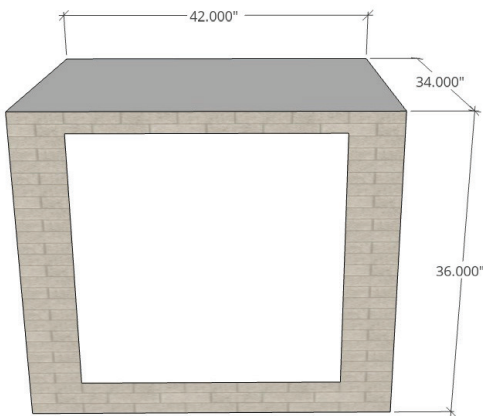

Cabinet, 42" wide - Easy Finish (EZDD42SC)  
30" Triple Access Door - Blaze BLZ (30W-3DRW)

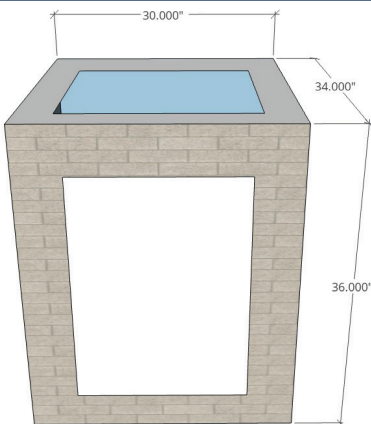

Cabinet, 30" wide - Easy Finish (EZIB30SC)  
22" Ice Bin/Wine Chiller - Blaze BLZ (ICEB-WH)  
Single Access Door - Blaze BLZ (SV-2417-R)

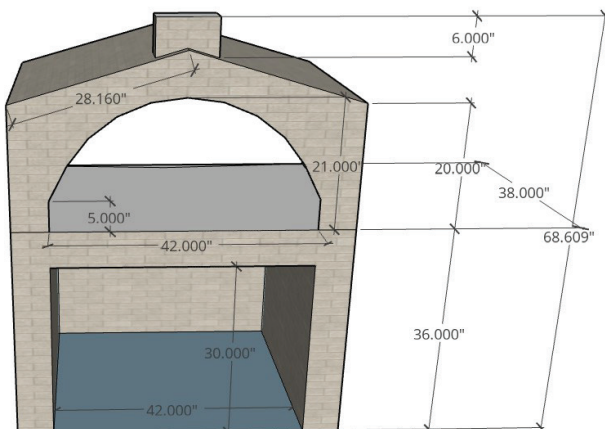

Cabinet, 54" wide - Easy Finish (EZPO54SC)

Opening size is determined by oven model

# READY-TO-ASSEMBLE OUTDOOR KITCHEN

## Refrigerator & Ice Maker Cabinets

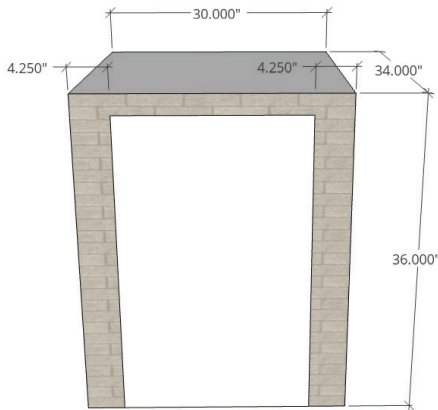

Cabinet, 30" wide - Easy Finish (EZFC30130SC)  
Refrigerator 4.4 CF - (SSRF126)

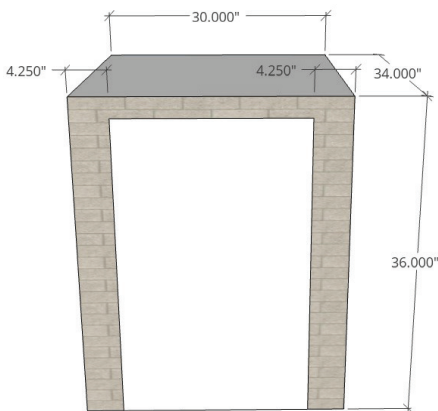

Cabinet, 30" wide - Easy Finish (EZFC3041SC)  
Refrigerator Outdoor Rated 3.2 CF - (SSRF-15)

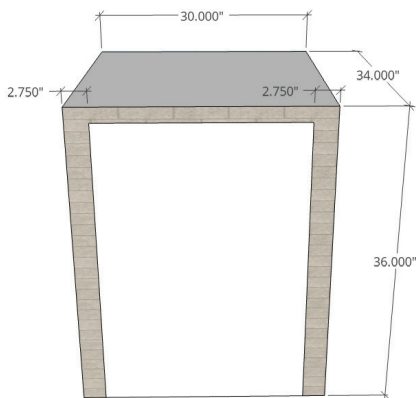

Cabinet, 30" wide - Easy Finish (EZFC3052SC)  
Refrigerator Outdoor Rated 5.5 e - Blaze BLZ  
(GD-BeV5.5 PBDR51)

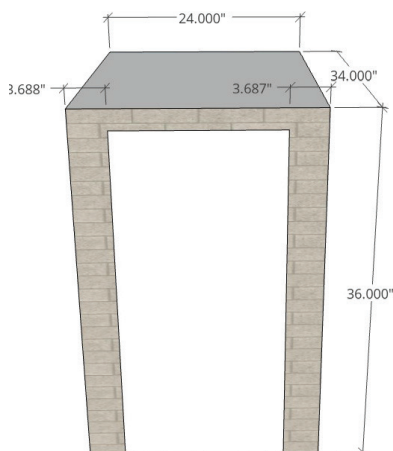

Cabinet, 24" wide - Easy Finish (EZFC24IMSC)  
Ice Maker 50# production/40# Storage Blaze  
(BLZ-ICEMKR-50CR)



# READY-TO-ASSEMBLE OUTDOOR KITCHEN

## Corner Cabinet, Filler and End Panels

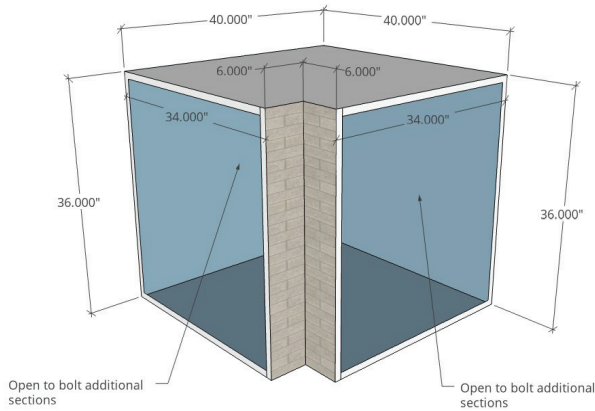

Cabinet, 40"X40" wide - Easy Finish (EZCC4040SC)

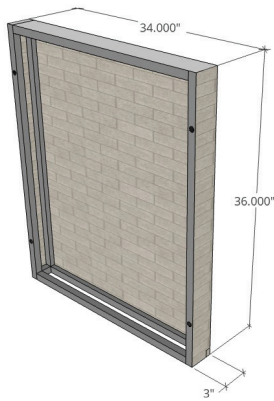

Cabinet - Easy Finish (EZEP3SC)

3" wide Left & Right Side End Panels, 3" wide

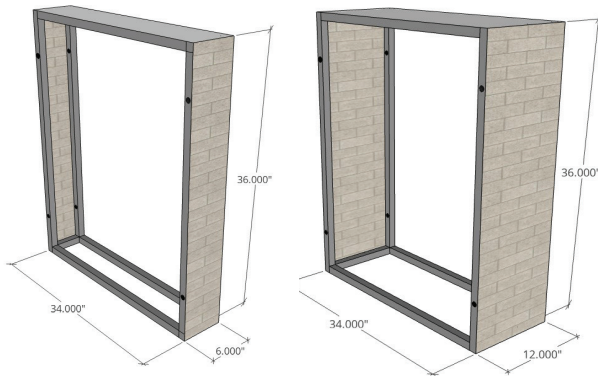

Cabinet, 6" wide - Easy Finish (EZFP6SC)

Cabinet, 12" wide - Easy Finish (EZFP12SC)

Filler Section 6" and 12" Wide

Need to add more counter top space?

Simply add a filler section.

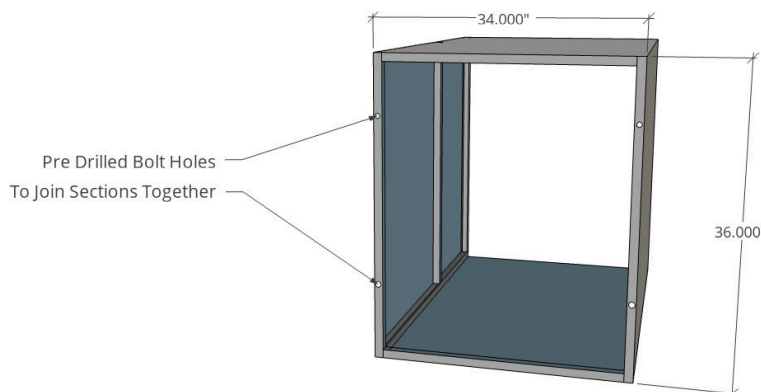

All cabinets come pre-drilled with bolts, nuts and washers to ensure proper alignment of cabinets as well as quick and easy assembly.

All units can be bolted from both right and left side allowing unlimited flexibility of placement and design of your outdoor structure.

# Outdoor Kitchen Design Ideas

#1

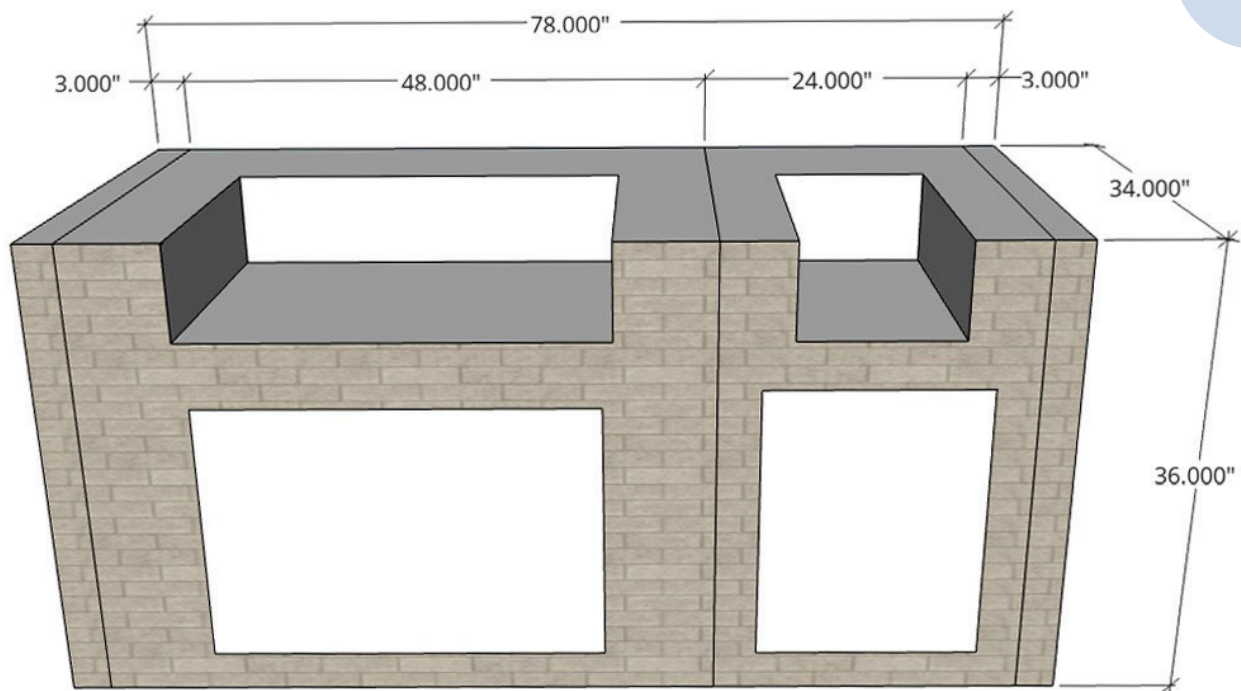

48" Grill Cabinet (EZCC48SC) • 24" Side Burner Cabinet (EZBC242SC) • 3" End Panel (EZEP3SC) (2)

## COMPONENTS



Grill (BLZ-4LTE2)



Side Burner (BLZSB2LTE)



Access Doors (BLZ-AD32-R)



2 Drawer (BLZ-Drw2-R)

# Outdoor Kitchen Design Ideas

#2

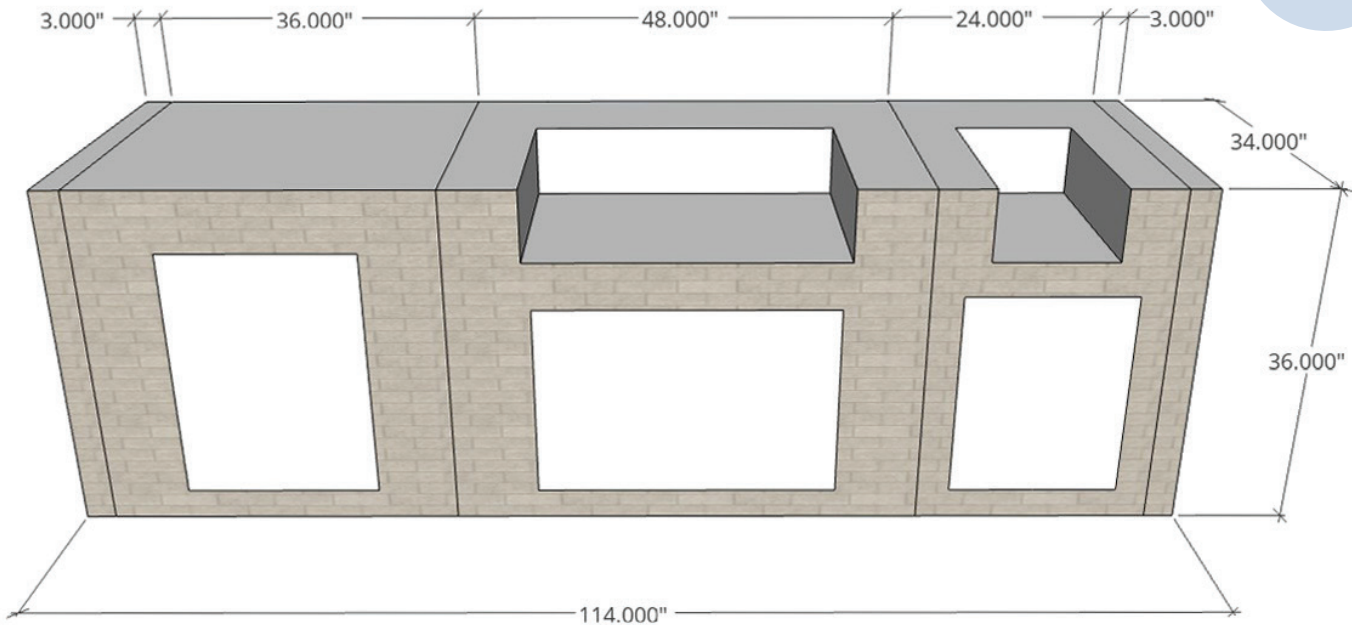

36" Trash/Recycling Cabinet (EZTC36SC) • 48" Grill Cabinet (EZGC48SC)  
24" Side Burner Cabinet (EZBC242SC) • 3" End Panel (EZEP3SC) (2)

## COMPONENTS



Recyclable Drawer  
(BLZ-TREC-DRW)



32" Grill (BLZ4LTE-LP-NG)



Side Burner (BLZ-SB2LTE-LP/NG)



2 Drawer Cabinet (BLZDRW2-R)

32" Access Doors (BLZ-AD32-R)



# Outdoor Kitchen Design Ideas

#3

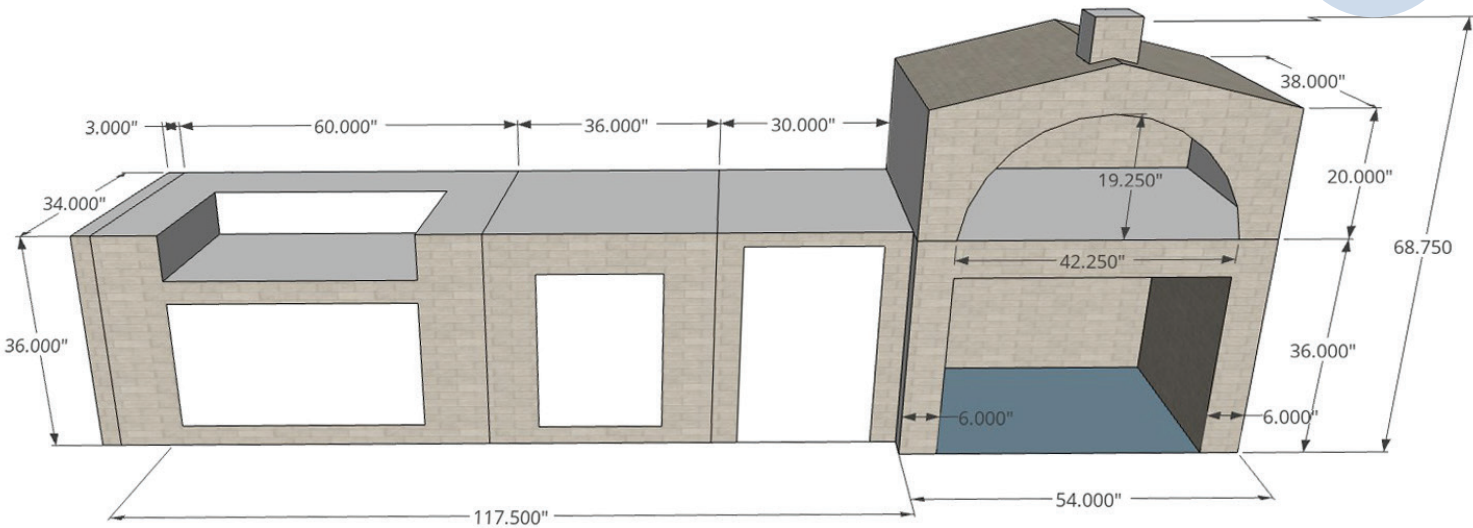

60" Grill Cabinet (EZGC60SC)  
 36" Trash/Recycling Cabinet (EZTC36SC) • 30" Fridge Cabinet (EZFC3041SC)  
 60" Pizza Oven Cabinet (EZPO60SC) • 3" End Panel (EXEP3SC) (1)

## COMPONENTS



40" Grill (BLZ5LTE-LP-NC)



Trash/Recyclable Drawer (BLZ-TREC-DRW)



Outdoor Fridge (BLZ-SSRF-5.5DH)



40" Access Doors (BLZ-AD39-R)



Pizza Oven

# Outdoor Kitchen Design Ideas

#4

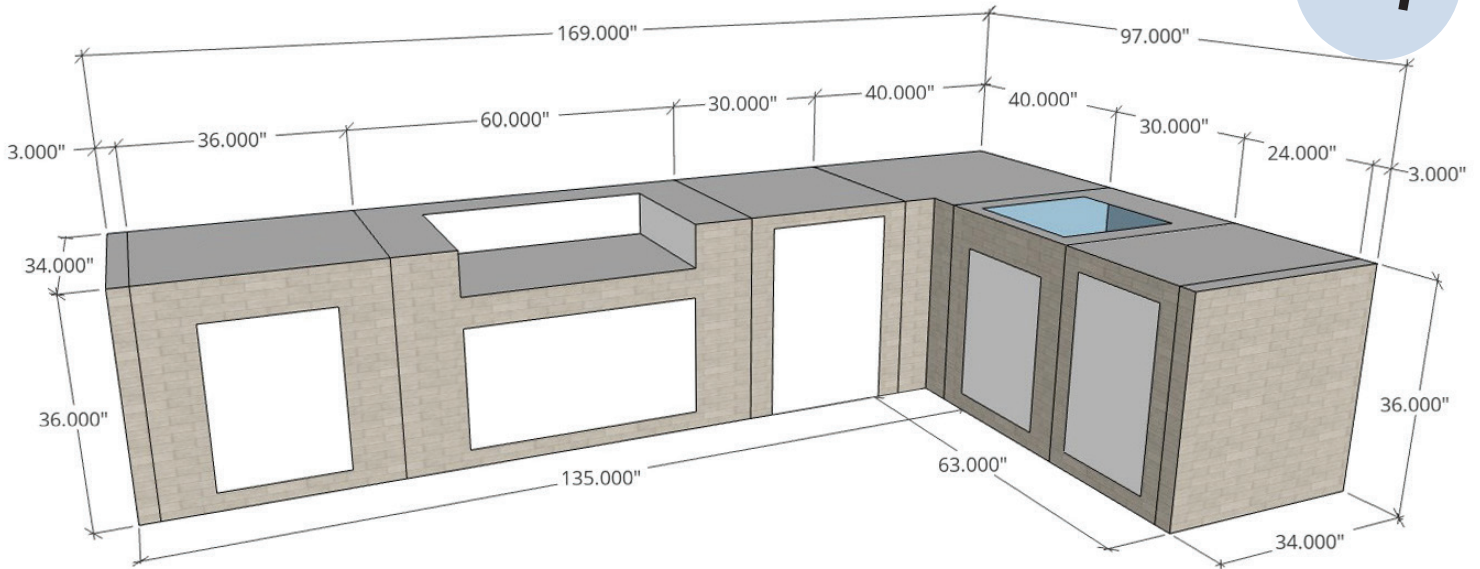

36" Trash/Recycling Cabinet (EZTC362SC) • 60" Grill Cabinet (EZCC60SC)

30" Fridge Cabinet (EZFC3041SC) • 36" Corner Cabinet (EZCC3636SC)

30" Ice Bin Cabinet (EZIB30SC) • 24" Drawer Cabinet (EZDD24SC) • 3" End Panel (EZEP3SC) (2)

## COMPONENTS



Trash/Recycle Bin  
(BLZ-TREC-DRW)



40" Crill (BLZ-5LTEZ)



Outdoor Fridge  
(BLZ-SSRF-5.5DH)



3 Drawer  
(BLZ-DRW3-R)



Drawer Door Combo  
(BLZ-DDC39-R)



Ice and Wine Chiller  
(BLZ-ICEB-WH)

Access Door  
(BLZ-SINGLE2417-R)

# Outdoor Kitchen Design Ideas

#5

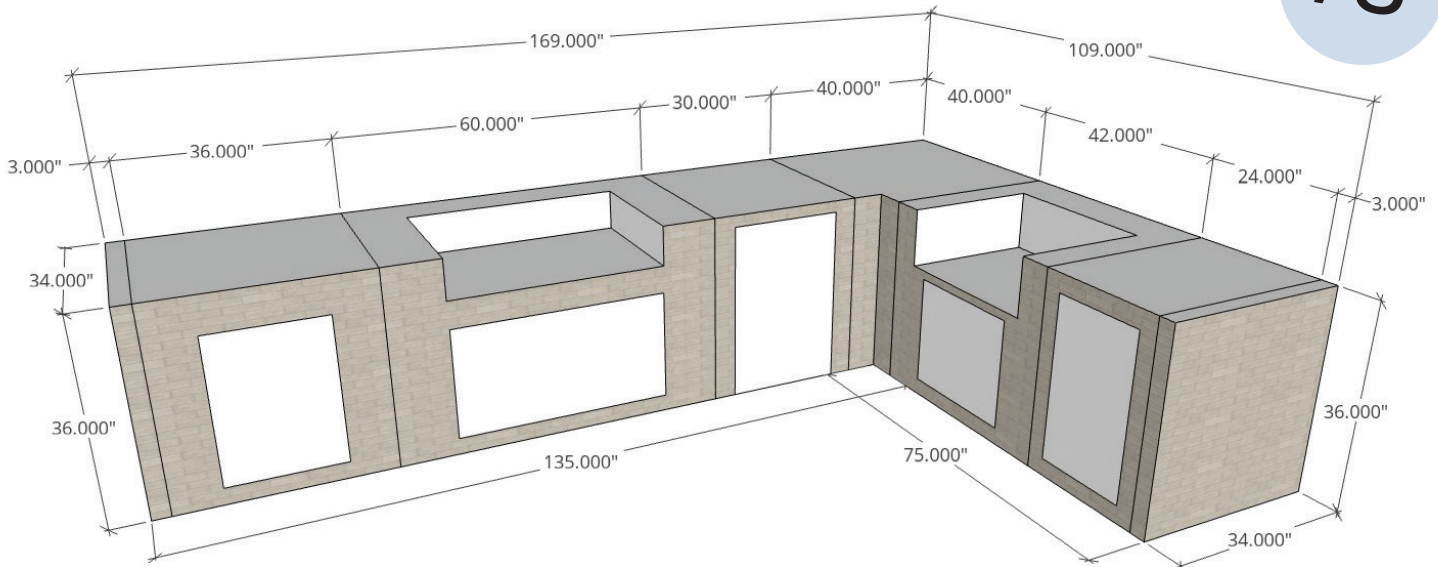

36" Trash/Recycling Cabinet (EZTC36SC) • 40" Grill Cabinet (EZGC60SC)  
 30" Fridge Cabinet (EZFC3041SC) • 36" Corner Cabinet (EZCC3636SC)  
 42" Griddle Cabinet (EZGIDD4230SC) • 24" Drawer Cabinet (EZDD24SC) • 3" End Panel (EZEP3SC) (2)

## COMPONENTS



Trash/Recycle Bin  
(BLZ-TREC-DRW)



40" Grill (BLZ-5LET2)



Outdoor Fridge  
(BLZ-SSRF-5.5DH)



3 Drawer  
(BLZ-DRW3-R)



Drawer Door Combo  
(BLZ-DDC39-R)



Access Door  
(Blz-SINGLE2417-R)

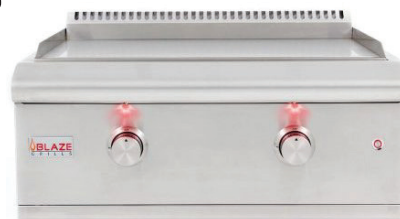

(BLZ-GRIDDLE-LTE)

# Outdoor Kitchen Design Ideas

#6

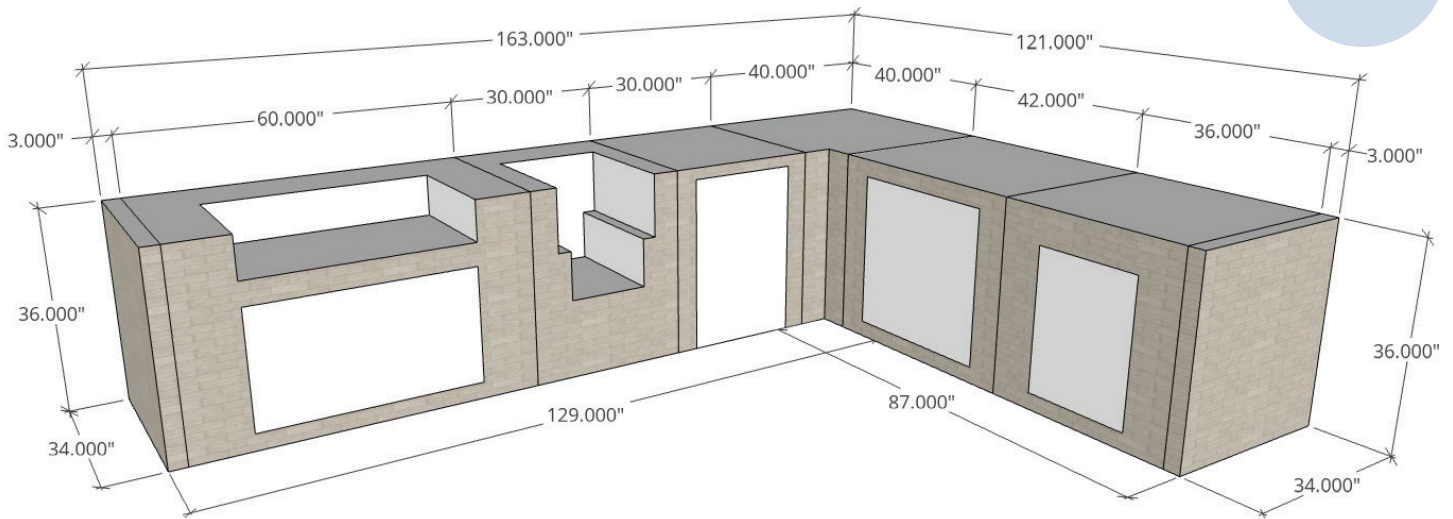

60" Grill Cabinet (EZCC60SC) • 30" Power Burner Cabinet (EZPB30SC)  
 30" Fridge Cabinet (EZFC3041SC) • 36" Corner Cabinet (EZCC3636SC)  
 42" Drawer Cabinet (EZDD42SC) • 36" Trash/Recycle Cabinet (EZTC36SC) 3" End Panel (EZEP3SC) (2)

## COMPONENTS



40" Grill (BLZ-5LTE)



Built in Power Burner (BLZ-PROPB)



3 Drawer (BLZ-30W-3DRW)



Drawer Door Combo (BLZ-DDC39-R)



Outdoor Fridge (BLZ-SSRF-5.5DH)



Trash/Recycle Bin (BLZ-TREC-DRW)

**CUSTOM MADE  
OUTDOOR  
KITCHENS**

**EZ FINISH  
OUTDOOR SYSTEMS**

[EZFINISHSYSTEMS.COM](http://EZFINISHSYSTEMS.COM)

**STEP ONE**

Send us a sketch of your dream outdoor structure.

**STEP TWO**

We make a complete computer rendering of your order, including dimensions.

**STEP THREE**

With your seal of approval, we construct your order.



**KITCHENS**

**OUTDOOR SYSTEMS**

[EZFINISHSYSTEMS.COM](http://EZFINISHSYSTEMS.COM)

**STEP ONE**

Send us a sketch of your dream outdoor structure.

**STEP TWO**

We make a complete computer rendering of your order, including dimensions.

**STEP THREE**

With your seal of approval, we construct your order.

**STEP FOUR**

After construction, we deliver your order.



**STEP ONE**

Send us a sketch of your dream outdoor structure.

**STEP TWO**

We make a complete computer rendering of your order, including dimensions.

**STEP THREE**

With your seal of approval, we construct your order.

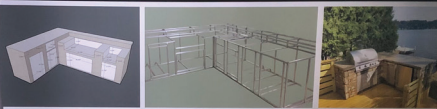

**STEP ONE**

Send us a sketch of your dream outdoor structure.

**STEP TWO**

We make a complete computer rendering of your order, including dimensions.

**STEP THREE**

With your seal of approval, we construct your order.



**EZ FINISH  
OUTDOOR SYSTEMS**