

KOWO

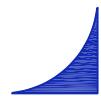
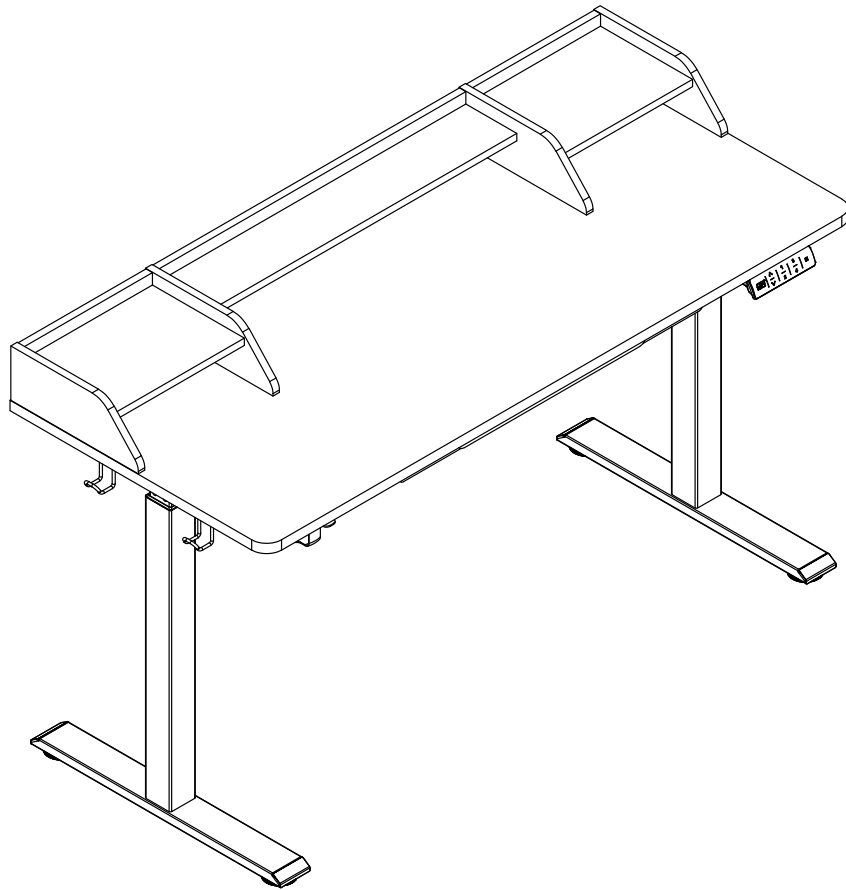

Hutch

Model#HD01-12/14

Any questions or issues please contact us

Tel : 020-8187-1190

Email:service.uk@kowohome.com

9:00 AM - 5:00 PM GMT Monday - Friday

Accessory Package

PLEASE NOTE: Check that you have received all components and hardware before assembling. If you are missing any parts, please contact us for replacement parts.

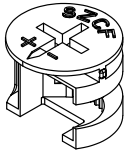

A. Cam Lock - 12



B. CAM SCREW - 12

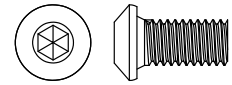

C. 1/2" Small Machine Screw - 8

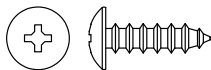

D. 1/2" Large Wood Screw - 8

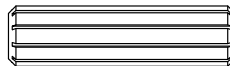

E. Wood Dowel - 9

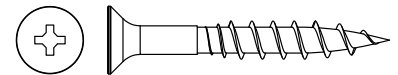

F. 1-1/2" Large Wood Screw - 13



G. 1/2" Medium Wood Screw - 15

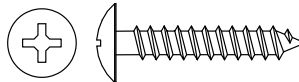

H. 1" Medium Wood Screw - 12

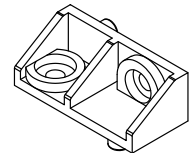

J. Mounting Bracket - 4



K. Slides - 2

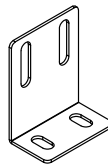

L. L Shaped Bracket - 2

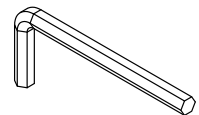

M. Wrench - 1

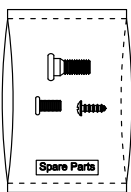

N. Spare Parts - 1

Diagram of Components

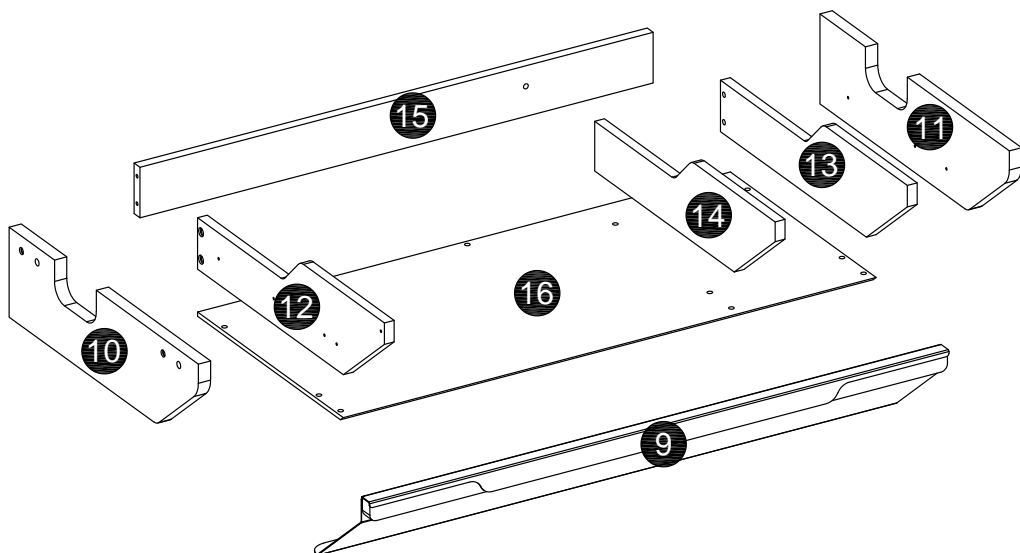
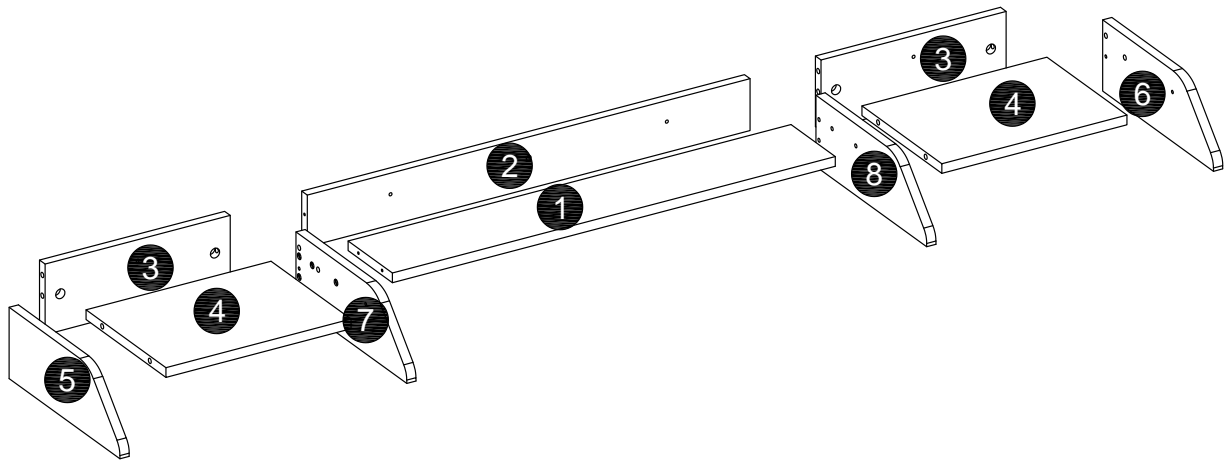

STEP 1

Detaching the Slide

Press lever to disconnect and separate the Extension Slide (K-2) from the Slide (K-1). Do this for both drawer Slides.

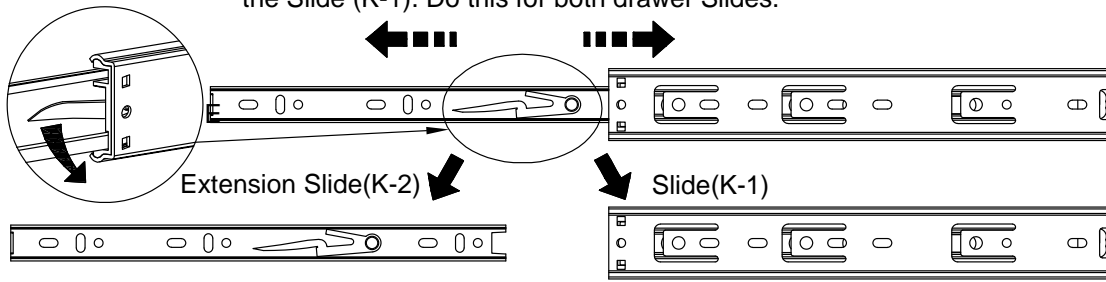

Adjust SLIDE to align with the screw holes.

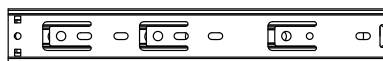
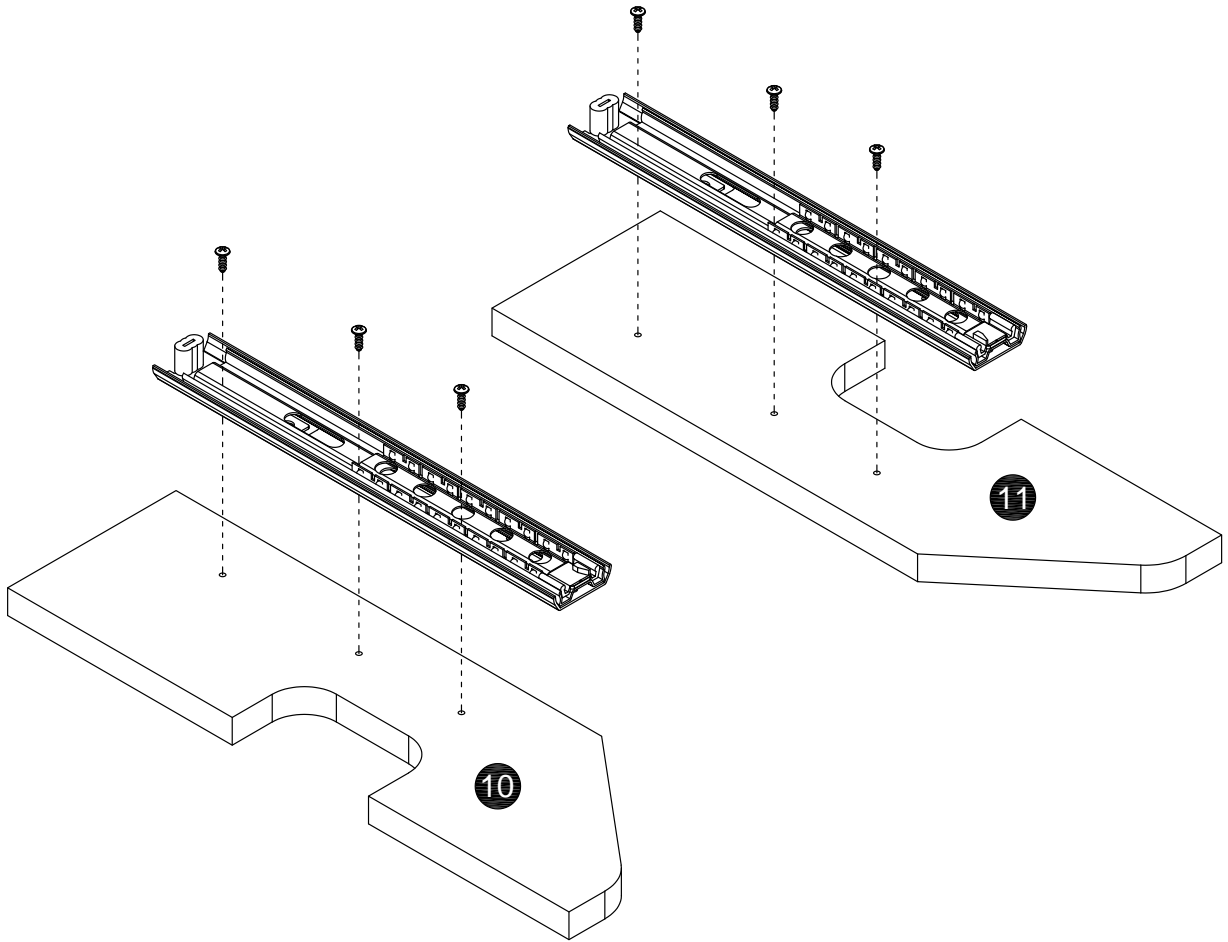
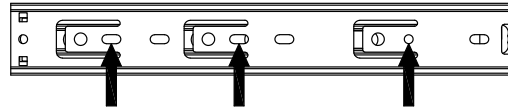

K.Slides -2



G.1/2" Medium Wood Screw-6

STEP 2

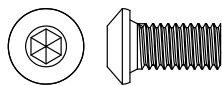
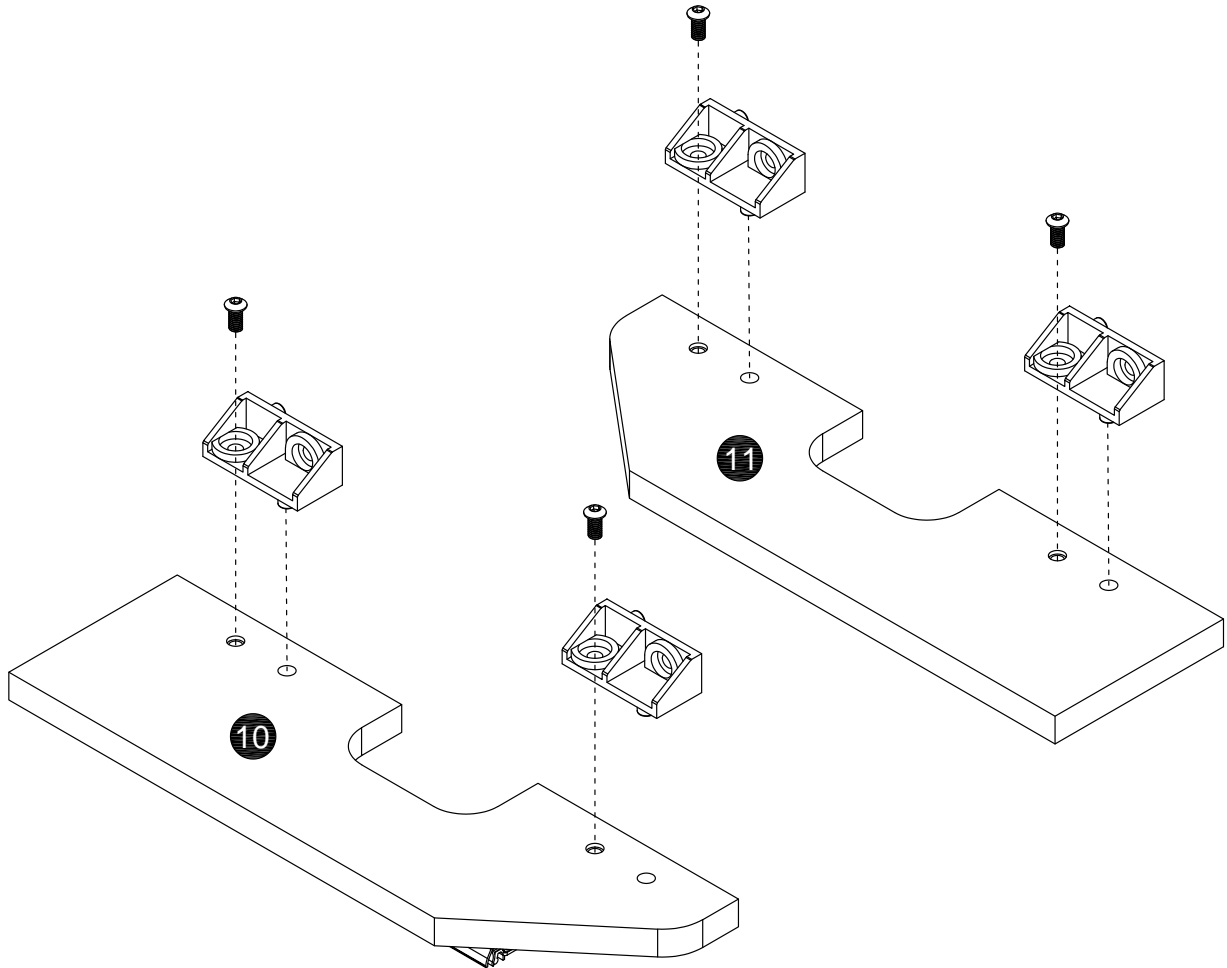

C. 1/2" Small Machine Screw - 4

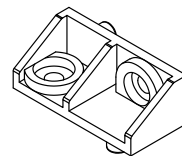

J. Mounting Bracket - 4

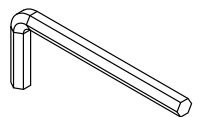

M. Wrench - 1

STEP 3

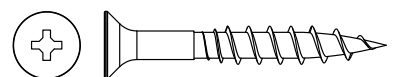
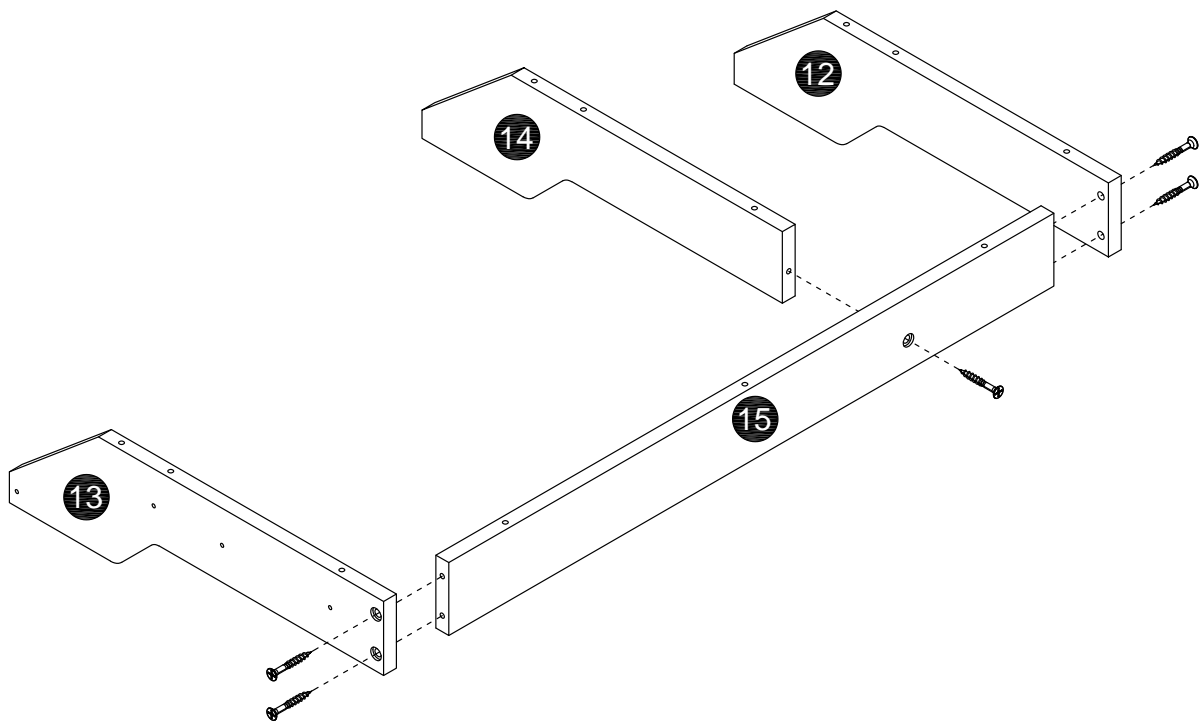

F. 1-1/2" Large Wood Screw - 5

STEP 4

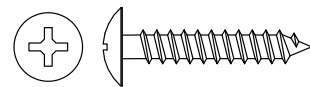
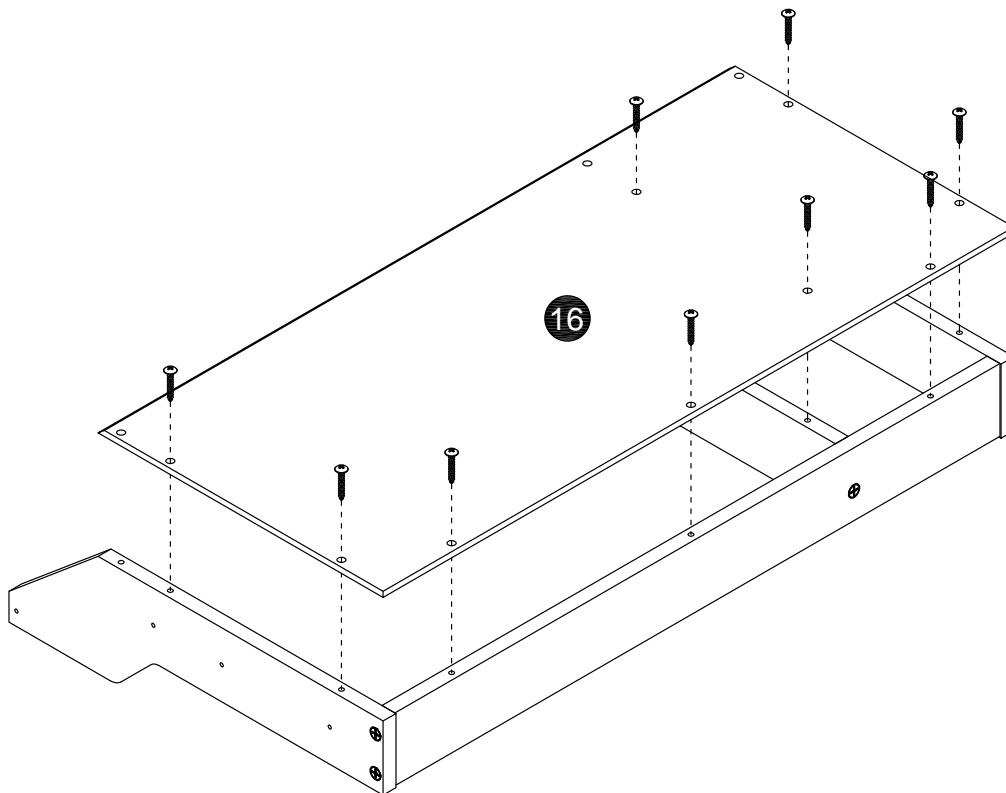

H. 1" Medium Wood Screw-9

STEP 5

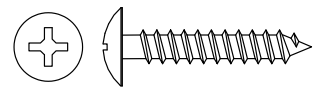
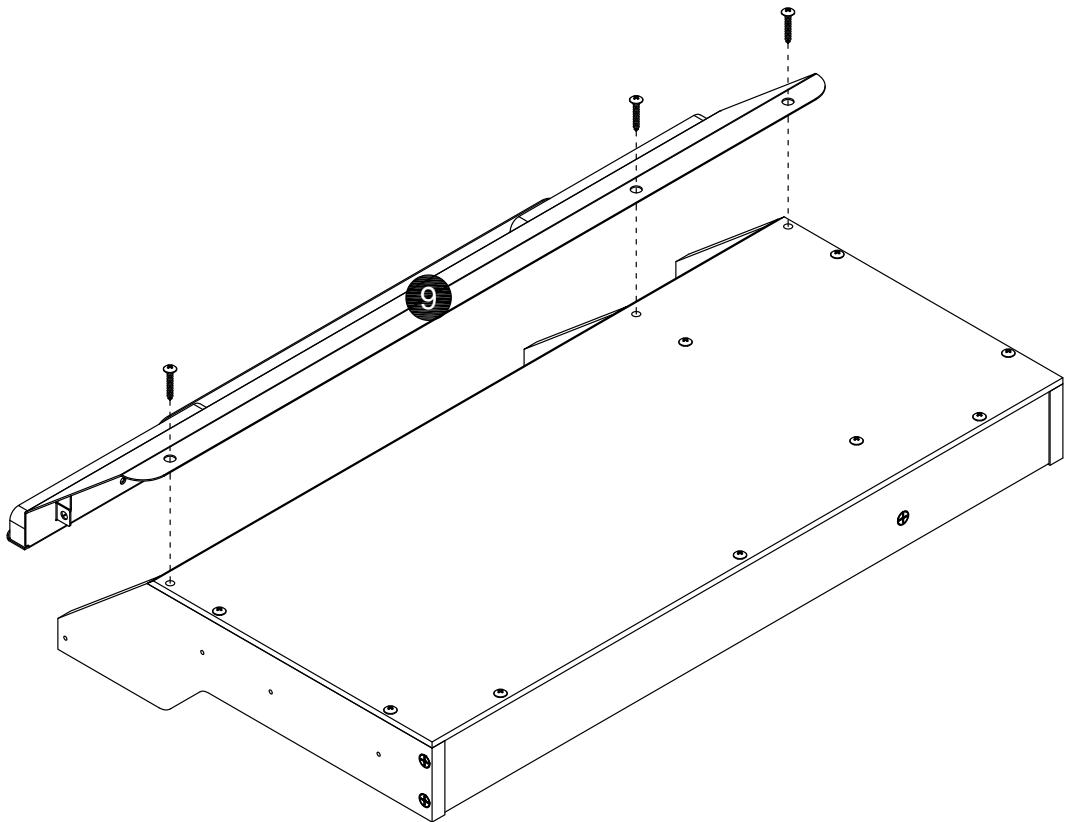

H. 1" Medium Wood Screw-3

STEP 6

Adjust runner to access the screw holes.

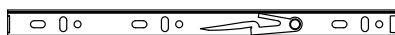
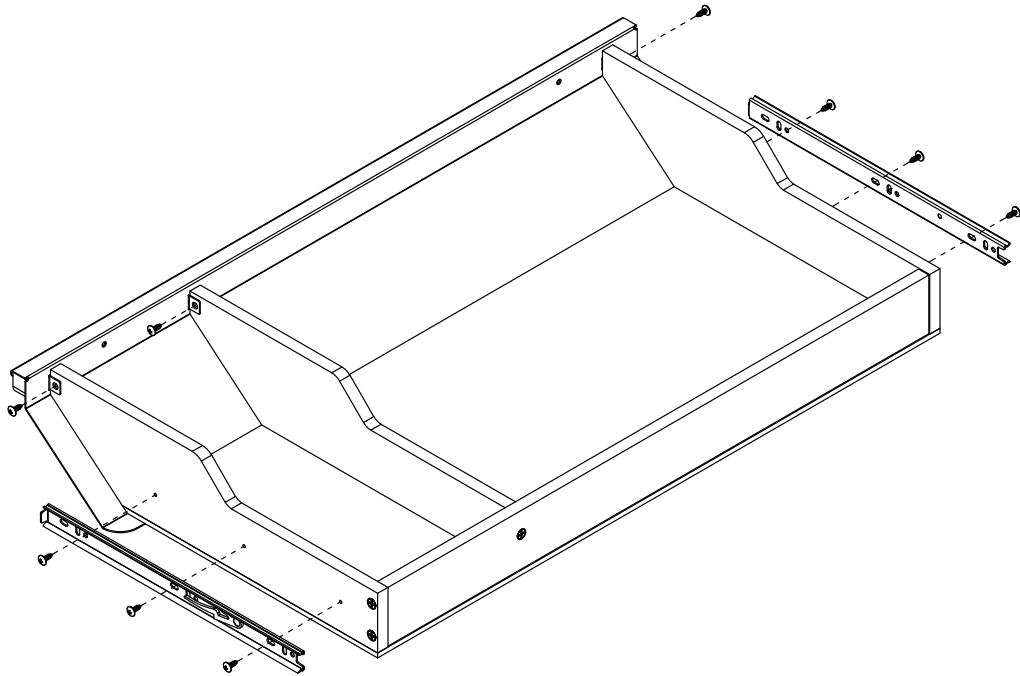

K.Extension Rail (K-2) - 2

G.1/2" Medium Wood Screw-9

STEP 7

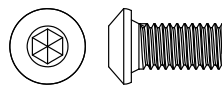
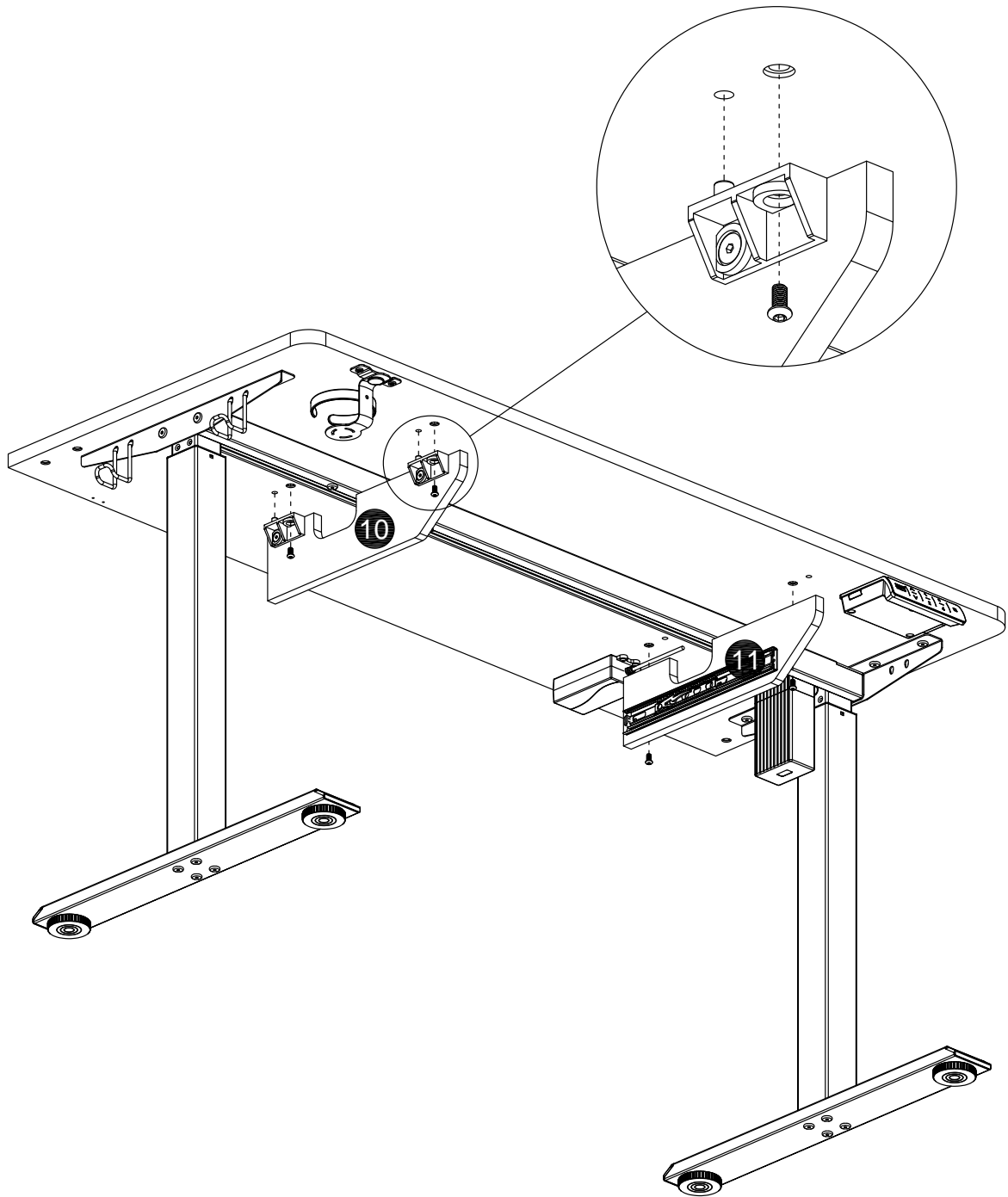

C. 1/2" Small Machine Screw - 4

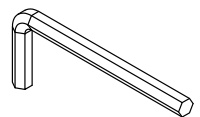

M. Wrench - 1

STEP 8

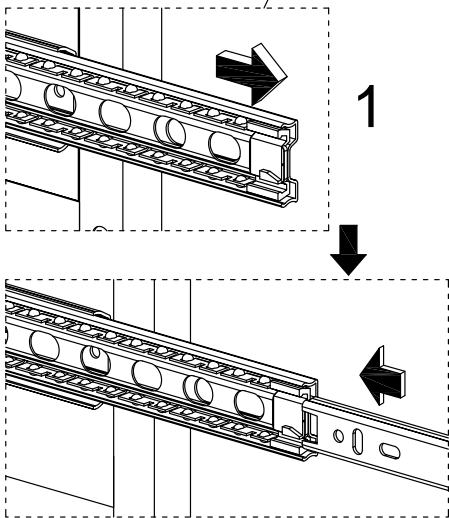
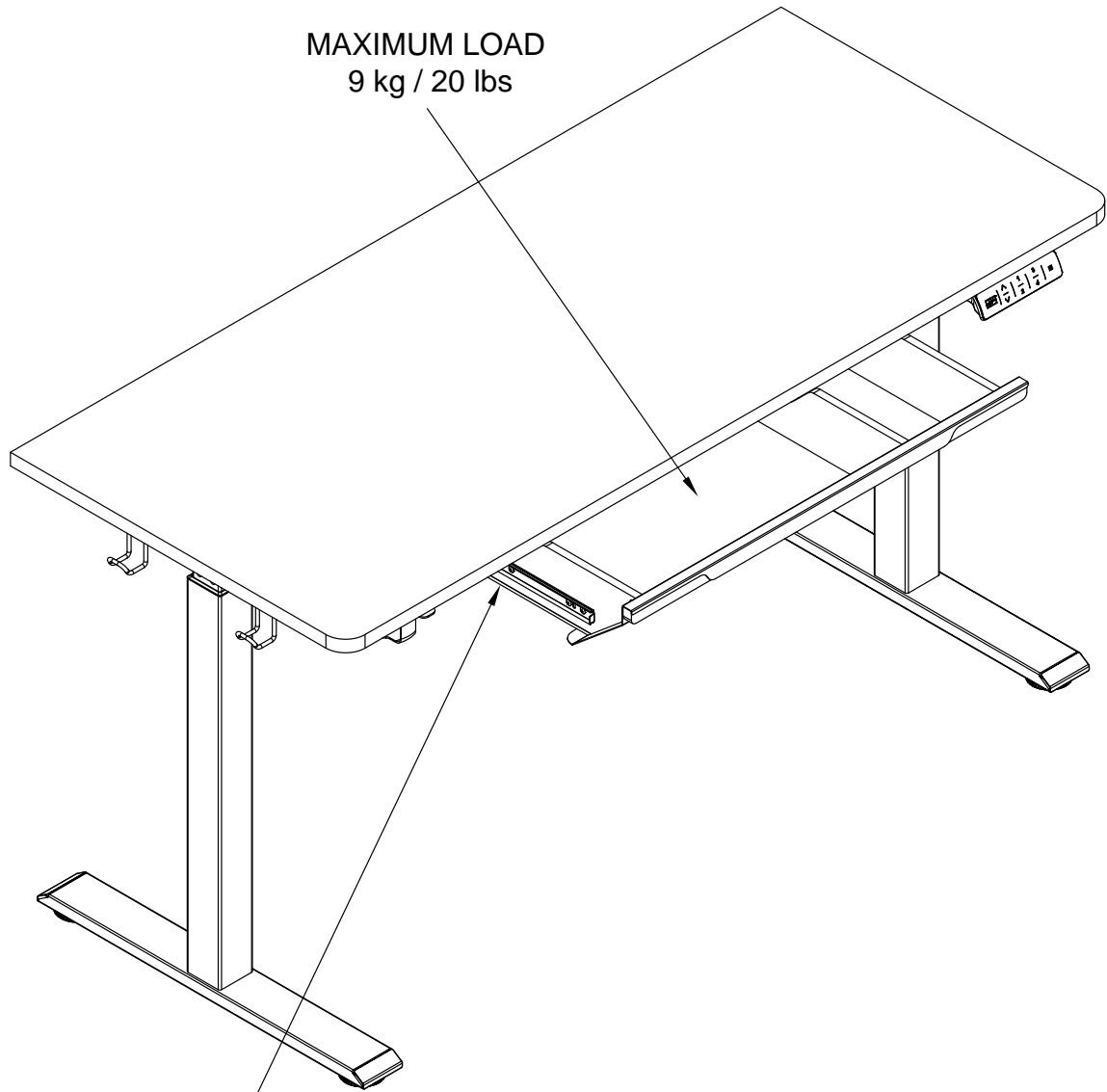

Attach the drawer to the desk.

1. Pull the internal part of the Slide (E-1) out.
2. Hold the drawer upright and insert the Extension Slide (E-2), aligning with the slide's internal part (E-1).
3. Slide the drawer into place. The first slide inward can sometimes push harder, but once the tracks are engaged, the drawer should slide in and out smoothly.

STEP 9

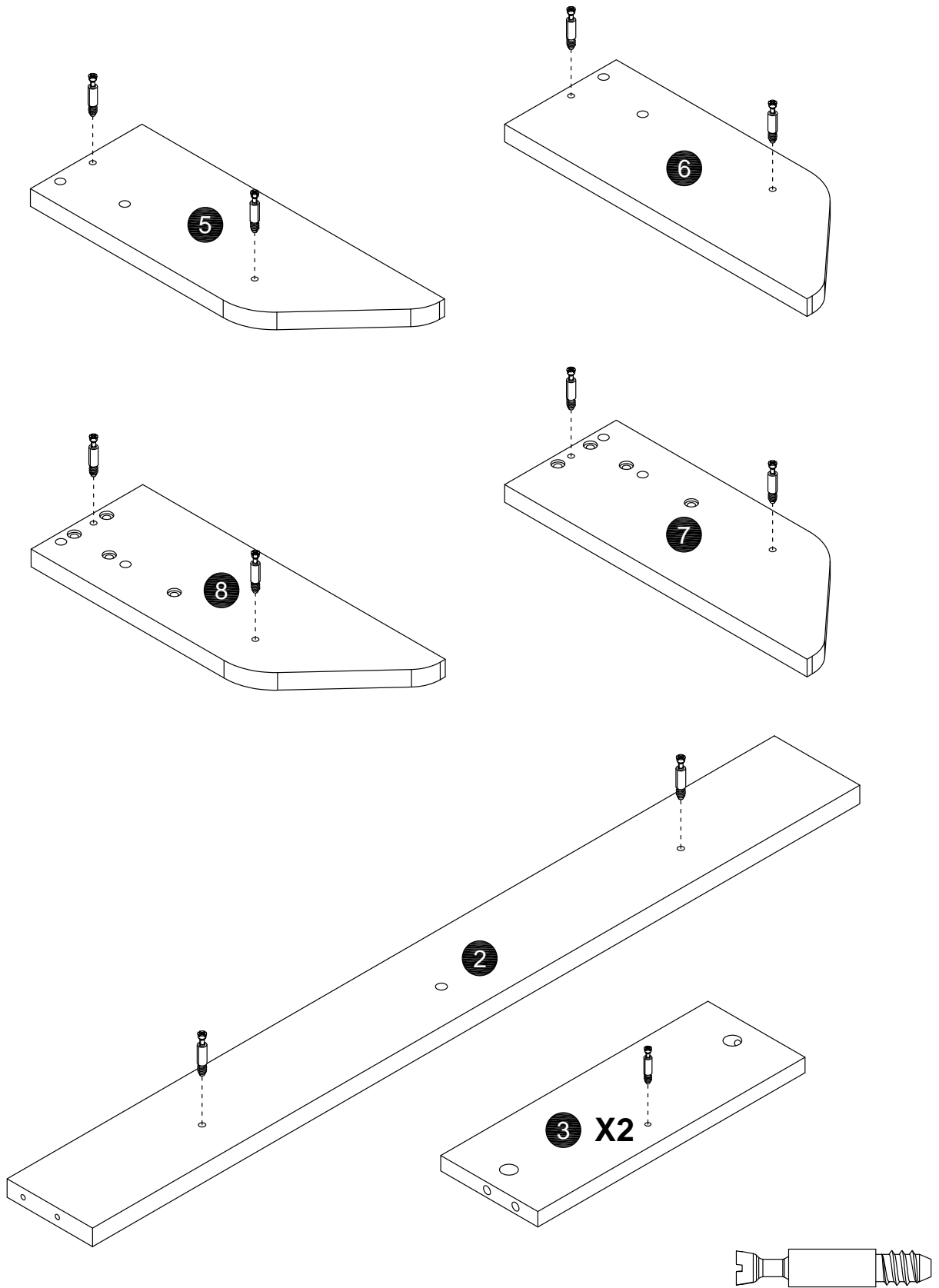

B.CAM SCREW - 12

STEP 10

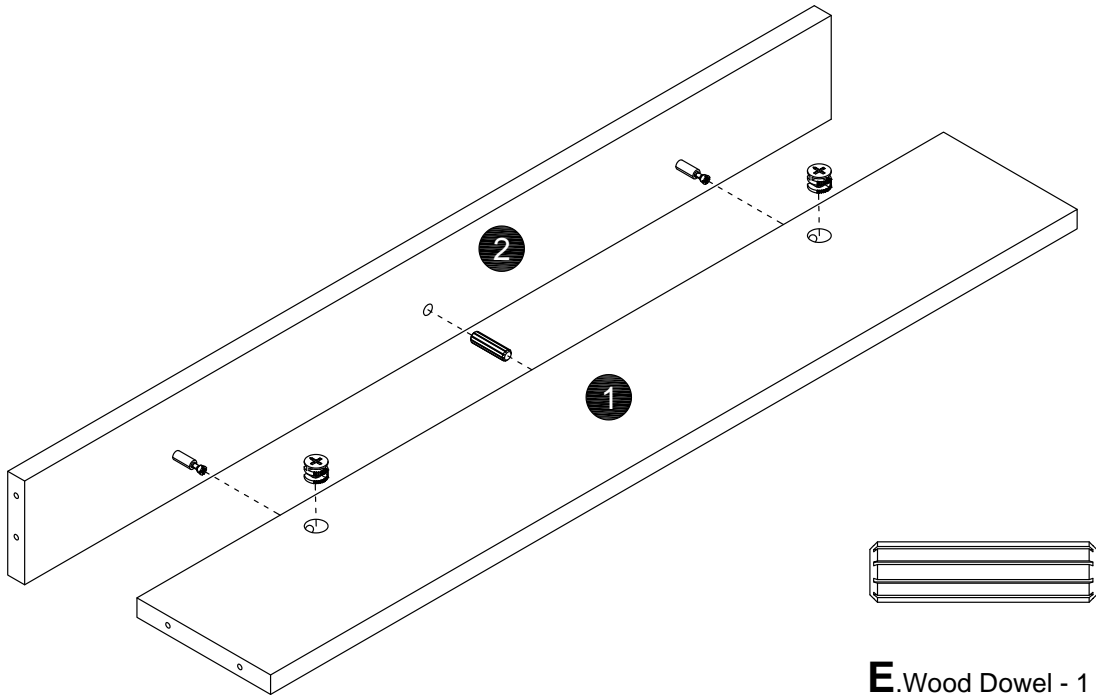

E. Wood Dowel - 1

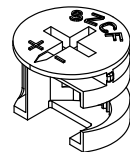
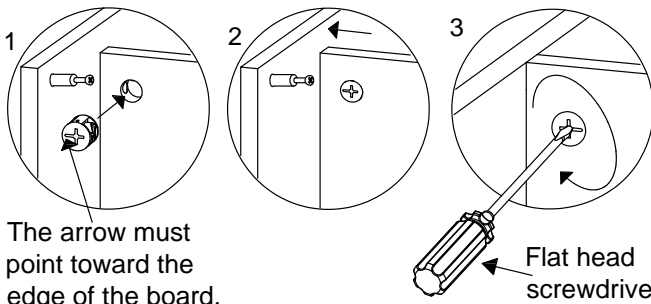
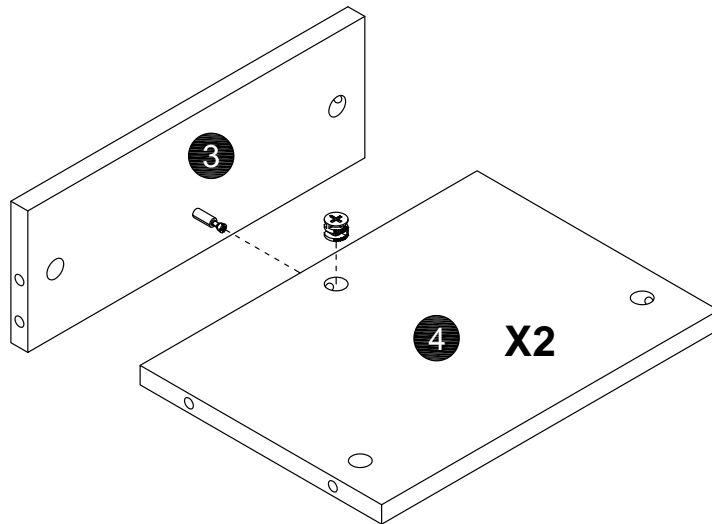

A. Cam Lock - 4

STEP 11

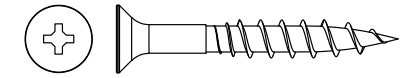
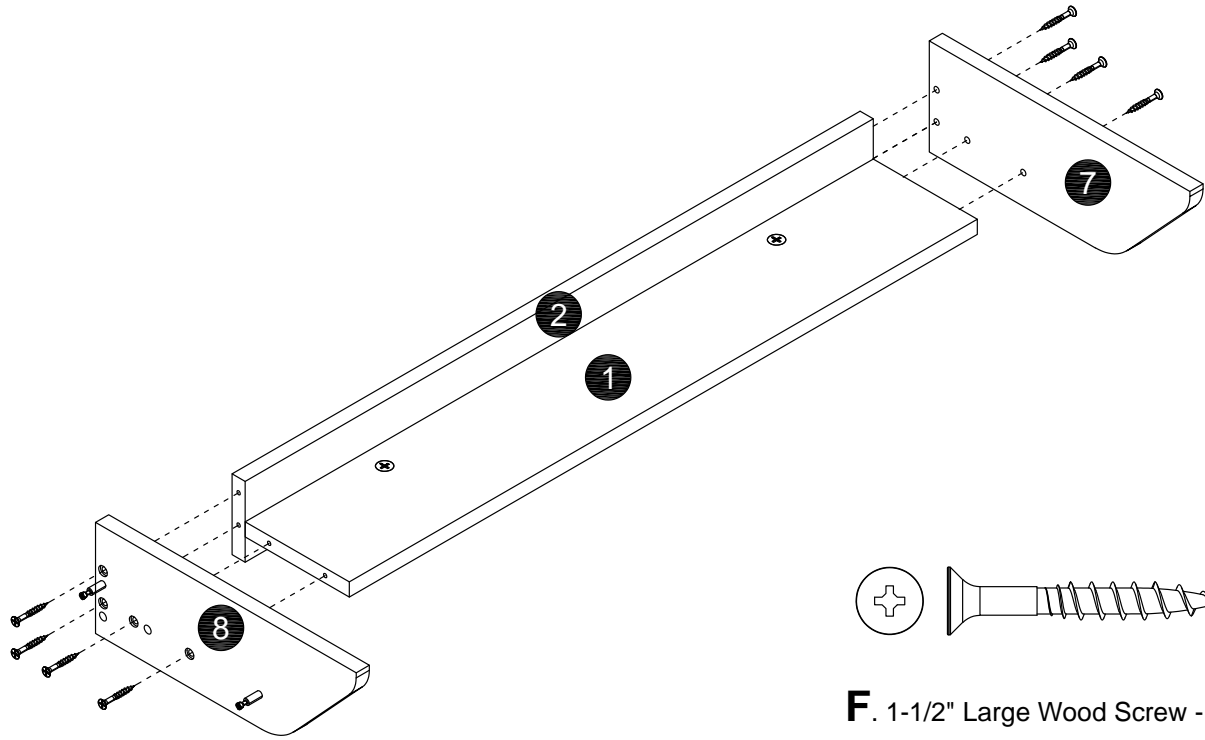

F. 1-1/2" Large Wood Screw - 8

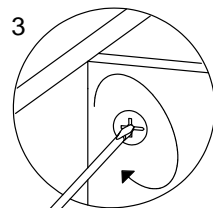
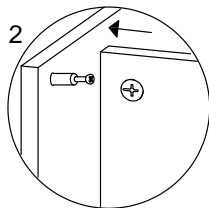
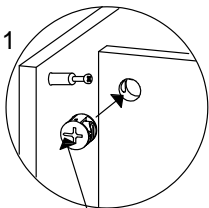
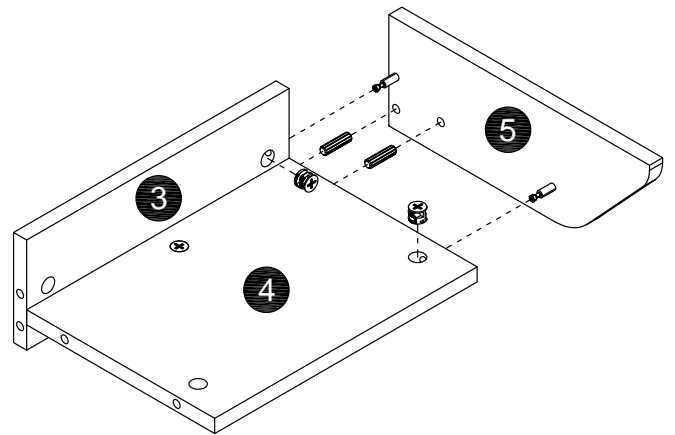
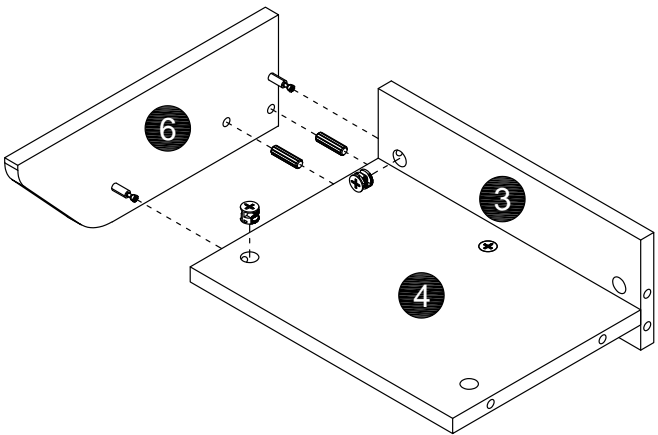

The arrow must point toward the edge of the board.

Flat head screwdriver

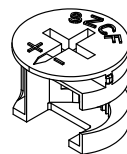

A. Cam Lock - 4



E. Wood Dowel - 4

STEP 12

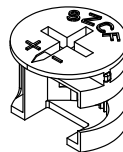
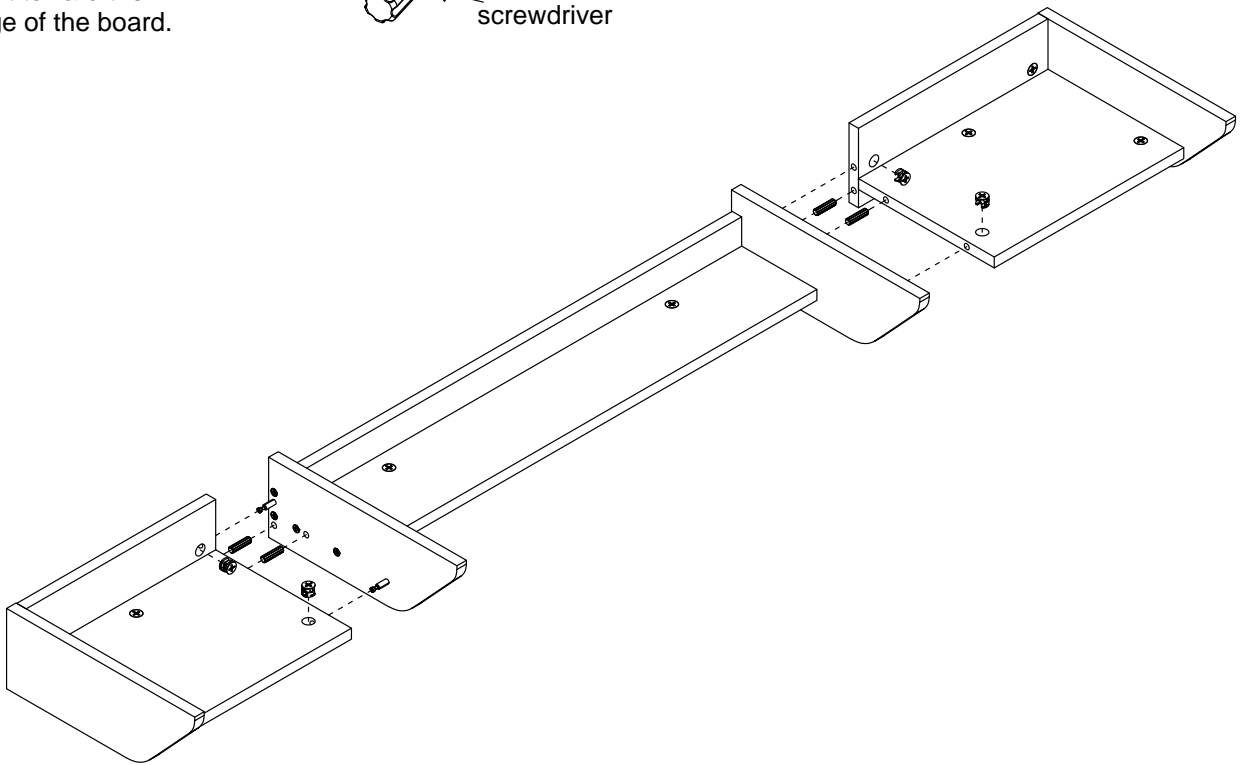
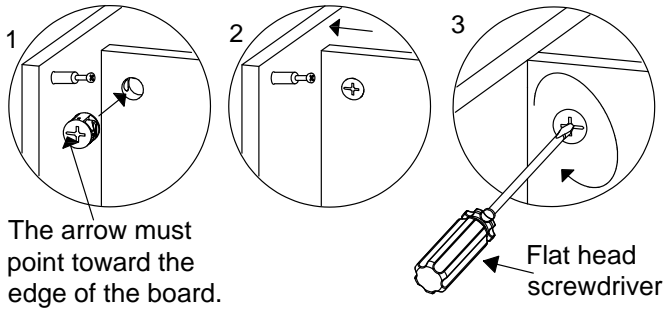

A. Cam Lock - 4



E. Wood Dowel - 4

STEP 13

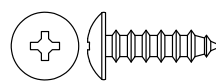
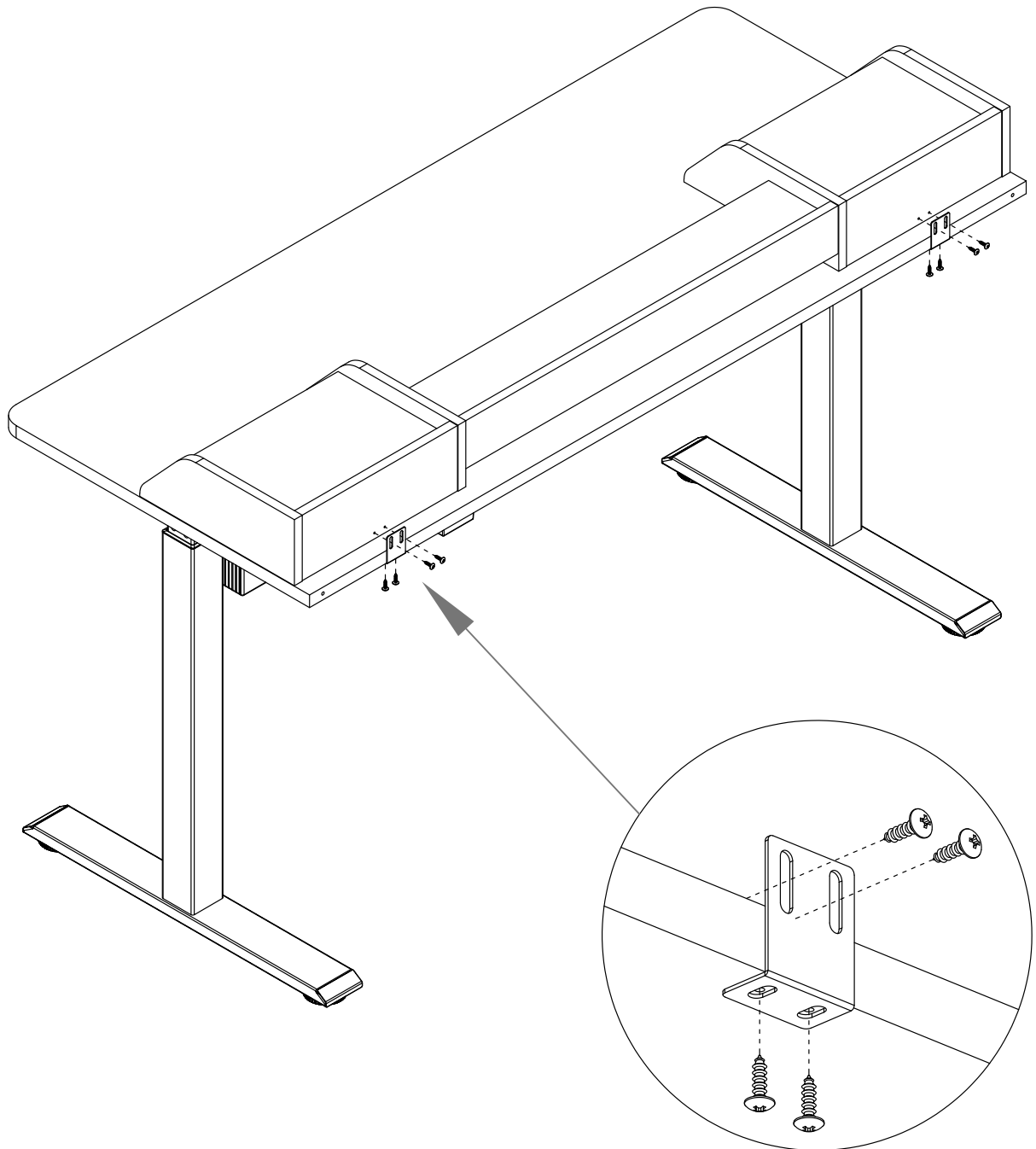

D. 1/2" Large Wood Screw-8

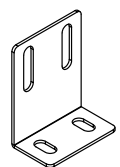

L. L Shaped Bracket - 2

STEP 14

