

LT161

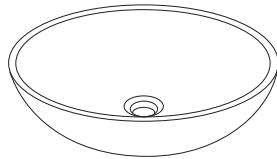

LT162

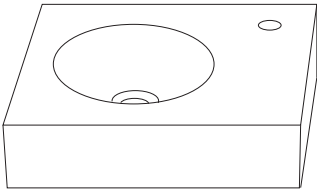

LT163

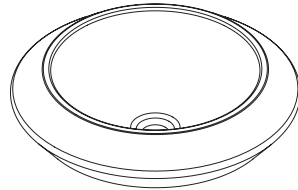

LT185

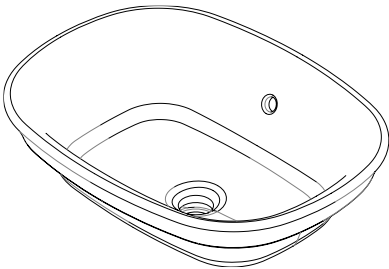

LT480(G)

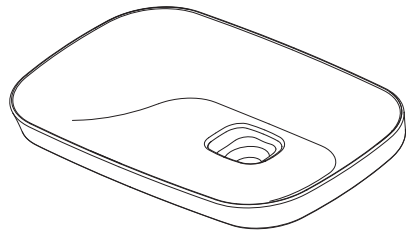

LT994(G) / LT995(G)

BEFORE INSTALLATION

If you are installing this product in a new construction or remodel, please make sure you are following all local plumbing and building codes. Carefully unpack and examine your new fixture for damage. To help insure that the installation process will proceed smoothly and correctly, please read these instructions carefully before you begin.

PREPARATION

1. Cut out the provided template along the inside of the cutting line.
2. Position the template on the countertop and secure with adhesive tape. Except LT163, mark the desired faucet location, making sure the chosen faucet has adequate clearance and reach.

INSTALLATION

1. Cut out the opening on the countertop by following the cut line on the template.
2. Temporarily set the lavatory on the countertop to check for fit.
3. Install the faucet and drain fittings (not included) per the manufacturer's instructions.
4. **LT161 & LT162:** Apply 2 beads of adhesive caulk (not provided) on the bottom surface of the lavatory. Apply the first bead approx. 1/4" from the outside edge. Apply the second bead about 5/8" from the first bead.

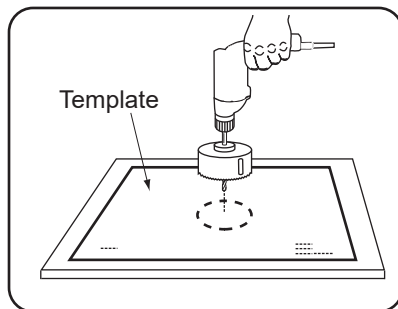

LT163, LT185, LT480(G), LT994(G) & LT995(G): Apply a bead of adhesive caulk on the bottom surface of the lavatory.

See illustration:

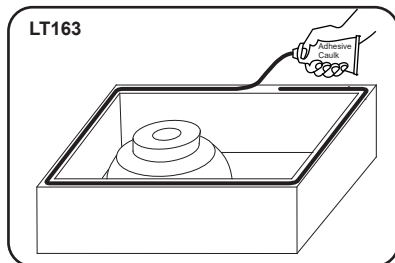
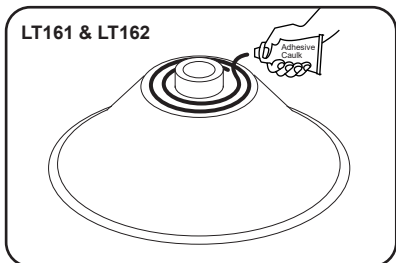

INSTALLATION (cont.)

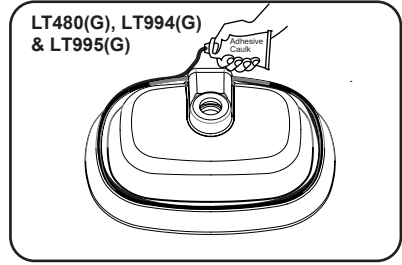
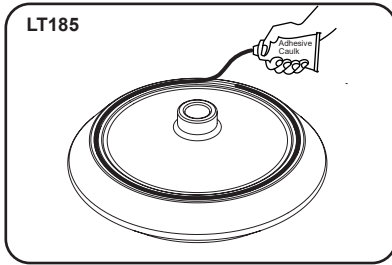

5. Carefully set the lavatory on the counter top.
6. Lightly press on the lavatory to set the adhesive caulk. Wipe away any excess and fill voids as necessary.
7. Allow adhesive to set per manufacturer's instructions.
8. Finish up the faucet and drain connections.
9. Run water into the lavatory and check for leaks.

CEFIONTECT® CLEANING INSTRUCTIONS



WHAT IS CEFIONTECT®?

CEFIONTECT® is TOTO's super-smooth permanent glaze that prevents debris from sticking to surfaces. Products with the letter "G" in the number have the CEFIONTECT® glaze. This glaze, along with regular cleaning, will help keep your TOTO product in pristine condition.

NOTE:

For best results to keep your Toto product with CEFIONTECT® clean:

- Lavatory: Use a mild dish detergent with a clean, soft cloth.
- Toilet: Use a gel based cleaner with a soft bristled-plastic brush.
- **Don't use** cleaners, polishing powders or detergents that have gritty or coarse particles.
- **Don't use** bleach, chemical thinners or products that have acid or alkaline detergents listed as ingredients.
- **Don't use** metal scrub brushes or steel wool.

Following these instructions will ensure that your TOTO product with the CEFIONTECT® glaze will always stay intact, keeping your product like new for years to come!



No CEFIONTECT®



With CEFIONTECT®

