

RVH8359

UNDERMOUNT WORKSTATION SINK

RUVATI®

SPECIFICATION SHEET

MATERIAL

- True 16 Gauge Thickness
- Premium T304 Grade Stainless Steel
- 18/10 Chromium/Nickel Content
- Commercial Brushed Finish

FEATURES

- Heavy duty sound guard padding and undercoating
- Slanted bottom with elegant drain grooves for easy draining
- Single-Tier Ledge for Accessories

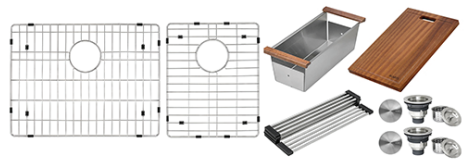

IN THE BOX

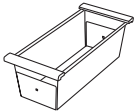

Colander
[RVA1317]

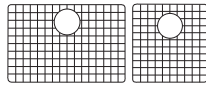

Rinse Grid
[RVA68359]

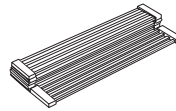

Folding Rack
[RVA1395]

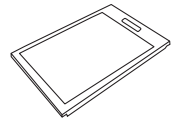

Cutting Board
[RVA1217]



Basket Strainer
[RVA1025] x 2

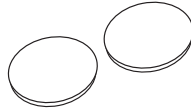

Drain Cover
[RVA1035] x 2

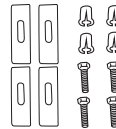

Mounting Clips
[RVA11031]



Cut-out
Template

NOMINAL DIMENSIONS

- Exterior:** 36" (wide) x 19" (front-to-back)
- Interior Bowl:** 20" x 16" (left) x 13" x 16"(right)
- Bowl Depth:** 10"
- Minimum Cabinet Size:** 39" wide
- Drain Hole Size:** 3½"

- Installation Type:** Undermount
- Inside Corners:** Zero Radius
- Drain Location:** Rear Center

OPTIONAL ACCESSORIES (SOLD SEPARATELY)



Deep Basket
Disposal Flange
[RVA1049ST]

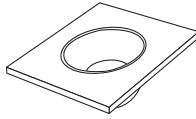

Mixing Bowl
and Platform
[RVA1288]

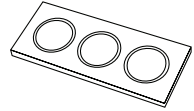

Condiment
Serving Tray
[RVA1377]

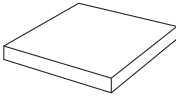

Butcher Block
[RVA2445ACA]

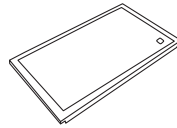

Black Plastic
Cutting Board
[RVA1217BLK]

DIMENSIONS

