



HAYLOU

HAYLOU Lady Bag
真无线降噪蓝牙耳机

使用说明书

01 包装内容物



耳机x1



充电线x1



耳帽x3



说明书x1



操作指南x1

02 按键功能

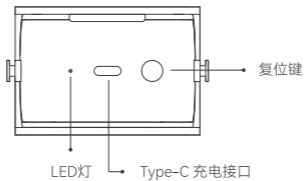
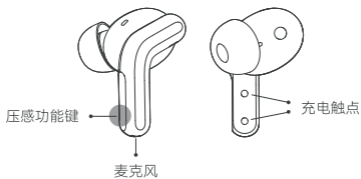



压感功能键操作

功能	操作
接听/挂断电话	按一下功能键
来电拒接	连续按两下功能键
播放/暂停音乐	按一下功能键
下一曲播放	连续按两下右耳功能键
上一曲播放	连续按两下左耳功能键
切换降噪、标准、通透模式	长按任意功能键2s
低延迟模式	连续按三下任意功能键

03 佩戴方式

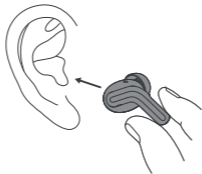

将耳机轻轻塞入耳道，调整耳机达到最佳佩戴状态，为保证ANC效果，建议选用合适的耳帽尺寸。



通话时，将耳机麦克风朝向嘴部可使通话更清晰。

04 基本操作

首次开机使用，请先去除左右耳机充电触点处的隔离膜，将充电盒及耳机充满电。



插入充电线时，充电盒指示灯持续闪烁，充满灭灯。

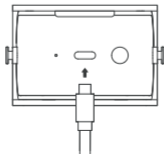

开机：充电盒开盖，耳机自动开机。

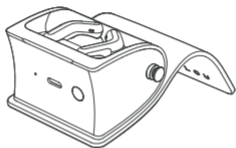

关机：耳机放入充电盒中，合盖耳机关机（扣位扣好才可关机）。

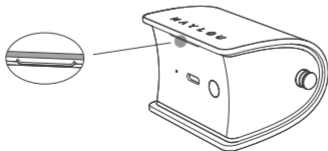

05 连接配对

1. 首次连接时，双耳机在盒内，开盖状态即可进入配对模式，打开设备蓝牙搜索“Haylou Lady Bag”并点击完成连接。
2. 使用其他手机连接时，双耳机在盒内开盖状态，复位键长按2s，也可使耳机进入配对模式。

如果连接失败，将耳机放回充电盒，重复上述操作。首次连接后，耳机开机可自动回连上一次配对设备（蓝牙需开启）。



06 耳机重置

1. 耳机放回充电盒，保持充电盒电量充足，然后长按充电盒复位键6秒；
2. 清除手机配对记录，重新完成连接即可。

* 若操作不成功，请重复以上步骤；或登录官方旗舰店，联系客服，查看复位操作视频。

常见异常

1. 耳机一边有声一边无声：
尝试将无声的耳机放入充电盒再取出；
以上步骤操作后还无法解决，尝试重置步骤；
2. 耳机无法充电：
检查充电舱电量是否充足；
用干布或者棉签擦拭充电接触部位；
3. 耳机无法和手机自动断连：
检查充电舱电量是否充足，没电会导致耳机无法关机，无法和手机断开连接。

07 耳机基本参数

产品名称: Haylou Lady bag

产品型号: Haylou T87

耳机基本参数

通讯距离: 10米 (无障碍空旷环境)

电池容量: 34mAh (单耳机)

充电时间: 约1.5小时

通话时间: 约3小时 (ANC OFF状态下)

待机时间: 约25小时 (ANC OFF状态下)

输入参数: 5V=100mA

电池类型: 锂离子聚合物电池

无线连接: 蓝牙5.2

充电盒基本参数

输入参数: 5V=500mA

输出参数: 5V=200mA

充电时间: 约2小时

电池容量: 300mAh

电池类型: 锂离子聚合物

CMIIT ID: 2022DP13890

* 以上数据是在特定条件下由HAYLOU内部实验室测试所得, 仅供参考, 实际使用时依据用户使用习惯及环境不同也会有所差异。

08 注意事项

警告

1. 请勿以任何理由拆开、维修或改装耳机，否则可能会导致起火甚至彻底损坏本产品。
2. 请勿将设备置于温度过低或过高（0°C以下或45°C以上）的环境下。
3. 使用产品指示灯时，请避开儿童或动物的眼睛。
4. 请勿在雷暴天气下使用本产品，雷暴可导致设备工作异常，并增加触电的危险。
5. 请勿使用酒精或其他挥发性液体擦拭本产品。
6. 该耳机可用于日常清洗，但不能对着麦克风孔处冲洗和浸泡，否则对其麦克风的性能可能会产生影响。
7. 运动过后或清洗后请不要立即充电，以免充电口里面可能残留的汗水或液体导致耳机电路损伤。

注意

1. 使用产品前请仔细阅读本使用说明书并请妥善保管。
2. 首次使用时，请先将本产品充满电。
3. 如果产品长期(超过2个星期)不用，请对其充电。
4. 必须选择正规厂家生产且经过国家CCC认证的充电器。
5. 过高音量下听音乐可能会损伤您的听力，声音也可能会失真。

说明书中的产品、配件、用户界面等插图均为示意图，仅供参考。由于产品的更新和升级，产品实物与示意图可能略有差异，请以实物为准。

09 产品中有害物质的名称及含量

部件名称	有害物质					
	铅 (Pb)	汞 (Hg)	镉 (Cd)	六价铬 (Cr(VI))	多溴联苯 (PBB)	多溴二苯醚 (PBDE)
耳机主体	X	O	O	O	O	O
电 池	X	O	O	O	O	O
充 电 线	O	O	O	O	O	O
充 电 盒	O	O	O	O	O	O
耳 帽	O	O	O	O	O	O

本表格依据SJ/T 11364的规定编制。

O：表示该有害物质在该部件所有均质材料中的含量均在GB/T 26572规定的限量要求以下。

X：表示该有害物质至少在该部件的某一均质材料中的含量超出GB/T 26572规定的限量要求。



1) 本标识内的数字表示产品（除电池外）在正常使用状态下，环保使用期限为10年。



2) 本标识内的数字表示电池在正常使用状态下，环保使用期限为5年。

部件上的环保使用年限标识优先于产品上任何与之相冲突或不同的环保使用期限标识。本产品所有环保使用期限是指在产品说明书规定的使用条件下使用本产品不发生有毒有害物质泄露的安全年限。

10 售后服务

HAYLOU蓝牙耳机售后服务承诺:严格按照《中华人民共和国消费者权益保护法》、《中华人民共和国产品质量法》实行售后三包服务,服务内容如下:在三包有效期内,您可凭购物凭证依照本规定享受免费的修理、更换、退货的权利。

- 1.自您购买之日起7日内,本产品出现故障,经由HAYLOU售后服务中心确定为产品质量问题,可享受修理、更换、退货的服务。
- 2.自您购买之日15日内,本产品出现故障,经由HAYLOU售后服务中心确定为产品质量问题,可享受修理或更换的服务。
- 3.自您购买之日起12个月内,本产品出现故障,经由HAYLOU售后服务中心确定为产品质量问题,可享受修理的服务。

Haylou Lady Bag 性能故障表

名称	性能故障
蓝牙耳机	1.使用过程中听不到声音。 2.通话过程中,对方听不到声音。 3.无法充电。 4.无法关机。

非保修条例

- 1.使用造成的正常磨损脏污如:刮痕、颜色改变;因接触化学试剂、接触尖锐物体、掉落挤压等人为导致损坏。
- 2.未经授权的维修、误用、碰撞、疏忽、滥用、进液、事故、改动、不正确的使用非本产品配件或撕毁、涂改标贴、防伪标记。
- 3.已超过三包有效期。
- 4.因不可抗力造成的损坏。
- 5.不符合《性能故障表》所列性能故障的情况。
- 6.因人为原因导致本产品及其配件产生《产品性能故障表》所列性能故障。

若有售后服务需求,请联系HAYLOU客服

制造商: 东莞市猎声电子科技有限公司

制造商地址: 广东省东莞市南城街道宏图路
86号1栋 401-410室

网 址: www.haylou.com

客服电话: 4008-555-083



HAYLOU微信公众号



H A Y L O U

HAYLOU Lady Bag
ANC True Wireless Earbuds

User Manual

01 Package List



Earbuds x 1



Charging cable x 1



Ear tips x 3



User manual x 1



Operation guide x 1

02 Button Functions

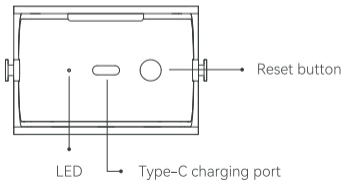
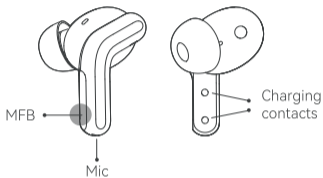

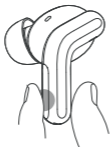

MFB operation

Function	Operation
Answer/hang up	Press the MFB
Reject an incoming call	Press the MFB twice
Play/pause music	Press the MFB
Skip track forward	Press the right MFB twice
Skip track backward	Press the left MFB twice
Switch among noise cancellation, standard and transparent modes	Press and hold any MFB for 2s
Low latency mode	Press any MFB three times

03 Wearing Method

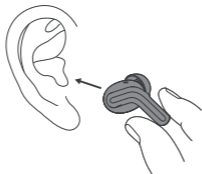

Gently insert the earbud into the ear canal, adjust the earbud to the most comfortable wearing state. It is recommended to choose suitable size of ear tips to ensure ANC effect.



When calling, adjust Mic towards mouth to gain better talking experience.

04 Basic Operation

For first time use, please remove the isolation film on the charging contacts of both earbuds. Then fully charge the charging case and earbuds.

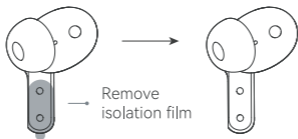

When the charging cable is inserted, the charging case indicator flashes continuously, then goes out after the case is fully charged.

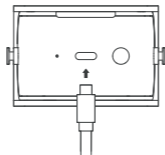

Power on: When the charging case is opened, the earbuds will automatically power on.

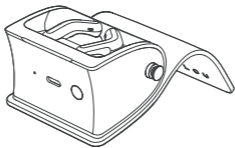

Power off: Put the earbuds into the charging case, and close the lid to power off (the earbuds can be turned off only after the buckle is fastened).

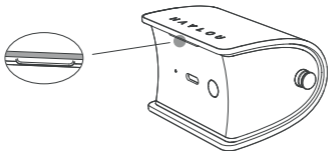

05 How to Pair

1. Connect for the first time: when the earbuds are in the charging case, they will enter pairing mode once opening the lid. Open device Bluetooth and search for "Haylou Lady Bag", and click to connect.
2. Connect with other phone: when the earbuds are in the charging case with the lid open. Press and hold the reset button on the case for 2s, the earbuds will enter pairing mode.

Put the earbuds back to the charging case and repeat the above operation if the connection fails. After the first connection, the earbuds can be automatically connected to the last paired device when powering on (Bluetooth needs to be turned on).

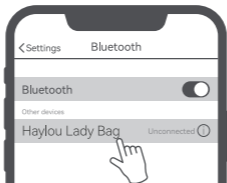

06 Restore factory settings

1. Put the earbuds back into the charging case and ensure the case has sufficient power. Then press and hold the reset button on the charging case for 6s;
2. Clear phone pairing record and complete the connection again.

Common abnormal:

1. One of the earbuds is mute:
Try to put the mute earbud into the charging case and then take it out;
If the problem is still not solved after the above operation, try the reset steps;
2. The earbud cannot be charged:
Check whether the charging case has sufficient power;
Wipe the charging contacts with a dry cloth or cotton swab;
3. The earbud cannot automatically disconnect from the mobile phone;
Check whether the charging case has sufficient power. The earbud will not power off if the case is out of power and will not disconnect from the mobile phone.

07 Basic Parameters of Earbuds

Product name: Haylou Lady bag

Product model: Haylou T87

Basic Parameters(earbuds)

Operation range: 10m (open space with no obstacle)

Battery capacity: 34mAh (single earbud)

Charging time: approx. 1.5hr

Talk time: approx. 3hr (ANC OFF state)

Standby time: approx. 25hr (ANC OFF state)

Input parameter: 5V = 100mA

Battery type: li-ion

Bluetooth version: V5.2

Basic Parameters(charging case)

Input parameter: 5V = 500mA

Output parameter: 5V = 200mA

Charging time: approx. 2hr

Battery capacity: 300mAh

Battery type: li-ion

- * The above data is obtained from Haylou's internal laboratory tests under specific conditions and is for reference only. It may vary in actual use depending on user habits and environment.

08 Caveats

Warning

1. Do not disassemble, repair or modify the product for any reason, as this may cause fire or even completely destroy the product.
2. Do not expose the product to environments where the temperature is too low or too high (below 0°C or above 45°C).
3. Keep the indicators away from the eyes of children and animals while using the headphones.
4. Do not use this product during thunderstorms. Thunderstorms may cause the product to malfunction and increase the risk of electric shocks.
5. Do not wipe and clean the headphones or their case with alcohol or other volatile liquids.
6. Avoid any contact with liquids.

Note

1. Please read this user manual carefully before using the product and please properly store it.
2. When using for the first time, please fully charge this product.
3. Please charge the product, in case it has not been used over two weeks.

4. Please use certificated charger.
5. Do not wear headphones for a long term to protect your hearing.
6. Do not wear headphones in any situations with potential risks as wearing them may reduce your perception to the outside world.

FCC Requirement

Changes or modifications not expressly approved by the party responsible for compliance could void the user's authority to operate the equipment.

This device complies with Part 15 of the FCC Rules. Operation is subject to the following two conditions:

1. This device may not cause harmful interference;
2. This device must accept any interference received, including interference that may cause undesired operation.

Daily maintenance

Please do not shower with headphones. Do not wear them in rainy day. Do not leave them in washing machine or other extreme situations. Clean them with dry cloth.

09 Warranty Card

Warranty Period 12 months after you purchase this item. (or you may inquire your local shopper for more details.)

Free Service

Supposing any defects caused by quality issues occur within the warranty period, please take this warranty card and purchase receipts to your distributor for free exchange service.

Model Number	
Date of Purchasing	
User's Name	
User's Phone	
User's Address	
Shop's Name	
Shop's Address	
Comments	

Free exchange service will not be accessed under following circumstances:

1. Damages caused by unauthorized disassembly.
2. Defects or physical damages caused by leaking or dropping off.
3. Damages by act of God. Supposing your item is within any damages or defects except the above circumstances, please return to us or your distributor for free repairing.

For more language versions: 한국어, Deutsch, Italiano,
日本語, Português, Español, Русский



Please scan the QR code

Manufacturer: Dongguan Liesheng Electronic Co., Ltd.

Address: Room 401-410, Building 1, No.86 Hongtu Road,

Nancheng District, Dongguan City, Guangdong, China

Web: www.haylou.com



R-R-zK2-HaylouT87

FCC ID: 2AMQ6-T87