



MADE IN ITALY  
DAL 1925



S E R R A T U R E







S E R R A T U R E



## INDICE

### INDEX

<b>01</b>	<b>LUCCHETTI</b> <i>PADLOCKS</i>	<b>pag. 03</b>
<b>02</b>	<b>CILINDRI</b> <i>CYLINDERS</i>	<b>pag. 13</b>
<b>03</b>	<b>FERROGLIETTI</b> <i>RIM PLATE LOCKS</i>	<b>pag. 21</b>
<b>04</b>	<b>SERRATURE DA INFILARE</b> <i>MORTICE LOCKS</i>	<b>pag. 25</b>
<b>05</b>	<b>SERRATURE DA SERRANDA</b> <i>SHUTTER CYLINDER LOCKS</i>	<b>pag. 29</b>
<b>06</b>	<b>SERRATURE DA APPLICARE</b> <i>RIM LOCKS</i>	<b>pag. 35</b>
<b>07</b>	<b>SERRATURE PORTONCINO DA APPLICARE</b> <i>RIM LOCKS</i>	<b>pag. 43</b>
<b>08</b>	<b>SPIONCINI E SERRATURE SMART</b> <i>DIGITAL DOOR VIEWER AND SMART HANDLE</i>	<b>pag. 47</b>

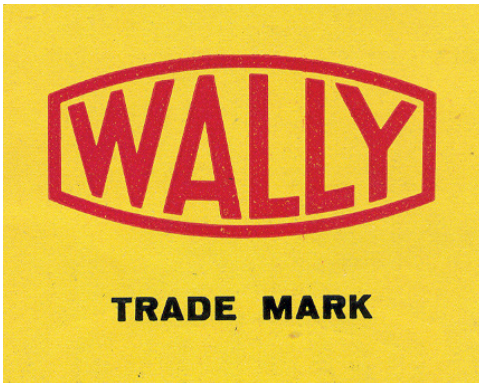

Fondata da Mario Zaina il 27 agosto del 1925, la Società WALLY muove i primi passi della propria attività all'interno di un capannone, attrezzato di pochi macchinari capaci di produrre una vasta varietà di prodotti appartenenti al settore di ferramenta.

Il Core Business dell'azienda nella fase primordiale della produzione riguardava cilindri e serrature di sicurezza con la distinzione di due Brand: WALLY e MZM (acronimo del fondatore).

Nel periodo tra le due Guerre Mondiali la Società consolida la sua posizione ed acquisisce una certa importanza nel mercato italiano riuscendo a dare una svolta decisiva negli anni '50 affacciandosi sul mercato estero.



275	Lucchetto in ottone ad arco <i>Brass padlock</i>	290B	Lucchetto a campana per serrande senza accessori <i>Snail armoured padlock for shutter without accessories</i>
275L	Lucchetto in ottone ad arco lungo <i>Brass padlock long shackle</i>	277	Kit accessori per serrande <i>Accessories for shutters</i>
275EL	Lucchetto in ottone ad arco extralungo <i>Brass padlock</i>	278	Kit accessori per serrande basculanti <i>Accessories for shutters</i>
275M	Lucchetto marino ad arco <i>Marine padlock</i>	273	Lucchetto a doppio perno <i>Security chain padlock</i>
275ML	Lucchetto marino ad arco lungo <i>Marine padlock long shackle</i>	274	Lucchetto a doppio perno <i>Security chain padlock</i>
279	Lucchetto in ottone a combinazione <i>Brass combination padlock</i>	CT	Catena quadra <i>Square chain</i>
279TSA-B	Lucchetto TSA a combinazione <i>TSA combination padlock</i>	WA70828	Catena quadra <i>Square chain</i>
279TSA-N	Lucchetto TSA a combinazione <i>TSA combination padlock</i>	WA82928	Catena quadra <i>Square chain</i>
276	Lucchetto rettangolare <i>Rectangular padlock</i>	WABL	Catena quadra <i>Square chain</i>
284	Lucchetto blindato <i>Armoured padlock</i>	WA80358	Catena quadra <i>Square chain</i>
300	Lucchetto rettangolare monoblocco <i>Heavy duty rectangular padlock</i>	WA20958 WA20368	Catena quadra <i>Square chain</i>
290A	Lucchetto a campana per serrande <i>Snail armoured padlock for shutter</i>	WA22378 WA80978	Catena quadra <i>Square chain</i>
		WAMO	Catena quadra <i>Square chain</i>



## art. 275

### Lucchetto in ottone ad arco

Lucchetto in ottone - arco in acciaio temprato.

#### Brass padlock

Brass padlock - hardened steel shackle

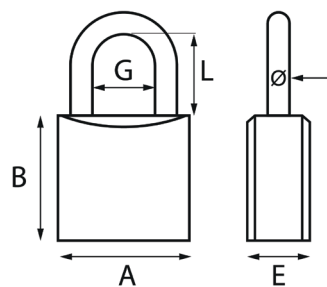
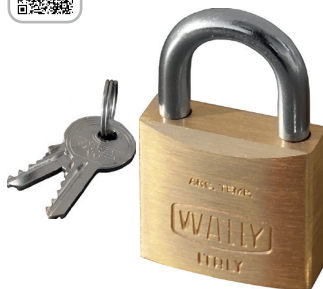

\*4 KA disponibili / available

A	B	E	Ø	L	G	Pz/pcs
15 mm	18	9,5	3	12	9	12
20 mm	20	10	3,5	13,5	10	12
25 mm	24	11	4,3	15,5	13	12
* 30 mm	27	13	5	16	15	12
* 40 mm	32	14	6	22	21	12
* 50 mm	39,5	16	8	25	26	6
60 mm	44,5	18	10	32	32	6
70 mm	48	20	11	37	37	6

## art. 275L

### Lucchetto in ottone ad arco lungo

Lucchetto in ottone - arco lungo in acciaio temprato.

#### Brass padlock long shackle

Brass padlock - hardened steel long shackle

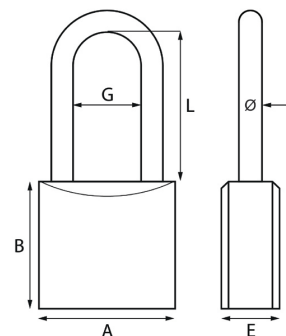

\*2 KA disponibili / available

A	B	E	Ø	L	G	Pz/pcs
* 30 mm	27	13	5	32	16,5	6
* 40 mm	32	14	6	41	22,5	6
* 50 mm	39,5	16	8	49	28	6

## art. 275EL

### Lucchetto in ottone ad arco extra lungo

Lucchetto in ottone - arco extra lungo in acciaio temprato.

#### Brass padlock

Brass padlock - hardened steel extra long shackle

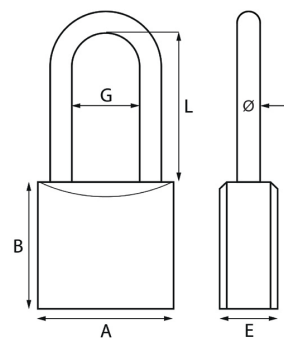

A	B	E	Ø	L	G	Pz/pcs
30 mm	30	27	5	60	16,5	6
40 mm	40	32	6	63	22,5	6
50 mm	50	39,5	8	80	28	6

## art. 275M

### Lucchetto marino ad arco

Lucchetto in ottone cromato - arco in acciaio inossidabile

#### Marine padlock

Brass chrome padlock - stainless steel shackle

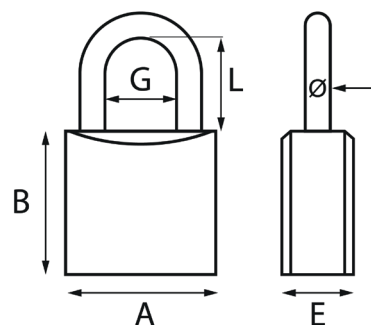

\*2 KA disponibili / available

A	B	E	Ø	L	G	Pz/pcs
* 30 mm	27	13	5	16	15	12
* 40 mm	32	14	6	22	21	12
* 50 mm	39,5	16	8	25	26	6

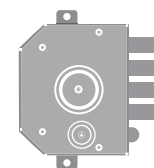



## art. 275ML

### Lucchetto marino ad arco lungo

Lucchetto in ottone cromato - arco lungo in acciaio inossidabile

### Marine padlock long shackle

Brass chrome padlock - stainless steel long shackle

\*1 KA disponibili / available

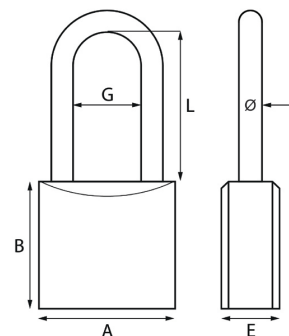

	A	B	E	Ø	L	G	Pz/pcs
*	30 mm	27	13	5	32	16,5	12
*	40 mm	32	14	6	41	22,5	6
*	50 mm	39,5	16	8	49	26	6

## art. 279

### Lucchetto in ottone a combinazione

Lucchetto in ottone - arco in acciaio temprato.

### Brass combination padlock

Brass padlock - steel shackle tempered

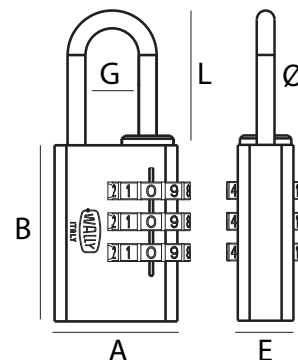

	A	B	E	Ø	L	G	Pz/pcs
	21 mm	29	9,4	3	23,4	9	12
	28 mm	41,5	10,5	5	30,7	12,7	12

## art. 279TSA-BL

### Lucchetto TSA a combinazione

Lucchetto in zama - cavo in acciaio - combinazione a 3 pomelli

### TSA combination padlock

Zinc alloy body - steel cable - 3 combination

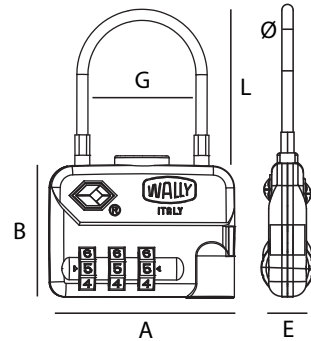

A	B	E	Ø	L	G	Pz/pcs
50 mm	35,6	14	3	42	32	12

## art. 279TSA-NE

### Lucchetto TSA a combinazione

Lucchetto in zama - arco in acciaio - combinazione a 4 pomelli

### TSA combination padlock

Zinc alloy body - steel shackle 4 combination

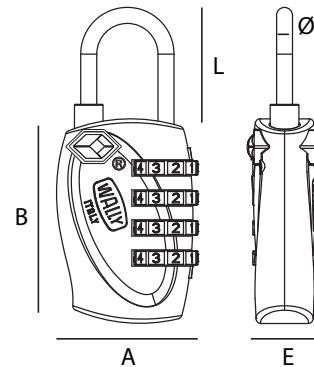

A	B	E	Ø	L	G	Pz/pcs
30,6 mm	45	12,9	3,5	24,5	11	12

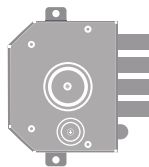
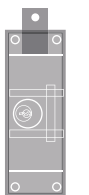
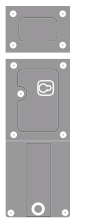



## art. 276

### Lucchetto rettangolare

Lucchetto rettangolare di sicurezza  
- corpo in ottone - 2 chiavi

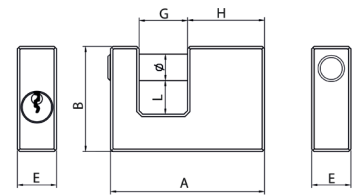

Chiavi grezze disponibili

### Rectangular padlock

Brass padlock - close-latch in  
hardened steel - 2 steel



Blank keys available

A	B	E	Ø	L	G	Pz/pcs
50 mm	37	15	8	13,2	15,5	6
60 mm	44	16	10	15	20,5	6
70 mm	48	18	12	14,3	22	6
90 mm	60	18	12	19,3	36	6

## art. 284

### Lucchetto blindato

Corpo in ottone satinato - corazza  
e piastre laterali antitrapano in  
acciaio temprato, nichelate e cro-  
mate - molle in acciaio inossidabi-  
le e bronzo fosforoso - paletto  
di chiusura in acciaio temperato,  
nichelato e cromato - 2 chiavi

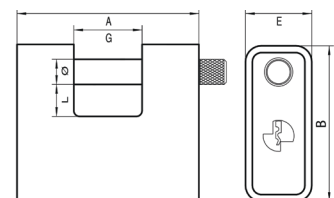

Chiavi grezze disponibili

### Armoured padlock

Brass padlock - cover in  
hardened steel - close-latch in  
hardened steel



Blank keys available

\*1 KA disponibili / available

A	B	E	Ø	L	G	Pz/pcs
60 mm	55	25	10	10,9	23	6
* 80 mm	68	29	11	14	30	6
* 90 mm	75	30	12	17	36	6

## art. 300

### Lucchetto rettangolare monoblocco

Corpo in acciaio temprato -  
paletto in acciaio temprato - 5  
chiavi punzonate

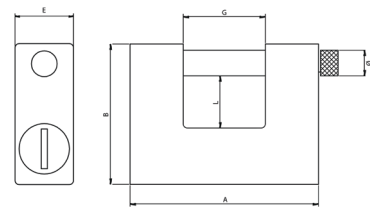

Chiavi grezze disponibili

### Heavy duty rectangular padlock

Steel hardened padlock - clo-  
se-latch in hardened steel - 5 keys



Blank keys available

\*2 KA disponibili / available

A	B	E	Ø	L	G	Pz/pcs
84 mm	70	29	12,8	16	36	6
* 94 mm	70	29	12,8	16	41	6

## art. 290A

### Lucchetto a campana per serrande

Corazza in acciaio inox - molle in  
acciaio - 2 chiavi



Pz/pcs: 1 cartone / 1 box

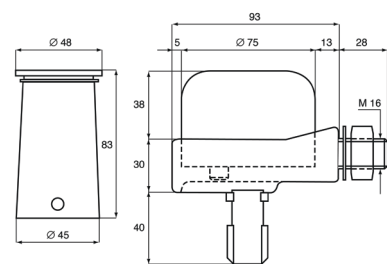

### Snail armoured padlock for shutters

Full coating armour in steel -  
spring in steel - 2 keys

1 KA disponibili / available

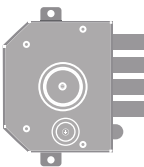
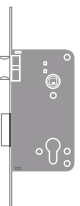



## art. 290B

### Lucchetto a campana per serrande

Corazza in acciaio inox - molle in acciaio - 2 chiavi - senza accessori

### Snail armoured padlock for shutters

Full coating armour in steel - spring in steel - 2 keys - without accessories



Pz/pcs: 1 cartone / 1 box

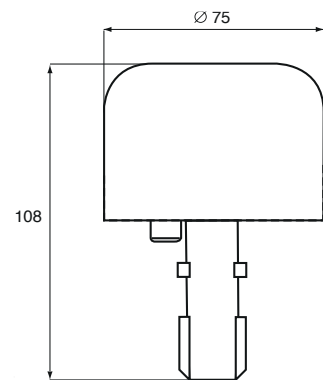

## art. 277

### Kit accessori per serrande

Dispositivo a pavimento per chiusura serrande

### Accessories for shutters



Pz/pcs: 1 cartone / 1 box

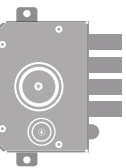
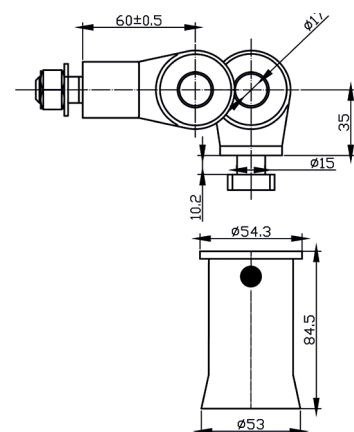



**art. 278****Kit accessori per serrande basculanti**

Dispositivo a pavimento per chiusura serrande

*Accessories for shutters*

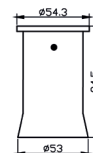
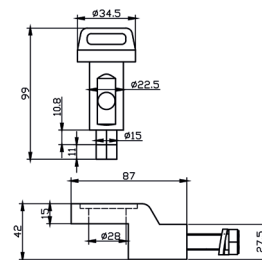

Pz/pcs: 1 cartone / 1 box

**art. 273****Lucchetto a doppio perno corazzato**

Lucchetto in ottone - arco in acciaio temprato.

Chiavi grezze disponibili

**Security chain padlock**

*Double pin padlock for chain - 2 keys*

Blank keys available



Pz/pcs: 6 cartone / 6 box

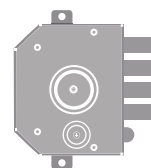
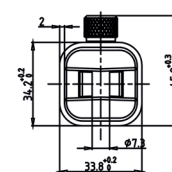
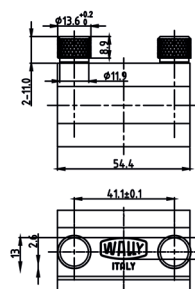



## art. 274

### Lucchetto a doppio perno corazzato

Lucchetto a doppio perno corazzato per catene - 2 chiavi

Chiavi grezze disponibili

### Security chain padlock

Double pin padlock for chain - 2 keys

Blank keys available



Pz/pcs: 6 cartone / 6 box

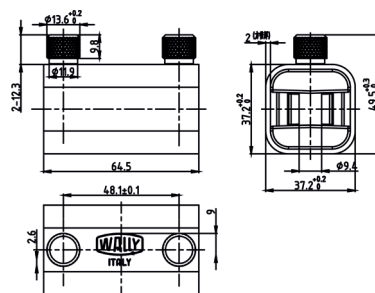

## art. CT

### Catena quadra

Catena quadra cementata rivestita in tessuto

### Square chain

Square chain with textile cover

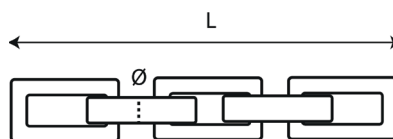

Art.	L	Ø	Pz/pcs
CT10	800 mm	6 mm	1
CT20	800 mm	8 mm	1
CT22	1000 mm	8 mm	1
CT24	1200 mm	8 mm	1
CT26	1500 mm	8 mm	1
CT32	1000 mm	10 mm	1
CT34	1200 mm	10 mm	1
CT36	1500 mm	10 mm	1
CT38	2000 mm	10 mm	1

52	<b>Cilindro staccato da applicare</b> <i>Loose cylinder</i>	64-01	<b>Doppio cilindro ovale per serrature</b> <i>Double cylinder for "narrow" mortice locks</i>
54	<b>Cilindro fisso da applicare</b> <i>Fixed cylinder</i>		
60	<b>Doppio cilindro profilo europeo</b> <i>Double cylinder</i>	64-01-NI	<b>Doppio cilindro ovale</b> <i>Cylinder for "narrow" mortice lock</i>
65	<b>Cilindro con pomolo profilo europeo</b> <i>Cylinder with knob</i>		
70	<b>Doppio cilindro profilo europeo</b> <i>Double cylinder</i>		
73	<b>Mezzo cilindro profilo europeo</b> <i>Half cylinder</i>		
80	<b>Doppio cilindro a profilo europeo</b> <i>European profile double security cylinder</i>		
86	<b>Doppio cilindro di sicurezza con codolo a profilo europeo</b> <i>European profile double security cylinder with brass bar</i>		
83	<b>Mezzo cilindro di sicurezza a profilo europeo</b> <i>Half european profile security cylinder</i>		

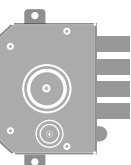
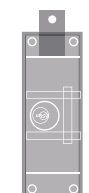
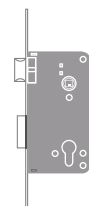
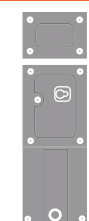

## art. 52

### Cilindro staccato da applicare

In ottone - 3 chiavi 5 spine - lunghezza 70 mm max - viti di fissaggio e piastra d'attacco

### Loose cylinder for rim locks

Loose type - 3 keys 5 pins - length max 70 mm - with rod tie plate and 2 screws



Pz/pcs: 10 cartone / 10 box

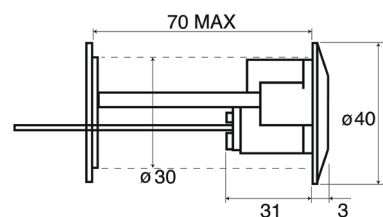

## art. 54

### Cilindro fisso da applicare

In ottone - 3 chiavi 5 spine - viti M4 di fissaggio - canotto in ferro - 4 fori di fissaggio - interasse 14/18 mm. Disponibile anche con sporgenza totale da 60/35 mm.

### Fixed cylinder for rim locks

Fixed type - 3 keys 5 pins - with cylinder spacer and screws

\*1 KA disponibili / available



Pz/pcs: 10 cartone / 10 box

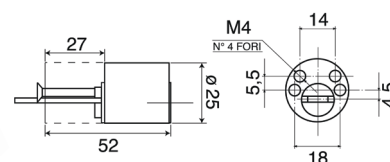

## art. 60

### Doppio cilindro a profilo europeo

In ottone - leva universale - 3 chiavi  
- vite di fissaggio

### European profile double cylinder

With 3 keys and fixing screws

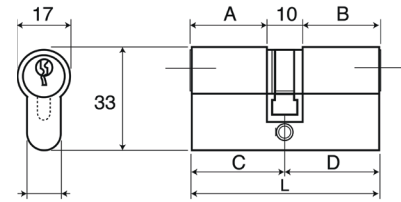

Art	L.mm	A	B	C	D	Leva	Pz/pcs
60-01	54	22	22	27	27	centrale	10
60-02	58	22	26	27	31	spostata	10
60-03	62	26	26	31	31	centrale	10
60-04	68	22	36	27	41	spostata	10
60-05	72	31	31	36	36	centrale	10
60-07	82	36	36	41	41	centrale	10
60-10	72	26	36	27	41	centrale	10
60-12	92	36	46	41	51	spostata	10
60-20	82	26	46	27	51	spostata	10
60-22	102	46	46	51	51	centrale	10
60-50	112	26	76	31	81	spostata	10
60-90	92	41	41	46	46	centrale	10

## art. 65

### Cilindro con pomolo a profilo europeo

In ottone - 3 chiavi profilo paracentrico sinistro - vite di fissaggio

### European profile cylinder with knob

Inside knob - 3 keys - with fixing screw

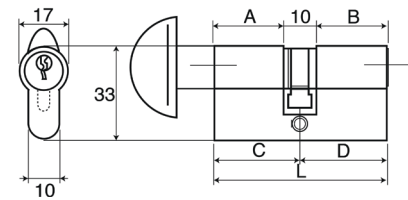

Art	L.mm	A	B	C	D	Posizione pomolo	Pz/pcs
65-02	54	26	22	31	27	lunga	10
65-04	62	26	26	31	31	-	10
65-08	72	26	36	31	41	corta	10
65-11	82	36	36	41	41	-	10
65-12	82	26	46	31	51	corta	10
65-13	82	46	26	52	31	lunga	10
65-20	102	46	46	51	51	-	10
65-21	72	31	31	36	36	-	10
65-22	92	56	26	61	31	lunga	10
65-22	102	56	36	61	41	lunga	10
65-28	82	41	31	46	36	lunga	10
65-30	92	41	41	46	46	-	10
65-31	87	46	31	51	36	lunga	10
65-34	95	35	50	40	55	corta	10

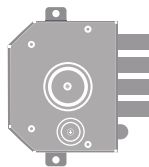

**art. 70****Doppio cilindro a profilo europeo**

In ottone nichelato - leva universale  
- 5 chiavi europee - 7 spine - vite di fissaggio

**European profile double cylinder**

Satin nickel brass body - universal cam - 5 european keys - 7 pins - fixing screw

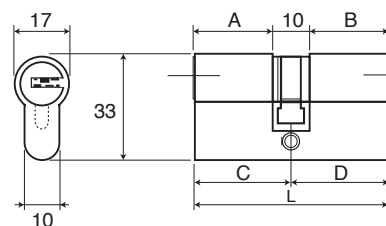

Art	Lmm	A	B	C	D	Leva	Pz/pcs
70-3030-NI	60	25	25	30	30	centrale	10
703040-NI	70	35	35	30	40	spostata	10
703050-NI	80	25	45	30	50	spostata	10
703060-NI	90	25	55	30	60	spostata	10
703070-NI	100	25	65	30	70	spostata	10
703535-NI	70	30	30	35	35	centrale	10
703545-NI	80	30	40	35	45	spostata	10
704040-NI	80	35	35	40	40	centrale	10
704050-NI	90	35	45	40	50	spostata	10
704080-NI	120	35	75	40	80	spostata	10
704575-NI	120	40	70	45	75	spostata	10

**art. 73****Mezzo cilindro a profilo europeo**

In ottone nichelato - leva universale  
- 5 chiavi europee - 7 spine - vite di fissaggio

**Half european profile cylinder**

Satin nickel brass body - universal cam - 5 european keys - 7 pins - fixin screw

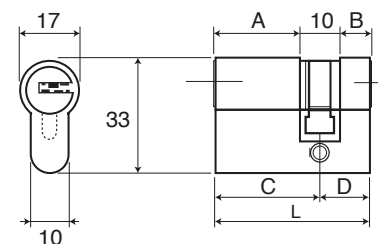

**\*1 KA disponibili / available**

	Art	Lmm	A	B	C	D	Pz/pcs
*	73-3010-NI	40	25	5	30	10	10
*	73-4010-NI	50	35	5	40	10	10

## art. 80

### Doppio cilindro a profilo europeo

In ottone cromato satinato - leva universale - 5 chiavi europee e 1 da cantiere - 10 spine - protezione antitrapano e anti taglio - vite di fissaggio

### European profile double security cylinder

Satin chrome brass - universal cam - 5 european keys + 1 construction keys - 10 pins - anti brake - anti drill protection - fixing screw

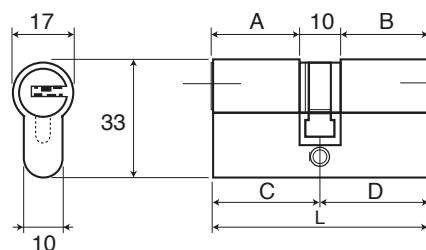

\*1 KA disponibili / available

	Art	L.mm	A	B	C	D	Leva	Pz/pcs
*	80-3030-NI	60	25	25	30	30	centrale	10
*	80-3530-NI	65	30	25	35	30	spostata	10
*	80-3040-NI	70	25	35	30	40	spostata	10
	80-3035-NI	70	30	30	35	35	centrale	10
	80-3045-NI	75	25	40	30	45	spostata	10
	80-3540-NI	75	30	35	35	40	spostata	10
*	80-3050-NI	80	25	45	30	50	spostata	10
	80-3545-NI	80	30	40	35	45	spostata	10
	80-4040-NI	85	35	35	40	40	centrale	10
	80-3550-NI	85	30	45	35	50	spostata	10
	80-4045-NI	85	35	40	40	45	spostata	10
*	80-3060-NI	90	35	55	30	60	spostata	10
	80-3555-NI	90	30	50	35	55	spostata	10
*	80-4050-NI	90	35	45	40	50	spostata	10
	80-4545-NI	90	40	40	45	45	centrale	10
	80-3560-NI	95	30	55	35	60	spostata	10
*	80-4550-NI	95	40	45	45	50	spostata	10
	80-3070-NI	100	25	65	30	70	spostata	10
	80-4060-NI	100	35	55	40	60	spostata	10
	80-4555-NI	100	40	50	45	55	spostata	10
	80-5050-NI	100	45	45	50	50	centrale	10
	80-6045-NI	105	55	40	60	45	spostata	10
	80-4070-NI	110	35	65	40	70	spostata	10
	80-4565-NI	110	40	60	45	65	spostata	10
*	80-5060-NI	110	45	55	50	60	spostata	10
	80-6045-NI	110	50	50	55	55	centrale	10
	80-5070-NI	120	45	65	50	70	spostata	10
	80-6060-NI	120	55	55	60	60	centrale	10
	80-5075-NI	125	45	70	50	75	spostata	10

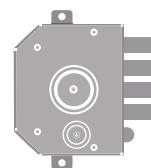
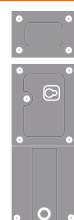



**art. 86****Doppio cilindro di sicurezza con codolo a profilo europeo**

In ottone cromato satinato - leva universale - 5 chiavi europee e 1 da cantiere - 10 spine - protezione anti-trapano e anti taglio - vite di fissaggio

**European profile double security cylinder with brass bar**

Satin chrome brass - universal cam - 5 european keys + 1 construction keys - 10 pins - anti brake - anti drill protection - fixing screw

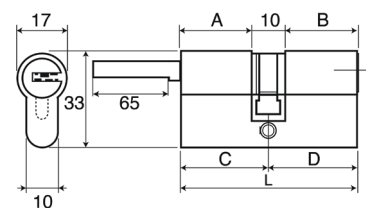

Art	L.mm	A	B	C	D	Leva	Pz/pcs
86-3030-NI	60	25	25	30	30	centrale	10
86-3040-NI	70	25	35	30	40	spostata	10
86-3035-NI	65	25	30	30	35	spostata	10
86-3045-NI	75	25	40	30	45	spostata	10
86-3050-NI	80	25	45	30	50	spostata	10
86-3060-NI	90	25	55	30	60	spostata	10

**art. 83****Mezzo cilindro di sicurezza a profilo europeo**

In ottone nichelato - leva universale - 5 chiavi europee 1 chiave cantiere - 10 spine - protezione antitrapano e anti taglio

**Half european profile security cylinder**

Satin nickel brass body - universal cam - 5 european keys - 10 pins - anti brake - anti drill protection

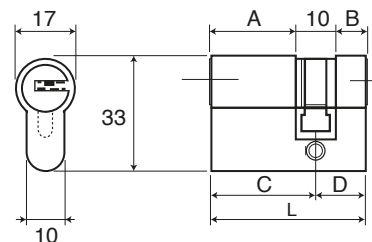

\*1 KA disponibili / available

Art	L.mm	A	B	C	D	Pz/pcs
* 83-2510-NI	35	20	5	25	10	10
* 83-3010-NI	40	25	5	30	10	10
83-3510-NI	45	30	5	35	10	10
83-4010-NI	50	35	5	40	10	10
83-4510-NI	55	40	5	45	10	10
83-5510-NI	65	50	5	55	10	10
83-6010-NI	70	55	5	60	10	10
83-7010-NI	80	65	5	70	10	10



**art. 64-01****Cilindro profilo ovale**

In ottone - 3 chiavi - vite di fissaggio

**Cylinder for "Narrow" mortice locks**

Brass oval cylinder - with 3 keys and fixing screw - universal cam

1 KA disponibili / available

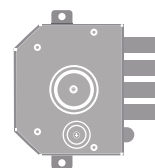
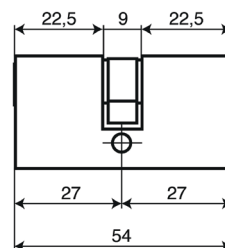
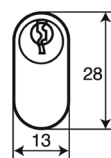

Pz/pcs: 10 cartone / 10 box

**art. 64-01-NI****Cilindro nichelato a profilo ovale**

In ottone nichelato - 3 chiavi - vite di fissaggio

**Cylinder for "Narrow" mortice locks**

Nikel brass oval cylinder - with 3 keys and fixing screw - universal cam

1 KA disponibili / available



Pz/pcs: 10 cartone / 10 box

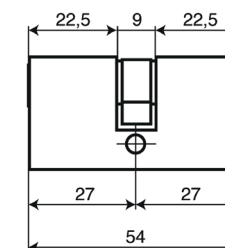
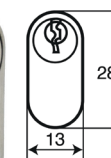



## RIM PLATE LOCKS

270A **Ferroglietto**  
*Rim plate deadlock*

270B **Ferroglietto**  
*Rim plate deadlock*

270A-BIS **Ferroglietto**  
*Rim plate deadlock*

270B-BIS **Ferroglietto**  
*Rim plate deadlock*

281A **Ferroglietto con  
catenaccio a scrocco**  
*Rim plate lock with separate  
drawback*

281B **Ferroglietto con  
catenaccio a scrocco**  
*Rim plate lock with separate  
drawback*

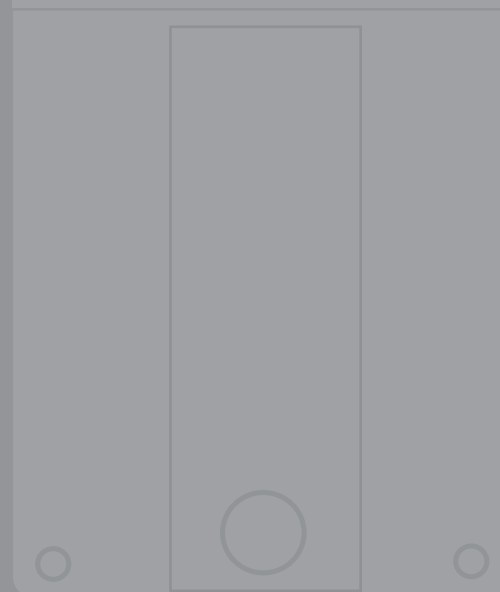
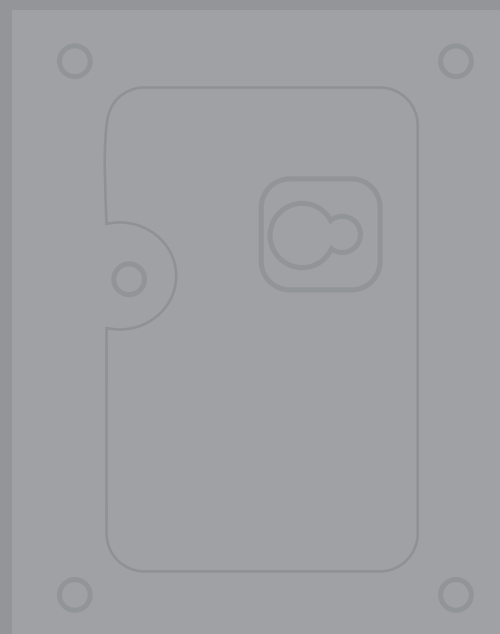
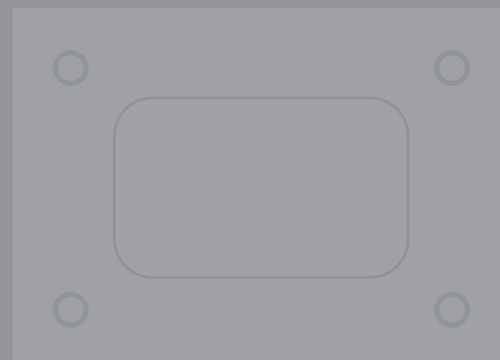



## art. 270A

### Ferroglietto

Cilindro esterno fisso - 3 chiavi - 6 giri - mano destra - finitura scatola verniciata

### Rim plate deadlock

Outside cylinder - 3 keys - 6 throws - right hand - fixed cylinder - painted finish

\*1 KA disponibili / available

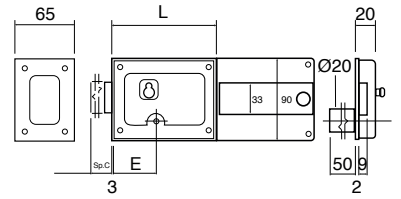
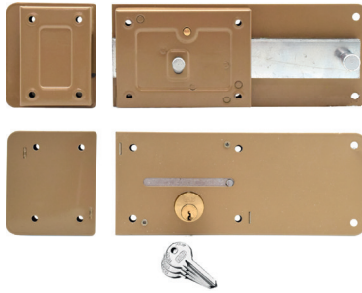

	Giri/Turns	Entrata/In	L	Sp. C.	Pz/pcs
*	6	40 - 50 - 60 - 70	220	72	2

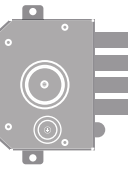
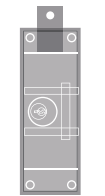
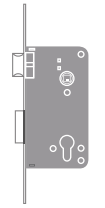

## art. 270B

### Ferroglietto

Cilindro esterno - 3 chiavi - 6 giri - mano destra - finitura scatola verniciata

### Rim plate deadlock

Outside cylinder - 3 keys - 6 throws - painted finish

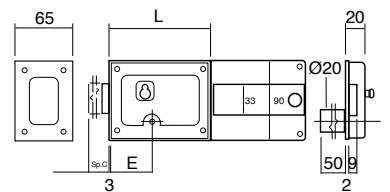
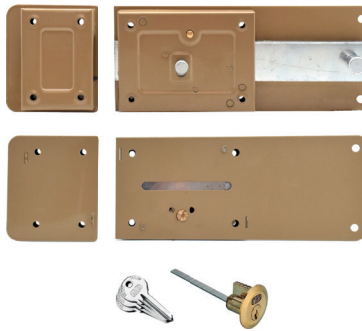

	Giri/Turns	Entrata/In	L	Sp. C.	Pz/pcs
	6	40 - 50 - 60 - 70	220	72	2

## art. 270A/BIS

### Ferroglietto

Cilindro esterno fisso - 3 chiavi  
- 5½ giri - mano destra - finitura  
scatola verniciata

### Rim plate deadlock

Outside cylinder - 3 keys - 5½  
throws - right hand - fixed cylinder  
- painted finish

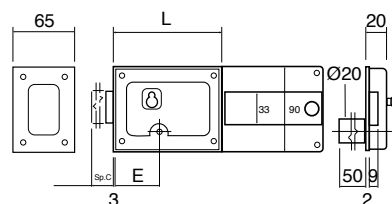

\*1 KA disponibili / available

Giri/Turns	Entrata/In	L	Sp. C.	Pz/pcs
5½	40 - 50 - 60 - 70	220	72	2

## art. 270B/BIS

### Ferroglietto

Cilindro esterno - 3 chiavi - 5½  
giri - mano destra - finitura  
scatola verniciata

### Loose cylinder for rim

Outside cylinder - 3 keys - 5½  
throws - right hand - loose cylinder  
- painted finish

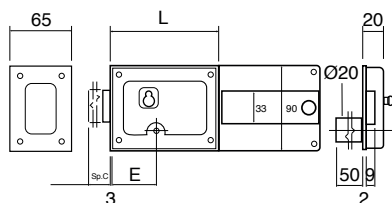

Giri/Turns	Entrata/In	L	Sp. C.	Pz/pcs
5½	40 - 50 - 60 - 70	220	72	2

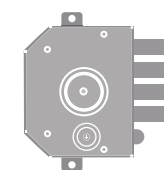
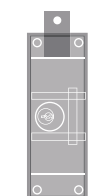
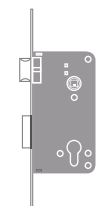
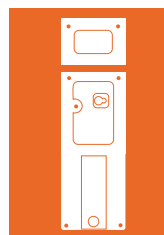

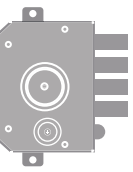
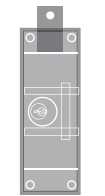
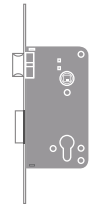
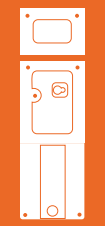

## art. 281A

### Ferroglietto con catenaccio a scrocco

Cilindro esterno fisso - 3 chiavi - 6 giri - mano destra - finitura scatola verniciata

### Rim plate lock with separate drawback

Outside cylinder - 3 keys - 6 throws - right hand - fixed cylinder - painted finish

\*1 KA disponibili / available

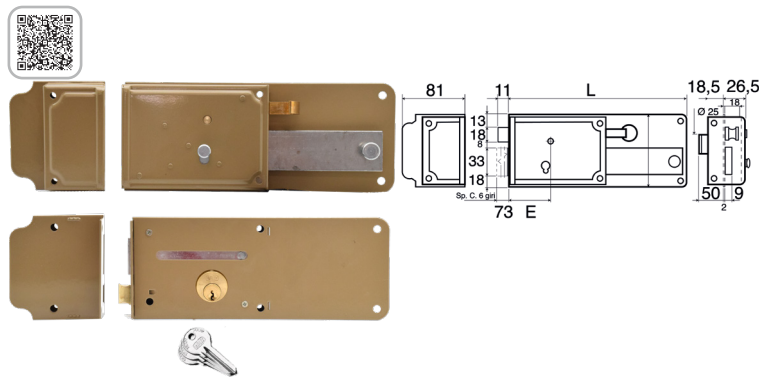

	Giri/Turns	Entrata/In	L	Sp. C.	Pz/pcs
*	6	40 - 50 - 60 - 70	220	72	2

## art. 281B

### Ferroglietto con catenaccio a scrocco

Cilindro esterno - 3 chiavi - 6 giri - mano destra - cilindro esterno staccato - finitura scatola verniciata

### Rim plate lock with separate drawback

Outside cylinder - 3 keys - 6 throws - right hand - loose cylinder - painted finish

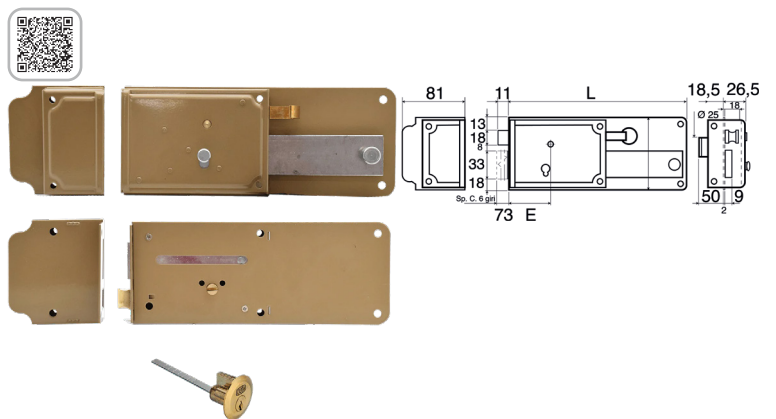

	Giri/Turns	Entrata/In	L	Sp. C.	Pz/pcs
	6	40 - 50 - 70	220	72	2

## MORTICE LOCKS

- 262 Serratura da infilare con scrocco  
*Mortice lock*
- 263 Serratura da infilare con solo catenaccio  
*Cylinder mortice deadlock*
- W362 Serratura per alluminio con scrocco  
*Alluminium mortice lock with latch*
- W462 Serratura per alluminio con rullo  
*Alluminium mortice lock with roller latch*



**art. 262BQ****Serratura da infilare  
con scrocco e mandata**

Scatola zincata - serratura da infilare - 2 giri e mezzo - scrocco reversibile, azionato anche dalla chiave - quadro maniglia 8 mm - interasse 85 mm - catenaccio in zama - frontale ottonato bordo quadro

**Cylinder mortice lock**

Zinc plated steel case - zama latch and bolt - double and half throws dead-bolt - reversible latch - brass plated front - hub 8 mm

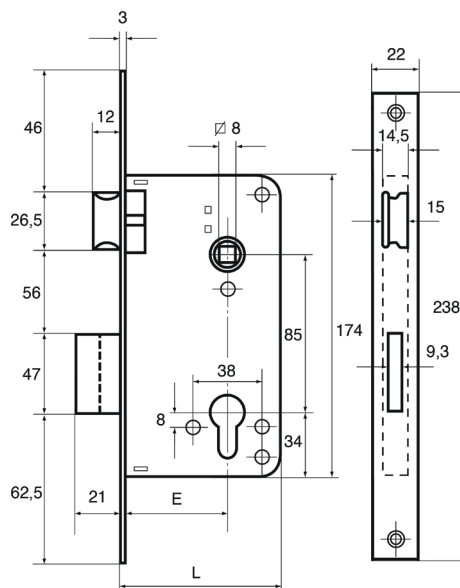

Entrata/In	35	40	45	50	60
L	70	29	12,8	16	36
Pz/pcs	1	1	1	1	1

**art. 262BT****Serratura da infilare  
con scrocco e mandata**

Scatola zincata - 2 giri e mezzo - scrocco reversibile, azionato anche dalla chiave - quadro maniglia 8 mm - interasse 85 mm - catenaccio in zama - frontale ottonato bordo tondo

**Cylinder mortice lock**

Zinc plated steel case - zamak latch and bolt - double and half throws dead-bolt - reversible latch - brass plated front - hub 8 mm

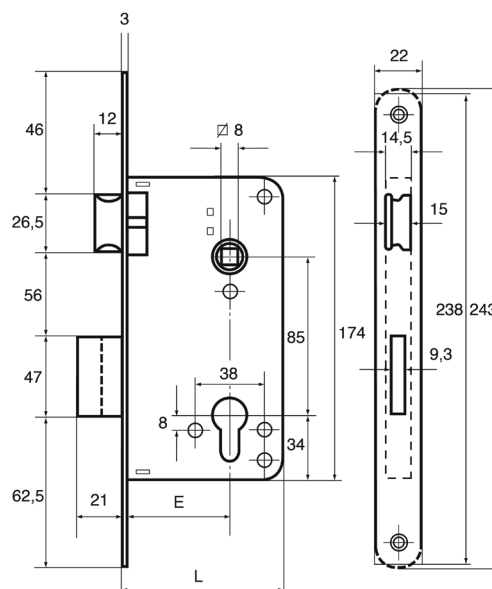

Entrata/In	35	40	45	50	60
L	70	29	12,8	16	36
Pz/pcs	1	1	1	1	1



## art. 263

### Serratura solo catenaccio

Catenaccio da infilare - 2 girp - frontale e contropiastra bordo quadro - finitura oro lucido

### Cylinder mortice deadlock

Brass plated iron front - double throws dead-bolt - dichromated flat striking plate - cylinder art. 60 - polished gold finish



Pz/pcs: 1 cartone / 1 box

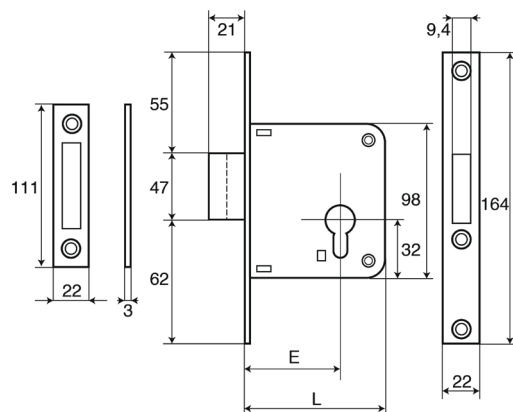

Entrata/In	35	40	45	50	60	70
L	62	67	72	77	87	97
Pz/pcs	1	1	1	1	1	1



## art. W362

### Serratura per alluminio con scrocco

Scatola zincata - 1 giro e mezzo - scrocco reversibile azionabile anche dalla chiave - quadro maniglia 8 mm - interasse 85 mm - contropiastra con spessore 1 mm - entrata 20 - 25 - 30 - 35 mm - lunghezza 35 mm

### Alluminium mortice lock with latch

Zinc plated steel case - one and half throws dead-bolt - handle hub 8 mm - strike thickness 1 mm - in 20 - 25 - 30 - 35 mm - lenght 35 mm



Pz/pcs: 1 cartone / 1 box

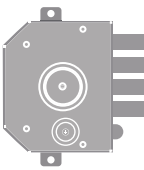
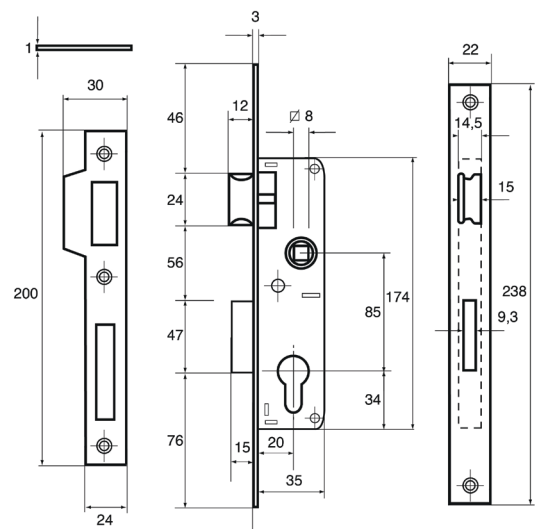

**art. W462****Serratura per alluminio  
con rullo**

Scatola zincata - 1 giro con rullo -  
quadro maniglia 8 mm - interasse  
85 mm - contropiastra con spes-  
sore 1 mm - entrata 20 - 25 - 30  
- 35 mm - lunghezza 35 mm

***Alluminium mortice  
lock with roller latch***

*Zinc plated steel case - one and  
half throws dead-bolt - handle  
hub 8 mm - strike thickness 1 mm  
- in 20 - 25 - 30 - 35 mm - lenght  
35 mm*



Pz/pcs: 1 cartone / 1 box

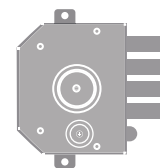
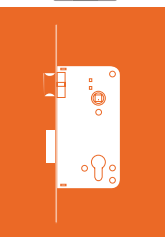
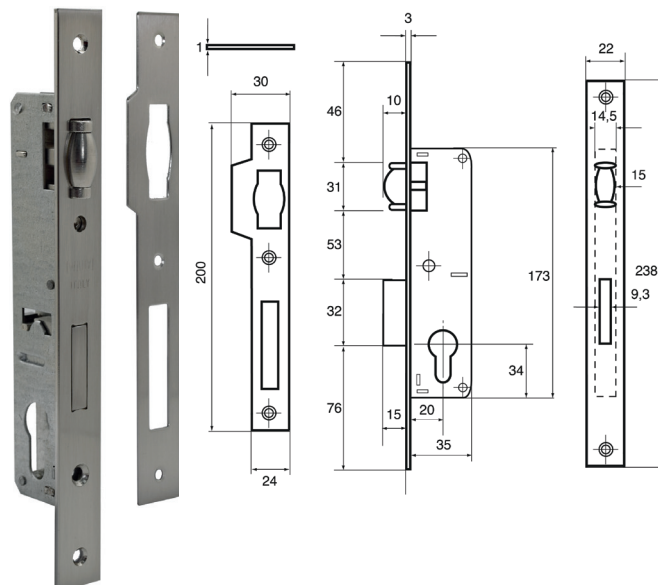

## SHUTTER CYLINDER LOKCS

- 288      **Serrature da serranda centrale**  
*Cylinder central lock for shutter*
  
- 288-P    **Serrature da serranda centrale catenaccio piegato**  
*Cylinder central lock for shutter with curved bolt*
  
- 289CP    **Serrature da serranda laterale**  
*Cylinder lateral lock for shutter*
  
- 289CP-P   **Serratura da serranda laterale con catenaccio piegato**  
*Cylinder lateral lock for shutter with curved bolt*
  
- 291CP    **Serrature da serranda laterale coppia**  
*Cylinder lateral lock for shutter*

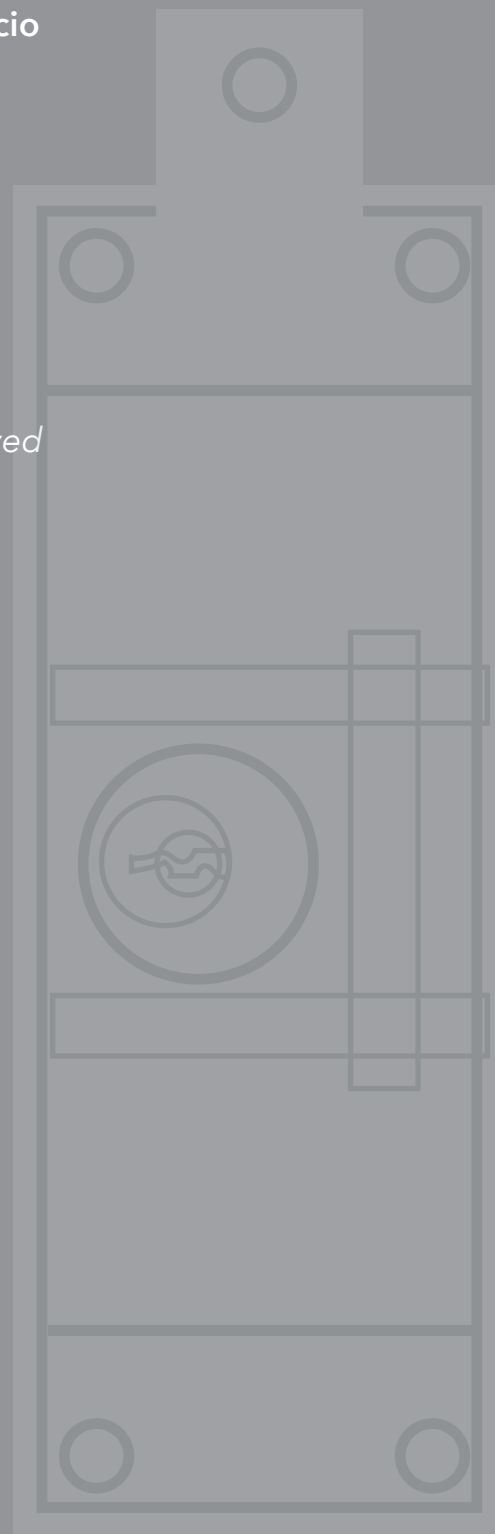

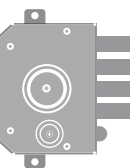
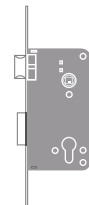
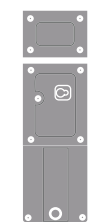

## art. 288

### Serratura da serranda centrale

Cilindro esterno - doppio catenaccio  
- 2 chiavi profilo simmetrico - 2 giri -  
finitura zincata

### Cylinder central lock for shutter

Double bolt - 2 keys symmetric  
profile, 5 pins - 2 throws - galvani-  
zed finish



Pz/pcs: 2 cartone / 2 box

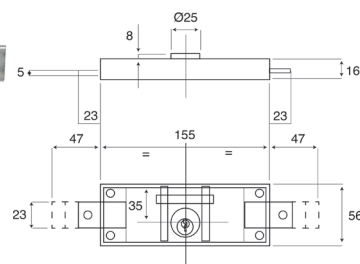

## art. 288-P

### Serratura da serranda centrale catenaccio piegato

Cilindro esterno - doppio cate-  
naccio - 2 chiavi profilo  
simmetrico - catenaccio piegato - 2  
giri - finitura zincata

### Cylinder central lock for shutter with bent bolt

Double bolt - 2 keys symmetric  
profile, 5 pins - curved bolt - 2  
throws - galvanized finish



Pz/pcs: 2 cartone / 2 box

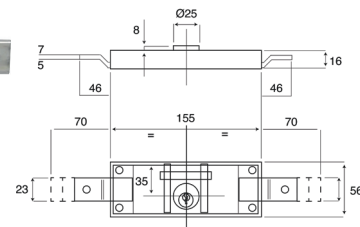

## art. 289

### Serratura da serranda laterale

Cilindro esterno - catenaccio laterale - 2 chiavi profilo simmetrico - 2 giri - finitura zincata

### Cylinder lateral lock for shutter

Long bolt - 2 keys symmetric profile - 2 throws - galvanized finish

**289-DX** catenaccio a destra

**289-SX** catenaccio a sinistra



Pz/pcs: 2 cartone / 2 box

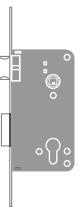
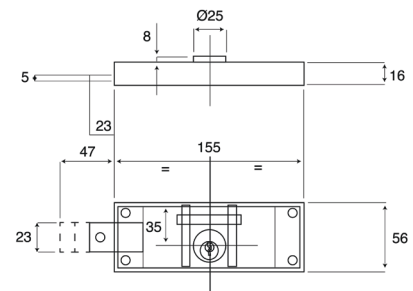

## art. 289CP

### Serratura da serranda laterale accoppiate

Cilindro esterno - catenaccio laterale - coppia dx e sx - 2 chiavi profilo simmetrico - 2 giri - finitura zincata

### Cylinder lateral lock for shutter

Long bolt - 2 keys symmetric profile - 2 throws - galvanized finish shackle



Pz/pcs: 2 cartone / 2 box

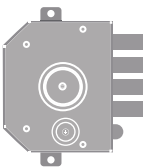
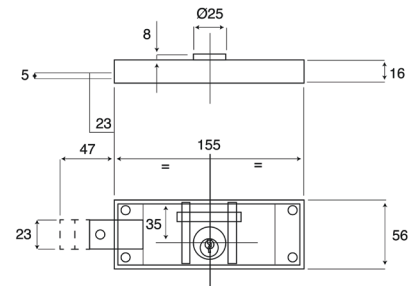

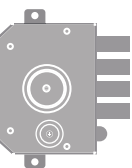
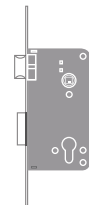
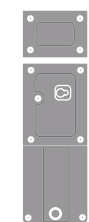

## art. 289P

### Serratura da serranda laterale catenaccio piegato

Cilindro esterno - catenaccio  
laterale piegato - 2 chiavi profilo  
simmetrico - 2 giri - finitura zin-  
cata

#### *Cylinder lateral lock for shutter with bent bolt*

*Long curved bolt - 2 keys symme-  
tric profile - 2 throws - galvanized  
finish*



Pz/pcs: 2 cartone / 2 box

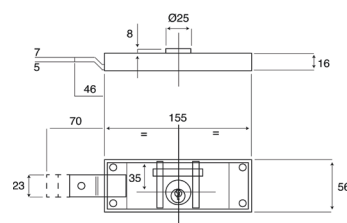

## art. 289CP

### Serratura da serranda laterale catenaccio piegato accppiate

Cilindro esterno - catenaccio  
laterale piegato - coppia dx e sx -  
2 chiavi profilo simmetrico - 2 giri  
- finitura zincata

#### *Cylinder lateral lock for shutter with bent bolt*

*Long curved bolt - 2 keys symme-  
tric profile - 2 throws - galvanized  
finish*



Pz/pcs: 2 cartone / 2 box

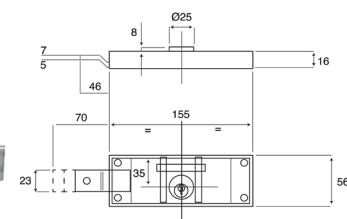

## art. 291CP

### Serratura da serranda laterale accoppiate

Cilindro esterno - coppia dx e sx - catenaccio unico - 2 chiavi - 2 giri - finitura zincata

### Cylinder lateral lock for shutter

Outside cylinder - right and left - long double bolt - 2 keys - 2 throws - galvanized finish

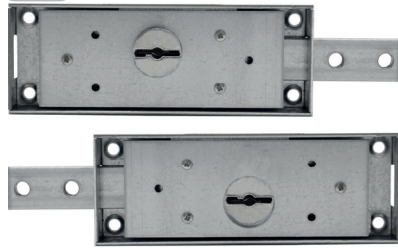

Pz/pcs: 2 cartone / 2 box

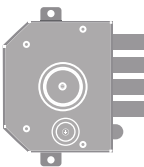
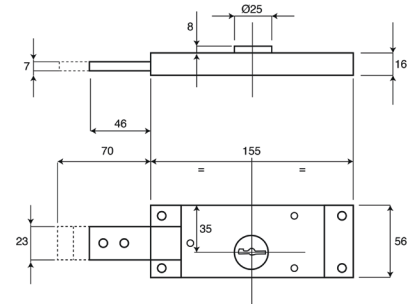





## RIM LOCKS

- B200**      Serratura da applicare laterale  
*Rim dead lock*
- B210**      Serratura da applicare laterale con mezzo giro  
*Rim dead lock*
- B250**      Serratura da applicare laterale con pomolo interno  
*Rim dead lock with knob*
- B260**      Serratura da applicare laterale con mezzo giro  
*Rim dead lock with knob*
- B400**      Serratura da applicare triplice  
*Multi point rim dead lock*
- B410**      Serratura da applicare laterale con mezzo giro  
*Multi point rim dead lock*
- B450**      Serratura da applicare triplice con pomolo interno  
*Multi point rim dead lock with knob*
- B460**      Serratura da applicare triplice con mezzo giro, aste  
e pomolo interno  
*Multi point rim dead lock with knob*
- B710**      Serratura da applicare laterale con mezzo giro  
*Rim dead lock*
- B910**      Serratura da applicare triplice con mezzo giro  
*Multi point rim dead lock*
- B.AS-E**    Aste e accessori per serratura triplice  
*Accessories for Multi point rim dead lock*
- B.CP**      Cilindro a pompa su piastra  
*Cylinder for pump locks*

**art. B200****Serratura da applicare  
laterale**

Serratura da applicare laterale  
con 4 giri e chiave - 3 chiavi  
europee

**Rim dead lock**

Rim dead lock with 4 throws - 3  
european keys

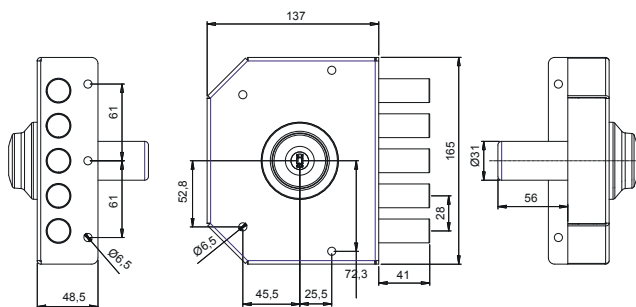
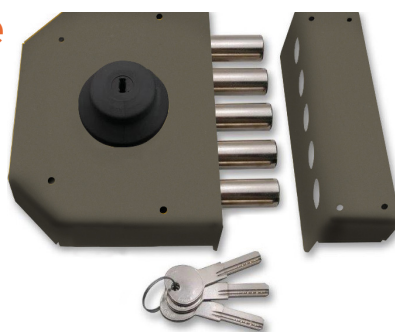

Art.	Dx / Sx	Con aste e accessori	Pz/pcs
B200-60-DX.0	Dx	-	1
B200-60-SX.0	Sx	-	1

**art. B210****Serratura da applicare  
laterale con mezzo giro**

Serratura da applicare laterale  
con 4 giri e mezzo e chiave - 3  
chiavi europee

**Rim dead lock**

Rim dead lock with 4½ throws- 3  
european keys

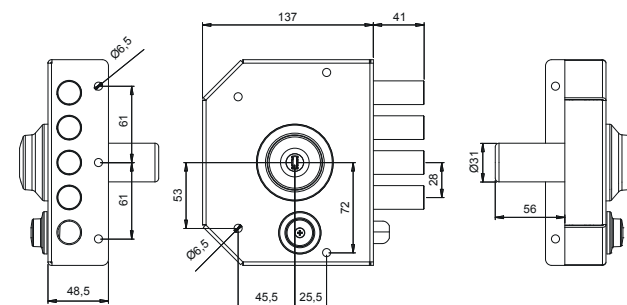

Art.	Dx / Sx	Con aste e accessori	Pz/pcs
B210-60-DX.0	Dx	-	1
B210-60-SX.0	Sx	-	1



**art. B400****Serratura da applicare  
triplice**

Serratura da applicare triplice  
con 4 giri e chiave - 3 chiavi  
europee

**Multi point rim dead  
lock**

*multi point rim dead lock with 4  
throws - 3 european keys*

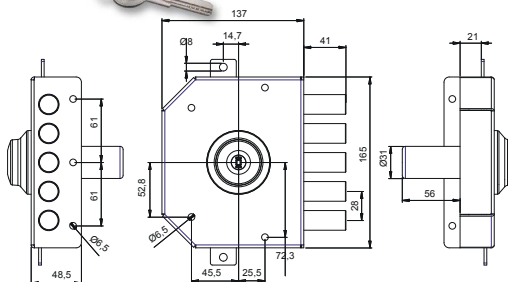
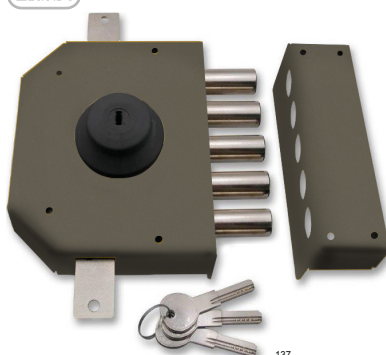

Art.	Dx / Sx	Con aste e accessori	Pz/pcs
B400-60-DX.1	Dx	Sì	1
B400-60-SX.1	Sx	Sì	1
B400-60-DX.0	Dx	No	1
B400-60-SX.0	Sx	No	1

**art. B410****Serratura da applicare  
triplice con mezzo giro**

Serratura da applicare triplice  
con 4 giri e mezzo e chiave - 3  
chiavi europee

**Multi point rim dead  
lock**

*Multi point rim dead lock with 4½  
throws 3 european keys*

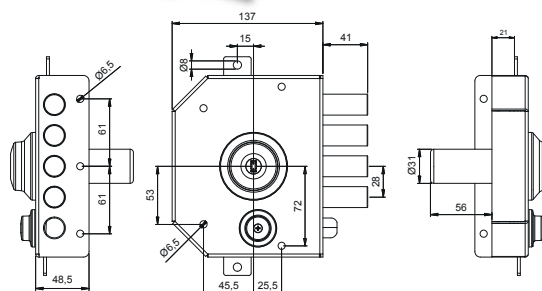
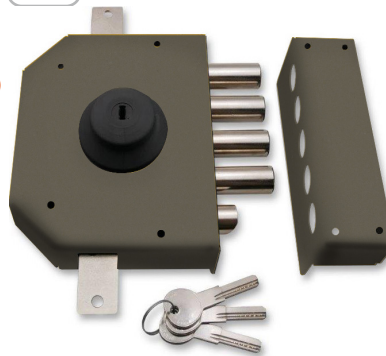

Art.	Dx / Sx	Con aste e accessori	Pz/pcs
B410-60-DX.1	Dx	Sì	1
B410-60-SX.1	Sx	Sì	1
B410-60-DX.0	Dx	No	1
B410-60-SX.0	Sx	No	1

## art. B450

### Serratura da applicare triplice con pomolo interno

Serratura da applicare triplice con pomolo interno - 3 chiavi europee

#### Multi point rim dead lock

Multi point rim dead lock with 4 throws and knob - 3 european keys

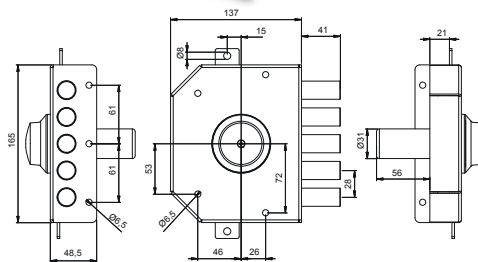
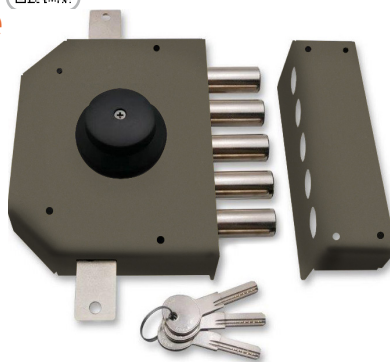

Art.	Dx / Sx	Con aste e accessori	Pz/pcs
B450-60-DX.1	Dx	Sì	1
B450-60-SX.1	Sx	Sì	1
B450-60-DX.0	Dx	No	1
B450-60-SX.0	Sx	No	1

## art. B460

### Serratura da applicare triplice con pomolo interno

Serratura da applicare triplice con pomolo interno - 3 chiavi europee

#### Multi point rim dead lock

Multi point rim dead lock with 4 throws and knob - 3 european keys

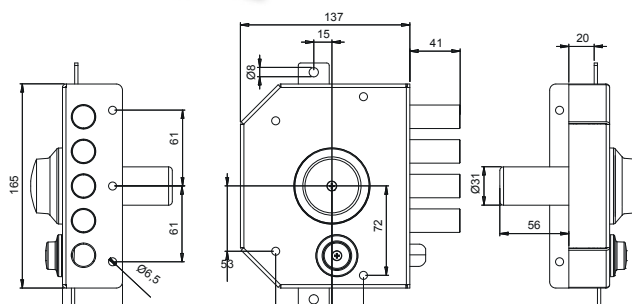

Art.	Dx / Sx	Con aste e accessori	Pz/pcs
B460-60-DX.1	Dx	Sì	1
B460-60-SX.1	Sx	Sì	1

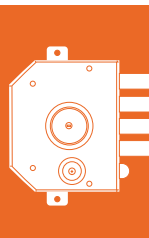



## art. B.AS-E

Set aste e accessori per serratura triplice

*Accessories for Multi point rim dead lock*

Pz/pcs: 1 cartone / 1 box

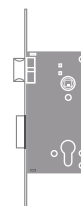
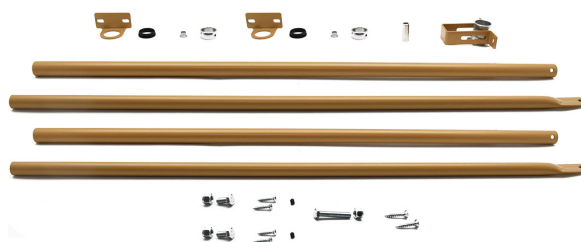

## art. B.CP.

Cilindro a pompa su piastra

*Cylinder for pump lock*

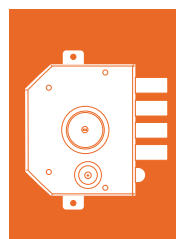
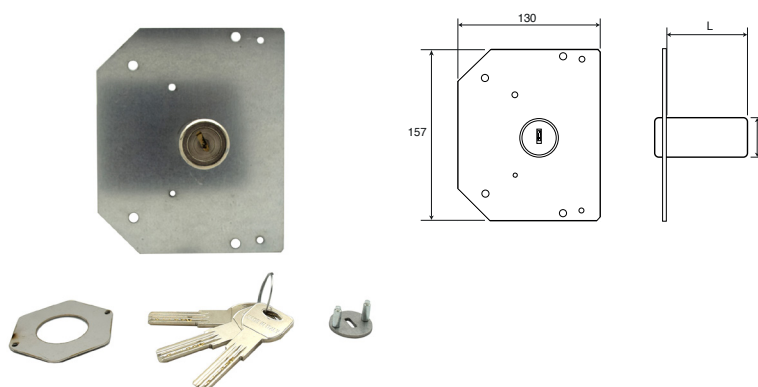

L	Ø	Pz/pcs
60 mm	30	1
70 mm	30	1
80 mm	30	1





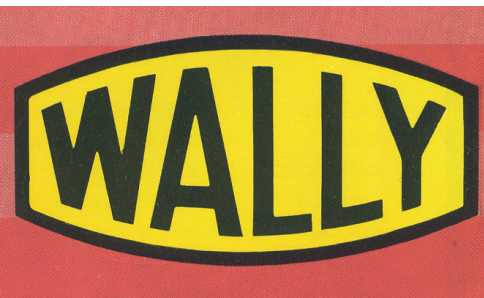
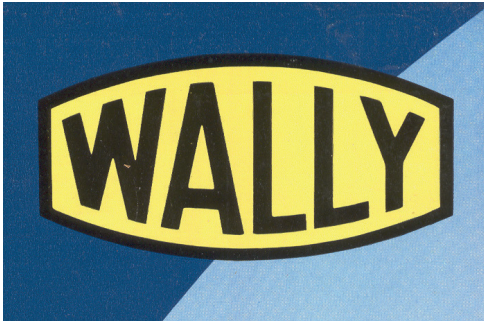

Il marchio WALLY, ormai eccellenza MADE IN ITALY, si evolve rapidamente, l'innovazione delle linee produttive e le spiccate doti imprenditoriali di Ambrogio Zaina portano all'inaugurazione nel 1950 di un nuovo stabilimento a Castelletto di Senago (MI).

Il marchio MZM cessa di esistere lasciando il comando esclusivamente a WALLY.

Attualmente la Società riconosciuta come specialista del settore, vanta una consolidata presenza sul mercato italiano ed estero con prodotti che ancora oggi costituiscono una pietra miliare nel campo delle serrature di sicurezza.

I clienti target sono industrie, società del settore di ferramenta, minuteria metallica e più in generale nella ferramenta.



## RIM LOCKS

- 310ADX Serratura da portoncino  
*Rim lock*
- 330ADX Serratura da portoncino con pomolo  
*Rim lock with knob*
- 330BDX Serratura da portoncino con pomolo  
*Rim lock with knob*
- 600ADX Serratura da portoncino con maniglia  
*Rim lock with handle*
- SE401 Serratura elettrica per portoni con pulsante  
*Electric rim lock with button*



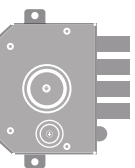
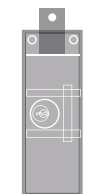
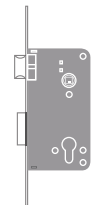
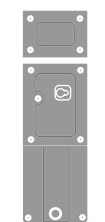

## art. 310ADX

### Serratura da portoncino

Doppio cilindro - 3 chiavi - 3 giri - mano destra - cilindro fisso - finitura verniciata

### Cylinder rim lock

Double cylinder - 3 keys - 3 throws - right hand - painted

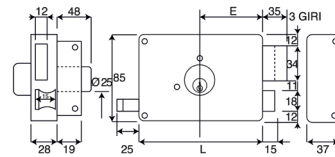

Entrata/In	60	70
L	120	140
Pz/pcs	1	1

## art. 330ADX

### Serratura da portoncino con pomolo

Cilindro esterno - pomolo interno - 3 chiavi - 3 giri - manopola interna - mano destra - cilindro fisso - finitura verniciata

### Rim lock with knob

Outside cylinder - inside knob - 3 keys - right hand - fixed cylinder - painted

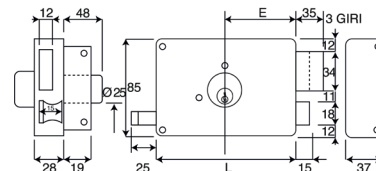

Entrata/In	50	60	70
L	100	120	140
Pz/pcs	1	1	1

## art. 330BDX

### Serratura da portoncino con pomolo

Cilindro esterno - pomolo interno  
 - 3 chiavi a profilo paracentrico - 3 giri - manopola interna - mano destra - cilindro staccato - finitura verniciata

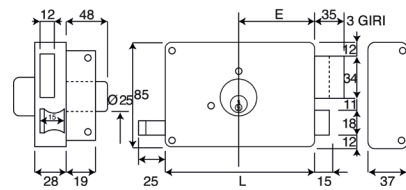

### Rim lock with knob

Outside cylinder - inside knob - 3 keys - right hand - loose cylinder - painted

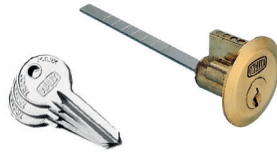

Entrata/In	50	60	70
L	100	120	140
Pz/pcs	1	1	1

## art. 600ADX

### Serratura da portoncino con maniglia

Doppi cilindro - 3 chiavi - mano destra - finitura verniciata - quadro maniglia 8mm

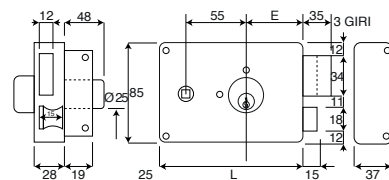

### Rim lock with handle

Doble cylinder - 3 keys - right hand - painted finiture hub 8 mm



Entrata/In	50	60
Giri/Tums	2	3
L	140	140
Pz/pcs	1	1

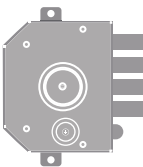
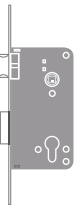

**art. SE401****Serratura elettrica per  
portoni con pulsante**

Cilindro interno con pulsante -  
entrata 60 mm - 3 chiavi - 2 giri  
- serratura destra - cilindro fisso -  
finitura verniciata nera

**Electric rim lock with  
button**

Double cylinder with button - in  
60 mm - 3 keys - 2 throws - right  
hand - fixed cylinder - black painted



Pz/pcs: 1 cartone / 1 box

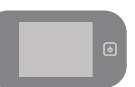
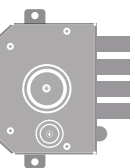
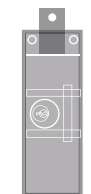
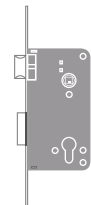
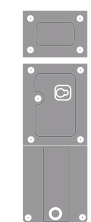
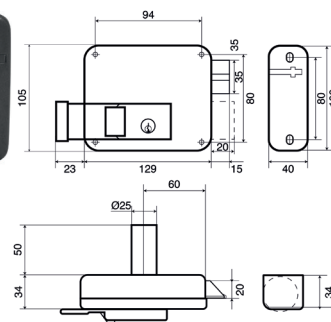

## DIGITAL DOOR VIEWER SMART HANDLE

- SP01      **Spioncino digitale**  
*Digital door viewer*
- SP02      **Spioncino digitale**  
*Digital door viewer*
- SP03      **Spioncino digitale smart**  
*Digital smart door viewer*
- MA01      **Maniglia smart**  
*Smart handle*

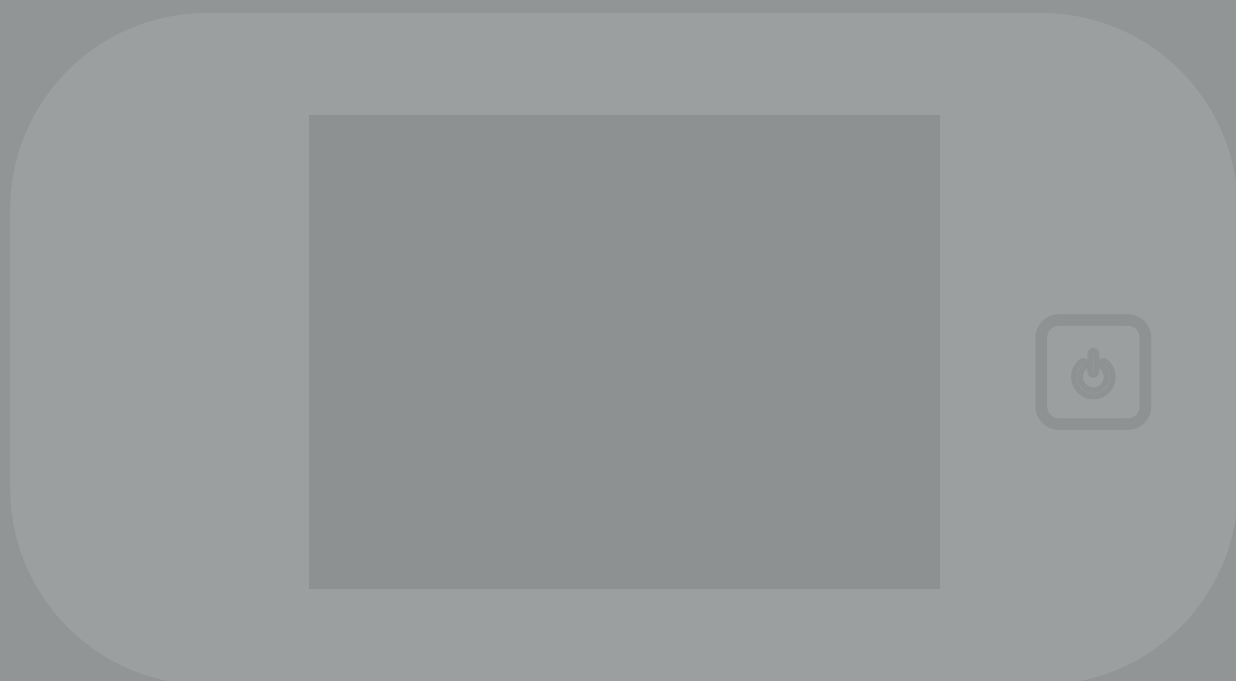

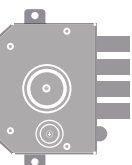
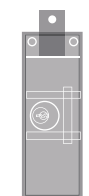
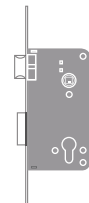
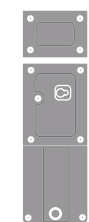

## art. SP01

### Spioncino digitale

Per porte con spessore da 38 a 110 mm - foro porta Ø 14 mm - sensore 0,3 Mega Pixel CMOS - schermo LCD 3,2" TFT - risoluzione LCD 320x240 - angolo di visuale 105° - alimentazione a batterie AAA.

Colori disponibili: argento, bianco e oro

### Digital door viewer

Thickness door 38 - 110 mm - fits barrel hole 14 mm - sensor 0,3 Mega Pixel CMOS - LCD screen 3,2" TFT - LCD resolution 320x240 - view angle 105 degree - power AAA batteries.

Colors: silver, white and gold

## art. SP02

### Spioncino digitale

Per porte con spessore da 38 a 110 mm - foro porta Ø 14 - 26 mm - schermo LCD 3,5" TFT - suoneria polifonica - visione notturna ad infrarossi - funzione auto scatto e registrazione video - registro visitatori - supporto scheda di memoria microSD (fino a 32 GB) - alimentazione a batterie AA.

### Digital door viewer

Thickness door 38 - 110 mm - fits barrel hole 14 - 26 mm - polyphonic ringtones - infrared night vision - automatic A/V recording - enquiry for visitors record - support TF card (Up to 32 GB) - power AA batteries



## art. SP03

### Spioncino digitale smart



Schermo LCD 2,8"HD - sensore da 1,0 Mega Pixel CMOS (720P) - per porte di spessore da 32 - 104 mm - foro porta Ø 14 - 35 mm - angolo visuale 134° - alimentazione a batteria integrata da 4300mAh Lithium - visione notturna ad infrarossi - sensore di movimento - chiamate audio/video in remoto - funzione registrazione AV - registro visitatori - controllo remoto da app

### Digital smart door viewer

LCD screen 2,8" HD - sensor 1,0 Mega Pixel CMOS (720P) - thickness door 32-104 mm - Fits barrel hole 14-35 mm - view angle 134° - power 4300mAh built-in Lithium battery - intelligent motion detection - remote control with app



## art. MA01

### Maniglia smart



Per porte con spessore da 38 a 56 mm - apertura con impronta digitale, bluetooth o pin - controllo remoto attraverso app "JANUS LOCK" - maniglia reversibile - alimentazione a batterie AAA - sostituisce la maniglia tradizionale senza apportare modifiche alla porta - adattabile a qualsiasi serratura con fori vite interasse 38 mm - tastierino luminoso - controllo accessi



### Smart door handle

Thickness door 38-56 mm - can open the door with finger print, bluetooth or pin code - remote control app "JANUS LOCK" - reversible handle - power AAA batteries - it replace traditional handles - compatible with all security lock with hole distance of 38 mm - lighting key board - entry control

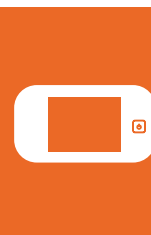
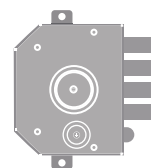
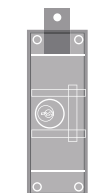
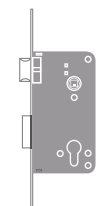
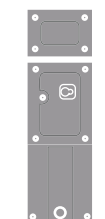





**La maniglia Smart Wally MA01** con la tastiera touch e il lettore di impronte digitali offre innumerevoli vantaggi in confronto ad una maniglia tradizionale.

Scaricando l'APP dedicata in pochissimi passaggi sarà possibile configurare la maniglia in piena autonomia, registrare l'impronta digitale, inserire il pin di accesso e sbloccare da remoto la serratura permettendo quindi l'apertura della porta.

Alimentata da 4 batterie AAA e completa di rosette e bocchette tonde, è facilmente installabile su tutte le porte con spessore compreso tra i 38 mm e i 56 mm.

Scarica l'applicazione "Janus lock" dall'App Store, Google play oppure inquadra il QR Code.



**Lo spioncino digitale Wally SP03** renderà l'abitazione un ambiente più sicuro e sempre monitorabile.

Alimentato da una batteria interna ricaricabile a lunga durata può registrare e acquisire immagini ad ampio raggio, visualizzabili sia direttamente dal dispositivo che dall'app remota anche in visione notturna.

Adattabile a tutte le porte con spessore compreso tra i 32 mm e 104 mm.

Scarica l'applicazione "With door viewer" dall'App Store, Google play oppure inquadra il QR Code.







Oggi la Società è simbolo di affidabilità e professionalità, un'eccellenza tutta Italiana, che vanta una storia in continua evoluzione.

WALLY oggi è un marchio di successo, il restyling del logo avvenuto negli anni racconta una storia fatta da importanti partnership e un modello di business improntato sull'innovazione e la fiducia dei proprio clienti, con l'obbiettivo comune di soddisfare le esigenze dei suoi diversi stakeholders.





**FBD SRL**

info@wallyserrature.it • +39 335 5491143  
P.IVA 08217920720

