

RMB EV

MULTI-POINT



Read this manual completely
before assembling and riding our
RMB EV Multi-Point

Owner's Manual

RMB EV
3362 Fulton Road
Fulton, CA 95439 USA
Tel: (707) 568-3388 Fax: (707) 526-1409
www.rmbev.com

RMB EV

Table of Contents

Technical Information-----	1
Warning Statement-----	2
Read Before Riding-----	3
List of Parts-----	4
Front Bar-----	6
Tool Kits In The Tool Bag-----	7
Assembling The Multi-Point-----	8
Charging The Batteries-----	17
Charging The Batteries Outside Scooter-----	18
Riding The Multi-Point-----	20
Folding The Multi-Point-----	24
Maintenance-----	26
Wiring Diagram-----	27
Trouble Shooting Guide-----	29

Warranty-----31

Instructions for optional attachments-----36

Technical Information

Multi-Point

Model No.	RMB Multi-Point
Product size	45 L x 27 W x 44 H inch (115 x 68 W x 113 cm)
Type of motor	Permanent-magnet brushless DC wheel motor
Motor power	500 w Wheel motor, 48 V
Battery type	sealed lead acid battery
Battery capacity	48 Volt, 12Ah
Charger	110V-240V, UL approved
Charging time	4-6 hours
Max. speed	Up to 16 MPH (26 km/h)
Single charge	Up to 31 MILES (50 km)
Max capacity	350 LBS (139kg)
Net weight	101 LBS (46 kg)

Warning Statement

Multi-Point



IMPORTANT!

Before you operate your Multi-point , please read carefully:

YOUR EXISTING INSURANCE POLICY MAY NOT PROVIDE COVERAGE FOR ELECTRIC VEHICLES, YOU SHOULD CONTACT YOUR INSURANCE AGENT TO DETERMINE IF COVERAGE IS PROVIDED.



Do not ride this scooter until you read and thoroughly understand the owners manual. It contains information critical to your safety. If you have any questions about the operation of the scooter, you should consult your authorized dealer.



It is extremely important that you follow the safety guidelines contained in this manual in order to ensure maximum safety.



Failure to comply with the standards outlined in this manual could result in fire and/or serious injury.



RMB EV is not liable for any damage or injuries caused by unsafe or faulty repairs. Any repairs made to this product by unauthorized service technicians are the sole responsibility of the owner.



Our products are designed to be ecologically conscious, please dispose of used batteries in compliance with local laws.

WARNING

THE RMB MULTI-POINT IS NOT A TOY AND SHOULD NOT BE OPERATED BY ANYONE UNDER 12 YEARS OLD.

Safety Instructions:

(Please take note of the following before each ride)

- The maximum weight capacity is 350 lbs.
- Only one person at a time should ride.
- Always wear protective gear including knee and elbow pads and an approved safety helmet when riding the Multi-Point.
- Before riding, be sure to check that all pivot points, locking buttons, quick releases, and latches are secured properly.
- The power switch lock must be in the “off” position when the Multi-Point is being charged.
- Do not use the Multi-Point when it is raining.
- Do not place the battery near heat or fire.
- Do not expose the charger to water or any moisture.
- Check if batteries are properly charged and installed.
- Charge Batteries after each use.
- Always ride on dry paved surfaces. Gravel, wet, extreme incline, and uneven surfaces are a hazard.

Check if all tires are properly inflated.

List of Parts

Multi-Point



List of Parts

Multi-Point

- 1 Multi-function Instrument
- 2 Foldable structure
- 3 Basket
- 4 Lamp bracelet
- 5 Connecting tube
- 6 Seat
- 7 Ring-pull steel pin
- 8 Seat post
- 9 Plastic base
- 10 Rear wheel
- 11 Battery
- 12 Dual-purpose lock bolt
- 13 Tri pod stands
- 14 Front fender
- 15 Controller
- 16 Motor
- 17 Front wheel

Front Bar

Multi-Point



- 1 Brake lever
- 2 Lock mechanism switch
- 3 Horn switch
- 4 Multi-function Instrument
- 5 Key switch
- 6 USB port
- 7 Forward/reverse switch
- 8 Throttle

Tool Kits In The Tool Bag

Multi-Point



- 1 Screwdriver
- 2 Allen wrench (2.5mm)
- 3 Allen wrench (3mm)
- 4 Allen wrench (5mm)
- 5 Allen wrench (6mm)
- 6 Wrench (8 x 10mm)
- 7 Wrench (16 x 18mm)
- 8 Wrench (16 x 18mm)
- 9 charger

Assembling The Multi-Point

Multi-Point

1. Unpack the Multi-Point carefully so that you do not misplace any of the parts.



2. Place the Multi-Point on a flat, level surface.
3. Insert the two support stands into the corresponding tubes at the base of the front half of the scooter to form a tri pod. Secure with wing nuts. Stand the front half of the scooter upright (be sure to lock hand brake after handlebars are attached).



Assembling The Multi-Point

Multi-Point

4. Extend the handle bar tube to full upright position, and slide it in to connect with the front fork.



*Note: The tube shaft is intentionally off center to allow handlebars to fold to the side. Be sure to align release button to pivot on brake handle side



5. Ensure that the handlebar is facing front, the brake on the left side and the throttle on the right, then tighten the handlebar tube collar

Assembling The Multi-Point

Multi-Point

-
- clamp using the enclosed 5mm wrench.
6. Firmly connect wire harness to junction box then slightly loosen junction box mounting brackets and twist the junction box to the right until it faces the rider. Re-tighten clamps.
 7. Front half of scooter is now assembled



NOTE: Handle bar height adjustment. Handle bar height can be easily adjusted by opening the quick release on the handlebar tube to preferred height, then firmly closing quick release.

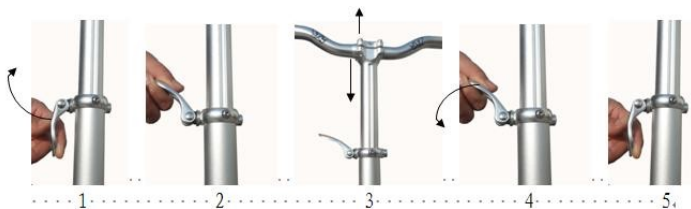

Assembling The Multi-Point

Multi-Point



8. Prior to assembling or disassembling the Multi-Point, extend stands to the ground on a flat

surface and secure with wing nuts (B).

If you plan on using the Quick release system often, you have two choices to conveniently retain the stands with the scooter:

(1) To use stands as a foot rest, flip stands upside down and secure wing nuts into corresponding slots on stand shaft. (A)

Assembling The Multi-Point

Multi-Point

(2) From position (B) loosen wing nuts and slide stands up the support tube, turn 90 degrees so the stand footings face the rear of the scooter.

Figure (C)



NOTE: If you do not plan on using the Quick release system often and do not want to use the foot rest option, it is recommended that you remove the stands all together until such time that you need them.

Assembling The Multi-Point

Multi-Point

Assembling and disassembling the Multi-Point using the Quick release system:



1. With power turned off, stand the front of the scooter upright using the footing stands.



Assembling The Multi-Point

Multi-Point

2. With seat attached to floor deck, grab seat with both hands and place foot on tow hitch. Pull

back while applying pressure with your foot to tilt floor deck up.



3. Place female end of floor deck onto male end of front half. Secure with special bolt. (once secure, rock back and forth to ensure full insertion and re-tighten.)

Assembling The Multi-Point

Multi-Point

4. The two power connector wires are fitted with

male to female plugs that have an alignment notch. Take note when plugging in.

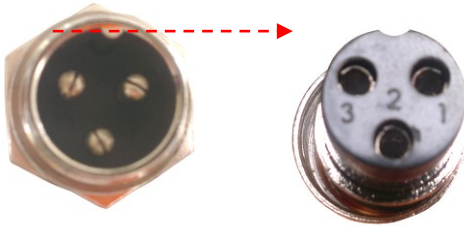

5. Plug the two power connecting wires into the corresponding sockets on the battery box respectively. Then zip tie the wire to the frame to keep from getting caught on any debris when riding.



Assembling The Multi-Point

Multi-Point

To disassemble:

1. Turn off power.

2. Unplug the single power wire that connects the front half of the scooter to the floor deck.
3. Reverse assembly steps and gently separate.



NOTE: In the rare instance the Quick Release Mechanism becomes too tight to release easily, turn the special screw upside down and screw in using the outer threads. This will apply pressure to release the mechanism.

**Extraction
threads**

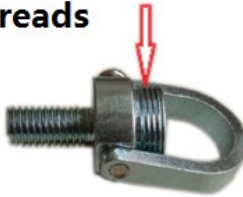

Charging The Batteries

Multi-Point

-
- Before you ride the Multi-Point for the first time you must charge the batteries for 4-6 hours or

until the charger light turns green using only the supplied charger.

● To charge the batteries, plug the charger into the charger socket located on the rear side of the scooter. Then plug the charger into a wall outlet. Red light on charger indicates charging, green light indicates charged.

Warning: Never charge scooter longer than 10 hours. If the charger does not turn green by 10 hours or you smell a Sulphur odor after a long charge there is a problem and contact the dealer for instructions.



Charging The Batteries Outside Scooter

Multi-Point

1. Turn off the key switch.

2. Lift the floor mat. Unscrew two bolts that secure the battery cover and remove it.



3. Take out the battery, then charge it.



Charging The Batteries Outside Scooter

Multi-Point



Riding The Multi-Point

Multi-Point

●Once you have completed the initial charge you are ready to ride. Remember, this is not a toy. The Multi-Point can reach speeds up to 16 mph depending on the terrain and the weight of the rider. You must wear a helmet and protective pads. Be aware of all local laws and ordinances that govern and/or restrict the use of powered scooters. The laws and ordinances vary greatly from municipality to municipality. It is your responsibility to know and abide by your local restrictions.

●To ride, insert the key into the key switch and turn the key in clockwise direction till the first click. The battery gauge will be illuminated indicating that the battery is in operation. Turn the key to the second click in clockwise direction for headlight.



● Hold onto the front bar with both hands. Your left fingers will control the brakes and your right

Riding The Multi-Point

Multi-Point

hand will control the throttle. As you twist the throttle towards yourself, the speed will increase. Release the throttle and apply the brake to stop. You will control the speed of the scooter by using both the throttle and the brake. **When the brake handle is squeezed it cuts power off the throttle.**

NOTE 1: WARNING: Never try stunts. Always maintain a safe speed.

NOTE 2: When scooter is parked, please remove the key, this will avoid anyone from accidentally turning the throttle causing the scooter to speed forward. Failure to do this could lead to an accident.

NOTE 3: If you need to stop in an emergency or kill power quickly, you can turn the key off.

NOTE 4: Depending on skills of the driver, the Multi-Point comes equipped with an adjustable speed button located on the controller which allows you to limit speed to 8mph or switch to max speed of 16 mph. When the button is pushed in, the max speed is 8mph. When the button is released, the max speed is 16mph.

Riding The Multi-Point

Multi-Point



NOTE 5: When you use reverse, the scooter must be stopped, and then push the reverse switch to “R”, the horn will send out a noise, then **GENTLY** turn the throttle to back up. **Warning, do not twist throttle to full power when in reverse.** When finishing reverse, push the reverse switch back to “F”.



Riding The Multi-Point

Multi-Point

NOTE 6: The Maximum output of dual ports USB part is 5V 2A which will charge all phones and tablets.



Folding The Multi-Point

Multi-Point

1. Turn off the key switch
2. Unlock the clamp safety ring by twisting to the left.



3. Pull clamp lever down to release.



Folding The Multi-Point

Multi-Point

4. Tilt the handlebar in the direction of its hinge.
(which is also attached to the handlebar tube).



5. Carefully lower the handlebar tube.



Maintenance

Multi-Point

Battery: (for professional use only)

The RMB Multi-Point is powered by 4, 12 volt, rechargeable batteries housed in a single compartment. Other than recharging, these batteries need no maintenance. To prolong battery life, recharge the battery after each use. You must also charge your Multi-Point if it has not been used for 30 days or more. If you need to replace the battery pack, it is located inside the battery compartment on the footboard. To get to the battery pack, remove the compartment cover by loosening the screws. To remove the batteries disconnect the wires from the battery terminals. Replace the battery pack with a new one and reconnect the wires. Follow the instructions on charging batteries to charge the new batteries.

Wiring Diagram

Multi-Point

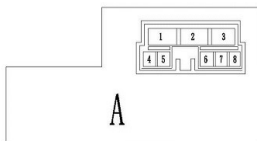
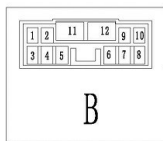
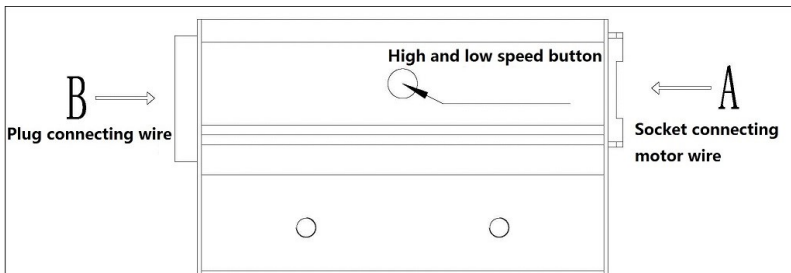

- | | |
|-------------------------|------------------------|
| 1.Main key Brown | 7.Empty |
| 2.Empty | 8.Power - Black |
| 3.Throttle +5V Blue | 9.Empty |
| 4.Throttle signal Green | 10.Battery + Red |
| 5.Brake Yellow | 11.Power - Black thick |
| 6.Reverse White | 12.Power + Red thick |

- 1.Motor Yellow
- 2.Motor Green
- 3.Motor Blue
- 4.Motor power+ Red
- 5.Motor power- Black
- 6.Motor hall signal Yellow
- 7.Motor hall signal Green
- 8.Motor hall signal Blue

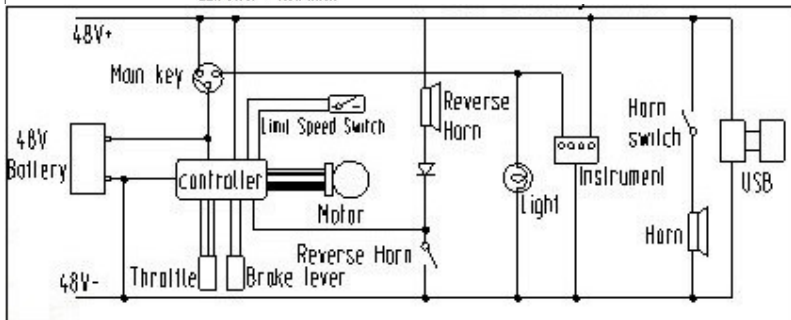

Wiring Diagram

Multi-Point

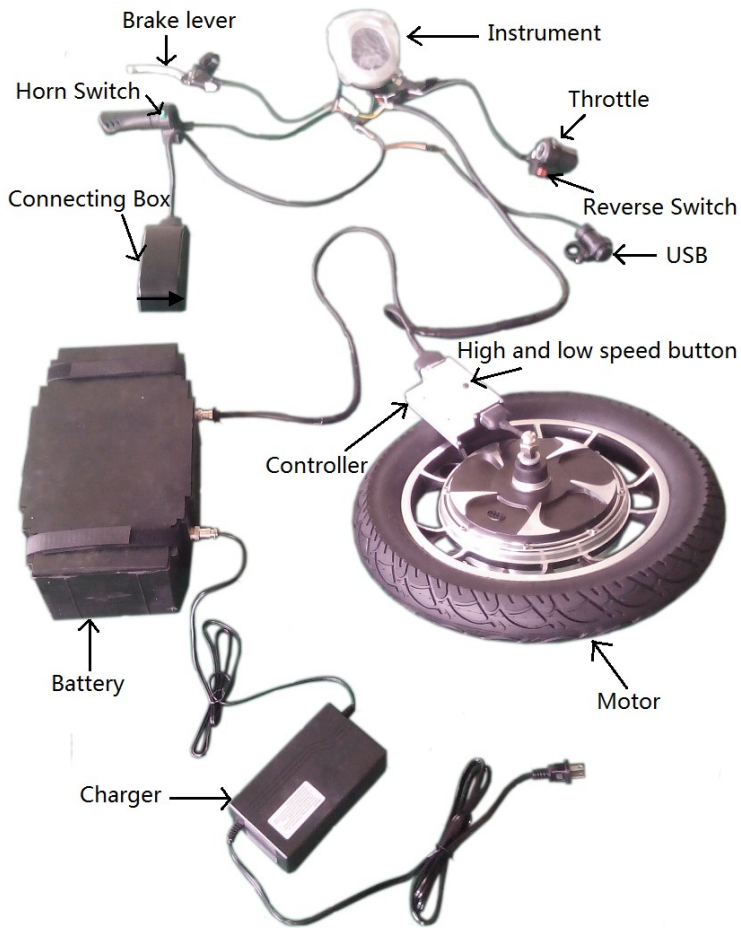

Trouble Shooting Guide

Multi-Point

Problem	Cause	Solution
The power light on the instrument does not illuminate when the Multi-Point is on.	<ol style="list-style-type: none">1. Battery is discharged.2. Loose connection inside Multi-Point.3. Fuse is blown.4. The instrument is defective.	<ol style="list-style-type: none">1. Recharge your Multi-Point.2. Remove the screws that hold the battery compartment cover and raise the cover. Visually inspect all wire connections making sure there are no loose wires, reconnecting those that are.3. Replace the fuse.4. Replace the instrument.
The power indicator on the instrument illuminates but Multi-Point still does not work.	<ol style="list-style-type: none">1. The throttle handle is not operating properly.	<ol style="list-style-type: none">1. Replace the throttle handle. Call Customer Service to order a new throttle

Trouble Shooting Guide

Multi-Point

When the brake lever is squeezed the Multi-Point does not stop.	1. The brakes are not adjusted properly.	1. Adjust the brake by loosening the bolt on the rear brake wheel, pull the cable and retighten the bolt.
Scooter is losing speed.	1. Low battery 2. Battery is defective. 3. Low tire pressure.	1. Recharge your battery for 4~6 hours. 2. Replace battery. Call Customer Service to order a new battery. 3. air tires up to correct pressure.

Warranty

Multi-Point

The Limited Warranty does not cover or apply to the following: Normal wear and tear; any damage, failure and/or loss caused by accident, misuse, neglect, abuse and/or failure to follow instructions or warnings as stated on the product or in the applicable owner's manual or other printed materials provided with the product; damage, failure and/or loss caused by the use of the product in any other manner for which such products were not specifically designed.

RMB EV warrants the Multi-Point for six (6) months according to the following terms. Batteries and tires are warranted for three (3) months. This warranty extends to the original retail purchaser only and commences on the date of the original retail purchase. Any part of the RMB EV product manufactured or supplied by RMB EV and found in the reasonable judgment of RMB EV to be defective in material or workmanship will be repaired or replaced by an authorized RMB EV service dealer without charge for parts or labor. RMB EV is responsible for the expense of delivering the warranty replacement parts. However, if the customer chooses not to replace the parts, the **expense of**

Warranty

Multi-Point

delivering the Multi-Point to the factory / authorized service dealer for warranty work or the expense of returning it back to the owner after repair/ replacement will be paid for by the owner. RMB EV's responsibility in respect to claims is limited to making the required repairs or replacements and no claim of breach of warranty shall be cause for cancellation or rescission of the contract of sale of any RMB EV product. Proof of date of purchase will be required by the dealer to substantiate any warranty claim. An authorized RMB EV service dealer must perform all warranty work. The warranty is limited to thirty (30) days from the date of purchase for any RMB EV product that is used for rental demonstration, commercial purposes, or any other income producing purpose. This warranty does not cover any RMB EV product that has been subject to misuse, neglect, negligence or accident, or has been operated in any way contrary to the operating instructions as specified in RMB EV's owner's manual. This warranty does not apply to any damage to RMB EV products that is the result of improper maintenance or to any RMB EV product that has been altered or modified so as to

Warranty

Multi-Point

adversely affect the products operation, performance, or durability, or that has been altered or modified to change its intended use. This warranty does not extend to repairs made necessary by normal wear and or by use of parts that are incompatible with RMB EV products. In addition this warranty does not cover items that experience normal wear and tear. RMB EV reserves the right to improve the design of the product without assuming any obligations to modify any product previously manufactured. All warranties are limited in duration to the six (6) months warranty period. Any such implied warranties including merchantability, fitness for a particular purpose or otherwise are disclaimed in their entirety after the expiration of the appropriate thirty day warranty period. RMB EV's obligation under this warranty is strictly and exclusively limited to the repair and replacement of defective parts and RMB EV does not assume any other obligation. Some states do not allow limitations on how long an implied warranty lasts, so the above limitation may not apply to you. RMB EV assumes no responsibility for incidental consequential or other damages including but not limited to expense of returning

Warranty

Multi-Point

the Multi-Point to an authorized service dealer and expense of delivering it back to the owner, mechanics travel time, telephone charges, rental of a like product during the time the warranty service is being performed, travel loss, or damage to personal property, loss of revenue, loss of time, or inconvenience. Some states do not allow the exclusion or limitation of incidental or consequential damages so the above limitations may not apply to you.

WHAT RMB EV WILL DO:

RMB EV will, at its sole option, either repair, replace or refund the purchase price of any unit that does not conform to this limited warranty. RMB EV may choose at its option to use functionally equivalent reconditioned, refurbished, or new units or parts or any units. You are responsible to get the unit back to RMB EV.

Warranty

Multi-Point

HOW TO GET WARRANTY SERVICE:

To obtain warranty service, please call or fax to the following telephone numbers for RMB EV Customer Service - warranty repair

Tel. 1-707-568-3388 or Fax. 1-707-526-1409,
Email: info@rmbev.com

DO NOT RETURN YOUR PRODUCT TO ANY ADDRESS.

Please call, email, or write for the location of the RMB EV authorized service center nearest you and for the procedures for obtaining warranty claims.

Instructions for optional attachments

Multi-Point

Installing the optional dc to ac inverter

1. Turn off the key switch.
2. Remove seat post from seat.



3. Install special seat post on seat.



4. Insert inverter into special seat post and secure with small allen screws.

Instructions for optional attachments

Multi-Point

5. Install seat.



6. Plug provided wire into inverter, zip tie to seat post and plug into the charge port on floor deck.



Instructions for optional attachments

Multi-Point

7. When using the inverter, turn on the power



switch.

Inverter specification:

- Input voltage is DC 48V
- Output voltage is AC 110V 60Hz

NOTE 1: Do not expose to water drip or spray.

NOTE 2: Shock hazard. Keep away from children

- Do not insert foreign objects into the inverter's ac outlet or vent openings.
- Do not under any circumstances. connect the inverter to power utility AC distribution wiring.
- Failure to follow the above instructions may result in personal injury or inverter damage.

NOTE 3: Do not expose the inverter to

temperatures in excess of 104°F(40°C).

NOTE 4: The inverter is meant for small tools, lights, or appliances. Large devices will cause inverter to pulse and should not be used.

Instructions for optional attachments

Multi-Point

How to install the trailer

1. Turn off the key switch
2. Put the trailer tongue into the slot, after aligning the holes, place the two bolts through the holes. Twist the bolts, and tighten them with the nuts provided.



3. Place the trailer connection plate (A) into the trailer connection frame (B) of front of trailer tongue. After aligning the holes, place the trailer pin through the hole. Secure the trailer pin with the cotter pin.



Instructions for optional attachments

Multi-Point

How to install the solar panel

1. Turn off the key switch
2. Put the front support(A) onto the riser(B), aligning the holes, place the two bolts through the holes, then twist the bolts, and tighten them with the nuts provided.



3. Put the left front frame(A) onto the front support(B), aligning the three holes, place the three bolts through the holes, then twist the bolts, and tighten them with the nuts provided. The right front frame is the same as the left front frame.

Instructions for optional attachments

Multi-Point



4. Install the rear frame onto the scooter with the two bolts, and tighten them with the nuts provided.



Instructions for optional attachments

Multi-Point

5. Install the rear support (A) onto rear frame(B) with the two bolts, and tighten them with the nuts provided.



6. Fix the rear support and seat post with one bolt, and tighten them with the nuts provided.



Instructions for optional attachments

Multi-Point

7. Fix the solar panel onto the front frames(A) with support pipe(B), fix the solar panel onto the rear frames(C) with support board(D).

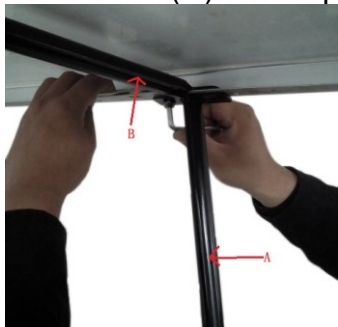

the front frame



the rear frame

7. Connect the wiring harness well.
Confirm that the switch on the solar panel is off (solar panel display lamp (A) is extinguished), then connect controller connector(C) and battery connector(D), battery display lamp(B) is light, turn on the switch, solar panel display lamp is light.

Instructions for optional attachments

Multi-Point

A: Solar panel display lamp

B: Battery display lamp



the upper rear frame



the lower rear frame

Instructions for optional attachments

Multi-Point

NOTE 1: When not using the solar panel for more than one week, please turn off the switch of solar panel.

NOTE 2: When disassembling the solar panel, please turn off the switch of solar panel.

Instructions on the use of the alarm

1. Take out the alarm.



2. Connect the battery and install on seat post..



3. The “1” button is the alarm button. When

Instructions for optional attachments

Multi-Point

pressing it gently, the horn will ring one loud, after three seconds, the scooter will be on alert. Touching or moving the scooter, activates alarm and horn will ring continuously.

4. The “2” button is the disarm button. Pressing this button gently, the horn will ring one loud, then the alert is removed.



Instructions for optional attachments

Multi-Point

Instructions on the use of the LED lights

To use undercarriage LED lights, the head light must be turned on, then click the switch to “1”, the LED lights will be illuminate. Push switch “0” to turn off the LED.

