

Simplicity[®]

VACUUMS

Owner's Manual

SPSC1



Getting Started

Important Safety Instructions	2
Description of the Spot Cleaner.....	6

Preparing the Spot Cleaner

Attaching the hose	7
Filling the clean water tank	7

Operating the Spot Cleaner

On/Off Switch	9
2 Speed Switch	9
Operation	9

Maintenance and Care

Cleaning and emptying the clean water tank	11
Cleaning and emptying the dirty water tank.....	12
Cleaning the tools	14
Storage.....	15
General maintenance	15



Problem Solving Guide

Troubleshooting	16
-----------------------	----

IMPORTANT
BEFORE USE READ THESE INSTRUCTIONS AND RETAIN
FOR FUTURE REFERENCE

INTRODUCTION

The following instructions contain important information about the machine and safety advice for the operator. Equipment must be operated, serviced and maintained in accordance with the manufacturer's instructions. If in doubt contact the supplier of your machine.

  **Read all instructions before using the machine**

PRODUCT INFORMATION

This machine is for indoor household use only.

TECHNICAL SPECIFICATIONS

Model		SPSC1
Product Code		SPSC1
Voltage / Frequency	V / Hz	220-240 / 50 - 60
Vacuum motor power	W	800
Vacuum	kPa	16
Airflow rate	l/s	18.3
Capacity	l	1.5 / 3
Sound pressure level	dB(A)	83
Dimensions (L x W x H)	cm	46 x 26 x 27
Weight (inc. hose, wand, tools)	kg	6.5
Hose length	m	1.8
Cable length	m	5
Warranty		1 year

- Noise levels measured at a distance of 1 metre from machine and 1.6 metres above floor, when operating on a hard floor. Measurements recorded using a hand held meter.
- Dimensions are approx. Since the company's policy is to continuously improve the product, there could be changes without prior notice.
- Handle vibration does not exceed 2.5 m/s when operating on a smooth floor surface.

EC Declaration of Conformity

Machine Type: Household vacuum cleaner
 Model: SPSC1

This machine is in conformity with the following EU directives:

- Machinery Directive 2006/42/EC
- The EMC Directive 2014/35/EU

Applied harmonised standards:
 EN60335-1, EN60335-2-2, EN62233, EN55014-1, EN55014-2, EN610003-2, EN610003-3,

Simplicity
 Unit C (East), Hamilton Business Park,
 Manaton Way, Botley Road,
 Hedge End, Southampton,
 SO30 2JR, UK

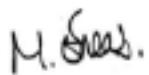
 Malcolm Eneas
 Operations Manager
 Southampton, 17.05.2023

WASTE ELECTRICAL & ELECTRONIC EQUIPMENT (WEEE)



DO NOT dispose of this device with unsorted waste. Improper disposal may be harmful to the environment and human health. Please refer to your local waste authority for information on return and collection systems in your area.

IMPORTANT SAFETY ADVICE

The safety information described in this manual provides basic precautions and supplements standards in force in the country where the machine is used.



This symbol warns the operator of hazards and unsafe practices which could result in severe personal injury or death.



WARNING - to reduce the risk of injury, damage, electric shock or fire.

This machine must only be used for the manufacturer's approved application as described in this manual.

- The machine must be unpacked and assembled in accordance with these instructions before connecting to the electrical supply.
- Only genuine accessories and spare parts provided with the machine or those approved by the manufacturer should be used. The use of other accessories may impair the safety of the machine. All repairs must be performed by a qualified service agent.
- DO NOT** modify the machine from its original design.
- Operators must be fully trained in the use of the machine in accordance with these instructions, able to perform regular user maintenance and the correct selection of accessories.
- Operators should be physically capable to manoeuvre, transport and operate the machine.

- Operators should be able to recognise unusual operation of the machine and report any problems.
- This appliance can be used by persons with reduced physical, sensory or mental capabilities, or lack of experience and knowledge if they have been given supervision or instruction concerning use of the machine in a safe way and understand the hazards involved.
- DO NOT** allow the machine to be used by children. Keep children and unauthorised persons away from the machine when in use. **DO NOT** use as a toy. Cleaning and user maintenance shall not be done by children.
- DO NOT** use if it has been damaged, left outdoors or dropped in water.
- DO NOT** use where hazardous dust is present.
- DO NOT** use in an explosive atmosphere.
- DO NOT** pick up or use near flammable or combustible fluids, hazardous dusts or vapours.
- CAUTION** - If it is suspected that there is hazardous dust or flammable/corrosive material, stop cleaning the area immediately.
- DO NOT** use to clean up any burning or lighted materials such as cigarettes, matches, ashes or other combustible objects.
- Only use the machine on firm level surfaces. **DO NOT** use on a gradient or slope of more than 2%.
- DO NOT** use on rough uneven surfaces e.g. industrial or coarse concrete surfaces.
- DO NOT** use outdoors e.g. on patios, decks or rough surfaces.
- CAUTION** - This machine is for dry indoor use only and should not be used or stored outdoors in wet conditions.
- Take care when using a machine near the top of stairs to avoid overbalancing.

20. **DO NOT** cover the machine when in use.
21. **DO NOT** use without filters in place.
22. **IMPORTANT** - The filter must be dry before refitting.
23. **DO NOT** leave machine running unattended.
24. Keep hair, loose clothing, hands, feet and all other parts of the body away from openings and moving parts.
25. **DO NOT** put any object into openings. **DO NOT** use with any opening blocked; keep free of dust, debris and anything that may reduce airflow.
26. **DO NOT** operate the machine if it malfunctions or is damaged in any way. Contact an authorised service agent for repair or adjustments.
27. **DO NOT** use the appliance to vacuum tiny particles like cement or plaster dust as this will shorten life of the motor.



CAUTION - Risk of electric shock

28. **DO NOT** operate the machine with a damaged power cord or plug, or after the machine malfunctions or is damaged in any way. Contact an authorised Service Agent for repair or adjustment.
29. The machine must be kept clean and in good condition with regular inspections of the power cord and plug for signs of any damage. If any parts are damaged they shall only be replaced by an approved part by the manufacturer, its service agent or a similar qualified person in order to avoid a hazard
30. When unplugging, pull the plug, not the power cord.
31. **WARNING:** Keep the power cord clear of moving parts.
32. **DO NOT** kink or twist the power cord and keep cord away from heated surfaces.
33. Switch off the machine before removing the plug.

34. **DO NOT** operate switches or touch the mains plug with wet hands as this may cause electric shock.
35. **DO NOT** pull or carry by the power cord. **DO NOT** use cord as a handle, close door on cord or pull cord around sharp edges or corners.
36. The machine must be disconnected from its power source when not in use and before commencing cleaning of the machine or undertaking maintenance operations.
37. **WARNING: DO NOT** fill the machine with water hotter than 40°C.
38. Never use excessive foaming or highly corrosive cleaning solutions.
39. Warm water can be used to aid cleaning. However, this can increase the risk of colours fading and carpets to shrink.

CLEANING AGENTS

1. When using cleaning and care agents, the manufacturer's danger warnings must be followed and protective goggles and clothing must be worn.
2. Only use low-foaming, non-combustible cleaning agents which do not contain general health-hazardous substances.
3. Please ensure that after each use any chemical residue is rinsed out with clean water.

TRANSPORTING THE MACHINE

1. Take extreme care when moving the machine up or down steps or stairs.
2. Incorrect lifting techniques may result in personal injury. We advise that the manual handling regulations are followed. Carefully wrap the power cord and store in a dry indoor location.
3. **DO NOT** expose the machine to rain or moisture.
4. When transporting the machine ensure that all components, tanks and removable parts are securely fastened, and that the power cord and plug are not trailing.

STORAGE

1. Always switch off the machine after use.
2. Store the machine in a dry indoor area only.
3. Always switch off, empty, wipe down and dry the machine after use.

GUARANTEE

Your product is guaranteed for one year from the date of original purchase, or hire purchase, against defects in materials or workmanship during manufacture. Within the guarantee period we undertake at our discretion, to repair or replace free of charge to the purchaser, any part found to be defective, subject to the following conditions:

CONDITIONS

1. Claims made under the terms of the guarantee must be supported by the original invoice/bill of sale issued at the time of sale, or the machine Serial No.
2. For claims under this guarantee contact the supplier from whom you purchased the product who will arrange the appropriate action. **DO NOT** initially return the product as this could result in transit damage.
3. Neither Simplicity nor its distributor shall be liable for any incidental or consequential loss.
4. This guarantee is governed by the laws of England.
5. This guarantee does not cover any of the following:
 - Periodic maintenance, and repair or replacement of parts due to normal wear and tear.
 - Damage caused by accident, misuse or neglect, or the fitting of other than genuine Simplicity parts.
 - Defects in other than genuine Simplicity parts, or repairs, modifications or adjustments performed by other than an authorised service agent.

- Costs and risks of transport relating directly or indirectly to the guarantee of this product.
 - Consumable items such as power cords, brushes, drive discs, filters, belts, vacuum skirts and other similar items.
6. This guarantee does not affect your statutory rights, or your rights against the supplier arising from their sales or purchase contract. Simplicity's policy is one of continual product development and we reserve the right to alter specifications without prior notice.

DESCRIPTION OF THE SPOT CLEANER

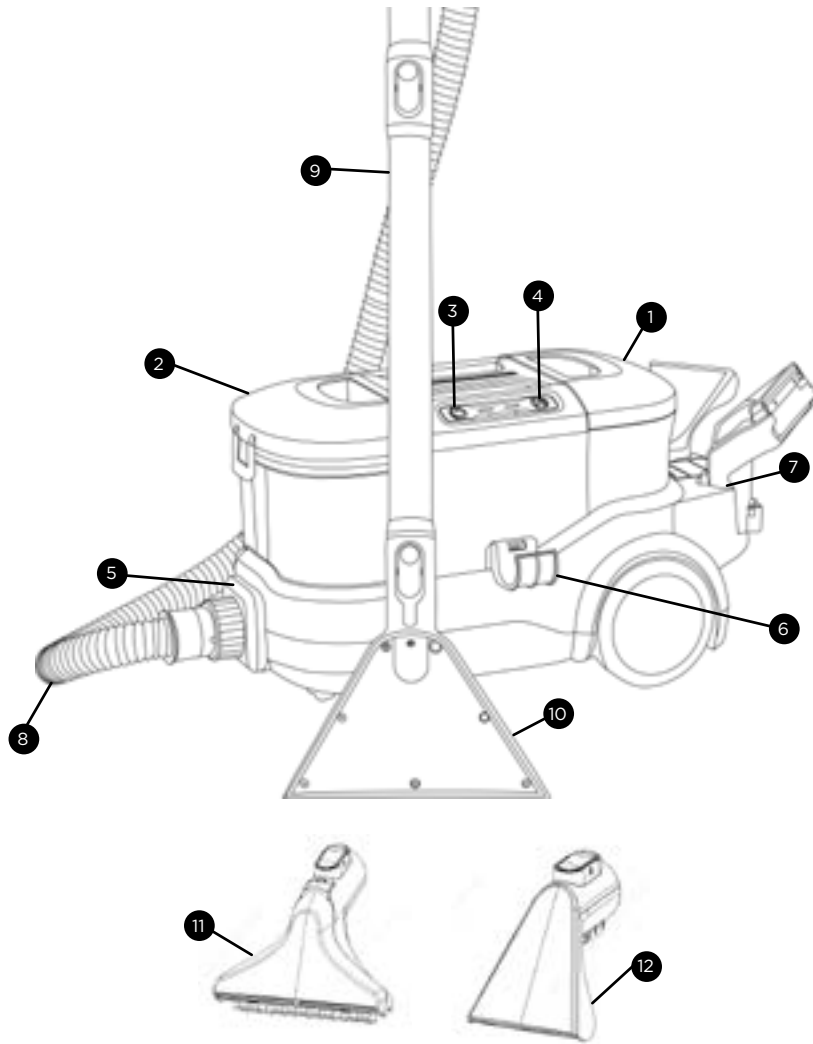

1. Clean water tank
2. Dirty water tank
3. On/off switch
4. 2 speed switch
5. Hose inlet
6. Hose hook

7. Accessory storage holder
8. Hose
9. Wand
10. Carpet tool
11. Stubborn stain brush
12. Upholstery tool

PREPARING THE SPOT CLEANER



WARNING: Before assembling, transporting or changing accessory tools, switch the spot cleaner off and unplug from the electrical outlet

Attaching the hose

1. Insert and align the valve into the front hose inlet and twist the hose connection until securely fastened (Fig 1)

Filling the clean water tank

2. Remove the clean water tank by lifting up from the handle and pulling it away from the base of the machine (Fig 2)
3. Open the screw cap and fill with clean water and solution. (Fig 3) The maximum water capacity is 3L. Please follow the instructions on the solution to ensure correct dosage.

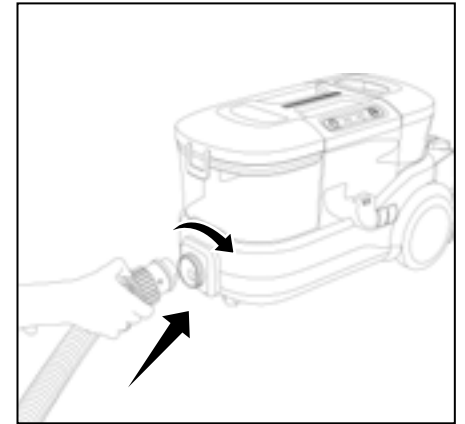

Fig. 1

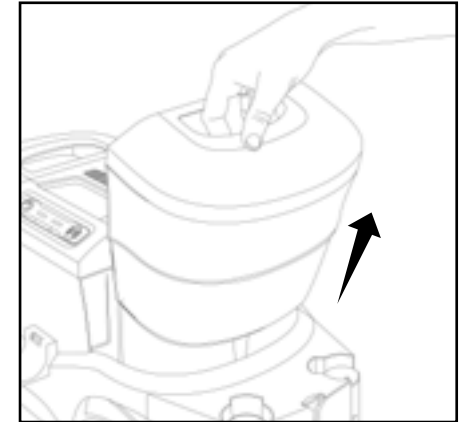

Fig. 2

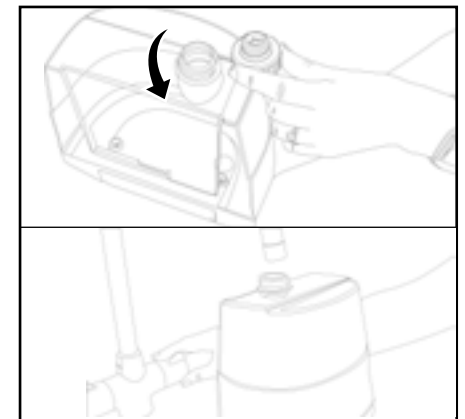

Fig. 3

PREPARING THE SPOT CLEANER

4. Tighten the screw cap and replace the clean water tank into the base until you hear a click (Fig 4)
5. Depending on the accessory tool being used either attach both wands together and slide onto the hose until you hear a click and attach the carpet tool to the wand (Fig 5)
6. If using either the stubborn stain brush or upholstery tool these can be added directly onto the hose (Fig 6)

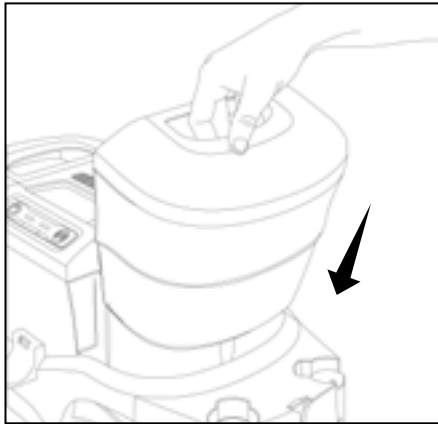

Fig. 4

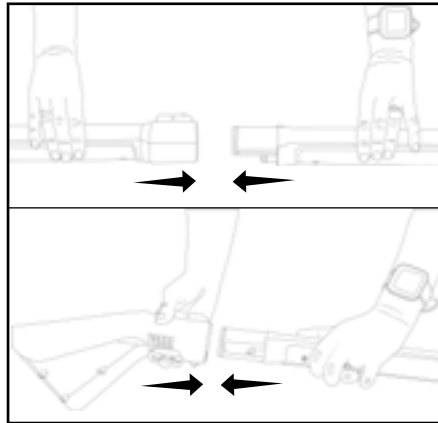

Fig. 5

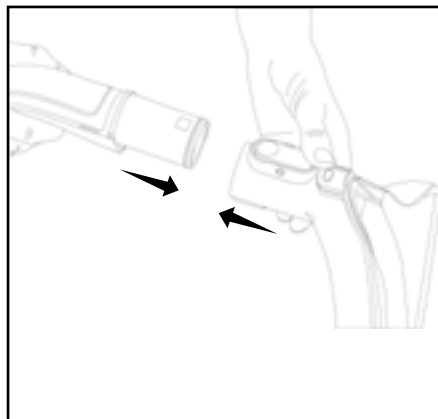

Fig. 6

OPERATING THE SPOT CLEANER

On/Off Switch

1. The on/off switch is positioned on top of the machine (Fig 1A)

2 Speed Switch

1. There is a two speed switch positioned on top of the machine (Fig 1B)

Operation

1. Plug the machine in (Fig 2)
2. Press the on/off switch to turn on the spot cleaner (Fig 1A). If more suction is required press the speed control switch to level II (Fig 1B)
3. Press the cleaning tool onto the floor, whilst pressing the lever to release solution, pull back slowly to vacuum up the solution (Fig 3)

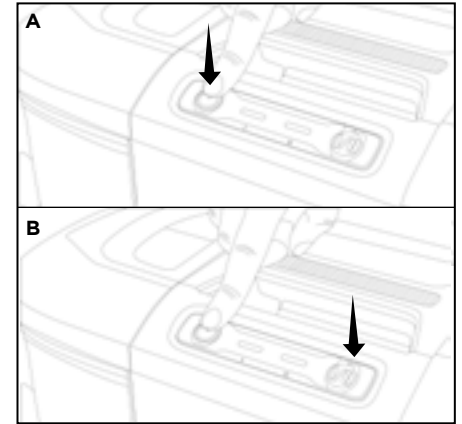

Fig. 1

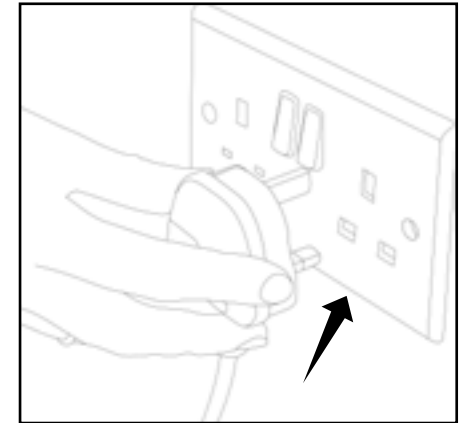

Fig. 2

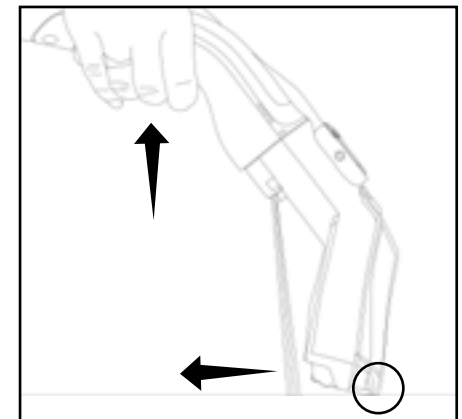

Fig. 3

OPERATING THE SPOT CLEANER

4. For stubborn stains allow the cleaning solution to work for a few minutes onto the soiled area, by holding the cleaning tool approximately 2.5cm above the area to be cleaned, press the lever on the handle to spray solution onto the soiled area. Do not spray continuously in the same spot. (Fig 4)
5. Use the brush to agitate the stain (Fig 5)
6. Press the cleaning tool onto the floor whilst pulling back and vacuuming the water up, without spraying any solution and repeat until all solution is vacuumed up. (Fig 5)
7. Turn off the spot cleaner when finished (Fig 6)



If the dirty water tank exceeds the maximum capacity the ball float will rise and the vacuum will stop. Immediately switch off the machine and empty the dirty water tank otherwise dirty water may overflow into the machine.

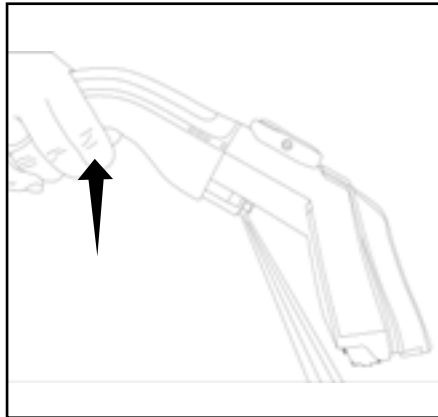

Fig. 4

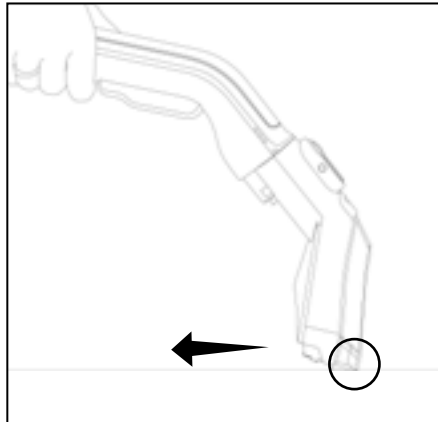

Fig. 5

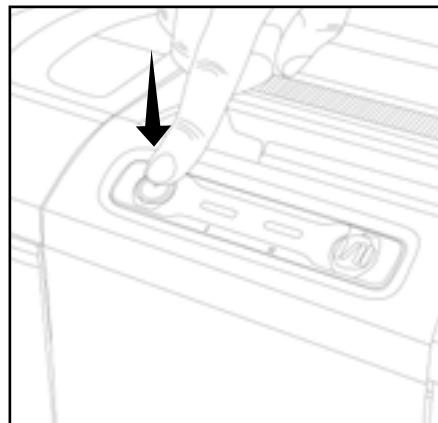

Fig. 6

MAINTENANCE AND CARE

Cleaning and emptying the clean water tank

1. Remove the clean water tank by lifting up from the handle and pulling it from the base of the machine (Fig 1)
2. Open the screw cap and empty any remaining solution (Fig 2)
3. Add clean water and turn on the machine. Press the handle lever to remove any remaining water and solution from the machine (Fig 3)
4. Rinse the tank with clean water and replace onto the machine.
5. If any solution is remaining near the filter on the base, dry with a cloth.



Fig. 1

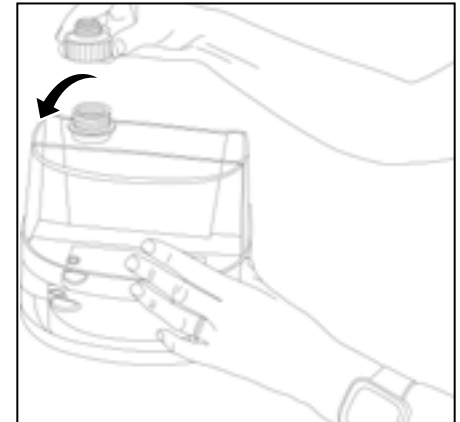

Fig. 2

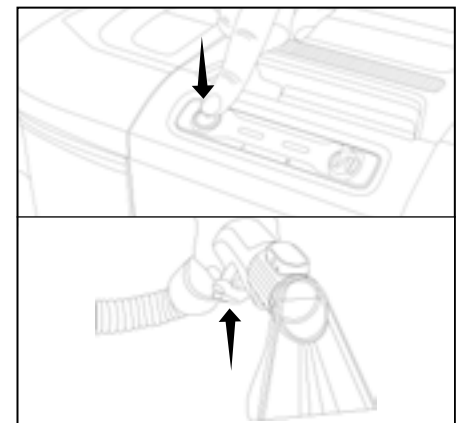

Fig. 3

MAINTENANCE AND CARE

Cleaning and emptying the dirty water tank

1. When the dirty water reaches the maximum level, switch off the machine and remove the dirty water tank by lifting up from the handle and pulling it away from the base of the machine (Fig 1)
2. Securely holding the tank lift up the latch at the front and remove the lid. Empty the dirty water (Fig 2)
3. Rinse the tank, lid and seal with clean water (Fig 3)

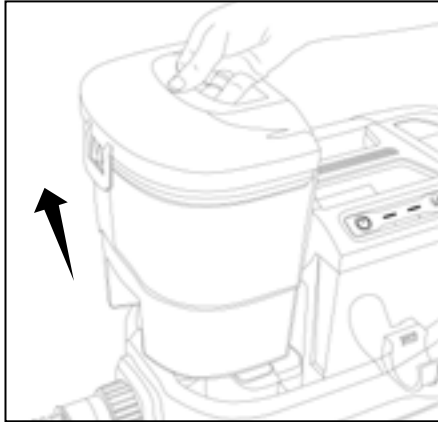

Fig. 1

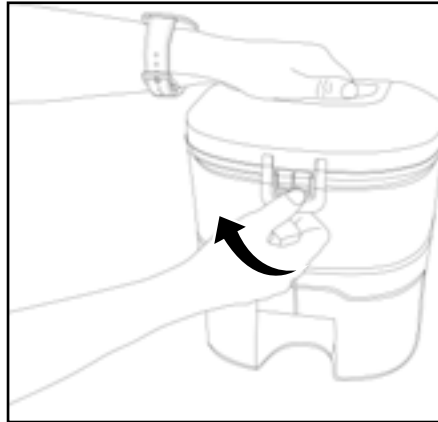

Fig. 2

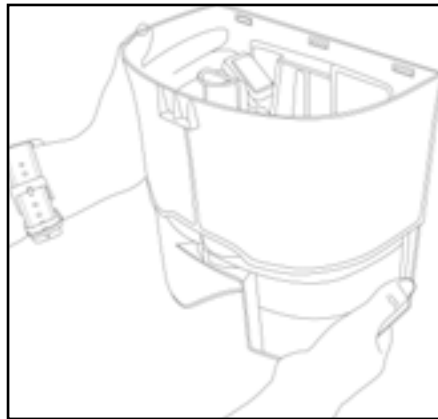

Fig. 3

MAINTENANCE AND CARE

4. Replace the lid onto the tank (Fig 4)
5. Replace the dirty water tank onto the machine (Fig 5)

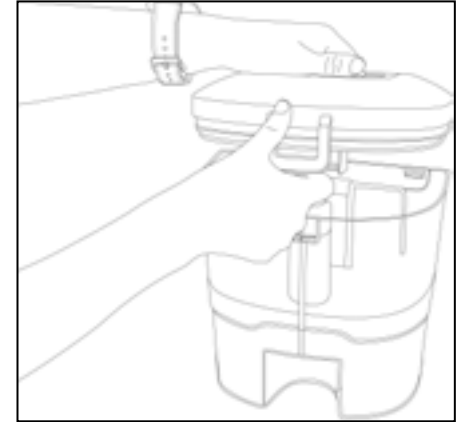

Fig. 4

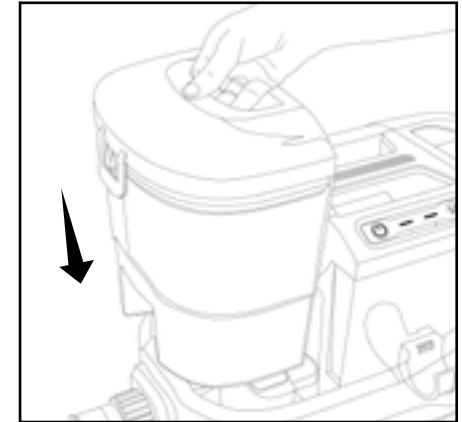

Fig. 5

MAINTENANCE AND CARE

Cleaning the tools

1. After every use rinse the tools with clean water and leave to dry (Fig 1)
2. To disassemble the stubborn stain tool pull the tab on the handle to remove the front cover off (Fig 2)
3. Rinse with clean water and replace the front cover by aligning the tabs and pushing securely until you hear a 'click' (Fig 3)

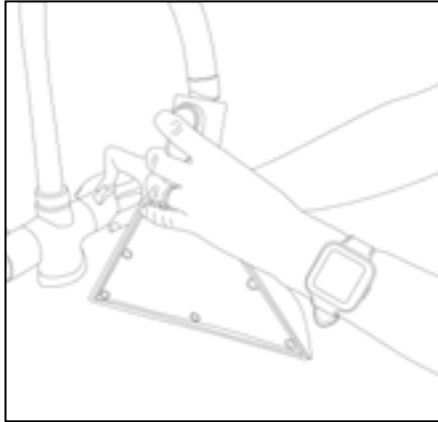

Fig. 1

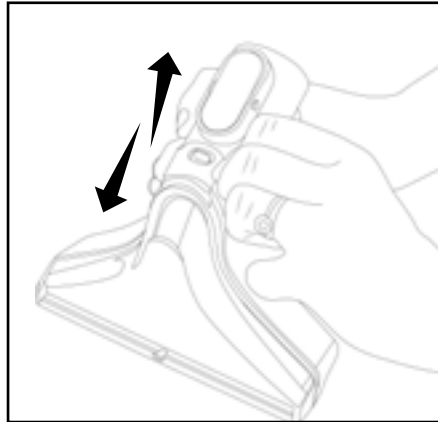

Fig. 2

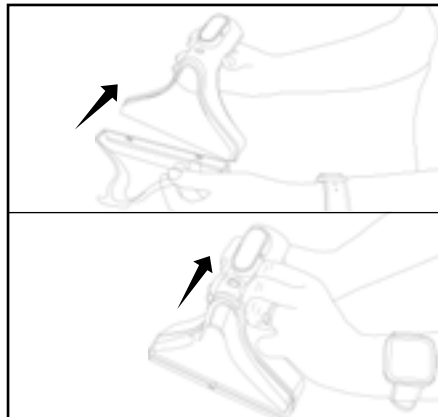

Fig. 3

MAINTENANCE AND CARE

Storage

1. Wrap the hose around the machine and store all tools on the accessory tool holder (Fig 1)
2. Store in a clean, dry area

General Maintenance

1. Check all nozzles after use for any blockages and remove if required (Fig 2)
2. Check the hose for any blockages or damage.
3. Rinse both the inlet air sponge and filter sponge after use and replace when dry. If required replace if damaged (Fig 3).

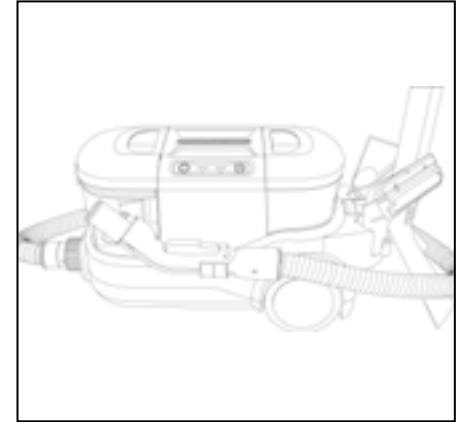

Fig. 1

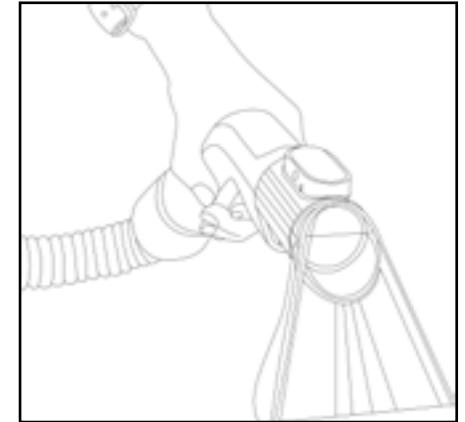

Fig. 2

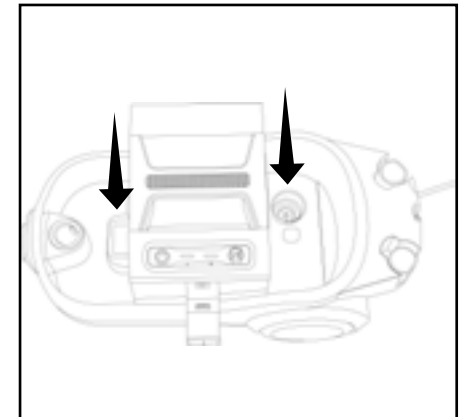

Fig. 3

PROBLEM SOLVING GUIDE

Troubleshooting



WARNING! To reduce the risk of electrical shock or injury from moving parts, turn off the spot cleaner before servicing or cleaning.



CAUTION! To reduce the risk of electric shock, do not handle plug or appliance with wet hands.

PROBLEM	CHECK POINT	POSSIBLE SOLUTION
Machine is not working	Lack of voltage / electrical supply	Check fuse, power cord, plug and socket outlet
Machine is not spraying solution	The nozzle is blocked	Rinse through
	The handle or pump is damaged	Contact service agent
Loss of vacuum suction	Dirty water tank is full	Empty the dirty water tank
	Dirty water tank is not properly in place	Install the dirty water tank properly
	Blocked hose or wand	Check and clear any blockages

For Best Performance

- Keep the machine and all accessories clean and in good operating condition.
- Empty and clean the clean and dirty water tanks after every use
- Check the filters regularly.
- Always use genuine filters and parts, as use of other products may result in poor cleaning performance.
- Store the machine carefully in a dry area.
- For optimum cleaning performance and safety, follow your owner's manual