

WallBeds Australia Bookcase Assembly Instructions

- * Insert all cam locks into the following panels: Top, Bottom, Kick, Back and Shelves.
 - * Insert Cam pins into the following panels: Sides and the opposite side to the cam locks on the Top & Bottom Panels.
 - * Attach the back panel (**H**) to one of the side panels (**G**) with the cam locks facing towards the back.
 - * Attach the Top (**I**) ensuring the cam locks are facing UP. **NOTE - The cam pins on the Top and Bottom panels panel need be attached to the opposite side to the cam locks.**
 - * Attach the Bottom (**I**) with the cam locks facing to the underside of the unit.
 - * Attach the Kick panel (**K**)
 - * Tighten all cam locks using a Phillips head screw driver (**not a power tool**)
 - * Attach the remaining Side panel (**H**) tighten all cam locks using a Phillips head screw driver (**not a power tool**) ensure all finished edges are also facing the same way.
- Stand the unit up and attach the bookcase to the side panel of the assembled Bed Cabinetry using the 28mm wood screws supplied. It is recommend that you pre-drill these holes. Ensure that the front edge of the bookcase is flush with the front edge of the Bed Cabinet.

Fitting the fixed shelves

- * Insert Cam pins into the pre-drilled holed located in each side panel (**G**)
- * Place the shelves with the cam locks already inserted over the cam pins and tighten the cam lock using a hand held Phillips Head Screw Driver.

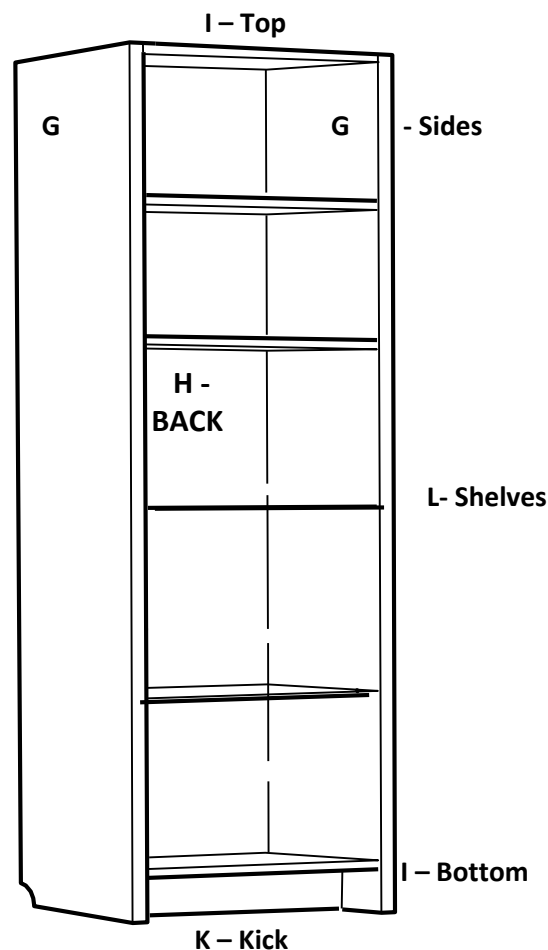

| Instructions Part Reference For Each Panel | Bookcase Panels | Sticker Description On Each Panel |
|--|----------------------|-----------------------------------|
| G | Side Bookcase Panels | Wall 1 Door - End L/R |
| H | Bookcase Back Panels | Wall 1 Door - Back |
| I | Top & Bottom Panels | Wall 1 Door - Top / Bottom |
| L | Shelves | Wall 1 Door - Shelf |

