

65.0 mm x 90.0 mm

URBAN



WIRELESS TWS
Q4
USER MANUAL

Quick Start Guide

Thank you for choosing the "Urban Q4" to better use this product, please read the quick start guide carefully before use and properly manage it.

Product Specifications

Product Name:	URBAN Q4
BT Connectivity:	5.3
BT Range:	10 mts
Driver Diameter:	10 mm
Impedance:	32Ω
Sensitivity	92dB±3dB 1KHz
Charging Type:	Type C
Charging Time:	Up to 2 Hours
Playtime:	Up to 24 Hours with Charging case
Product Weight:	30 gm

How to Pair

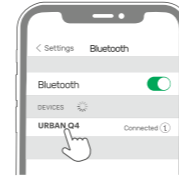
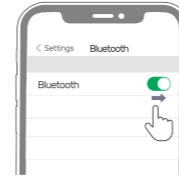

Power On :	Long press for about 4 seconds to power on
Power Off :	Long Press for about 5 seconds to power off
Answer / End Call :	Touch Once on right / Left to answer or hangup call
Incoming Call Rejection:	Long Press for 2 seconds on Right / Left Earbuds
Play/ Pause	Touch Once Right/ Left Earbuds
Last/ Next Song	Long Press the Left/ Right earbuds
Increase Volume	Touch Twice on Right Earbuds to Increase the volume
Decrease Volume	Touch Twice on left Earbuds to decrease the volume
Recall Last Number	Touch Twice on left Earbuds to decrease the volume

Left Earbud Functions



- Previous song**
(Touch once)
- Voice assistant**
(Touch twice)
- Answer the phone**
(Press)
- Refuse to answer the phone**
(Press and hold for two seconds)

Right Earbud Functions



- Previous song**
(Touch once)
- Next Song**
(Touch twice)
- Voice Assistant**
(Press)
- Answer the phone**
(Touch twice)
- Refuse to answer the phone**
(Press and hold for two seconds)

Important safety information

Don't remove or replace the Battery, including sensitive electronic components, including a battery, and can be damaged or cause injury if dropped, burned, punctured, crushed, disassembled, or if exposed to excessive heat or liquid. Don't use damaged batteries and electronic components.

Disposal and recycling information

Don't treat the product and battery as a household waste or into a here. When you decide to dispose of the product and its battery, please follow the local environmental laws to handle the battery to avoid an explosion.

Medical device interference

The product contains components and radios that emit electromagnetic fields and also contains magnets. These electromagnetic fields and magnets may interfere with pacemakers, defibrillator, or other medical devices. Maintain a safe distance of separation between your

Consult your physician and medical device manufacturer for information specific to your medical device. Stop using product if you suspect it is interfering with your pacemaker, defibrillator, or any other medical device.

Listen Responsibly

To avoid hearing impairment, please make sure to turn down the volume of the music player before connecting the earphones. After putting the earphones into/onto the ears, turn up the volume gradually until to a comfortable listening level. Noise level is measured in decibels (db). Exposure to 85db or higher noise will lead to gradual hearing impairment. Please supervise your usage and the hearing impairment is a function of loudness against time. The louder the sound is, the shorter you can be exposed. The softer the sound is, the longer you can listen.