

BRAEMERE MODELS

GREAT BRITISH MODEL KITS

1:32 5th Wheel Dolly



Instruction Manual

1:32 5th Wheel Dolly Model Kit

CLEAN ALL RESIN PARTS IN WARM SOAPY WATER

The silicone release agent used in the casting process will react with paint, it must be thoroughly cleaned off before painting.

This is a guide to using the kit. Care should be taken at each stage to make sure the model is going together correctly and any alterations that are not in the instructions should be carried out.

Glue: Recommended glue is a good quality super glue such as Gorilla Super Glue. I use the Blue Lid Gorilla Super Glue which is readily available from most hardware stores including B&Q and Screwfix. It provides a strong bond, the acrylic around the bond will snap before the bond breaks.

Paint: The instructions will suggest the best point to paint components. A good quality automotive primer or plastic primer followed by automotive acrylic is recommended. Brands such as Hycote or Halfords are likely to be problem free and provide a good finish to your model while being readily available.

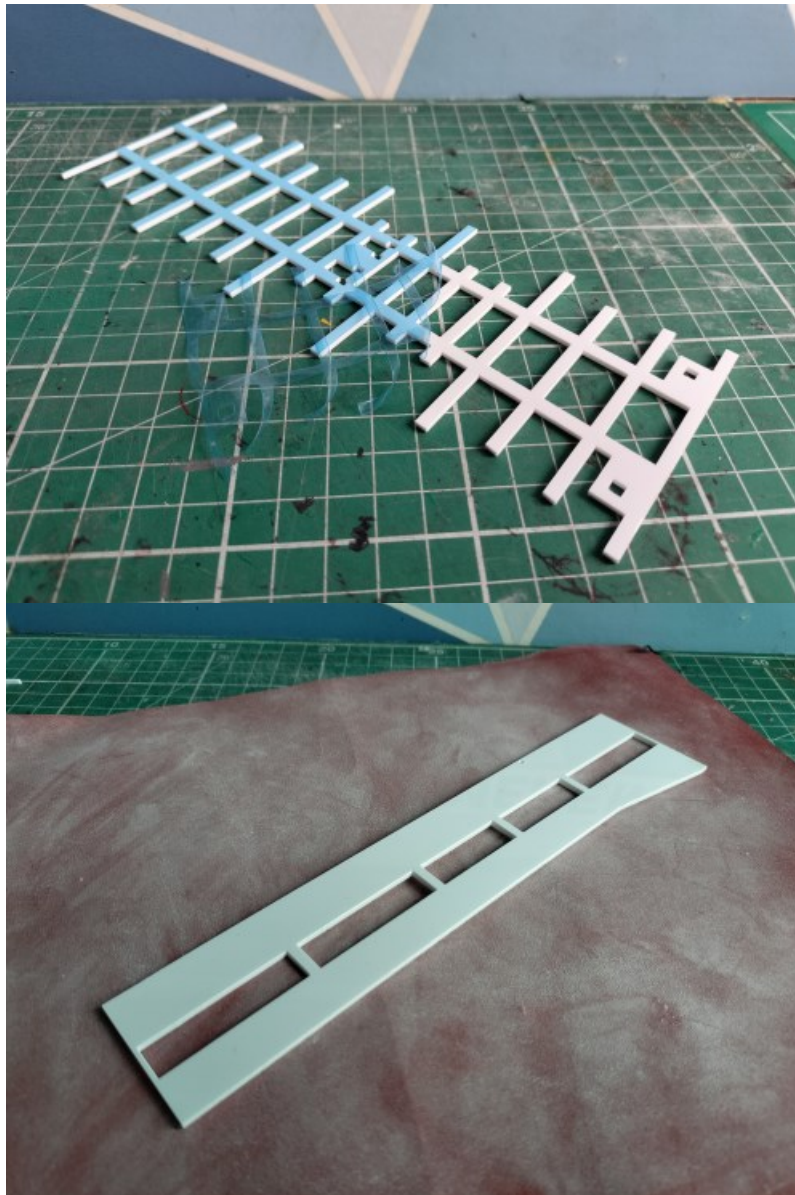

Read all the instructions before building to avoid any unexpected surprises

Step 1: To start with I recommend cleaning the resin parts (wheels and tyres) in a strong washing up liquid solution. Remove any flash from the resin parts too, this is excess resin left over from the casting process where resin is poured into the mould.

Then remove the plastic backing from all acrylic parts and use a knife to cut the small tabs holding each part to the sprue, DO NOT push the parts out, always cut them. Sand back the surface with a fine grit sand paper 220 grit or less. The laser cutting process causes a slight raised edge on most parts that will inhibit strong adhesion. By sanding these edges off a stronger glued bond can be made and the surface of the plastic is improved for paint adhesion. Sharp edges can give a thin paint application that shows as white edges in the final paint.

It is important to take care when sanding as Acrylic is a brittle material and can easily snap. If something does break simply line up the crack lines and glue back together, leave 24hrs before using the part again so the glue can set firmly. Same applies to resin parts.

Step 2: Start the build by gluing part 2 and part 5 to the front of a chassis rail part 1 as pictured.

Then repeat the process at the rear using another part 2 and a part 4

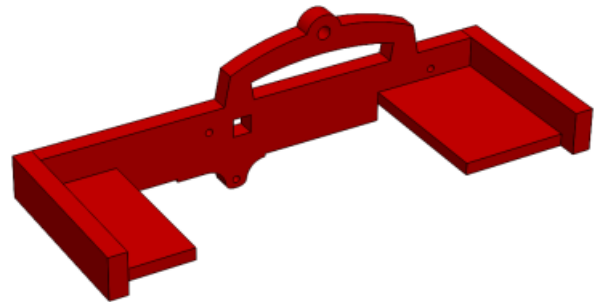
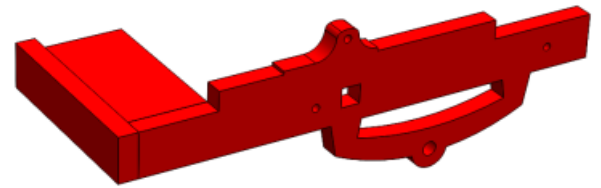

Step 3: Glue the cross member part 6 into the slot in the chassis rail, above this glue the fifth wheel bracket/slider part 3 to the side of the chassis rail.

Once in place glue the other chassis rail on the other side.

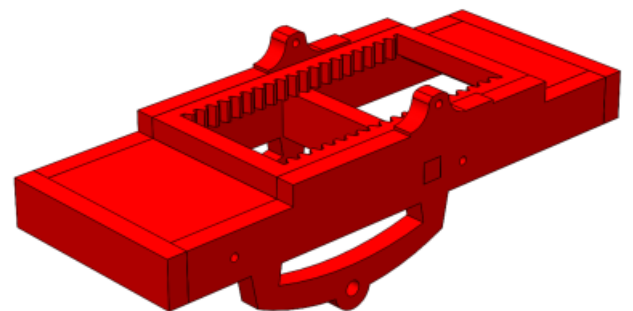
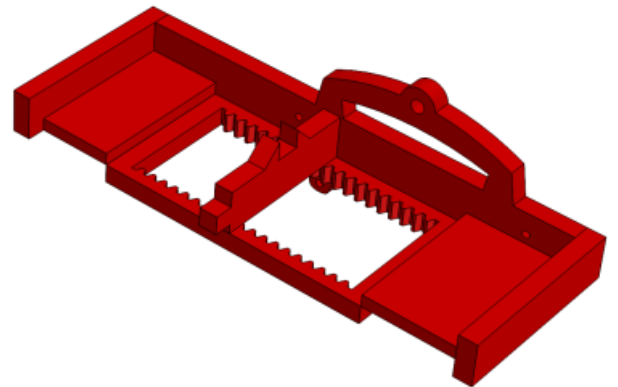

Step 4: Glue the two drawbar parts 7 back to back. Fit the tow eye part 8 in the slot at the front. Then glue the drawbar into its relevant slots and stops on the chassis.

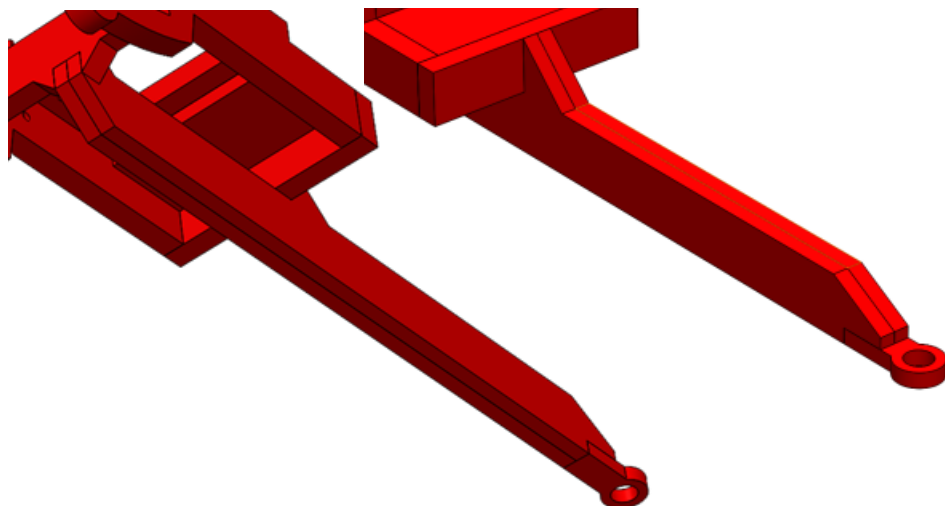

Step 5: Fit the two hinge brackets part 10 to the slots in the fifth wheel part 9.

This is fitted to the chassis with a length of wire, loose fit for now to paint separately. When loosely fitted glue the two guide rails part 11 onto the chassis aligning with the fifth wheel.

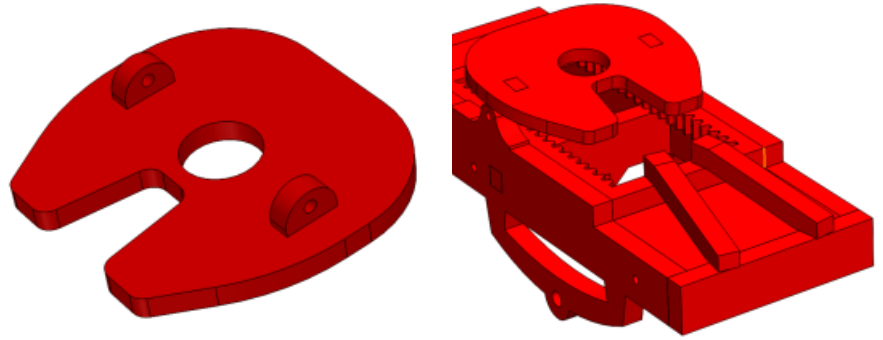

Step 6: If building a modern style dolly glue the pipe head part 14 to the arm part 13.

Glue the three drawbar foot parts 15 back to back and fit under the drawbar. Fit the rear light brackets to the chassis rail as illustrated.

Fit the front marker light brackets to the front of the chassis as shown.

Insert the mudguard poles through the holes in the chassis rail gluing them centrally.

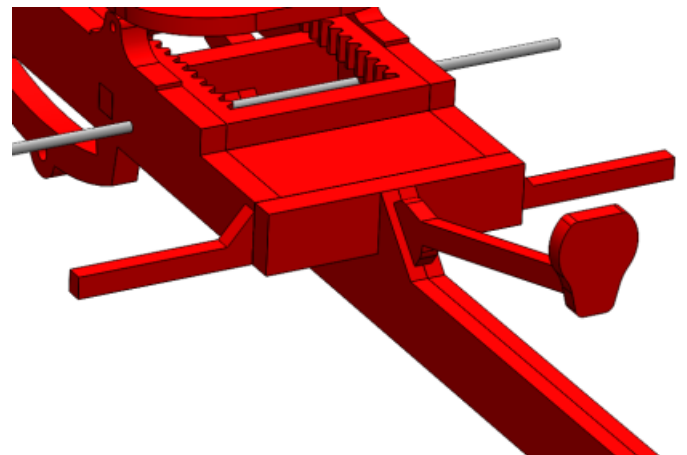
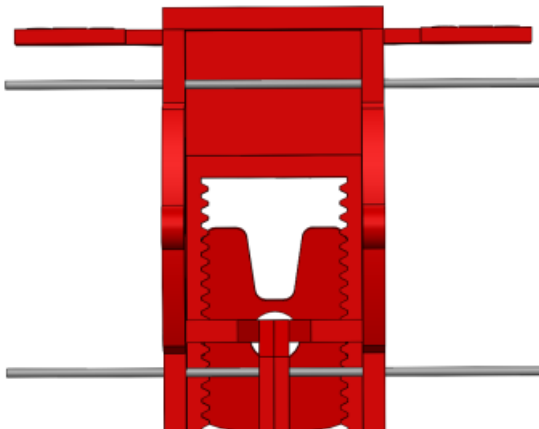
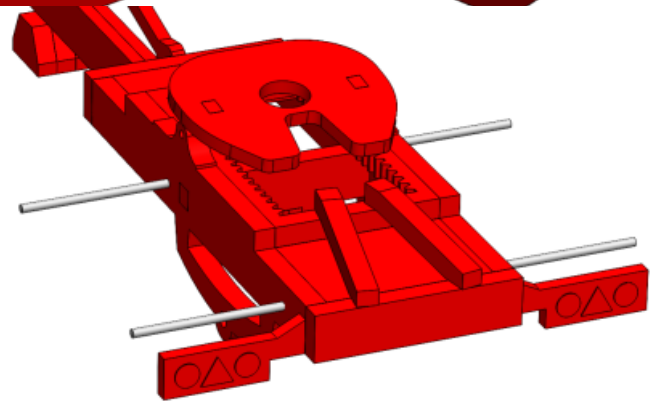
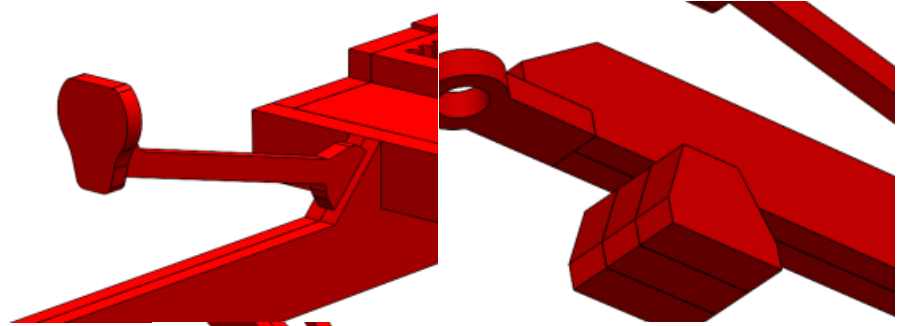



Step 7: Paint the parts. Here we have used Halfords Aerosol Spray Paints. First a coat of Plastic Primer (in this case red because of the top coat colour, see the top coat lid for details on the primer colour to use). Secondly the top coat is applied, here we have used Halfords Peugeot Cherry Red.

The mudguards have been painted in Matt Black (Tamiya XF1) and the rims in silver paint (Tamiya XF16).



Step 8: To mount the fifth wheel make an L shape out of a length of the rod, then thread through the mount holes, bend the other end over to lock in place and trim any excess.



Step 9: For modern versions the mudguards are fixed by gluing along the mounting bracket and lining up with the two wires sticking out of the chassis. Touch up any paint where damaged or smudged by glue.

To fit the wheels place a dab of glue on the end of the axle and insert into the wheel. Then thread through the chassis and glue the opposite sides wheel on.



Step 10: For a vintage look leave the light brackets off and glue the dual wheels as per the floatation's, the hubs for the dual wheels are separate parts to the rim, these can be painted separately then glued in the centres.

This will complete the build. Below are some photos of the finished item to help with assembly.



If you enjoyed this build why not check out our other kits at www.braemermodels.co.uk

BRAEMERMODELSBRAEMERMODELSBRAEMERMODELSBRAEMERMODELSBRAEMERMODELSBRAEMERMODELSBRAEMERMODELSBRAEMERMODELSBRAEMERMODELSBRAEMERMODELS

BRAEMERMODELSBRAEMERMODELSBRAEMERMODELSBRAEMERMODELSBRAEMERMODELS