

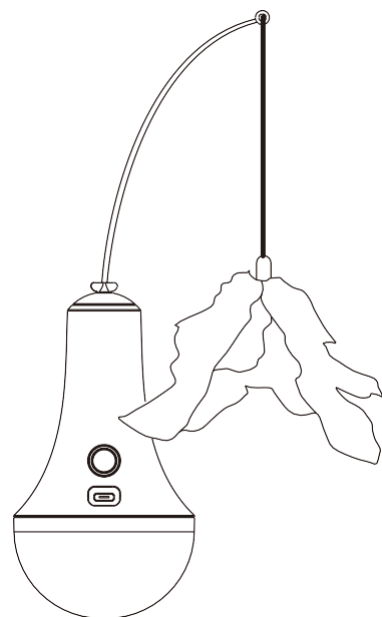

SNOW⁺Roly-Poly Cat Toy Instruction Manual

PS-050



Front

Thanks for buying our product. To ensure you use the product safely and correctly, please read these instructions carefully and thoroughly and save for future use. Please note that we are not responsible for any failure caused by misuse or improper maintenance.

Product Structure

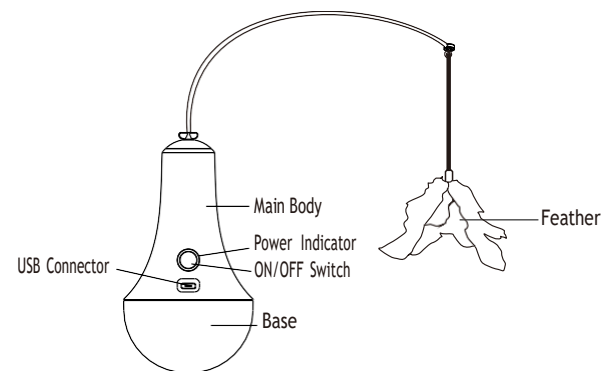

Features:

1. Irregular automatic spinning of the tumbler and the feathers to fascinate cats .
2. Cat teaser is removable to manually tease cats.
3. Quiet motor will not scare cats.
4. Small size cat toy, great for indoor use.
5. Built-in 15-minute shutoff timer to prevent cats from exercising too intensively.

Instructions:

1. Take out the wand and fix it to the pin on the top of the tumbler (refer to the following figure).
2. The power indicator flashes during charging and stays on constantly when fully charged. Please charge the product when the red light turns on.
3. Press the ON/OFF switch; the white light turns on and the tumbler starts to work, automatically shutting off after 15 minutes.

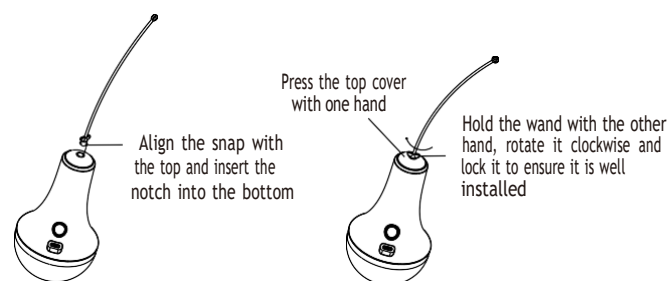

Cautions:

1. This product is not waterproof. Only use it in dry environment.
2. Excessive exercise may hurt the cat's heart. Do not let the cat play with the product for more than 15 minutes.
3. The red light turns on to show low power. Please charge once the red light is on.



Product Information:

1. Material: ABS, PP, Artificial feathers, Nylon String.
2. Product Dimension: Product body (not including the teasing wand and feather) :φ3.14*5.78 in.
3. Ion battery: 1000mAh.

Important Safety Precautions:

1. This product is for pet use only. Children can only use it under adult supervision.
2. If any damage or deformation to the product is found, please discontinue use.
3. Make sure the small-size product components are not swallowed by children or pets.
4. If the product is found to be in less than optimal condition, do not attempt to repair or dismantle it by yourself.
5. Dispose of the product properly to avoid polluting the environment. Do not burn the product, as it will explode.

FCC STATEMENT

This device complies with Part 15 of the FCC Rules. Operation is subject to the following two conditions:

- (1) This device may not cause harmful interference, and
- (2) This device must accept any interference received, including interference that may cause undesired operation.

Warning: Changes or modifications not expressly approved by the party responsible for compliance could void the user's authority to operate the equipment. NOTE: This equipment has been tested and found to comply with the limits for a Class B digital device, pursuant to Part 15 of the FCC Rules. These limits are designed to provide reasonable protection against harmful interference in a residential installation. This equipment generates uses and can radiate radio frequency energy and, if not installed and used in accordance with the instructions, may cause harmful interference to radio communications. However, there is no guarantee that interference will not occur in a particular installation. If this equipment does cause harmful interference to radio or television reception,

which can be determined by turning the equipment off and on, the user is encouraged to try to correct the interference by one or more of the following measures:
Reorient or relocate the receiving antenna.
Increase the separation between the equipment and receiver.
Connect the equipment into an outlet on a circuit different from that to which the receiver is connected.

Consult the dealer or an experienced radio/TV technician for help.

FCC Radiation Exposure Statement:

This equipment complies with FCC radiation exposure limits set forth for an uncontrolled environment.

This equipment should be installed and operated with a minimum distance of 7.87 in. between the radiator and your body.

Technical Specifications

Model	Name	Charging Voltage	Power	Size
PS-050	SNOW ⁺ Roly-Poly Cat Toy	DC5V/1A	3.5W	φ3.14*5.78 in.

Warranty Card

Product _____

Place of purchase _____

Shop address _____

Date of purchase _____ / _____ / _____

Shop signature _____

Purchaser signature _____

The product is warranted to be free of manufacturing and material defects for one (1) year from the date of purchase. Please save your dated original receipt or invoice as evidence of purchase and return the defective item to the point of purchase. Please keep in mind that this warranty does not cover damage caused by accident, misuse, or abuse. It also expressly disclaims any incidental or consequential damages, such as the loss of pets or other livestock as a result of any failure or fault in this product.

Back