

Max Load: 5~8 Kgs

Part List:

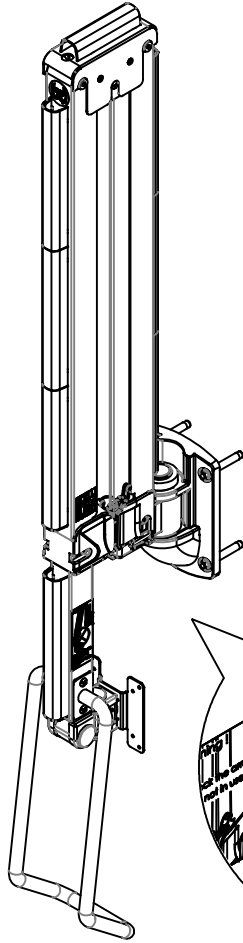

Warning !

Always lock the arm when it is without loading.

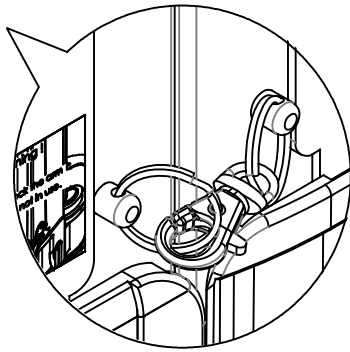

5/16" x 3" 5/16" x 3"
Use only for Concrete Use only for Wood
A. 4pcs/each

For Hollow-Walls:
Only use fasteners designed for the type and thickness of your wall & studs.
Consult a professional in case of doubt.

M4x10
B. 4pcs

C. 1pc

D. 1pc

E. 7pcs

F. 1pc

G. 1pc

M6x12
H. 4pcs

I. 1pc

J. 1pc

Warning !

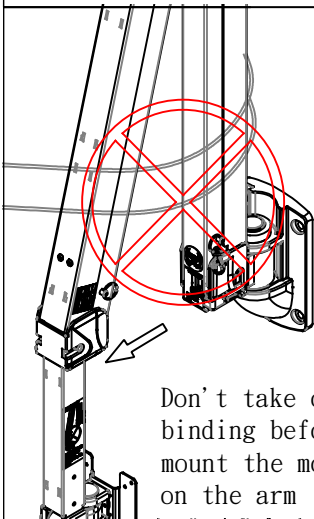

Don't take off the binding before you mount the monitor/TV on the arm !

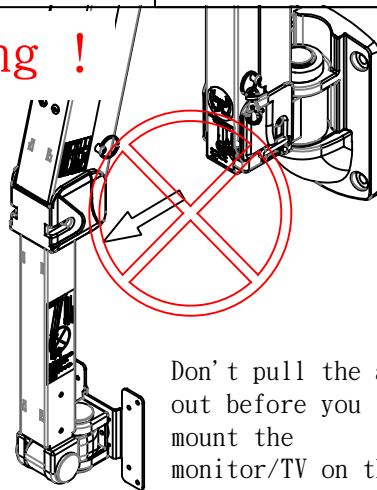

Don't pull the arm out before you mount the monitor/TV on the arm !

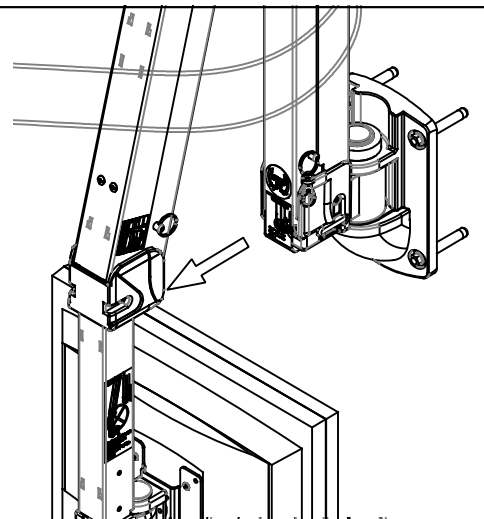

1.

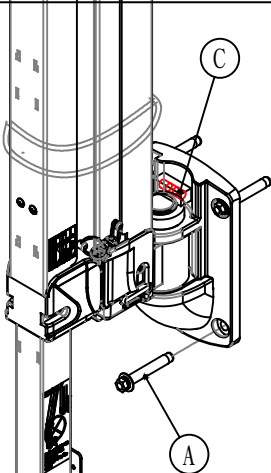

2.

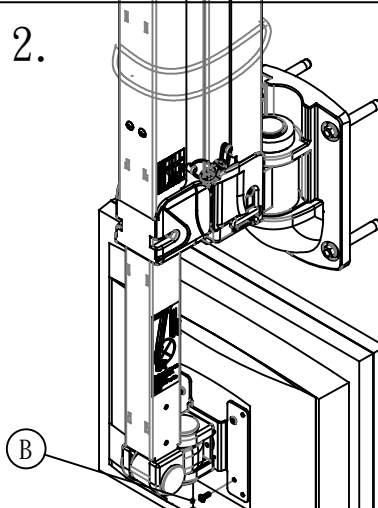

3.

