

System 32[®] Cassette - Roller blind system

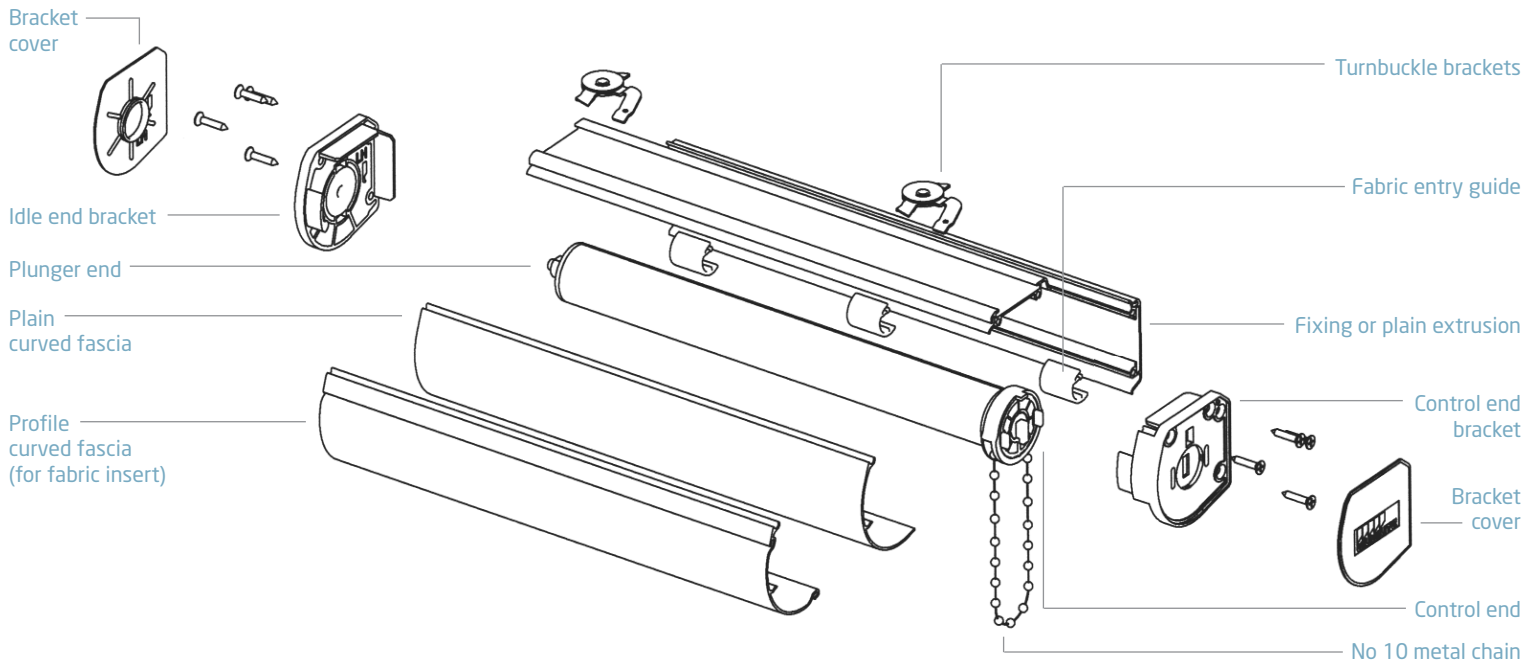

Frame Extrusion - plain or fixing

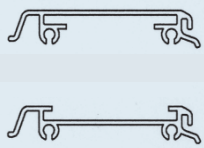

100% Aluminium
5m (5 1/2 yards) lengths
Dimensions: 57mm (2 1/4") x 10mm (5/8")
Wall thickness 1.3mm (1/16")
White painted

Fascia - plain or profile

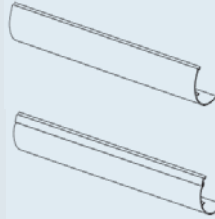

100% Aluminium
5m (5 1/2 yards) lengths
Dimensions: 63mm (2 1/2") x 10mm (5/8")
Wall thickness 1.3mm (1/16")
White painted

Fabric entry guide



Acetal
Dimensions: 20mm (3/4") x 15mm (5/8")
White

Tube

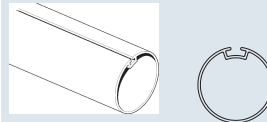

100% aluminium
Lengths: 5m (5.5 yard) maximum
Outside diameter: 32mm (1 1/4"), wall thickness: 1.05mm (1/32"), fabric locating slot: 1, strengthening fin: 4mm (5/32")

Side control end

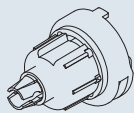

Patented universal side control operating unit featuring stainless steel/bezinal wrap spring clutch mechanism. The control end unit features a locking feature to secure the unit into the bracket.
Sprocket / sprocket guard acetal
Other parts glass filled nylon 6
Spring lock friction system
Unique bracket securing pin
Choice of nylon or metal chain drive
Colour: white

Plunger end

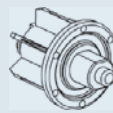

A sprung loaded plunger end allows for quick and easy installation by a single individual, even on larger blinds.
Nylon 6
Colour: white

Turnbuckle bracket



Zinc plated and powder coated
White

Brackets and Bracket Covers

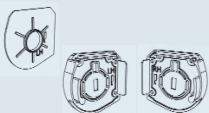

Glass filled nylon
Colour: white

Options

- Spring return roller system
- Easy break chain connector for child safety
- No.10 plastic chain, acetal ball - colour: white or brown
- Metal chain, Zinc plated - colour: silver or gold or stainless steel

CI/SfB 1976 reference by SfB Agency

(76.7) X