

Ü  
TUDALOO

**PRO**  
**User Manual**

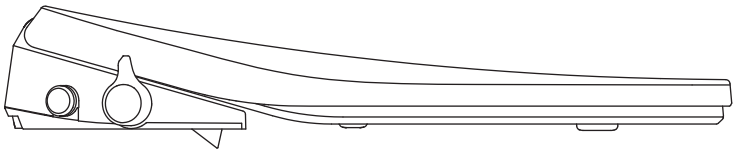

# Contents

---

Safety notes .....	1	<b>Before use</b>
User precautions .....	4	
Component description .....	5	
Installation steps .....	6	<b>Installation and use</b>
Product description .....	10	
Function introduction .....	11	
Cleaning and maintenance .....	14	<b>Other</b>
Troubleshooting .....	16	
Product dimensions .....	18	
Technical specifications .....	19	

# Safety notes

Read the safety instructions carefully before use so as to properly use the product. Note the following warnings relevant to the safety.



Warning



Prohibition



Compulsory observance



Note

Failure to operate pursuant to the above-mentioned warning signs may result in injury or life-threatening risk.

Individuals with physical, perceptual, intellectual limitations, or those lacking in experience and common sense (including children), may not have the capacity or necessary knowledge to use this device unsupervised. Therefore, they should be under the watchful eye of a responsible guardian who can provide guidance on safely operating the product. To prevent accidents, ensure that children do not use the equipment unattended and are kept from playing with the device.

This device adheres to Part 15 of the FCC Rules. Its operation depends on two conditions: (1) It cannot create harmful interference, and (2) it must tolerate any interference it receives, even if it leads to unwanted operation.



Avoid water splashing on the product.

- May result in fire or electric shock.

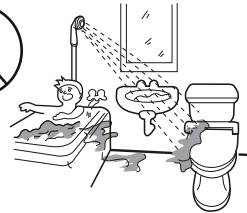

Earthing

Check if the 3-pole grounding structure is grounded.

- The 3-pole grounding structure requires proper grounding to prevent product malfunction or electrical leakage.



Compulsory observance

This product features a Y-type power cord connection. If the power cord becomes damaged, it must be replaced by the manufacturer or qualified technicians to prevent any hazards.



## Safety notes

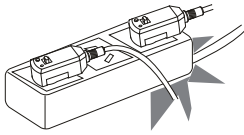
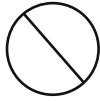

Do not plug this directly into an adapter of any kind.

- May result in overheating or fire.

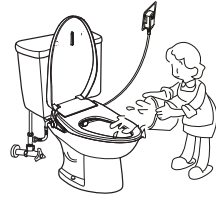
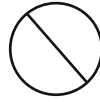

Make sure the power plug stays dry and is not exposed to water, cleaning agents, or urine.

- May result in fire or electric shock.



Do not pull the power plug/ power cord at will.

- May result in fire or electric shock.

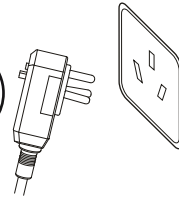

Do not use a loose socket.

- May result in fire or electric shock.

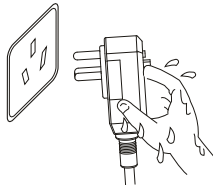
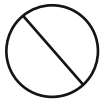

Do not plug/ pull the power plug when the hand is wet.

- May result in electric shock.

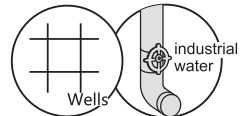
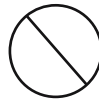

Do not connect to the substandard water pipe.

- May result in skin infections or product damage.

## Safety notes

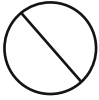

Do not disassemble, repair and modify products by without authorisation.

- May result in fire or electric shock.

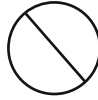

Please unplug the power supply when cleaning the product.

- May result in electric shock.



Avoid placing lit cigarettes or any other items capable of combustion close to the product.

- May result in fire.

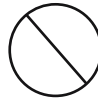

Do not bend or twist the water supply hose.

- May result in water leakage.

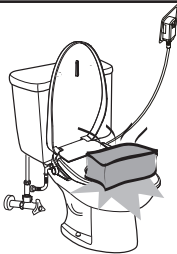

Do not place heavy objects on the toilet seat or the toilet cover

- May result in product damage.

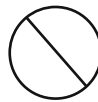

Do not invert product.

- May result in product damage.



Please clean with the diluted kitchen cleaning agent and do not use the following items:  
Benzene, paint thinner, detergent powder, nylon brush, etc.

- May result in product damage.

## User precautions



Do not place this product in direct sunlight.

- It may cause product discolouration and failure of seat heating function.



The room temperature of toilet should be above 0°C.

- Otherwise, it is possible to freeze the product. Use warm air and other methods to improve the temperature in the toilet.



Do not urinate on the bidet body and nozzle.

- May result in blockage.

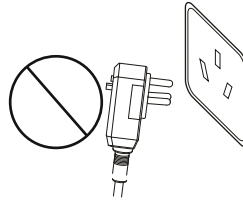

Do not use substandard power supply.

- May cause product failure.

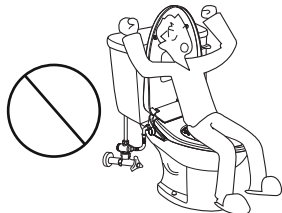

Do not lean against the toilet lid when in use

- May cause damage to the toilet lid.

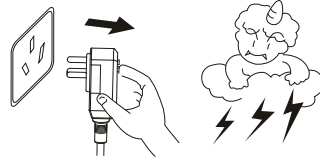

Unplug the device during lightning storms.

- May result in product failure or damage.



When not in use for a long time, drain the stored water and pull the plug.

- Otherwise, water pollution and skin infections may be caused.

# Component description

---

1.Toilet Seat

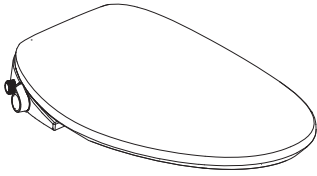

2. Installation template

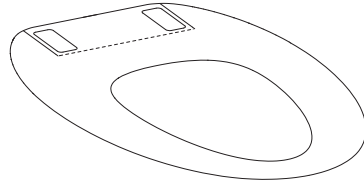

3.Fixation parts



Connecting bolt (2)



Adjustment sheet (2)



Plastic Tab(2)

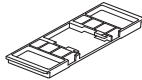

Fixing plate



Rubber bushing(2)

4.T-junction

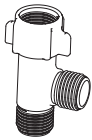

5. Water inlet hose



Filter screen

6. User manual

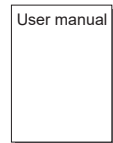

# Installation steps

## • Installation tools



Phillips head screwdriver

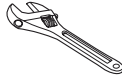

Monkey wrench



Bucket and cloth

## • Attention before installation

1. Water pressure range: 0.1-0.75MPa,
2. Supply valves shall be located close to the location where this product is installed and disassembled.
3. Please use the braided hose that comes with the product to prevent water leakage.
4. When installing braided hose, be careful to prevent the black gasket falling out.

## • Installation Procedure

1. Loosen the nut connection and remove the old lid.



2. Place the mounting template on the ceramic as shown. Align it with the rim of toilet.

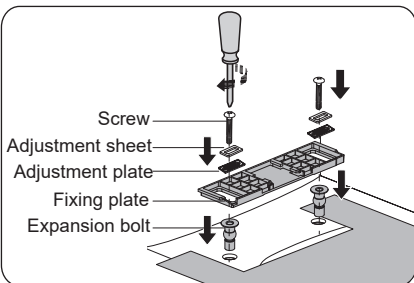
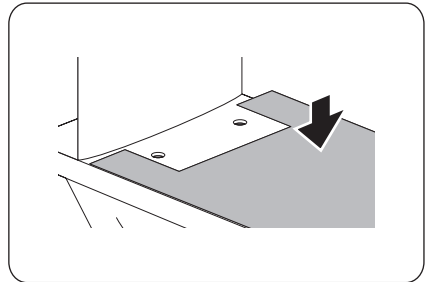

3. ① Insert the expansion bolt into ceramic hole;
- ② Place fixing plate in notch part of template;
- ③ Place adjusting sheet and plate in fixing plate;
- ④ Align expansion bolt hole, and tighten up;



## Installation steps

4. To ensure the normal use of the product, please press reset key before installation;

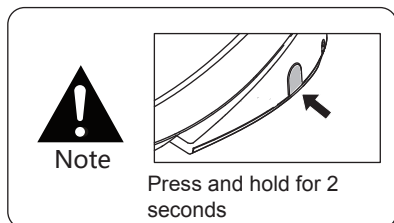

5. Press the cover gently into the fixing plate until a "click" sound confirms it is securely in place.

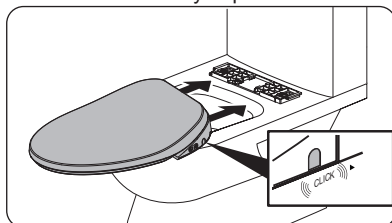

6. Close the water valve;

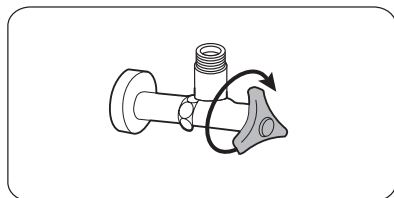

7. Install braided hose;

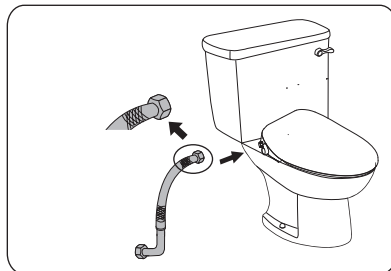
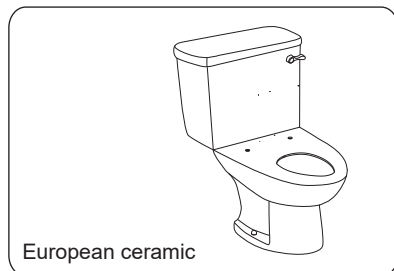

① When the ceramic is similar to the figure above, we suggest connecting the straight end of the hose to the cover

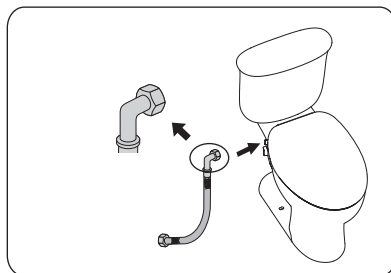
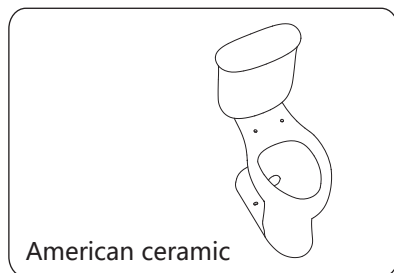

① When the ceramic is similar to the figure above, we suggest connecting the elbow end of the hose to the cover

# Installation steps

## 8. Tee Installation ;

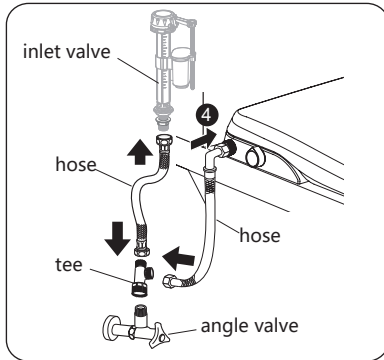

Normally, the tee is installed on the angle valve

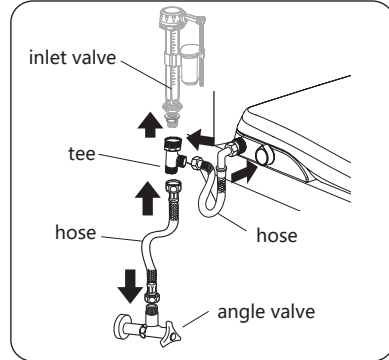

If the angle valve and wall are too close together, you can install the tee beneath the inlet valve.

## 9. Open the angle valve to check for water leakage

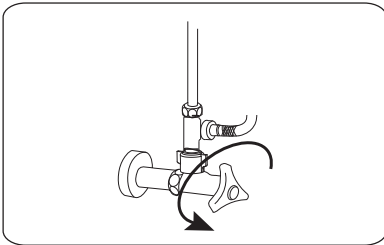

## 10. Turn on the knob to check whether the nozzle is activating

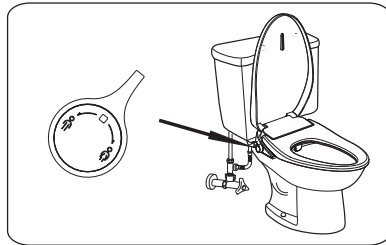

## 11. Plug into a power supply

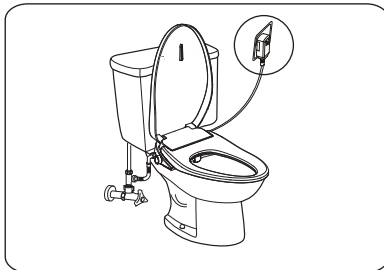

Note

In order to protect the internal circuit, be sure to turn on the knob to make the water run before plugging the device into a power source.



Prohibition

1. It is strictly prohibited to move the product from the toilet cover while in operation as this may cause mechanical failure.
2. It is strictly prohibited to connect water hotter than 40°C or cold water that may lead to freezing.

# Product description

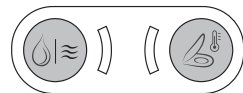
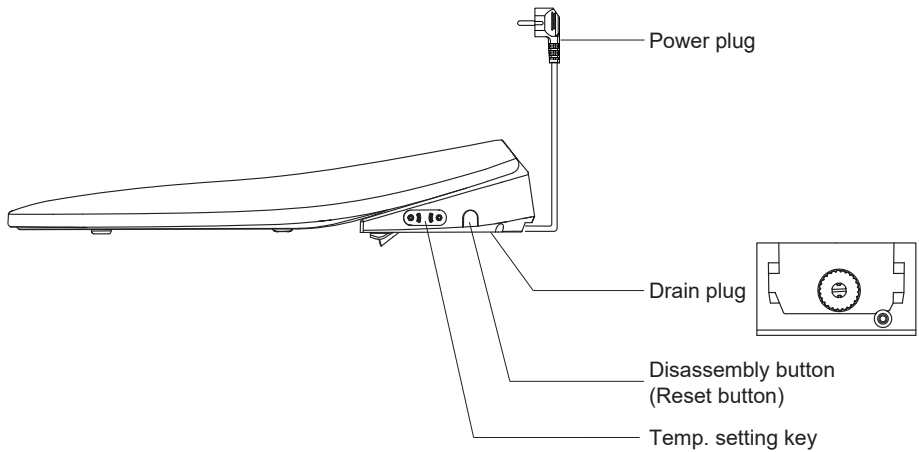
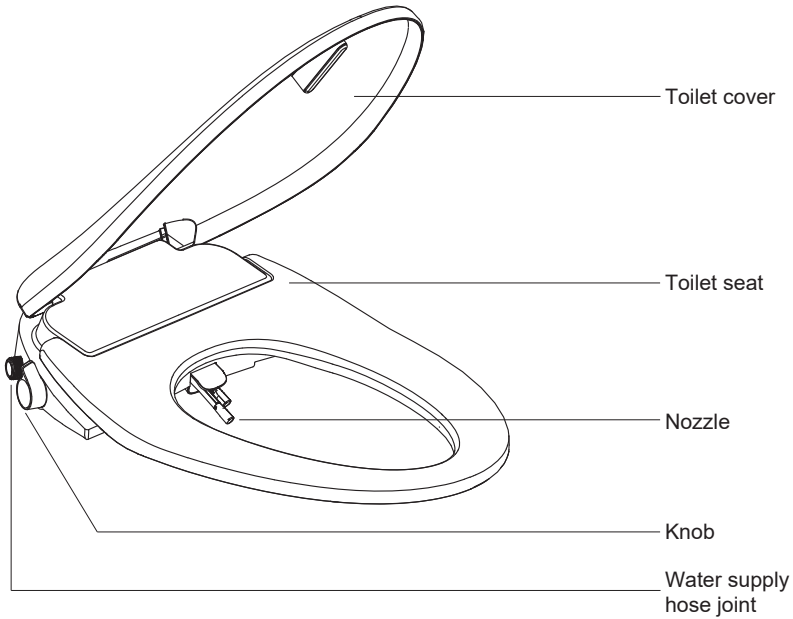

water/wind    seat

# Function introduction

## • Standby mode

1. After the power supply is connected, the “bi” indicates that the cover can be used normally.
2. Water temperature by default at low gear: about 35°C.
3. Seat temperature by default at low gear: about 33°C.

## • Rinsing function

### 1. Bidet/Douche

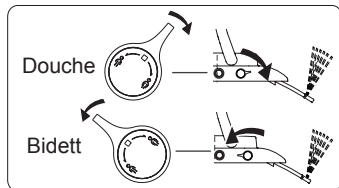

After sitting down, there is a beep prompt, rotate the knob to start rinsing.

### 2. Self-cleaning

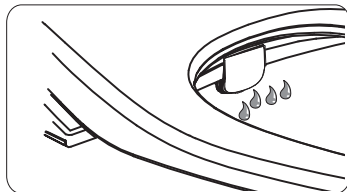

After sitting down, rotate the knob to activate the self-cleaning feature..

## Attention: close the knob after cleaning!

## • Key function

Breath lamp flashes when cleaning

Breathing lamp

Key

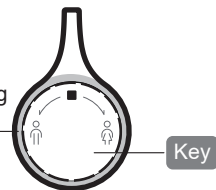

### 1. Lighting Settings

Press , you can set the light cycle, and there will be a sound prompt when switching

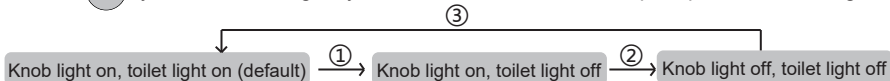

### 2. Cleaning setting

When cleaning, press  to set the cleaning mode in a cycle

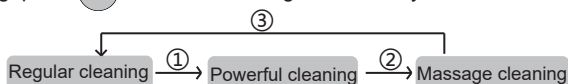

### 3. Warm air setting

① After rinsing, press  to activate the warm air function

② Turn off warm air: A. It will automatically close after 4 minutes.

B. It can be automatically closed when you stand up.

C. Press  again to close;

# Function Setting

## • Description of function

**Function setting key**

Lighting

Water/wind temp. setting key

Lighting

Seat temp. setting key

TIP

OFF      LOW      HIGH

- Repeatedly press to switch over water temp. in the sequence indicated in the left figure.
- Change water temp. : a short sound.  
Turn off water temp. : a long sound.
- Low : approx 35°C.  
High : approx 38°C.

- Repeatedly press will switch over wind temp. in the sequence indicated in the left figure.
- Change wind temp. : a short sound.  
Turn off wind temp. : a long sound.
- Low : approx 33°C  
Mid : approx 38°C  
High: approx 43°C.

- Repeatedly press to switch over seat temp. in the sequence indicated in the left figure.
- Change seat temp. : a short sound.  
Turn off seat temp. : a long sound.
- Low: approx 33°C  
High: approx 37°C.

## • Protection functions:

1. Anti-splash function:  
When the knob is not completely closed, it will alarm and automatically switch to self-cleaning.
2. Water temperature protection function
  - (1)When the water temperature exceeds 43°C, it will automatically switch to self-cleaning.
  - (2)At this time it must be reconnected to the power supply to reset product.
3. Low temperature scalding protection function:  
After seated for 5min, the seat temp. will automatically switch to Low temp. scalding protection

## Power Outages:

When the power is off, adjustments to water and seat temperatures are unavailable, but rinsing with ambient temperature water remains operational.

## Cleaning and maintenance

### • Manual cleaning of spray tube

- Carefully extend the nozzle and use a soft cloth, sponge, or small brush dipped in neutral detergent.
- With gentle support, clean both the spray tube and nozzle.

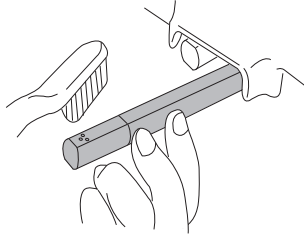

### • Clean filter screen

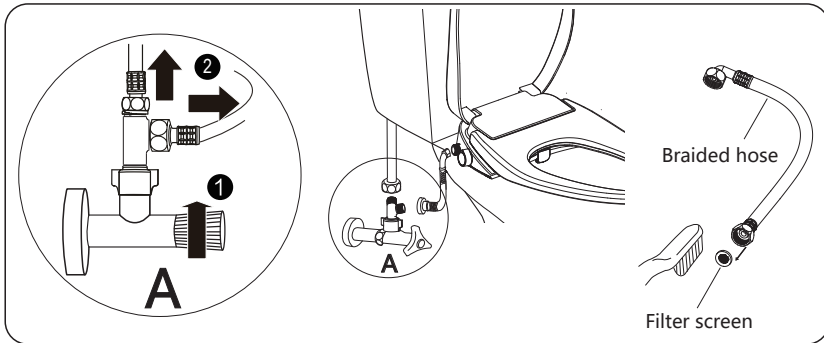

### **i** Tips:

- Ensure the corner valve is closed and the power is turned off before cleaning the filter screen.
- Clean the filter screen if you notice the water flow is weaker than usual.
- Completely disconnect the product from the water inlet hose before starting the cleaning process.
- After cleaning, reattach the filter screen following the steps in reverse.

### • Product surface cleaning

#### **⚠** Note: Please cut off power supply before cleaning.

- Clean the product's surface using a sponge or soft cloth moistened with room-temperature water or a mild detergent.
- For cleaning other parts with cleaning agents, lift the upper cover and the seat ring.
- Ensure the cleaning agent on the ceramic toilet is fully rinsed off before replacing the cover to prevent surface corrosion from the cleaning agent's evaporation.

# Cleaning and maintenance

---

## • Product maintenance in winter

When the temperature of room is below 0°C :

- Unplug the device.
- Disconnect the water inlet hose from the angle valve to the toilet, and drain the hose completely.
- Unscrew the bottom nut to release any water inside.

## • If not using

When this product is not used for a long time, drain the water in the product and cut off the power supply:

- Unplug the power cord.
- Shut off the angle valve to halt the water supply.
- Detach the water inlet hose from the angle valve to the toilet, and drain any remaining water from the hose.
- Close the upper cover, press and hold the removal button, slide the electronic seat cover forward to remove it.
- Store the cover in a cool, dry place if it will not be used for an extended period.

# Troubleshooting

## • Common fault diagnosis

When you think it is a fault, try some of the following methods. If the product is still not working properly, contact your local repair center or call the service hotline.

Check power supply	Check water supply
1.If power supply is under normal state. 2.Manual reset thermostat (Installation step 4)	1.If water supply is under normal state. 2.If corner valve is closed.



**Note: When water leakage occurs, close the angle valve and cut off the power supply.**

## • Water leakage analysis

Issue	Possible cause	Solution
When person leaves the seat, the product alarms and water outlet continues to leak	Knob is not closed	Close the knob
	Control valve has failed	Cut off the power supply, close the angle valve and contact the after-sales department for replacement.

## • Analysis of rinsing failure

Issue	Possible cause	Solution
There is no water when the knob is turned on	The inlet hose folds, causing blockage	Close the Angle valve and reinstall the inlet hose
After turning on the knob, the spray rod does not extend, but continues to flow	Self-cleaning nozzle before rinsing	Wait a few seconds
	Didn't sit on interaction area	It is necessary to sit on the interaction area of the seat (there is a drip sound prompt), and then turn on the knob again
	Abnormal water temperature, product over-temperature protection	Pull out the power plug to reset and reconnect the power after 5 seconds,
	Abnormal temperature sensor. Water vapor enters the product during use or cleaning in an environment without dry/wet separation, resulting in temporary short circuit	Please leave the product in a dry environment for 1-2 days, and reconnect the electricity to restore normal use. If the fault is still there, please contact the after-sales service for maintenance or replacement.
After turning on the knob, spray rod does not extend, a lot of water into the toilet	Abnormal pressure, product switch to pressure relief mode	Please close the Angle valve, remove the hose, check whether there is any foreign matter in the filter screen at the inlet of the product, reinstall the hose, open the Angle valve, and then open the knob to the maximum.
Cleaning pressure is weak	There are impurities in the water. The filter screen is blocked	Please clean the filter screen of the hose and the filter screen of the product inlet according to the maintenance instructions
Spray rod can be normally extended to wash but no warm water	The product is not connected to power supply	Plug the product into the power socket and check whether the indicator light of the plug is on
	The water temperature function is turned off	Turn on the water temperature function by pressing the key
	The product over-temperature protector is disconnected, so reset operation is needed	Press the product disassembly button to and hold it for two seconds (installation step 4)



# Troubleshooting



## • Failure analysis of seat

Issue	Possible cause	Solution
The seat is cold	The seat heating is turned off	Turn on the heating function in advance
Temperature drops when rinsing	The product started the low temperature scald prevention function	After cleaning, the setting temperature will rise again

## • Failure analysis of light

Issue	Possible cause	Solution
Night light is not ON.	Night light is turned off or damaged	Reconnect to the power supply, if the fault still exists contact the after-sales department for replacement
Knob light is not ON	Knob light is turned off or damaged	

## • Failure analysis of air dryer

Issue	Possible cause	Solution
Press  without response	Didn't sit on interaction area	Stay seated while activating air dryer
	Can't use warm air during rinsing	Press  after you stop cleaning
	Fan fault	Unplug the power and close the valve, please contact the after-sales service for maintenance or replacement.
No warm wind	Over temperature protection	Unplug the power plug, wait 5 minutes, reconnect to the power supply. If the failure is still the same, please unplug the power supply, close the Angle valve, contact the after-sales service

# Product dimensions

- Product dimension drawing

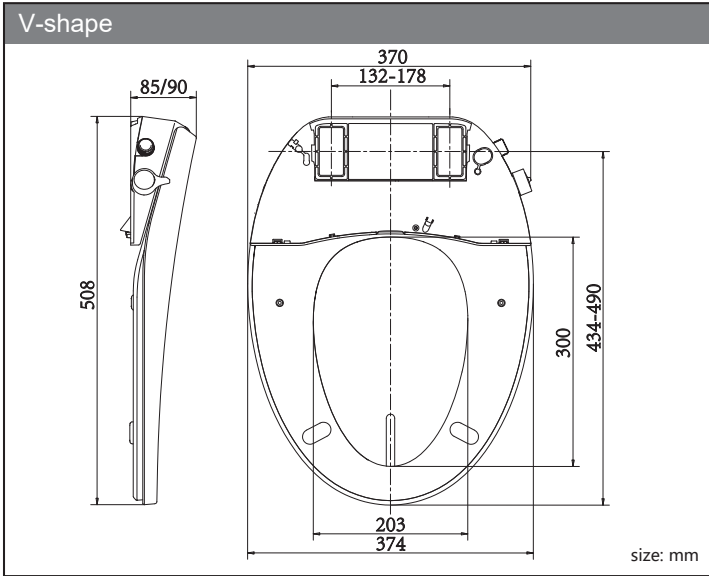

# Product technical specification

Items		Description
Rated voltage		220-240V~, 50Hz
Rated power		1050W
Length of power chord		1.5m
Water supply pressure		0.1 ~ 0.75MPa(Static pressure)
Water supply temperature		5 ~ 35°C
Ambient temperature		0 ~ 40°C
Waterproof grade		IPX4
Cleaning device	Water amount regulation	Stepless regulation
	Water temperature regulation	Gear 3: about 35/38 °C/OFF
	Heating method	Instant heating
	Protective device	Anti-siphon valve + anti-backflow valve
	Safety device	Double thermostat
Warm seat	Surface temperature	Gear 3: about 33/37 °C/OFF
	Heater power	50W
	Safety device	Thermostat & fuse
Warm wind	Wind temperature	Gear 3: about 33-43 °C (The specific temp. is slightly different depending on the ambient temp.)
	Heating wire power	180W
	Safety device	Thermostat + fuse
Others	Massage rinse	YES
	Antibacterial material	Nozzle and seat
	Low temperature scalding protection	YES
	Abnormality prompt	Alarm sound
	Control operation	Knob
	Auxiliary key	Water temperature and seat temperature setting
	Seat sense	YES
	Light control	YES

Rated power:

Under the ambient temp. of 23±2°C and the inlet water temp. of 15±1°C, the product starts to power up and start up, and the water temp. and setting temp. are adjusted to top grade. Turn on the hip wash function for testing (the reference flow rate is about 600ml/min). The measured product works continuously and stably Average power of cleaning cycle (3 minutes)