

P	LTR	DESCRIPTION	DATE	DWN	APVD
B1		REVISED PER ECO-11-005301	07MAR11	RK	HMR

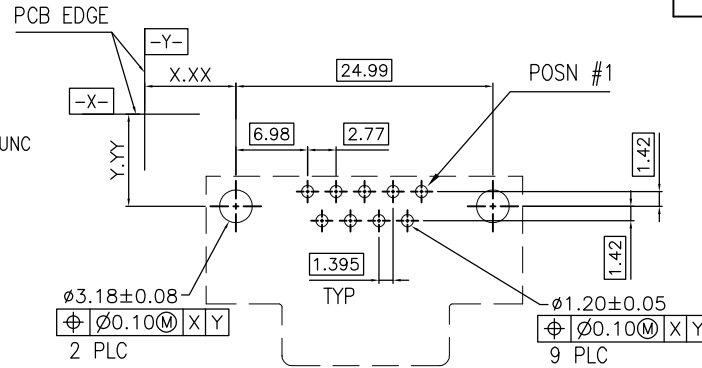

NOTES:

- MATERIAL:
 - HOUSING: THERMOPLASTIC, UL 94V-0 RATED, BLACK
 - CONTACTS: PHOSPHOR BRONZE
 - SHELL: SPCC
 - BOARDLOCKS: BRASS
 - RIVET: COPPER ALLOY
- FINISH:
 - CONTACT:
 - GOLD PLATING ON CONTACT AREA
 - 2.54µm[100µ"] MIN. MATTE TIN PLATING ON SOLDER TAIL AREA
 - 1.27µm[50µ"] MIN. NICKEL UNDERPLATING OVERALL
 - BOARDLOCK:
 - 2.54µm[100µ"] MIN. MATTE TIN PLATING
 - 1.27µm[50µ"] MIN. NICKEL UNDERPLATING OVERALL
 - SHELL: NICKEL PLATED
 - RIVET: NICKEL PLATING OVERALL
- RECOMMENDED PCB THICKNESS: 1.6 mm
- WAVE SOLDER CAPABLE TO 265°C PER TE CONNECTIVITY SPEC. 109-202, CONDITION B.
- THE SCREW TORQUE FORCE APPLIED: 7.0 Kgf-cm MAX.
- NET WEIGHT: 7.03 gram/pc OR 11.0 gram/pc(WITH SCREW)

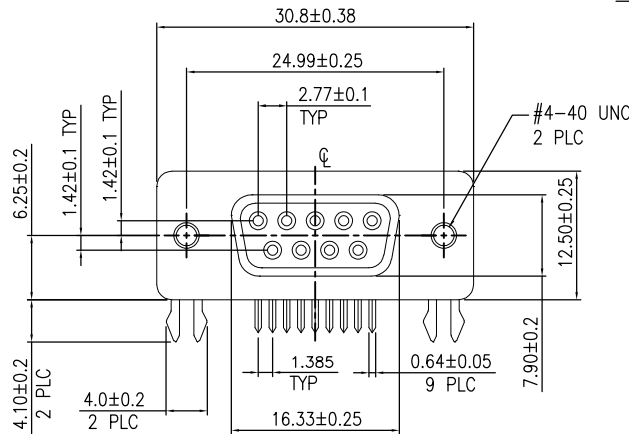
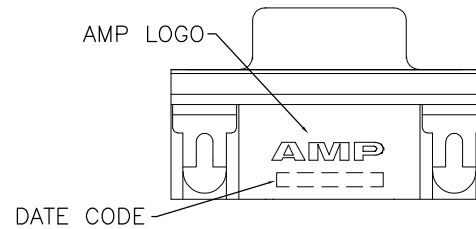
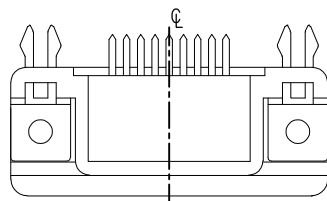
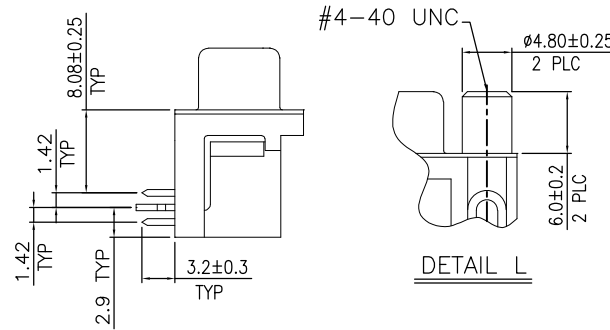
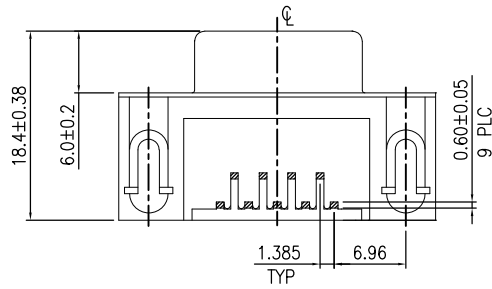

(SEE DETAIL L)	OBSOLETE	W/	15µ"	1-1734348-2
		W/O	15µ"	1734348-2
			G/F	1734348-1
	SCREW	GOLD PLATING		PART NO.

THIS DRAWING IS A CONTROLLED DOCUMENT.		DWN J. LEE 11JUL2007														
		CHK S. HOU 11JUL2007														
DIMENSIONS: MM		APVD W.J. KE 11JUL2007	NAME													
TOLERANCES UNLESS OTHERWISE SPECIFIED:		PRODUCT SPEC	RECEPTACLE ASSEMBLY, 9 POSN, RIGHT ANGLE, 8.08mm[0.318in] SERIES, AMPLIMITE													
<table border="1"> <tr><td>0 PLC</td><td>±</td></tr> <tr><td>1 PLC</td><td>±0.38</td></tr> <tr><td>2 PLC</td><td>±0.25</td></tr> <tr><td>3 PLC</td><td>±0.15</td></tr> <tr><td>4 PLC</td><td>±</td></tr> <tr><td>ANGLES</td><td>±</td></tr> </table>		0 PLC	±	1 PLC	±0.38	2 PLC	±0.25	3 PLC	±0.15	4 PLC	±	ANGLES	±	QUALIFICATION TEST REPORT	SIZE CAGE CODE DRAWING NO RESTRICTED TO	
0 PLC	±															
1 PLC	±0.38															
2 PLC	±0.25															
3 PLC	±0.15															
4 PLC	±															
ANGLES	±															
MATERIAL SEE NOTE		FINISH SEE NOTE	501-57613													
		WEIGHT SEE NOTES	A3 00779 C-1734348													
		CUSTOMER DRAWING	SCALE	SHEET 1 OF 2 REV B1												

THIS DRAWING IS UNPUBLISHED. RELEASED FOR PUBLICATION
 © COPYRIGHT - BY - ALL RIGHTS RESERVED.

LOC	DIST	REVISIONS			
P	LTR	DESCRIPTION	DATE	DWN	APVD
		SEE SHEET 1.	-	-	-

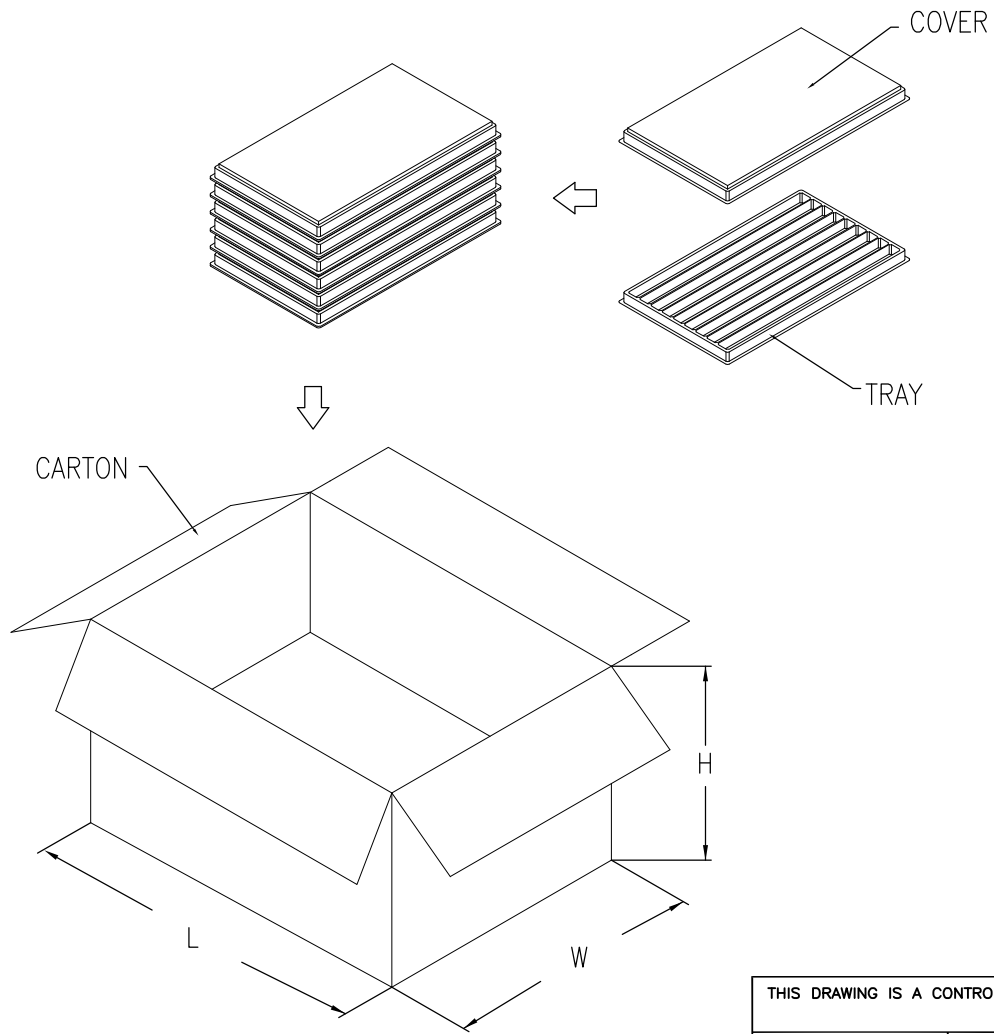

- NOTES:
- MATERIAL:
 - 1.1 TRAY: PVC
 - 1.2 SHIPPING CARTON: CORRUGATED FIBERBOARD
 - DIMENSION:
 - 2.1 TRAY: L=340, W=228, H=15
 - 2.2 SHIPPING CARTON: L=440, W=321, H=153
 - QUANTITY:
 - 3.1 PRIMARY PACKING: 90 PCS/TRAY
 - 3.2 SECONDARY PACKING: 11 TRAY/CARTON (990PCS)
 - SHIPPING CARTON WEIGHT:
 - 4.1 NET WEIGHT: 6.962 Kg OR 10.8 Kg(WITH SCREWS)
 - 4.2 GROSS WEIGHT: 7.962 Kg OR 11.8 Kg(WITH SCREWS)

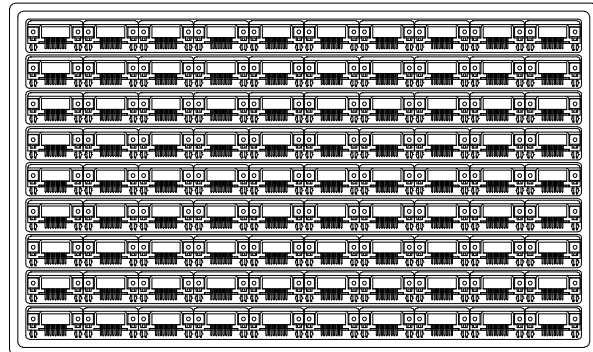

THIS DRAWING IS A CONTROLLED DOCUMENT.		DWN -			
		CHK -			
DIMENSIONS:		TOLERANCES UNLESS OTHERWISE SPECIFIED:		NAME	
MM				RECEPTACLE ASSEMBLY, 9 POSN, RIGHT ANGLE, 8.08mm[0.318in] SERIES, AMPLIMITE	
		0 PLC ±		PRODUCT SPEC	
		1 PLC ±		-	
		2 PLC ±		APPLICATION SPEC	
		3 PLC ±		-	
		4 PLC ±		WEIGHT	
		ANGLES ±		-	
MATERIAL		FINISH		SIZE	
-		-		A3 00779	
				DRAWING NO	
				C=1734348	
				RESTRICTED TO	
				-	
CUSTOMER DRAWING		SCALE		SHEET	
		-		2 of 2	
				REV	
				B1	