

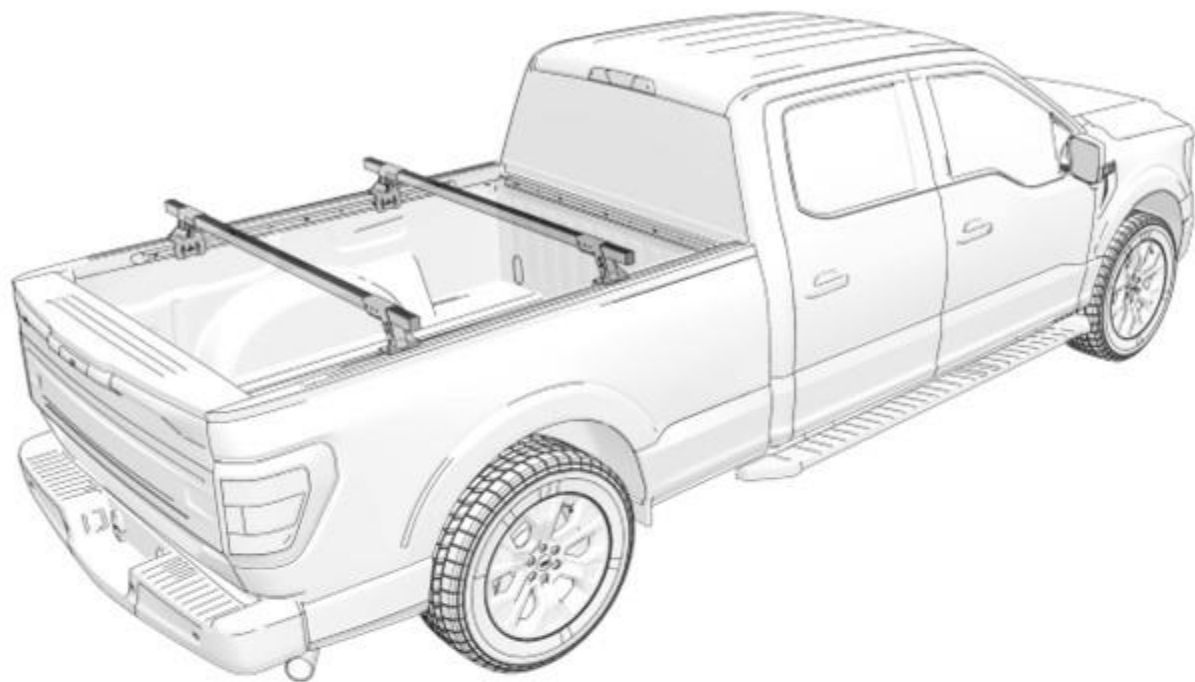

ApexOEM

321111 / 321112-CROSS BARS



INSTALL TIME: 1 HOUR

TOOLS REQUIRED

A	RATCHET
B	7/16" SOCKET
C	5/32" ALLEN KEY
D	SAW

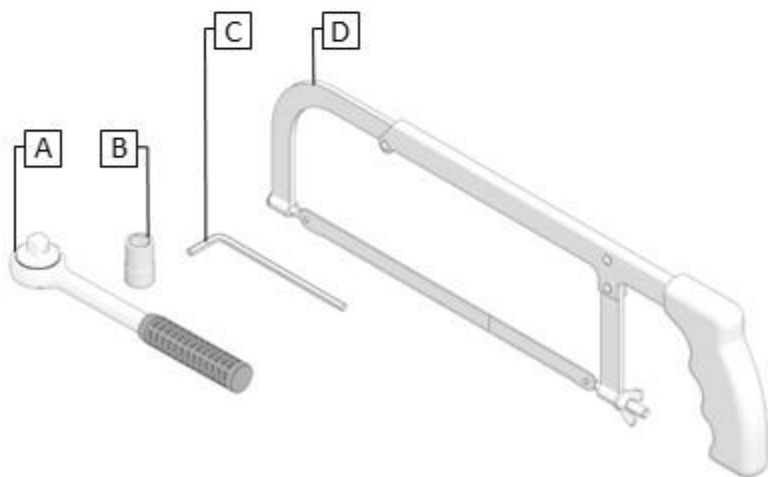

PARTS LIST

ITEM	QTY.	DESCRIPTION	PART NO.
1	4	BASE BRACKET ASSEMBLY	32111-1006
2	4	TOP CHANNEL BRACKET	32111-1000
3	2	CROSS BAR	32111-1001
4	2	CHANNEL COVER	32111-1008
5	4	SHORT BASE BAR	32111-1005
6	4	TALL BASE BAR	32111-1004
7	4	BASE BRACKET PAD	32111-1007
8	8	THREADED SPACER	321127-1002
9	4	CHANNEL END CAP	X20173121
10	4	LOCK PLATE	A000-115-B
11	4	DOUBLE STRUT NUT ASSEMBLY	201425-02
12	16	SINGLE STRUTNUT	191425-01
13	40	FLAT WASHER	
14	16	SPLIT LOCK WASHER	
15	16	¼"-20 X ¾" BUTTON HEAD SCREW	
16	8	¼"-20 X 1" BUTTON HEAD SCREW	
17	8	¼"-20 X 1" FLAT HEAD SCREW	
18	8	¼"-20 X ¾" HEX HEAD SCREW	
19	4	CLAMP BRACKET	
20	8	¼"-20 X 1 ½" SQUARE NECK BOLT	
21	8	¼"-20 LOCK NUT	

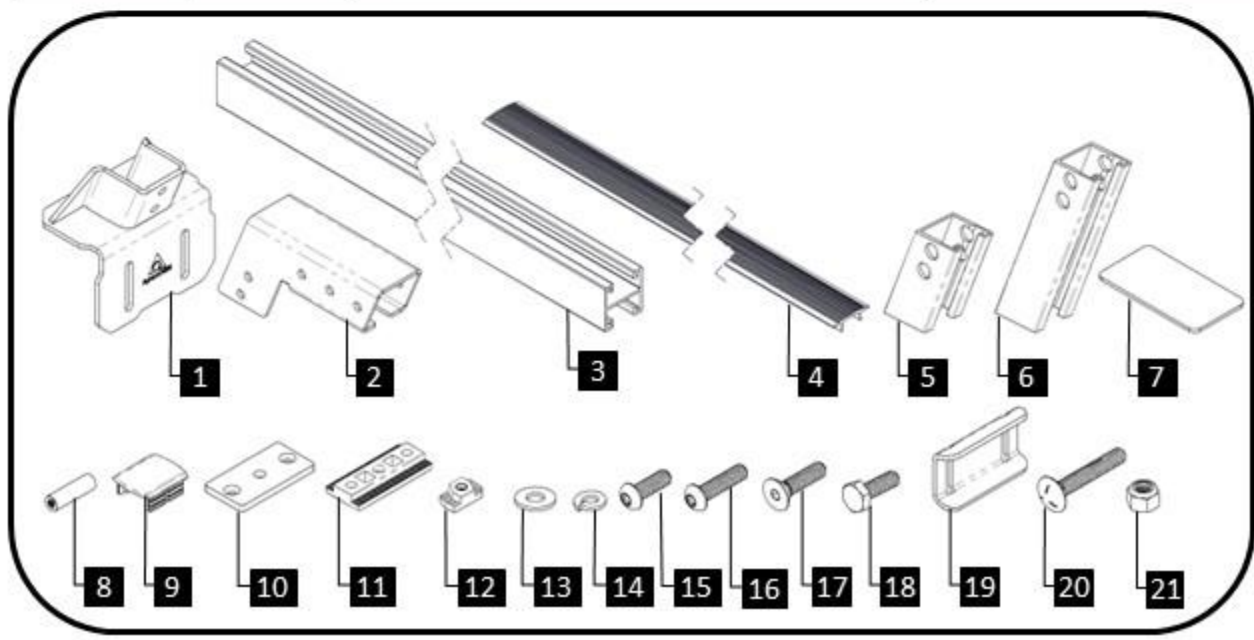

1

ASSEMBLE BASE AS SHOWN 4X.
USING 5/32" ALLEN KEY.

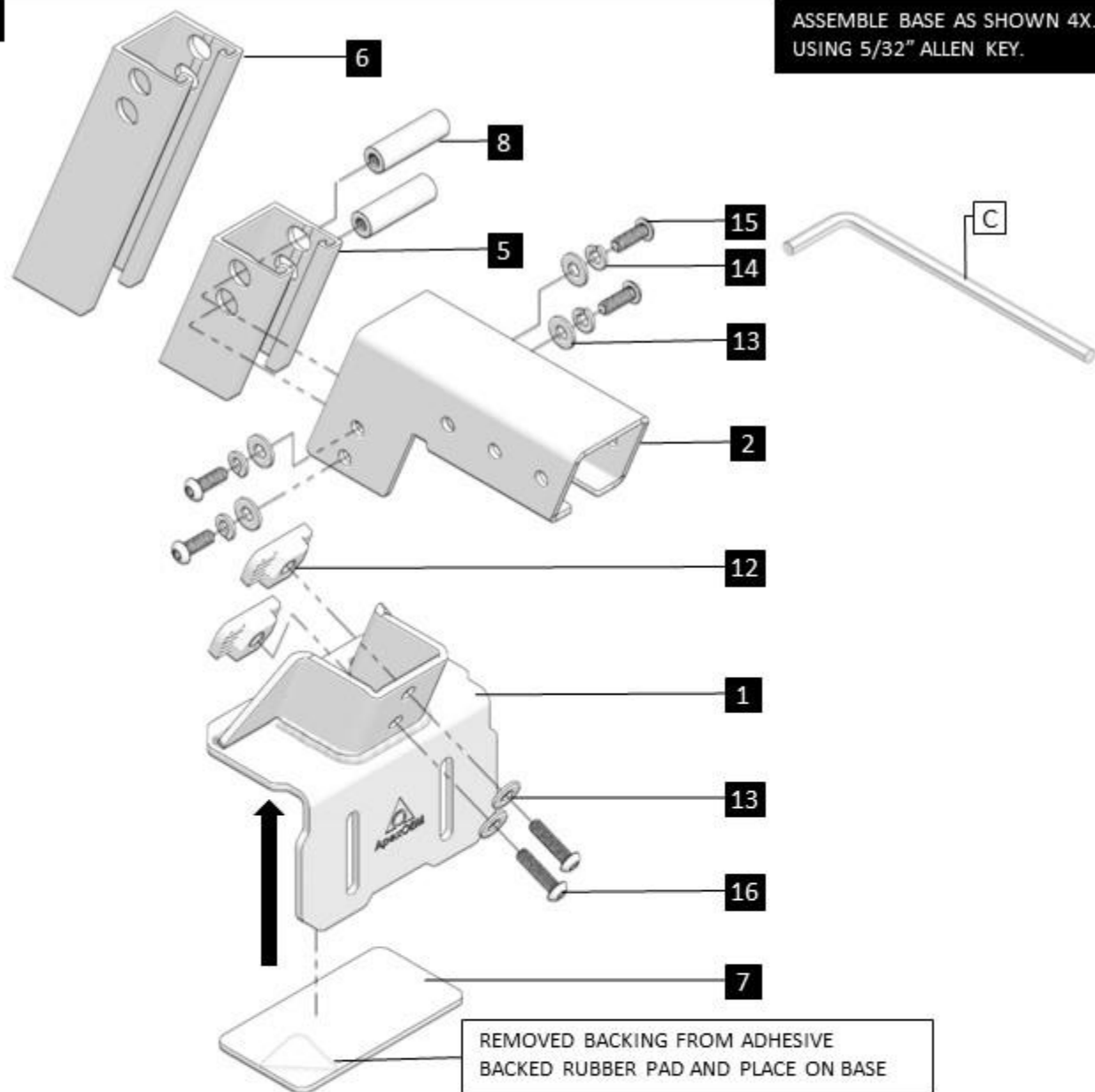

ASSEMBLED BASE SHOWN WITH SHORT BASE BAR.



ASSEMBLED BASE SHOWN WITH TALL BASE BAR.



2

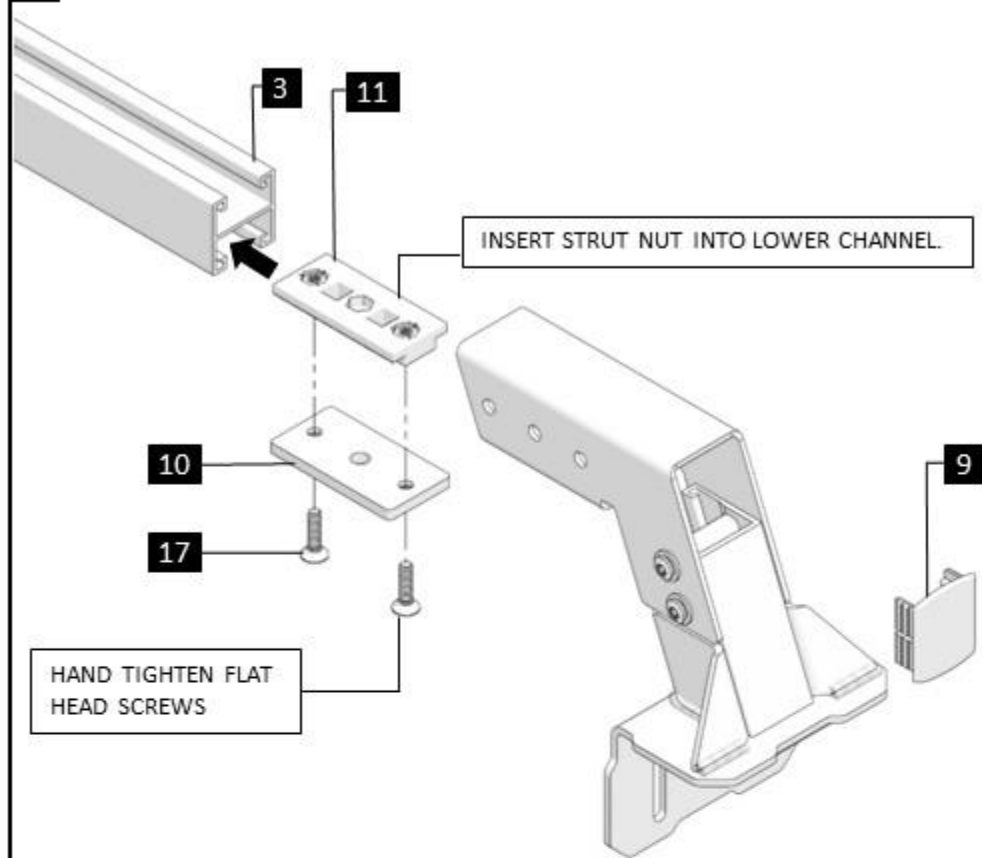

3

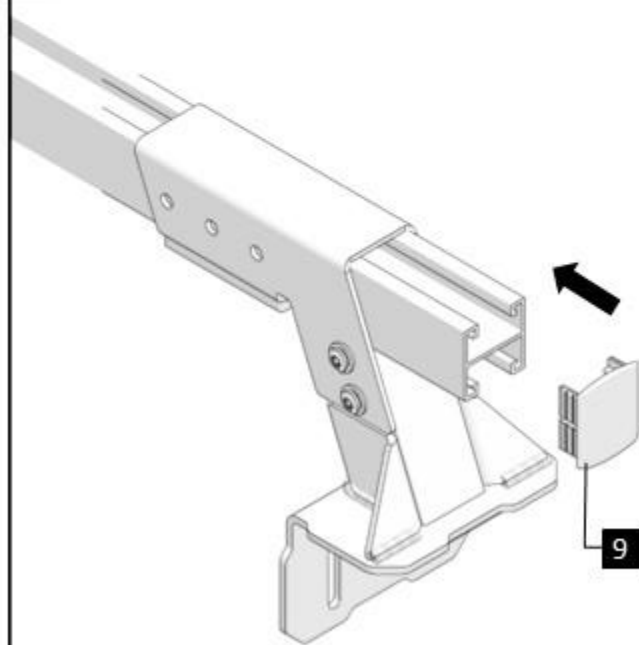

SLIDE CROSS BAR THROUGH BASE AND PRESS END CAP INTO PLACE.

4

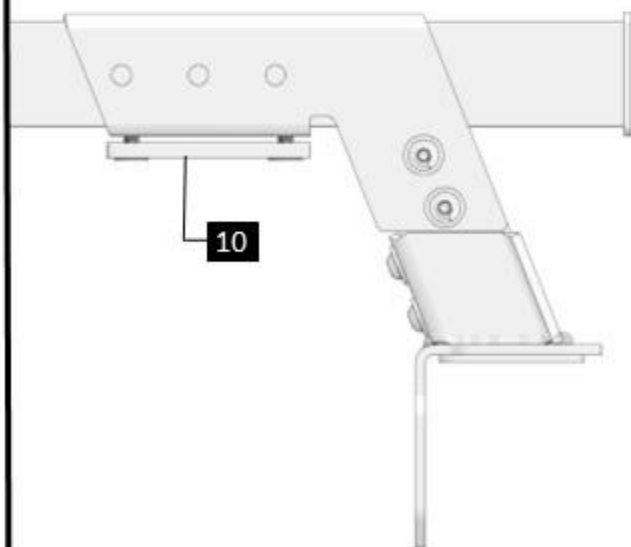

DO NOT TIGHTEN LOCK PLATE.

5

CARGO RAIL MOUNTING

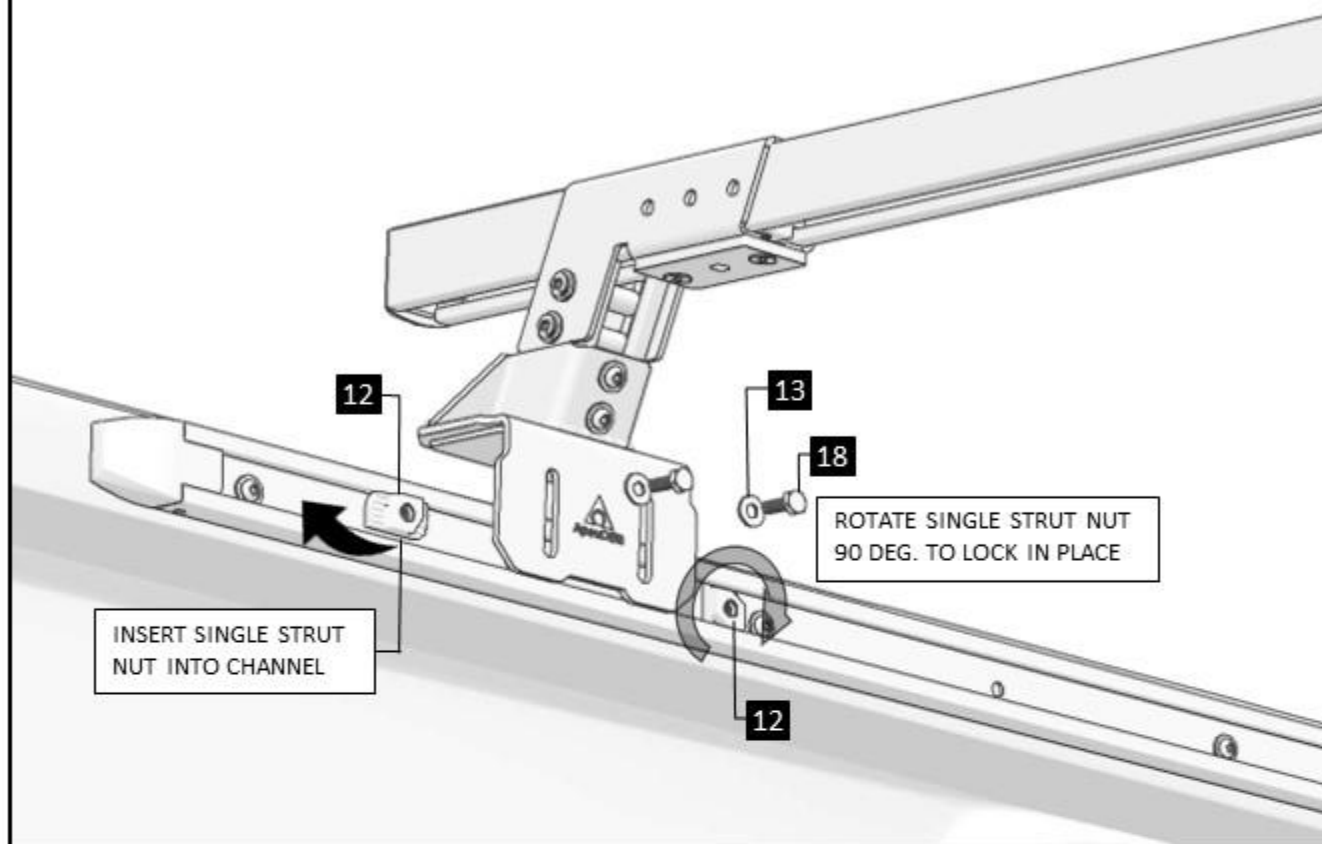

6

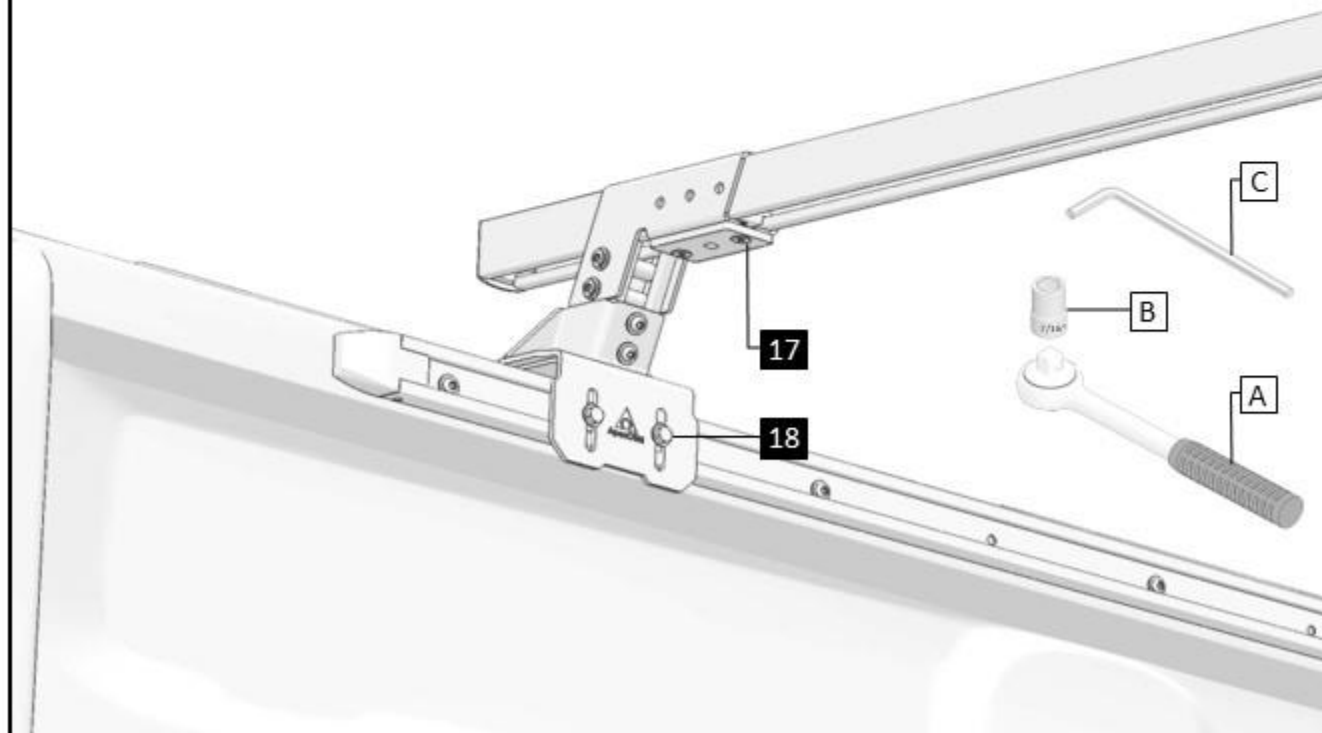

7

CLAMP BRACKET MOUNTING

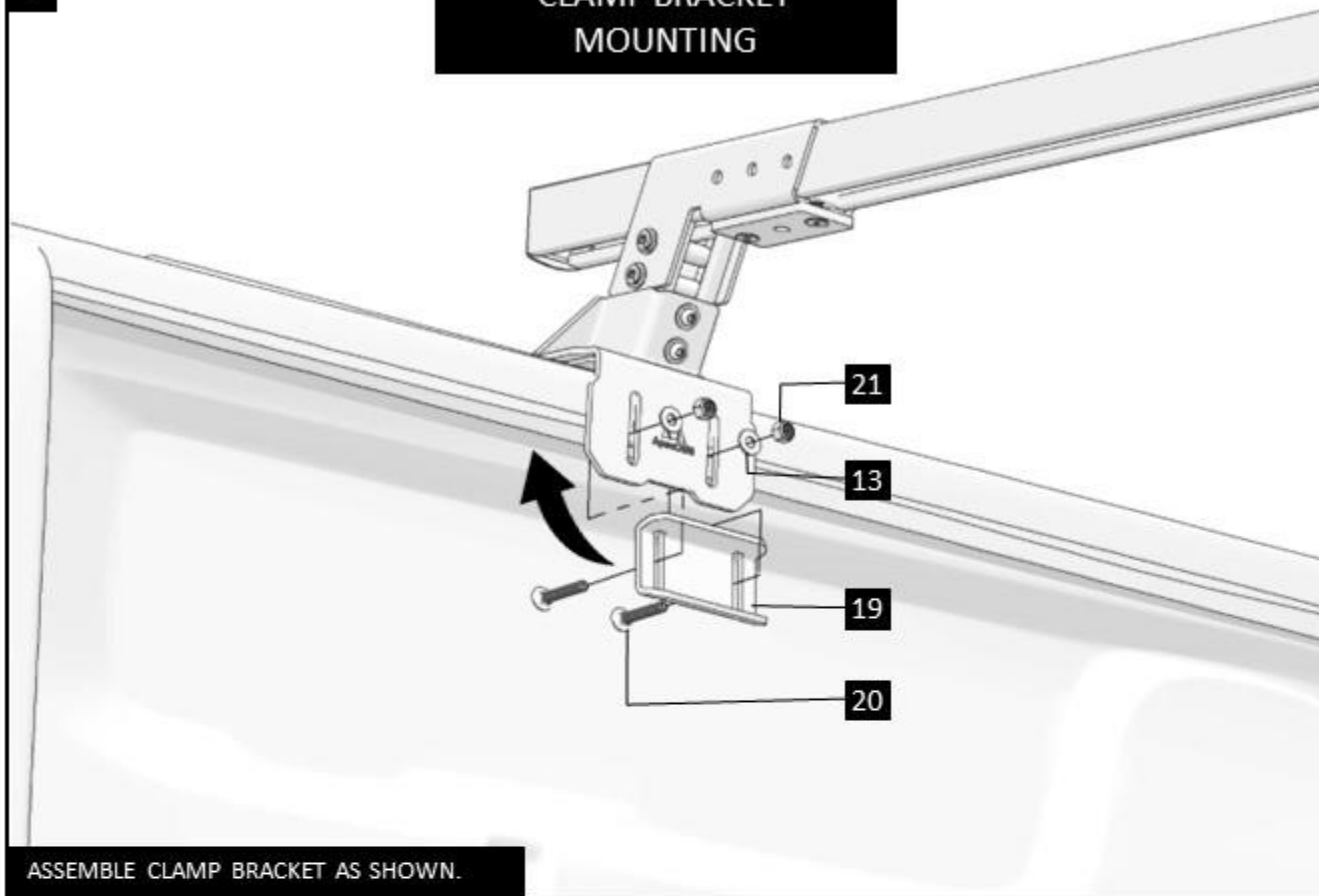

ASSEMBLE CLAMP BRACKET AS SHOWN.

8

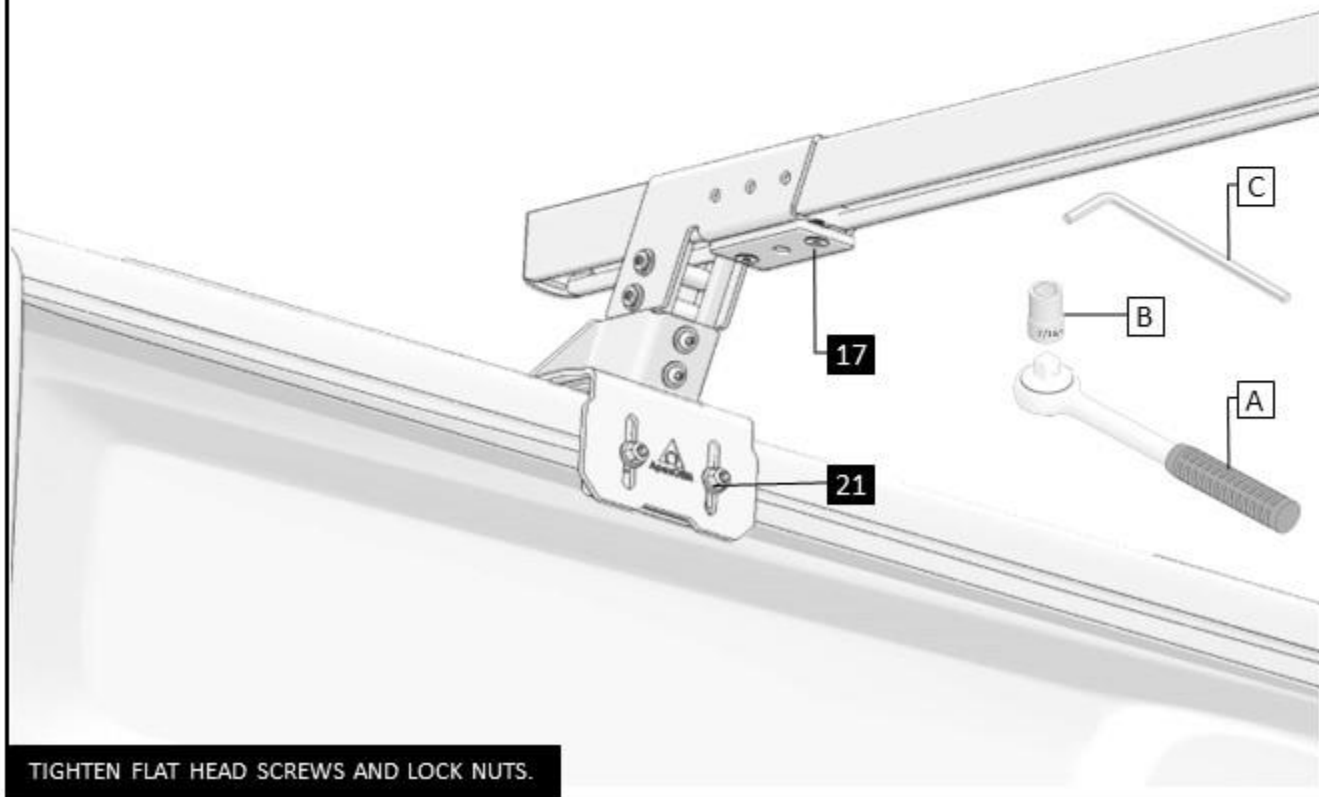

TIGHTEN FLAT HEAD SCREWS AND LOCK NUTS.

9

CUT CHANNEL COVER TO LENGTH
AND SNAP INTO PLACE.

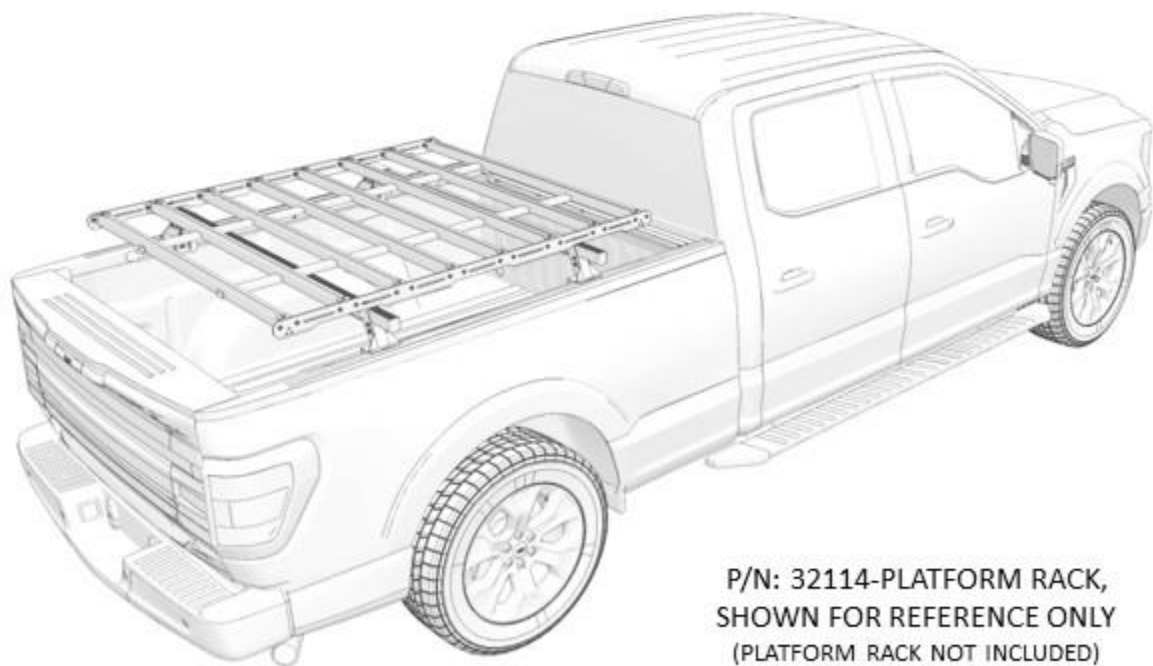
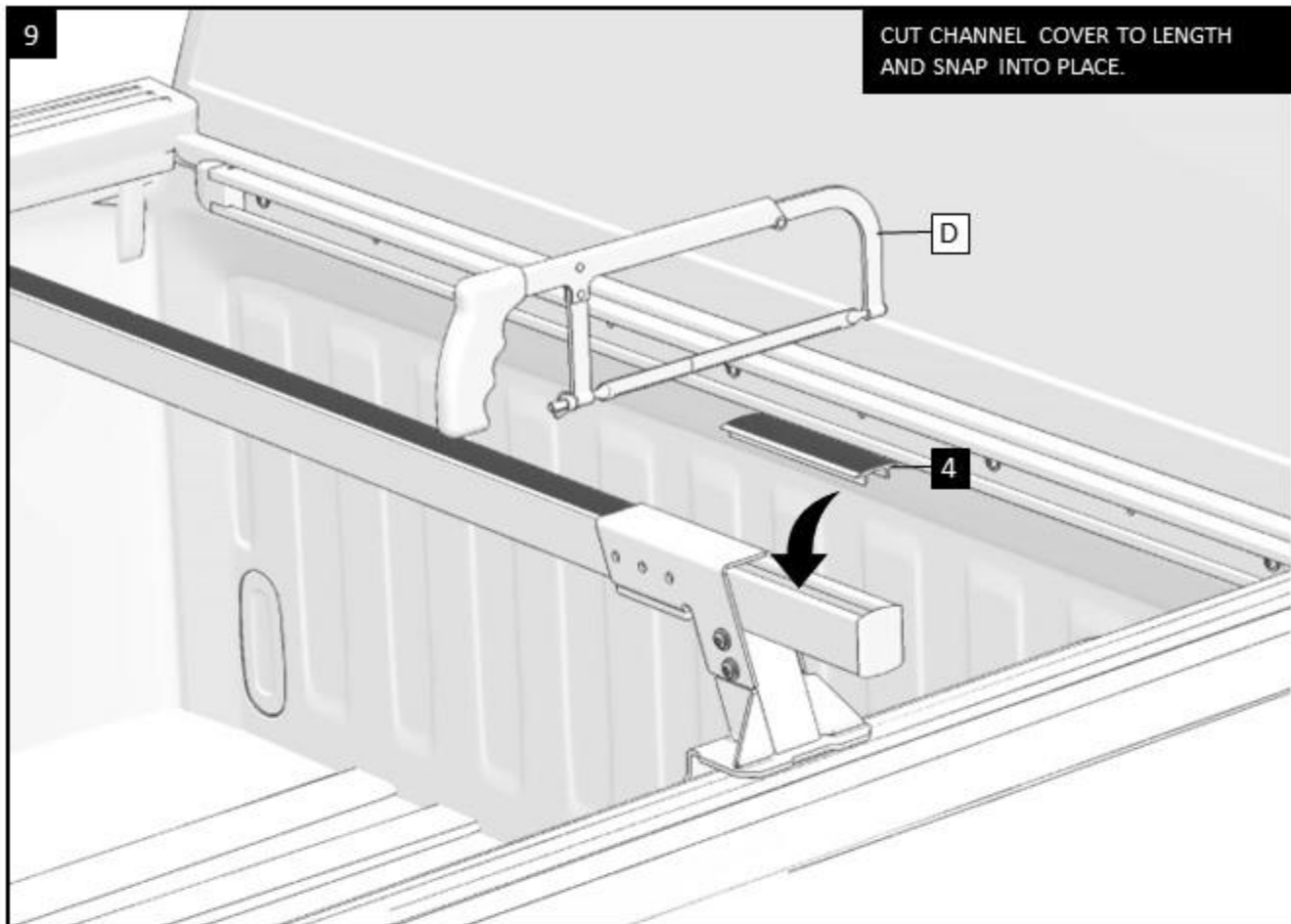

P/N: 32114-PLATFORM RACK,
SHOWN FOR REFERENCE ONLY
(PLATFORM RACK NOT INCLUDED)