

THE

ROTATOR

360 spin isofix car seat

INSTRUCTIONS FOR USE



ECE R44/04 GROUP 0+/1/2/3 (0-36kg)

 ickle bubba

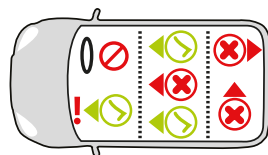
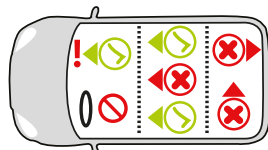
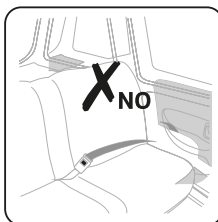
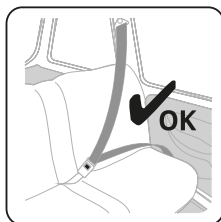

Item: Rotator Car Seat (newborn to 36kg)

Group 0+ (newborn to 13kg / birth to approximately 12-15 months)

Group 1 (9kg to 18kg / approximately 9months - 4 years)

Group 2 (15kg to 25kg / approximately 3 years - 7 years)

Group 3 (25kg to 36kg / approximately 7 years - 12 years)

Thank you for purchasing this Group 0+, 1, 2, 3 car seat. If you are not completely satisfied with the car seat or you would like to change any accessory or obtain any help about the car seat, please contact our customer services department.

Please Note: Only suitable for use in vehicles fitted with a 3 point retractable safety belt or Isifix attachments.

Read the instructions carefully before use and keep for future reference.

CONTENTS

• Warnings	03
• Car Seat Features and Components	06
• Securing your baby	07
• Installation in the vehicle	09
• Care and Maintenance	13
• Warranty and Product Guarantee	14

IMPORTANT!

IMPORTANT! Read the instructions carefully before use and keep for future reference. Install and use the child safety seat as described in the instruction manual. Failure to do this could result in serious injury or death. Keep the instructions together with the child restraint for future reference. This seat conforms to ECE R44/04 and meets the listed classifications; Group 0+ (birth-13kgs) rear-facing, Group I (9-18kgs) rear-facing, Group II (15-25kg) and Group III (25-36kg). Group 0+ and Group I must be fastened with ISOFIX and top-tether connected. Group II and Group III must be fastened using ISOFIT (ISOFIX and lap-sash seatbelt together). This seat should only be used in a vehicle which is ISOFIX compatible.

IMPORTANT! Because of potential medical issues inherent to low birth weight and premature infants, always have a trained professional doctor or hospital staff member assess the suitability of the child restraint prior to leaving the hospital or using the child restraint. It is recommended that the car seat inserts be used until the child's weight exceeds 13kg.

WARNINGS!

WARNING: The correct routing of the seat belt is essential for your child's safety. Please see the Installation section. Never thread the belt in any other way.

A correctly adjusted harness is essential for your child's protection.

NEVER leave a child unattended in the car seat while in the car.

NEVER use the car seat on a seat equipped with a front airbag unless the airbag is deactivated as this can result in the death or injury of the baby. This does not apply to side airbags.

NEVER use the car seat without the backrest as it will not protect your child in the event of an accident.

DO NOT leave your child in this restraint for extended periods of time.

DO NOT use a child safety seat with damaged or missing parts.

DO NOT use damaged or frayed harness straps or vehicle belt.

DO NOT use a child safety seat that has been in a crash. A crash can cause unseen damage to the child safety seat.

DO NOT use a second-hand child seat or child seat whose history you do not know.

DO NOT use this child seat in the home. It has not been designed for home use and should only be used in your car.

The seat must always be secured, even when not in use.

The rigid items and plastic parts of a child restraint must be located and installed so that they are not liable, during everyday use of the vehicle, to become trapped by a movable seat or in a door of the

vehicle. Any straps holding the restraint to the vehicle should be tight. Any straps restraining the child should be adjusted to the child's body, and the straps should not be twisted.

It is important to ensure that any lap strap is worn low down, so that the pelvis is firmly engaged.

It is dangerous to make any alterations or additions to the device without the approval of a competent authority, and to not closely follow the installation instructions provided by the child restraint manufacturer.

The chair should be kept away from sunlight, otherwise it may be too hot for the child's skin.

Any luggage or other objects liable to cause injuries in the event of a collision should be properly secured.

The child restraint must not be used without the cover.

The seat cover should not be replaced with any other than the one recommended by the manufacturer, as the cover constitutes an integral part of the restraint performance.

If the position of the vehicle safety-belt buckle relative to the main load bearing contact points on the child safety seat is unsatisfactory, please contact the manufacturer.

Do not use any load bearing contact points other than those described in the instructions and marked in the child restraint.

If the seat belt height is adjustable, adjust it to the lowest position.

WARNINGS!

When securing your child using the vehicle belt for Group II and Group III, you **MUST ONLY** use a lap sash (3 point seat belt) that crosses the waist and shoulder. **NEVER** use a lap only belt as this could result in serious injury or death to the occupant.

Refer to the table and diagram below.

Here is the positions of installation for your reference.

Forward Facing	✓
Rear facing	✓
Two points seat belts	X
Three points seat belts	✓
Front passenger seat	X
The rear vehicle seats	✓

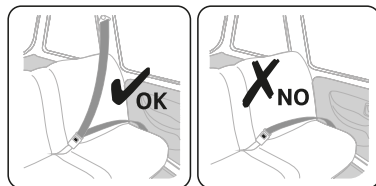

WARNINGS!

NEVER fasten the child restraint on the front passenger seat as air bag deployment will interfere with the safety of the restraint and may cause serious injury or death.

ALWAYS secure the child restraint to the rear vehicle passenger seats.

NEVER fasten the child restraint to rear facing or lateral facing vehicle seats.

Refer to the graphic below when selecting a vehicle seat to install your child restraint to.

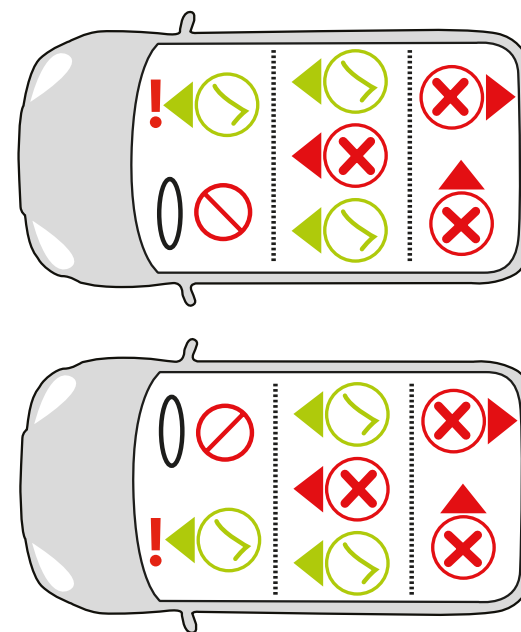

Car Seat Features

1. Headrest and Harness Height Adjustment
2. Seat Backrest
3. Top-Tether Strap
4. Top-Tether Adjuster
5. Top-Tether Clip
6. ISO-FIX Latches
7. Sash Guides (for Group II and III)
8. ISO-FIX Release Buttons
9. ISO-FIX Connection Indicator
10. Headrest
11. Harness Shoulder Straps
12. Harness Chest/Shoulder Pads
13. Crotch Buckle Pad
14. Harness Centre Front Adjuster
15. Infant Head Insert
16. Harness Chest Pads
17. Infant Body Insert
18. Harness Adjuster Strap
19. Recline Adjustment Handle
20. Metal Tongue From Vehicle
21. Buckle From Vehicle
22. Left and Right Buckle Tongue
23. Harness Buckle
24. Rotation Adjustment Button
25. Top-Tether Belt Guide
26. Release Clip for Harness Pads
27. Harness Splitter Plate

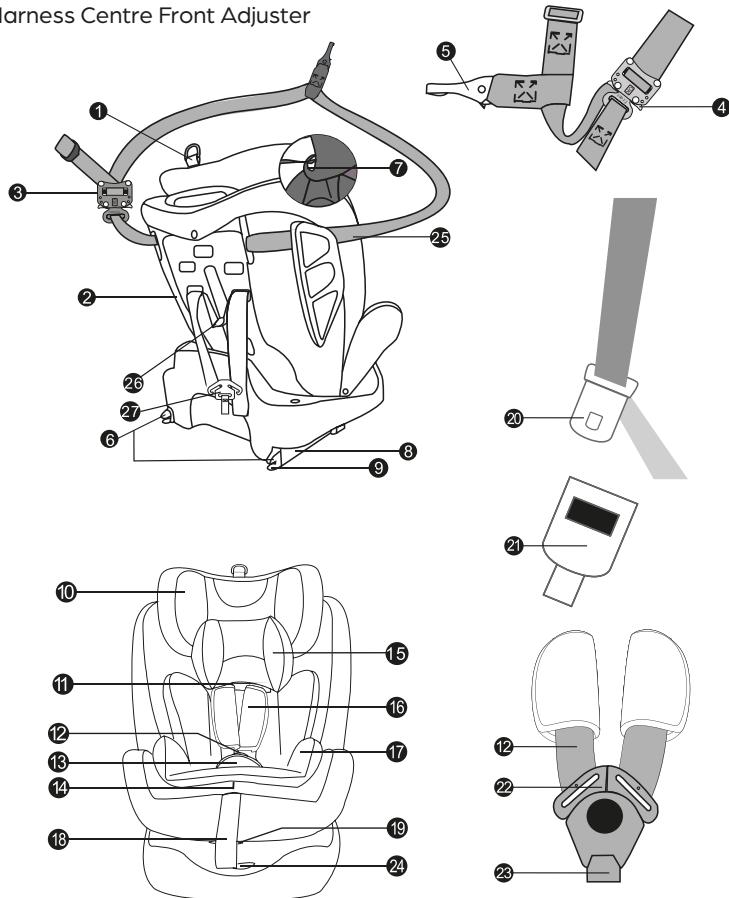

Securing your baby using the baby insert

CAUTION: For the protection of your baby:

Please use the insert attached to this car seat up to approximately 13kg.

The baby insert is used to provide extra comfort for very small babies, and it gives your baby the necessary support while he or she is still small.

- Always secure your baby in the car seat using the harness.
- Never leave your baby unattended in the car seat when placing it on elevated surfaces (e.g. a table, nappy changing unit, etc.).
- Never allow the strap end to become caught in moving parts (e.g. automatic doors, escalators, etc.).
- Caution! The plastic parts of the car seat heat up in the sun, so that your baby may get burnt. Protect your baby and the car seat against intensive solar radiation (e.g. by putting a light cloth over the seat).
- Take your baby out of the car seat as often as possible to relieve its spine.
- We recommend frequent breaks during long journeys. Even outside of the car, please avoid leaving your baby in the car seat for too long.

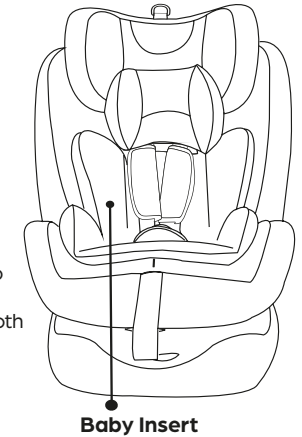

How to adjust the belts, headrest and seat positions

IMPORTANT: The correct belt height of the shoulder belts is attained when the belt disappears into the shell slightly above the shoulder of the child. Make sure that the shoulder belts fit properly over the shoulders of the child.

Adjusting the belts

- Loosen the harness straps by pressing the release button and pulling the harness straps as far as you can. **NOTE: Do not** pull the Shoulder pads.

Headrest adjust

- There are seven adjustable headrest position pull the headrest adjust button upwards, move the headrest to the correct shoulder strap height and check that it is properly engaged by lightly sliding the head rest downwards.

To change the recline

- The seat can be reclined into multiple different positions.
- You can change the recline position while the child is installed in the car seat.
- Changing recline position gives your child optimal comfort for sleeping.
- For children from 0-12 year old, use the seat in its most reclined position with the infant insert to ensure your child's spine is supported whilst sleeping.
- To change the positions press the recline button and push or pull the seat into the desired position.

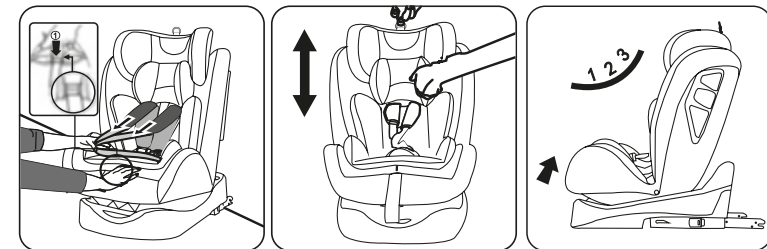

Securing your baby using the harness

- Loose the harness straps by pressing the release button and pulling the harness straps as far as you can. NOTE: Do not pull the Shoulder pads.
- Open the harness buckle, then fix the harness straps into the belt guide band. Put the baby into the car seat.
- The correct height of the shoulder belts is attained when the belt disappears into the shell slightly above the shoulder of the child. Make sure that the harness straps fit properly
- Slide buckle tongues together and insert them in the buckle with an audible sound "click".
- Pull the straps tight by the harness adjustment strap, and make sure the tightness is comfortable to your kid.

CAUTION: Do not twist or interchange the harness straps.

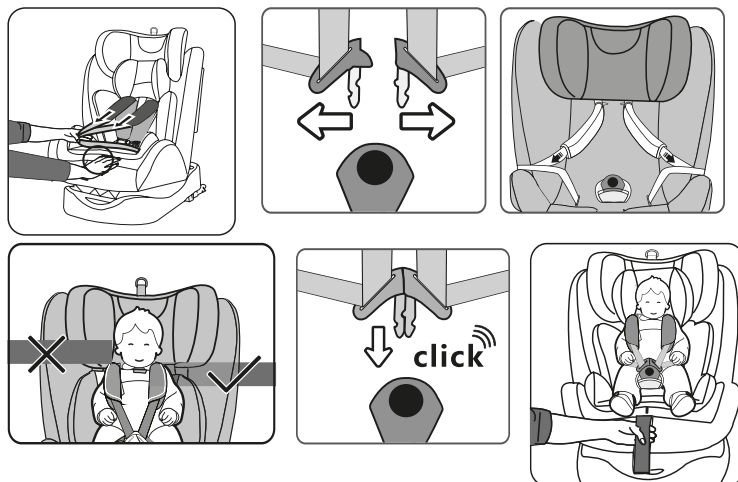

Tightening the harness

CAUTION: Pull the strap end straight towards you, not upwards or downwards.

Please pay attention to the strap end. Whilst traveling (especially outside the car) it should always be attached to the cover.

Checklist to ensure that your baby is buckled up correctly

IMPORTANT: For the safety of your baby, please ensure that:

- The harness straps of the car seat are comfortable but firm fit around your child.
- The harness straps are adjusted correctly.
- The harness straps are not twisted.
- The buckle tongues are engaged in the harness buckle.

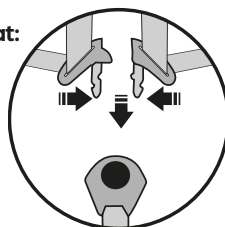

Installation in the vehicle

! Please do not leave your child unattended in the child safety seat in the vehicle. For the protection of all vehicle occupants:

In the case of an emergency stop or an accident unsecured persons or objects may cause injury to other vehicle occupants. Please always check that:

- The backrests of the vehicle seats are locked (i.e. that a foldable rear seat bench latch is engaged).
- All heavy or sharp-edged objects in the vehicle (e.g. on the parcel shelf) are secured.
- All persons in the vehicle have their seat belts fastened.
- The child safety seat is always secured when it is in the vehicle, even if no child is being transported.

To protect your vehicle

Some vehicle seat covers of sensitive materials (e.g. velour, leather, etc.) may develop wear marks when child seats are used. This can be avoided by placing a blanket or towel under the child seat.

Installation of Group 0+(birth–13kg), Group I (9–18kg) with ISOFIX and Top tether

IMPORTANT: First please check if there are 2 ISOFIX anchorings in the perpendicular intersection of the vehicle seat back and seat cushion, and the user-ready top tether anchoring behind the vehicle seat.

Tips: The user-ready tether anchorage is usually permanently installed on the inner rear luggage shelf or on the vehicle floor.

For more details you could read your vehicle guidelines or contact the vehicle manufacturer.

- Rotate by pressing the rotation button and turn the seat into the rearward facing position.
- Press the ISOFIX release button and push the ISO FIX connectors forward as far as possible.
- Push the ISOFIX connectors directly into the anchorages until you hear an audible sound "click"
- Press the rotation button and turn the seat against the direction of travel, as rearward facing position. Grasp the recline button and press the child seat into the most reclined position
- Tip: If the ISOFIX connectors are correctly installed, the Release button will pop out, and you can see a clear green mark on it.
- Grasp the seat body to check the seat if it is fastened tightly or shakes. If the seat shakes and the ISOFIX connectors are pulled out, please repeat the above steps and install it again.

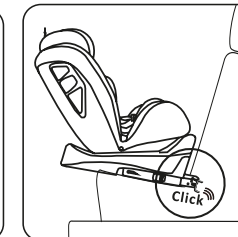
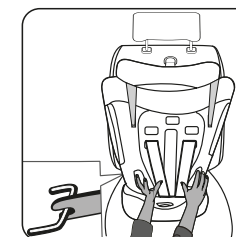
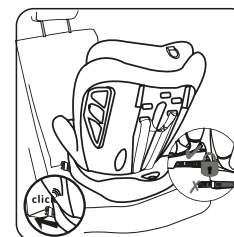
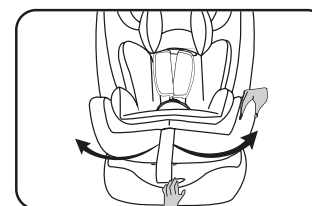

Installation of Group 0+(birth–13kg), Group I(9–18kg) with ISOFIX & Top tether

- The top tether strap should go through the belt guides on both sides, then lock the hook on the anchor bracket.



- Pull out the top tether and press the tether strap release button to extend the strap until it is long enough to hook onto the User-ready tether anchorage behind.
- Hook the tether strap hook onto the User-ready anchorages. There maybe 3 anchorages for the hook, please find one in your favor.



- Pull the tether strap on the other end back to tighten the Top tether.



CAUTION: If the top tether is tightened correctly, an ok mark will show up on the other end of the strap release button, please check it.

- Press the top tether adjustor button then release it.
- It's easy to release the adjustor button to achieve the rotation function when baby in the vehicle.

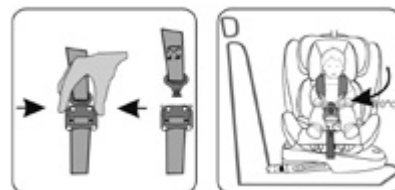

How to adjust the height of the shoulder belts

If your child is big enough and can not fit the shoulder belts, you should adjust it or take it away.

- Pressing the button on the central adjuster and pull the shoulder belts out
- Remove the end of shoulder belts from the spreader bar
- Pull belts out from the slots



Harness buckle removal

- Locate the metal buckle strap retainer on bottom of the shell.
- Pull retainer away from child restraint to loosen, turn the retainer so that the short side will go through the slot in the restraint shell. Push the retainer through slots in the shell and cover to the top of the restraint. Uninstall harness system.

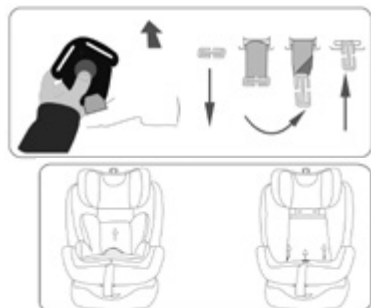

Installation of Group 2/3 (15–36kg)



Note: The Baby insert, Harness strap, Harness buckle, Buckle pads, Shoulder pads & Shoulder belts axle should be stored away safely for future use (see 5.1 Removing the 5-point harness system and cover).

WARNING!

Do not to use any load bearing contact points other than those described in the instructions and marked in the child restraint.

The belt must be routed as shown in the manual.

- Press the ISOFIX release button and push the ISOFIX connectors forward as far as possible.
- Push the ISOFIX connectors directly into the anchorages until you hear an audible sound "click"
- Press the rotation button and turn the seat against the direction of travel, as rearward facing position. Grasp the recline button and press the child seat into the most reclined position
- Tip: If the ISOFIX connectors are correctly installed, the Release button will pop out, and you can see a clear green mark on it.

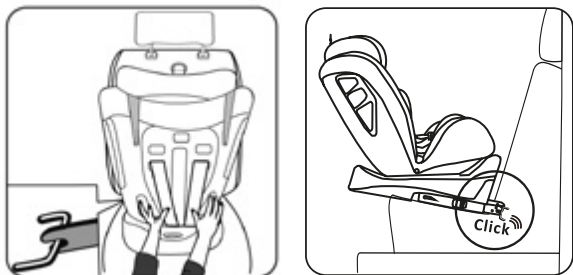

Installation of Group 2/3 (15–36kg)

- Grasp the seat body to check the seat if it is fastened tightly or shakes. If the seat shakes and the ISOFIX connectors are pulled out, please repeat the above steps and install it again.
- Pull the shoulder strap axle out, untie the shoulder strap and pull the harness strap out from the harness slot.
- Place your child into the baby car seat and let the car belt pass the Belt guide. Fasten the car belt with an audible sound "click".
- Make sure the Lap belt is stretched as low as possible over the child's hips, within the Belt guides, and fastened into the buckle. The Shoulder belt must cross midway between child's shoulder and neck.

⚠ Please make sure that any lap strap is worn low down, so that the pelvis is firmly engaged.

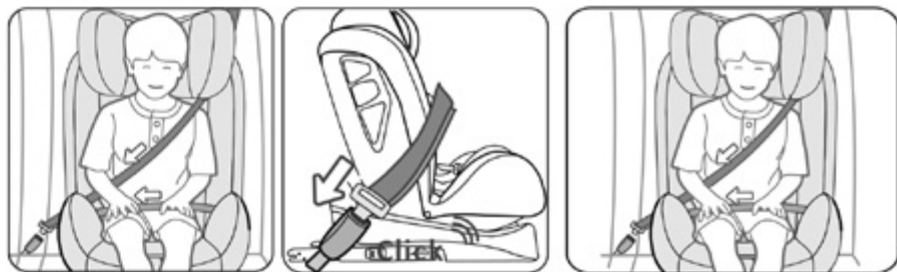

Care and Maintenance

Removing the Soft Seat Trim

1. Remove the infant inserts by loosening the harness and pulling them out from around the waist and shoulder straps.
2. Remove the buckle pad by sliding it off the buckle.
3. Remove the headrest padding by first releasing the press studs around the shoulder straps and then pulling the cover up and away from the headrest
4. Remove the body padding by first releasing the four internal press studs from around the harness. Once released, disconnect the external press studs from the seat plastics as shown in image F-1 and then untuck the cover from around the edges of the seat. Once the seat is untucked, pull the fabric cover off and away from the plastic shell.

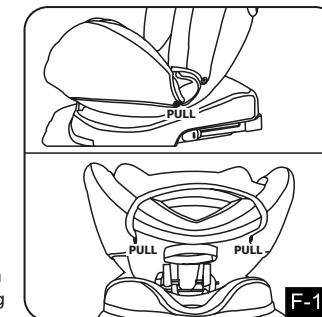

NOTE: Adjust the headrest into the lowest position to make this process easier.

Cleaning the Car Seat

The seat cover can be washed at 30 degrees celsius with mild detergent using the delicate setting on your washing machine. Never tumble dry or dry-clean, only line dry inside out.



The plastic and metal components can be cleaned using soapy water but do not use harsh cleaning agents or solvents.

Cleaning the Harness Buckle

The buckle may need periodic cleaning if the child regularly eats and drinks whilst seated in the restraint. Ensure the buckle is checked regularly for accumulating debris or dried liquids that could prevent operation. If the buckle's audible click becomes muted or is no longer latching, clean it immediately before use.

Remove the buckle by releasing the retention clip underneath the seat and threading it back through the slot.

Once removed, rinse thoroughly under warm water to loosen any debris. If this is ineffective, allow the buckle to soak in warm water over night.

DO NOT take apart or attempt to disassemble the buckle or any of its components.

DO NOT use solvents, detergents or and washing liquids as this may cause irreparable damage to the buckle or buckle straps.

DO NOT lubricate or oil any part of the buckle, affiliated components or any parts of the seat.

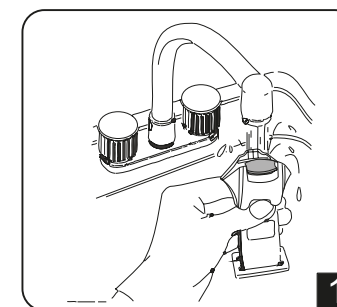

Replacing Damaged Components

If your seat trim becomes damaged, only replace it with one provided by Ickle Bubba as it is dangerous to use an uncertified replacement. If you need a replacement cover, contact our customer care team.

It is not safe to buy or sell secondhand restraints. Please dispose of your child restraint safely once it has been involved in an accident or is damaged. Although it may look undamaged, after an accident, a child restraint can have hidden stress and strain that could make it ineffective if another accident was to occur.

Warranty Information:

Please ensure you have registered your product online and keep your proof of purchase for any future claim. We will not be able to investigate any claims without this. If you register your product with us online within 28 days of receiving your product, we will extend all parts/items with standard 2 year* warranty to 4 years* from the date of purchase, at no extra cost.

Our warranty covers you against manufacturing defects, you are not covered against the below:

- Normal wear and tear.
- Incorrect use, cleaning or storage.
- Damage caused by not following your Ickle Bubba product user guide.
- Modifying or altering your product with non-approved parts, or by an unauthorised agent.
- Accidental damage (including airline damage) or damage caused by non-domestic use.
- Damage caused by use of accessories not recommended by Ickle Bubba, or advised against in your user guide.

If you have any problems with your Ickle Bubba product caused by a manufacturing defect when under warranty, we offer a 4-step speedy aftercare service within 5 working days. We advise customers to check the contents of their product within 14 days of delivery. Please contact us within 7 days if you discover a fault with your product.

We are more than happy to fulfil our warranty commitments. Ickle Bubba have the right to offer a repair, provide a replacement self-fit part/spare, or a full replacement product. If your product design, colour or fabric has been discontinued we may be required to offer an alternative equivalent product. If a returned item is found to have a fault not related to a manufacturing defect, Ickle Bubba reserve the right to charge for any repairs carried out or spares/ replacements provided.

The warranty applies in the country of purchase only. The warranty applies to the original purchaser and is non-transferrable. It does not cover second hand purchases.

*Standard and extended warranty is only applicable on certain parts/items, please check the warranty overview table for further details.

Your consumer statutory rights are not affected by the warranty.

Pram/pushchair/stroller chassis & pram/seat frames	2 years*
Car seats	2 years*
Wheels and brake bars	1 year
All fabric parts, handle coverings, bumper bars and accessories	6 months

*4 year extended warranty applies to these parts/items only.

Register your product

To register your product and activate your extended warranty, please visit our website:

UK – <https://icklebubba.com/pages/warranty>

Notice:

Notice regarding Semi-universal ISOFIX child restraint system (in Group O+/I)

1. This is an ISOFIX CHILD RESTRAINT SYSTEM. It is approved to Regulation No.44, 04 series of amendments for general use in vehicles fitted with ISOFIX anchorages systems.
2. It will fit vehicles with positions approved as ISOFIX positions . (as detailed in the vehicle handbook), depending on the category of the child seat and of the fixture.
3. The mass group and the ISOFIX size class for which this device is intended is: Group O+/I, D

NOT TO USE REARWARD FACING SYSTEMS IN SEATING POSITIONS WHERE THERE IS AN AIRBAG INSTALLED.

Notice regarding Semi-universal category (Group 0+ I/II/III)

This child restraint is classified for "Semi-universal" use and is suitable for fixing into the seat positions of the following cars:

<u>CAR</u>	<u>FRONT</u>	<u>REAR</u>	
		<u>Outer</u>	<u>Centre</u>
Refer to vehicle list	Yes	Yes	No

Seat positions in other cars may also be suitable to accept this child restraint. If in doubt, consult either the child restraint manufacturer or the retailer.

Only suitable if the approved vehicles are fitted with 3 point with retractor safety-belts, approved to UN/ECE Regulation No.16 or other equivalent standards.



contact@icklebubba.com

Atlantic House, Unit 2, Atlantic Close, Swansea SA7 9FJ

Unit 125, 3 Lombard Street East, Dublin 2, D02 HC78

www.icklebubba.com