

Stairwell Tower
1.8m Long x 0.72m Wide

Working Height
4.3m

Platform Height
2.3m

Tower Components

Item	Description	Quantity
1	150mm Base Plate	4
2	Adjustable Leg 500mm	4
3	1m 4 Rung Frame	1
4	1.5m 6 Rung Frame	0
5	2m 8 Rung Frame	0
6	2m 8 Rung Walkthrough Frame	2
7	Walkthrough Frame Ladder	1
8	1.8m Trapdoor Platform	1
9	1.8m Horizontal Brace	2
10	2.1m Diagonal Brace	3
11	1.8m AGR	2
12	Complete Toe Board Set	1
13	S2 Stabiliser	0 or 2 or 4
14	Stairwel Brace	2 or 1 or 0
15	Instruction Manual & EN1004:-1:2020 certificate of conformity	1

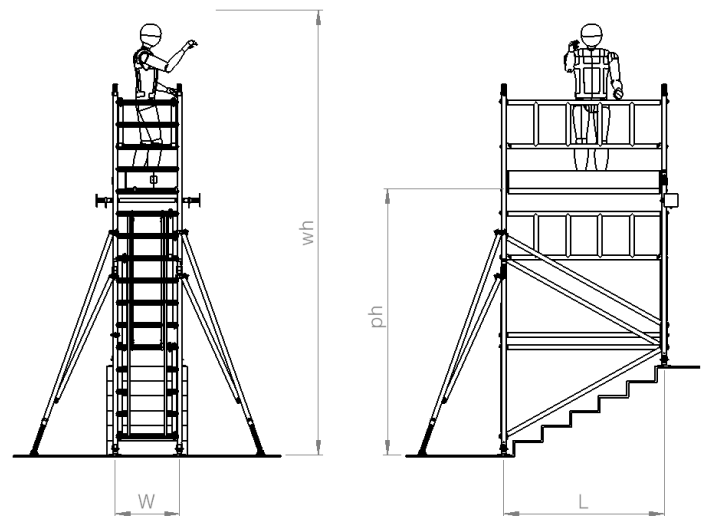
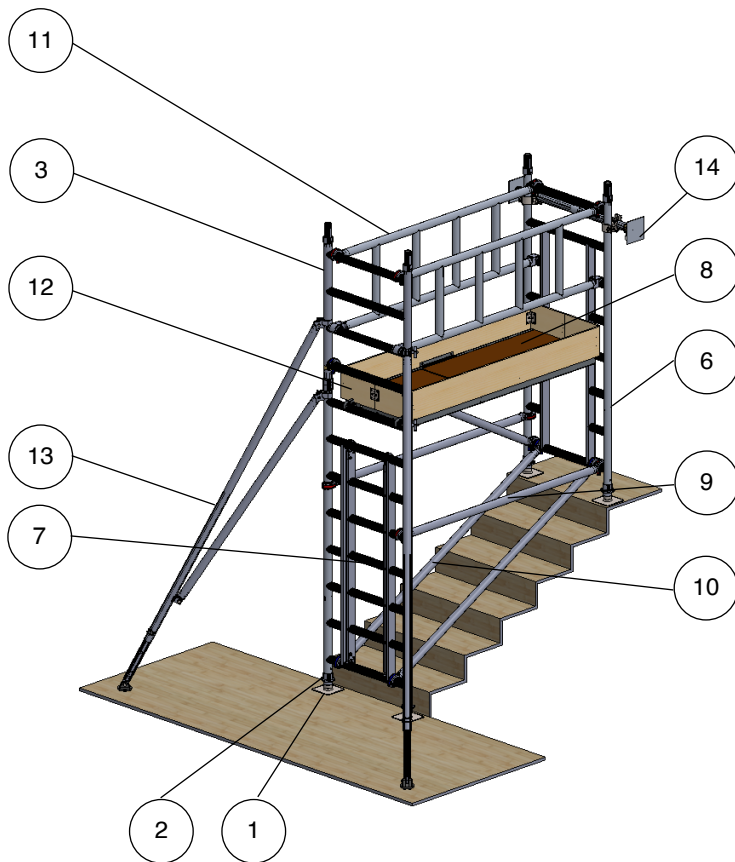

Technical information:

Base Dimensions:	(L)1.8m X (W)0.72m
Maximum Platform Height (ph):	2.3m
Maximum Working Height (wh):	4.3m
Maximum Working Load Per Platform:	275kg
Maximum Working Load Per Tower: (including tower weight)	950kg
Weight:	103.9kg

Note:

Use a combination of stabilisers and stairwell braces:
4 stabilisers and no braces
2 stabilisers and 1 brace
0 stabilisers and 2 braces.

Stairwell Tower
1.8m Long x 0.72m Wide

Working Height
4.8m

Platform Height
2.8m

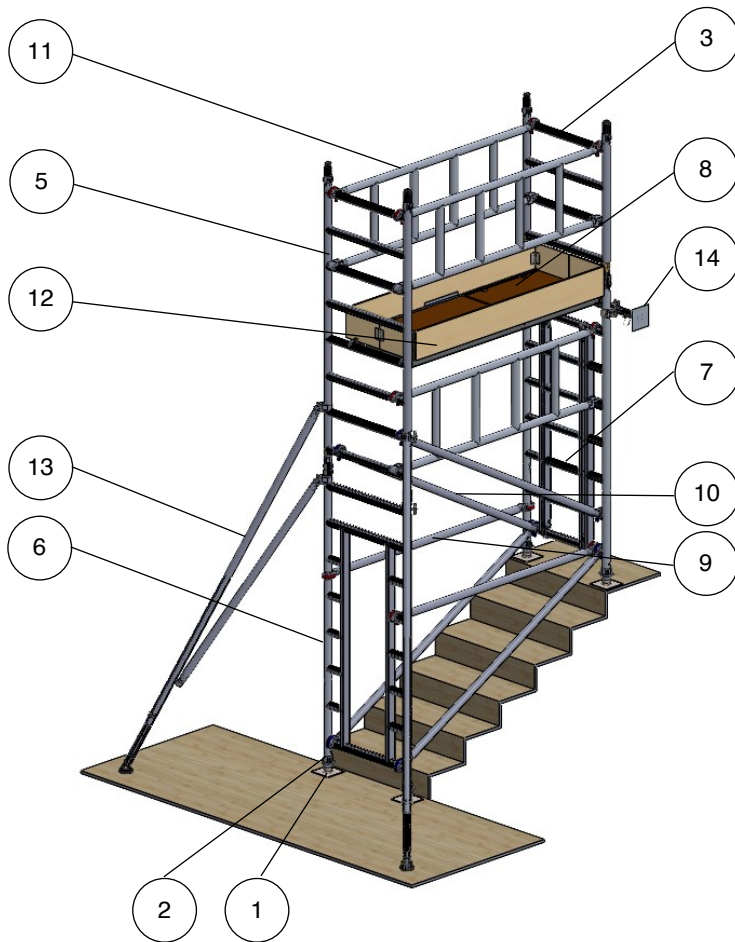

Tower Components

Item	Description	Quantity
1	150mm Base Plate	4
2	Adjustable Leg 500mm	4
3	1m 4 Rung Frame	1
4	1.5m 6 Rung Frame	0
5	2m 8 Rung Frame	1
6	2m 8 Rung Walkthrough Frame	2
7	Walkthrough Frame Ladder	1
8	1.8m Trapdoor Platform	1
9	1.8m Horizontal Brace	2
10	2.1m Diagonal Brace	4
11	1.8m AGR	3
12	Complete Toe Board Set	1
13	S2 Stabiliser	0 or 2 or 4
14	Stairwel Brace	2 or 1 or 0
15	Instruction Manual & EN1004:-1:2020 certificate of conformity	1

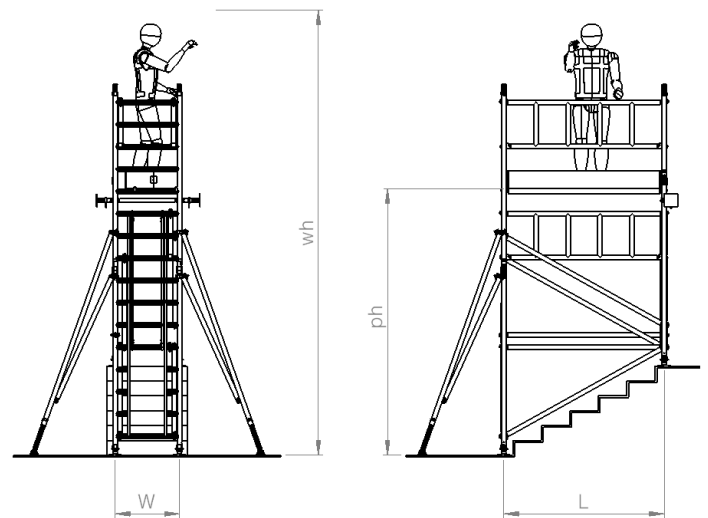

Technical information:

Base Dimensions:	(L)1.8m X (W)0.72m
Maximum Platform Height (ph):	2.8m
Maximum Working Height (wh):	4.8m
Maximum Working Load Per Platform:	275kg
Maximum Working Load Per Tower: (including tower weight)	950kg
Weight:	122.1kg

Note:

Use a combination of stabilisers and stairwell braces:
4 stabilisers and no braces
2 stabilisers and 1 brace
0 stabilisers and 2 braces.

Stairwell Tower
1.8m Long x 0.72m Wide

Working Height
5.3m

Platform Height
3.3m

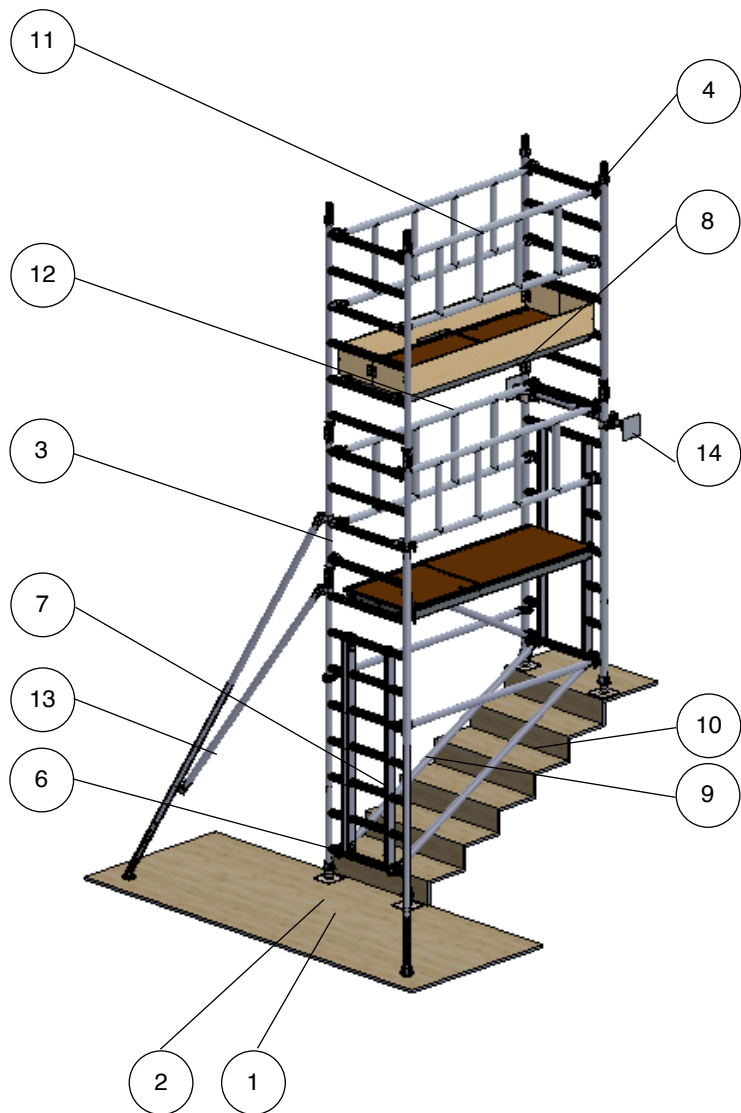

Tower Components

Item	Description	Quantity
1	150mm Base Plate	4
2	Adjustable Leg 500mm	4
3	1m 4 Rung Frame	1
4	1.5m 6 Rung Frame	2
5	2m 8 Rung Frame	0
6	2m 8 Rung Walkthrough Frame	2
7	Walkthrough Frame Ladder	1
8	1.8m Trapdoor Platform	2
9	1.8m Horizontal Brace	2
10	2.1m Diagonal Brace	3
11	1.8m AGR	4
12	Complete Toe Board Set	1
13	S2 Stabiliser	0 or 2 or 4
14	Stairwel Brace	2 or 1 or 0
15	Instruction Manual & EN1004:-1:2020 certificate of conformity	1

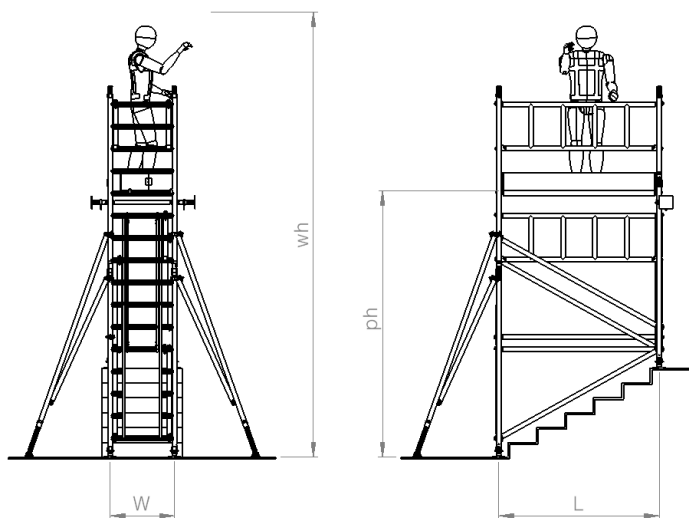

Technical information:

Base Dimensions:	(L)1.8m X (W)0.72m
Maximum Platform Height (ph):	3.3m
Maximum Working Height (wh):	5.3m
Maximum Working Load Per Platform:	275kg
Maximum Working Load Per Tower: (including tower weight)	950kg
Weight:	149.0kg

Note:

Use a combination of stabilisers and stairwell braces:
4 stabilisers and no braces
2 stabilisers and 1 brace
0 stabilisers and 2 braces

Stairwell Tower
1.8m Long x 0.72m Wide

Working Height
5.8m

Platform Height
3.8m

Tower Components

Item	Description	Quantity
1	150mm Base Plate	4
2	Adjustable Leg 500mm	4
3	1m 4 Rung Frame	1
4	1.5m 6 Rung Frame	0
5	2m 8 Rung Frame	2
6	2m 8 Rung Walkthrough Frame	2
7	Walkthrough Frame Ladder	1
8	1.8m Trapdoor Platform	2
9	1.8m Horizontal Brace	2
10	2.1m Diagonal Brace	3
11	1.8m AGR	5
12	Complete Toe Board Set	1
13	S2 Stabiliser	0 or 2 or 4
14	Stairwel Brace	4 or 2 or 0
15	Instruction Manual & EN1004:-1:2020 certificate of conformity	1

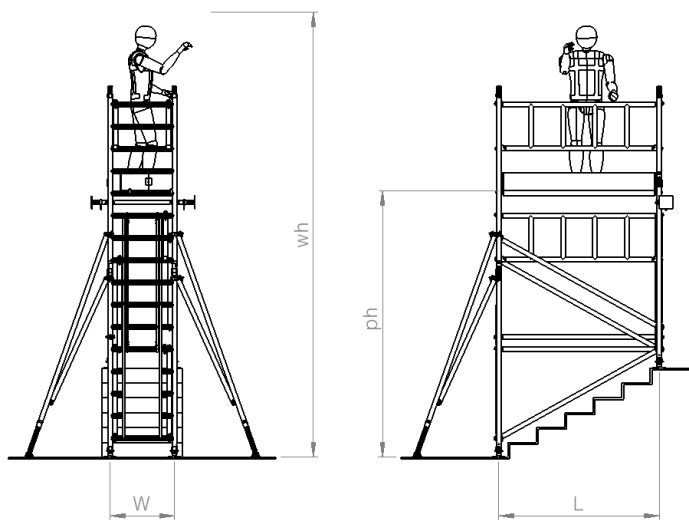
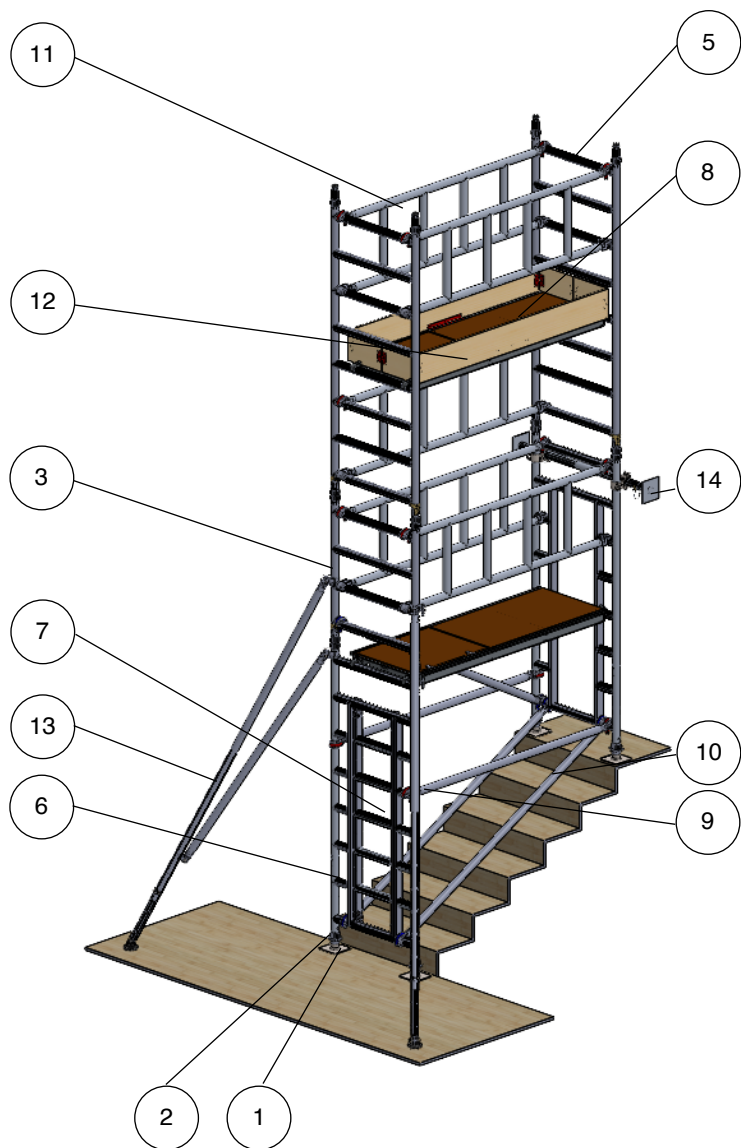

Technical information:

Base Dimensions:	(L)1.8m X (W)0.72m
Maximum Platform Height (ph):	3.8m
Maximum Working Height (wh):	5.8m
Maximum Working Load Per Platform:	275kg
Maximum Working Load Per Tower: (including tower weight)	950kg
Weight:	154.6kg

Note:

Use a combination of stabilisers and stairwell braces:
4 stabilisers and no braces
2 stabilisers and 2 brace
0 stabilisers and 4 braces

Stairwell Tower
1.8m Long x 0.72m Wide

Working Height
6.3m

Platform Height
4.3m

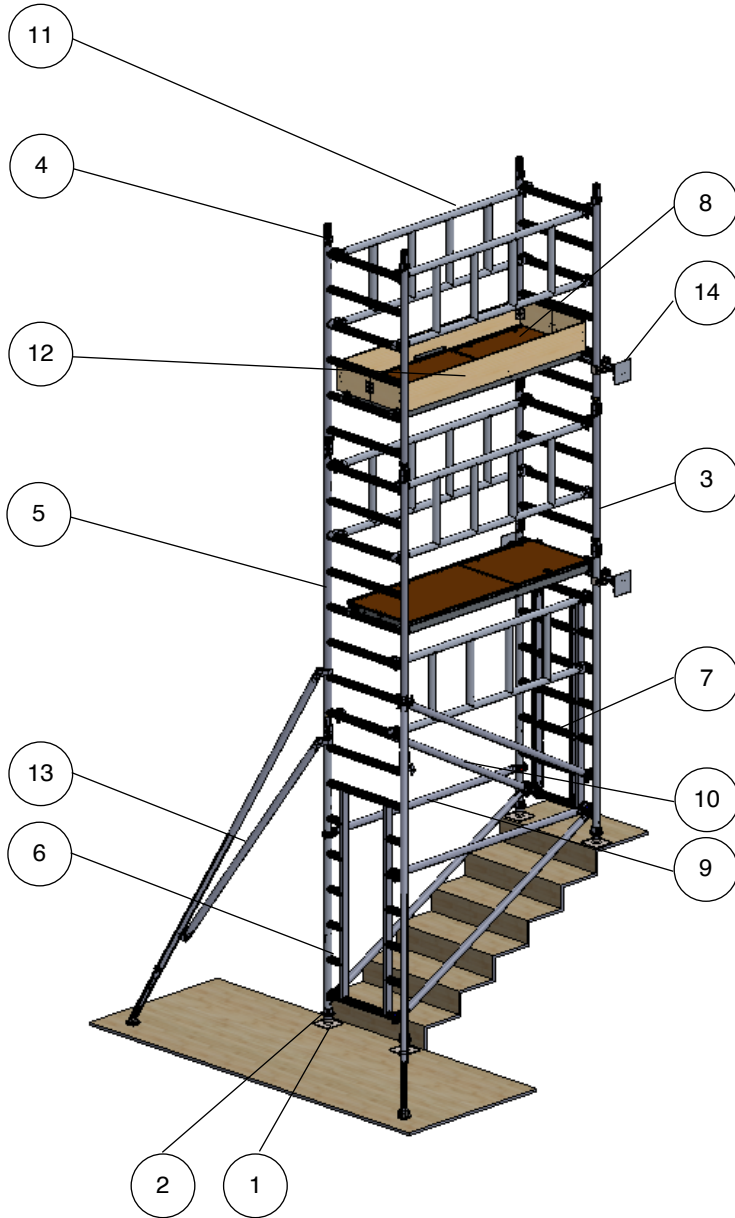

Tower Components

Item	Description	Quantity
1	150mm Base Plate	4
2	Adjustable Leg 500mm	4
3	1m 4 Rung Frame	1
4	1.5m 6 Rung Frame	2
5	2m 8 Rung Frame	1
6	2m 8 Rung Walkthrough Frame	2
7	Walkthrough Frame Ladder	1
8	1.8m Trapdoor Platform	2
9	1.8m Horizontal Brace	2
10	2.1m Diagonal Brace	4
11	1.8m AGR	5
12	Complete Toe Board Set	1
13	S2 Stabiliser	0 or 2 or 4
14	Stairwel Brace	4 or 2 or 0
15	Instruction Manual & EN1004:-1:2020 certificate of conformity	1

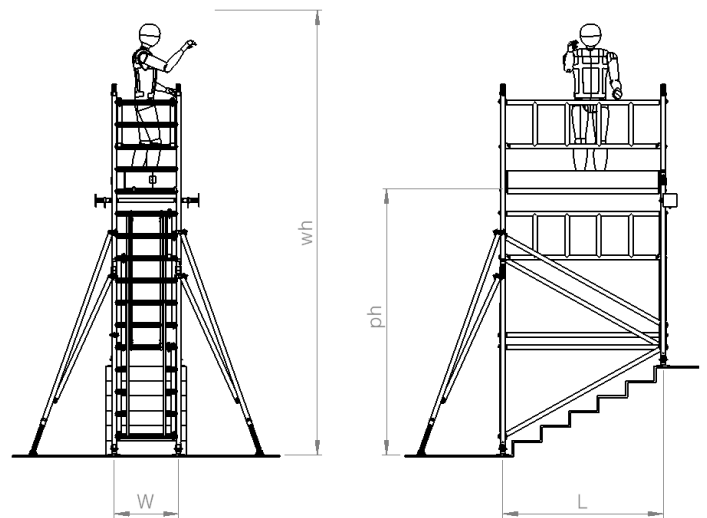

Technical information:

Base Dimensions:	(L)1.8m X (W)0.72m
Maximum Platform Height (ph):	4.3m
Maximum Working Height (wh):	6.3m
Maximum Working Load Per Platform:	275kg
Maximum Working Load Per Tower: (including tower weight)	950kg
Weight:	167.0kg

Note:

Use a combination of stabilisers and stairwell braces:
4 stabilisers and no braces
2 stabilisers and 2 brace
0 stabilisers and 4 braces

Stairwell Tower
1.8m Long x 0.72m Wide

Working Height
6.8m

Platform Height
4.8m

Tower Components

Item	Description	Quantity
1	150mm Base Plate	4
2	Adjustable Leg 500mm	4
3	1m 4 Rung Frame	1
4	1.5m 6 Rung Frame	0
5	2m 8 Rung Frame	3
6	2m 8 Rung Walkthrough Frame	2
7	Walkthrough Frame Ladder	1
8	1.8m Trapdoor Platform	2
9	1.8m Horizontal Brace	2
10	2.1m Diagonal Brace	4
11	1.8m AGR	6
12	Complete Toe Board Set	1
13	S2 Stabiliser	0 or 2 or 4
14	Stairwel Brace	4 or 2 or 0
15	Instruction Manual & EN1004:-1:2020 certificate of conformity	1

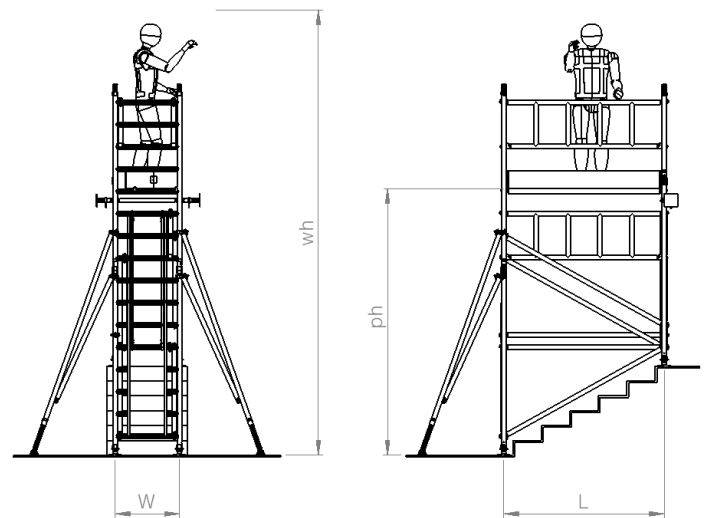
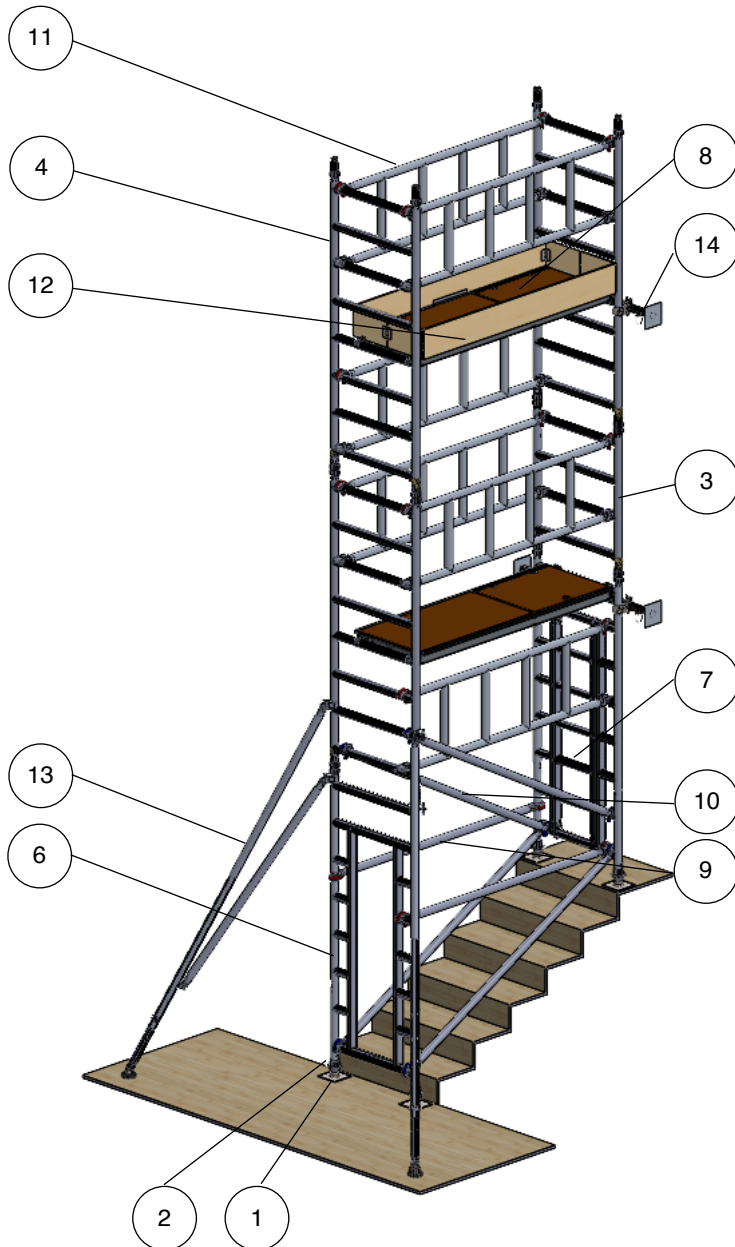

Technical information:

Base Dimensions:	(L)1.8m X (W)0.72m
Maximum Platform Height (ph):	4.8m
Maximum Working Height (wh):	6.8m
Maximum Working Load Per Platform:	275kg
Maximum Working Load Per Tower: (including tower weight)	950kg
Weight:	172.8kg

Note:

Use a combination of stabilisers and stairwell braces:
4 stabilisers and no braces
2 stabilisers and 2 brace
0 stabilisers and 4 braces

Stairwell Tower
1.8m Long x 0.72m Wide

Working Height
7.3m

Platform Height
5.3m

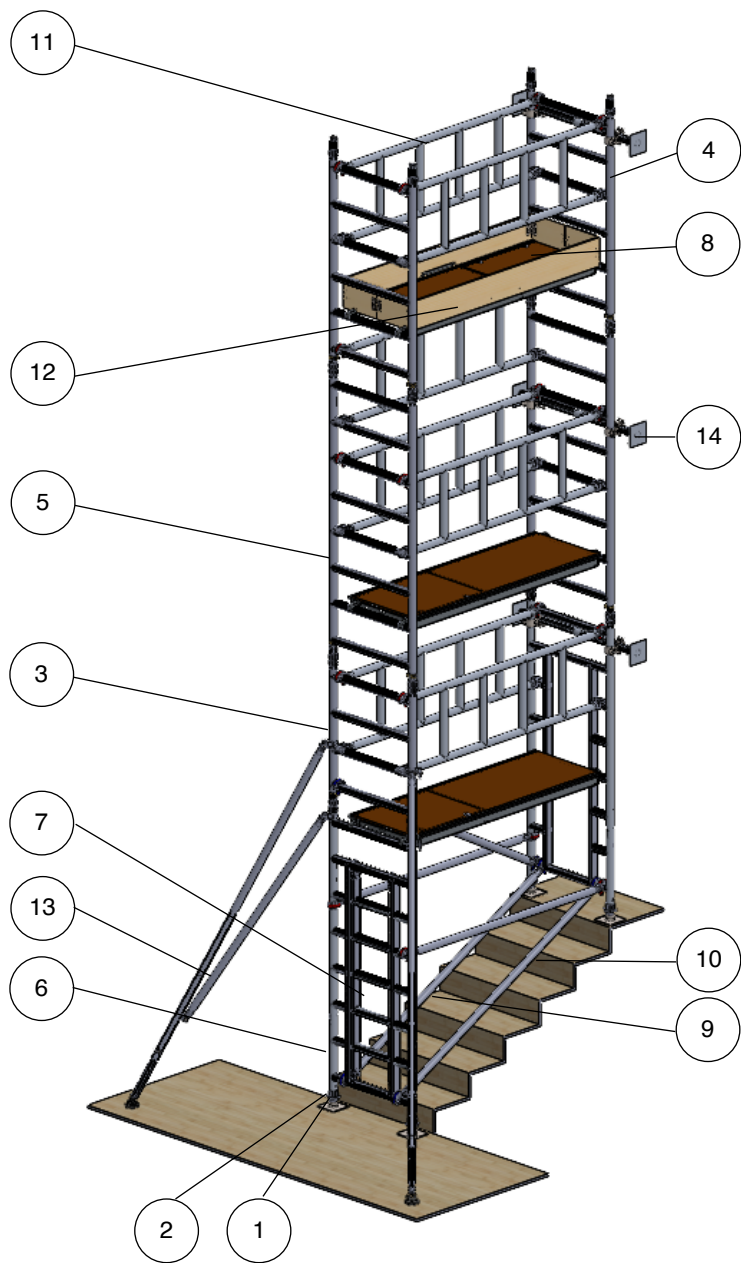

Tower Components

Item	Description	Quantity
1	150mm Base Plate	4
2	Adjustable Leg 500mm	4
3	1m 4 Rung Frame	1
4	1.5m 6 Rung Frame	2
5	2m 8 Rung Frame	2
6	2m 8 Rung Walkthrough Frame	2
7	Walkthrough Frame Ladder	1
8	1.8m Trapdoor Platform	3
9	1.8m Horizontal Brace	2
10	2.1m Diagonal Brace	3
11	1.8m AGR	7
12	Complete Toe Board Set	1
13	S2 Stabiliser	0 or 2 or 4
14	Stairwel Brace	6 or 3 or 0
15	Instruction Manual & EN1004:-1:2020 certificate of conformity	1

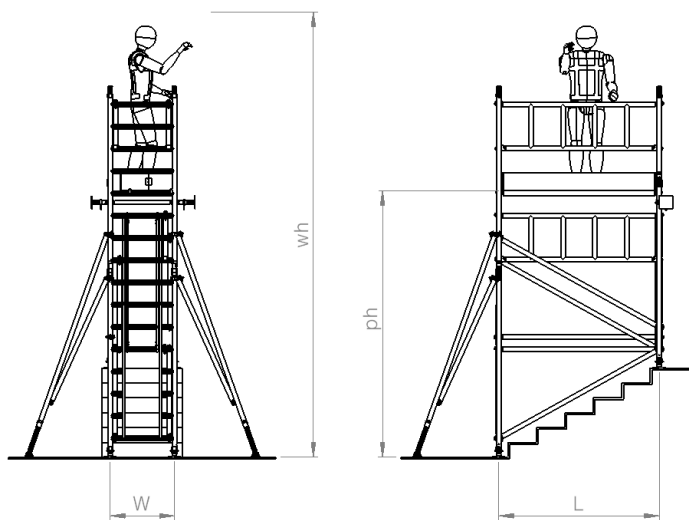

Technical information:

Base Dimensions:	(L)1.8m X (W)0.72m
Maximum Platform Height (ph):	5.3m
Maximum Working Height (wh):	7.3m
Maximum Working Load Per Platform:	275kg
Maximum Working Load Per Tower: (including tower weight)	950kg
Weight:	199.0kg

Note:

Use a combination of stabilisers and stairwell braces:
4 stabilisers and no braces
2 stabilisers and 3 brace
0 stabilisers and 6 braces

Stairwell Tower
1.8m Long x 0.72m Wide

Working Height
7.8m

Platform Height
5.8m

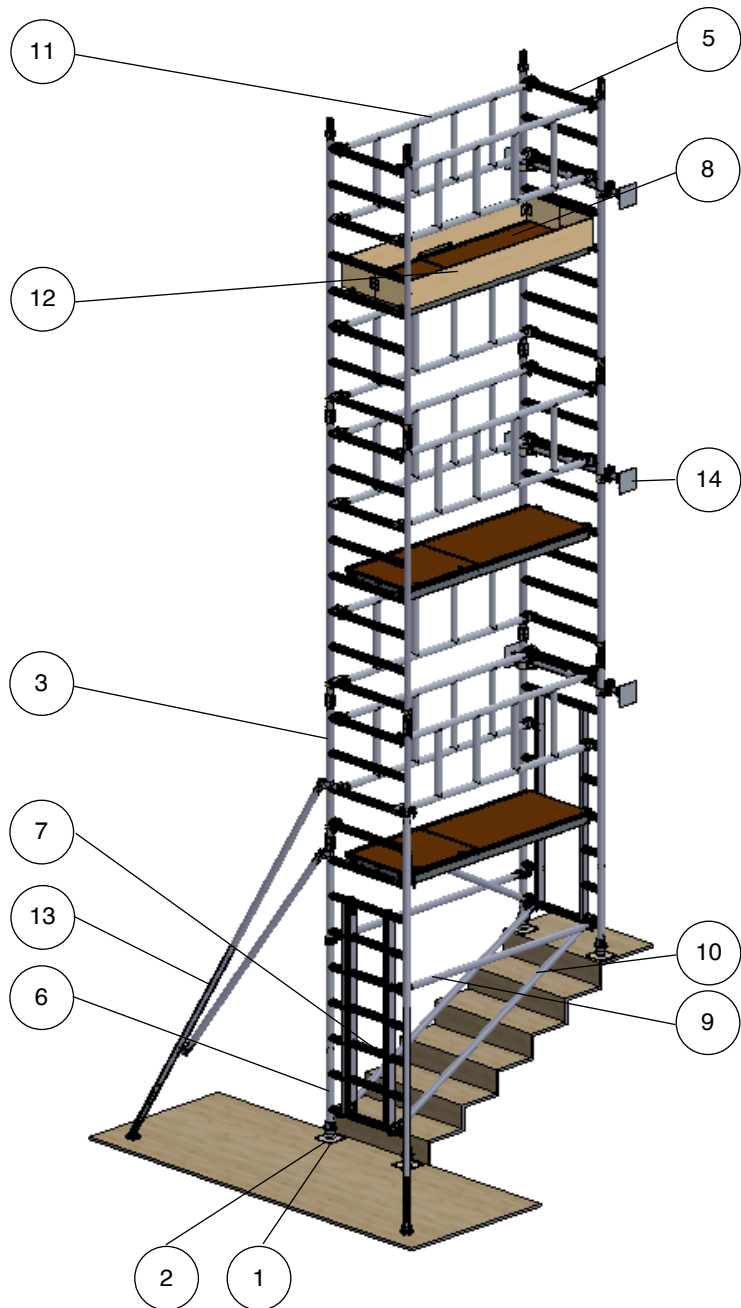

Tower Components

Item	Description	Quantity
1	150mm Base Plate	4
2	Adjustable Leg 500mm	4
3	1m 4 Rung Frame	1
4	1.5m 6 Rung Frame	0
5	2m 8 Rung Frame	4
6	2m 8 Rung Walkthrough Frame	2
7	Walkthrough Frame Ladder	1
8	1.8m Trapdoor Platform	3
9	1.8m Horizontal Brace	2
10	2.1m Diagonal Brace	3
11	1.8m AGR	8
12	Complete Toe Board Set	1
13	S2 Stabiliser	0 or 2 or 4
14	Stairwel Brace	6 or 3 or 0
15	Instruction Manual & EN1004:-1:2020 certificate of conformity	1

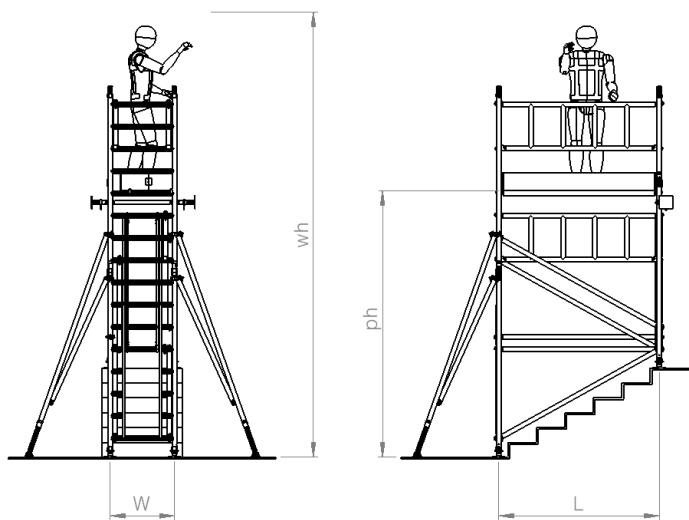

Technical information:

Base Dimensions:	(L)1.8m X (W)0.72m
Maximum Platform Height (ph):	5.8m
Maximum Working Height (wh):	7.8m
Maximum Working Load Per Platform:	275kg
Maximum Working Load Per Tower: (including tower weight)	950kg
Weight:	205.3kg

Note:

Use a combination of stabilisers and stairwell braces:
 4 stabilisers and no braces
 2 stabilisers and 3 brace
 0 stabilisers and 6 braces

Stairwell Tower
1.8m Long x 0.72m Wide

Working Height
8.3m

Platform Height
6.3m

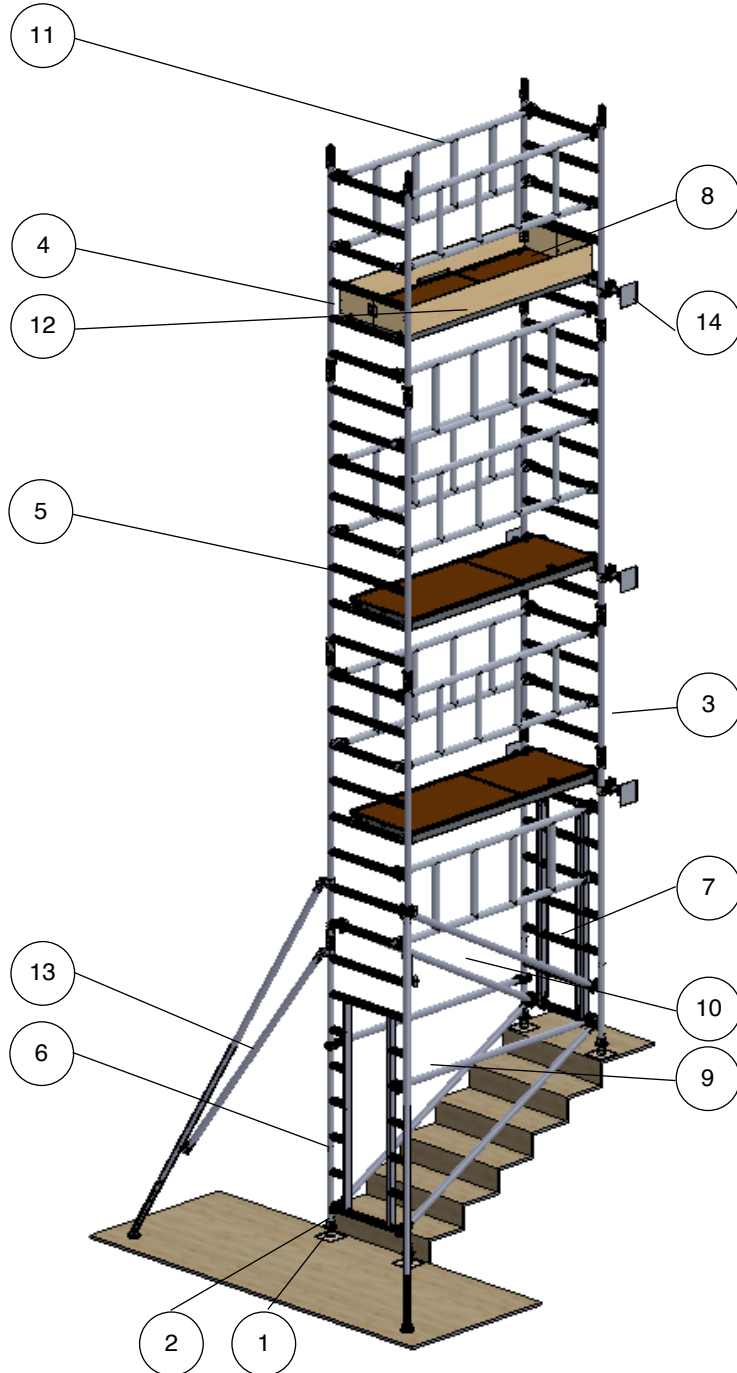

Tower Components

Item	Description	Quantity
1	150mm Base Plate	4
2	Adjustable Leg 500mm	4
3	1m 4 Rung Frame	1
4	1.5m 6 Rung Frame	2
5	2m 8 Rung Frame	3
6	2m 8 Rung Walkthrough Frame	2
7	Walkthrough Frame Ladder	1
8	1.8m Trapdoor Platform	3
9	1.8m Horizontal Brace	2
10	2.1m Diagonal Brace	4
11	1.8m AGR	8
12	Complete Toe Board Set	1
13	S2 Stabiliser	0 or 2 or 4
14	Stairwel Brace	6 or 3 or 0
15	Instruction Manual & EN1004:-1:2020 certificate of conformity	1

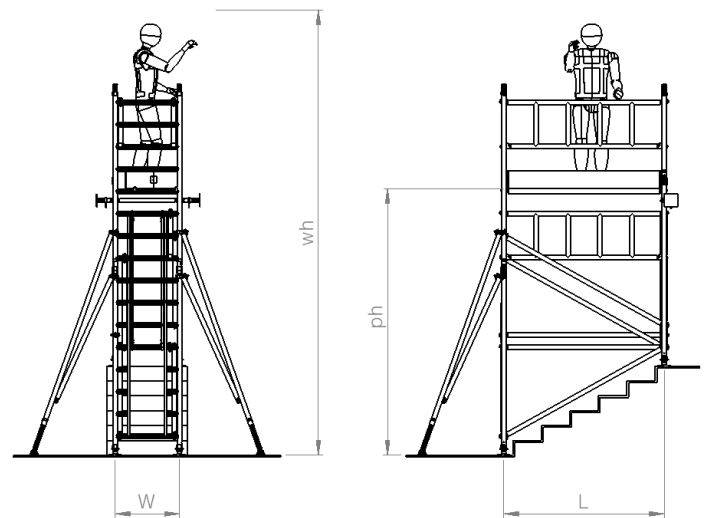

Technical information:

Base Dimensions:	(L)1.8m X (W)0.72m
Maximum Platform Height (ph):	6.3m
Maximum Working Height (wh):	8.3m
Maximum Working Load Per Platform:	275kg
Maximum Working Load Per Tower: (including tower weight)	950kg
Weight:	218.0kg

Note:

Use a combination of stabilisers and stairwell braces:
 4 stabilisers and no braces
 2 stabilisers and 3 brace
 0 stabilisers and 6 braces

Stairwell Tower
1.8m Long x 0.72m Wide

Working Height
8.8m

Platform Height
6.8m

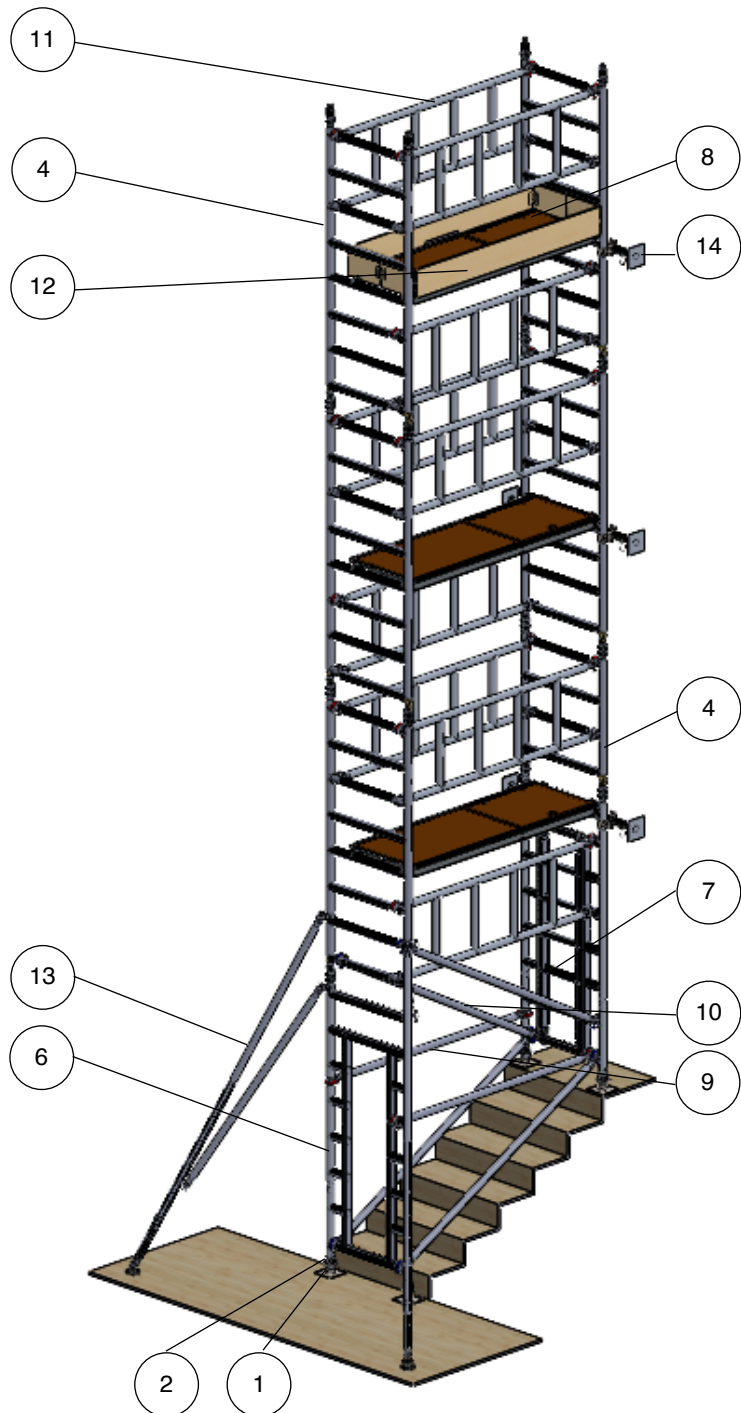

Tower Components

Item	Description	Quantity
1	150mm Base Plate	4
2	Adjustable Leg 500mm	4
3	1m 4 Rung Frame	1
4	1.5m 6 Rung Frame	0
5	2m 8 Rung Frame	5
6	2m 8 Rung Walkthrough Frame	2
7	Walkthrough Frame Ladder	1
8	1.8m Trapdoor Platform	3
9	1.8m Horizontal Brace	2
10	2.1m Diagonal Brace	4
11	1.8m AGR	9
12	Complete Toe Board Set	1
13	S2 Stabiliser	0 or 2 or 4
14	Stairwel Brace	6 or 3 or 0
15	Instruction Manual & EN1004:-1:2020 certificate of conformity	1

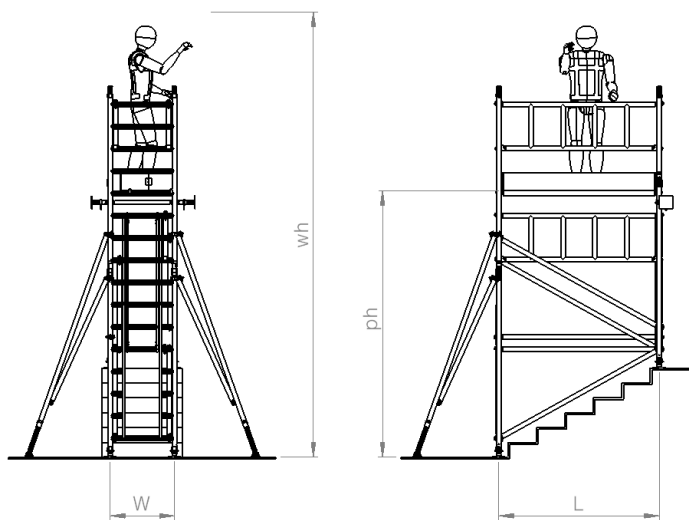

Technical information:

Base Dimensions:	(L)1.8m X (W)0.72m
Maximum Platform Height (ph):	6.8m
Maximum Working Height (wh):	8.8m
Maximum Working Load Per Platform:	275kg
Maximum Working Load Per Tower: (including tower weight)	950kg
Weight:	223.5kg

Note:

Use a combination of stabilisers and stairwell braces:
 4 stabilisers and no braces
 2 stabilisers and 3 brace
 0 stabilisers and 6 braces