



V4

Performance Hardware



30mm Blocks



A2030
 "Perfect for the 49er mainsheet system,
 I wouldn't use anything else"
 Dylan Fletcher

Dylan Fletcher & Stu Bithell - 49er

30mm



| Part | Description | Length mm | Max Line Dia. mm | Shackle Pin mm | Breaking Load kg | MWL kg | Weight g |
|------------|-------------------------------------|-----------|------------------|----------------|------------------|--------|----------|
| A2030 | Single | 49 | 8 | - | 750 | 140 | 26 |
| A2030F | Single Fork Head With Removable Pin | 56 | 8 | 5 | 450 | 140 | 31 |
| A2030F-873 | Single Fork Head With Kicker Key | 77 | 8 | 5 | 450 | 140 | 40 |
| A2030HL | Single High Load | 49 | 8 | - | 800 | 300 | 39 |
| A2030Tii | Single Tii-On | 42 | 8 | - | 750 | 140 | 24 |



| Part | Description | Length mm | Max Line Dia. mm | Shackle Pin mm | Breaking Load kg | MWL kg | Weight g | Hole Centres mm |
|--------------|--|-----------|------------------|----------------|------------------|--------|----------|-----------------|
| A2030HLF | Single Fork Head With High Load Sheave | 56 | 8 | 5 | 750 | 300 | 43 | |
| A2030HLF-873 | Single High Load Dynamic Fork Head With SA.873 | 77 | 8 | 5 | 750 | 300 | 52 | |
| A2030TiiHL | Single Tii-On High Load | 41 | 8 | - | 800 | 300 | 37 | |
| A2031 | Single Multi Function | 47 | 8 | 4 | 500 | 140 | 28 | - |
| A2036 | Cheek Block | 59 | 8 | 4 | 500 | 140 | 35 | - |
| A2036M | Composite Cheek | 50 | 8 | - | 400 | 140 | 24 | 30 |

30mm Dynamic Blocks

Allen 30mm Dynamic Blocks use the same high quality dynamic bearing, materials and precision engineering as our 20mm Dynamic Block range. Our high strength and rope friendly stainless steel ultra-strap makes them amongst the strongest and most reliable ball bearing blocks in their class. The range is available with different types of accessories including lacing eyes, hooks, swivels and cleats. The range also features a central rivet that provides great options as a tie on becket.

You'll find a 30mm block to suit most control line applications.



| Part | Description | Length mm | Max Line Dia. mm | Breaking Load kg | MWL kg | Weight g |
|-----------------|--------------------------|-----------|------------------|------------------|--------|----------|
| A2030XHL-BLACK | Extreme High Load Black | 43 | 8 | 1250 | 500 | 41 |
| A2030XHL-BLUE | Extreme High Load Blue | 43 | 8 | 1250 | 500 | 41 |
| A2030XHL-GOLD | Extreme High Load Gold | 43 | 8 | 1250 | 500 | 41 |
| A2030XHL-ORANGE | Extreme High Load Orange | 43 | 8 | 1250 | 500 | 41 |
| A2030XHL-PURPLE | Extreme High Load Purple | 43 | 8 | 1250 | 500 | 41 |
| A2030XHL-SILVER | Extreme High Load Silver | 43 | 8 | 1250 | 500 | 41 |



| Part | Description | Length mm | Max Line Dia. mm | Shackle Pin mm | Breaking Load kg | MWL kg | Weight g | Hole Centres mm |
|--------------|------------------------------------|-----------|------------------|----------------|------------------|--------|----------|-----------------|
| A2030SC | Swivel Block | 66 | 8 | 4 | 450 | 140 | 36 | - |
| A2031F | Single Fork Head | 59 | 8 | 4 | 450 | 140 | 36 | - |
| A2031SC | Single Swivel Fork | 63 | 8 | 4 | 400 | 140 | 37 | - |
| A2031XHL-873 | Extreme High Load Block With A.873 | 48 | 8 | - | 1000 | 500 | 55 | - |
| A9030 | TiiTAN Block | 40 | 8 | - | 1250 | 500 | 29 | - |
| A9031-873 | TiiTAN Block ILCA Vang Block | 48 | 8 | 5 | 1000 | 500 | 43 | - |



| Part | Description | Length mm | Max Line Dia. mm | Shackle Pin mm | Breaking Load kg | MWL kg | Weight g | Hole Centres mm |
|---------------|------------------------------------|-----------|------------------|----------------|------------------|--------|----------|-----------------|
| A2030SHK | Single With Swivel Hook | 70 | 8 | - | 450 | 140 | 35 | - |
| A2030LZ | Stand-Up Fixed | 59 | 8 | - | 500 | 140 | 30.2 | 34 |
| A2039FIDDLE | Single With Fiddle | 85 | 8 | 4 | 600 | 140 | 47 | - |
| A2039-CAM | Single With Fiddle And Cleat | 88 | 8 | 4 | 600 | 140 | 86.2 | - |
| A2039-CAM-LDC | Single With Fiddle, Cleat and Hook | 100 | 8 | - | 600 | 140 | 86 | - |



| Part | Description | Length mm | Max Line Dia. mm | Shackle Pin mm | Breaking Load kg | MWL kg | Weight g |
|----------|-------------------------|-----------|------------------|----------------|------------------|--------|----------|
| A2032A | Articulating Double | 63 | 8 | - | 1250 | 280 | 61.6 |
| A2032 | Double | 63 | 8 | - | 1250 | 280 | 72 |
| A2032HL | Double High Load Sheave | 63 | 8 | - | 1250 | 450 | 87 |
| A2032Tii | Double Tii-On | 42 | 8 | - | 1250 | 280 | 48 |
| A2033 | Double With Becket | 76 | 8 | - | 1250 | 280 | 77 |
| A2136M | Double Composite Cheek | 50 | 8 | - | 400 | 280 | 36.6 |



| Part | Description | Length mm | Max Line Dia. mm | Shackle Pin mm | Breaking Load kg | MWL kg | Weight g |
|---------|---------------------|-----------|------------------|----------------|------------------|--------|----------|
| A2034A | Articulating Triple | 63 | 8 | - | 1750 | 490 | 82.2 |
| A2034 | Triple | 63 | 8 | 1750 | 490 | 103 | - |
| A2034HL | Triple High Load | 63 | 8 | 1750 | 650 | 132 | - |
| A2035 | Triple With Becket | 83 | 8 | 1750 | 420 | 114 | - |



| Part | Description | Length mm | Max Line Dia. mm | Shackle Pin mm | Breaking Load kg | MWL kg | Weight g |
|--------------|-------------------------|-----------|------------------|----------------|------------------|--------|----------|
| A2036-PROFIX | Cheek Adaptor For A2031 | - | - | - | - | - | 3.8 |
| A5405S | Shackle Head For A2031 | 19 | - | 5 | 1250 | - | 9 |

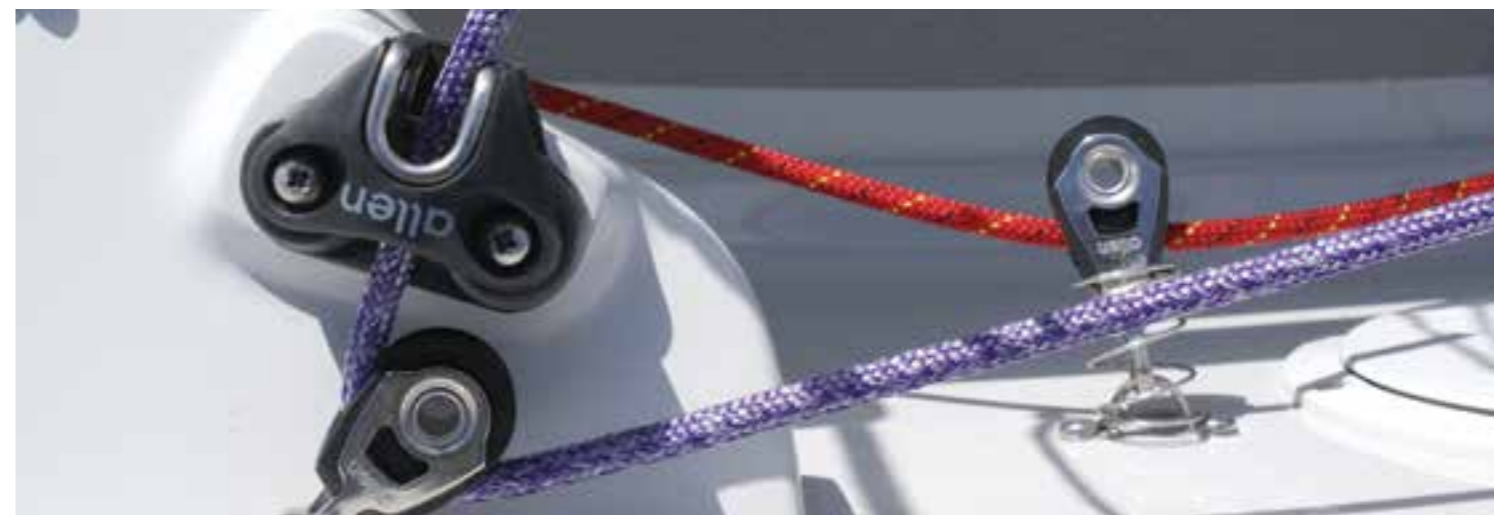

| Part | Description | Length mm | Max Line Dia. mm | Shackle Pin mm | Breaking Load kg | MWL kg | Weight g |
|---------|-----------------------|-----------|------------------|----------------|------------------|--------|----------|
| A2030R2 | Two Singles On Ring | - | 8 | - | 750 | 140 | 82.5 |
| A2030R3 | Three Singles On Ring | - | 8 | - | 750 | 140 | 108.5 |



| Part | Description | Length mm | Max Line Dia. mm | Shackle Pin mm | Breaking Load kg | MWL kg | Weight g |
|-----------|-----------------------------------|-----------|------------------|----------------|------------------|--------|----------|
| A2034-676 | Triple With Inverted Cleat | 65 | 8 | - | 1750 | 490 | 193 |
| A2035-676 | Triple, Becket And Inverted Cleat | 83 | 8 | - | 1750 | 490 | 200 |
| A2037 | Triple, Cleat & Becket | 83 | 8 | - | 1750 | 490 | 208 |



| Part | Description | Length mm | Max Line Dia. mm | Shackle Pin mm | Breaking Load kg | MWL kg | Weight g |
|----------|--------------------------|-----------|------------------|----------------|------------------|--------|----------|
| A2038 | Back To Back | 78 | 8 | - | 750 | 140 | 49 |
| A2038HL | Back To Back High Load | 78 | 8 | - | 750 | 600 | 76 |
| A2039 | Linked A2030 Blocks | 94 | 8 | - | 750 | 140 | 52 |
| A2030-40 | Linked 30 Andd 40 Blocks | 110 | 8/10 | - | 750 | 140 | 63 |



| Part | Description | Length mm | Max Line Dia. mm | Shackle Pin mm | Breaking Load kg | MWL kg | Weight g | Hole Centres mm |
|---------|---|-----------|------------------|----------------|------------------|--------|----------|-----------------|
| A2131 | Single Through Deck | 47 | 8 | - | 500 | 140 | 25.6 | 60 |
| A2131HL | Single Through Deck Block With Steel Sheave | 47 | 8 | - | 500 | - | 25.6 | 60 |
| A2132 | Double Through Deck | 77 | 8 | - | 500 | 140 | 45 | 90 |
| A2132HL | Double Through Deck Block With Steel Sheave | 77 | 8 | - | 500 | - | - | - |



| Part | Description | Length mm | Max Line Dia. mm | Shackle Pin mm | Breaking Load kg | MWL kg | Weight g | Hole Centres mm |
|-----------|----------------------------------|-----------|------------------|----------------|------------------|--------|----------|-----------------|
| A2133 | Flip Flop Block | - | 8 | - | 700 | 140 | 53 | 20 |
| A2133-677 | Flip Flop Block With A.677 Cleat | - | 8 | - | 700 | 140 | 119 | 20 |
| A2133-77 | Flip Flop Block With A..77 Cleat | - | 8 | - | 700 | 140 | 128 | 20 |
| A4101 | Upstand Block | 45 | 8 | - | 850 | 140 | 57 | 25 |
| A4111 | Double Upstand Block | 45 | 8 | - | 850 | 140 | 46 | 47 x 25 |

High Load Blocks

High Load Blocks fit between the standard dynamic range and the XHL range. The blocks feature a stainless-steel sheave which runs on a double race of stainless-steel ball bearings. By utilising a stainless-steel sheave with a slight V shape profile, the Allen High Load range offers the ability to be paired with both wire and Dyneema®. This design also reduces deformation of the sheave under high static loads. These combinations result in less friction, higher working loads, better performance and durability over the acetal sheave Dynamic Block range.



20mm

| Part | Description | Length mm | Max Line Dia. mm | Shackle Pin mm | Breaking Load kg | MWL kg | Weight g | Sheave Dia. mm |
|--------------|----------------------------------|-----------|------------------|----------------|------------------|--------|----------|----------------|
| A2020HL | Single High Load | 37 | 6 | - | 540 | 250 | 17.5 | 20 |
| A2020HL-4036 | Single High Load With Lacing Eye | 52 | 6 | - | 540 | 250 | 21 | 20 |
| A2022HL | Double High Load | 48 | 6 | - | 600 | 325 | 42 | 20 |
| A2024HL | Triple High Load | 50 | 6 | - | 650 | 400 | 63 | 20 |
| A2028HL | Back To Back High Load | 52 | 6 | - | 540 | 300 | 32 | 20 |

30mm

| Part | Description | Length mm | Max Line Dia. mm | Shackle Pin mm | Breaking Load kg | MWL kg | Weight g | Sheave Dia. mm |
|------------|--|-----------|------------------|----------------|------------------|--------|----------|----------------|
| A2030HL | Single High Load | 49 | 8 | - | 800 | 300 | 39 | 30 |
| A2030HLF | Single Fork Head With High Load Sheave | 56 | 8 | 5 | 750 | 300 | 43 | 30 |
| A2030TiiHL | Single Tii-On High Load | 41 | 8 | - | 800 | 300 | 37 | 30 |
| A2032HL | Double High Load Sheave | 63 | 8 | - | 1250 | 450 | 87 | 30 |
| A2034HL | Triple High Load | 63 | 8 | - | 1750 | 650 | 132 | 30 |
| A2038HL | Back To Back High Load | 78 | 8 | - | 750 | 600 | 76 | 30 |

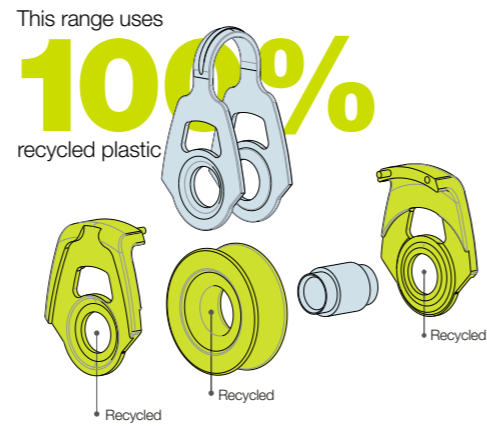

Plain Bearing Blocks



The new range of plain bearing blocks is made using 100% recycled plastics as well as 20% less material than the previous version. Using the outer cheek and strap from the 20 and 30mm dynamic range allows us to manufacture this new range more efficiently, whilst helping to reduce the long-term impact of plastics and un-recyclable materials on the environment. More Eco-friendly they also feature a grey sheave to differentiate them from the existing dynamic range, which sheave is Black. Plain bearing blocks offer great static loading capabilities at a low weight and cost, making them perfect for take-up systems or applications that don't require high dynamic performance.

| Part | Description | Length mm | Max Line Dia. mm | Breaking Load kg | Weight g | Sheave Dia. mm | Fixing Hole Centres mm |
|--------------------|---|-----------|------------------|------------------|----------|----------------|------------------------|
| 20mm A2020P | Single | 37 | 6 | 540 | 10 | 20 | - |
| A2020P-4035 | Single With P-Clip | 62.4 | 6 | 540 | 13.9 | 20 | - |
| A2020P-4036 | Single With Lacing | 52 | 6 | 540 | 13.9 | 20 | 15 |
| A2026P | Single Cheek | 45 | 6 | 350 | 14.2 | 20 | - |
| A2020PSC | Single With Swivel | 53 | 6 | 350 | 18 | 20 | - |
| A2020PSHK | Single With Swivel | 57.7 | 6 | 350 | 17.9 | 20 | - |
| A2020PTi3 | Plain Bearing Ti3-On | 29 | 6 | 540 | 7 | 20 | - |
| A2020PTii | Tii-On | 29 | 6 | 540 | 7 | 20 | - |
| A2021P | Single Multi-Function Single | 35 | 6 | 350 | 10.4 | 20 | - |
| A2021PHK | Single With Hook | 65.5 | 6 | 165 | 16.4 | 20 | - |
| A2022P | Double | 47.6 | 6 | 500 | 29.4 | 20 | - |
| A2022PSHK | Plain Bearing Double With Swivel Hook | 57.7 | 6 | 500 | 32 | 20 | - |
| A2023P | Double With Becket | 59 | 6 | 500 | 31.2 | 20 | - |
| A2024P | Triple | 50.1 | 6 | 650 | 44.6 | 20 | - |
| A2025P | Triple With Becket | 66 | 6 | 650 | 49.6 | 20 | - |
| A2020PLZ | Single Stand Up Fixed | 43 | 6 | 540 | 14.3 | 20 | 27 |
| A2121P | Through Deck Single | 54 | 6 | 400 | 10.8 | 20 | 42 |
| A2122P | Plain Bearing Double Through Deck Block | 75 | 6 | 350 | 20 | 20 | 63 |

| Part | Description | Length mm | Max Line Dia. mm | Breaking Load kg | Weight g | Sheave Dia. mm | Fixing Hole Centres mm |
|--------------------|---|-----------|------------------|------------------|----------|----------------|------------------------|
| 30mm A2030P | Single | 49 | 8 | 750 | 23 | 30 | - |
| A2030PF | Single With Fork Head and Removable Pin | 56 | 8 | 600 | 28 | 30 | - |
| A2030PF-873 | Single With Fork Head and Vang Key | 77 | 8 | 600 | 37 | 30 | - |
| A2036P | Single Cheek | 58.7 | 8 | 500 | 32 | 30 | - |
| A2030PSC | Single With Swivel | 66.3 | 8 | 600 | 33 | 30 | - |
| A2030PSHK | Single With Swivel Hook | 70.4 | 8 | 450 | 32 | 30 | - |
| A2031P | Single Multi-Function | 46.6 | 8 | 750 | 25 | 30 | - |
| A2032P | Double | 64 | 8 | 1250 | 66 | 30 | - |
| A2033P | Double With Becket | 76 | 8 | 1250 | 71 | 30 | - |
| A2034P | Triple | 62.6 | 8 | 1750 | 94 | 30 | - |
| A2035P | Triple With Becket | 82.5 | 8 | 1750 | 105 | 30 | - |
| A2030PLZ | Single Stand Up Fixed | 59 | 8 | 500 | 27.2 | 30 | - |
| A2131P | Plain Bearing Single Through Deck Block | 47 | 8 | 500 | 25.6 | 30 | 60 |
| A2132P | Double Through Deck Block | 104 | 8 | 500 | 45 | 30 | 60 |

High Roller Blocks

TiiTAN & XHL

High Roller Block Range - High performance blocks designed for high stakes sailing.

Lightweight aluminium side cheeks encapsulate an aluminium sheave, which free spins on roller bearings and side load ball bearings.

Easily unassembled and serviced to give longer lasting high performance.

Ideal for fast running and highly loaded lines on big boats. Applications such as: mainsheets, runners, halyards, spinnaker systems, jib sheets and control lines.

TiiTAN

The TiiTAN Block is a further development from our XHL range. Weighing in at only 28 grams makes the TiiTAN the lightest and strongest 30mm ball bearing pulley available on the market. This is an incredible 30% weight reduction when compared to the 30mm XHL block.

Find out more by scanning the QR code



Fanatic, Cape 31 – Credit: Paul Wyeth



Features:

- Ceramic ball bearings for reduced friction in salt water.
- Titanium sheave for maximum weight reduction.
- Chamfered rope guide for soft attachment with two lashing holes.
- Upgraded XHL bearing system

HIGH ROLLER BLOCKS

TiiTAN BLOCK

A9040

This is the smallest block available on the market which features a high load two-stage roller bearing system. Roller (needle) bearings take the main loads of the sheave and offer great sheave rolling speeds at high loads. The side load ball bearings cater for any off-centre loading and minimise friction further.

A9060

The 60mm high roller block features caged roller (needle) bearings. The cage keeps the rollers spread evenly around the sheave whilst also stopping the rollers from rubbing together. This reduces friction and allows for faster rolling speeds. The side load ball bearings cater for any off-centre loading and minimise friction further.

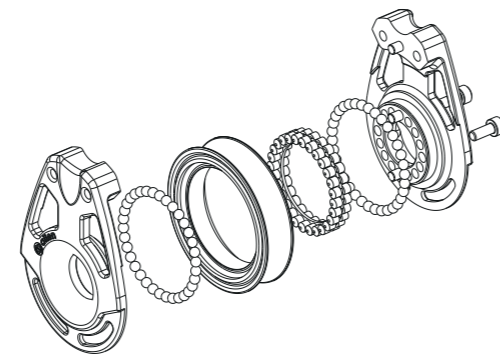

| Part | Description | Breaking Load kg | Length mm | Max Line Dia. mm | MWL kg | Sheave Dia. mm | Weight g | Hole Centres mm |
|--------|---------------------------|------------------|-----------|------------------|--------|----------------|----------|-----------------|
| A9040 | Single Tii-On High Roller | 2000 | 55 | 10 | 800 | 40 | 47 | - |
| A9060 | Single Tii-On High Roller | 4000 | 83 | 13 | 2000 | 60 | 132 | - |
| SA9040 | Servicing Kit For A9040 | - | - | - | - | - | - | - |
| SA9060 | Servicing Kit For A9060 | - | - | - | - | - | - | - |

XHL

The XHL range has been designed to deal with extremely high loads without compromising on low load dynamic performance. This is achieved with our XHL bearing system which features twin rows of stainless steel ball bearings running on a stainless steel axle paired with a precision plain bearing washer. When the XHL range is exposed to extreme static loads, it changes to a plain bearing block. Stopping the ball bearings from getting damaged. As soon as the static load is reduced the XHL returns to a high-performing dynamic block.

Features:

- Stainless steel ball bearings for long lasting performance.
- Stainless steel sheave with V profile, optimised for the fast running of rope without weakening the working load of the line.
- Aluminium side cheeks for a stronger and longer-lasting body which holds its shape under extreme loads.
- Available in six colours: Blue, Black, Silver, Gold, Orange, Purple.

The TiiTAN and XHL range is ideal for use in vang cascades and halyard or control line turning points where static loads can be extremely high but low load dynamic performance is required.

| Part | Description | Breaking Load kg | MWL kg | Sheave Size mm | Length mm | Maximum Line Dia. mm | Weight g |
|--------------|--|------------------|--------|----------------|-----------|----------------------|----------|
| A2020XHL | Extreme High Load Block | 900 | 400 | 20 | 29 | 6 | 17 |
| A2031XHL-873 | Extreme High Load Vang Block With SA.873 | 1000 | 500 | 30 | 57 | 8 | 55 |
| A2030XHL | Extreme High Load Block | 1250 | 500 | 30 | 43 | 8 | 41 |
| A2040XHL | Extreme High Load Block | 1500 | 650 | 40 | 54 | 8 | 71 |
| A9031-873 | TiiTAN Vang Block With SA.873 | 1000 | 500 | 30 | 69 | 8 | 43 |
| A9030 | TiiTAN Block | 1250 | 500 | 30 | 40 | 8 | 28 |



Tii-On Blocks

Our Tii-On Blocks feature a stainless steel loop at the head of the block. This gives our range maximum strength and reliability with minimal cheek separation when tied on and loaded up with a soft shackle. The stainless steel head loop also ensures the block stays in the right orientation when being used.



| Part | Description | Length mm | Max Line Dia. mm | Breaking Load kg | MWL kg | Weight g |
|----------|---------------|-----------|------------------|------------------|--------|----------|
| A2020Tii | Single Tii-On | 29 | 6 | 540 | 115 | 8 |
| A2022Tii | Double Tii-On | 29 | 6 | 600 | 225 | 15.6 |
| A2030Tii | Single Tii-On | 42 | 8 | 750 | 140 | 24 |
| A2032Tii | Double Tii-On | 42 | 8 | 1250 | 280 | 48 |
| A2040Tii | Single Tii-On | 58 | 10 | 800 | 180 | 34.5 |
| A2050Tii | Single Tii-On | 72 | 10 | 900 | 300 | 61 |
| A2060Tii | Single Tii-On | 84 | 10 | 1400 | 700 | 91 |

Tii-Shackles

This simple and easy attachment system will save weight and give you more options for attaching blocks. Tii-Shackles feature an adjustable loop to make attachment quick and easy. Perfectly designed for use with our Tii-On blocks and Pad-Tii ranges.



| Part Number | Description | For Use With | Length mm | Diameter mm | Breaking Load kg | Weight g |
|-------------|-------------|----------------------|-----------|-------------|------------------|----------|
| A15100 | Tii-Shackle | A2020Tii | 100 | 1.5 | 200 | 0.6 |
| A15110 | Tii-Shackle | 20 & 30mm Tii-Blocks | 110 | 1.5 | 360 | 0.9 |
| A20110 | Tii-Shackle | A2022Tii | 110 | 2 | 200 | 1.3 |
| A25110 | Tii-Shackle | A2030Tii | 110 | 2.5 | 300 | 4.8 |
| A25120 | Tii-Shackle | A2032Tii | 120 | 2.5 | 300 | - |
| A25130 | Tii-Shackle | A2040Tii | 130 | 3 | 400 | - |
| A40140 | Tii-Shackle | A2050Tii | 140 | 4 | 600 | - |
| A40180 | Tii-Shackle | A2060Tii | 180 | 4 | 600 | - |

Dog Bones

Allen Dog Bones can be used in a variety of applications. Ideal for use with soft shackles as rope stops. CNC machined from aluminium our Dog Bones are extremely hard wearing. Available in 6 colours. Black, Blue, Gold, Silver, Purple and Orange

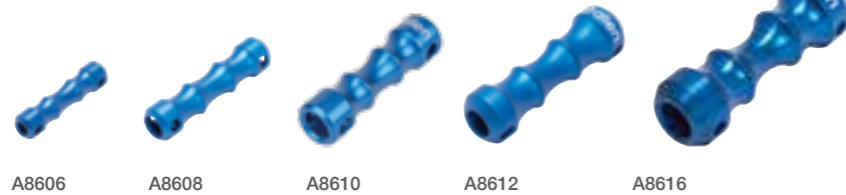

| Part Number | Description | Length mm | Maximum Outside Diameter mm | Minimum Outside Diameter mm | Rope Diameter mm | *Safe Working Load kg | *Breaking Load kg | Weight g |
|-------------|-------------|-----------|-----------------------------|-----------------------------|------------------|-----------------------|-------------------|----------|
| A8606 | Dogbone | 24 | 6 | 4 | 2 - 4 | 350 | 600 | 1 |
| A8608 | Dogbone | 32 | 8 | 6 | 4 - 5 | 600 | 1100 | 3 |
| A8610 | Dogbone | 10 | 10 | 6.5 | 6 | 900 | 1800 | 4.6 |
| A8612 | Dogbone | 40 | 12 | 7 | 5 - 6 | 1400 | 2500 | 7 |
| A8616 | Dogbone | 48 | 16 | 8 | 6 - 8 | 2000 | 3500 | 14 |

*Estimated Loads

High Load Thimbles

Thimbles are a great alternative to blocks when there is a need for high static load capabilities. Our high load thimbles come coated in Teflon to help reduce friction. Machined from aluminium and anodised in a choice of 6 colours, black, blue, silver, purple, gold and orange. Also available in stainless steel.



A..82-8
A..82-10
A..82-14



| Part Number | Description | Inside Diameter mm | Depth mm | Maximum Working Load kg | Weight g |
|-------------|-------------------------|--------------------|----------|-------------------------|----------|
| A..87-15 | Aluminium Thimble | 6 | 6 | 300 | 1 |
| A..87-20 | Aluminium Thimble | 8 | 8 | 400 | 2 |
| A..87-25 | Aluminium Thimble | 10 | 10 | 800 | 5 |
| A..87-30 | Aluminium Thimble | 12 | 12 | 1000 | 7 |
| A..87-35 | Aluminium Thimble | 15 | 14 | 1500 | 11 |
| A..87-50 | Aluminium Thimble | 20 | 21 | 2000 | 40 |
| A..87-75 | Aluminium Thimble | 28 | 31 | 2500 | 154 |
| A..87-90 | Aluminium Thimble | 28 | 39 | 3000 | 289 |
| A..82-8 | Stainless Steel Thimble | 8 | 5 | 150 | 0.5 |
| A..82-10 | Stainless Steel Thimble | 9 | 6 | 250 | 2 |
| A..82-14 | Stainless Steel Thimble | 14 | 8 | 300 | 1.5 |

Pad-Tii

Pad-Tii's are a soft attachment deck fitting which are a great choice if you are looking to add an attachment point to a surface that is low profile and easy to thread rope around. To find out more go to page 61.



| Part Number | Description | Fixing Hole Centres mm | Fixing Hole Depth Maximum mm | Fixing Hole Depth Minimum mm | Fixing Hole Diameter mm | Outside Diameter mm | Breaking Load kg | Maximum Working Load kg | Weight g |
|-------------|-------------------|------------------------|------------------------------|------------------------------|-------------------------|---------------------|------------------|-------------------------|----------|
| A8639-6 | Pad-Tii | 13 | 8 | 6 | 12.8 | 19 | 350 | 250 | 21 |
| A8639-8 | Pad-Tii | 13 | 10 | 8 | 12.8 | 19 | 350 | 250 | 21 |
| A8639-10 | Pad-Tii | 13 | 12 | 10 | 13 | 19 | 350 | 250 | 21 |
| A8739-6 | Pad-Tii | 17 | 8 | 6 | 16 | 24 | 400 | 300 | 7 |
| A8739-8 | Pad-Tii | 17 | 10 | 8 | 16 | 24 | 400 | 300 | 7 |
| A8739-10 | Pad-Tii | 17 | 12 | 10 | 16 | 24 | 400 | 300 | 7 |
| A8739-18 | Pad-Tii | 17 | 20 | 18 | 16 | 24 | 400 | 300 | 10 |
| A881310 | Pad-Tii Fixed Bar | 13 | 10 | 4.5 | 12.8 | 19 | 350 | 250 | 8 |
| A881610 | Pad-Tii Fixed Bar | 17 | 10 | 4.5 | 16 | 24 | 575 | 350 | 10 |
| A82525 | Pad-Tii Fixed Bar | 25 | 25 | 5 | 25 | 38 | 1400 | 700 | 33 |

Ratchet Blocks

AutoRatchet

The Allen AutoRatchet Blocks were the first of their kind on the market some 30 years ago. Years of constant development, with the World's top sailors, has led us to the release of our X2 AutoRatchets. The new "X2" pawl system which incorporates two pawls into the mechanism ensures that the load is evenly shared between both pawls, this means that the block can withstand higher working loads while also increasing both the reliability and longevity. It also features the patented swivel head lock system which can be fixed in position, allowing for more setup options.

Switchable Ratchet

Allen Switchable Ratchet Blocks can easily be switched on or off, even under load. The patented swivel head lock system can be fixed in position, allowing for more setup options. The sheave design gives high grip under load while allowing easy release when required.

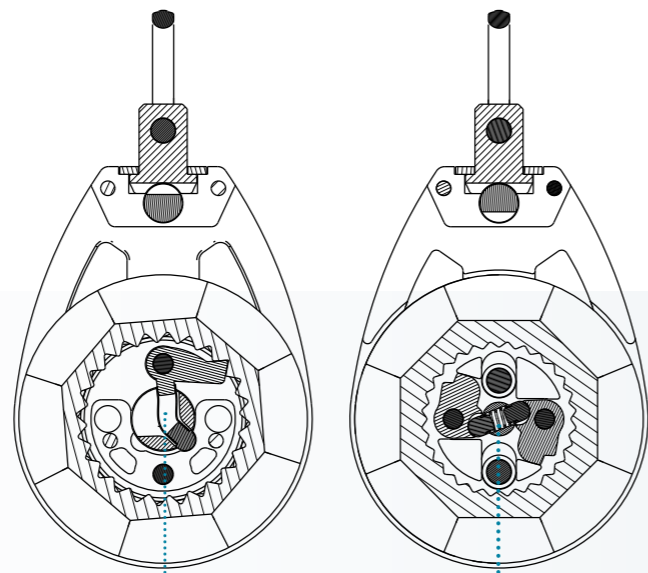

A2160
Switchable-ratchet block - Ratchet mechanism can be switched on and off as required.

A2360
AutoRatchet block - Load sensitive AutoRatchet which is triggered when block comes under load.

Wave Ratchet

The wave ratchet offers 20 to 40%* more grip without adding any additional wear to the rope.

The most effective way to increase friction is to add sharp edges to the ratchet sheave, but this quickly deteriorates and wears away the rope. So, after working alongside leading rope manufacturers the Allen design team came up with a simple solution which improves grip without chewing away at your expensive rope.

The Wave Ratchet sheave has an offset V style grip, made from a hard-wearing recycled plastic nylon, which does not have sharp edges that will eat into the rope. Instead, by adjusting the V formation in the sheave to be slightly offset, the ratchet now grips the rope at additional points around the sheave, resulting in more grip. However, the new Wave Ratchet not only improves grip but as a result of the design it also allows for a less 'jumpy' feel when easing the sheets.

*Depends on the type of rope in use with the sheave.

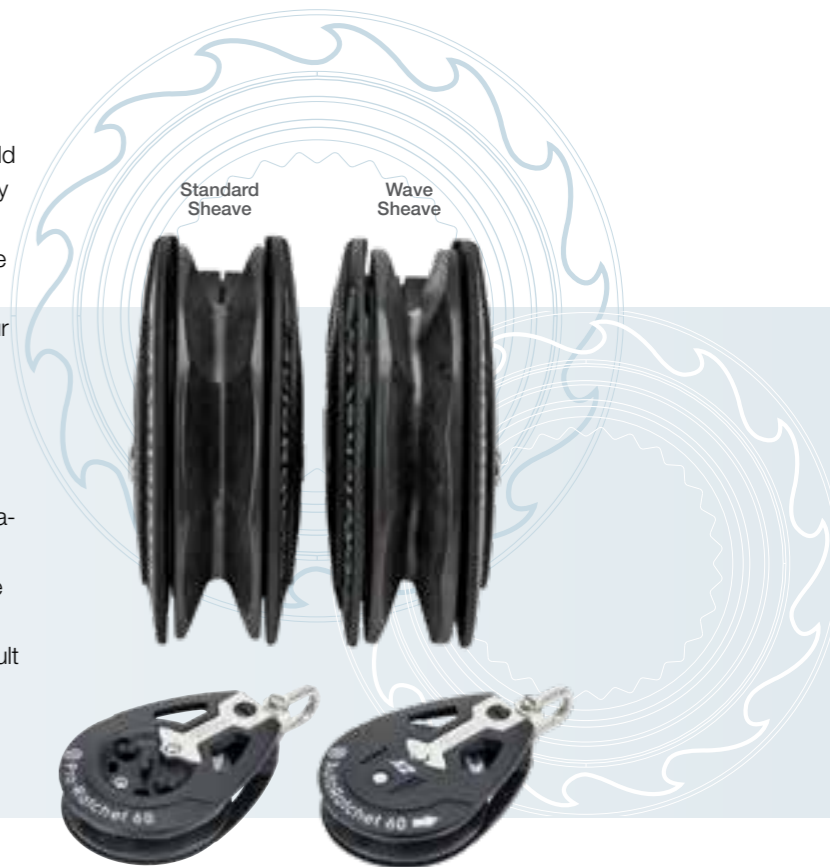

A2160WAVE

A2360WAVE

| Part | Description | Sheave Dia. mm | Length mm | Max Line Dia. mm | Shackle Pin mm | Breaking Load kg | Trigger Load kg | MWL kg | Weight g |
|-----------|------------------------------|----------------|-----------|------------------|----------------|------------------|-----------------|--------|----------|
| A2160WAVE | Pro-Ratchet With Wave Sheave | 60 | 110 | 12 | 5 | 1000 | - | 275 | 110 |
| A2360WAVE | X2 Wave AutoRatchet | 60 | 110 | 12 | 5 | 1000 | 10 | 275 | 139 |



A2140 A2345 A2150

A2345
"Perfect for our kite sheets. Turns on and off exactly when you want it to."
Fynn Sterritt



A2160 A2150C A2160C A2150FIDDLE A2160FIDDLE A2360

| Part | Description | Sheave Dia. mm | Length mm | Max Line Dia. mm | Shackle Pin mm | Breaking Load kg | Trigger Load kg | MWL kg | Weight g |
|-------------|-----------------------------------|----------------|-----------|------------------|----------------|------------------|-----------------|--------|----------|
| A2140 | Pro-Ratchet 40 | 40 | 78 | 6 | 4 | 475 | - | 120 | 40 |
| A2345 | X2 AutoRatchet | 45 | 90 | 8 | 4 | 280 | 10 | 140 | 56 |
| A2150 | Pro-Ratchet 50 | 50 | 95 | 10 | 4 | 700 | - | 200 | 64.5 |
| A2150C | Pro-Ratchet 50 With Cheek Adaptor | 50 | 92 | 10 | 4 | 700 | - | 200 | 80 |
| A2150FIDDLE | Pro-Ratchet 50 With Fiddle | 50 | 126 | 10 | 4 | 700 | - | 200 | 80 |
| A2160 | Pro-Ratchet 60 | 60 | 110 | 12 | 5 | 1000 | - | 275 | 110 |
| A2160C | Pro-Ratchet 60 With Cheek Adaptor | 60 | 108 | 12 | 5 | 1000 | - | 275 | 139 |
| A2160FIDDLE | Pro-Ratchet 60 With Fiddle | 60 | 150 | 12 | 5 | 1000 | - | 275 | 139 |
| A2360 | X2 AutoRatchet | 60 | 110 | 12 | 5 | 1000 | 10 | 275 | 110 |



A2151 A2161 A2058 A2068 A2159 A2169 A.622

A2169 & A2069
"The Quint mainsheet system is really, really smooth"
Laura Marimon

| Part | Description | Sheave Dia. mm | Length mm | Max Line Dia. mm | Shackle Pin mm | Breaking Load kg | MWL kg | Weight g |
|-------|---|----------------|-----------|------------------|----------------|------------------|--------|----------|
| A2151 | Pro-Ratchet With Becket & Cleat | 50 | 136 | 10 | 4 | 700 | 200 | 64.6 |
| A2058 | Triple With Switchable Ratchet & Adjustable Cleat | 50 | 120 | 10 | 4 | 950 | 470 | 394 |
| A2159 | Quint With Switchable Ratchet, Becket & Cleat | 50 | 136 | 10 | 4 | 700 | 200 | 503 |
| A2161 | Single Switchable Ratchet With Becket & Cleat | 60 | 127 | 12 | 5 | 1000 | 275 | 333 |
| A2068 | Triple With Switchable Ratchet, Becket & Cleat | 60 | 145 | 12 | 5 | 1250 | 600 | 535 |
| A2169 | Quint With Switchable Ratchet, Becket & Cleat | 60 | 148 | 12 | 6 | 1000 | 600 | 750 |
| A.622 | Spring Guard For Ratchets | - | - | - | - | - | - | 2.5 |

Flip Flop Blocks

Deck Organiser

30mm Flip Flop Blocks

Flip flop blocks are designed to pivot around a central fixing point, this keeps the rope close to the deck, mast or boom whilst still allowing the block to articulate to the correct lead angle, ensuring friction stays as low as possible whilst still guiding the rope to where it needs to go.



| Part | Description | Breaking Load kg | Fixing Hole Centres mm | Fixing Hole Size mm | Max Line Dia mm | MWL kg | Sheave Size mm | Weight g |
|-----------|---|------------------|------------------------|---------------------|-----------------|--------|----------------|----------|
| A4988X | Lightweight Flip Flop Cleat With Removable Sheave | - | 85.5 | 5 | 10 | 100 | 30 | 108 |
| A2133 | Flip Flop Block | 700 | 20 | 5 | 8 | 140 | 30 | 53 |
| A2133-677 | 30mm Flip Flop Block With A.677 Cleat | 700 | 20 | 5 | 8 | 140 | 30 | 119 |
| A2133-77 | 30mm Flip Flop Block With A..77 Cleat | 700 | 20 | 5 | 8 | 140 | 30 | 128 |

30mm



Blaze Nationals - Credit: Nick Champion

FLIP FLOP BLOCKS

DECK ORGANISER

40mm Flip Flop Blocks



| Part | Description | Breaking Load kg | Fixing Hole Centres mm | Fixing Hole Size mm | Max Line Dia mm | MWL kg | Sheave Size mm | Weight g |
|-----------|--|------------------|------------------------|---------------------|-----------------|--------|----------------|----------|
| A2143 | 40mm Flip Flop Block | - | 60.3 | 5 | 10 | 150 | 40 | 77 |
| A2143-676 | 40mm Flip Flop Block with Allenite Cam Cleat | - | 60.3 | 5 | 10 | 150 | 40 | 210 |
| A2143-76 | 40mm Flip Flop Block With Cam Cleat | - | 60.3 | 5 | 10 | 150 | 40 | 255 |

40mm

Deck Organiser

Designed for leading control lines and halyards along a deck or coach roof.

Features dynamic bearing sheaves. Which uses twin rows of stainless-steel ball bearings running on a stainless-steel rail. This provides a superior load-carrying ability and longevity when compared to other bearing systems which run on a plastic rail.

The cheeks are made from marine grade aluminium and anodised black.



| Part | Description | Breaking Load kg | Length mm | Max Line Dia mm | MWL kg | Sheave Dia. mm | Weight g |
|-------|---------------------|------------------|-----------|-----------------|--------|----------------|----------|
| A2423 | 20mm Deck Organiser | 540 | 87 | 6 | 115 | 20 | 41 |
| A2433 | 30mm Deck Organiser | 700 | 118 | 8 | 140 | 30 | 86 |
| A2443 | 40mm Deck Organiser | 700 | 170 | 16 | 200 | 40 | 208 |

Wire Blocks

Wire Blocks

Specifically intended for use where wire lines are subjected to low rotational high loads. The range uses stainless-steel side cheeks to give maximum strength in the smallest form possible and a single row of spaced stainless-steel ball bearings in the sheave. Available with different accessories including hooks, becket, swivels and shackles giving a whole range of choice to suit the application.



Nick Evans - Optimist - Credit: Sportography TV



A4068



A4379HK-90 A4393 A4393HK A4479 A4993 AB1342



A4679 A4779 A4593 A4693 A4979

| Part | Description | Sheave Dia. mm | Length mm | Max Line Dia. mm | Shackle Pin mm | Breaking Load kg | Weight g |
|------------|--|----------------|-----------|------------------|----------------|------------------|----------|
| A4379HK-90 | Single With 90 Degree Hook | 25 | 90 | 2 - 6 | - | 500 | 81 |
| A4393 | Single Fixed Head With Becket | 25 | 59 | 2 - 5 | 5 | 750 | 31 |
| A4393HK | Single Fixed Head And Becket With Hook | 25 | 103 | 2 - 5 | - | 750 | 81 |
| A4479 | Single With Shackle | 25 | 58 | 2 - 5 | 5 | 750 | 33 |
| A4993 | Single Clevis Pin Head | 25 | 43 | 2 - 5 | 5 | 750 | 31 |
| AB1342 | Brass Sheaved Plain Bearing | 20 | 37 | 6 | - | 540 | - |
| A4679 | Double Fixed Head | 25 | 57 | 2 - 5 | 5 | 750 | 54 |
| A4779 | Double Fixed Head With Becket | 25 | 70 | 2 - 5 | 5 | 750 | 60 |
| A4593 | Triple Fixed Head | 25 | 57 | 2 - 5 | 5 | 750 | 78 |
| A4693 | Triple Fixed Head With Becket | 25 | 70 | 2 - 5 | 5 | 750 | 84 |
| A4979 | Quad Fixed Head | 25 | 51 | 2 - 5 | 5 | 750 | 89 |



A4568 A4668 A4569 A4669 A4570 A4670

| Part | Description | Sheave Diameter mm | Length mm | Max Line Dia. mm | Shackle Pin mm | Breaking Load kg | Weight g |
|-------|--------------------|--------------------|-----------|------------------|----------------|------------------|----------|
| A4568 | Single | 16 | 29 | 2 - 4 | 4 | 400 | 11 |
| A4668 | Single With Becket | 16 | 50 | 4 | 4 | 400 | 40 |
| A4569 | Double | 16 | 40 | 2 - 4 | 4 | 400 | 25 |
| A4669 | Double With Becket | 16 | 50 | 2 - 4 | 4 | 400 | 26 |
| A4570 | Triple | 16 | 40 | 2 - 4 | 4 | 400 | 36 |
| A4670 | Triple With Becket | 16 | 50 | 2 - 4 | 4 | 400 | 38 |

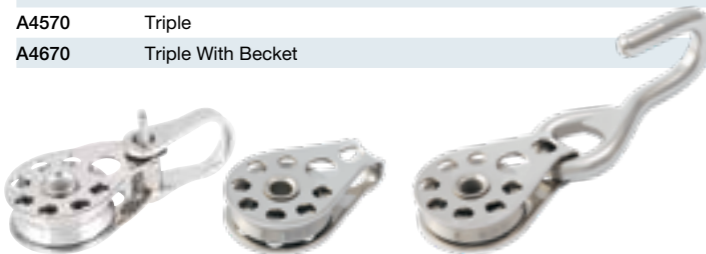

A4279 A4379 A4379HK

| Part | Description | Sheave Diameter mm | Length mm | Max Line Dia. mm | Shackle Pin mm | Breaking Load kg | Weight g |
|---------|---------------------|--------------------|-----------|------------------|----------------|------------------|----------|
| A4279 | Single Flared Cheek | 25 | 41 | 2 - 7 | 5 | 750 | 44 |
| A4379 | Single Fixed Head | 25 | 41 | 2 - 5 | 5 | 750 | 25 |
| A4379HK | Single With Hook | 25 | 105 | 2 - 6 | - | 500 | 81 |



A4196 A4296 A4396



A4496 A4596 A4696 A4796 A4068

| Part | Description | Sheave Dia. mm | Length mm | Max Line Dia. mm | Shackle Pin mm | Breaking Load kg | Weight g |
|-------|-------------------------------|----------------|-----------|------------------|----------------|------------------|----------|
| A4196 | Single Fixed Head | 38 | 62 | 2 - 6 | 5 | 1000 | 71 |
| A4296 | Single With Shackle | 38 | 74 | 2 - 6 | 5 | 1000 | 80 |
| A4396 | Single Fixed Head With Becket | 38 | 80 | 2 - 6 | 5 | 1000 | 84 |
| A4496 | Double Fixed Head | 38 | 74 | 2 - 6 | 5 | 1000 | 141 |
| A4596 | Double Fixed Head With Becket | 38 | 93 | 2 - 6 | 5 | 1000 | 150 |
| A4696 | Triple Fixed Head | 38 | 74 | 2 - 6 | 5 | 1000 | 195 |
| A4796 | Triple Fixed Head With Becket | 38 | 93 | 2 - 6 | 5 | 1000 | 208 |
| A4068 | Optimist Sprit | 16 | 55 | 2 - 4 | 4 | 400 | 20 |

BLOCKS

CLEATS &
JAMMERS

TRACK &
KEELBAND

DECK & HULL
FITTINGS

SPARS &
RIGGING

RUDDERSTOCK
& ACCESSORIES

SAILMAKERS
HARDWARE

SHACKLES

ACCESSORIES

DISTRIBUTORS &
MAJOR STOCKIST

PRODUCT CODE
INDEX



**SAIL-VOILE
CANADA**

Hardware partner to the Canadian Sailing Team



www.allenbrothers.co.uk



[allensailinghardware](https://www.facebook.com/allensailinghardware)



[@allen_sailing](https://twitter.com/allen_sailing)



[@allen_sailing](https://www.instagram.com/allen_sailing)



sales@allenbrothers.co.uk