



Cordless Rotary Tool

Operator's Manual



Thank you for purchasing this product. To ensure proper use and trouble-free operation, please read this guide carefully before operating. If there is any issue, please contact us via Amazon or email:

hardell.service@gmail.com, we will help you within 12 hours.

Product Descriptions

Components



1. Chuck --2.4mm
2. Spindle Locking Button (**DON'T press it when the device is running**)
3. Speed Indicator (5000/10000/15000rpm)
4. USB Charging Port
5. Heat Dissipation Holes(Dissipate the heat produced by the motor operation)
6. Speed Button(3-level rate, Low/Middle/High Speed)

Specification

INPUT: 5V

No Load Speed: 5000-15000/min

Speed Settings: 3

Collect Size: ϕ 2.4mm

Charge time: 0.5 hours (Fully charged, the indicator light lights up)

Weight: 0.3kg

Try not to use it until it is completely dead and cannot be recharged, especially if it's out of charge, still press the power button, it may happens battery dead.

Please full charge the main device before using



1. When charging:
Red Light



2. When full charged :
Green Light

Package Includes



NOTE: The product contains a 2.4 mm collet

How to Use

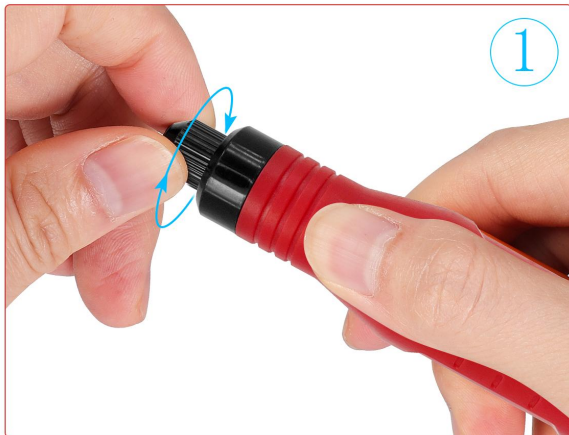

1. Press down the spindle locking button and unscrew the nut

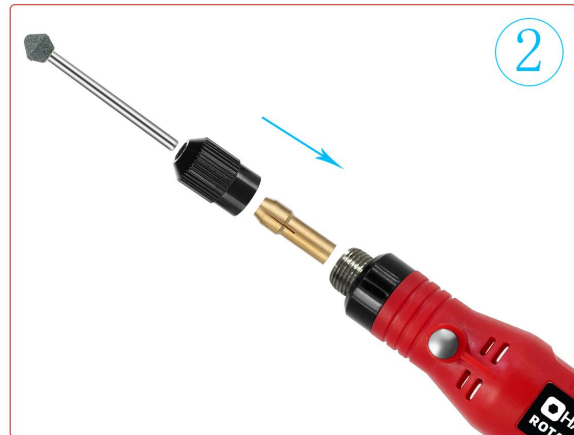

2. Choose the suitable collet and put the black nut

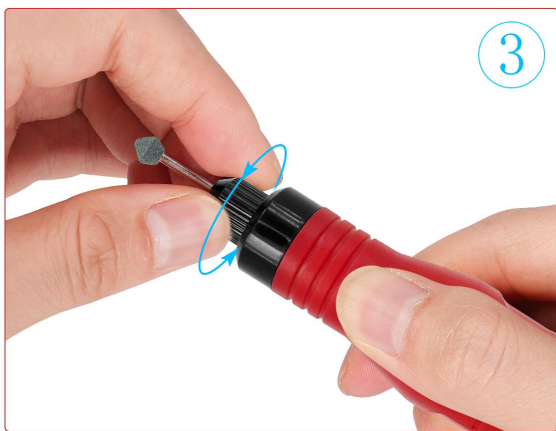

3. Insert the bits you need, hold the lock button and screw on the nut tightly.

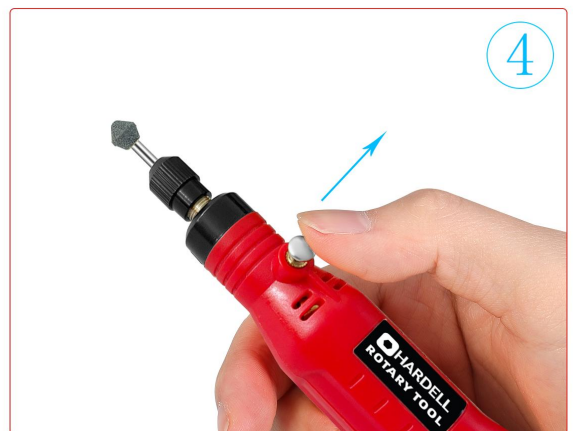

4. Release the spindle locking button.

ATTENTION: Different accessories fit different collets, If the accessories come off easily, please replace another suitable collet.



How to fit a sanding band

1. Align the sanding drum and band
2. Press the band into the drum and twist the top of the drums crew to adjust the tightness

How to fit the cutting disc

1. Twist off the top of the wheel mandrel
2. Put the cutting disc on the (close to circle)
3. Twist the top of the slim



1. Twist off the top of the wheel mandrel
2. Put the cutting disc on the (close to circle)
3. Twist the top of the slim end into the mandrel

Widely Application

Function	Types of Artworks for Creation
Sanding	Suitable for sanding work on Softwood/ Aluminum/ Plastic/ Brass/ Stone/ Shell/ Ceramic etc.
Grinding	Suitable for grinding work on Aluminum/ Steel/ Brass/ Stone/ Shell/ Ceramic etc.
Engraving / Carving	Expertise in engraving on Glass/ Soft Wood/ Aluminum/ Plastic/ Brass/ Stone /Shell/ Ceramic etc.
Drilling	Suitable for drilling on Softwood/ Aluminum/ Plastic / Shell/ Jadeite/ Agate/ Jade etc.
Polishing / Cleaning	Suitable for polishing on Glass/ Soft Wood/ Aluminum/ Plastic/ Brass/ Stone/ Shell/ Ceramic etc.

ATTENTION: Not for Heavy-duty Projects !!!



Sanding



Engraving



Polishing



Drilling

Safety Instructions

1. Keep this product away from children.
2. Keep this product away from water.
3. Do not touch it with wet hands.
4. Do not place the product on hot surfaces, near hot surfaces, or an open fire.
5. Do not dismantle the appliance under any circumstances.
6. Do not hold the work by hand or against your body and may lead to loss of control.
7. Do not force tool.
8. Do not use tools if the switch does not turn that on or off.
9. Maintain tools with care. Keep cutting tools sharp and clean.
10. Check for misalignment or binding of moving parts, breakage of parts.
11. Use only accessories that are recommended by the manufacturer for your model.
12. Use this power tool and accessories following the instructions.

Warranty

The product supports a 1-year warranty from the date of purchase. This warranty does not apply to products that have been lost, altered, broken, or damaged by misuse or failure to follow the instruction provided with the product. Never try to repair the product by yourself. For any inquiries concerning our products, please contact our after-sales team via hardell.service@gmail.com, we are free to help you solve your problem anytime.