

Product Description

1. Please read all safety warnings and instructions carefully. Failure to follow the relevant warnings and instructions is likely to result in accidents such as electric shock, fire, and severe burns.
2. Do not use or expose electric pruning shears in the rain.
3. When operating the electric pruning shears, do not put your hands close to the cutting area to avoid injury.

Package includes



Basic Instructions

1. Install the lithium battery box of the electric pruning shears to the battery dock at the bottom of the electric shears.
2. Turn on the battery power switch, the buzzer of the control box will beep once when the power is turned on and the trigger will be activated by pulling the trigger twice.
3. Normal cutting: Press the trigger and the blade will close. Release the trigger, the blade opens, press and hold the trigger, the buzzer beep shortly once to switch between 30mm and 40mm opening width.
4. Before working, press the trigger without load several times to check whether it works normally.
5. Start working after checking.
6. After working, hold the trigger until the buzzer beep twice and the blade closes. Then you can switch off and take off the battery.

Oiling your scissors

The blade should be oiled at least twice a day in the morning and afternoon. The power of the scissors must be disconnected before oiling.

1. Add proper amount of lubricating oil to the contact surface of the scissors blade.
2. Squeeze the lubricating oil from the oil bottle into the contact position between the blade and the pin.
3. Cut without load several times to distribute the lubricating oil evenly.



Charging Batteries

1. The battery of the new product is not fully charged, please charge it fully before use.
2. Insert the plug of the charger into the battery socket, and then connect the charger to the power supply. At this time, the charger indicator light is red, indicating that the charger is charging; after 4-5 hours, the charger indicator light is green, and the charging is finished, a fully charged battery can be used for 3-4 hours (normal pruning of branches).

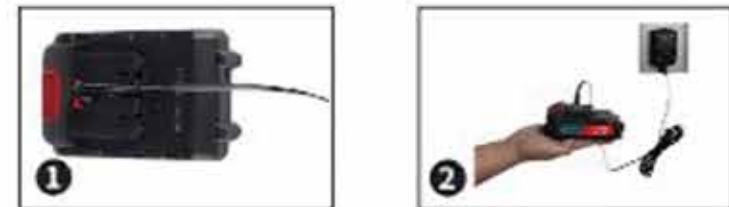

Blade Replacement

1. Use an allen wrench to remove the two head cap screws on the upper cover.
2. Use the provided wrench to loosen the anti-loosening washer and small screws.
3. Use a wrench to loosen the lock nut and remove the pin.
4. Remove the old blade and replace it with a new one.
5. If necessary, clean the gears (warning: do not use chemical reagents).
6. Install the blade and gear on the scissors.
7. Put on the pin shaft and lock the large anti-loosening nut.
8. Tighten the anti-loosening washer and small screws.
9. Close the upper cover and tighten the screws with a screwdriver.

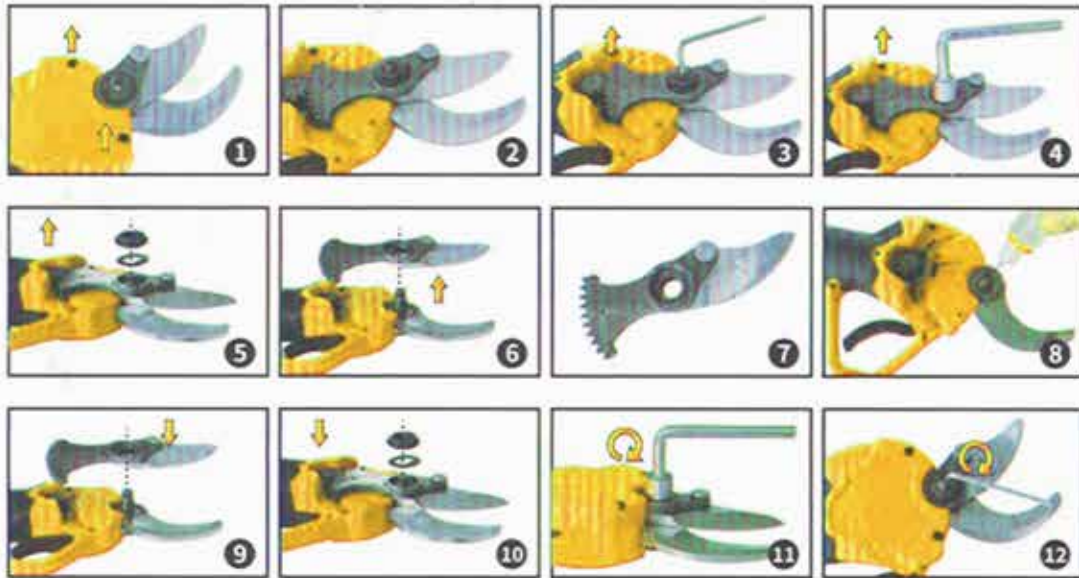

Precautions

1. It is normal for the charger and battery to slightly heat up during charging.
2. Do not recharge after a short period of operation, which may reduce the working time and efficiency of the battery.
3. Do not use damaged battery packs, and do not disassemble the charger and battery pack.
4. The battery may explode when thrown into a fire.
5. Do not charge the battery outdoors or in a humid environment.
6. With the gradual decrease of battery power, it is normal that the ability to cut big diameter branch will decrease.
7. Do not store the battery pack in a humid environment.
8. If the blade is loose, it should be tightened in time to prevent the gear from being removed and worn out.

Environmental Note

Electronic and electrical appliances cannot be disposed of as domestic garbage, and it is prohibited to randomly discard scrapped machinery, equipment, accessories and packaging as recyclable parts.