

KIDA

Armchair

Design by **Stephen Burks** | Ref. **CJD** | Weight **6,8 kg/15 lbs** | COM (Customer Own Material): **1,2 m/1.30 yds** (plain fabric only)

Measurements

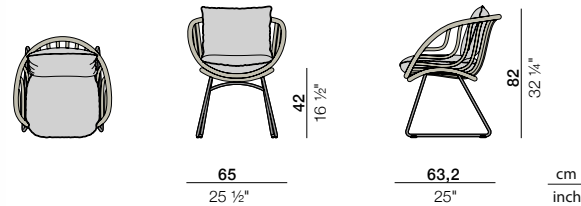

Collection: With KIDA, Stephen Burks has designed a collection as delightful to look at as to use.

This collection to be wrapped rather than woven in DEDON special Fiber Touch, features a cradle-like organic form that's open, airy, light and inviting.

Characteristics: Fresh, friendly, transparent, iconic, archetypal, geometric.

Frame: The seat frame is made of aluminum, and the base is constructed from stainless steel.

Frame Maintenance: Clean with a soft cloth or brush, warm water and a gentle cleanser, if needed.

Cushion Maintenance: The covers can be removed, and washed at 30 °C / 86 °F.

Craftmanship in numbers: Length 280 m / 306 yds | **Weaving hours:** 10

Material Combinations

Fiber / Frame

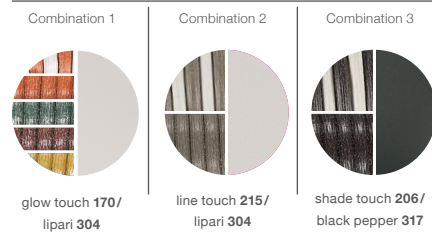

Additional Items

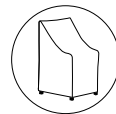

CJD
Cover

Cushions

Dry+ seat cushion* CJM + fabric code	Back cushion CJL + fabric code
B 52 cm x T 56 cm x H 8 cm W 20 1/2" x d 22" x H3 1/4"	B 45 cm x T 38 cm x H 6 cm W 17 3/4" x D 15" x H 2 1/4"
weight: 0,8 kg	weight: 0,6 kg

*Only the seat cushion is equipped with Dry+ functionality and a cushion holder.

Fabrics

Cushions for this collection are available in all fabrics **Cat. A, B, C** excluding GLAN.

Features



Contract

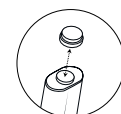

Interchangeable slider

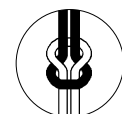

Cushion holder*

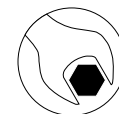

Assembly required

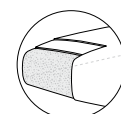

Dry+ cushion

To learn more about DEDON, our collections and warranty policy, please visit our website –

dedon.de

11/23

DEDON