

# ACRE MADE



Custom Furniture

2023

Custom banquette table.  
Interior Designer: Ruth Diana Interiors (@ruthdiana.interiors)  
Photographer: Studio Burdi (@studio.burdi)



We believe the things we  
surround ourselves with are  
*a reflection* of who we are.

At Acre Made, we firmly believe that the objects and pieces of furniture we choose to surround ourselves with are a representation of our values, tastes, and personal style. It is through these selections that we make a statement about who we are and what matters most to us. Our custom process allows you to choose the perfect dimensions, materials, and finishes for your space, ensuring that your furniture will be one-of-a-kind and truly reflective of your style. The best part? They're built to last, so that you can pass your one-of-a-kind piece down from generation to generation.





## Built just for you with *sustainably-sourced* materials.

When we build, we give special consideration to the materials we use – we know they can make or break a piece. All of our materials are solid and sustainably harvested, native Ontario hardwood species.

**WOOD SPECIES**

Ambrosia Maple

Ambrosia is a popular choice for furniture because it offers a great mix of affordability and durability. The grains in this wood are quite intricate, giving it a slight rustic appearance. It's perfectly suitable for all wood furniture when working with a budget.

---



NATURAL  
AMBROSIA MAPLE



AMBER  
AMBROSIA MAPLE



ESPRESSO  
AMBROSIA MAPLE

**WOOD SPECIES**

Oak

Oak is one of the most premium and durable hardwood species that are domestic to Ontario. This wood has a warm natural colour and can take a variety of finishes beautifully!

---



NATURAL OAK



OILED OAK



WHITENED OAK



ESPRESSO OAK



BLACKENED  
OAK



SMOKED OAK

**WOOD SPECIES**

Walnut

This species is very desirable because of its natural, rich colour. Walnut varies from a light brown to a dark chocolate brown depending on the finish you choose. It typically has a clean, straight grain. Along with Oak, this is a very popular, premium hardwood.

---



WARM WALNUT



BLACK WALNUT

**WOOD SPECIES**

Ash

Ash is very suitable for furniture-making because of its straight grain appearance and durability. It can sometimes be mistaken for oak because of the similar "cathedral" grain pattern.

---



BLEACHED ASH

**WOOD SPECIES**

Cherry

A durable, stable, straight-grained wood. This wood has an even texture with a natural lustre. Cherry in its natural form is stunning with the colour becoming more vibrant over time. There are many heritage homes in Ontario with cherry millwork that has stood the test of time and aged beautifully. We think cherry is an under appreciated wood - it's one of our favourites!

---



CHERRY

THE HARVEST DINING TABLE





Designed in collaboration  
with *you*, built with *expert*  
craftsmanship.



## Table Tops

These are our most popular tabletop shapes. Have something else in mind? Let us know – we love a challenge.

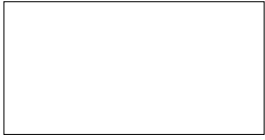

RECTANGLE



RACETRACK

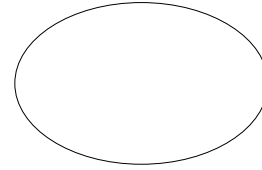

OVAL



RADIUS CORNER 2"



RADIUS CORNER 6"

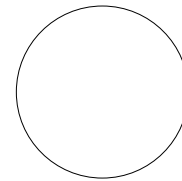

CIRCLE

## Edge Profiles

Our furniture pieces can be built with different edge profiles for a look of your choice – whether you want a modern, contemporary look or a casual feel.



STRAIGHT EDGE



UNDER BEVEL



ROUNDED UNDER BEVEL



ROUND OVER



KNIFE EDGE



BULLNOSE

# Table Bases

Here are just some of the table base styles we work with most. We can build nearly anything you can think of. Have a style in mind? Let us know!

ANGULAR PEDESTAL

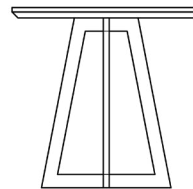
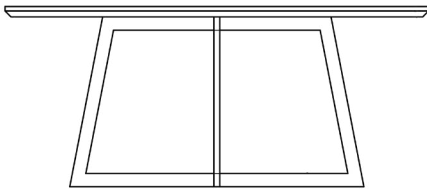

TRAPEZOID

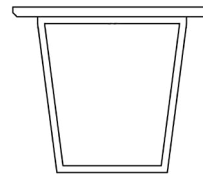

FARMHOUSE

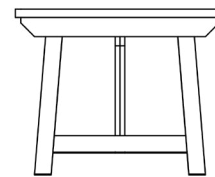
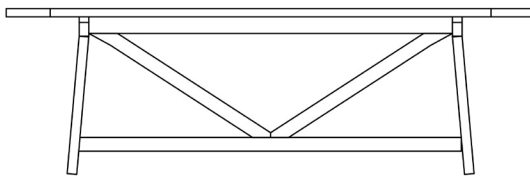

TRESTLE

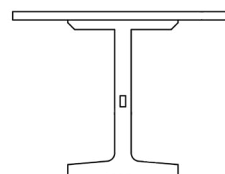
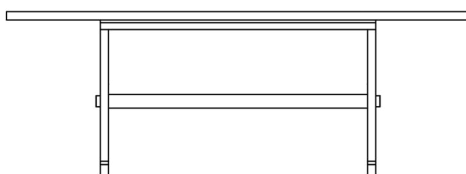

TAMBOUR

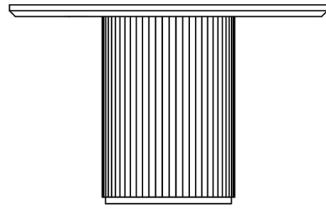

TULIP

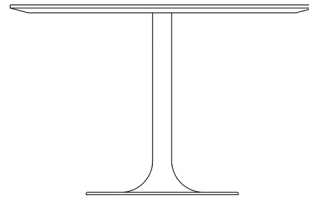

CROSS BRACE

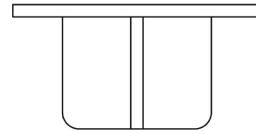
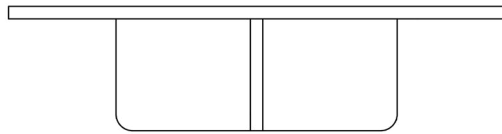

PANEL LEG

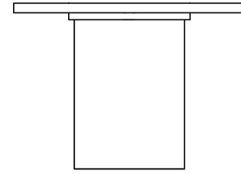

You dream it, we build it. The options are endless.

We're up for a challenge and love to hear your ideas. Let's work together to create a one-of-a-kind table base that perfectly complements your unique style.

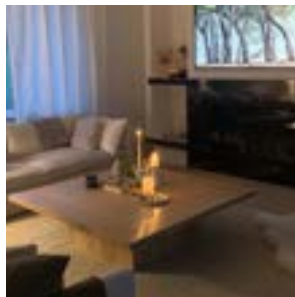

Custom dining table for Friday Harbour Resort.  
Interior Designer: Natalie Chong (@lovenataliechong)  
Photographer: Lauren Miller (@lomillerphoto)





# The custom process is easy.

Your home should be a space that perfectly fits your lifestyle and meets your needs. Let us help you make your house a home with furniture that's made just for you.

## CONTACT US

[hello@shopacremade.com](mailto:hello@shopacremade.com)

1-647-556-2290



### 1. COMPLIMENTARY CONSULTATION

You tell us your ideas and needs. We go over everything from measurements, to materials, to product preferences. From there, you receive a custom quote based on our consultation.



### 2. DESIGN AND BUILD

We work one-on-one with you throughout the creative process – you'll be able to review drawings and share feedback. Once the design of your piece is finalized, we can build it!

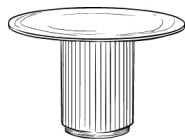

### 3. COMPLETION AND DELIVERY

Our team of professionals deliver and set up your custom furniture. We love this part – seeing you experience your new custom furniture for the first time in your home.

# ACRE MADE

1-647-556-2290

[hello@shopacremade.com](mailto:hello@shopacremade.com)

[SHOPACREMADE.COM](http://SHOPACREMADE.COM)