

WIPERS CSW

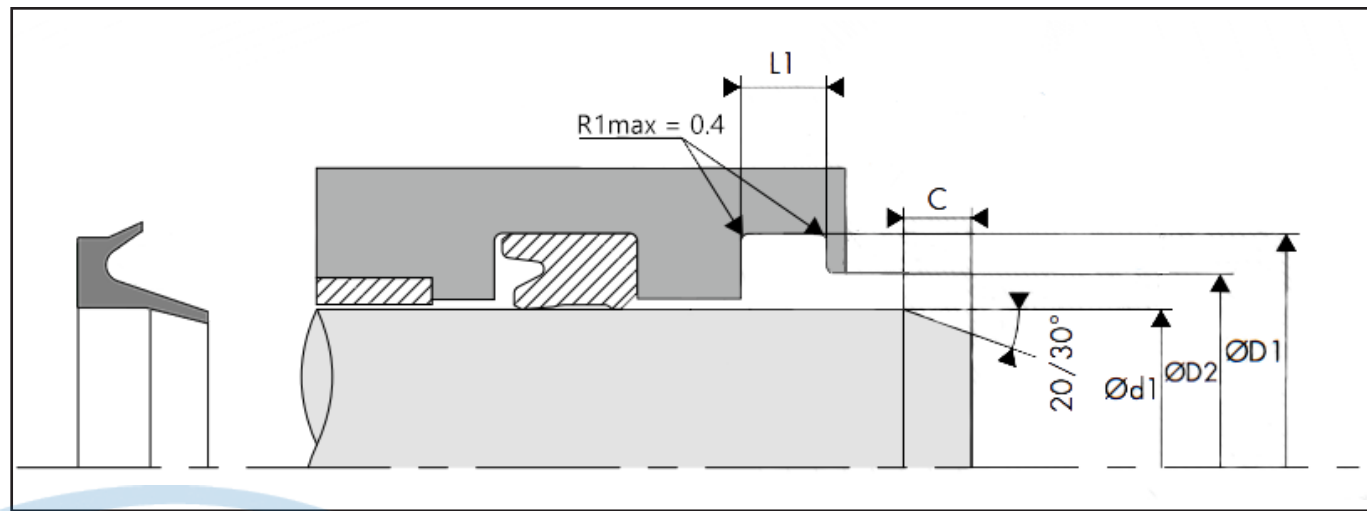
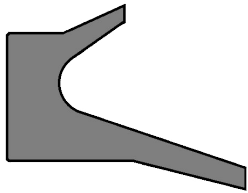

TECHNICAL DATA

Temperature	-40°C / +100°C
Speed	1.0 m/sec
Media	Mineral Hydraulic Oil Water based Hydraulic oils Ester based Hydraulic oils

SURFACE ROUGHNESS

Roughness	Dynamic surface area	Static surface area	Groove flanks
Ra	0.1-0.4 µm	≤ 1.6 µm	≤ 3.2 µm
Rz	0.63 - 2.5 µm	≤ 6.3 µm	≤ 10.0 µm
Rmax	1.0 - 4.0 µm	≤ 10.0 µm	≤ 16.0 µm

TOLERANCES

Ød1	-0.005/+0.00mm (-0.002"/+0.000")
ØD1	-0.00/+0.15mm (-0.000"/+0.006")
ØD2	-0.00/+0.12mm (-0.000"/+0.005")
L1	-0.00/+0.10mm (-0.000"/+0.004")

CHAMFER

The chamfer length as well as the chamfer angle are determined by the rod seal.

MATERIALS

Profiled Seal

POM (Acetal)
PA (Nylon) +MoS2

DESCRIPTION

The CSW/CSWM is a heavy duty rigid plastic scraper designed to remove mud, tree sap, ice and other hard to remove foreign materials from the rod.

ADVANTAGES

Outside sealing lip for a positive seal between the gland and wiper
Hard wearing
Good abrasion and wear resistance

APPLICATIONS

Agriculture
Mobile Machinery
Pulp and Paper
Manufacturing Machinery