

vapour^{M4S}

HYBRID STEAM CLEANER



All in One Steam Cleaner

INSTRUCTION MANUAL

Before using this product, please read the instructions and keep it for future references.

IMPORTANT SAF

When using an electrical appliance, basic safety precautions should always be observed, including the following: Read all instructions before using this appliance.

WARNING! To reduce the risk of fire, electrical shock, or injury:

1. This steam cleaner is authorized for household/ domestic use only.
2. Do not use outdoors in raining conditions or on wet surfaces. Do not immerse the steam cleaner in water or other liquids.
3. Do not allow steam cleaner to be used as a toy. Close attention is necessary when used by or near children. Do not leave steam cleaner unattended. Always unplug product when not in use.
4. Use only as described and for the uses described in this manual. Use only manufacturer's approved and supplied parts and accessories. Use of other accessories is not recommended and will void the warranty.
5. Always make sure the Handle Assembly is in the upright position before plugging in or unplugging. Keep cord away from heated surfaces (e.g., cooking surfaces) and sharp edges and corners.
6. Do not use if power cord or plug has been damaged, or if any part of steam cleaner has been dropped, damaged, left outdoors, or dropped in water. Do not attempt to disassemble or repair steam cleaner. Return it to manufacturer or an authorized service center for examination or repair.
7. Do not wrap cord too tightly around cord winders. Never carry by the cord or yank to disconnect from an outlet. To unplug, always grasp plug to remove from outlet – do not pull on cord.
8. Do not handle the cord or the steam cleaner with wet hands or bare feet.

ETY INSTRUCTION

9. Look closely at steam cleaner and follow all labels and marking instructions.
10. Do not put any objects into openings. Do not use with any opening blocked.
11. Keep hair, loose clothing, fingers and all parts of body away from openings and moving parts.
12. Before filling with water or emptying, always place Handle Assembly in upright position, unplug the steam cleaner and allow it to briefly cool down. Always turn the Boiler Cap slowly to open the water tank – this will allow any remaining steam to escape gradually.
13. Use caution while emptying the steam cleaner. Contact with hot water or steam may cause burns.

14. To unlock the steam handle, press the safety button on the right side (1).

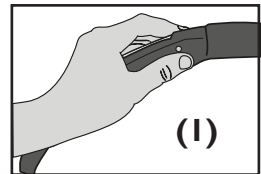

At the end of use it is recommended to lock the steam handle by pressing the button on the left side (2).

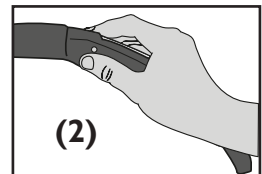

15. Never use cleaning solutions, perfumes, oils or other chemical substances other than tap or distilled/demineralized water in the steam cleaner. Use of chemicals may damage steam cleaner and will void the warranty.
16. Be sure Boiler Cap is (and remains) closed during use.
17. When in use, never turn the steam cleaner on its side. Do not direct steam at people, animals or other electrical equipment (i.e, inside an oven).
18. Do not operate around flammable or combustible liquids such as gasoline or in areas where fumes may be present.

IMPORTANT SAF

19. The steam cleaner is not intended for space heating purposes.
20. To reduce the likelihood of circuit overload, do not operate another high wattage appliance on the same circuit. Plug in to a standard (220-240V, 50/60Hz) electrical outlet.

ATTENTION! This product is equipped with a 3-prong grounded power cord. Insert only into a 3-prong grounded electrical outlet. Do not try to remove the contacts of the grounded connection.

21. Do not use extension cords or outlets that are damaged or with inadequate voltage. Use only heavy duty, high-rated extensions cords.
22. Store the steam cleaner indoors in a cool, dry place.
23. If steam cleaner is damaged, it must be repaired by manufacturer in order to avoid safety issues to the operator.
24. This steam cleaner is not intended for use by persons (including children) with reduced physical, sensory or mental capabilities, or lack of experience and knowledge, unless they have been given supervision or instruction concerning use of this product by a person responsible for their safety.
25. Read and follow all important notices in this guide.

CAUTIONS

- ***Extreme care should be taken when opening the Boiler Cap as it may become hot during use and escaping steam can cause scalding.*** 

ETY INSTRUCTION

CAUTIONS

- **Do not use your steam cleaner without a Hard Surface Pad or Carpet Glide & Pad attached to the system.**
- **Never leave your steam cleaner in one spot on any surface for any period of time. Make sure that the steam cleaner Handle Assembly is in the full “UPRIGHT POSITION” when not in use.**

● Save your back

No need
to press hard
The steam
cleaner does
the work
for you



·IMPORTANT·

Please read all of the instructions for use and Important Safety Instructions carefully. Remove and discard all packaging materials and keep them out of the reach of children.

Euroflex relieves itself of any liability for damages that shall be the result of improper use of the appliance, not in conformity with what's written in this instruction manual.

Attention: the photographs and/or drawings in this document are for illustrative purposes only. Actual steam cleaner and the accessories may vary due to product enhancement.

Safety Informations in Digital Format: www.plastecs.it/warning

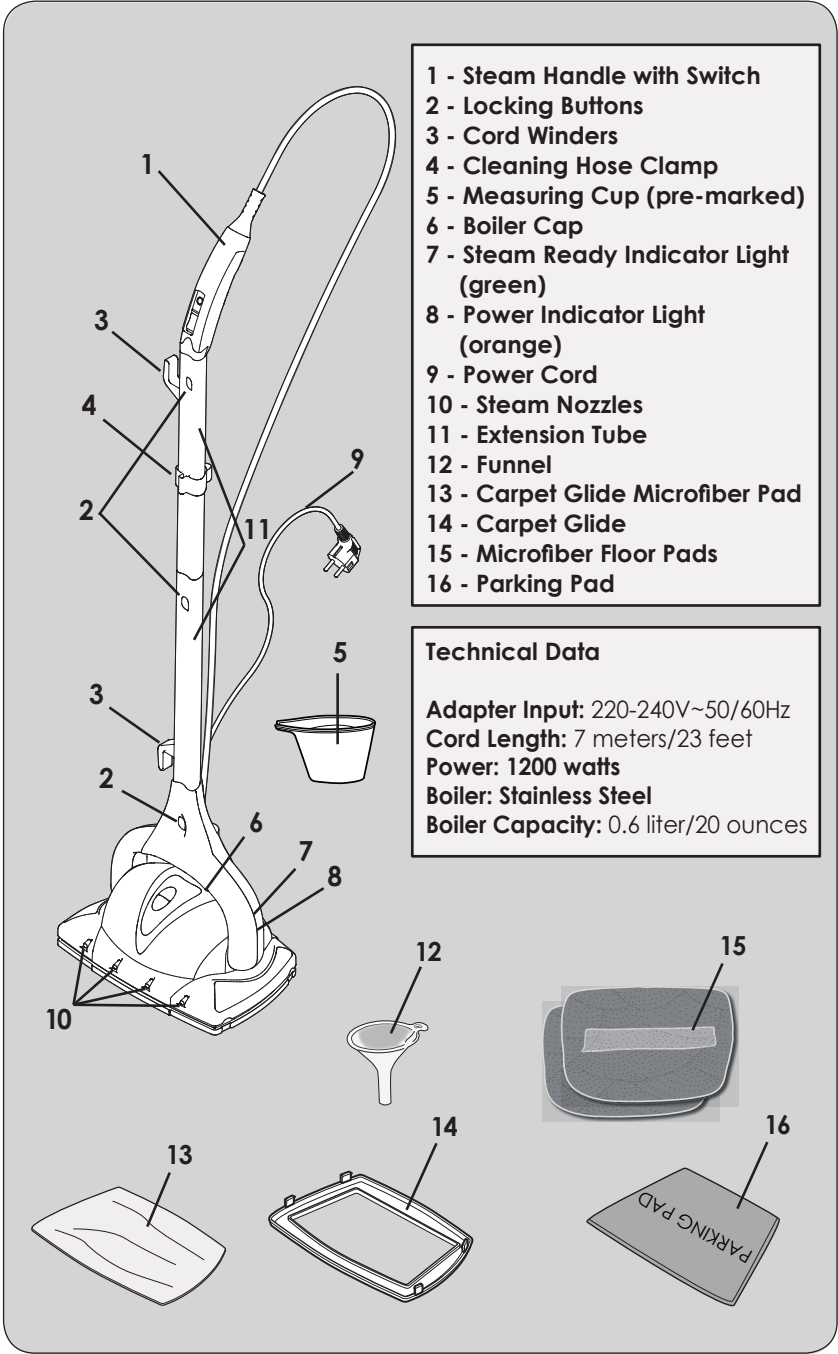

- 1 - Steam Handle with Switch
- 2 - Locking Buttons
- 3 - Cord Winders
- 4 - Cleaning Hose Clamp
- 5 - Measuring Cup (pre-marked)
- 6 - Boiler Cap
- 7 - Steam Ready Indicator Light (green)
- 8 - Power Indicator Light (orange)
- 9 - Power Cord
- 10 - Steam Nozzles
- 11 - Extension Tube
- 12 - Funnel
- 13 - Carpet Glide Microfiber Pad
- 14 - Carpet Glide
- 15 - Microfiber Floor Pads
- 16 - Parking Pad

Technical Data

Adapter Input: 220-240V~50/60Hz
Cord Length: 7 meters/23 feet
Power: 1200 watts
Boiler: Stainless Steel
Boiler Capacity: 0.6 liter/20 ounces

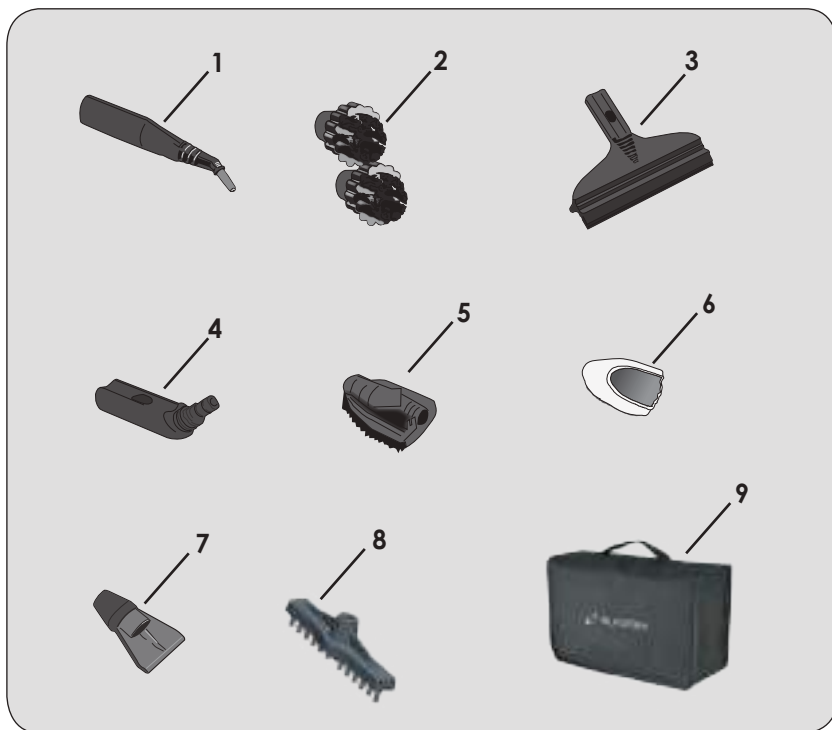

ACCESSORIES

- 1 - Detail Nozzle
- 2 - Nylon Small Brushes
- 3 - Window Cleaner
- 4 - Small Brush Adapter
- 5 - Small Brush
- 6 - Fitted Microfiber Pad for Small Brush
- 7 - Scraper
- 8 - Grout Brush
- 9 - Accessory Bag

1 FLOOR STEAM CLEANING MODE

Assembly of Parts & Preparation of Steam Cleaner

Make sure all parts are in the box (see pg 6-7).

IMPORTANT! FOLLOW THESE INSTRUCTIONS CAREFULLY.

WARNING! Always ensure steam handle is not steaming when attaching an accessory to the steam cleaner.

A. Attach Steam Handle to Steam Cleaner

- Insert the lower Extension Tube into the steam cleaner base and press firmly in place (as shown in Fig. A).
- Insert the upper Extension Tube into the lower extension tube and press firmly in place (as shown in Fig. B).
- Insert the Steam Handle into the upper extension tube and press firmly in place (as shown in Fig. C).

Attention! The lower Extension Tube has the cord support pointing down. The upper Extension Tube has the cord support pointing upwards.

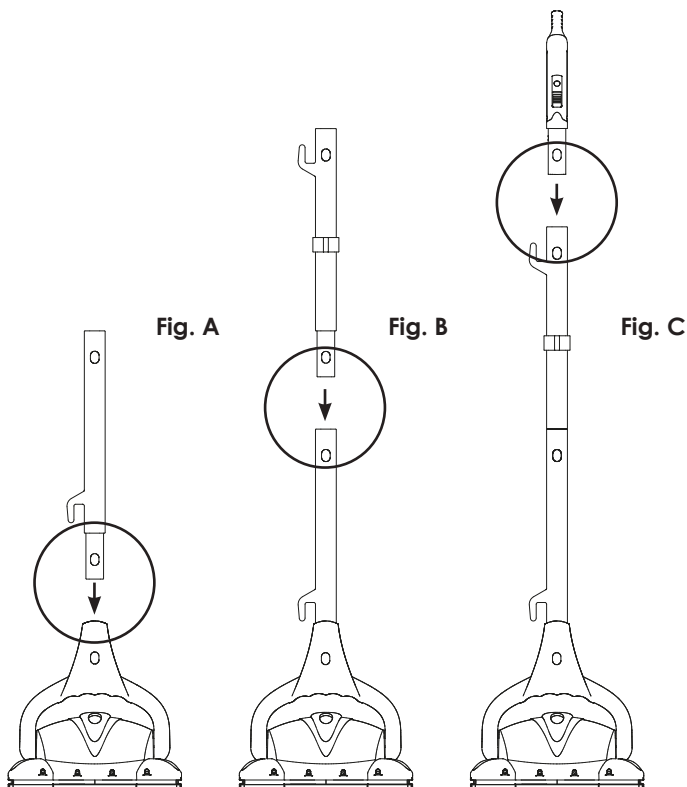

B. Attach Cleaning Pads to Steam Cleaner

WARNING! To prevent floor damage, ALWAYS attach either the Microfiber Floor Pad or the Carpet Glide Accessory with Carpet Pad when using the steam cleaner. NEVER USE WITHOUT EITHER OF THESE ATTACHMENTS AFFIXED TO THE BASE.

ATTACHING SCRUBBING FLOOR PAD

Scrubbing Floor Pad – Place Microfiber Floor Pad face down on the floor, wide side forward, with center Scrub Strip facing down (and positioned to match metal heat plate on bottom of Base-see “A”). Hold steam cleaner about 2” above Pad and gently place steam cleaner on the Pad. Firmly press down to ensure Pad is adhered to the steam cleaner.

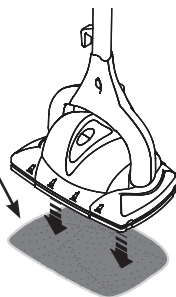

ATTACHING CARPET GLIDE WITH CARPET PAD

Place carpet glide face up on floor. Center and place carpet pad on top of carpet glide. Hold steam cleaner over carpet glide and gently lower the steam cleaner onto the glide. Make sure the 4 clips on glide are around the outside of the steam cleaner base and using hands, attach the 4 clips of the carpet glide to the base.

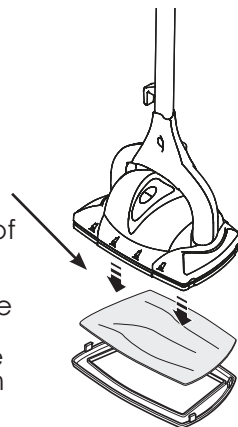

USE ON HARDWOOD FLOORS – For timber floors, use only on “sealed” timber surfaces. Move steam cleaner forward and backward while cleaning, carefully observing the amount of steam used, as too much water could cause damage.

IMPORTANT NOTE ABOUT LINOLEUM FLOORING*

Steam can cause wax to be stripped from, and consequently damage, some varieties of linoleum flooring. ALWAYS test a small, inconspicuous portion of the floor BEFORE using steam to ensure that your linoleum floor does not have this issue. For some varieties of linoleum or vinyl floors the steam cleaner is harder to push forward and back.

NOTE: See “Maintenance & Cleaning” for care and cleaning instructions for Microfiber Pads.

C. Filling Water when Boiler is Cold

WARNINGS:

- Carefully read all instructions before removing Boiler Cap.
- Always unplug appliance before filling the Boiler.

IMPORTANT

Use ordinary tap water. **Distilled or demineralized water is recommended if tap water is too hard.** DO NOT add detergents, perfumes, oils, or other chemical substances to the Boiler. The product warranty will be null and void if anything other than water is added to the Boiler.

Follow these instructions to avoid overfilling the Boiler:

- Be sure steam cleaner is unplugged from the electrical power outlet, and **the boiler has not been heated.**
- **Make sure Handle Assembly is in the horizontal position.** Remove Boiler Cap by turning it counterclockwise.

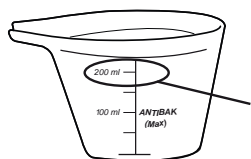
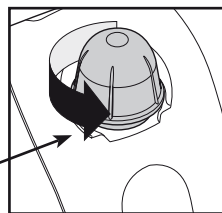

- Pour in 600 mls of water using the Measuring Cup and Filler Funnel provided – fill cup to the “200 ml” marking three times. **Be careful not to overfill the Boiler.** Please note that excess water will be flushed out during use if the Boiler is overfilled, resulting in wet floors.

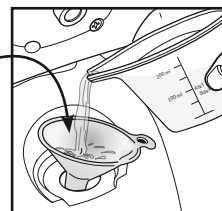

- Replace Boiler Cap by turning it clockwise. Do not tighten Boiler Cap too much – finger tightening is sufficient to lock the steam in the Boiler. If using cold water, heating time is about 3-5 minutes. If using warm water, heating time is reduced.

IMPORTANT

- Do not overfill the Boiler as excess water will be flushed out of the Boiler before dry steam will emit.
- If re-filling the Boiler while steam cleaner has been in use, be sure to allow boiler to cool for at least 5 minutes and loosen Boiler Cap slowly to allow any excess steam to escape before completely removing Cap. (See part E, “Refilling Water when Boiler is Hot” for detailed instructions.)

2

Using the Steam Cleaner to Wash Floors

A. Using the Parking Pad

You can use the Parking Pad if the steam cleaner is warm or hot.

CAUTIONS

The Parking Pad is provided to prevent floor damage that can result from leaving a hot steam cleaner resting on the same spot for too long. ALWAYS place steam cleaner on the Parking Pad when not in use, or while it is cooling before storage.

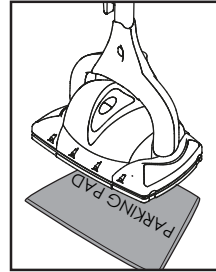

B. Starting the Steam Cleaner

- Be sure Boiler is filled with water and Boiler Cap is securely in place.
- Insert the plug into a 3-prong grounded electrical outlet (orange Power Indicator Light will illuminate).
- **Keeping the handle in the upright position**, wait until the (green) Steam Ready Indicator Light illuminates.

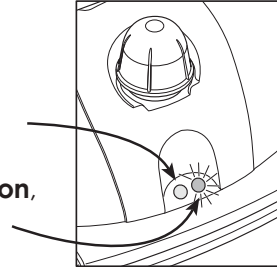

Once Boiler is filled and the green Steam Ready Indicator Light glows, steam cleaner is ready to clean the floors.

PLEASE NOTE: The green Steam Ready Indicator Light will turn on and off during use. This is normal and not a fault.

C. Releasing Steam

- Press the button on the right side of the steam handle to unlock the steam cleaner.
- To emit steam from the underside of the steam cleaner, press the **FRONT** part of the button on the steam handle.

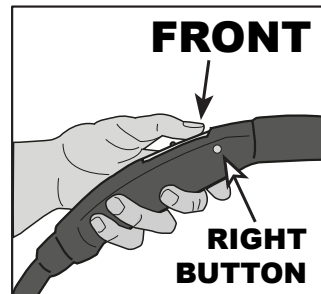

IMPORTANT: during floor cleaning the front part of the button should be pressed for most of the time for maximum cleaning performance.

NOTE: Some recondensed water may be emitted when the handle is first pulled down after filling. This is normal.

D. Releasing Steam (continued)

- To emit steam from the 4 front nozzles, press the **REAR** part of the button on the handle.
- **IMPORTANT:** at the end of the cleaning task, press the button on the left side of the steam handle to lock the steam cleaner in safety mode.

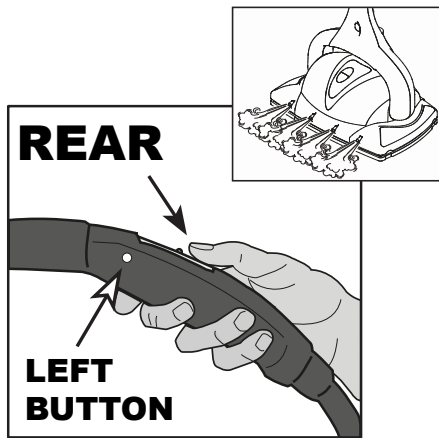
**•IMPORTANT•**

The 4 front Nozzles are meant to be used in steam "bursts" and should never be used on a sustained basis. The front Nozzles will help loosen difficult dirt and will assist in cleaning hard to reach areas such as floor edges.

NOTE: The Steam Cleaner will not need refilling for about 20-25 minutes of usage.

The Steam Cleaner will stop producing steam when the Boiler is empty. When this happens unplug and store the steam cleaner or refill with water per instructions (below).

NOTE: If the Floor or Carpet Pad becomes too wet or too dirty, replace with a clean, dry Pad and continue cleaning.

E. Refilling Water when Boiler is Hot

When the Steam Cleaner has run out of water, there will be no more steam coming out. At this stage it is time to refill the Boiler.

Follow the refilling instructions below.

•IMPORTANT•

The Steam Cleaner has a Boiler that should not be overfilled. To avoid the potential for overfilling, only refill the Boiler when it is completely run out of water and only add 600ml. Always follow the practice of using the Steam Cleaner until it has run out of water and then refill 600ml only.

If floor cleaning is completed and water remains in the Boiler, the Steam Cleaner can be stored with the remaining water in the Boiler, there will be no harm done to the product. At the next cleaning session simply heat up the steam cleaner and use the water already in the Boiler, then refill when empty.

Or alternatively at the next cleaning session, open the Boiler Cap when the product is still cold and pour out the water and then refill (if this alternative method is used, it is recommended that only 500ml of water is added, because the product will not completely drain when the water is poured out from the Boiler).

WARNING: Let steam cleaner cool 5 minutes before opening Boiler Cap. Use care when opening Boiler Cap as it may still be hot and steam may escape, causing burns. If Boiler is still hot, water may spurt out during refilling which can also cause burns.

- **Unplug the steam cleaner from the electrical power outlet. This will stop the boiler from continuing to heat up.**
- Slowly turn the Boiler Cap counterclockwise, ensuring that no steam is present.
- **Be sure steam cleaner has cooled 5 minutes before refilling with water.**

The product warranty will be null and void if anything other than water is added to the Boiler.

- Pour in 600 mls of water using the Measuring Cup and Filler Funnel provided – fill the Measuring Cup to the 200 ml marking 3 times. Be careful not to overfill the Boiler.
- Replace Boiler Cap by turning it clockwise. Do not tighten Boiler Cap too much – finger tightening is sufficient to lock the steam in the Boiler.
- Insert plug into 3-prong electrical outlet. Wait for green Steam Ready Indicator Light to turn on. Steam Cleaner is ready to use once again.

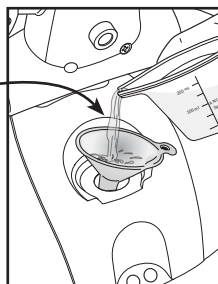

REMINDERS

- Always use ordinary tap water.
- If tap water is too hard, use distilled or demineralized water to avoid the risk of mineral deposits and sediment from forming.
- Do not add detergents, perfumes, oils or other chemical substances to the Boiler. This will damage the steam cleaner and void the warranty.
- The green Steam Ready Indicator Light may turn on and off during use. This is normal and not a fault.

IMPORTANT

Do not overfill the Boiler as excess water will be flushed out of the Boiler before dry steam will emit.

3

PORTABLE STEAM CLEANER MODE

Multipurpose Portable Steam Cleaner

The Hybrid Steam Cleaner is a 2 in 1 model that converts into a multipurpose portable steam cleaner with just one click. The portable steam cleaner features include:

1. Lightweight and portable unit.
2. Ergonomic steam handle for easy of use.
3. Versatile and quick change accessories.
4. On/off control.

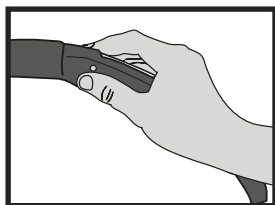

5. Security locking button.
6. Cleans many areas such as bathrooms, kitchens, pet areas and more.

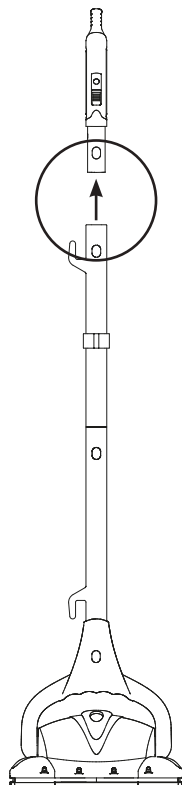

Accessories - Attachment & Descriptions

A. Always use the Parking Pad when resting the steam cleaner on a surface

B. Attach Steam Handle to Steam Cleaner

To use: Hold down the locking button on the Steam handle while sliding it in an Extension Tube. Be sure the locking button lines up with the hole on the Extension Tube and button locks in place.

To attach Extension Tubes together: Press down the locking button while sliding Tubes together. Be sure button and hole line up and button locks in place.

To disconnect Extension Tubes: Press the locking button and pull the two sections apart.

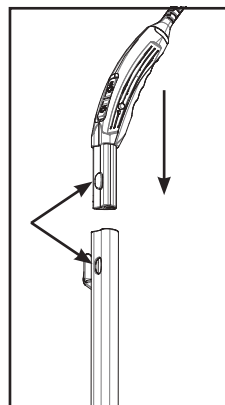

C. Attach Extension Tube or Steam Handle to Brush Adapter

Once the small Brush is attached to the Brush Adapter, press the locking button on the Extension Tube or Steam Handle while sliding the Tube or handle in the Brush Adapter. Ensure the locking button and the hole on the Brush Adapter line up.

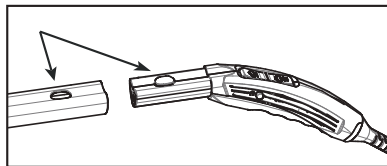

D. Attach Extension Tube or Steam Handle to Detail Nozzle

The Detail Nozzle provides a powerful steam jet very useful for cleaning hard to reach areas. It is ideal for blasting dirt out of tight areas, cleaning door and window tracks, shutters and sanitary fixtures.

To use: Slide and lock Detail Nozzle on the Steam Handle or Extension Tube.

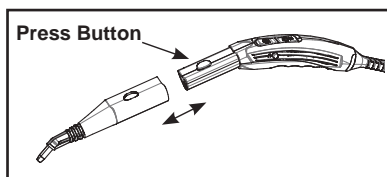

E. Attach Grout Brush to Detail Nozzle

The Grout Brush is designed to clean the grout in between tiles. Use on floor grout, backsplashes and in showers.

To use: Push the Grout Brush on the end of the Detail Nozzle.

(Detail Nozzle should be connected to the Steam Handle or Extension Tubes.)

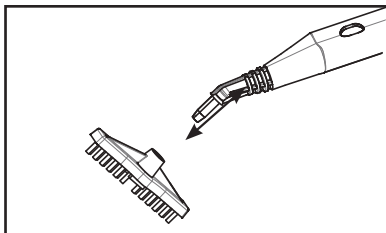

F. Attach Extension Tube or Steam Handle to Window Cleaner

The Window Cleaner is very useful for cleaning large windows and glass.

To use: Connect Window Cleaner to Steam Handle or Extension Tube(s) for hard to reach windows. Apply steam liberally, rub with soft spongy edge, then remove excess water and dirt with Window Cleaner Blade. Wipe dirt from Window Cleaner blade.

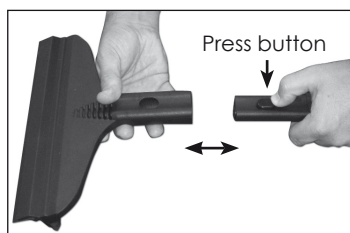

CAUTION: When cleaning windows, always avoid any sudden changes in temperature to prevent glass breakage or cracks.

G. Attach Nylon Small Brush to Detail Nozzle

The Nylon Brush is used to help scrub particularly tough dirt.

To use: Push the Nylon Brush on the end of the Detail Nozzle. (Detail Nozzle should be connected to the Steam Handle or Extension Tubes.)

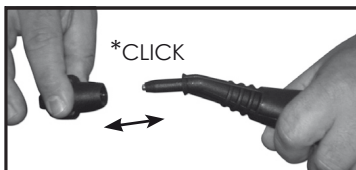

H. Attach Scraper to Detail Nozzle

The Scraper is best for removing small amounts of wallpaper and also anything that can be scraped from a flat surface, e.g., grease deposits in an oven. It is also useful when defrosting freezers.

To use: Push the Scraper on the end of the Detail Nozzle. (Detail Nozzle should be connected to the Steam Handle or Extension Tubes.)

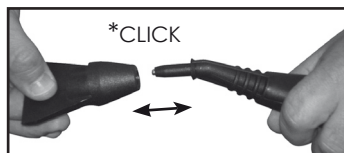

I. Connecting Brush Adapter to Small Brush

The Small Brush attaches either to the extension tube(s) or the Steam Handle and is used to clean smaller areas that the Steam Cleaner cannot easily reach, such as corners of floors, stairs and around furniture legs.

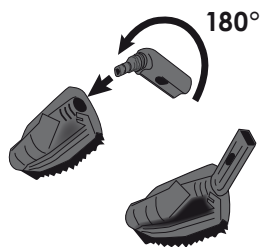

To use: Attach Small Brush to Small Brush Adapter. Attach Extension Tube or Steam Handle to Adapter by pressing the locking button while sliding Tube or handle into Brush Adapter. Be sure button and hole line up (see parts "B" and "C" above) and button locks in place.

J. Attaching Microfiber Pad to Small Brush

A fitted Microfiber Pad should be placed over the bristles of the Small Brush to clean smooth surfaces such as kitchen cupboards, splash backs, countertops, etc. Fit the Small Microfiber Pad over the Small Brush as shown below.

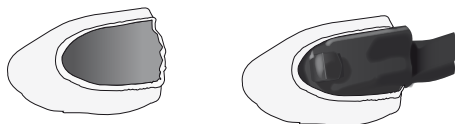

4 Steam Release

To release steam from the Steam Handle, press the button on **FRONT** part of the button. Steam will continue to be released while the button is pressed. To stop the steam, stop pressing the button.

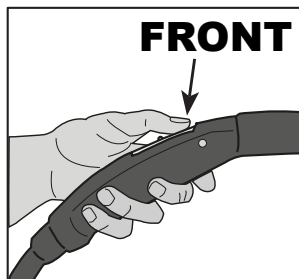

IMPORTANT: When the Steam Cleaner has run out of water, steam output will cease. Follow refill instructions (page 12) to use your Steam Cleaner again.

To move the steam cleaner around simply grab the base at the top of the arch as shown in the image.

WARNING

While using the product as a portable steam cleaner, keep the arch perpendicular (upright) to the body of the steam cleaner to avoid the ejection of steam from the front nozzles.

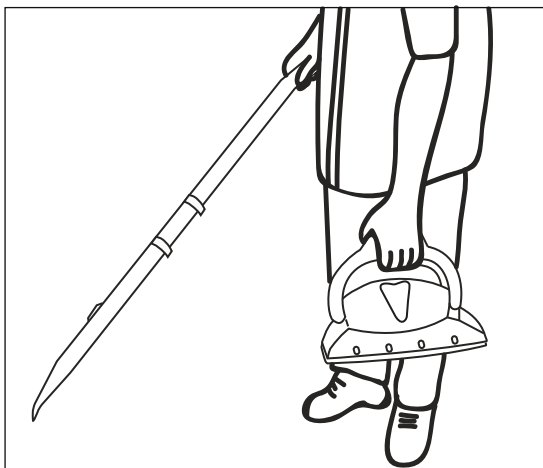

5 Turning Steam Cleaner Off

- To turn Steam Cleaner off, unplug the electrical cord from the power outlet.
- Any remaining water can be left in the unit.

REMINDERS

- We recommend distilled or demineralised water as the best way to care for and utilize your Steam Cleaner.
- If tap water is too hard, use distilled or demineralized water to avoid the risk of floor streaking.
- Do not add detergents, perfumes, oils or other chemical substances.

6 Cleaning the Steam Cleaner

We recommend you periodically clean the Steam Cleaner to prevent the accumulation of calcium, mineral deposits and other sediment caused by the use of tap water. After every 10-15 refills, fill the Boiler three-quarters full of hot tap water, shake several times and empty out the water into a sink.

Repeat several times to ensure that the Boiler is flushed of any calcium or mineral deposits. Wipe the Steam Cleaner with a damp cloth and dry.

***NEVER HOLD THE STEAM CLEANER UNDER THE TAP TO FILL.
Use the filling cup provided to fill the Boiler.***

If distilled or demineralised water is regularly used in the Steam Cleaner, cleaning of the Boiler can be done less frequently. In some areas tap water is very hard, it is recommended that the Boiler is cleaned more frequently if hard water is used.

The cleaning of the Boiler and Steam Cleaner is the sole responsibility of the owner. Calcium, mineral deposits and other sediments left to build up in the Steam Cleaner causing it to fail and/or the steam pathways in the Steam Cleaner to block, is not covered by the product warranty. Users must follow the cleaning instructions above.

If the Steam Cleaner and Boiler is not cleaned according to the instructions above and the product fails and/or the steam pathways are blocked, the owner should send the product for servicing by contacting the Customer Support Line.

The Steam Cleaner is intended for domestic household use only. It is not intended for commercial use. Any use other than for domestic household purposes will void the product warranty.

7 Replacement of Brushes, Microfiber Pads and Accessories

The Nylon Brushes and the fitted Microfiber Pad for the Small Brush provided with the Steam Cleaner are to get you started using your Steam Cleaner. As these brushes and microfiber pads become dirty or wear out, replacement brushes and microfiber pads can be purchased from the retailer from which you purchased your Steam Cleaner and/or from most other electrical appliance retail outlets.

It is normal to have replacements of the brushes and microfiber pads close at hand when cleaning as the brushes wear out or the microfiber pads become dirty.

Any of the other accessory tools are replaceable by contacting the Customer Support Line.

Steam Cleaner Tips & Reminders

Steam cleaning allows the user to clean chemical-free by using the power of steam, in place of harsh chemical-based cleaners. The heat from the steam softens and loosens dirt on surfaces, while the steam pressure lifts the dirt away. All that is left to do is to wipe the surface to remove the dirt and moisture using a cloth (preferably with a microfiber cloth).

TIP: to get the best cleaning results use a microfiber cloth to wipe the dirt and moisture from the surface being cleaned. Microfiber is designed to pick up and hold dirt, a great aid in lifting and removing the dirt that the steam cleaner has softened and loosened. Also, Microfiber requires moisture to glide over surfaces, the steam cleaner provides moisture that the Microfiber needs to glide. Microfiber and Steam, a great cleaning combination!

Making Contact with Surfaces

The steam is at its hottest just as it leaves the nozzle/accessory. This is the area of the steam output that should be used to clean to achieve maximum performance. All accessories should make direct contact with the surfaces being cleaned to transfer the heat from the Steam Cleaner to the surface in order to soften and loosen dirt. If the accessory being used does not make contact with the surface, the desired results may not be achieved. If assistance is required contact our Customer Support Line.

TIP: steam will clean hard, sealed, non-porous surfaces in place of harsh chemical-based cleaners and detergents. For soft furnishings such as carpets, rugs, lounges, children's toys etc, steam will refresh and deodorise the fibres. Steam is not used to clean carpets, other than to spot clean. To clean carpets proper carpet cleaning equipment should be used.

Water

Use ordinary tap water for all cleaning. In hard water areas, we recommend distilled or demineralised water to reduce the formation of calcium and other mineral deposits in the Steam Cleaner. Use distilled or demineralised water in the boiler to eliminate the possibility of floors streaking.

IMPORTANT: Do not add cleaning solutions, perfumes, oils or any other chemicals to the water used in the Boiler.

Temperature

The temperature in the stainless steel Boiler reaches about 130°C. The steam temperature just outside the tip of the nozzle/accessory is between 105°C and 115°C. The temperature of the steam falls to 38°C at a distance of 25cm from nozzle. This Steam Cleaner produces a drier steam which cools very rapidly to avoid burns and injuries. Steam must make direct contact with surfaces for it to clean effectively.

TIP: the hot steam can be used to kill dust mites in soft furnishings and mattresses. The Steam Cleaner is ideal for asthma sufferers, persons with skin sensitivities and anyone with chemical sensitivities.

9 Microfiber Pad Care & Cleaning

Your floor Microfiber Pads are designed for hundreds of uses. Clean Pads regularly, either by hand washing (using mild soap and warm water) or in your clothes washer on a delicate cycle, cool water. Never use fabric softener or bleach. We recommend letting Pads air dry to maintain maximum long term effectiveness.

Replacement pads are available at most retail outlets or on our website at www.euroflex.com.au.

Microfiber washing instructions – ULTRA MICROFIBER

MICROFIBER FLOOR PAD	CARPET PAD
<p>50% Polyester / 50% Polyamide</p> <p>Hand wash only Tumble dry low or air dry No bleach / No fabric softener</p>	<p>80% Polyester / 20% Polyamide</p> <p>Hand wash only Tumble dry low or air dry No bleach / No fabric softener</p>

10 Troubleshooting

ISSUES	POSSIBLE CAUSES	SOLUTIONS
Steam is not coming out of the 4 front Nozzles	Improper Handle Assembly	Call Customer Service to receive instructions to correct the problem
The Microfiber Floor Pad is not adhering to Steam Cleaner	Not enough pressure was applied when attaching Pad	Position Steam Cleaner about 2" above Pad and FIRMLY press it down onto the Pad
	Floor Pad requires replacing due to age of the Floor Pad	Replacement Floor Pads can be purchased at most electrical appliance retail outlets
The Microfiber Floor Pads are getting soaked (too wet). Why?	Boiler is overfilled	Let Steam Cleaner run until excess water ceases. -OR- Remove some water from Boiler once the Boiler has cooled down completely
	Green "Steam Ready Indicator Light" is not illuminated	Wait for green "Steam Ready Indicator Light" to illuminate
The steam seems to be making my floor too wet	Front nozzles are being used too frequently	Only use Front nozzles in short bursts for cleaning tougher dirt or to clean hard to reach areas
	The Microfiber Floor Pad is too wet (saturated with moisture)	Replace the wet Pad with a dry, clean Pad and continue cleaning

IMPORTANT QUESTION:

Q: Do I always need to use a Microfiber Pad when cleaning with my Steam Cleaner?

A. YES! It is critically important to ALWAYS use your Microfiber Pads. When in use the Steam Cleaner should NEVER be used without either a Microfiber Floor Pad or Carpet Glide with Carpet Pad.

Q: Why is my Vapour-M4S Hybrid Steam Cleaner hard to push on my floors?

A. A possible reason is the microfibre floor pad does not have sufficient moisture. Ensure the front part of the steam release button is pressed down for most of the time while cleaning. This will replenish the moisture in the pad allowing the microfibre to glide easier and equally as important, it will keep the pad hot to soften the dirt so that the microfibre pad can easily remove the dirt. The microfibre pad needs moisture and heat to achieve the best cleaning results.

Customer Support

Customers needing assistance with their Steam Cleaner can call the Customer Support Line on the phone numbers listed below. Customers should also call the Customer Support Line if they require product warranty repair or post-warranty product servicing. Our friendly Customer Service Team can assist you with getting the best cleaning results from your Steam Cleaner, they are full of helpful steam cleaning tips, too.

Customer Support Line

AUSTRALIA 1800 663 866
NEW ZEALAND 0800 666 783

Euroflex Australia Pty Ltd

79 Furniss Road
DARCH WA 6065
AUSTRALIA
TEL: 08 9302 2526
Email: admin@euroflex.com.au
Website: www.euroflex.com.au

Euroflex New Zealand Ltd

c/- Dubins
137 Glenfield Road
Birkenhead Auckland 0626

NEW ZEALAND

TEL: 0800 666 783
Email: admin@euroflex.com.au
Website: www.euroflex.com.au

Plastecs SRL

Via dei Colli, 59
31058 Susegana (TV)
ITALY
Tel: +39 0438 453334
Email: info@plastecs.it
Website: www.euroflex-appliances.com

