

vapour^{M3S}

FLOOR STEAM CLEANER WITH ULTRA DRY STEAM

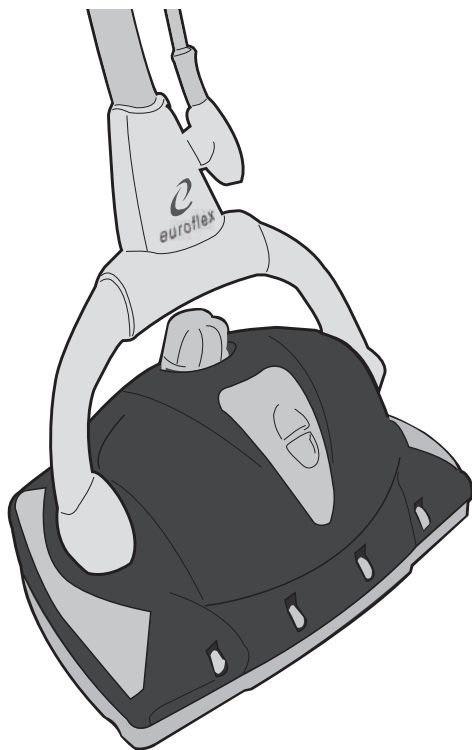

Floor Steam Cleaner with Frontal Steam Jet

INSTRUCTION MANUAL

Before using this product, please read the instructions and keep it for future references

IMPORTANT: SAVE THESE INSTRUCTIONS

SAFETY WARNING

- This appliance should not be used by children or by persons with reduced physical, sensory or mental capabilities, that lack experience or knowledge regarding the safe operation of the product, unless proper supervision or instruction has been given.
- Children should not play with the appliance. Cleaning and user maintenance should not be done by children.
- Keep the appliance out of reach of children when it is plugged in or cooling down.
- If the power cord is damaged, it must be replaced by the manufacturer, its service agent or similarly qualified person in order to avoid a hazard.
- The steam released from the appliance is extremely hot. Both appliance and accessory tools may scald. Avoid direct contact. The steam symbol  (symbol 5597 relative to IEC 60417-1) warns operators that there is the risk of scalding!
- Never open the boiler cap while using the device.
- Unscrew the boiler cap only when the appliance is switched off, pressure-free and cooled.

ETY INSTRUCTION

- This appliance is not to be used if it has been dropped, if there are visible signs of damage or if it is leaking.
- Disconnect the appliance from the power supply prior to any maintenance or cleaning operations. Always allow the appliance to completely cool down.
- Do not leave the appliance unattended while it is connected to the power supply. Disconnect the plug if you need to get away even just for a few minutes.

Important Notices

- This appliance complies with European Directives regarding “electromagnetic compatibility” and “Electrical product safety”. The appliance carries CE marking.
- The Antibak Tank Cover should never be opened during use except to refill while Steam Cleaner is stationary.
- Antibak should ONLY be used in the Antibak Tank (as detailed on pages 12 and 13).
- Never use cleaning solutions, perfumes, oils, Antibak or substances other than tap or distilled/demineralized water in the Boiler. Use of any chemicals in Boiler may damage Steam Cleaner and will automatically void the warranty.
- Do not direct the steam jet towards people, animals or plants.
- Do not use the appliance when close to flammable or explosive substances.
- Do not insert any object in the various openings and do not use the appliance if any opening is obstructed.
- Do not store the appliance outdoors.
- Do not expose the appliance to atmospheric agents, humidity or heat sources.
- Use a dry or slightly damp cloth to clean this appliance.
- Only use accessories and spare parts recommended by the manufacturer.
- The manufacturer, importer or distributor assume no responsibility for damage to property or injury to persons, in the event that this appliance is damaged as a result of improper use or assembly.
- Repairs must be carried out exclusively by personnel authorized by the manufacturer. Appliance repaired by unauthorized personnel poses a danger to the user and voids the warranty.
- Do not pull on the electrical cable. Do not use the cable to move the appliance. Do not crush the cable by closing the door. Avoid any contact with sharp edges and corners. Keep the cable away from hot surfaces.
- The manufacturer reserves the right to make changes to the design and features of the appliance without notice.

IMPORTANT SAF

ATTENTION! This appliance is equipped with a 3-prong grounded power cord. Insert only into a 3-prong grounded electrical outlet. Do not try to remove the contacts of the grounded connection.

- This appliance is intended for domestic use only.
- Connect the appliance only after making sure that the voltage of the electrical network corresponds to that indicated on the plate of the appliance.
- Do not immerse the Steam Cleaner in water or other liquids. Always turn off and unplug appliance when filling with water.
- Do not allow to be used as a toy. Close attention is necessary when used by or near children, pets or plants.
- Do not use with any opening blocked.
- Follow all labels and marking instructions on Steam Cleaner.
- Before filling with water or emptying, always unplug the appliance and allow it to cool completely. Always turn the boiler cap slowly to open the boiler. This will allow any residual steam to escape gradually.
- Use caution while emptying the appliance. Contact with hot metal parts, hot water or steam may cause burns.
- Be sure Boiler Cap is (and remains) closed during use.
- Never use cleaning solutions, perfumes, oils or other chemical substances other than tap or distilled/demineralized water in the Steam Cleaner. Use of chemicals may damage appliance and will void your warranty.
- When in use, never turn the appliance on its side.
- Do not use Antibak sanitizer on carpets or rugs (or any other soft furnishings such as mattresses or lounge). When using the Carpet Glider on carpets or rugs, do not pull the trigger on the Handle to dispense Antibak. The steam coming from the bottom of the Steam Cleaner is sufficient to refresh carpet or rugs.
- Euroflex is not liable for any damages that are the result of improper use of the appliance or not in conformity with what's written in this instruction manual.

CAUTIONS

Do not use Steam Cleaner without a Pad attached to the system.

WARNING

THIS STEAM CLEANER WAS DESIGNED TO USE **ANTIBAK** CLEANING SOLUTION **ONLY! DO NOT USE** ANY OTHER SOLUTION OR CLEANING AGENT OR YOU WILL DAMAGE THE STEAM CLEANER AND VOID THE WARRANTY.

● Save your back

No need to press hard
The steam cleaner does the work for you



ETY INSTRUCTION

CAUTIONS

- *Care should be taken when placing down the hot boiler cap, to ensure it is not within children's reach.*
- *Extreme care should be taken when opening the Boiler Cap as it may become hot during use and escaping steam can cause scalding.*

ADVICE ON DISPOSAL

1. When this crossed-out bin symbol appears on a product it means that the product is covered by European Directive 2002/96/EC
2. All electrical and electronic products should be disposed of separately from the municipal waste stream via specific collection facilities designated by the government or the local authorities.
3. Proper disposal of your old appliance will help prevent potential negative consequences for the environment and human health.
4. For more detailed information about disposal of your old appliance, please contact your municipality, the waste disposal service or the shop where you purchased the product.



INDICATIONS OF USE

This manual can not take into account every possible use. For further information or for any problems that are not covered in detail in this manual, please contact the Service Center or retailer. **Keep this manual in a safe place for future reference. Destroy all plastic bags and packaging material, they can be a risk for children!**

NOTE: Keep the packaging for possible future transport (eg relocations, repairs, etc.)

Attention: the photographs and/or drawings in this document are for illustrative purposes only. Actual appliance and the accessories may vary due to product enhancement.

Safety Information in Digital Format: www.plastecs.it/warning

One (1) Floor Steam Cleaner

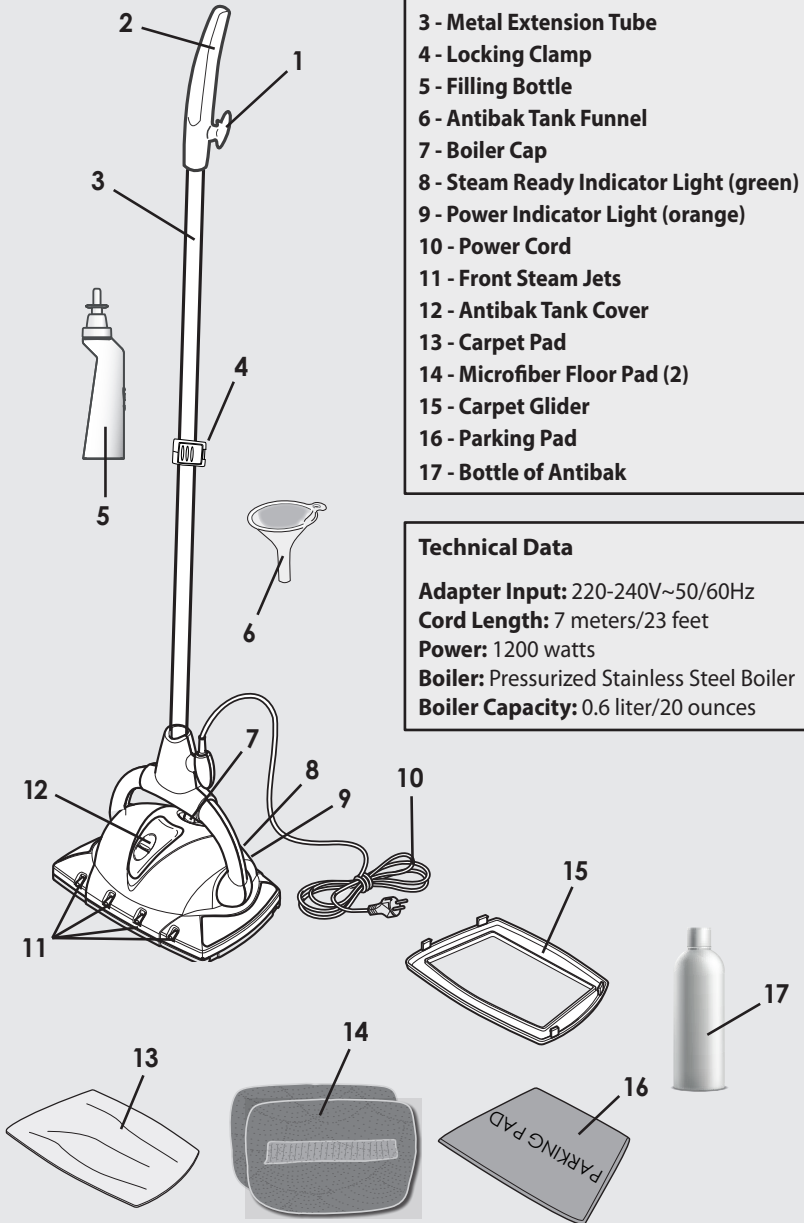

- 1 - Cord Winder
- 2 - Handle
- 3 - Metal Extension Tube
- 4 - Locking Clamp
- 5 - Filling Bottle
- 6 - Antibak Tank Funnel
- 7 - Boiler Cap
- 8 - Steam Ready Indicator Light (green)
- 9 - Power Indicator Light (orange)
- 10 - Power Cord
- 11 - Front Steam Jets
- 12 - Antibak Tank Cover
- 13 - Carpet Pad
- 14 - Microfiber Floor Pad (2)
- 15 - Carpet Glider
- 16 - Parking Pad
- 17 - Bottle of Antibak

Technical Data

Adapter Input: 220-240V~50/60Hz
Cord Length: 7 meters/23 feet
Power: 1200 watts
Boiler: Pressurized Stainless Steel Boiler
Boiler Capacity: 0.6 liter/20 ounces

Security Labels

Please read the warning labels and printed instructions on the steam cleaner for proper operation. Refer to the illustration below for the location of the warning labels and printed instructions.

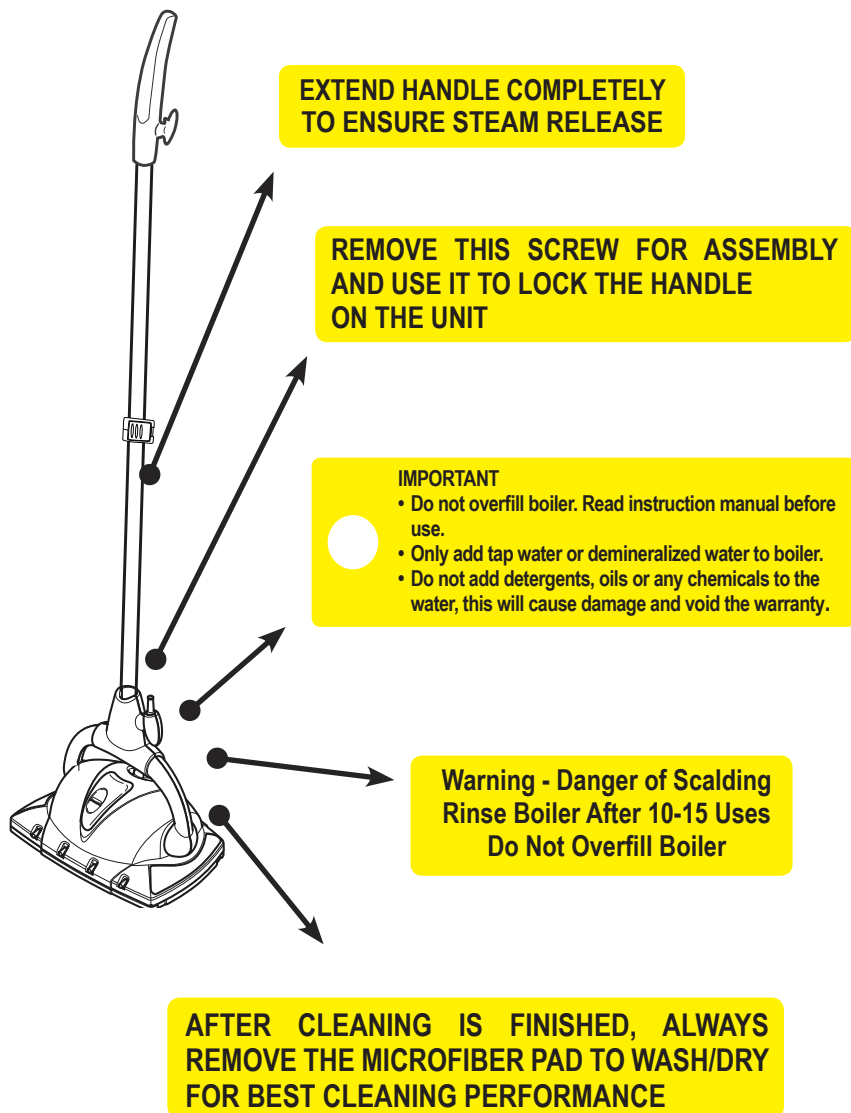

1 Assembly of Parts & Preparation of Steam Cleaner

Make sure all parts are in the box (see pg 6).
IMPORTANT: FOLLOW THESE INSTRUCTIONS CAREFULLY!

A. Assemble Handle

After removing Handle Assembly from carton:

- Pull Extension Tube apart until you see the lock opening (hole) on the Tube.

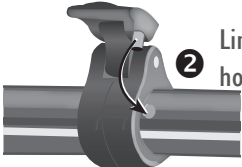
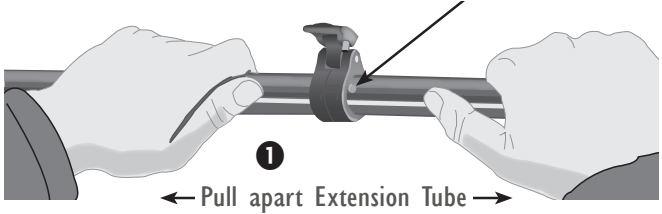

Line up the peg on Locking Clamp with the hole on Extension Tube and...

snap the Locking Clamp closed, to lock the Extension Tube in position.

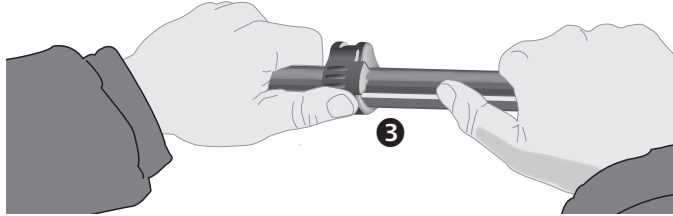

IMPORTANT

Front steam jets will only operate when Extension Tube is in the “Maximum Extension” position. **BE SURE EXTENSION TUBE IS FULLY EXTENDED AND LOCKED IN PLACE FOR OPTIMAL STEAM OPERATION.** Do not remove Handle Assembly once attached to steam cleaner.

B. Attach Handle Assembly to Steam Cleaner

- Before starting, remove the self-tapping screw from the bottom of Extension Tube.
- Insert the Handle Assembly into the Steam Cleaner Base. Align Arrow on Extension Tube with Arrow on Base (as shown in Fig. A).
- Once inserted, twist Handle Assembly 90° clockwise (as shown in Fig. B). Be sure Arrow on the Extension Tube is aligned with Line/Lock Icon on Base.

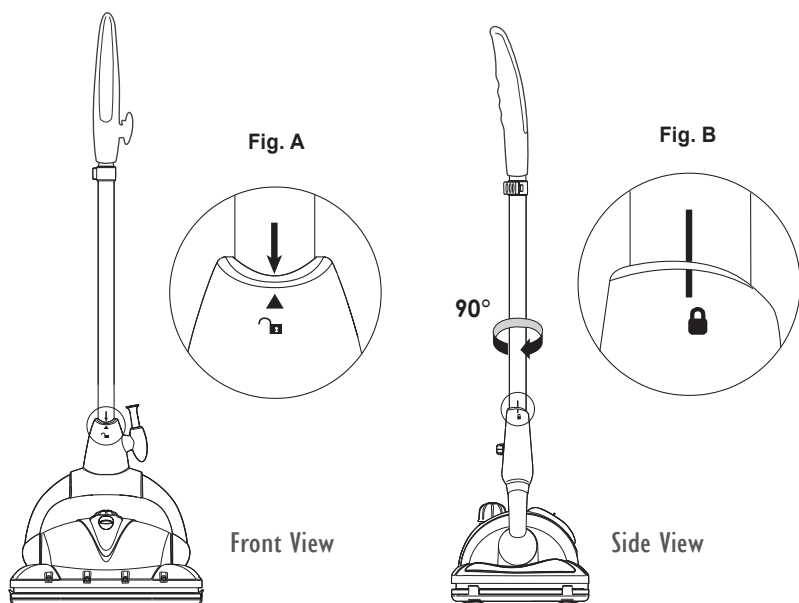

Fig. C

- Align the Handle Assembly screw hole with the opening in the steam cleaner housing. Secure the handle assembly with self-tapping screw which was removed from bottom of Extension Tube (as shown in Fig. C).

C. Attach Microfiber Pads to Steam Cleaner

WARNING! To prevent floor damage, ALWAYS attach either the Microfiber Pad or the Carpet Glider with Carpet Pad when using your Steam Cleaner. **NEVER USE WITHOUT EITHER OF THESE ATTACHMENTS AFFIXED TO THE STEAM CLEANER.**

ATTACHING MICROFIBER FLOOR PAD

Microfiber Floor Pad – Place Microfiber Floor Pad face down on the floor, wide side forward. Hold Steam Cleaner about 2" above Pad and gently place Steam Cleaner on the Pad. Firmly press down to assure Pad is adhered to the Steam Cleaner.

HEATED PLATE ON BOTTOM OF BASE PROVIDES ADDITIONAL CLEANING BOOST.

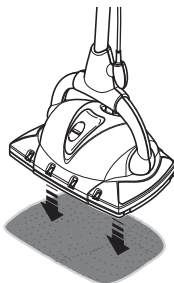
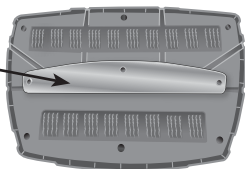

USE ON TIMBER FLOORS – For timber floors, use only on “sealed” smooth timber surfaces. Move Steam Cleaner forward and backward while cleaning, carefully observing the amount of steam used, as too much water could cause damage.

ATTACHING CARPET GLIDER WITH CARPET PAD

Place Carpet Glider face up on floor. Center and place Carpet Pad on top of Carpet Glider. Hold Steam Cleaner over Carpet Glider and gently lower the Steam Cleaner onto the Glider. Make sure the 4 clips on Glider are around the outside of the Steam Cleaner Base and using hands, attach the 4 clips of the Carpet Glider to the Steam Cleaner Base.

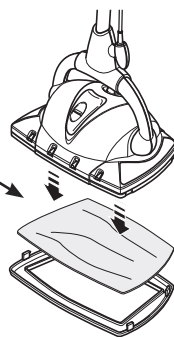

* IMPORTANT NOTE ABOUT LINOLEUM FLOORING *

Steam can cause wax to be stripped from, and consequently damage, some varieties of linoleum flooring. ALWAYS test a small, inconspicuous portion of the floor BEFORE using steam to ensure that your linoleum floor does not have this issue. For some varieties of linoleum or vinyl floors the Steam Cleaner is harder to push forward and back.

NOTE: See “Maintenance & Cleaning” for care and cleaning instructions of Microfiber Pads.

D. Filling Boiler with Water

WARNINGS:

- Carefully read all instructions before removing Boiler Cap.
- Always unplug appliance before filling the Boiler

IMPORTANT Use ordinary tap water. Demineralized or distilled water is recommended if tap water is too hard. DO NOT add detergents, perfumes, oils, or other chemical substances to the Boiler. The product warranty will be null and void if anything other than water is added to the Boiler.

Follow these instructions to fill the Boiler:

- Be sure appliance is unplugged from the electrical power outlet, and has **cooled for at least 5 minutes before filling with water.**
- **Make sure Handle Assembly is in the upright "OFF" position.** Remove Boiler Cap by turning it counterclockwise.
- Keeping the handle assembly pushed forward **(A)**, place the filling bottle upside down and insert the nozzle inside the boiler opening **(B)**. Press down the bottle to deactivate the locking mechanism to release water. Re-fill the bottle and continue filling the boiler. The filling bottle allows you to fill the boiler to correct level, avoiding overfilling.
- Keep the handle assembly pushed forward **(A)** while removing the bottle.
- Replace Boiler Cap by turning it clockwise. Do not tighten Boiler Cap too much – finger tightening is sufficient to lock the steam in the Boiler. If using cold water, heating time is about 3-5 minutes. If using warm water, heating time is reduced.

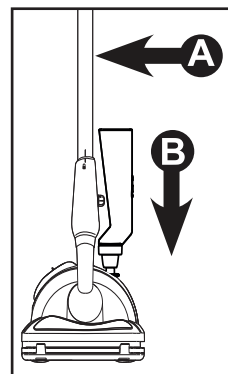
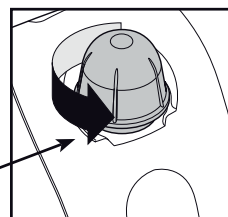

IMPORTANT

Use the filling bottle when refilling your Boiler. The filling bottle has a built-in mechanism that prevents overfilling your Boiler. If you use a measuring cup to refill, add a maximum of 600ml of water when the Boiler is empty.

If re-filling the Boiler while Steam Cleaner has been in use, be sure to allow Steam Cleaner to cool for at least 5 minutes and loosen Boiler Cap slowly to allow any excess steam to escape before completely removing Cap. (See page 15, "Refilling Boiler During Use" for detailed instructions).

E. The Antibak Sanitizing System

This Superclean Steam Cleaner is equipped with a unique on-demand option designed to sanitize your hard floor surfaces (sealed timber, tile, marble, granite, linoleum, etc.).

Included in this package is a 200 ml bottle of "Antibak", a special sanitizing agent that will quickly kill up to 99.9% of germs and bacteria. The Antibak continues to work after it's used, by preventing regrowth of bacteria several days after use. Be sure to use as directed.

Adding Antibak Sanitizer

- Push Antibak Tank Cover in the upward direction (as shown in "A") to reveal opening.
- Insert the small Antibak Tank Funnel in the Antibak Tank.
- Pour the desired amount of Antibak into the tank "C". Keep in mind that the bottle contains 200ml and that numbers 1-2-3 identify each 50ml level as shown in fig. "B".

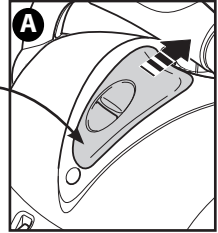

REMEMBER: YOU CAN FILL THE ANTIBAK TANK WHEN THE STEAM CLEANER IS ON AND HOT. BUT NEVER FILL THE BOILER WHILE THE STEAM CLEANER IS HOT!

- Remove the small Antibak Tank Funnel from the Antibak Tank before use.

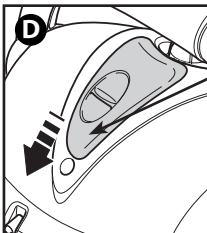
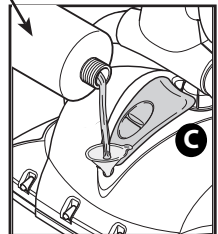

- Close the Antibak Tank Cover as shown in fig. "D".

- You can now sanitize on demand by pulling up the Trigger on the Handle as shown in fig. "E".

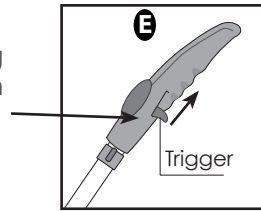

E. The Sanitizing System (Continued)

- The sanitizer is delivered to the surface only through the front jets of the Steam Cleaner as shown in fig. "F".

WARNING: Only use Antibak sanitizer in the Antibak Tank located on the front of Steam Cleaner. Do not use the Antibak Sanitize in the boiler.

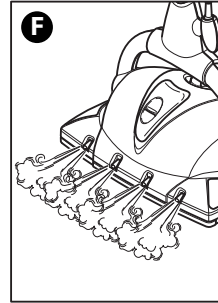

The Steam Cleaner was designed to be used with Antibak only. Any other solutions (detergents or oils) used may damage your Steam Cleaner and will void the warranty.

HINT: A little Antibak goes a long way - no need to soak your floor.

IMPORTANT

Do not use Antibak sanitizer on carpets or rugs (or any other soft furnishings such as mattresses or lounge). When using the Carpet Glider on carpets or rugs, do not pull the trigger on the Handle to dispense Antibak. The steam coming from the bottom of the Steam Cleaner is sufficient to refresh carpet or rugs.

2

Using the Steam Cleaner

A. Parking Pad

You must use the Parking Pad if the Steam Cleaner is warm or hot.

WARNINGS

The Parking Pad is provided to prevent floor damage that can result from leaving a hot Steam Cleaner resting on the same spot for too long. ALWAYS place Steam Cleaner on the Parking Pad when not in use, or while it is cooling before storage.

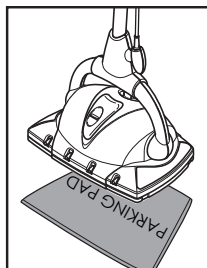

B. Starting the Appliance

- Ensure the Boiler is filled with water and the Boiler Cap is in place.
- Insert the plug into a 3-prong grounded electrical outlet (orange Power Indicator Light will illuminate).
- Keeping the handle in the upright "Off" position, wait until the (green) Steam Ready Indicator Light illuminates.
- When the green Steam Ready light comes on, the Steam Cleaner is ready for cleaning.

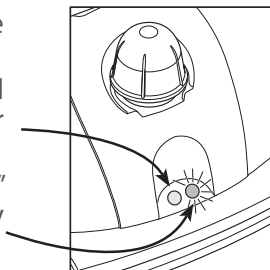

PLEASE NOTE: The green Steam Ready Indicator Light will turn on and off during use. This is normal and not a fault.

C. Using Steam

- To emit steam from the underside of the Steam Cleaner, simply pull the Handle downwards.
- Return Handle to the upright position to stop the steam.

You will find that your Steam Cleaner can easily clean most hard sealed smooth floors using the steam from the underside alone.

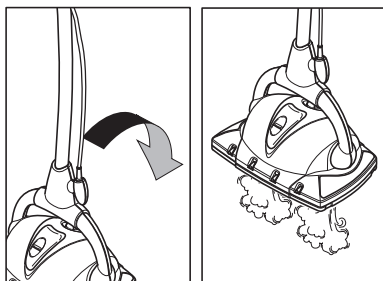

NOTE: Some water may be emitted when the handle is first pulled down after filling. This is normal.

Using the Sanitizing System

The Superclean Steam Cleaner will sanitize non-porous hard floor surfaces by using a sanitizing agent called Antibak. The Antibak will also keep floors sanitized by stopping the growth of bacteria for many days after use.

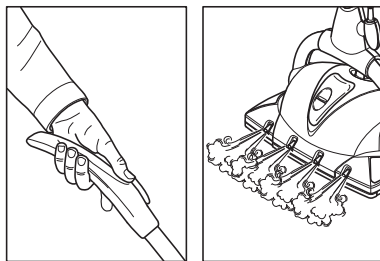

To sanitize your floors using Antibak, follow the filling instructions on page 12 of this manual.

To release the Antibak onto the floor, pull the trigger on the Handle. The Antibak will mix into the steam as it exits from the 4 front steam jets. Push the Steam Cleaner back and forth on the floor to spread the Antibak. A small amount of Antibak goes a long way. One pull of the trigger will release enough Antibak to cover an area of 1 meter by 1 meter. The Antibak sanitizer that is mixed with the steam coming from the front jets will get under furniture and cabinets and disinfect to a distance of 30 cm.

Refill the Antibak tank as needed. Once the Antibak runs out, replacement bottles can be purchased from the appliance retailer who sold you the Superclean Steam Cleaner.

NOTE: the boiler in the Steam Cleaner will not need refilling for about 20-25 minutes of usage.

The Steam Cleaner will stop producing steam when the Boiler is empty. When this happens unplug and store unit or refill with water per instructions.

NOTE: If the Floor or Carpet Pad becomes too wet or too dirty, replace with a clean one and continue cleaning.

D. Refilling Boiler During Use

When the Steam Cleaner has run out of water, there will be no more steam coming out of the unit. At this stage it is time to refill the Boiler. Follow the refilling instructions below.

•IMPORTANT•

Use the filling bottle when refilling your Boiler. The filling bottle has a built-in mechanism that prevents overfilling your Boiler. If you use a measuring cup to refill, add a maximum of 600ml of water when the Boiler is empty.

If cleaning is completed and water remains in the Boiler, the Steam Cleaner can be stored with the remaining water in the Boiler. There will be no harm done to the unit. At the next cleaning session simply fill the Boiler using the filling bottle.

WARNING: let Steam Cleaner cool 5 minutes before opening Boiler Cap. Use care when opening Boiler Cap as it may still be hot and steam may escape, causing burns. If Boiler is still hot, water may spurt out during refilling which can also cause burns.

- **Unplug the appliance from the electrical power outlet.**
- Place Handle in the "ON" position to release any residual steam and pressure from the Boiler.
- After all the steam and pressure have been released from the Steam Cleaner, return the handle to the upright "Off" position.
- Slowly turn Boiler Cap counterclockwise. This will allow remaining steam to escape.
- **Make sure Steam Cleaner has cooled 5 minutes before refilling with water.**

The product warranty will be invalidate if anything other than water is added to the Boiler.

- Keeping the handle assembly pushed forward **(A)**, place the filling bottle upside down and insert the nozzle inside the boiler opening **(B)**. Press down the bottle to deactivate the locking mechanism to release water. The filling bottle allows you to fill the boiler to correct level, avoiding overfilling.
- Keep the handle assembly pushed forward **(A)** while removing the bottle.
- Replace the Boiler Cap on and turn it clockwise. Do not tighten Boiler Cap too much.

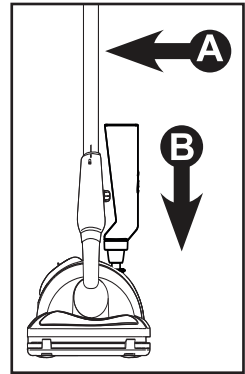

If you use cold water, the heating time is about 3-5 minutes. If you use hot water, the heating time is reduced.

- Insert the plug into electrical outlet. Wait for green Steam Ready Indicator Light to turn on. Steam Cleaner is ready to use once again.

REMINDERS

- Always use ordinary tap water.
- If tap water is too hard, use distilled or demineralized water to avoid the risk of mineral deposits and sediment from forming.
- Do not add detergents, perfumes, oils or other chemical substances to the Boiler. This will damage the Steam Cleaner and void the warranty.
- The green Steam Ready Indicator Light will turn on and off during use. This is normal and not a fault.

7 Maintenance Instructions

We recommend you periodically clean the Steam Cleaner to prevent the accumulation of calcium, mineral deposits and other sediment caused by the use of tap water. After every 10-15 refills, fill the Boiler three-quarters full of hot tap water, shake several times and empty out the water into a sink.

Repeat several times to ensure that the Boiler is flushed of any calcium or mineral deposits. Wipe the Steam Cleaner with a damp cloth and dry.

NEVER HOLD THE STEAM CLEANER UNDER THE TAP TO FILL. Use the filling bottle provided to fill the Boiler.

If distilled or demineralized water is regularly used in the Steam Cleaner, cleaning of the Boiler can be done less frequently. In some areas tap water is very hard, it is recommended that the Boiler is cleaned more frequently if hard water is used.

The cleaning of the Boiler and Steam Cleaner is the sole responsibility of the appliance owner. Calcium, mineral deposits and other sediments left to build up in the Steam Cleaner causing it to fail and/or the steam pathways in the Steam Cleaner to block, is not covered by the product warranty. Users must follow the maintenance instructions above.

If the Steam Cleaner and Boiler is not cleaned according to the instructions above and the product fails and/or the steam pathways are blocked, the appliance owner should send the product for servicing by contacting the Customer Support Line.

The Steam Cleaner is intended for domestic household use only. It is not intended for commercial use. Any use other than for domestic household purposes will void the product warranty.

10 Microfiber Pad Care & Cleaning

Your Microfiber Pads are designed for hundreds of uses. Clean Pads regularly, either by hand (using mild soap and warm water) or in your washing machine on a delicate cycle, cool water. Never use fabric softener or bleach. We recommend letting Pads air dry to maintain maximum long term effectiveness.

Replacement pads are available at most retail outlets or on our website at www.euroflex.com.au.

Microfiber washing instructions – ULTRA QUALITY MICROFIBER

FLOOR PAD	CARPET PAD
<p>50% Polyester / 50% Polyamide</p> <p>Hand wash only Tumble dry low or air dry No bleach / No fabric softener</p>	<p>80% Polyester / 20% Polyamide</p> <p>Hand wash only Tumble dry low or air dry No bleach / No fabric softener</p>

ISSUES	POSSIBLE CAUSES	SOLUTIONS
Steam is not coming out of the Steam Nozzles	Improper Handle Assembly	Call Customer Service to receive instructions to correct the problem
The Hard Surface Floor Pad is not adhering to Steam Cleaner	Not enough pressure was applied when attaching Pad	Position Steam Cleaner about 2" above Pad and FIRM-LY press it down onto the Pad
	Floor Pad requires replacing due to age of the Floor Pad	Replacement Floor Pads can be purchased at most electrical appliance retail outlets
The Cleaning Pads are getting soaked (too wet). Why?	Boiler is overfilled	Let Steam Cleaner run until excess water ceases. -OR- Remove some water from Boiler once the Boiler has cooled down completely
	Green "Steam Ready Indicator Light" is not illuminated	Wait for green "Steam Ready Indicator Light" to illuminate
The steam seems to be making my floor too wet	Front Steam Jets are being used too frequently	Only use Front Steam Jets in short bursts for cleaning tougher dirt or to clean hard to reach areas
	The Cleaning Pad is too wet (saturated with moisture)	Replace the wet Pad with a dry, clean Pad and continue cleaning
The Antibak is running out quickly.	Trigger is being used too frequently.	Pull Trigger less and use Antibak more sparingly.

IMPORTANT QUESTION:

Q: Do I always need to use a Microfiber Pad when cleaning with my Steam Cleaner?

A. YES! It is critically important to ALWAYS use your Microfiber Pads. The Steam Cleaner should NEVER be used without either a Hard Surface Floor Pad or Carpet Glider with Carpet Pad.

Customer Support

Customers needing assistance with their Steam Cleaner can call the Customer Support Line on the phone numbers listed below. Customers should also call the Customer Support Line if they require product warranty repair or post-warranty product servicing. Our friendly Customer Service Team can assist you with getting the best cleaning results from your Steam Cleaner, they are full of helpful steam cleaning tips, too.

Customer Support Line

AUSTRALIA 1800 663 866
NEW ZEALAND 0800 666 783

Euroflex Australia Pty Ltd

79 Furniss Road
DARCH WA 6065
AUSTRALIA
TEL: 08 9302 2526
Email: admin@euroflex.com.au
Website: www.euroflex.com.au

Euroflex New Zealand Ltd

c/- Dubins
137 Glenfield Road
Birkenhead Auckland 0626
Email: admin@euroflex.com.au
Website: www.euroflex.com.au

NEW ZEALAND
TEL: 0800 666 783

Plastecs SRL

Via dei Colli, 59
31058 Susegana (TV)
ITALY
Tel: +39 0438 453334
Email: info@plastecs.it
Website: www.euroflex-appliances.com

