

Implant

Screw Removal Kit

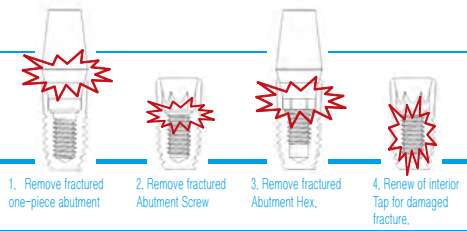

Used for removing a broken screw in the fixture safely & speedily.

Screw Removal Kit

OSRKIT

• Size 160 x 85 x 65H(mm)

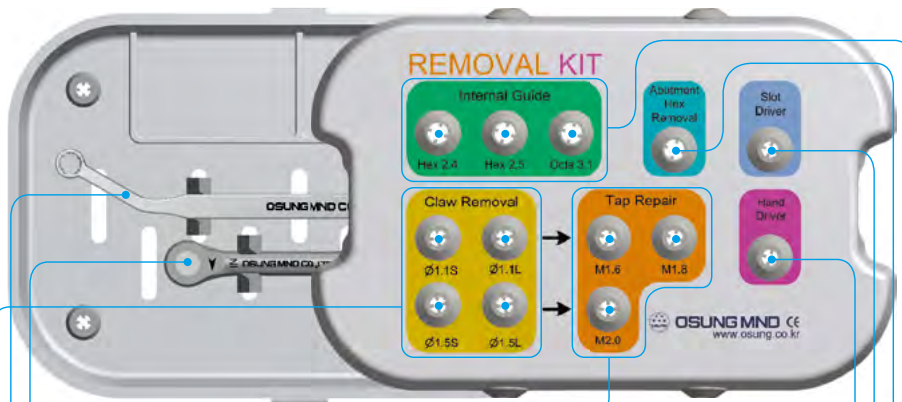

Tap Repair
• Consist of M1.6, M1.8, and M2.0



Ratchet Wrench
• For abutment hex removal and tap repair



Internal Guide Handle
• Used for holding an internal guide firmly.



Claw Removal
• Consist of Ø1.1S, Ø1.1L, Ø1.5S, and Ø1.5L for removing a broken screw inside a fixture



Abutment Hex Removal

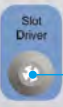

Slot Driver



Hand Driver



Slot Driver

• For damaged Hex of healing abutment, cover screw and abutment screw



Abutment Hex Removal

• used for removing octa or broken hex of abutment



Internal Guide

• Consist of IH2.4, IH2.5, and IO3.1
• It is used with claw removal Ø1.1L or Ø1.5L as a guide

	Ø1.1S	Screw for dia Ø1.6
	Ø1.1L	
	Ø1.5S	Screw for dia Ø2.0
	Ø1.5L	

Screw Removal Kit

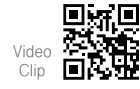

Practice

1. Remove fractured one-piece Abutment

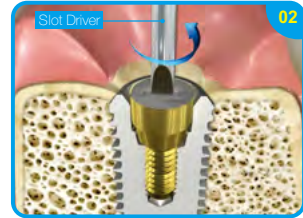
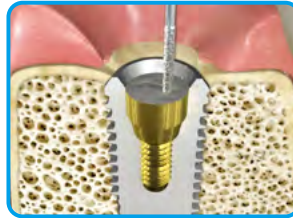

01. Make a linear slot using over 0.8mm bur.

02. Fit a slot driver into the preformed linear slot and turn counterclockwise to remove the broken abutment.

2. Remove fractured Abutment Screw

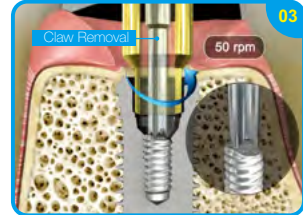
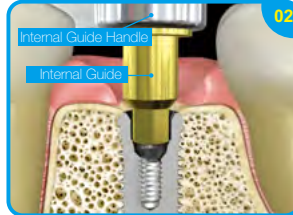

01. Fractured screw

02. Hold guide handle not to move internal guide.

03. Put claw removal to reach the screw through an internal guide.

3. Remove fractured Abutment Hex



01. Fractured abutment hex

02. Turn Abutment Hex removal clockwise until it hangs to fractured Abutment hex (Fixture can be moved if you put excessive power)

03. Remove Hex.

4. Renew of interior Tap for damaged fracture

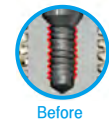
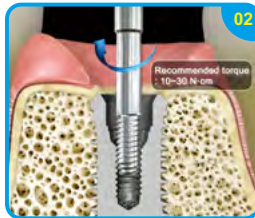
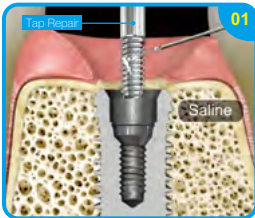

01. Do not harm by heat injecting saline continuously.

02. Refine internal tap with a force of 10-30N.

03. Remove residue in the tap. (2-3 times repeat)