

REMOTE CONTROL

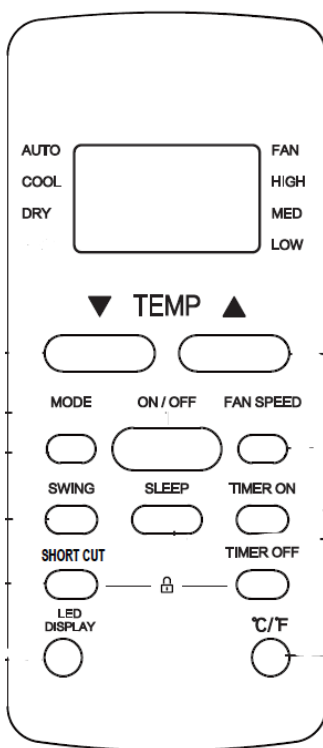

MODEL
RG51F5(1)/CE

BATTERIES
AAA x 2
(R03/LR03x2)

RANGE
8 METRES

WARRANTY
365 DAYS

EN USER INSTRUCTION & OPERATION MANUAL
ES MANUAL DE INSTRUCCIONES Y OPERACIONES PARA EL USUARIO
DE BENUTZERANLEITUNG & BETRIEBSANLEITUNG
FR MANUEL D'UTILISATION ET D'UTILISATION
IT ISTRUZIONI PER L'USO E MANUALE OPERATIVO

EN

Thank you for purchasing this ALL AIR product.

Please read the user manual carefully before operating this appliance.

We will update our instruction manuals if necessary.

For the most up-to-date user manual, please visit our official website: www.netta.co.uk.

You can download a copy of up-to-date user manuals at any time in electronic format. We do not supply you with a paper-based user manual after each revision.

Require a larger version of this Instruction Manual?

Please download electronically from our website and use PDF reader on your device to enlarge the text if needed.

www.netta.co.uk

Safety and Warnings

Intended Use

ALL AIR Design is for domestic and indoor use only. This product is not intended for use by people who have lack of experience and knowledge or have reduced ability, or sensory and metal capabilities.

Regular Check-Ups

Remove the batteries from the remote if the device is not being used for a long time. This will prevent unnecessary damage.

Quick Start Guide

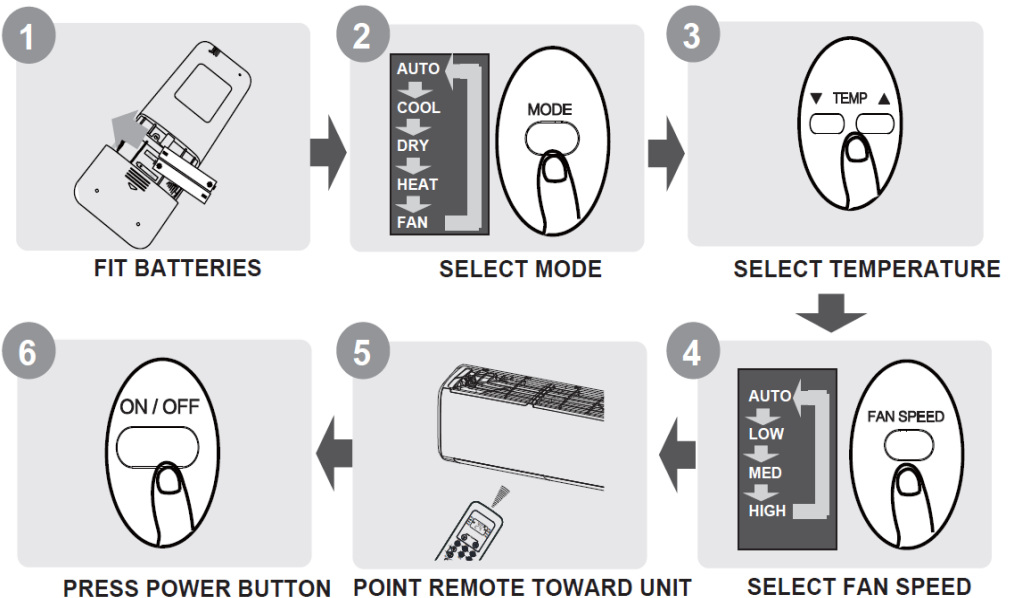

NOT SURE WHAT A FUNCTION DOES?

Refer to the **How to Use Basic Functions** and **How to Use Advanced Functions** sections of this manual for a detailed description of how to use your air conditioner.

Note: Button designs on your device may differ slightly from the examples. If your AC unit does not have a particular function, pressing that function's button on the remote control will have no effect.

Handling the Remote Controller

Inserting and Replacing Batteries

Your air conditioning unit may come with two batteries (some units). Put the batteries in the remote control before use.

1. Slide the back cover from the remote control downward, exposing the battery compartment.
2. Insert the batteries, paying attention to match up the (+) and (-) ends of the batteries with the symbols inside the battery compartment.
3. Slide the battery cover back into place.

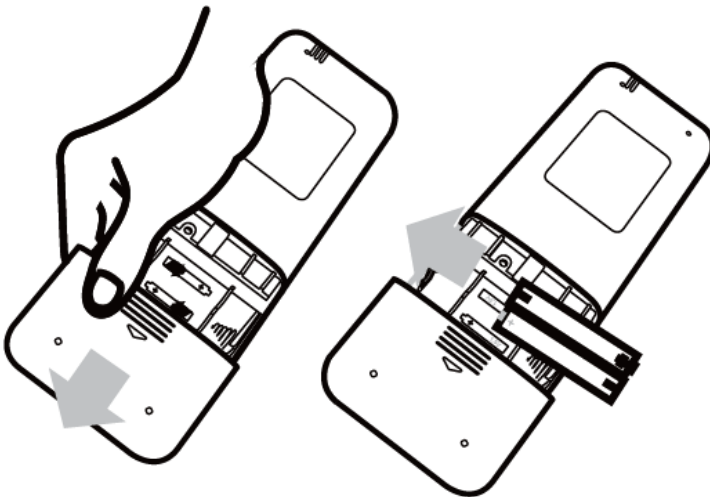

- Do not mix old and new batteries, or batteries of different types.
- Do not leave batteries in the remote control if you don't plan on using the device for more than 2 months.
- Do not dispose of batteries as unsorted municipal waste.

Tips for Using the Remote Control

- The remote control must be used within 8 meters of the unit.
- The unit will beep when the remote signal is received.
- Curtains, other materials and direct sunlight can interfere with the infrared signal receiver.
- Remove batteries if the remote will not be used for more than 2 months.

Operating the Product

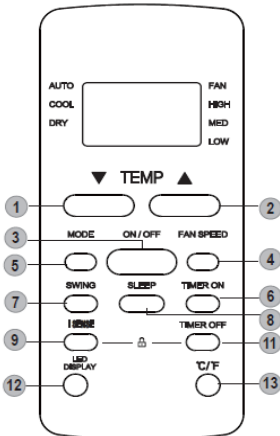

Model: RG51F2(1)/CEF
RG51F2(1)/CEFU1

- 1 **TEMP ▼** : Decreases temperature in 1°C/1°F increments. Min. temperature is 17°C/62°F.
- 2 **TEMP ▲** : Increases temperature in 1°C/1°F increments. Max. temperature is 30°C/86°F.
- 3 **ON/OFF**: Turns the unit on or off.
- 4 **FAN SPEED**: Selects fan speeds in the following order: AUTO → LOW → MED → HIGH
- 5 **MODE**: Scrolls through operation modes as follows: AUTO → COOL → DRY → FAN
- 6 **TIMER ON**: Sets timer to turn unit on (see **How to Use Basic Functions** for instructions).
- 7 **SWING**: Starts and stops the horizontal louver movement. Hold down for 2 seconds to initiate vertical louver auto swing feature (some units).
- 8 **SLEEP**: Saves energy during sleeping hours.

- 9 **I SENSE**: Temperature sensing and room temperature display button.
- 10 **SHORT CUT**: Sets and activates your favorite pre-settings.
- 11 **TIMER OFF**: Sets timer to turn unit off (see **How to Use Basic Functions** for instructions).
- 12 **LED DISPLAY**: Press this button to turn on and turn off the display on the indoor unit.
- 13 **°C/°F**: Press this button to alternate the temperature display between the °C & °F.

NOTE: Press together the two buttons simultaneously for 5 seconds to lock the keyboard. Press together the two buttons for 2 seconds to unlock the keyboard.



Press together simultaneously

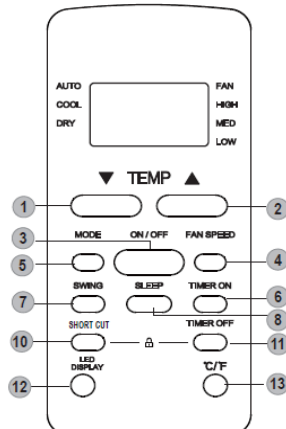

Model: RG51F5(1)/CE
RG51F5(1)/CEU1





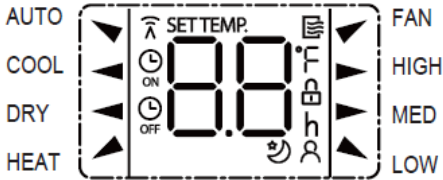



Remote Screen Indicators

Information are displayed when the remote controller is power up.



Mode display

AUTO COOL DRY
HEAT FAN

	Displayed when data transmitted.
	Displayed when remote controller is ON.
	Displayed when TIMER ON time is set
	Displayed when TIMER OFF time is set
	Shows set temperature or room temperature, or time under TIMER setting
	Indicated all the current settings are locked
	Displayed when I SENSE feature is activated(some units)
	Displayed when SLEEP feature is activated

Fan speed indication

▶ HIGH	High speed
▶ MED	Medium speed(some units)
▶ LOW	Low speed
NO display	Auto fan speed

Note:

All indicators shown in the figure are for the purpose of clear presentation. But during the actual operation, only the relative function signs are shown on the display window.

How to Use Basic Functions

! ATTENTION Before operation, please ensure the unit is plugged in and power is available.

AUTO Mode

Select AUTO mode

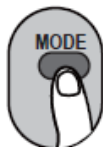

Set your desired temperature



Turn on the air conditioner



NOTE:

1. In AUTO mode, the unit will automatically select the COOL, FAN, or HEAT function based on the set temperature.
2. In AUTO mode, fan speed can not be set.

COOL or HEAT Mode

Select COOL/HEAT mode

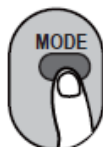

Set the temperature



Set the fan speed



Turn on the air conditioner



DRY Mode

Select DRY mode



Set your desired temperature



Turn on the air conditioner



NOTE: In DRY mode, fan speed can not be set since it has already been automatically controlled.

FAN Mode

Select FAN mode

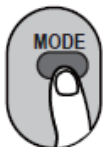

Set the fan speed



Turn on the air conditioner



NOTE: In FAN mode, you can't set the temperature. As a result, no temperature displays in remote screen.

Setting the TIMER

TIMER ON/OFF - Set the amount of time after which the unit will automatically turn on/off.

TIMER ON setting

Press **TIMER ON** button to initiate the ON time sequence.

Press Temp. up or down button for multiple times to set the desired time to turn on the unit.

Point remote to unit and wait 1sec, the **TIMER ON** will be activated.

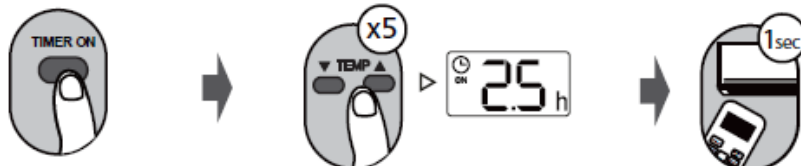

TIMER OFF setting

Press **TIMER OFF** button to initiate the OFF time sequence.

Press Temp. up or down button for multiple times to set the desired time to turn off the unit.

Point remote to unit and wait 1sec, the **TIMER OFF** will be activated.

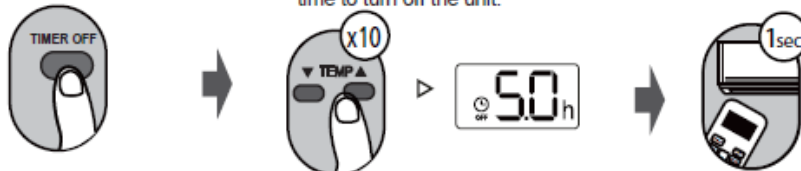

NOTE:

- When setting the **TIMER ON** or **TIMER OFF**, the time will increase by 30 minutes increments with each press, up to 10 hours. After 10 hours and up to 24, it will increase in 1 hour increments. (For example, press 5 times to get 2.5h, and press 10 times to get 5h.) The timer will revert to 0.0 after 24.
- Cancel either function by setting its timer to 0.0h.

TIMER ON & OFF setting(example)

Keep in mind that the time periods you set for both functions refer to hours after the current time.

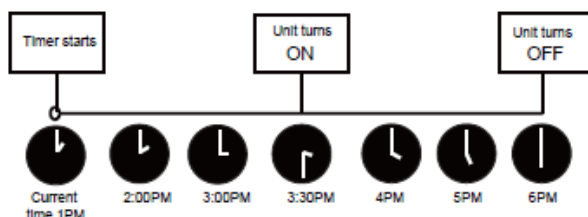
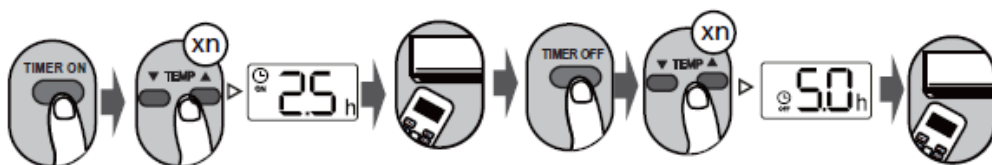

Example: If current timer is 1:00PM, to set the timer as above steps, the unit will turn on 2.5h later (3:30PM) and turn off at 6:00PM.

How to Use Advanced Functions

Swing function(some units)

Press Swing button



The horizontal louver will swing up and down automatically when pressing Swing button. Press again to make it stop.



Keep pressing this button more than 2 seconds, the vertical louver swing function is activated. (Model dependent)

SLEEP function



The SLEEP function is used to decrease energy use while you sleep (and don't need the same temperature settings to stay comfortable). This function can only be activated via remote control.

The sleep function is not available in Fan or Dry mode. Please refer to the OWNER'S MANUAL for more details.

I SENSE function(some units)



When the I SENSE function is activated, the remote display is actual temperature at its location. The remote control will send this signal to the air conditioner every 3 minutes interval until press the I SENSE button again.

NOTE: Press this button for seven seconds to start/stop memory feature of I SENSE function.

- If the memory feature is activated, "On" displays for 3 seconds on the screen.
- If the memory feature is stopped, "OF" displays for 3 seconds on the screen.
- While the memory feature is activated, press the ON/OFF button, shift the mode or power failure will not cancel the I SENSE function.

SHORTCUT function(some units)



Used to restore the current settings or resume previous settings.

Push this button when remote controller is on, the system will automatically revert back to the previous settings including operating mode, setting temperature, fan speed level and sleep feature(if activated).

If pushing more than 2 seconds, the system will automatically restore the current operation settings including operating mode, setting temperature, fan speed level and sleep feature (if activated).

Spare Parts and Repairs

To order replacement parts, please go to netta.co.uk/collections/parts.

You will need PDC information from your product, user manual or carton box. Alternatively, go to our website and use search bar to find the parts available.

You can also find this code on the back of this User Manual.

For our Repair Service, please contact our customer support with email on support@netta.co.uk they will provide with more details of repair service with ALL AIR.

Disposal of Product

IMPORTANT INFORMATION FOR CORRECT DISPOSAL OF THE PRODUCT IN ACCORDANCE WITH EC DIRECTIVE 2002/96/EC.

DISPOSAL:

Please dispose of this product responsibly. This item cannot be disposed of with general waste. Please contact your local council authority for more information on how to dispose this product. If this product is disposed of with general waste, it will end up in a landfill and will leak hazardous substances into the groundwater – effecting our food chain.



Your Warranty

If you purchased with NETTADIRECT, or one of our authorised resellers, you will automatically enrol your warranty for 1 (ONE) year. You do not need to register again for your warranty. All warranties will be carried out under our terms and conditions including warranty conditions which you can find out from our website at www.netta.co.uk.

Copyrights

ALL AIR and its logo including images and contents in this manual and website is copyrighted. All intellectual property rights belong to ALL AIR owner CONSUMABLE DIRECT LIMITED.

ANY UNAUTHORISED USE, MODIFICATION or DISTRIBUTION of the ALL AIR logo, website image, and its contents (from website, manuals) will violate worldwide copyright, trademark and associated laws.

We reserve the right to proceed with lawsuits to anyone who is found breaching our copyrights policy. For more details, please check our website copyright policy for more information.

Product Dependency Code (PDC)

Your PDC is below:

PDC: MPPDB-12CRN7-QB6
SKU: 103976

ALL AIR is a registered trademark of CONSUMABLE DIRECT LIMITED.

Product Produced for CONSUMABLE DIRECT LIMITED, 78 CAWDOR STREET, ECCLES, GREATER MANCHESTER, M30 0QF, U.K.