

# 42 INCH TOWER FAN

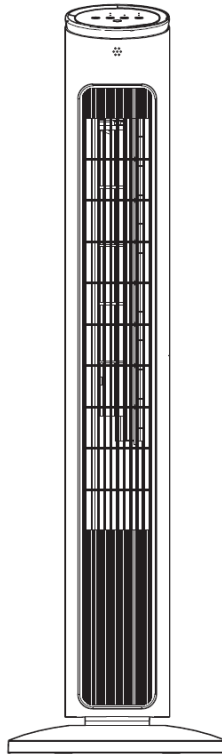

**RATED  
POWER**  
40W

**TIMER**  
7 HOURS

**OSCILLATION**  
60 DEGREES

**SPEED  
SETTINGS**  
THREE



**Thank you for purchasing this NETTA product.**

Please read the user manual carefully before operating this appliance.

We will update our instruction manuals if necessary.

For the most up-to-date user manual, please visit our official website: [www.nettdirect.com](http://www.nettdirect.com).

You can download a copy of up to date user manuals at any time in electronic format. We do not supply you with a paper-based user manual after each revision.

**Require a larger version of this  
Instruction Manual?**

Please download electronically from our website and use PDF reader on your device to enlarge the text if needed.

[www.nettdirect.com](http://www.nettdirect.com)

## SAFETY & WARNINGS

### INTENDED USE

NETTA Design is for domestic and indoor use only. This product is not intended for use by people who have lack of experience and knowledge or have reduced ability, or sensory and mental capabilities.

### REGULAR CHECKUPS

Ensure that the power plug and cable are not damaged before using this product.

## GENERAL CAUTIONS

- If the supply cord is damaged, it must be replaced by manufacturer or its service agent or a similarly qualified person in order to avoid a hazard.
- To protect against the risk of electrical shock, do not immerse the unit, cord or plug in water or other liquid.
- When the appliance is not in use and before cleaning, unplug the appliance from the outlet.
- When the fan was assembled, the rotor blade guard shall not be taken off anymore.
  - Prior cleaning unplug the fan.
  - The rotor guard shall not be disassembled/opened to clean the rotor blades.
  - Wipe the fan enclosure and rotor blade guard with a slightly damp cloth.
- **WARNING** - To reduce the risk of fire or electric shock, do not use this fan with any solid-state speed control device.

## GENERAL CAUTIONS

- Read rules for safe operation and instructions carefully.
- This appliance can be used by children aged from 8 years and above and persons with reduced physical, sensory or mental capabilities or lack of experience and knowledge if they have been given supervision or instruction concerning use of the appliance in a safe way and understand the hazards involved.
- Children shall not play with the appliance. Cleaning and user maintenance shall not be made by children without supervision.
- Keep electrical appliances out of reach from Children or infirm persons. Do not let them use the appliances without supervision.
- Never insert fingers, pencils, or any other object through the grille when fan is running.
- Disconnect fan when moving from one location to another.
- Be sure fan is on a stable surface when operating to avoid overturning.
- Do not leave the fan running unattended.
- Household use only.

## PRODUCT OVERVIEW

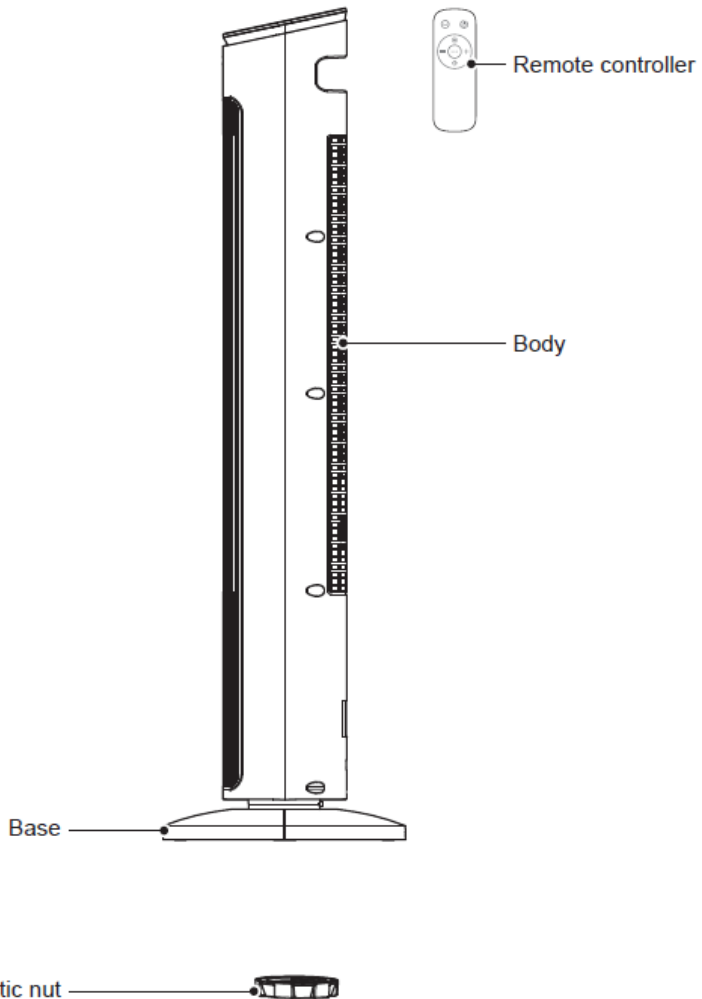

### NOTE

All the pictures in this manual are for explanation purpose only. Any discrepancy between the real object and the illustration in the drawing shall be subject to the real subject.

## ASSEMBLY INSTRUCTIONS

Please place the machine on the package foam or other soft surfaces and invert it to avoid scratch mark when install the base.

1. Take out the two parts of the base from packing box. Then, align the centers of the two parts of the base and place them in a crossed form. Rotate one of the two bases to align its hole site and make it stuck correctly.

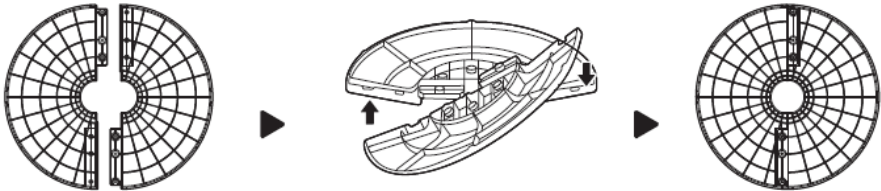

2. Detach the plastic nut from the fan body.

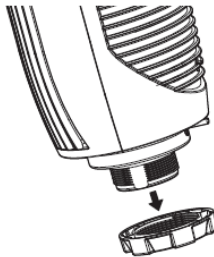



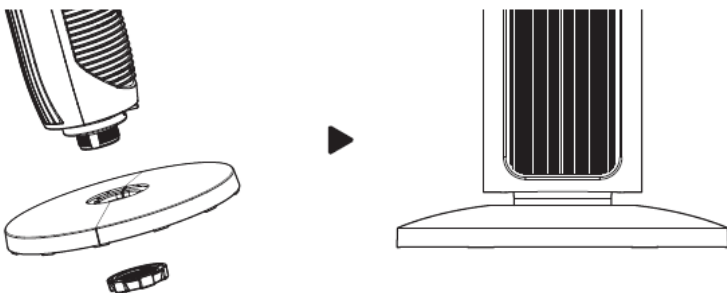



3. Remove the pole, and then directly fix the fan body to the base with a plastic nut.

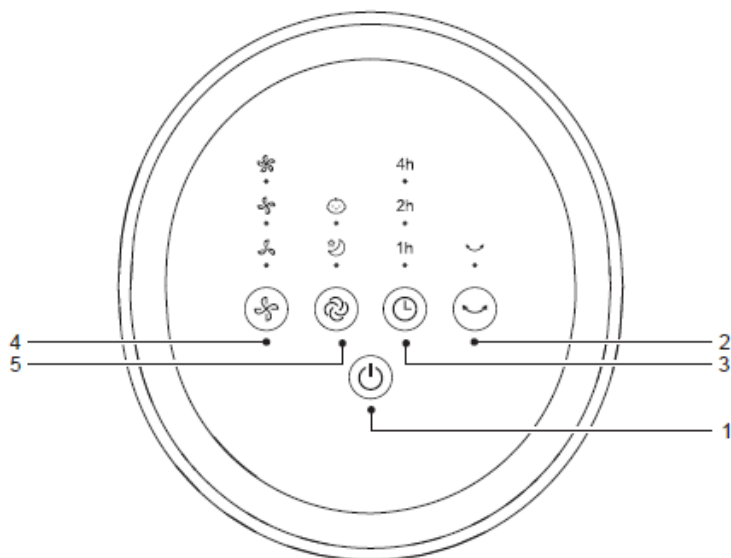

## OPERATING INSTRUCTIONS

### Control Panel





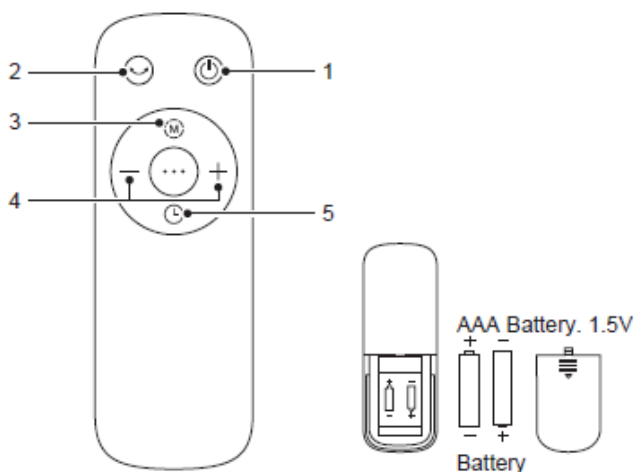

No	Button	Function description
1	 ON/OFF	<ul style="list-style-type: none"> <li>• Press this key to switch on/switch off the fan.</li> </ul>
2	 OSC/ LOUVER	<ul style="list-style-type: none"> <li>• After the fan has started, press this key to select oscillation mode. The lights on the display can indicate fan oscillation mode.</li> </ul>
3	 TIMING	<ul style="list-style-type: none"> <li>• Press this timer key repeatedly to set the time for air delivery. Increase in increments up to "0-1-2-3-4-5-6-7-0" hours.</li> </ul>
4	 SPEED	<ul style="list-style-type: none"> <li>• When the fan started, press this key repeated, the fan will work with "1-2-3-1" circulatory.</li> </ul>
5	 MODE	<ul style="list-style-type: none"> <li>• When the machine is on, short press this button to select "normal wind", "sleep wind", "baby wind"..... Circulating between the three wind classes.</li> <li>• "☺" Light on, start the sleep wind mode, and the fan will automatically adjust the gear cycle according to the established procedure.</li> <li>• "☺" The light is on in baby wind mode.</li> </ul>

## Remote Control

- Point the remote controller at the receptor on body of the fan and press the desired button. The remote controller will work at distances of up to roughly 5 meters and the angle of 30 degree included between right and left from the receptor.
- The batteries must be removed from the remote controller before it is scrapped and that they are disposed of safely.



No	Key	Function description
1	 ON/OFF KEY	<ul style="list-style-type: none"> <li>• The "ON" key is for switching on the fan .The fan will be started at breeze step.</li> <li>• Press the "OFF" key if the fan needs to switch off.</li> </ul>
2	 OSC/ LOUVER KEY	<ul style="list-style-type: none"> <li>• After the fan has started, press this key to select oscillation mode. The lights on the display can indicate fan oscillation mode.</li> </ul>
3	 MODE KEY	<ul style="list-style-type: none"> <li>• When the machine is on, short press this button to select "baby wind", "sleep wind", "normal wind"..... Circulating between the three wind classes.</li> </ul>
4	 SPEED KEY	<ul style="list-style-type: none"> <li>• When the fan started, press " + " key repeated, the fan will work with "1-2-3-1" circulatory. Press " - " key repeated, the fan will work with "3-2-1-3" circulatory.</li> </ul>
5	 TIMER KEY	<ul style="list-style-type: none"> <li>• Press this timer key repeatedly to set the time for air delivery. Increase in increments up to "1-2-3-4-5-6-7" hours.</li> </ul>



## Batteries Installation

Battery not included in the packaging

1 Slide the battery compartment cover.



Fig 1

2 Insert the batteries, and make sure that the batteries are placed as shown in the Fig 2.

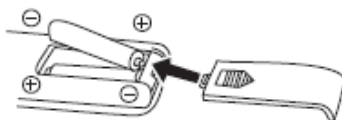

Fig 2

3 Slide back the battery cover.



Fig 3

### NOTE

Use manganese or alkaline batteries of type "AAA". DO not use rechargeable batteries.

## Overheat Protection of the Motor

The windings of the motor have a thermal-fuse that burns out and the fan switches off and temperature of the motor is no longer going up so that plastic parts of the fan don't subject to deformation so far so to be burned by the overheat if the motor is overheat for any unexpected reason.

## CLEANING AND MAINTENANCE

The fan requires little maintenance. Do not try to fix it by yourself. Refer it to qualified service personnel if service is needed.

1. Before cleaning and assembling, fan must be unplugged.
2. To ensure adequate air circulation to the motor, keep vents at the rear of the motor free of dust. Do not disassemble the fan to remove dust.
3. Please wipe the exterior parts with a soft cloth soaking a mild detergent.
4. Do not use any abrasive detergent or solvents to avoid scratching the surface. Do not use any of the following as a cleaner: gasoline, thinner.
5. Do not allow water or any other liquid into the motor housing or interior parts.
6. Be sure to unplug from the electrical supply source before cleaning.
7. Plastic parts should be cleaned with a soft cloth moisten with mild soap. Thoroughly remove soap film with dry cloth.

Problem	Cause	Solution
The machine does not work properly after installed	• The power cable is not plugged in or has poor contact.	Make sure the plug is properly inserted into the socket.
	• The switch on the body is not turned on.	Turn on the switch on the body.
The remote does not work	• The battery needs replacing.	Replace the battery.
	• The remote is being used more than 5m away from the fan.	Use the remote closer to the fan and make sure it is pointing directly at the control panel.

## SPARE PARTS/REPAIR

---

To order replacement parts, please go to [www.nettadirect.com/parts](http://www.nettadirect.com/parts).

You will need PDC information from your product, user manual or carton box. Alternatively, go to our website and use search bar to find the parts available.

You can also find this code on the [back of this User Manual](#).

For our Repair Service, please contact our customer support with email on [support@nettadirect.com](mailto:support@nettadirect.com) they will provide with more details of repair service with NETTA.

## DISPOSAL OF PRODUCT

---

**IMPORTANT INFORMATION FOR CORRECT DISPOSAL OF THE PRODUCT IN ACCORDANCE WITH EC DIRECTIVE 2002/96/EC.**

### **DISPOSAL:**

Please dispose of this product responsibly. This item cannot be disposed of with general waste. Please contact your local council authority for more information on how to dispose this product. If this product is disposed of with general waste, it will end up in a landfill and will leak hazardous substances into the groundwater – effecting our food chain.



## YOUR WARRANTY

---

If you purchased with NETTADIRECT, or one of our authorised resellers, you will automatically enrol your warranty for 1 (ONE) year. You do not need to register again for your warranty. All warranties will be carried out to our terms and conditions including warranty conditions which you can find out from our website at [www.nettadirect.com](http://www.nettadirect.com).

## COPYRIGHTS

---

NETTA and its logo including images and contents in this manual and website is copyrighted. All intellectual property rights belong to NETTA owner CONSUMABLE DIRECT LIMITED.

ANY UNAUTHORISED USE, MODIFICATION or DISTRIBUTION of the NETTA logo, website image, and its contents (from website, manuals) will violate worldwide copyright, trademark, and associated laws.

We reserve the right to proceed with lawsuits to anyone who is found breaching our copyrights policy. For more details, please check our website copyright policy for more information.

## PRODUCT DEPENDENCY CODE (PDC)

---

Your PDC is below:

**PDC: FZ10-22JR**  
**SKU: 104115 / 104116**

NETTA is a registered trademark of CONSUMABLE DIRECT LIMITED.  
Product Produced for CONSUMABLE DIRECT LIMITED M30 0QF U.K.