

16 INCH STAND FAN

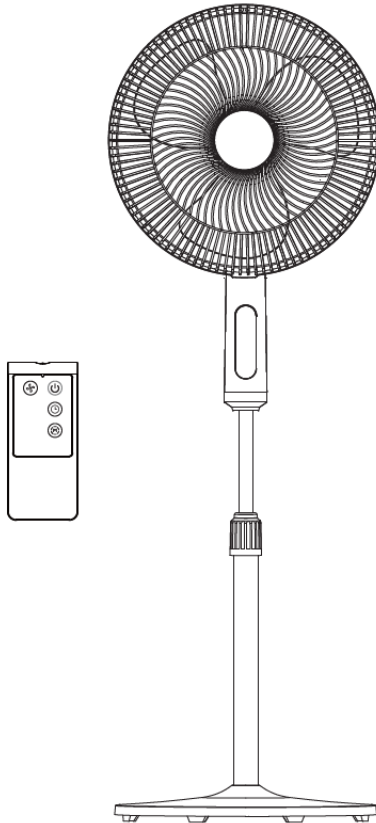

**RATED
POWER**
40W

TIMER
7 HOURS

OSCILLATION
80 DEGREES

**SPEED
SETTINGS**
THREE

Thank you for purchasing this NETTA product.

Please read the user manual carefully before operating this appliance.

We will update our instruction manuals if necessary.

For the most up-to-date user manual, please visit our official website: www.nettdirect.com.

You can download a copy of up to date user manuals at any time in electronic format. We do not supply you with a paper-based user manual after each revision.

Require a larger version of this Instruction Manual?

Please download electronically from our website and use PDF reader on your device to enlarge the text if needed.

www.nettdirect.com

SAFETY & WARNINGS

INTENDED USE

NETTA Design is for domestic and indoor use only. This product is not intended for use by people who have lack of experience and knowledge or have reduced ability, or sensory and mental capabilities.

REGULAR CHECKUPS

Check cables every time before plugging into a socket, make sure power cables are not burst or snapped and that the power-plug has no damage.

GENERAL CAUTIONS

- If the supply cord is damaged, it must be replaced by manufacturer or its service agent or a similarly qualified person in order to avoid a hazard.
- To protect against the risk of electrical shock, do not immerse the unit, cord or plug in water or other liquid.
- This appliance can be used by children aged from 8 years and above and persons with reduced physical, sensory or mental capabilities if they have been given instruction concerning use of the appliance in a safe way and understand the hazards involved. Children shall not play with the appliance. Cleaning and user maintenance shall not be made by children without supervision.
- When the appliance is not in use and before cleaning, unplug the appliance from the outlet.
- Indoor and household use only.
- When the fan was assembled, the rotor blade guard shall not be taken off anymore.
 - Prior cleaning unplug the fan.
 - The rotor guard shall not be disassembled/opened to clean the rotor blades.
 - Wipe the fan enclosure and rotor blade guard with a slightly damp cloth.

RULES FOR SAFE OPERATION

- Never insert fingers, pencils, or any other object through the grille when fan is running.
- Disconnect fan when moving from one location to another.
- Be sure fan is on a stable surface when operating to avoid overturning.
- DO NOT use fan in window, rain may create electrical hazard.

PRODUCT DIAGRAM

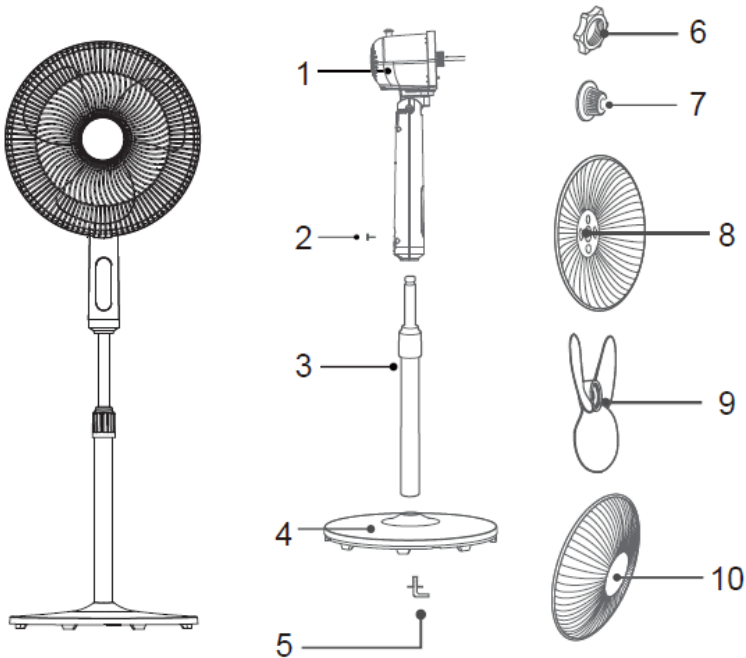

NO.	Description	NO.	Description
1	Motor	6	Plastic Nut
2	Tighten Knob	7	Spinner
3	Pole	8	Rear Grill
4	Chassis	9	Blade
5	7-shaped screw	10	Front Grill

ASSEMBLY INSTRUCTIONS

Before installation, first remove 7-shape screws from the pole, remove the Spinner and Plastic nut from the motor shaft, and then install.

Chassis Installation

Align the lower pole and the chassis, and then fasten securely with chassis screws.

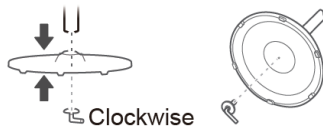

Pole Installation

Pull out and fix the internal pole (column) after adjusting the height by way of tightening or loosening the knob.

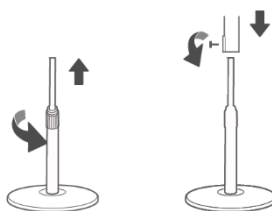

Install and fix the machine body by way of tightening or loosening tighten knob.

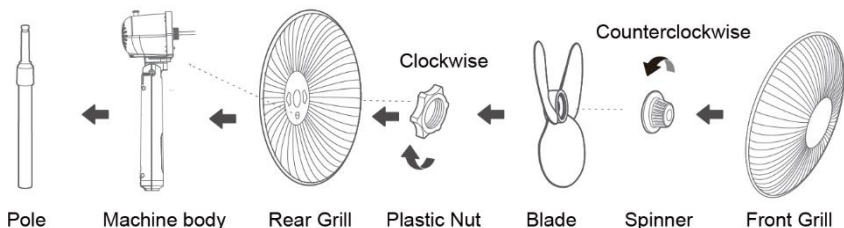

Installation of Rear Grill

Align the holes of rear grill with the protruded points on the motor housing.

Installation of Plastic Nut

Screw clockwise the plastic nut tightly to fasten the rear grill.

ASSEMBLY INSTRUCTIONS (cont.)

Blade Installation

After the installation of blade, rotate the blade with your finger to make sure the blade works normally.

Spinner Installation

Screw counterclockwise the spinner tightly, and then install the front grill.

Installation of Front Grill

From top to bottom align the clips of the front grill with the uppermost mesh of the rear grill.

After the alignment is correct, look from back to front according to the diagram.

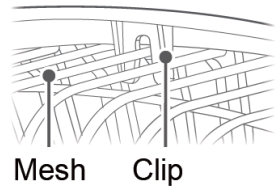
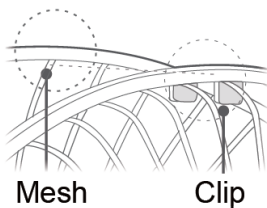

Press the grills in order with both hands. A sound of "click" will be heard when installed right.

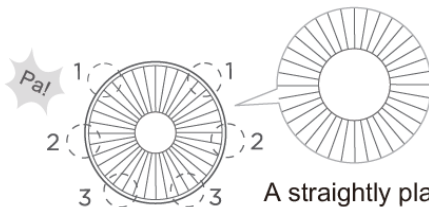

A straightly placed Logo indicates the grills have been correctly aligned.

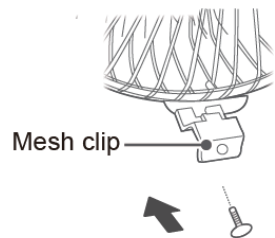

OPERATION INSTRUCTIONS

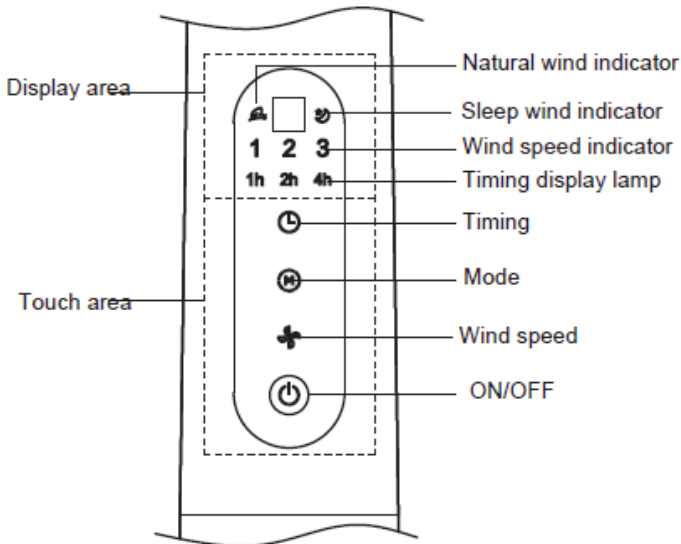
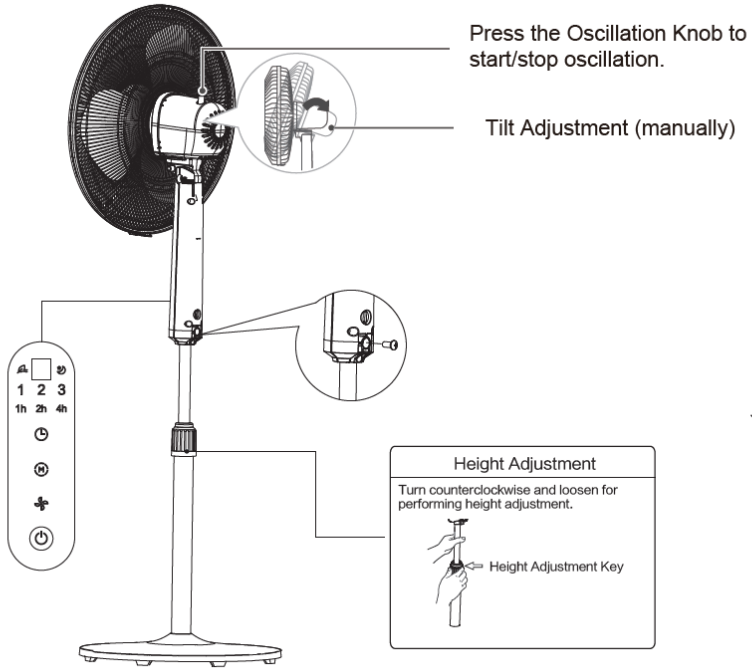

OPERATION INSTRUCTIONS (cont.)

Timer Key

When the Timer Key is touched repeatedly or kept in pressed state, the time to be set for air delivery increases step by step. For instance, if the fan operation is required to be set for 7 hours, this key must be touched repeatedly so that the pilot lamps for 1, 2 and 4 hours lighten together. It means that the set time is $1+2+4 = 7$ hours. The time setting indicated by the pilot lamp will decrease gradually by a unit of 1 hour. Don't press the Timer Key when the fan is required to operate continuously. At the moment all pilot lamps don't light.

Time (H)	lamps
1	1h
2	2h
3	1h/2h
4	4h
5	1h/4h
6	2h/4h
7	1h/2h/4h

Mode Key

Press the Mode Key to select mode. The sequence is normal, natural and sleep when the Mode Key being touched repeatedly or continuously. The light can indicate mode state. It can also be controlled by remote control

Speed Key

Press the “wind” key to select the natural wind, then press the “speed” repeatedly to choose 3 speed.

On/Off Key

The key is for switching on the fan. The fan will be started at low speed. Press the key again, it will be switched off.

OPERATION INSTRUCTIONS (cont.)

Oscillation Control

To make the fan oscillate, press the clutch knob located on the top of the motor housing. To get the directional airflow, pull the clutch knob up to its initial position.

Tilt Adjustment

To adjust the air flow upward or downward, push the grilles lightly to the desired direction.

Height Adjustment

The height of the fan can be adjusted by loosening the height adjustment ring, carefully raising or lowering the fan and firmly re-tightening the height adjustment ring.

Remote Controller (Fig.8)

On/Off Key

The key is for switching on the fan. The fan will be started at low speed. Press the key again, it will be switched off.

Timer Key

When this key is touched repeatedly, the time to be set 1, 2 and 4 hours and the correspond pilot lamp will light. If the lamp doesn't light after you touched the key, the fan will run continuously.

Speed Key

After the fan has started, this key serves as a speed selector in the sequence from “low-medium-high-low” when this key being touched repeated or continuously.

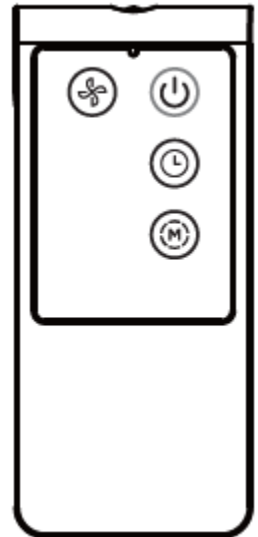

Fig.8

OPERATION INSTRUCTIONS (cont.)



Mode Key

Press the Mode Key to select mode. The sequence is normal, natural and sleep when this M being touched repeatedly or continuously. The light can indicate mode state. It can also be controlled by remote control. The sequence changes from NORMAL-NATURAL-SLEEP-NORMAL wind when this key being touched repeatedly or kept in.

Batteries Instructions

1. Press down on the battery compartment cover and slide it out.
2. Insert the batteries, making sure that the positive terminals are facing the proper way.
3. Replace the cover.

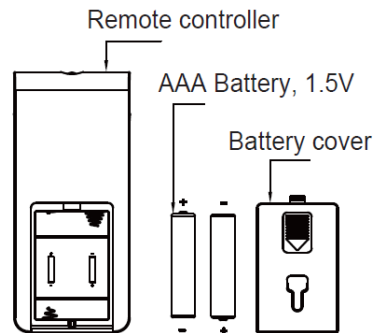

Battery Warnings

1. Do not dispose of batteries in fire as batteries may explode or leak.
2. Do not mix old and new batteries.
3. Do not mix alkaline, standard (carbon-zinc) or rechargeable (nickel-cadmium) batteries.

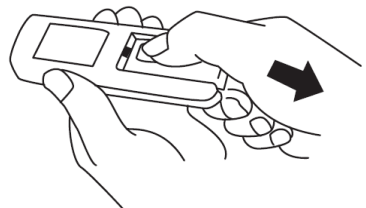
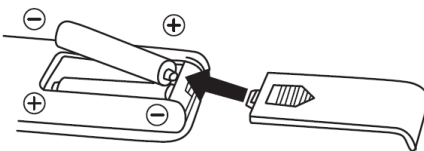

OPERATION INSTRUCTIONS (cont.)

Using the Remote Controller Correctly

Point the remote controller at the receptor on body of the fan and press the desired button. The remote controller will work at distances of up to five meters and the angle of 30 degree included between right and left from the receptor. The batteries must be removed from the remote controller and disposed of safely before disposing of the item.

CLEANING & MAINTANENCE

This fan requires little maintenance. Do not fix it by yourself. Refer it to a qualified service person if service is required.

- Before cleaning and assembling, the fan must be unplugged.
- To ensure adequate air circulation to the motor, keep vents at the rear of the motor free of dust. Do not disassemble the fan to remove dust.
- Please wipe the exterior parts with a soft cloth and a mild detergent.
- Do not use any abrasive detergent or solvents to avoid scratching the surface. Do not use gasoline or thinner as a cleaning agent.
- Do not allow water or any other liquid into the motor housing or interior parts.

CLEANING:

- Ensure to unplug the product from the electrical supply source before cleaning.
- Plastic parts should be cleaned with a soft cloth moistened with mild soap. Thoroughly remove remaining soap with a dry cloth.

SPARE PARTS/REPAIR

We hope our products will last as long as possible to reduce the build-up of electrical waste in the world.

If any consumable parts need replacing, please check our website for stock availability and purchase.

If our website does not have the parts listed, but you still need consumable parts, please contact our customer support to check availability and process your order.

To order replacement parts, please go to www.nettadirect.com/parts.

You will need PDC information from your product, user manual or carton box. Alternatively, go to our website and use search bar to find the parts available.

You can also find this code on the [back of this User Manual](#).

For our Repair Service, please contact our customer support with email on support@nettadirect.com they will provide with more details of repair service with NETTA.

DISPOSAL OF PRODUCT

IMPORTANT INFORMATION FOR THE CORRECT DISPOSAL OF THE PRODUCT IN ACCORDANCE WITH EC DIRECTIVE 2002/96/EC.

DISPOSAL:

Please dispose of this product responsibly. This item cannot be disposed of with general waste. Please contact your local council authority for more information on how to dispose this product. If this product is disposed of with general waste, it will end up in a landfill and will leak hazardous substances into the groundwater – effecting our food chain.



YOUR WARRANTY

If you purchased with NETTADIRECT, or one of our authorised resellers, you will automatically enrol your warranty for 1 (ONE) year. You do not need to register again for your warranty. All warranties will be carried out to our terms and conditions including warranty conditions which you can find out from our website at www.nettdirect.com.

COPYRIGHTS

NETTA and its logo including images and contents in this manual and website is copyrighted. All intellectual property rights belong to NETTA owner CONSUMABLE DIRECT LIMITED.

ANY UNAUTHORISED USE, MODIFICATION or DISTRIBUTION of the NETTA logo, website image, and its contents (from website, manuals) will violate worldwide copyright, trademark and associated laws.

We reserve the right to proceed with lawsuits to anyone who is found breaching our copyrights policy. For more details, please check our website copyright policy for more information.

PRODUCT DEPENDENCY CODE (PDC)

Your PDC is below:

PDC: FS40-21MR
SKU: 104119

NETTA is a registered trademark of CONSUMABLE DIRECT LIMITED.
Product Produced for CONSUMABLE DIRECT LIMITED M30 0QF U.K.