

16" METAL STAND FAN



**RATED
POWER**
50W

**ADJUSTABLE
HEIGHT**

OSCILLATION
60 DEGREES

**SPEED
SETTINGS**
THREE

Thank you for purchasing this NETTA product.

Please read the user manual carefully before operating this appliance.

We will update our instruction manuals if necessary.

For the most up-to-date user manual, please visit our official website:
www.nettdirect.com.

You can download a copy of up to date user manuals at any time in electronic format. We do not supply you with a paper-based user manual after each revision.

Require a larger version of this Instruction Manual?

Please download electronically from our website and use PDF reader on your device to enlarge the text if needed.

www.nettdirect.com

SAFETY & WARNINGS

INTENDED USE

NETTA Design is for domestic and indoor use only. This product is not intended for use by people who have lack of experience and knowledge or have reduced ability, or sensory and metal capabilities. Keep supervised when groups of people use this item.

REGULAR CHECKUPS

Check cables every time before plugging into a socket, make sure power cables are not burst or snapped and that the power-plug has no damage.

GENERAL CAUTIONS

- Use the fan only for the specific purpose outlined in this instruction manual.
- Do not operate fan until fully assembled.
- Ensure the correct voltage is being used prior to plugging in the fan.
- Place the fan on a stable surface to avoid it being tipped over.
- Do not operate the fan directly adjacent to curtains, plants, etc. to avoid accidental entanglement.
- To avoid potential fire hazards, never place your fan or its electrical cord under rugs or carpet.
- Insert and remove the plug from the outlet by grabbing the plug by hand. Do not pull on the cord.
- Never operate the fan near an open flame or in the presence of explosive or combustible gas or fumes.
- Should the fan or electrical cord ever become damaged, discontinue use until a certified repair.
- Do not expose fan to excessive heat or humidity
- Never cover the fan whilst it is working.
- Do not block air inlets or outlets in any manner. Check the openings occasionally to remove dust.
- Do not adjust the fan tilt angle when the fan is moving. Switch the fan off before adjusting.
- Once the fan is assembled, the rotor blade guard should not be removed.

RISK OF PERSONAL INJURY

- To protect against electric shock, do not place fan on windowsill or allow it to come into any contact with water.
- To reduce the risk of shock, this plug is intended to fit the outlet. If the plug does not fit fully in the outlet, contact a qualified electrician.
- Turn off and unplug the fan from the outlet when not in use, when moving the fan from one location to another, and before cleaning.
- Do not operate the fan in the presence of explosives and/or flammable fumes.
- Do not place the fan or any parts near an open flame, cookers, or other heating appliances.
- Do not operate fan with a damaged cord or plug, or if the product malfunctions, or if dropped or damaged in any manner.
- Avoid contact with moving fan parts.
- The use of attachments not recommended by the manufacturer may be hazardous.
- Place the fan on a dry and level surface.
- Do not hang or mount the fan on a wall or ceiling.
- Do not operate if the fan housing is damaged.
- Place the electrical cord away from busy areas to avoid accidental tripping and contact.
- Keep fan out of reach of children and pets.
- Do not expose children or seniors to prolonged periods of direct cold air.
- Never insert fingers, pencils, or any other objects through the grill when the fan is running.
- Do not use the fan near windows as rain may create an electrical hazard.
- This product is for indoor, household use only.

COMPONENTS

1. Front Grill
2. Securing Screw
3. Fan Blade
4. Screw for Fan Blade
5. Securing Screw for Rear Grill
6. Rear Grill
7. Handle
8. Motor Shaft
9. Speed Control Knob
10. Oscillation Knob
11. Motor Housing
12. Fan Head Neck
13. Telescopic Rod
14. Adjustable Height Knob
15. Stand Feet
16. Round Base
17. Stand Feet Weight
18. Washer
19. Locking Lever

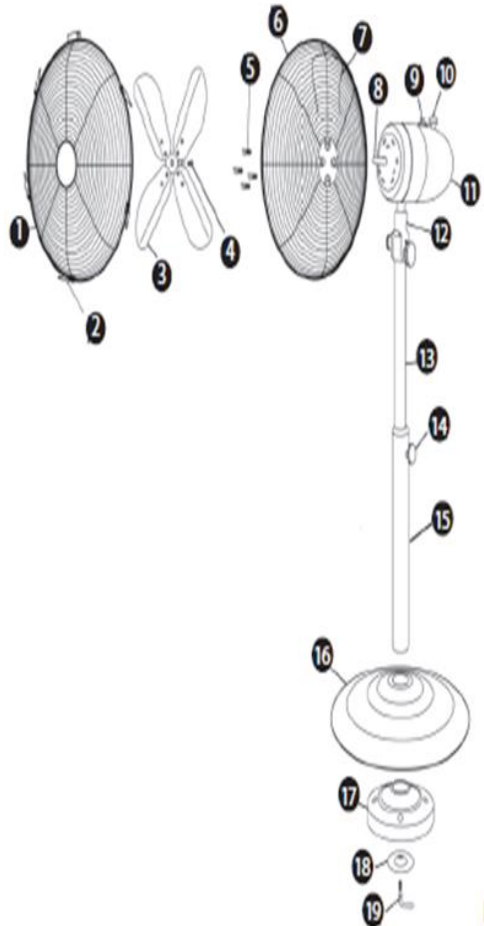

Fig (1)

A SCREWDRIVER IS NEEDED TO ASSEMBLE THIS FAN

ASSEMBLY

Assembly of telescopic rod holder with stand feet.

1. Turn the **locking level (19)** from the base of the **stand feet (15)**.
2. Insert the lower end of the **stand feet** into the **round base (16)**.
3. Place the **stand feet weight (17)** under the **round base** and connect all the parts with the **washer (18)** and the **locking lever**.
4. Make sure that all the parts are connected to each other.
5. Loosen the **adjustable height knob (14)** to adjust the **telescopic rod (13)**.
6. Pull the **telescopic rod** until it stops and tighten the **adjustable height knob** firmly.

ATTENTION! The adjustable height knob must be fully fastened before starting the assembly of the motor section with the stand.

Assembly of motor housing with telescopic rod holder.

20. Adjusting Screw
21. Setting Screw
22. Holding Fixture
23. Lock Nut for Mounting Screw
24. Mounting Screw

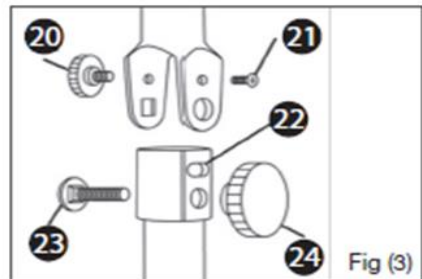

1. Place the **motor housing (11)** on the upper end of the **telescopic rod (13)** and fix the **motor housing** to the **telescopic rod** with the **mounting screw (23)** and the **lock nut (24)** and with the **setting screw (21)** and the **adjusting screw (20)**.
2. The position of the fan head can be changed by loosening the **setting screw (21)** and then fixing again.

Check for a firm and proper fixing.

Before starting this assembly, please check whether there is a protective plastic sleeve on the **motor shaft (8)**. Should it be present, remove it by pulling it forward.

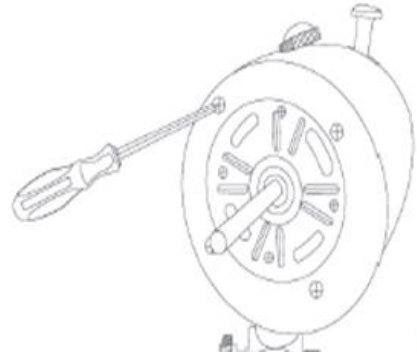

Fig (2)

1. Loosen the four screws from the front of the **motor housing (11)** with a screwdriver (Fig. 2)
2. Place the **rear grill (6)** on the **motor shaft (8)** and fasten the **rear grill** onto the motor with four screws.
3. Make sure the **rear grill** fits securely against the **motor housing** and that the **handle (7)** is at the top.
4. Loosen the **securing screw (4)** on the **fan blade (3)**. Slide the **fan blade** onto the **motor shaft (8)** with the shaft sleeve facing the motor.
5. Align the **securing screw** with the flat groove in the **motor shaft** and tighten with a screwdriver.
6. Ensure the **fan blade (3)** is fixed on the **motor shaft (8)**.
7. Remove the small **securing screw** from the **front grill**. Open the grill clamps on the **front grill (1)** and set the **front grill** with the fixed holder of the **rear grill (6)**. Mount the **front grill** to the **rear grill** and fix both grilles with the clamps. Use a screwdriver for fixing the screw and nut (Fig. 4).

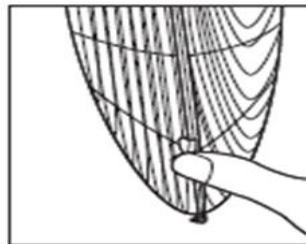
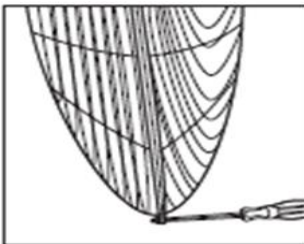

Fig (4)

OPERATION

- Ensure the fan is always placed on a flat and stable surface when in use.
- Plug the appliance into the mains.
- Press the control panel to:

Position 0 = Off

Position 1 = Minimum Speed

Position 2 = Medium Speed

Position 3 = Maximum Speed

Oscillation

Push and pull the **oscillating control knob (10)** to switch between having the function on or off.

Adjustments

- To adjust the angle of the fan head, loosen the **setting screw (20)** and move the fan head to the desired angle. Firmly tighten the knob to secure into place.
- The height of the fan can be adjusted by loosening the **height adjustment knob**.

Switch the Fan Off

- The fan is ready to operate if connected to the mains supply and plugged in.
- To completely switch the fan off, turn the rotary knob to 0 and pull the power plug from the socket.
- Always disconnect the mains plug from the socket outlet when the fan is not in use.

CLEANING & MAINTANENCE

This fan requires little maintenance. Do not fix it by yourself. Refer it to a qualified service person if service is required.

- Before cleaning and assembling, the fan must be unplugged.
- To ensure adequate air circulation to the motor, keep vents at the rear of the motor free of dust. Do not disassemble the fan to remove dust.
- Use a dry cloth to remove dust and fluff
- Do not use any abrasive detergent or solvents to avoid scratching the surface. Do not use gasoline or thinner as a cleaning agent.
- Do not allow water or any other liquid into the motor housing or interior parts.

CLEANING:

- Ensure to unplug the product from the electrical supply source before cleaning.
- Plastic parts should be cleaned with a soft cloth moistened with mild soap. Thoroughly remove remaining soap with a dry cloth.

SPARE PARTS/REPAIR

We hope our products will last as long as possible to reduce the build-up of electrical waste in the world.

If any consumable parts need replacing, please check our website for stock availability and purchase.

If our website does not have the parts listed, but you still need consumable parts, please contact our customer support to check availability and process your order.

To order replacement parts, please go to www.nettdirect.com/parts.

You will need PDC information from your product, user manual or carton box. Alternatively, go to our website and use search bar to find the parts available.

You can also find this code on the [back of this User Manual](#).

For our Repair Service, please contact our customer support with email on support@nettdirect.com they will provide with more details of repair service with NETTA.

DISPOSAL OF PRODUCT

IMPORTANT INFORMATION FOR CORRECT DISPOSAL OF THE PRODUCT IN ACCORDANCE WITH EC DIRECTIVE 2002/96/EC.

DISPOSAL:

Please dispose of this product responsibly. This item cannot be disposed of with general waste. Please contact your local council authority for more information on how to dispose this product. If this product is disposed of with general waste, it will end up in a landfill and will leak hazardous substances into the groundwater – effecting our food chain.



YOUR WARRANTY

If you purchased with NETTADIRECT, or one of our authorised resellers, you will automatically enrol your warranty for 1 (ONE) year. You do not need to register again for your warranty. All warranties will be carried out to our terms and conditions including warranty conditions you can find out from our website at www.nettdirect.com.

COPYRIGHTS

NETTA and its logo including images and contents in this manual and website is copyrighted. All intellectual property rights belong to NETTA owner CONSUMABLE DIRECT LIMITED.

ANY UNAUTHORISED USE, MODIFICATION or DISTRIBUTION of the NETTA logo, website image, and its contents (from website, manuals) will violate worldwide copyright, trademark, and associated laws.

We reserve the right to proceed with lawsuits to anyone who is found breaching our copyrights policy. For more details, please check our website copyright policy for more information.

PRODUCT DEPENDENCY CODE (PDC)

Your PDC is below:

PDC: FE-45F
SKU: 103772

NETTA is a registered trademark of CONSUMABLE DIRECT LIMITED.
Product Produced for CONSUMABLE DIRECT LIMITED M30 0QF U.K.