

TableBed | ASSEMBLY MANUAL

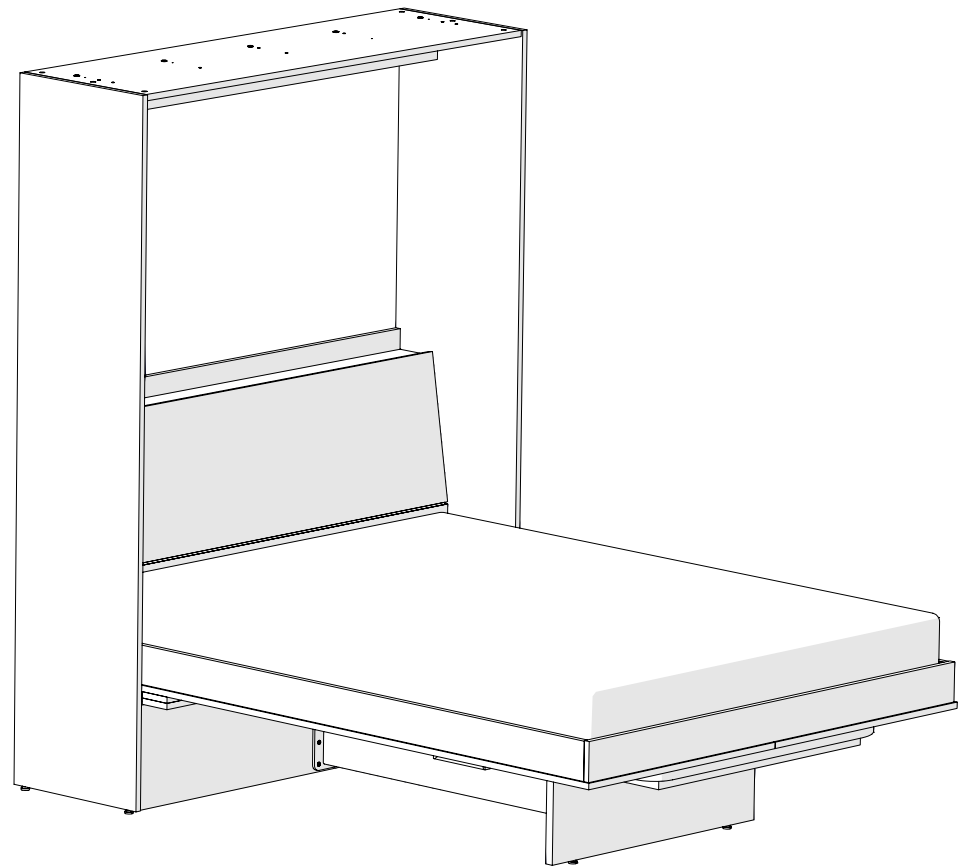

TABLEBED

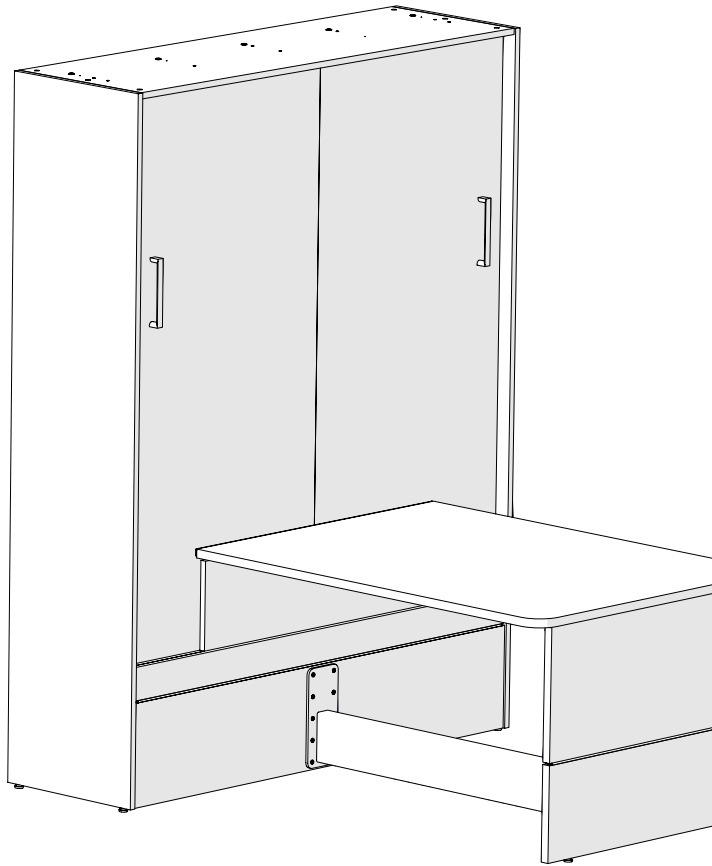

QUICK START GUIDE

TableBed | ASSEMBLY MANUAL

QUICK START GUIDE

HELPFUL INFORMATION

- Prior to opening your shipment, check and confirm the room is completely ready to receive the furniture (see “Room Readiness Checklist” below).
- Place the parts in the room according to the sequence of the assembly steps to avoid double handling
- The Hardware Box is located on the pallet and labeled “Hardware”
- Hardware is packed by STEP #, not PART #
- A large, contractor’s garbage bag is included the Hardware Box for trash removal
- All parts are labeled for easy identification
- Labels will not be seen once the Bed is completely assembled; the part label is a sticker and can be removed if desired.
- Each page of the assembly includes a “QR Code”, which is linked to a video for each step. To view, download a compatible QR Code App to view videos or go directly to YouTube (include link).

QUICK START GUIDE (CONT.)

ROOM READINESS CHECKLIST

- Check room to confirm the ceiling, floor, and walls in the room are finished and completed
- Select the wall and location in which the Bed will be placed
- Measure the length of the wall and height of ceiling to confirm the Bed will fit

TIP: You may want to remove existing baseboard that is located on the wall where

the Bed will be installed. By removing the baseboard, it will allow for a tighter fit against the wall (custom units may already have a notch for baseboard – see shop drawings, if applicable).

- Locate any electrical outlets on the wall that may be covered up by the Bed
- Clear out any items in the room so you have a clear path to the wall and an open area to assemble the Bed
- If the flooring is hard, lay down some furniture blankets, sheets of cardboard, or other

cushioning material to prevent parts from being scratched.

- Locate the mattress that will be used with this Bed; the specific mattress is required for proper adjustment of the Bed and completion of the assembly

QUICK START GUIDE (CONT.)

TOOLS NEEDED:

Electric Power Drill
#2 Phillips Bit
#3 Phillips Bit (provided)
#2 Square Bit (provided)
4mm Allen Wrench (provided)
4mm Allen Bit (provided)
9/16" Wrench
#2 Phillips Screwdriver
Hammer
Pliers
Utility Knife
Vise Grips
Flashlight
QR Code Scanner App
(To view videos)

HARDWARE LIST:

Bolts:

H-020 Panel Bolts, 25 mm
H-021 Panel Bolts, 40 mm
H-287 Pan Head Machine Bolts

Screws:

H-014s Euro Screws
H-019 Machine Screws
H-039 Wood Screws
H-065 Panel Screws
H-087 Pan Head Screws, 5/8"
H-107s Flat Head Euro Screws

H-425 Machine Screws

Other:

H-003 Wood Dowels
H-008 Leveler Feet
H-011 Minifix Pins
H-035 Clevis Pin
H-077 Wide Angle Brackets
H-085 Mending Plates
H-928 Cotter Pin
M-36 Cam Roller
Headboard Guides

HOW IT WORKS

TableBed | ASSEMBLY MANUAL

HOW IT WORKS

HOW IT MOVES UP AND DOWN:

The mechanism that allows the TableBed to move up and down is spring-loaded and located inside the FootRest.

As the TableBed is lowered down, gravity is naturally starting to pull it down. The springs “kick in” and provide enough resistance to avoid it from coming down too quickly.

As the TableBed is raised upward, gravity is resisting, To make it easier to lift, the springs

releases tension, assisting the bed as it is raised.

TO LOWER THE TABLEBED:

Handles are located on the outside of the Bed Cabinet (on the Bed Panels) for use to lower the Bed.

TO RAISE THE TABLEBED:

At the corner of the bed platform, place hands underneath and lift. Start walking toward the bed cabinet to close. Once at half-way, grab a handle and guide into the cabinet.

HOW IT WORKS (CONT.)

HOW TO ADJUST TENSION:

To adjust the tension of the TableBed:

Locate the two Bolts underneath the FootRest.

The ideal adjustment is to have as much tension as possible, so the bed is easy to raise and lower, but not so much that it “floats” up after it is lowered.

STEPS FOR ADJUSTMENT:

1. Place TableBed in Up Position
(so there is no tension when you are working)
2. Loosen the two 3/8” Bolts under the FootRest
3. To INCREASE tension: slide the bolts toward the TableLeg (away from TableBed) and tighten.
4. To DECREASE tension: slide the bolts away from the TableLeg (toward the TableBed) and tighten.

TableBed: Hardware Overview

The illustrations drawn are general representations of your product's hardware.

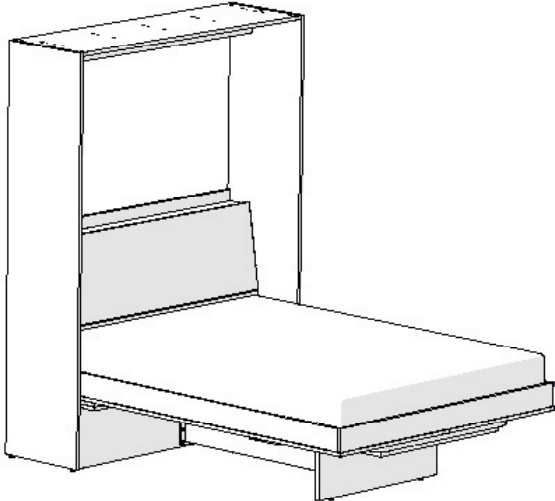
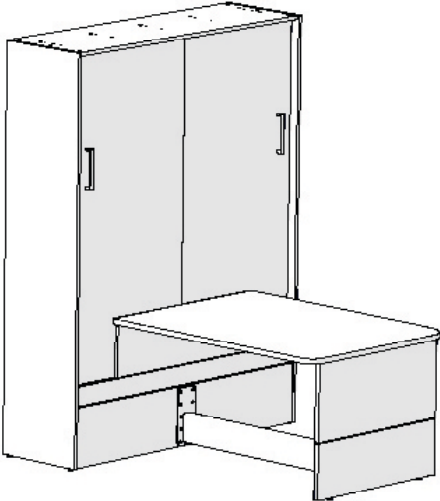

H-003



H-008

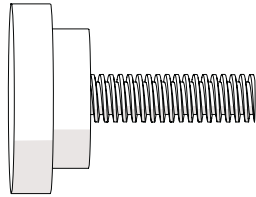

H-011

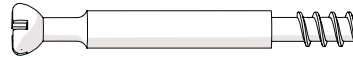

H-014s

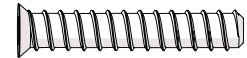

H-019

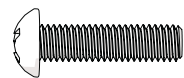

H-020

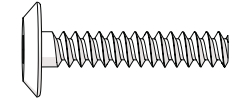

H-021

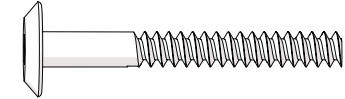

H-035

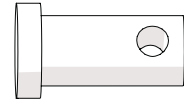

H-039

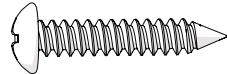

H-287

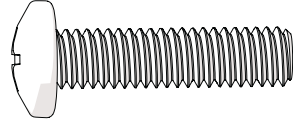

H-065

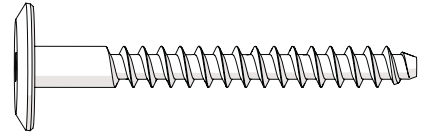

H-077

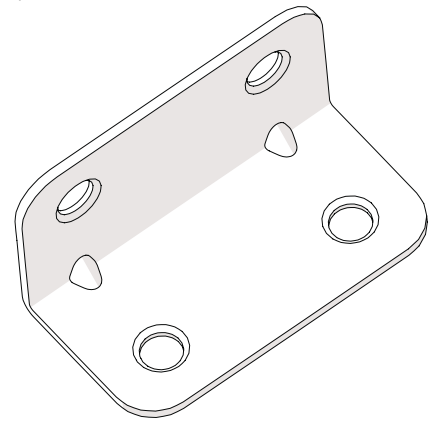

H-060

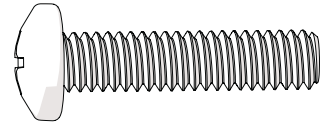

TableBed: Hardware Overview, cont.

The illustrations drawn are general representations of your product's hardware.

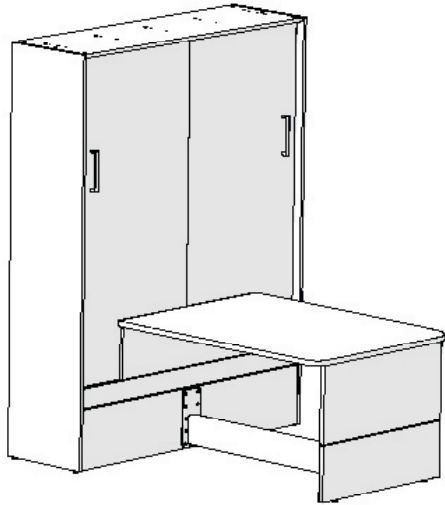

H-085

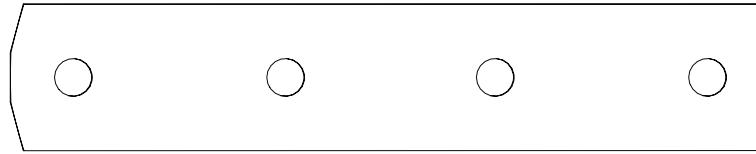

H-087

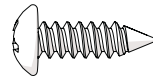

H-107s

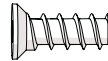

H-425



H-928

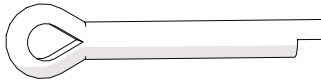

M-36

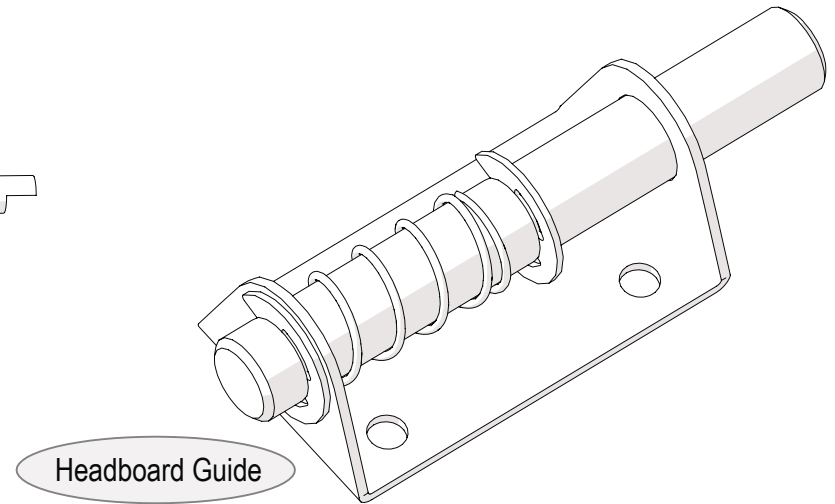
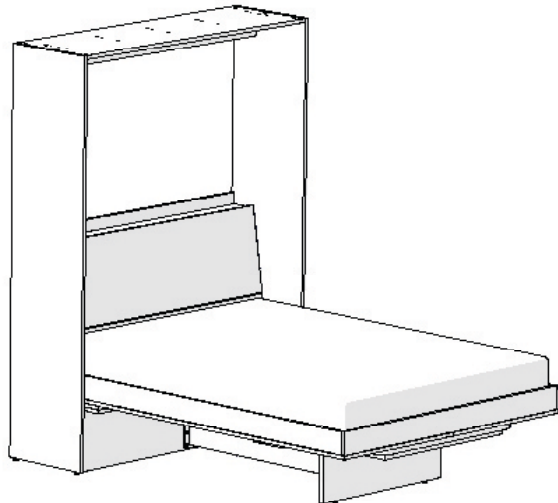
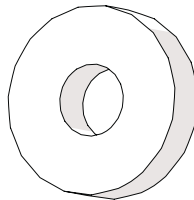

Headboard Guide

TableBed: Part Overview

The illustrations drawn are general representations of your product's parts.

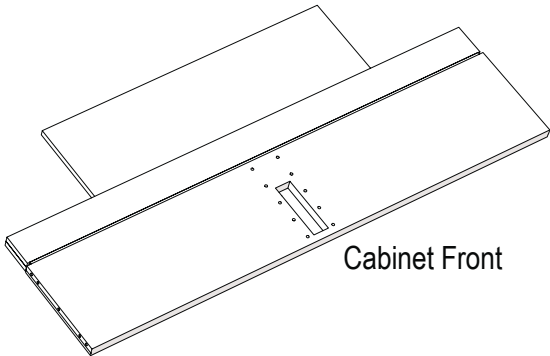
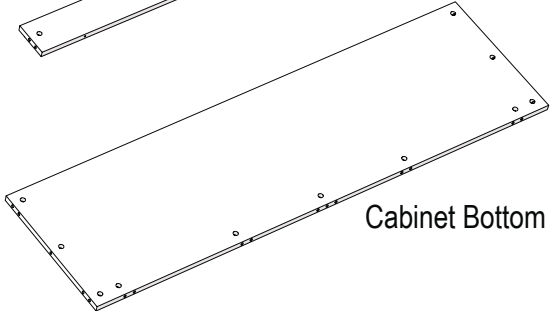
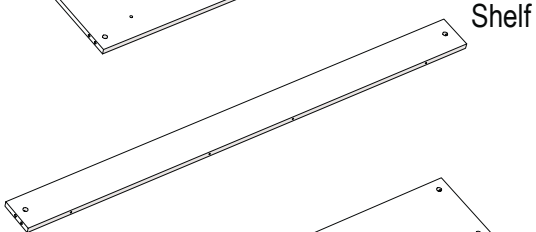
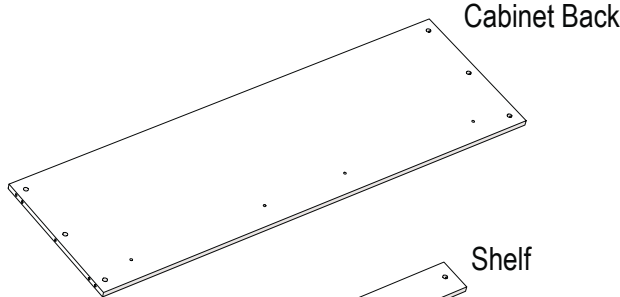
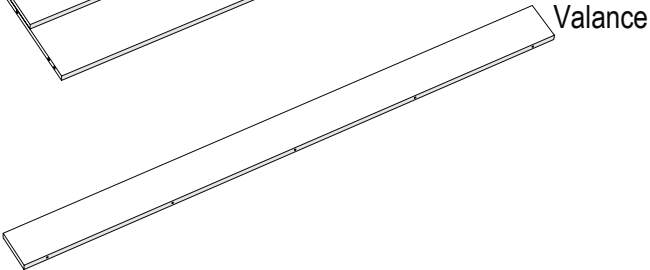
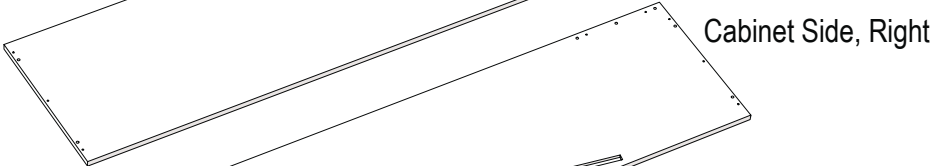
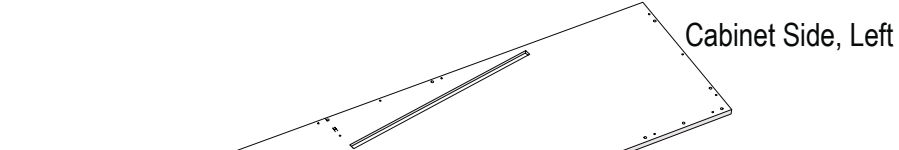

TableBed: Part Overview, cont.

The illustrations drawn are general representations of your product's parts.

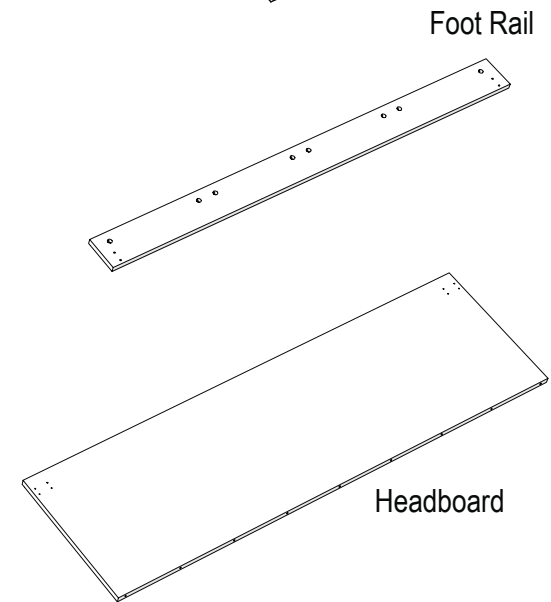
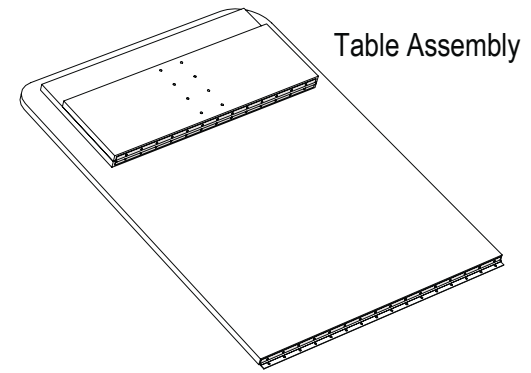
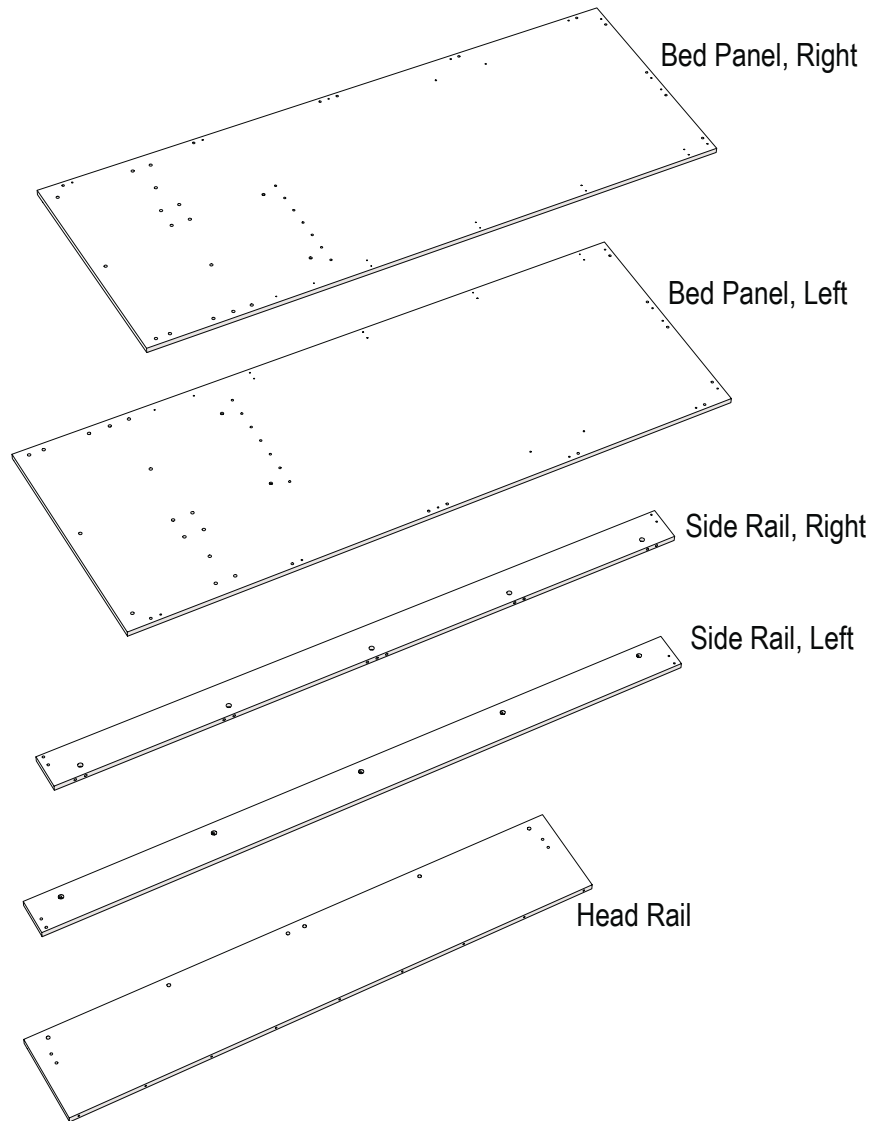

TableBed: Part Overview, cont.

The illustrations drawn are general representations of your product's parts.

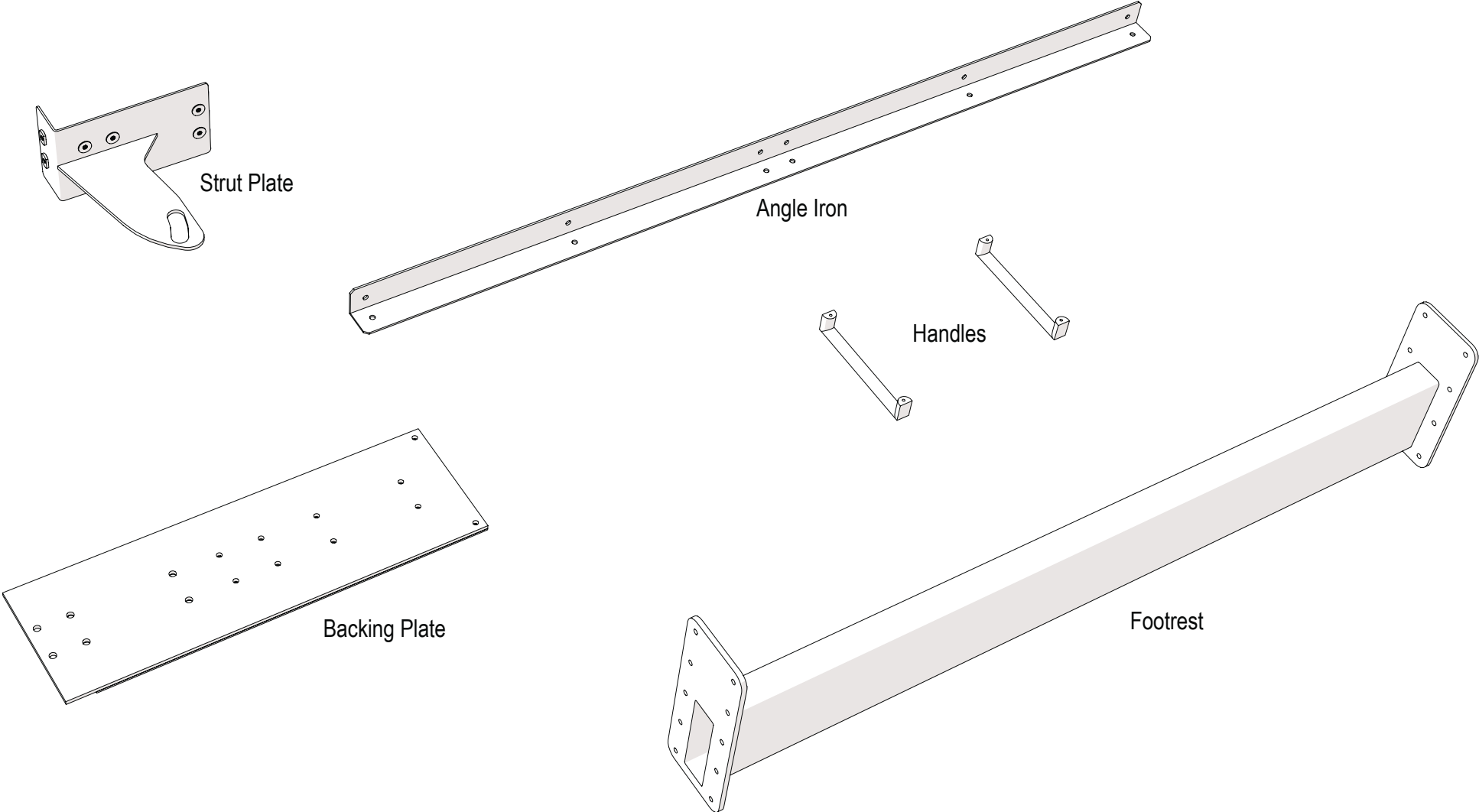

STEP 1: Prepare Right Cabinet Side

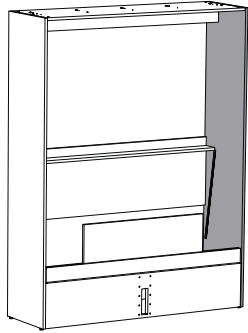

- A.** Lay the Right Cabinet Side on the floor as shown.
- B.** Screw the H-011 Minifix Pins into the small holes.
- C.** Tap the H-003 Wood Dowels into the larger holes.
- D.** Screw the H-008 Leveler Feet into the bottom edge of the Cabinet Side.

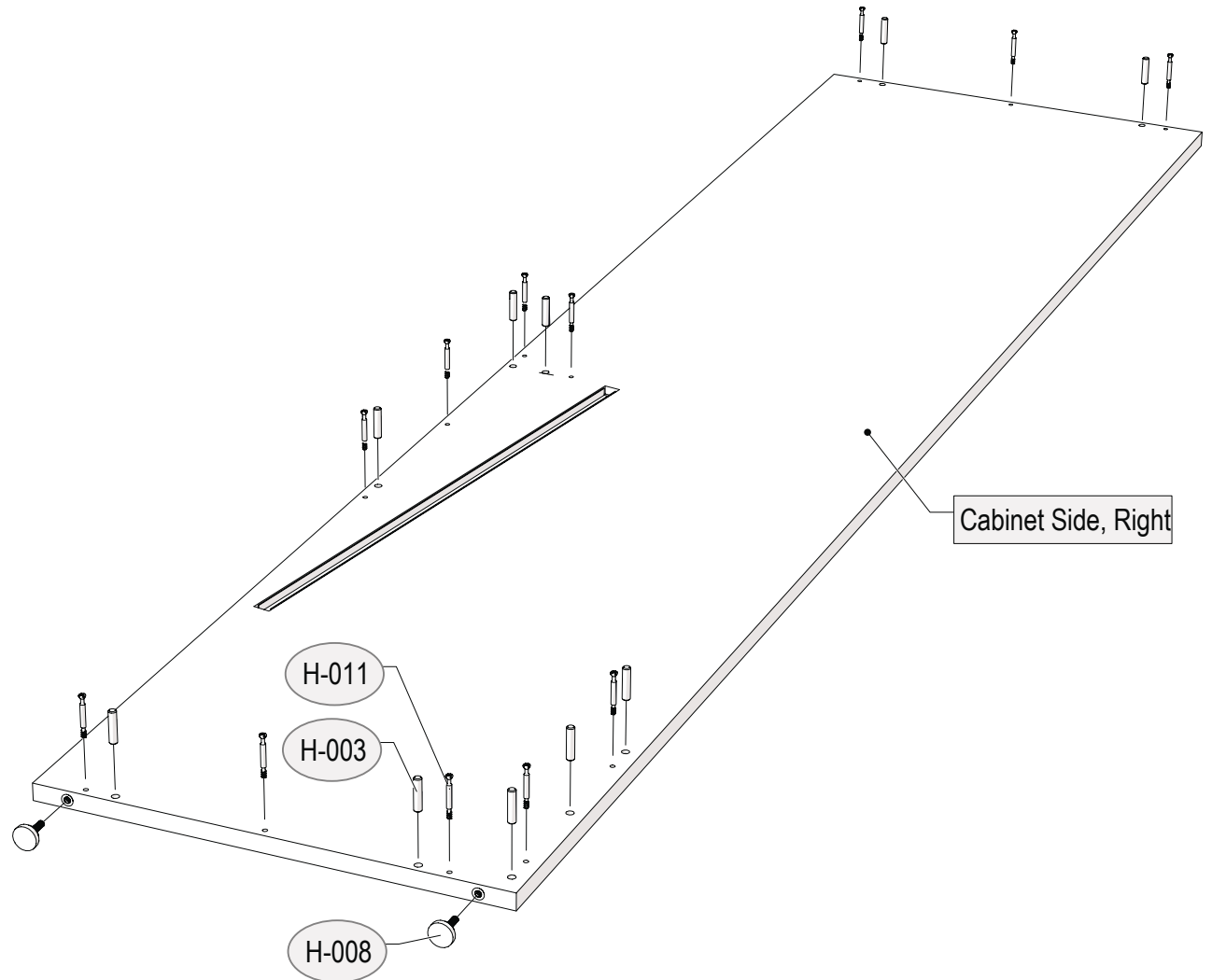

Scan this QR Code to watch this Step's video tutorial.

STEP 2: Attach Cabinet Front to Cabinet Bottom

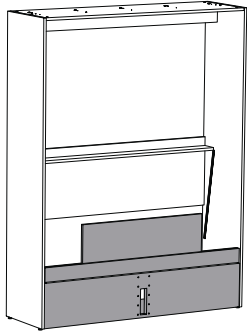

A. Lay the Cabinet Front on the floor and screw the H-011 Minifix Pins into the small holes of the Cabinet Front. Tap the H-003 Wood Dowels into the larger holes of the Cabinet Front.

B. Prepare to attach Cabinet Bottom to Cabinet Front.

C. Make sure all the Minifix Cams in the Cabinet Bottom have their arrows pointing towards the outside edge of the panel to allow the pins to slide into the Cams, as shown.

D. Slide the Cabinet Bottom onto the Minifix Pins and Wood Dowels in the Cabinet Front, then tighten the Minifix Cams in the Cabinet Bottom.

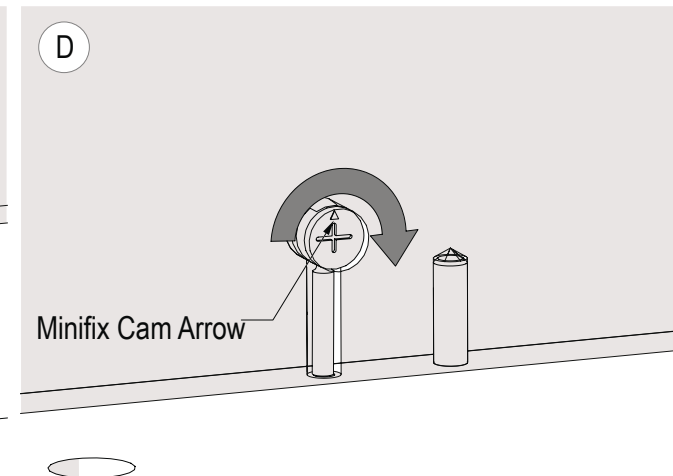
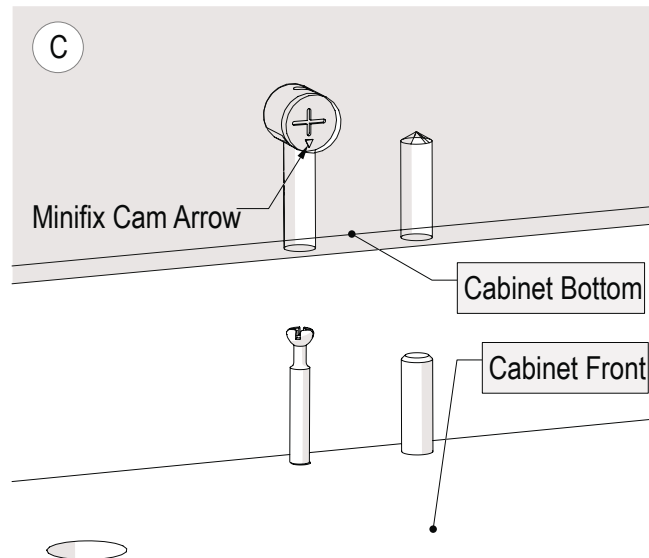
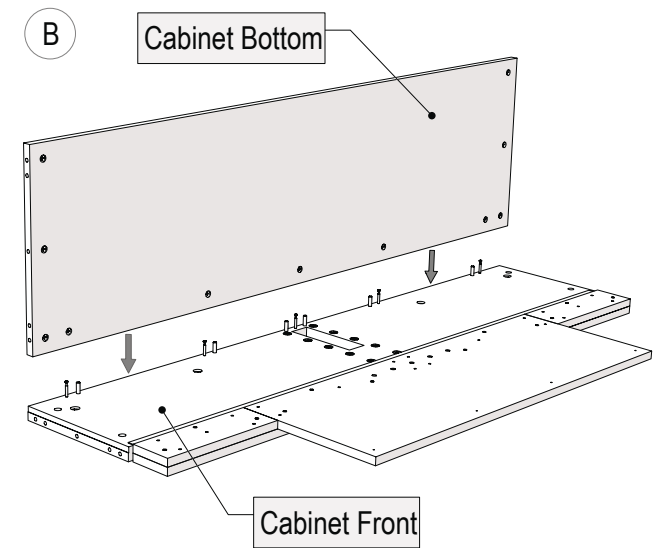
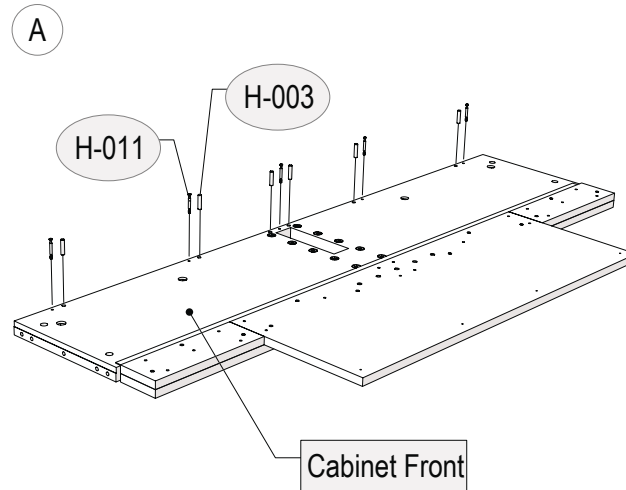

Scan this QR Code to watch this Step's video tutorial.

STEP 3: Attach Valance to Cabinet Top & Attach Shelf to Cabinet Back

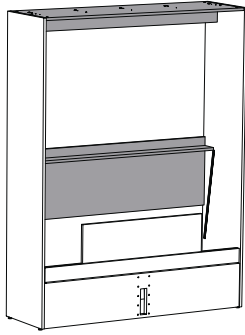

A. Hold the Valance next to the Cabinet Top.

B. Screw the Valance to the Cabinet Top with H-065 Panel Screws using a 4mm Allen Wrench.

C. Hold the Shelf next to the Cabinet Back.

D. Screw the Shelf to the Cabinet Back using H-065 Panel Screws using a 4mm Allen Wrench.

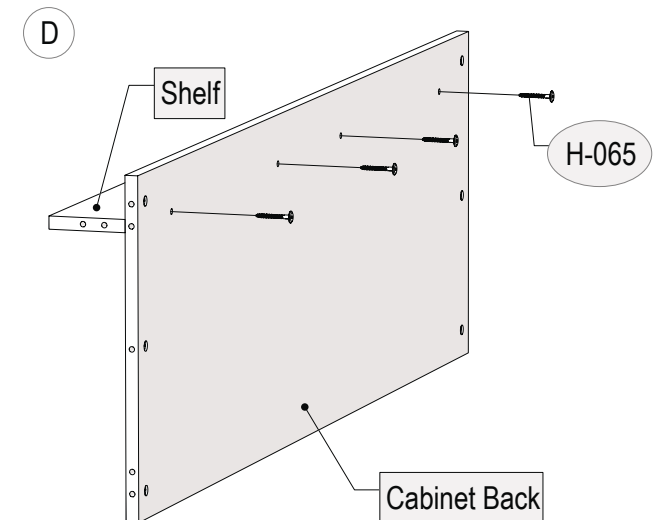
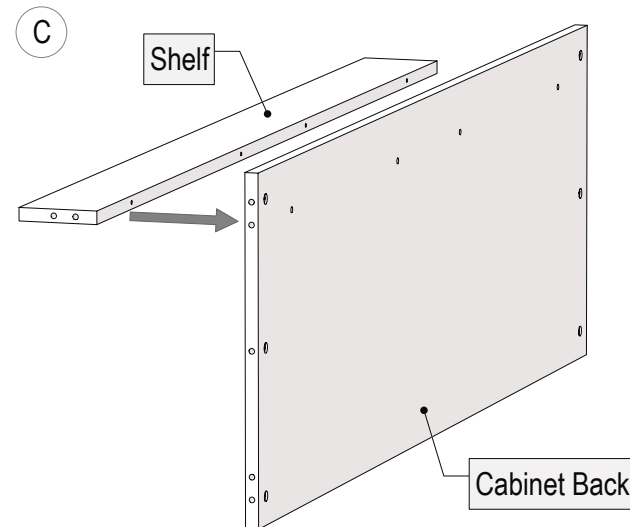
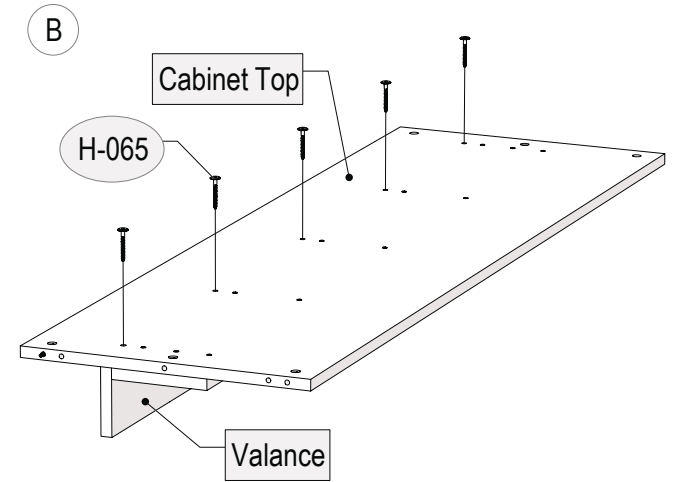
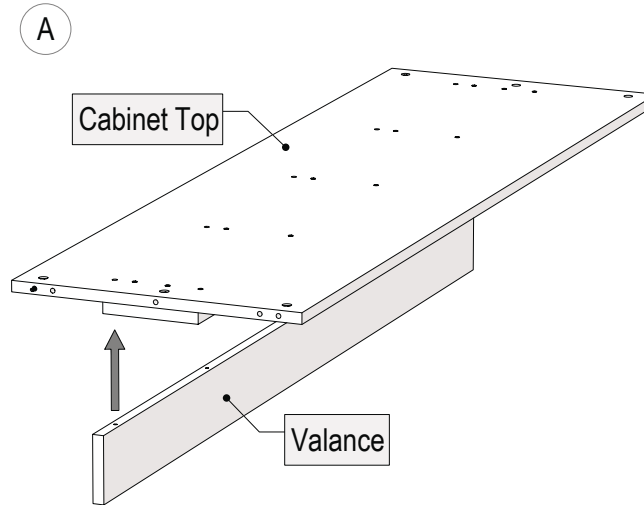

Scan this QR Code to watch this Step's video tutorial.

STEP 4: Attach Bottom Assembly, Cabinet Top & Cabinet Back to Right Cabinet Side

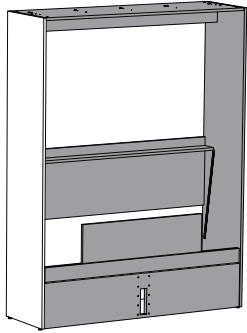

- A.** Lay the Right Cabinet Side from Step 1 on the floor as shown, using padding to protect it from getting scratched.
- B.** Slide the Cabinet Front/Bottom Assembly onto the fittings in the Right Cabinet Side and tighten the Minifix Cams.
- C.** Slide the Cabinet Back/Shelf Assembly onto the fittings in the Right Cabinet Side and tighten the Minifix Cams.
- D.** Slide the Cabinet Top Assembly onto the fittings in the Right Cabinet Side and tighten the Minifix Cams.

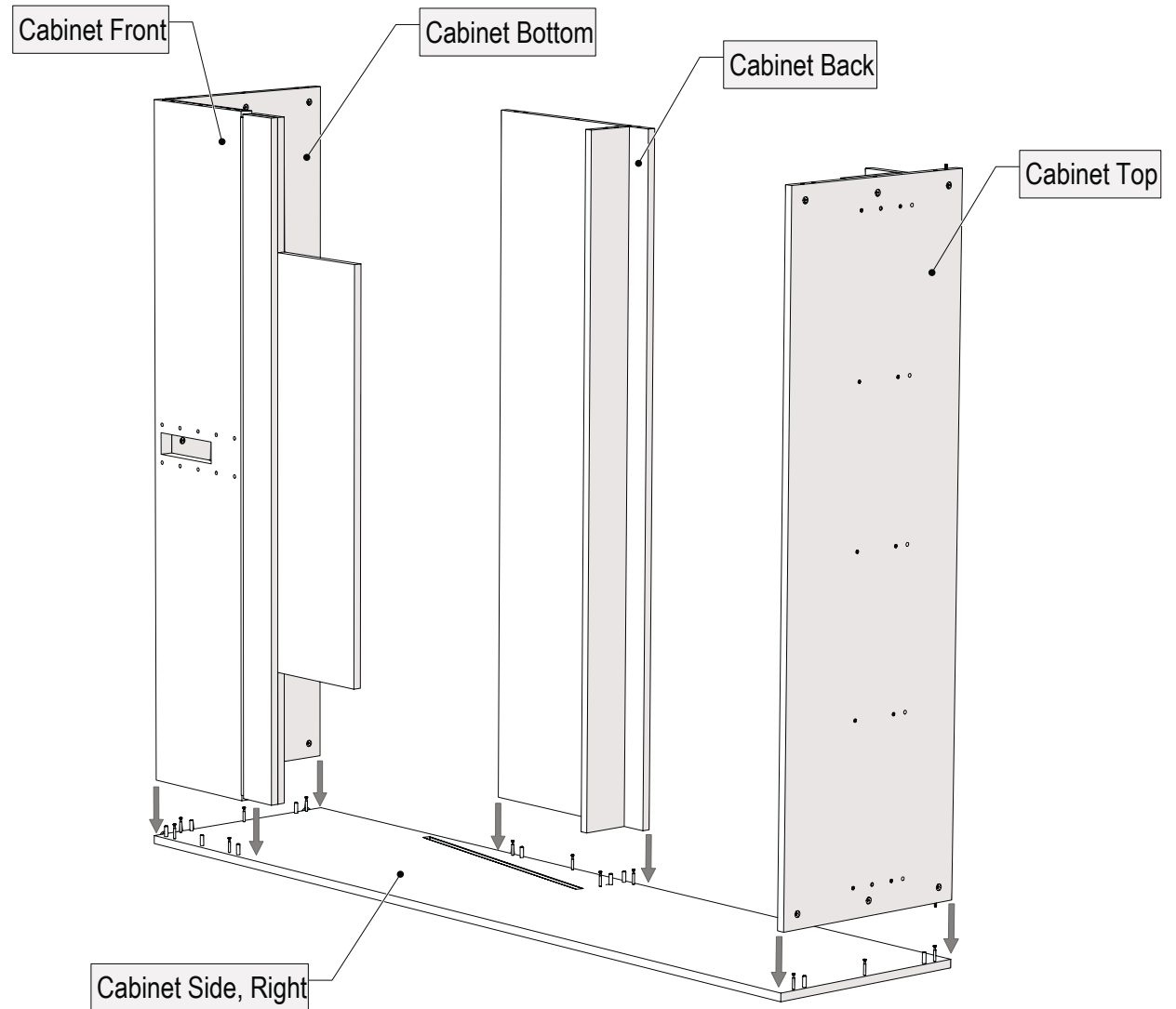

Scan this QR Code to watch this Step's video tutorial.

STEP 5: Prepare Left Cabinet Side

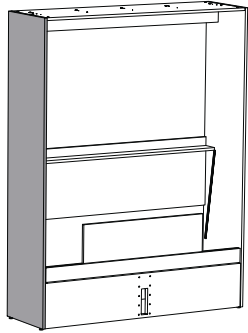

- A.** Lay the Left Cabinet Side on the floor as shown.
- B.** Screw the H-011 Minifix Pins into the small holes.
- C.** Tap the H-003 Wood Dowels into the larger holes.
- D.** Screw the H-008 Leveler Feet into the bottom edge of the Cabinet Side.

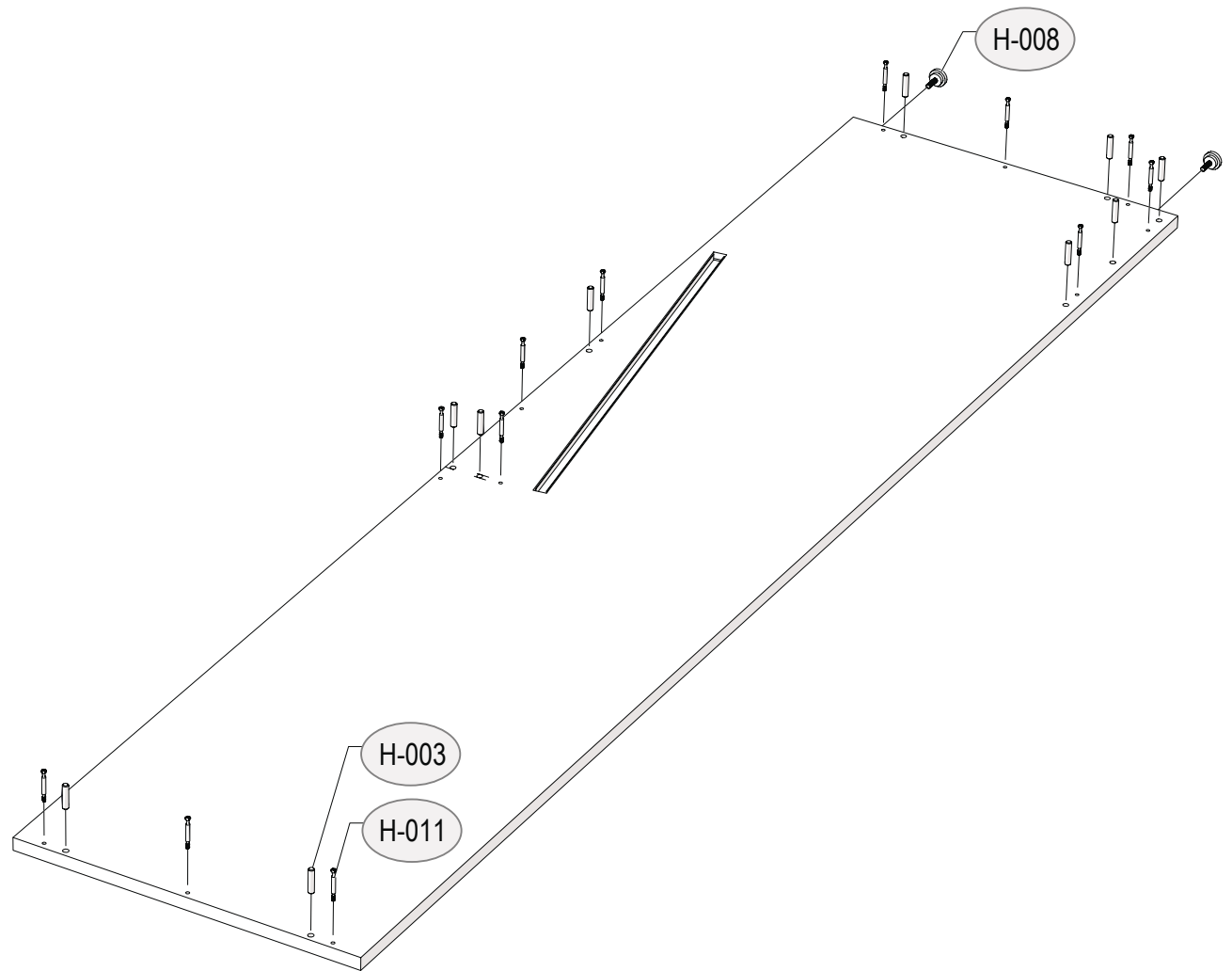

Scan this QR Code to watch this Step's video tutorial.

STEP 6: Attach Left Cabinet Side to the Cabinet Assembly

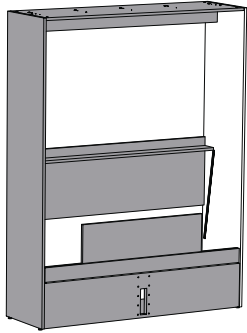

- A.** Make sure all the Minifix Cams have their arrows pointing to the nearest edge of the panels.
- B.** Lift the Left Cabinet Side, flip it over, and place it on the partly assembled cabinet as shown. You may need to shift the parts slightly to get the dowels and pins to line up with the holes.
- C.** Tighten all the Minifix Cams as in Step 4.
- D.** The Bed Cabinet is now complete and ready to stand up.

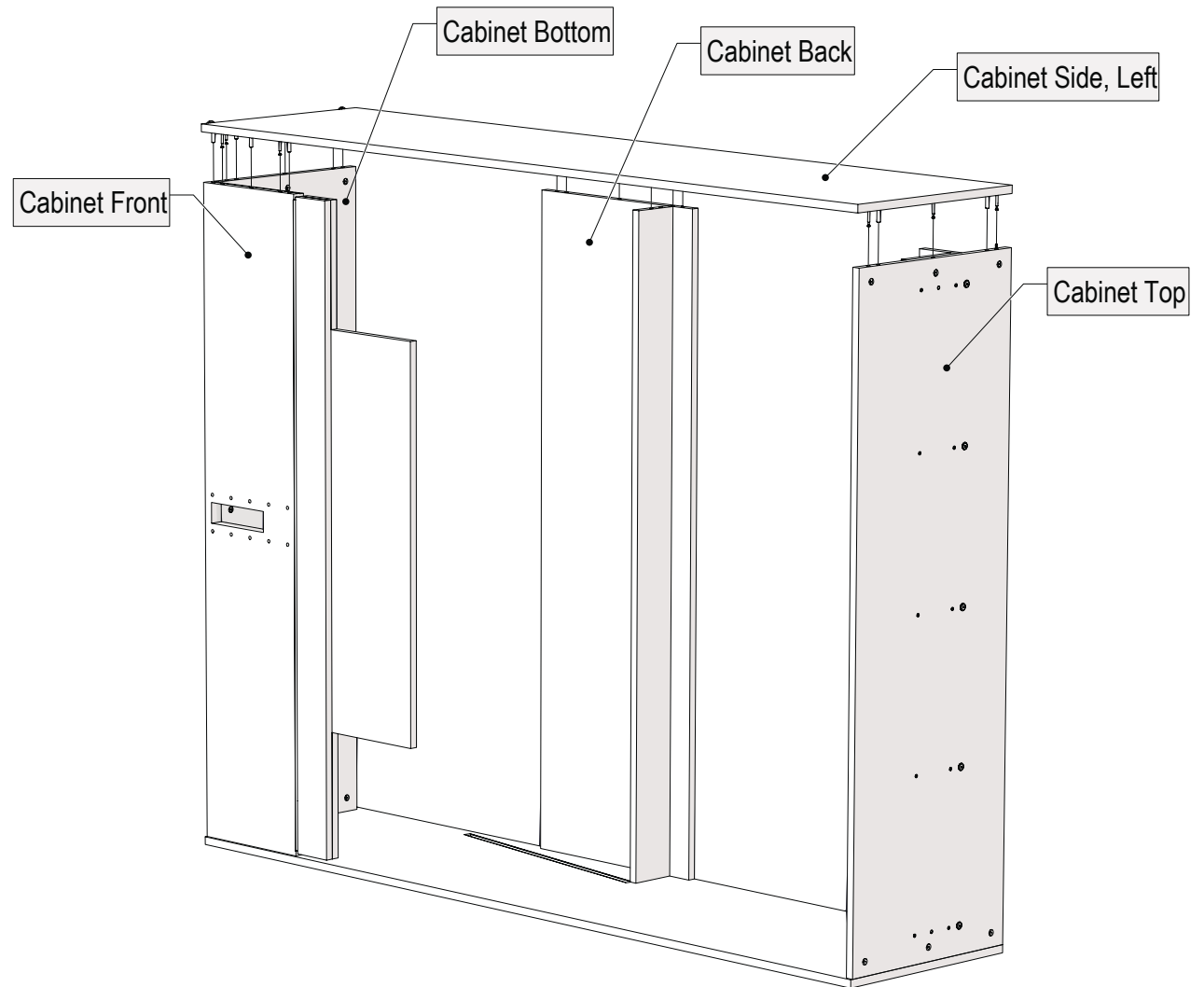

Scan this QR Code to watch this Step's video tutorial.

STEP 7: Lay the Cabinet Over on its Back and then Stand it Up

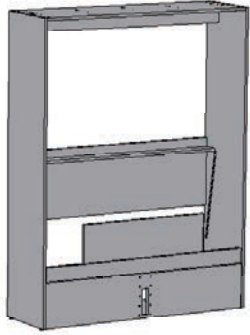

A. It is recommended this step is done by two people for safety. Carefully lay the Cabinet over as shown, using padding on the floor to protect the cabinet from being scratched. Guide the Flipper as the Cabinet is lowered.

B. Raise the Cabinet as shown. The Flipper will naturally trail along with the Cabinet. Make sure the Flipper does not pivot and fall down when the Cabinet gets to its standing position.

C. Carefully “walk” the standing Cabinet so that it is about two feet from the wall where it will be placed when it is finished. Guide the Flipper as it remains in its vertical position.

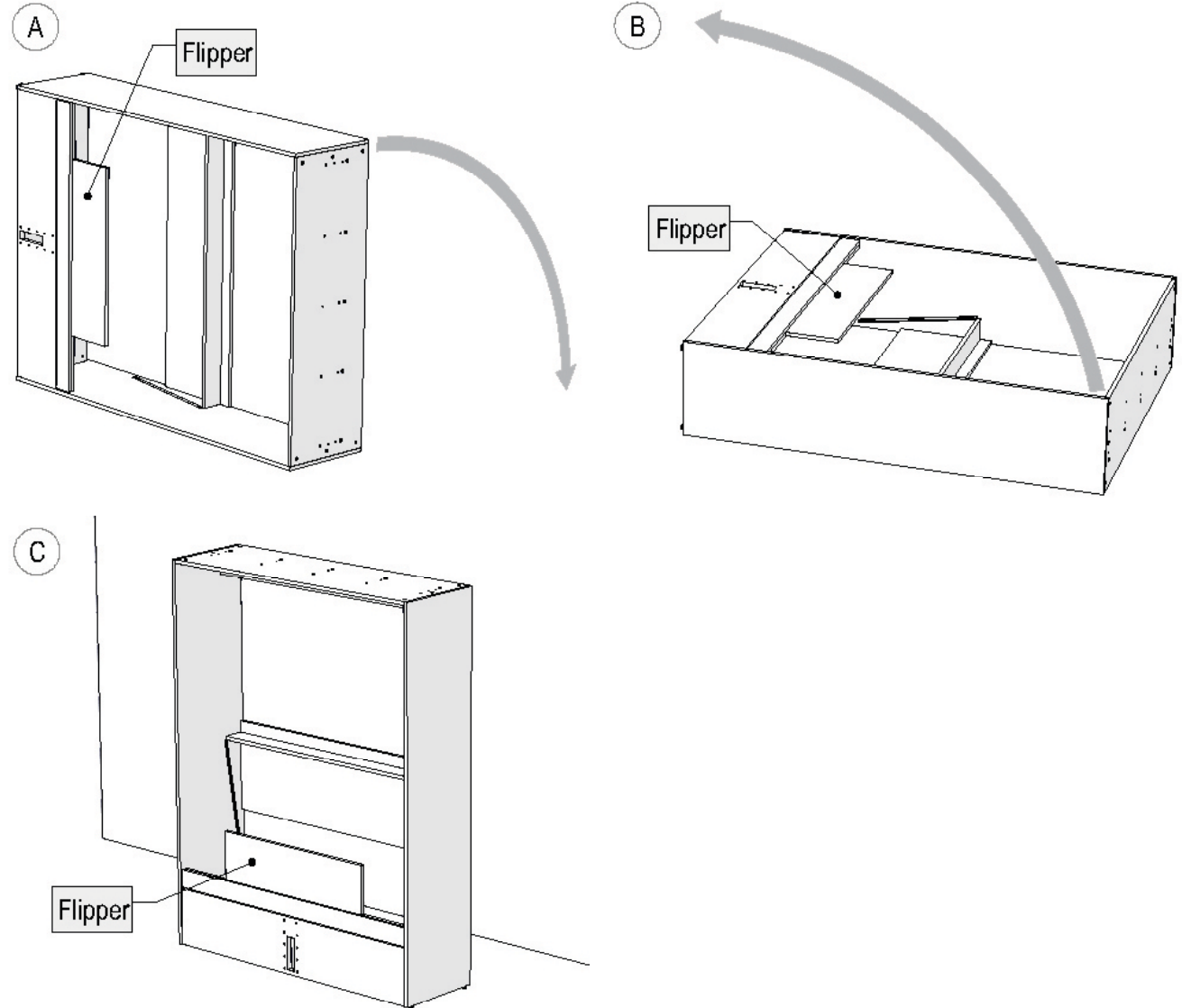

Scan this QR Code to watch this Step's video tutorial.

Anti-tip Strap Wall Attachment

A. Move the bed cabinet against the wall, where its final position will be in the room.

B. Locate the studs in the wall. Attach The H-508 Cable and bracket assembly to the wall, using the H-016 drywall screws. Ensure the screws go into wall studs.

C. Attach the other brackets to the bed cabinet using H-087 screws. In line with the wall mounted brackets, and close enough so that the cable loop will be able to connect to both the wall brackets and bed cabinet brackets.

D. With the brackets securely mounted to both the bed cabinet and the wall. Disconnect the cable loops and slide the bed cabinet forward a minimum of 2' away from the wall and resume build up.

E. Once the unit is fully built up, it can be put back into place and the cable loops can be reengaged.

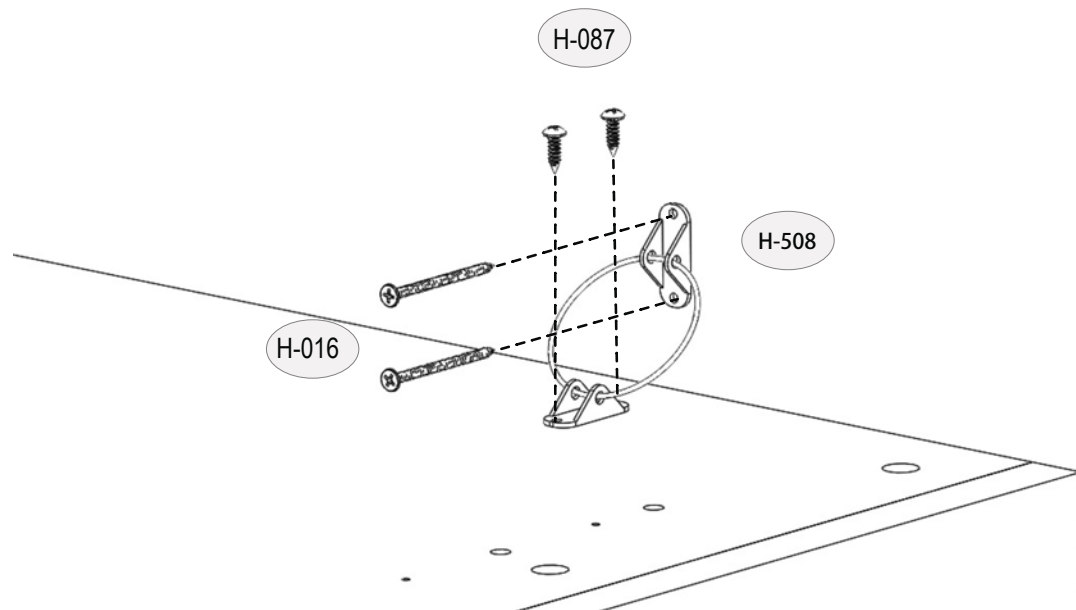
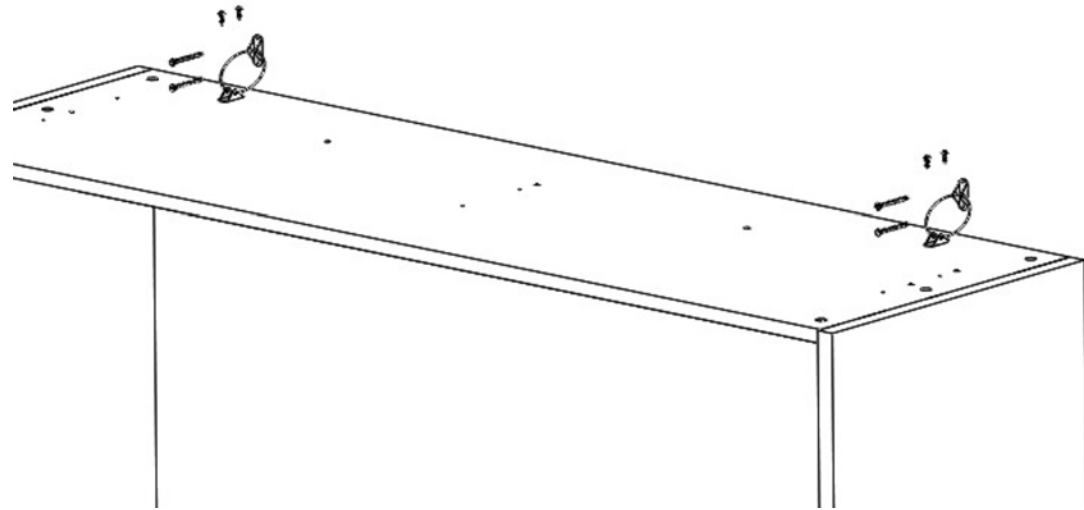

STEP 8: Attach Right and Left Bed Panels & Attach Side Rails to Bed Panels

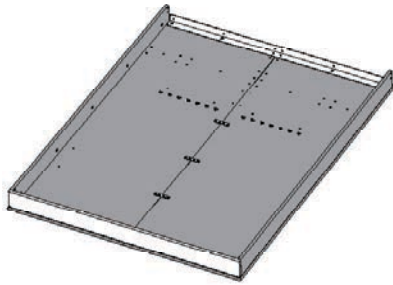

A. Carefully place the finished side of Bed Panels on the carpet or other padded surface. Make sure the area is clear of any hardware or debris that can cause damage.

B. Attach the Right and Left Bed Panels to each other using the H-085 Mending Plates and H-087 Pan Head Screws, making sure that the top edge of the panels are well aligned when installing the H-085 Mending Plates.

C. Screw the H-011 minifix pins into the smaller holes at the outer sides of the Bed Panels. Tap wood dowels into the larger holes. Be careful to tap gently; the dowels may dimple the face of the panels if hit too hard!

D. Place the Side Rails on top of the fittings as shown. Tighten all of the minifix cams. The Side Rails must be positioned so that their ends with pre-installed threaded inserts are oriented, as shown.

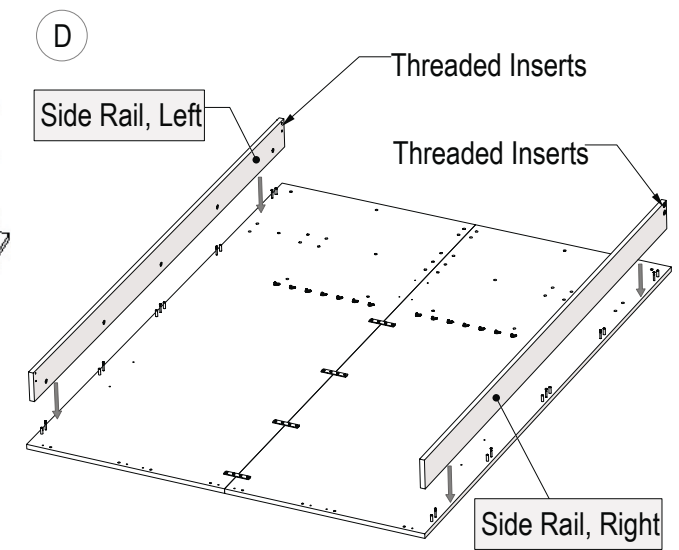
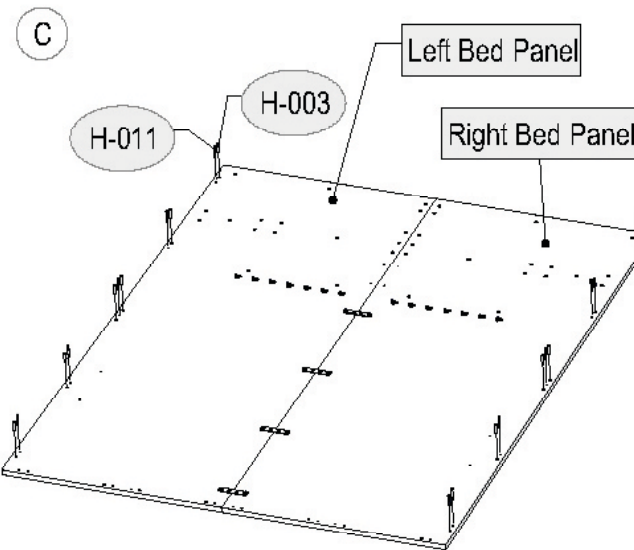
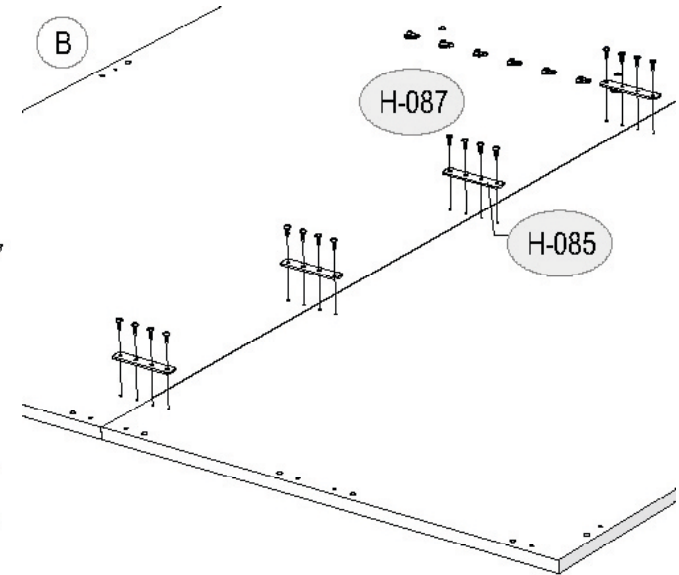
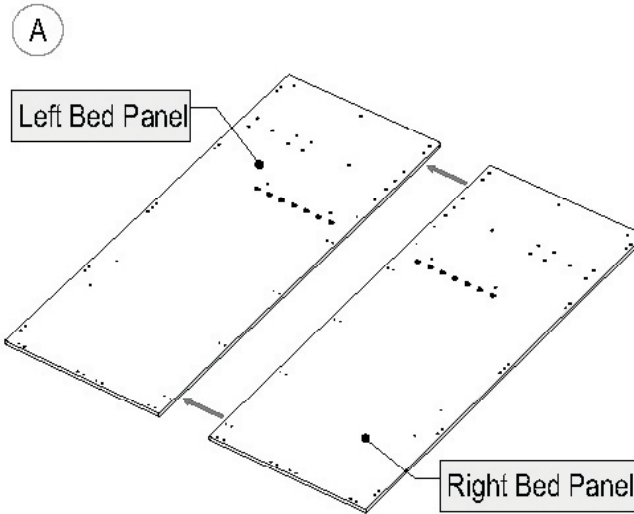

Scan this QR Code to watch this Step's video tutorial.

STEP 9: Attach Foot Rail & Angle Iron to Bed Panels

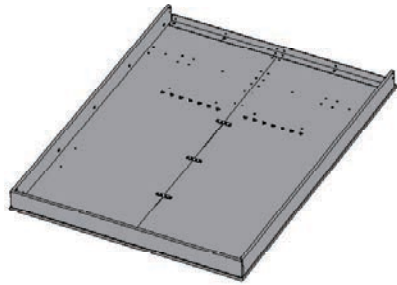

A. Screw the H-011 minifix pins into the smaller holes at the ends of the Bed Panels, as shown. Tap wood dowels into the larger holes. Be careful to tap gently; the dowels may dimple the face of the panels if hit too hard.

B. Place the Foot Rail on top of the fittings, as shown. Tighten all of the minifix cams.

C. Attach the Foot Rail to each Side Rail by connecting the H-077 Wide Angle Brackets to each corner with H-107s Flat Head Euro Screws, as shown.

D. Place the Angle Iron on the Bed Platform at the head of assembly. Align the Angle Iron holes with the Bed panel Holes. Screw the H-287 Panhead Machine Screws through the Angle Iron holes and the Bed Panels to attach the Angle Iron to the Bed Panels.

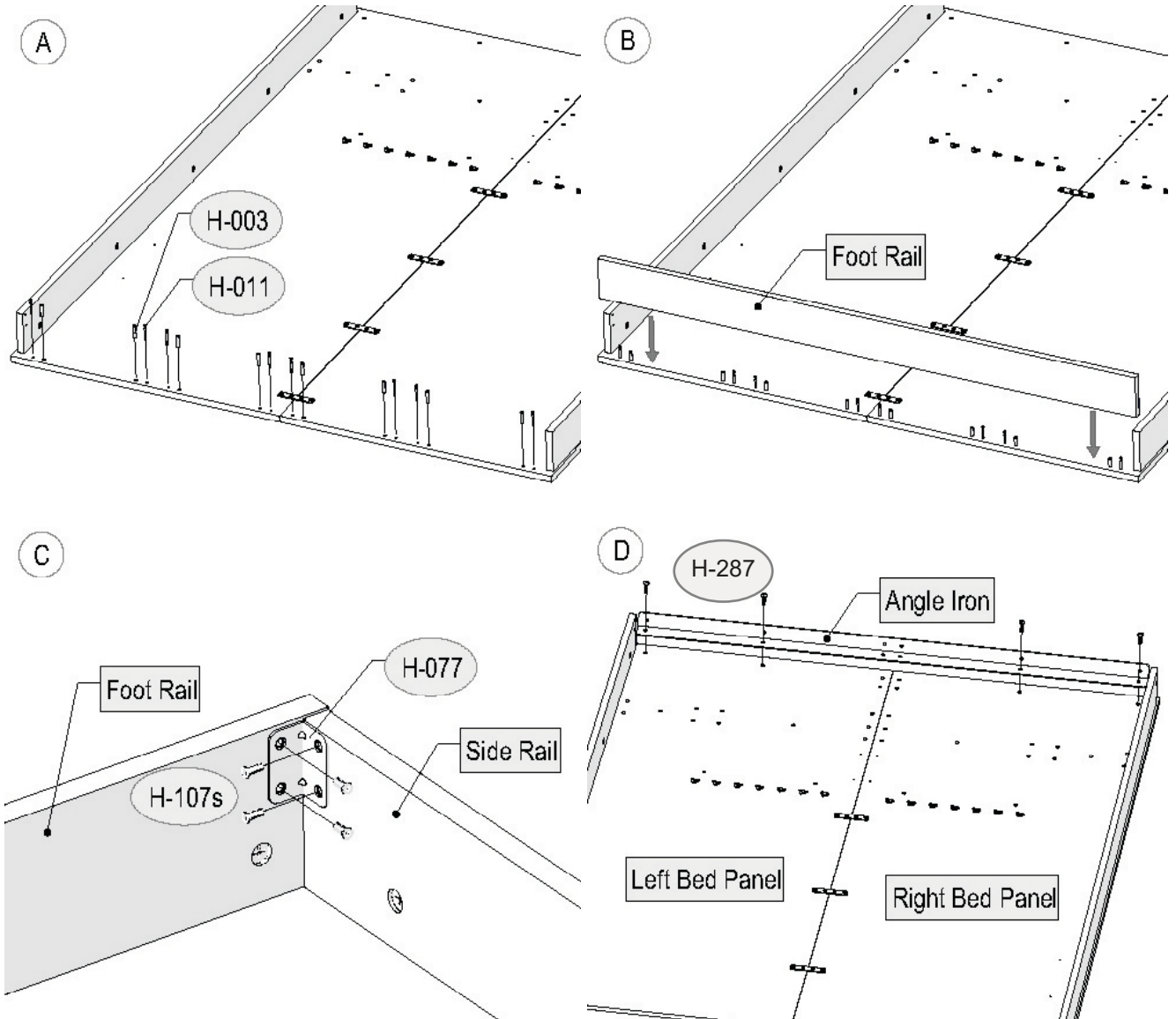

Scan this QR Code to watch this Step's video tutorial.

STEP 10: Attach the Footrest to the Table and Leg

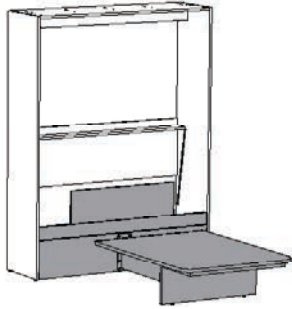

- A.** Lay the Table Assembly down, as shown, using padding on the floor to protect the Tabletop from scratches. Stand the Footrest on the Lower Leg with the smaller flange plate downward.
- B.** Screw the H-008 Leveler Feet into the bottom edge of the Lower Leg as shown.
- C.** Bolt the Footrest in place with H-020 Panel Bolts using a 4mm Allen Wrench.

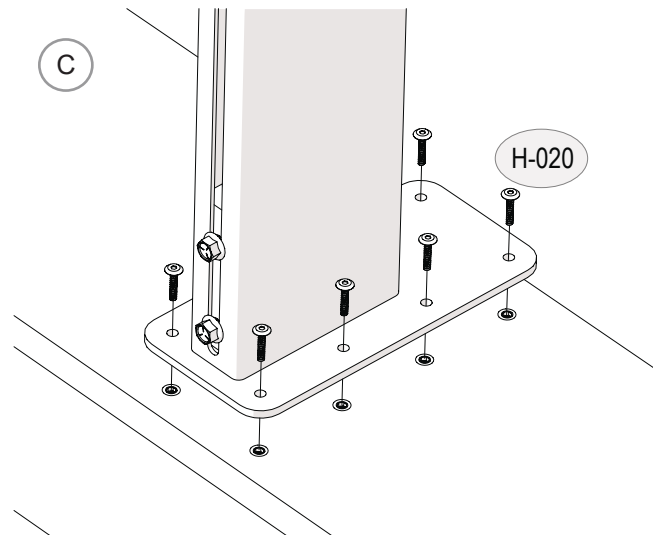
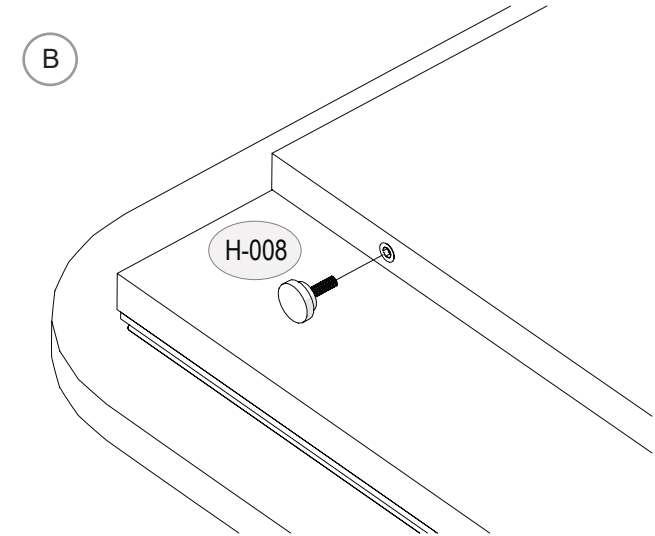
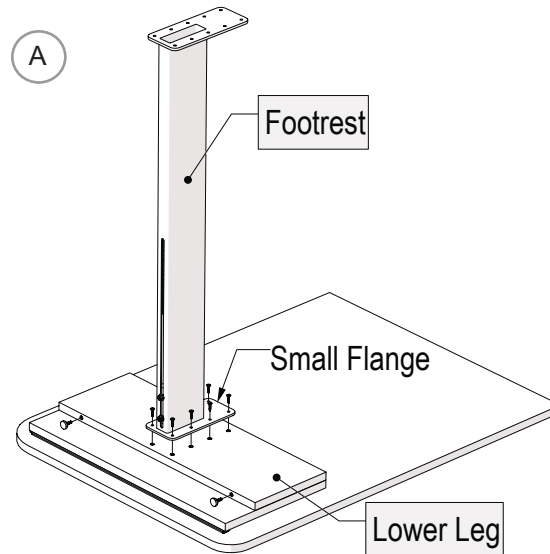

Scan this QR Code to watch this Step's video tutorial.

STEP 11: Turn the Table Assembly Over

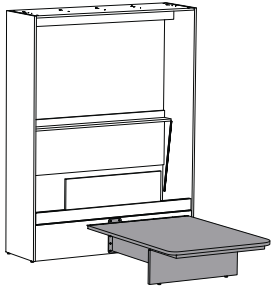

A. Pivot the Footrest down.

B. Carefully turn the Table, Leg, and Footrest assembly over as shown.

C. Continue to turn the Table, Leg, and Footrest assembly over as shown.

D. The Tabletop will naturally fall towards the top of the Footrest.

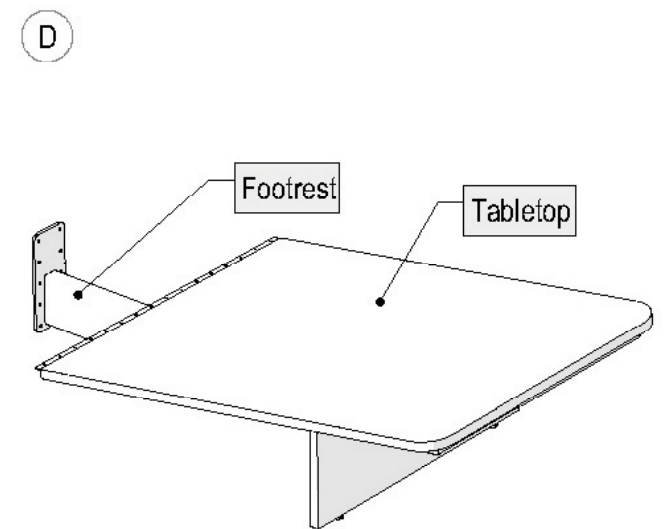
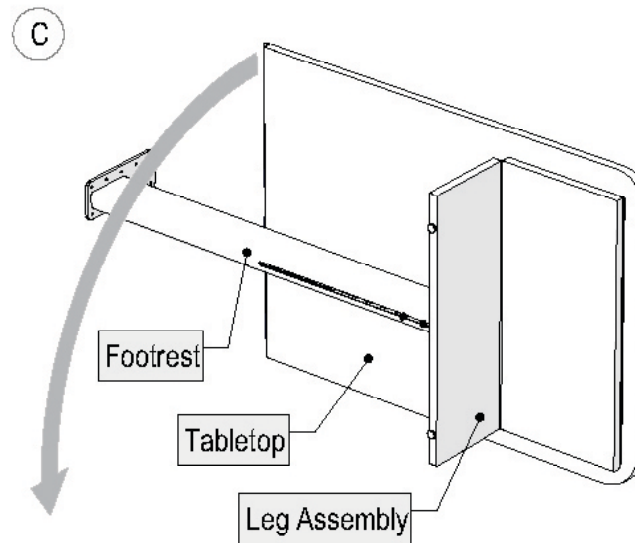
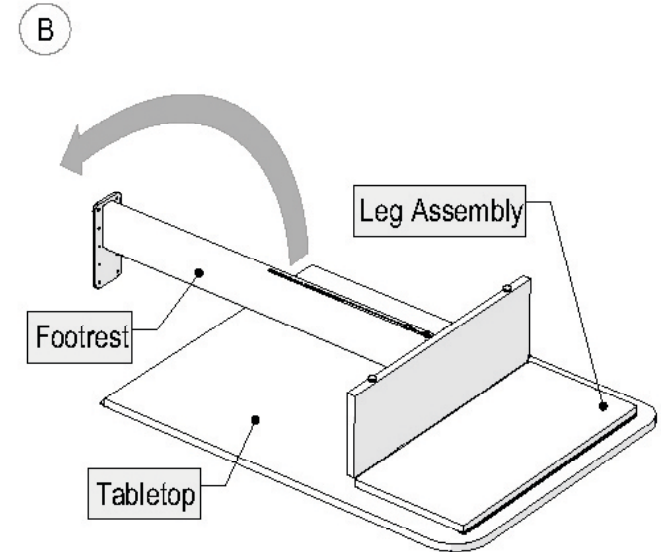
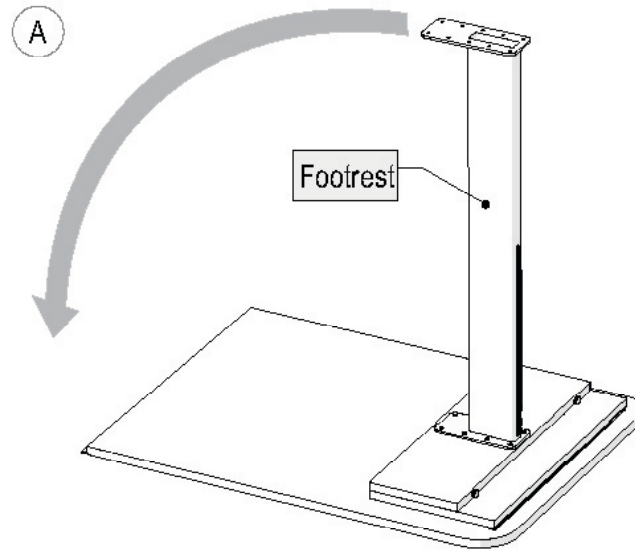

Scan this QR Code to watch this Step's video tutorial.

STEP 12: Attach Footrest to Cabinet Front

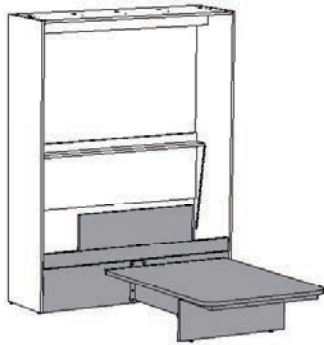

A. Place the Footrest and Table Assembly towards the cabinet until it touches the Cabinet Front.

B. Bolt the Footrest to the Cabinet Front with H-021 Panel Bolts. Be sure these bolts are tight; this connection is the key to the freestanding feature of the TableBed.

C. Pivot the Flipper down as shown.

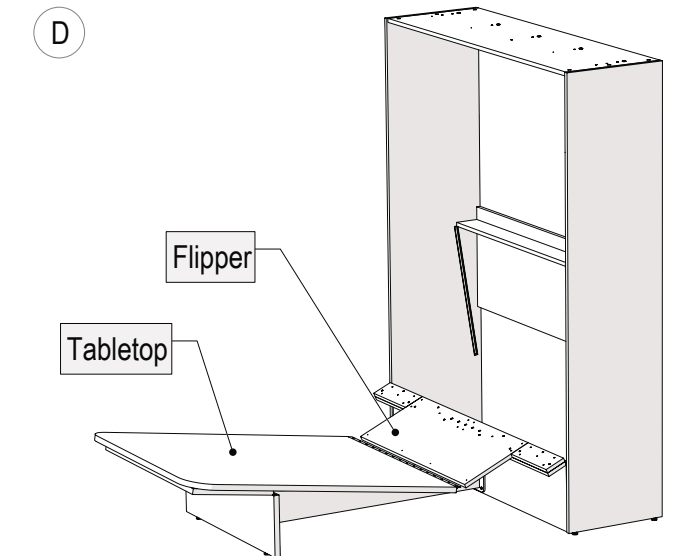
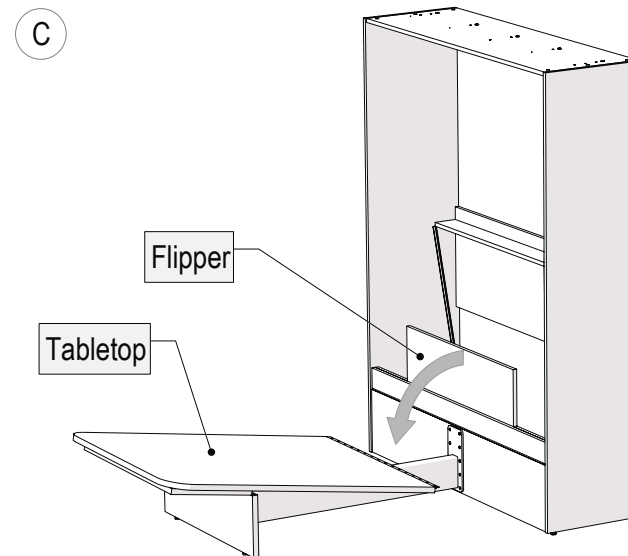
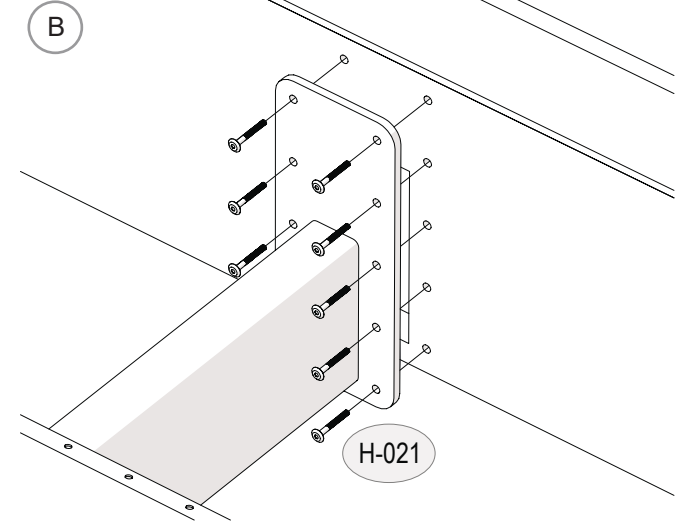
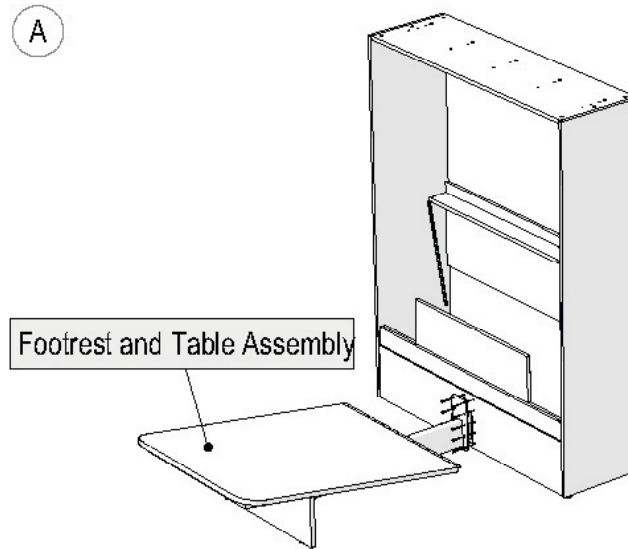

Scan this QR Code to watch this Step's video tutorial.

STEP 13: Attach Head Rail to Bed Platform & Place Bed Platform into Cabinet

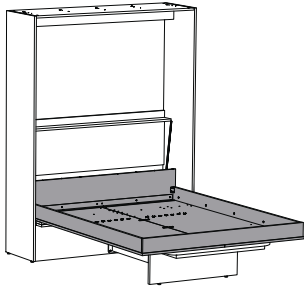

A. With two people, one on each side of the Bed Platform Assembly, lift up the assembly and locate it into the Bed Cabinet as shown. Once the Bed Platform has been located, and is supported by the Tabletop and Flipper Assembly proceed to the following step for attachment instructions.

B. Lower the Head Rail into place, behind the Angle Iron and on top of the Bed Platform.

C. Insert the H-287 Machine Screws through the Angle Iron and Head Rail, then tighten.

D. Attach the Head Rail to each of the Side Rails with H-077 Wide Angle Brackets and H-019 Machine Screws at each corner.

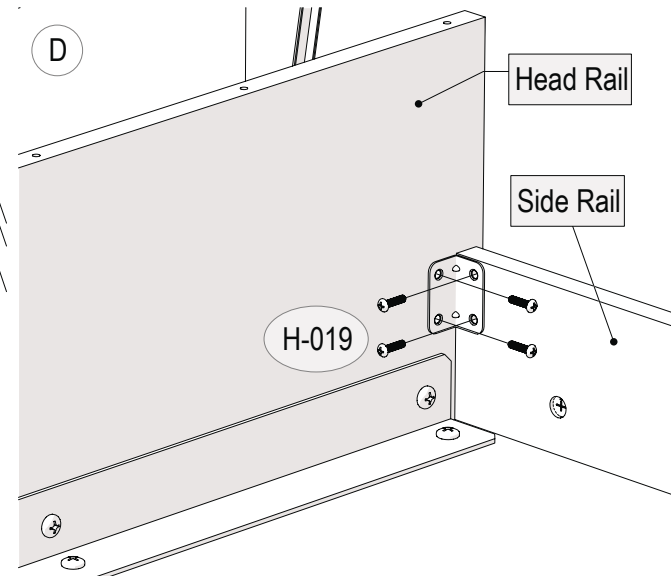
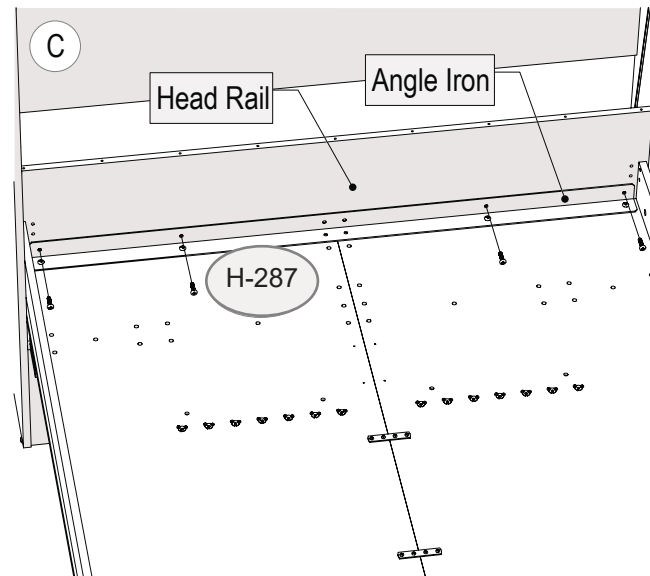
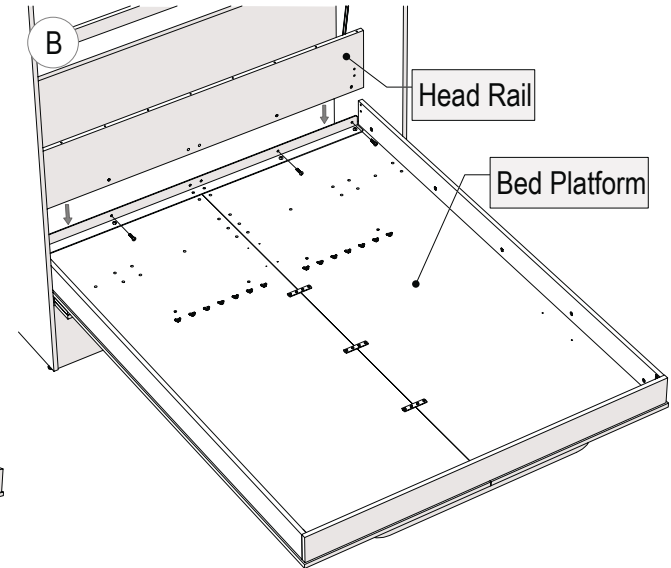
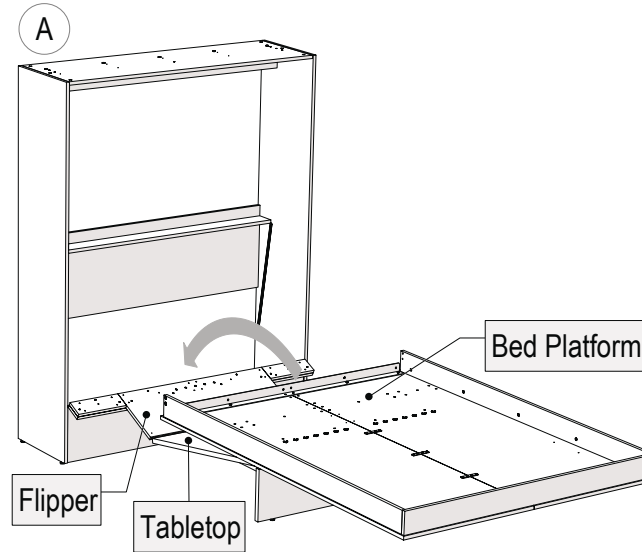

Scan this QR Code to watch this Step's video tutorial.

STEP 14: Attach the Strut Plate to the Bed Platform

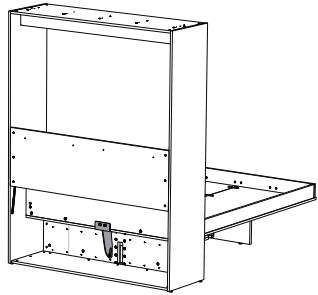

A. From behind the Bed Cabinet, hold the Strut Plate below the Bed Panels and back face of the Head Rail, as shown. Align the Strut Plate threaded inserts with the corresponding holes in the Bed Panel.

B. Hold the Strut in place from below.

C. From above the Bed Platform, insert the H-060 Machine Screws through the Angle Iron, Head Rail, and Strut Plate, then tighten as shown.

D. Position the Backing Plate as shown. Insert the H-060 Screws through the Backing Plate, Bed Panels, and Strut Plate, then tighten.

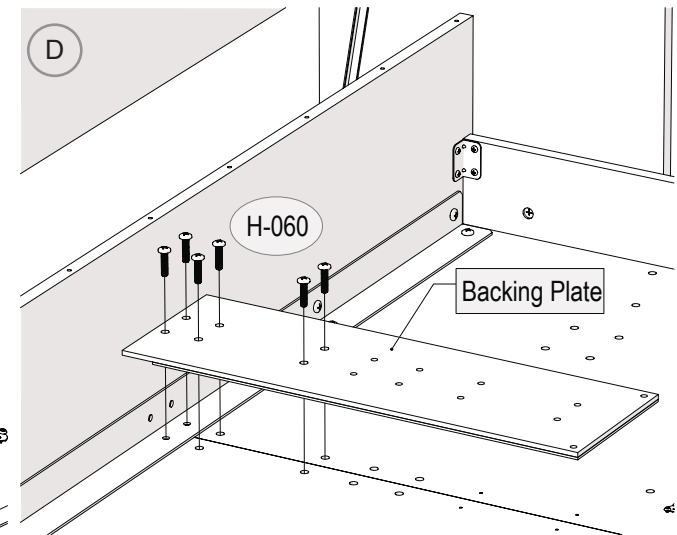
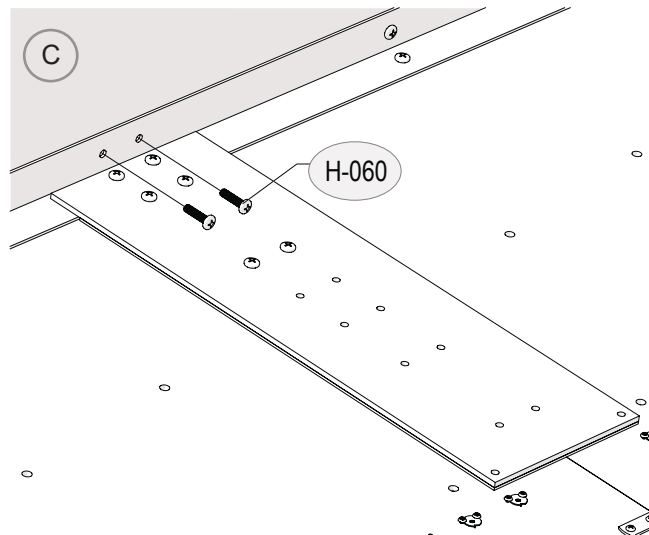
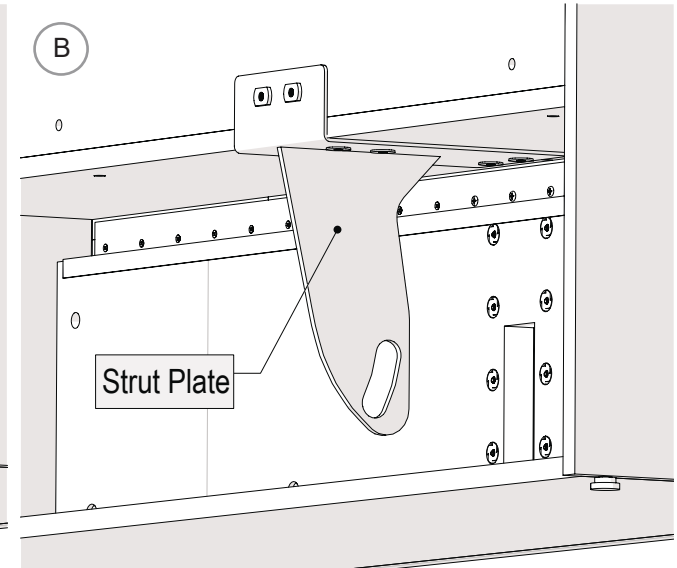
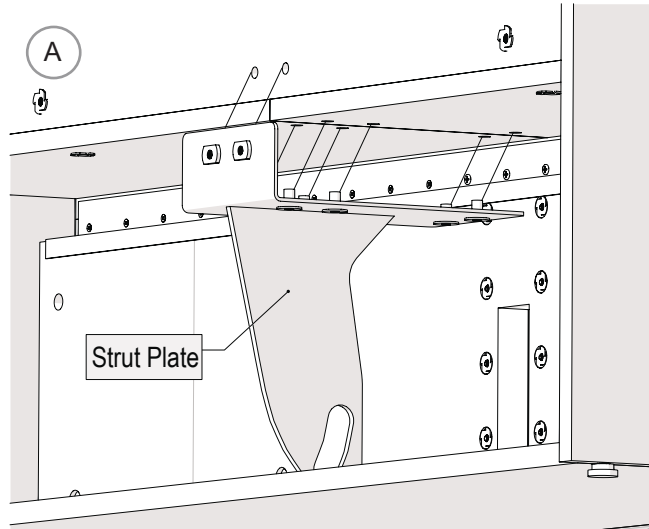

Scan this QR Code to watch this Step's video tutorial.

STEP 15: Attach the Table Hinge to the Bed Platform

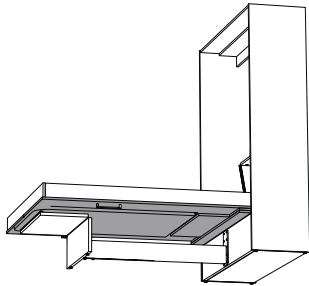

A. Under the Bed Platform, towards the Cabinet, line up the holes in the hinge at the end of the Tabletop with the corresponding holes in the Bed Platform.

B. Bolt the H-019 Machine Screws upwards through the holes in the hinge, through the Bed Panels, and into the T-Nuts that are already set in the Bed Panels on the other side.

C. TIP: It is best to start a H-019 Machine Screw at each end of the hinge. Once the hinge is aligned this way, you can finish inserting all of the machine screws and tightening them.

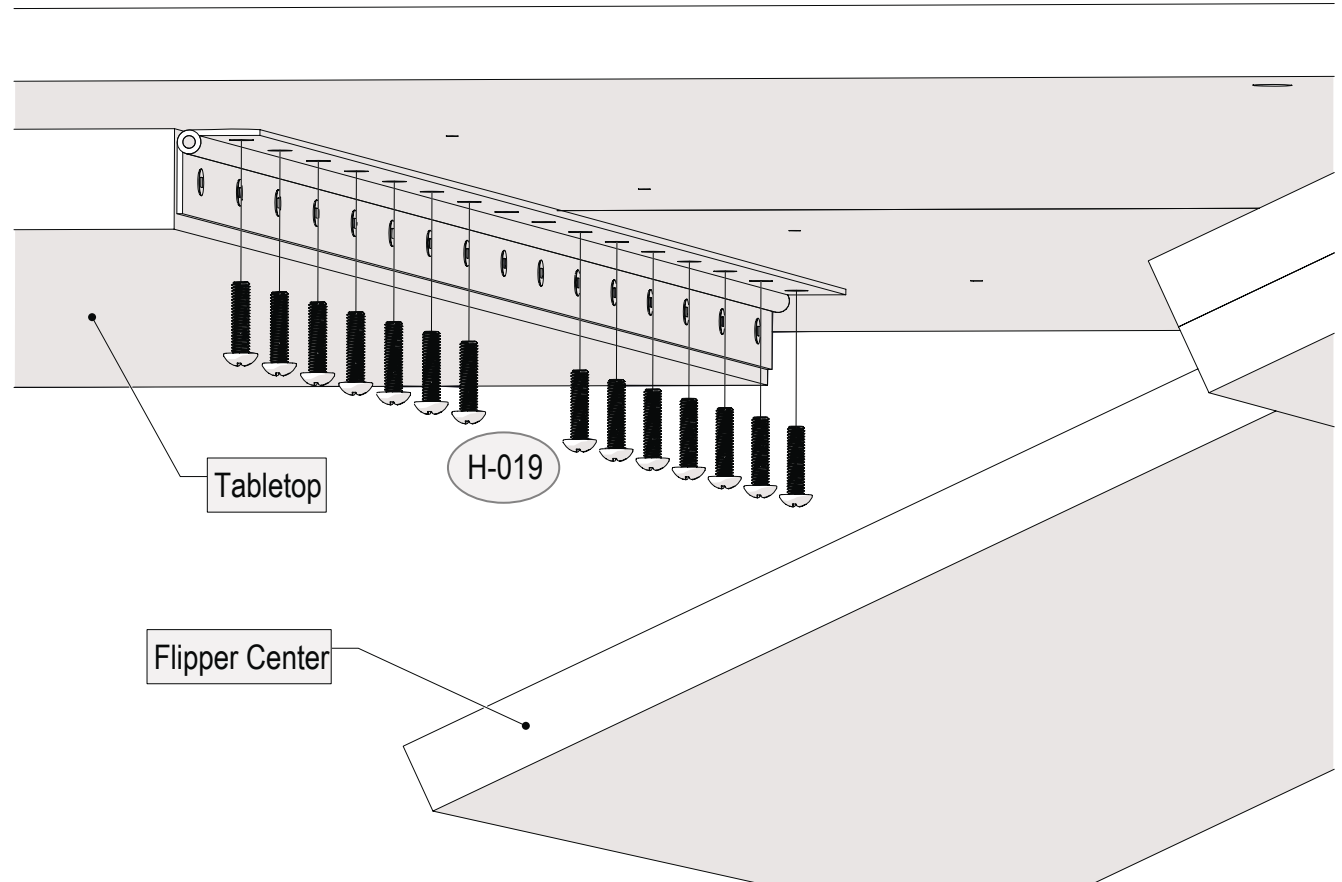

Scan this QR Code to watch this Step's video tutorial.

STEP 16: Attach the Bed Platform to the Flipper

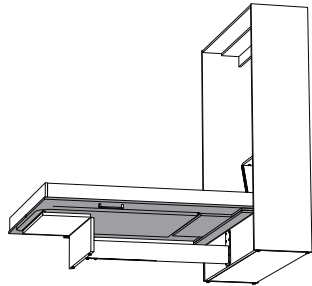

- A.** From underneath the Bed Platform, prop or hold the Flipper up against the bottom of the Bed Panels, as shown.
- B.** There is a series of holes in the Bed Platform towards the Head Rail. Align these holes with the holes in the Flipper.
- C.** Screw the Bed Panels to the Flipper with the H-065 Panel Screws, as shown.
- D.** Screw the Bed Panels to the Flipper with the H-039 Wood Screws, as shown.

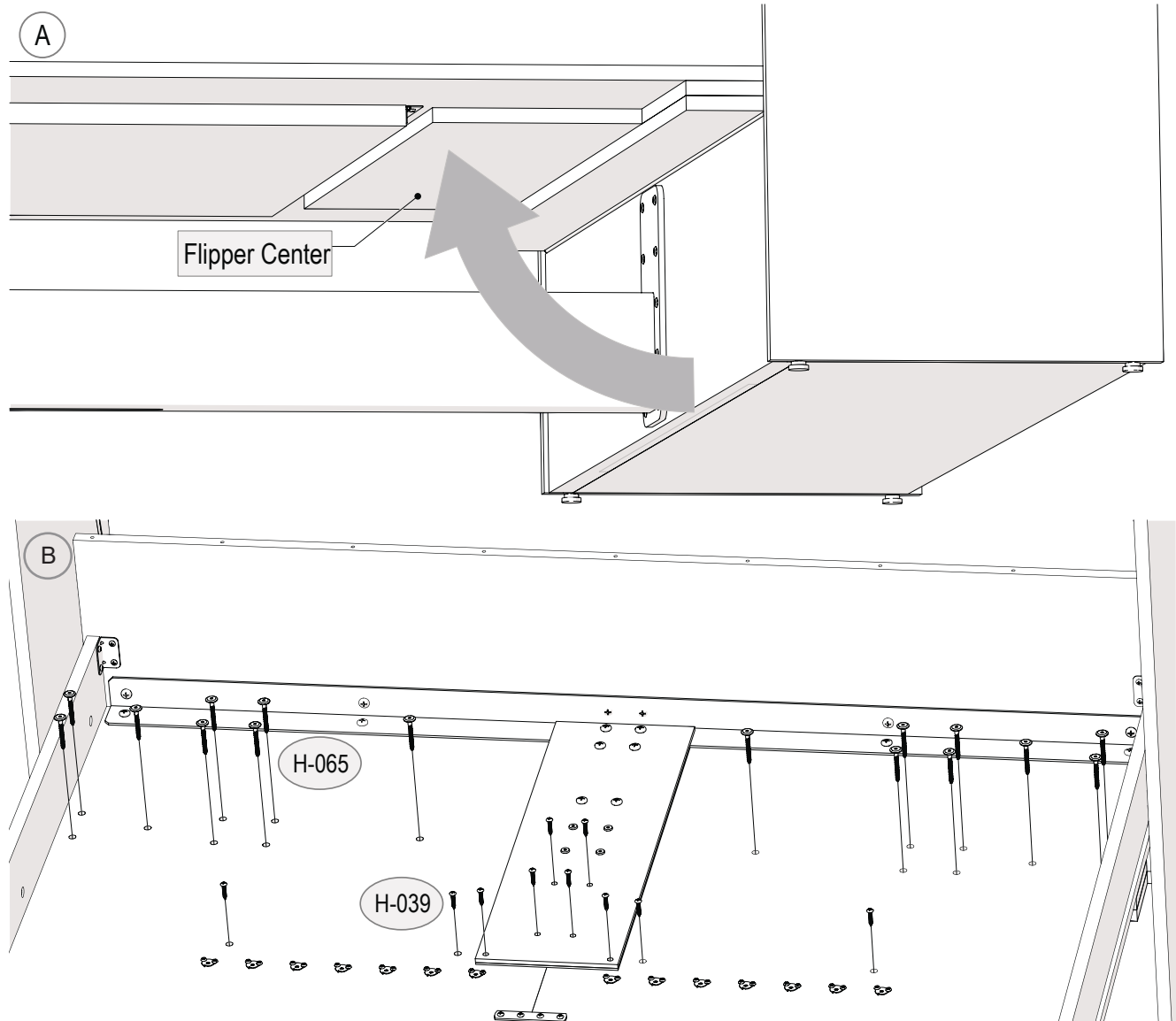

Scan this QR Code to watch this Step's video tutorial.

STEP 17: Attach the Linking Bars to the Strut Plate

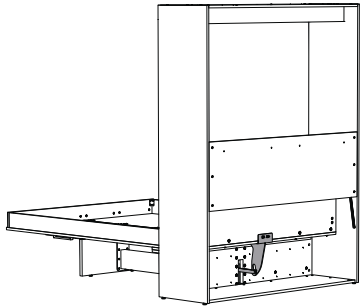

A. Loosen the two Hex Bolts under the Footrest in the slot near the Table Leg, as shown. Grab one of the bolts with a pair of pliers and slide the spring mechanism (inside the footrest) back towards the Cabinet. The Linking Strips will come through the rectangular hole in the Cabinet Front.

B. Place and rest the M-36 Roller Bearing into the curved slot of the Strut Plate. Relocate the Linking Strips until their holes line up with the Roller Bearing. Insert the H-035 Clevis Pin through a Linking Strip, Roller Bearing, and other Linking Strip.

C. Insert the H-928 Cotter Pin through the Clevis Pin hole. Bend the H-928 Cotter Pin Legs with Pliers to lock the Assembly in place, as shown.

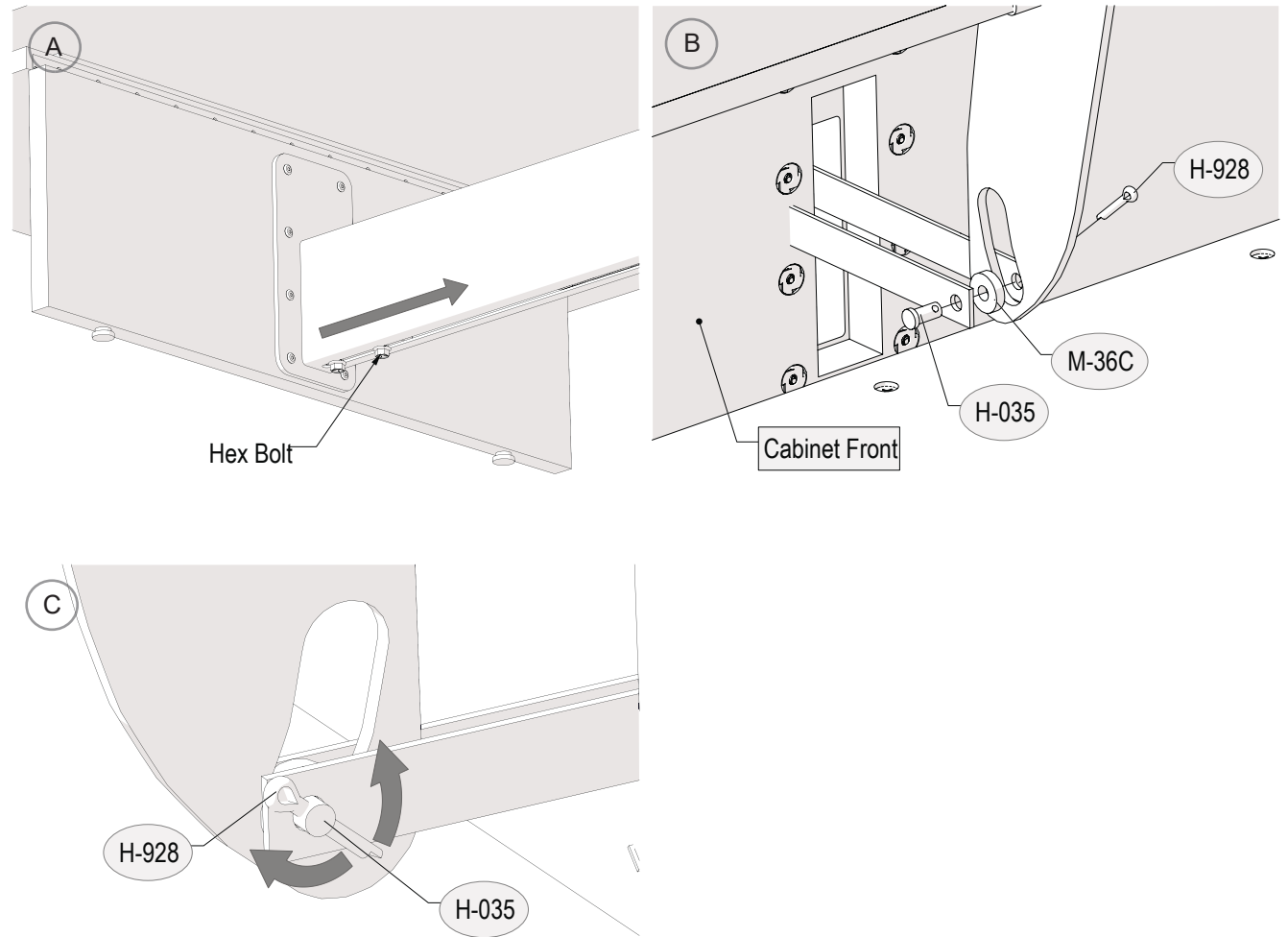

Scan this QR Code to watch this Step's video tutorial.

STEP 18: Attach the Handles to the Bed Platform

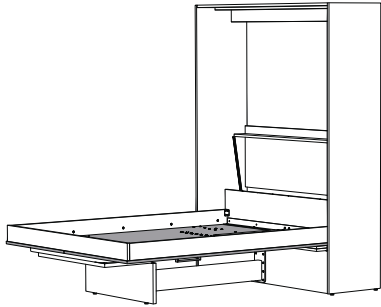

A. Attach the Handles on each side of the Bed Panels using the H-425 Machine Screws.

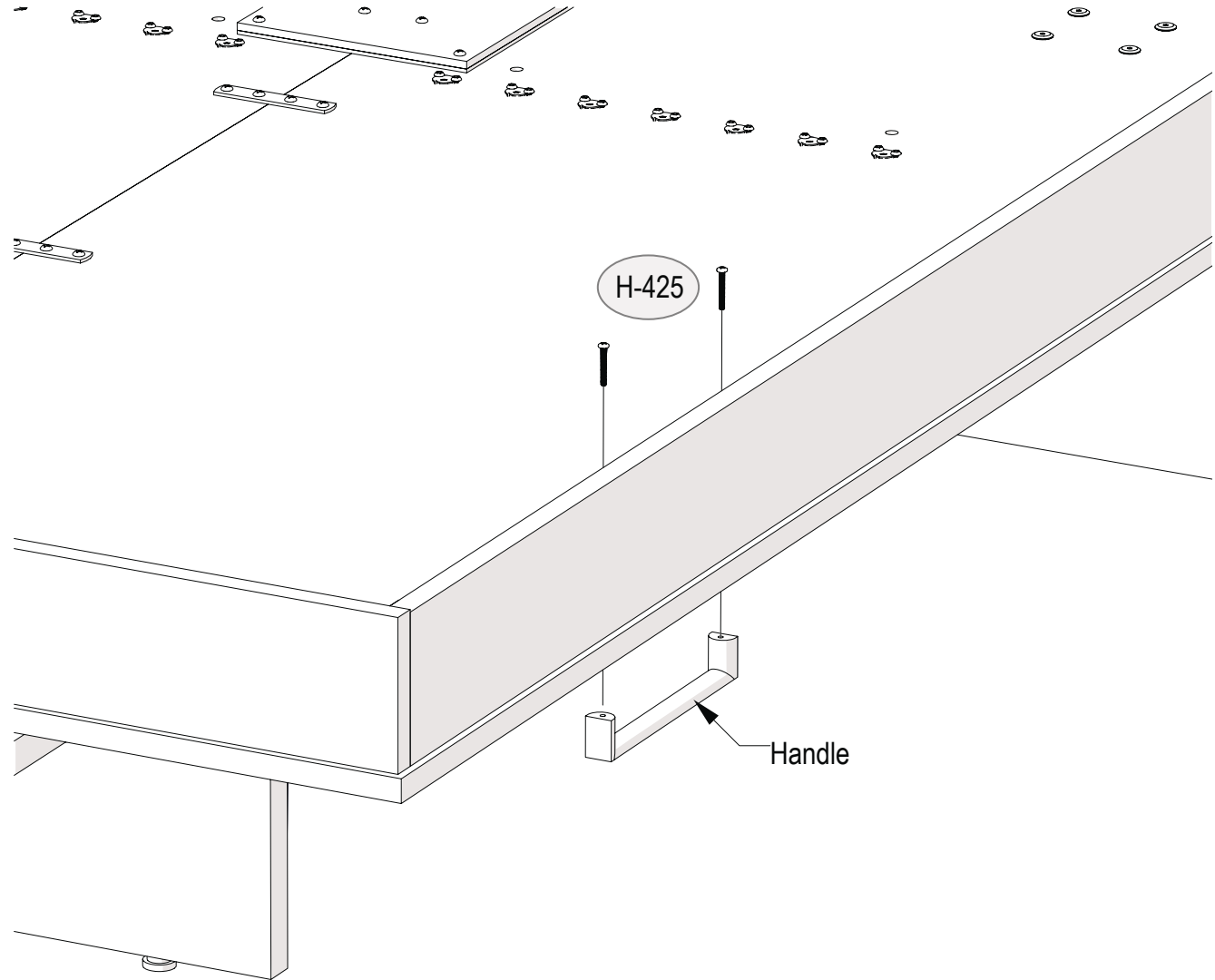

Scan this QR Code to watch this Step's video tutorial.

STEP 19: Put the Mattress in place & Attach the Headboard to the Head Rail

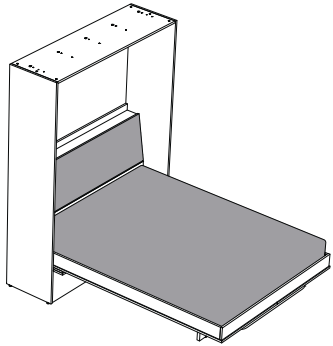

A. At this point the mattress can be placed into the Bed Platform.

B. Locate the Headboard so that the hinge holes align with the holes of the Head Rail. It is best to start a H-014s Euro Screw at each end of the hinge. Once the hinge is aligned this way, you can finish inserting all of the Euro Screws and tightening them.

C. Locate the Headboard Guide Assembly on the back of the Headboard. Align the 4 holes of each Headboard Guide with the 4 holes on each end of the Headboard. Attach the Headboard Guide to the Headboard with H-087 Pan Head Screws, as shown.

D. Pull the Guide Cable away from the Headboard so that Guide Pins are positioned in towards the center of the Bed, then pivot the Headboard toward the back of the Bed Cabinet. Once the Guide Pins are aligned with the Guide Tracks, release the Cable so that the Pins are positioned out into the Tracks.

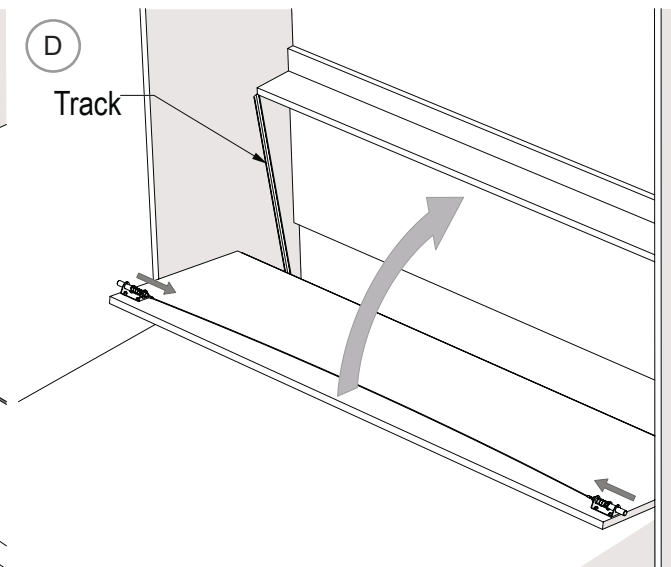
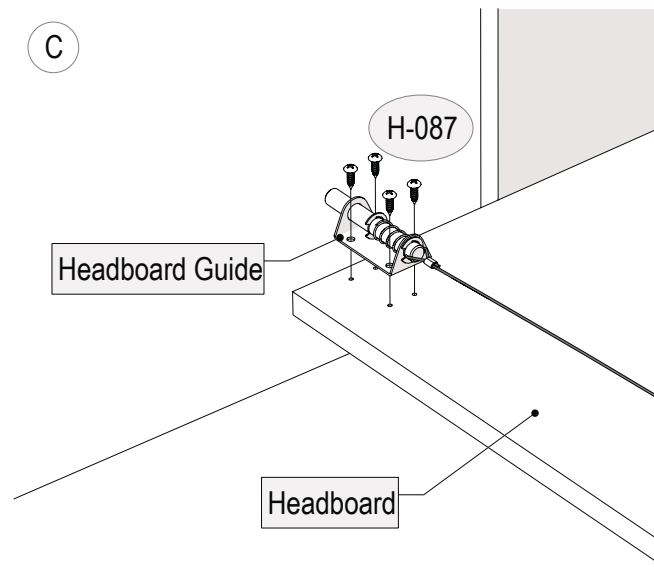
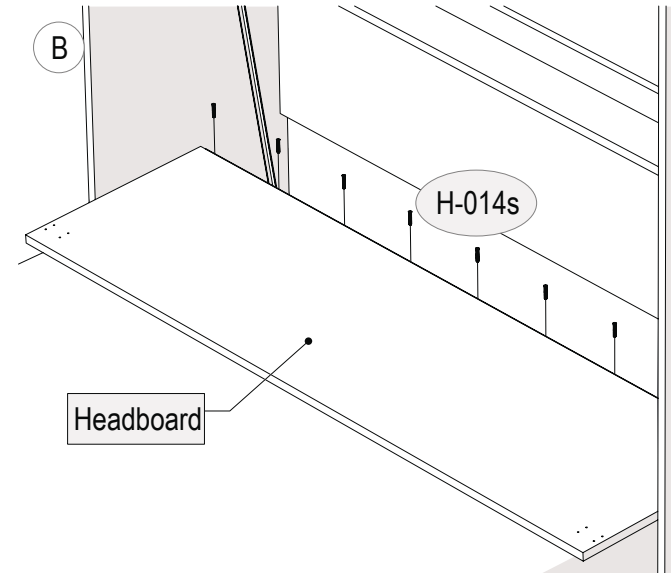
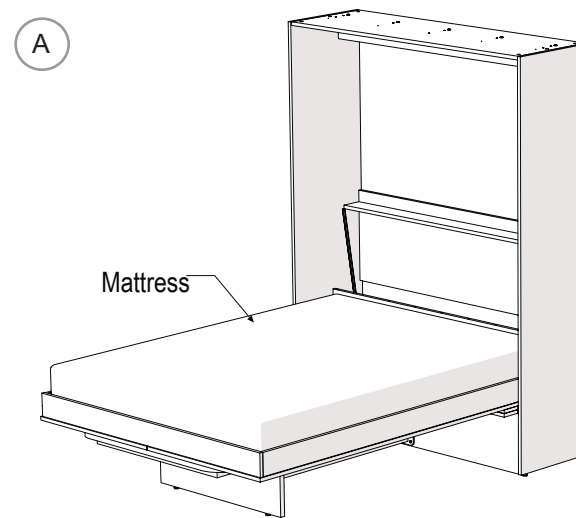

Scan this QR Code to watch this Step's video tutorial.

STEP 20: Raise the Bed and Tighten the Spring Anchor Bolts

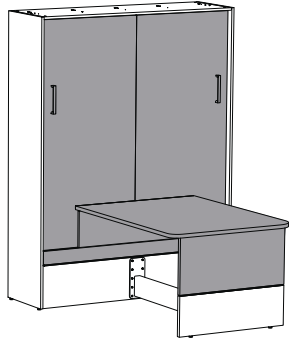

A. Carefully raise the Bed Platform to its upright position. It will feel heavy because the spring mechanism is not engaged yet. The Table will come up as the bed is raised.

B. As the bed is raised, the two bolts shown will slide forward toward the Table Leg. Grab one of those bolts with a pair of pliers and slide the spring mechanism (inside the footrest) towards the Table Leg. Don't pull it too tight; just move it until it stops naturally. Tighten both bolts firmly with a 9/16" wrench. The next time the Bed is lowered, the springs will balance its weight.

A

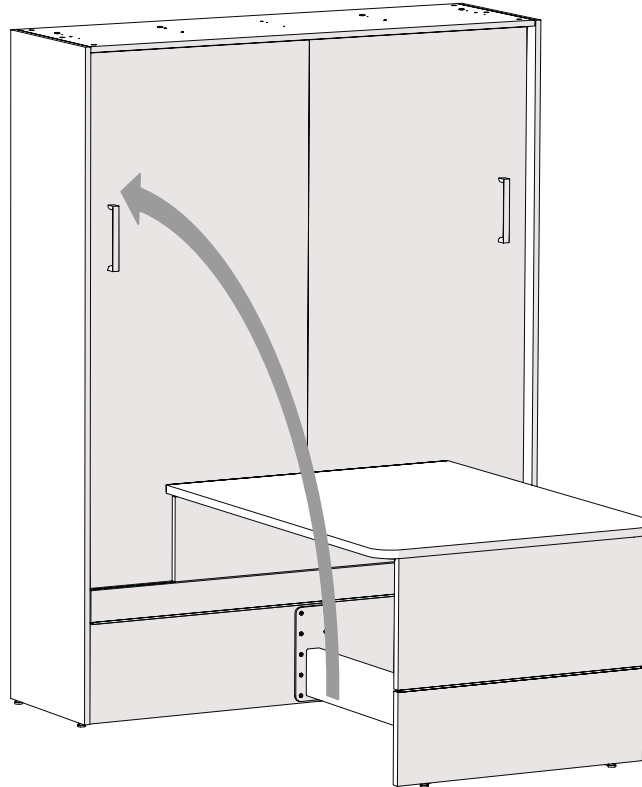

B

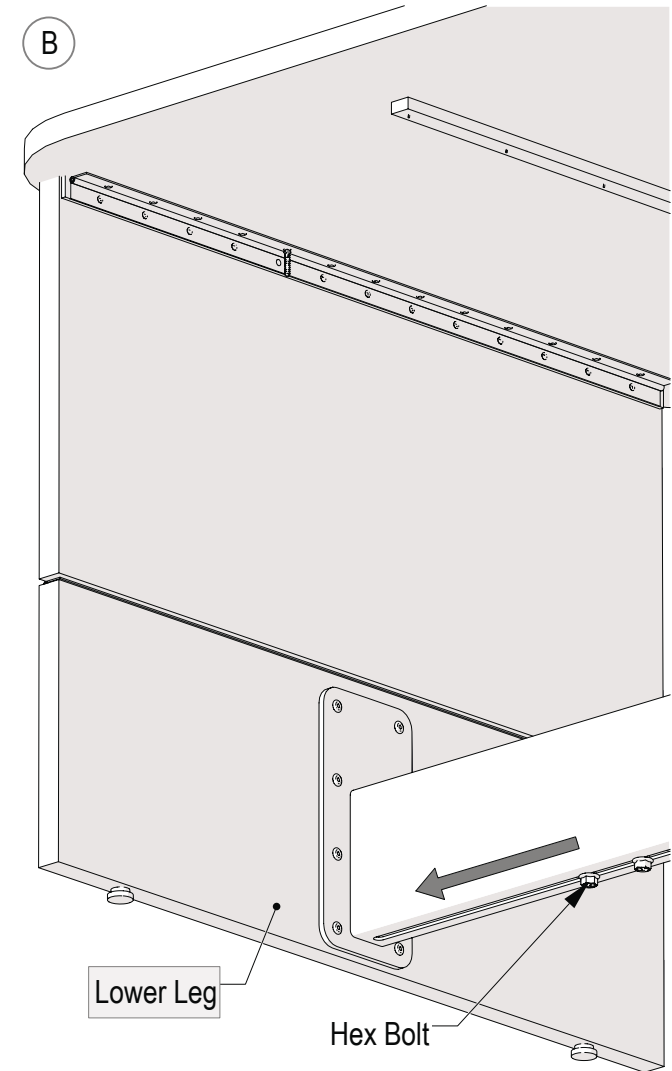

Scan this QR Code to watch this Step's video tutorial.

STEP 21: Adjust the Spring Tension to the Lower Leg

A. The Footrest acts as an outrigger to stabilize the entire TableBed and allow it to be freestanding. After assembly and periodically through the life of the unit, check to make sure the (10) bolts holding the Footrest to the Cabinet Front remain tight.

B. Periodically check to make sure the (8) bolts holding it to the Table Leg remain tight.

C. The (2) 3/8" bolts under the Footrest hold the the spring mechanism anchor bracket in place. This also holds the adjustment of the the spring tension for the unit. Maintaining the tightness of these bolts is crucial to the safe use of the unit. Check them periodically to make sure they are completely tightened.

D. Spring Balance of Bed: The position of the two 3/8" bolts under the Footrest determine how much spring tension is balancing the weight of the bed as it is raised and lowered. The ideal adjustment is to have as much tension as possible, so the bed is easy to raise and lower, but not so much that it "floats" up after it is lowered. The adjustment **MUST** only be made with the bed in the up position (so there is no tension on the springs while you are working). To increase the spring tension, loosen the two 3/8" bolts under the Footrest, slide them toward the Table Leg, and re-tighten them. To decrease the tension, loosen them, slide them away from the Table Leg, and re-tighten them.

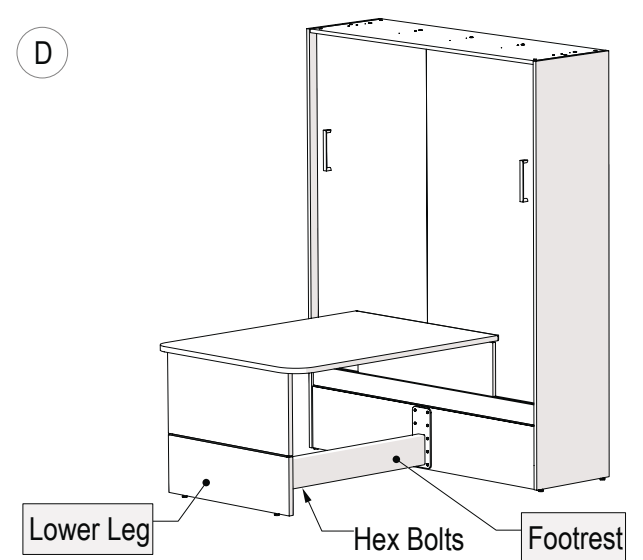
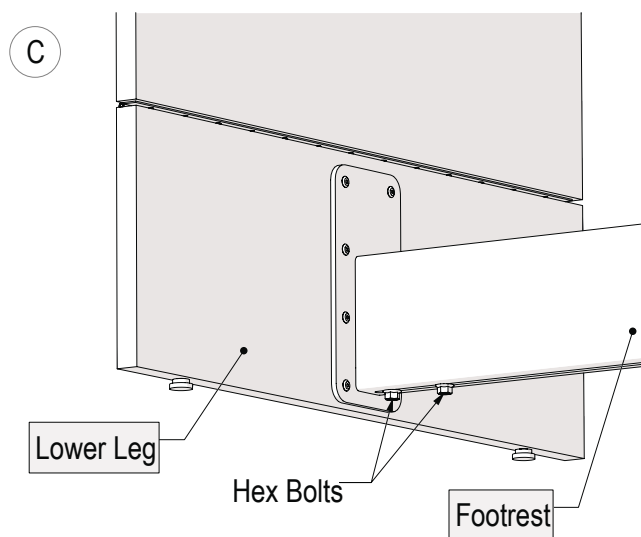
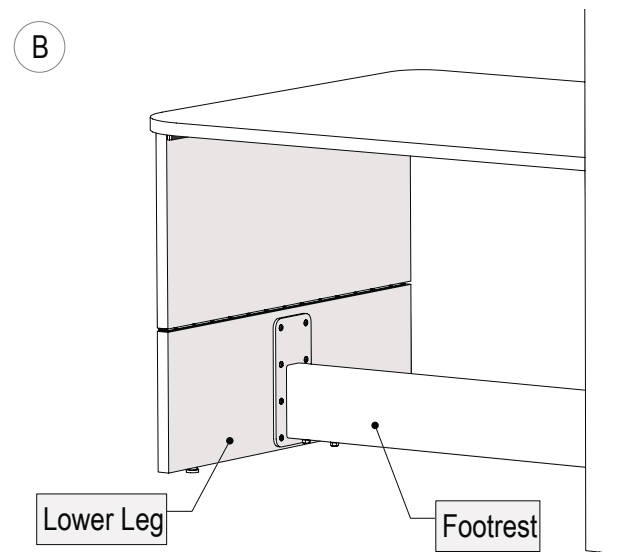
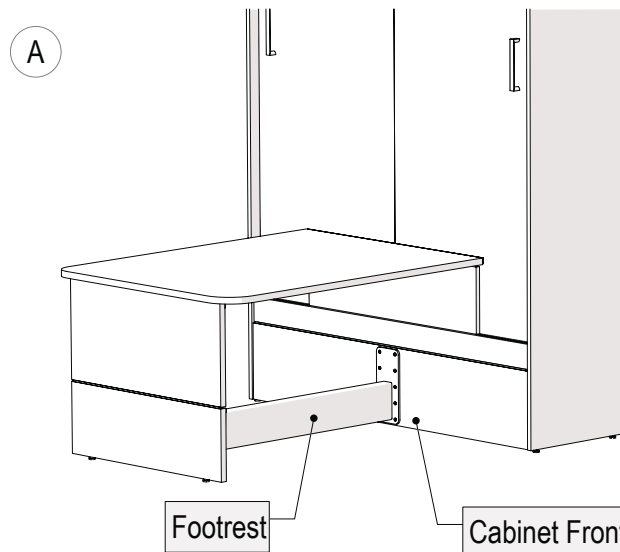

Scan this QR Code to watch this Step's video tutorial.

Final Step: Plaque

A. Open your InovaBed fully and attach the plaque to the Footrail using the provided screws.

A

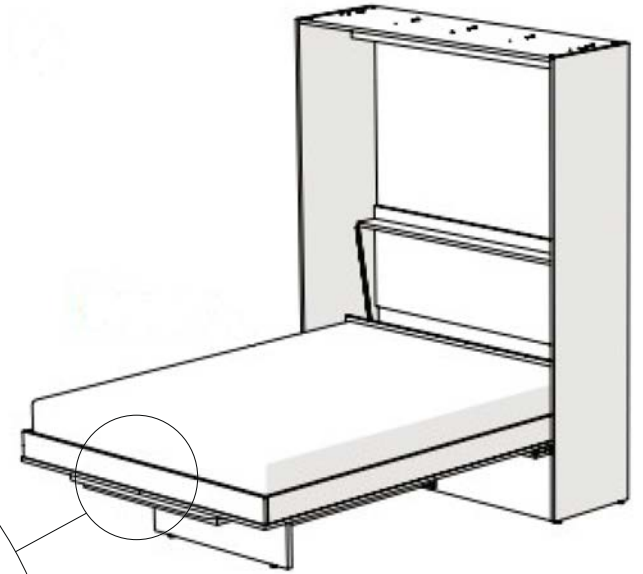
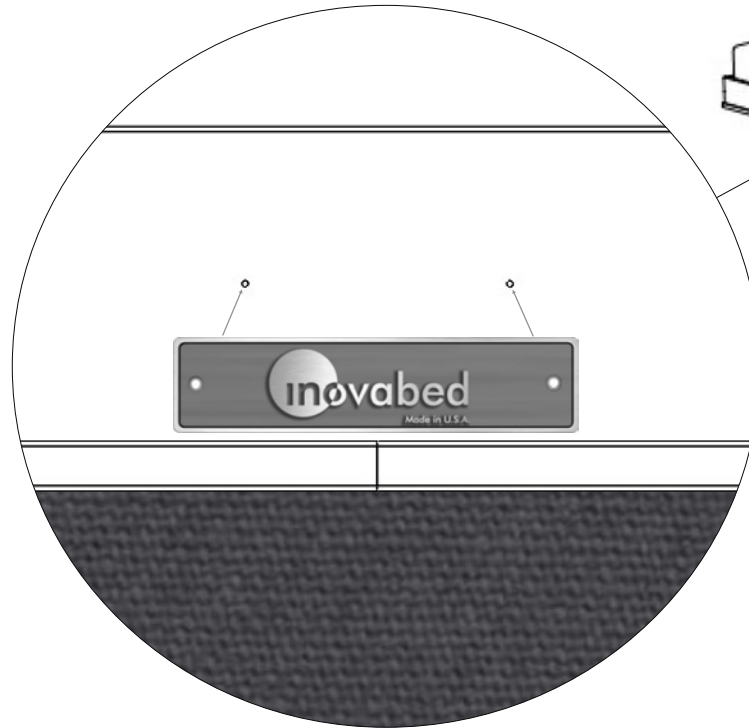

TROUBLESHOOTING

TableBed | ASSEMBLY MANUAL

TROUBLESHOOTING

HOW CAN I ACCESS BEHIND THE TABLEBED?

If you need to access to the area behind the bed, you most likely do not have to remove it from the wall. The Headboard does release, allowing access behind the Bed.

TO LOWER THE HEADBOARD:

Have someone lower the bed about halfway and hold it there. On the back of the Headboard there are guide pins located on the left and right, with a cable stretched between them. These pins extend into the track located on each side of the cabinet, guiding the

Headboard movement as the bed is raised and lowered. Reach behind the Headboard and locate the cable. Pull the cable upward to release the pins on both side and pivot the Headboard forward to the mattress. Make sure you keep holding tension on the cable as you pivot the Headboard to prevent the pins from scratching the inner faces of the Cabinet Sides. At this point, the Bed can be lowered down completely. To re-engage the pins, pull upward on the tension cable and raise Headboard, until the pins are aligned with the track. Release the cable. The pins should snap out into position, resetting the headboard for

use.

REMOVING BED FROM WALL:

With another person, “walk” each side of the Cabinet away from wall.

TIP: You may want to place moving pads underneath cabinet (with another person, tip cabinet slightly to place pad).

MY TABLEBED IS MAKING A SQUEAKY NOISE

First, confirm bolts underneath FootRest are tight and in the desired location (See: How It Works - Adjustment). **Test.**

TROUBLESHOOTING (CONT.)

The TableBed has 5 sets of Hinges that require periodic lubrication - see Care & Maintenance

THERE IS A LOUD BANG OR "GUITAR STRING" NOISE

This noise is most likely coming from the springs located in the FootRest.

If the TableBed is moving freely, cycle it up and down 3-5 times to see if this corrects itself.

Test.

If the TableBed does not move freely or this does not resolve the issue, Contact Us to

further troubleshoot.

CARE & MAINTENANCE INFORMATION

Please refer to your Welcome Booklet for detailed information on Care & Maintenance

NEED TO DISASSEMBLE AND MOVE THE TABLEBED

Reverse assembly steps from manual

TIP: Bag and label hardware per Step. This will be very helpful when reassembling

the TableBed.

I HAVE A BROKEN PART THAT NEEDS TO BE REPLACED

Please call Wayfair with your order ready.

THE TABLEBED IS DIFFICULT TO BRING DOWN (OPEN)

IMPORTANT!: Never Force Bed Open

First, confirm bolts underneath FootRest are tight and in the desired location (See: How It Works - Adjustment). **Test.**

If it still will not open, access behind the

TROUBLESHOOTING (CONT.)

TableBed (see above)

With a flashlight, look closely for any object (may be small) that may be obstructing the mechanism from working properly.

Also check that all connections are still in tact (see assembly manual for proper installation).

Prior to moving Bed back in place, **Test.**

THE TABLEBED IS DIFFICULT TO RAISE UP (CLOSE)

IMPORTANT!: Never Force TableBed Closed

First, confirm bolts underneath FootRest are tight and in the desired location

(See: How It Works - Adjustment). **Test.**

Remove any pillows. **Test.**

Confirm mattress and bedding has not exceeded maximum thickness (see original order for maximum thickness allowed). **Test.**

If the TableBed still will not raise up, lower the Headboard (see instructions under Access Behind Bed) and with a flashlight, check for an object (may be small) that may be obstructing the mechanism from working properly. Remove object. Also confirm all connections are still in tact with mechanism (see assembly manual

for proper installation). Set HeadBoard back in place. **Test.**

If the TableBed still will not raise up, confirm bolts underneath FootRest are tight and in the desired location (See: How It Works - Adjustment). **Test.**

FEEDBACK WELCOME

FEEDBACK WELCOME:

This assembly manual was created with you in mind. Over the years, we have been asked common questions and received important feedback on our products and services.

With great care, and through continuous improvement and learning, we have incorporated the answers and feedback within these manuals. We hope you find them useful and easy to use!

With this said, if there is any outstanding question that you have, please do not hesitate to contact us.

We also welcome any and all feedback about our product and your experience with it. Email us at support@inovabed.com or call us at **866.528.2804**.

We hope you enjoy your Inova TableBed for many years to come!

THANK YOU.

CONGRATULATIONS!



YOUR INOVABED IS READY FOR
YOU TO ENJOY!

**BEFORE YOU GO...PLEASE PROVIDE
YOUR FEEDBACK!**

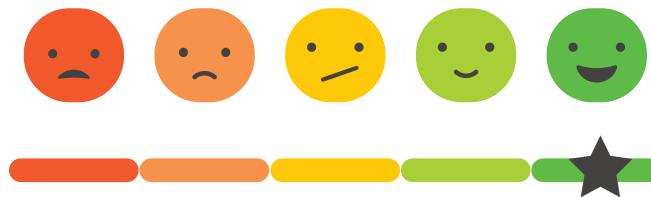
HELP US IMPROVE



Please send us your feedback and finished photos to
info@inovabed.com or tag us with [#inovabeds](https://www.instagram.com/inovabeds)

 Instagram [@InovaBeds](https://www.instagram.com/InovaBeds)
 Facebook [@InovaBed](https://www.facebook.com/InovaBed)

THANK YOU FOR YOUR PURCHASE!

