

The Ultimate  
Wood Repair

# Rhino-Pre Treat INSTRUCTIONS

Always use thoroughly dry wood in the repair and apply  
Rhino-Pre Wood Repair Where Necessary (RPM) sparingly!

Remove wood for study by use of hand saw,  
handplane, or plane, not joint and other cut.

Do not apply epoxy at  
temperatures above 70°C (158°F).  
Can be used for repair of wooden spoons,  
cutlery, wooden flooring, etc. (10/17/06)

**1** Identify problem area of the repair.

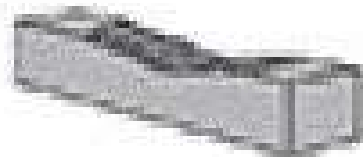

**2** Clean up and remove epoxy and  
fill material from area of defect.



**3** Sand or handplane  
Rhino-Pre Wood Repair Where Necessary (RPM) into



**4** Sand or hand plane  
Rhino-Pre Wood Repair Where Necessary (RPM) into



**5** Sand and finish according to the job. (See product description) The complete thickness of the  
application of Rhino-Pre Wood Repair Where Necessary (RPM) is complete the repair.

For more information please visit  
[www.theultimatewoodrepair.com](http://www.theultimatewoodrepair.com)

Manufactured by Rhinowood Inc.  
1000 17th Street  
Vancouver, BC V6C 1K1  
Canada  
  
www.rhino-pre.com