

## Installation Steps

### Important

Before installing your Kuna light, make sure all parts are present (see other side). If any part is missing or damaged, please contact us via [support@getkuna.com](mailto:support@getkuna.com) before returning the product.

### Get the App

Visit [getkuna.com/help](https://getkuna.com/help) from your iOS or Android device to download the free Kuna app.

### WiFi Setup

- 1 After installing the light and downloading the app, open the app and create a free Kuna account.
- 2 Follow in-app instructions to setup your Kuna light.

### Let Us Help

Get helpful hints, installation details and more at [getkuna.com/help](https://getkuna.com/help)

1

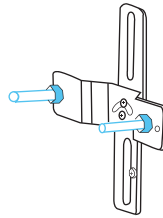

Disconnect power at fuse or circuit breaker before installing the light.

Ensure fixture long screws and nuts are inserted into the bracket as shown. Adjust the swivel angle based on your junction box.

2

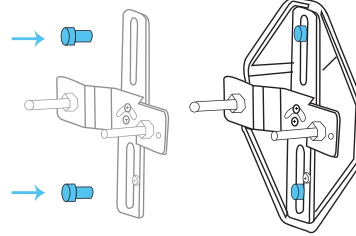

Tighten middle screws in the bracket so it's firm and doesn't wobble.

Fasten bracket to junction box using two junction box screws. Choose short or long pair as needed.

3

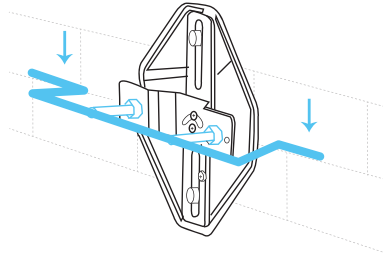

Use fixture screws length indicator to adjust the length of the two long screws from the wall, then tighten the two nuts.

4

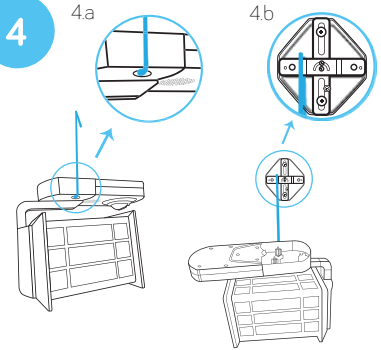

Use holding hook to suspend the light and free your hands for wiring.

Connect the bottom of the hook (square) to the right screw pole, then hang the top of the hook (triangle) on the mounting bracket.

5

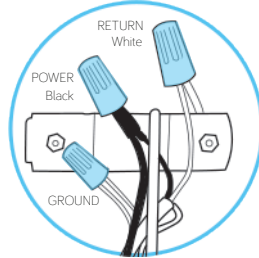

Use wire nuts to connect Black to Black wires. Insert both wires all the way into the nut and twist until secure. Then repeat for the white wires and for the ground wires.

Wall wire colors may vary.

**Recommended:** Use of a voltage detector to confirm the power is off.

6

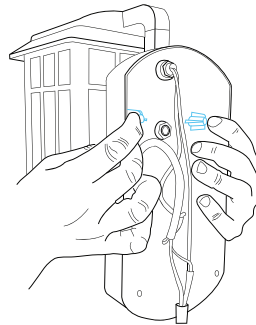

Holding the light fixture with both hands, align the two fixture long screws into the light fixture screw posts.

7

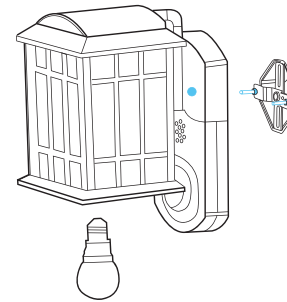

Mount the light fixture to the long screws as shown, then install both decorative nuts. Install a light bulb (Max. 100W).

Apply silicone sealant between wall and light fixture (optional).

Reconnect power at fuse or circuit breaker after installing the light.

8

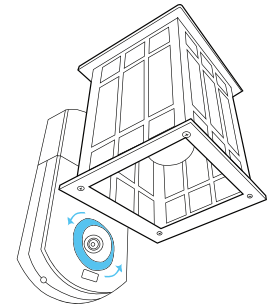

**For Kuna only:** Adjust the camera lens angle. Use 2 fingers to loosen up the locking ring, turning it counter-clockwise. Then, lock it up, turning the ring clockwise. Before making final adjustments, see video feed on your device after downloading the Kuna app and setting up Wi-Fi.

**For Kuna Companion only:** Open the Kuna app and follow the instructions to pair your Kuna light with your Kuna Companion.