

GN4100BT

HAMOKI

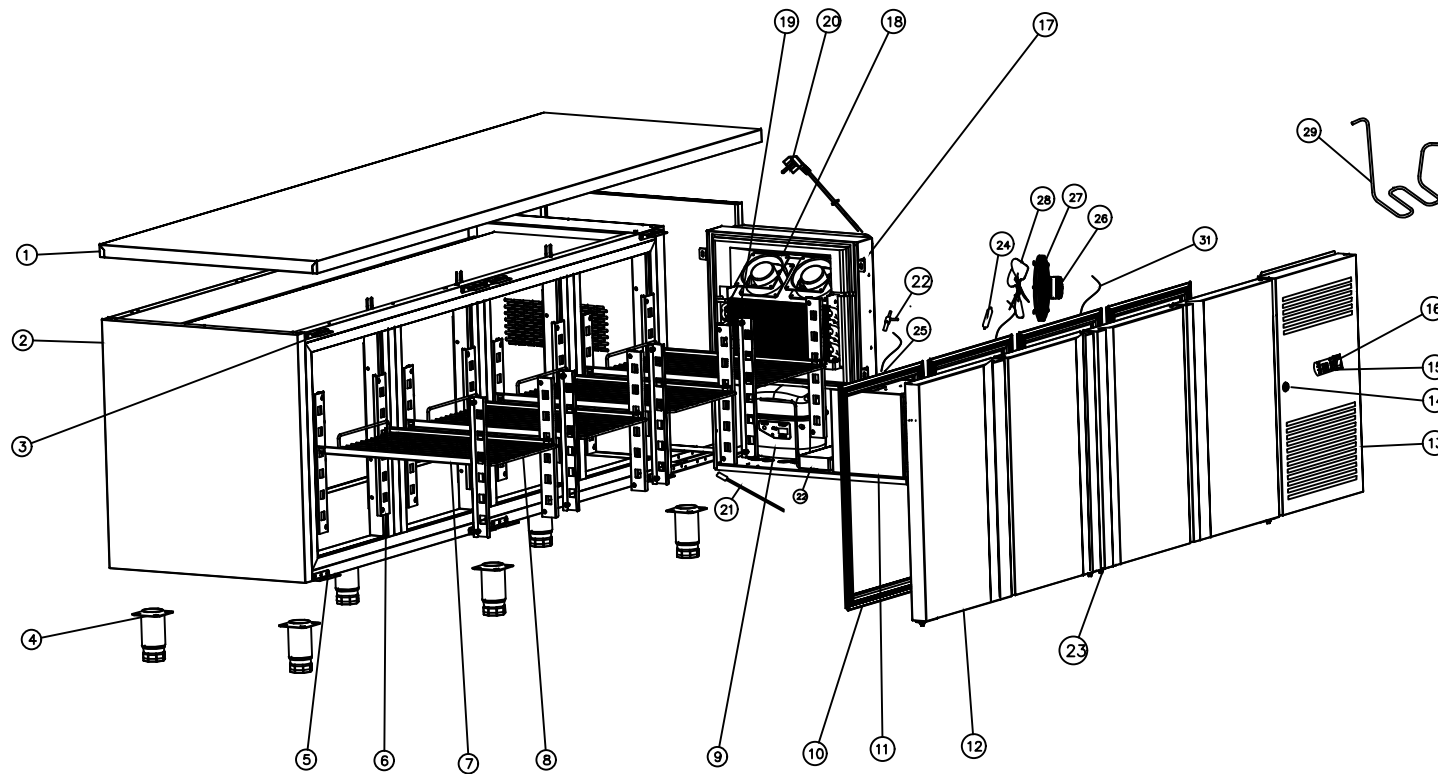

|     |                    |                  |
|-----|--------------------|------------------|
| 31  | The heating wire   | P4100-D01-JRS-A3 |
| 30  | Solenoid valve     | 1028-2           |
| 29  | High pressure pipe | WJ08-10-A2       |
| 28  | blades             | wj15-03          |
| 27  | net                | wj16-03          |
| 26  | fan                | 7W-220V          |
| 25  | capillary          | WJ07-01          |
| 24  | Dry filter         | RE09             |
| 23  | Return spring      | WJ12-17          |
| 22  | The water box      | SL03-10          |
| 21  | sensor             | DQ04-01 DQ04-03  |
| 20  | power cord         | VDE16-3G10-2200  |
| 19  | Evaporator         | P4100EVAP30-D2   |
| 18  | Evaporator Fan     | SA1238A2HBL      |
| 17  | Cassette unit      | P4100FS-R290     |
| 16  | Switch             | RL2-GR           |
| 15  | Thermostat         | XR02CX-5R0C1     |
| 14  | Lock               | MS1035-1         |
| 13  | Control panel      | P3100-B258-02-A4 |
| 12  | Door               | P3100MTB201      |
| 11  | Condenser          | P3100COND6       |
| 10  | Door gaset         | SL12-01          |
| 9   | Compressor         | NUG120NA         |
| 8   | Shelf              | WJ11-05-A2       |
| 7   | Guide              | P3100-B27-01-A0  |
| 6   | Ladder             | P3100-B23-01-B0  |
| 5   | Bottom hinge       | WJ09-12-A1       |
| 4   | Foot               | WJ12-22          |
| 3   | Upper hinge        | WJ09-11-A1       |
| 2   | Body               | P4100XT201-DCB   |
| 1   | Table              | P4100TMB201      |
| NO. | PART NAME          | PART NUMBER      |