

# **Citrus Juicer Instruction Manual**

**Model: CJ5**



**Please read this instruction manual carefully before  
operation**



# Safety Tips

**Read this instruction manual before using and keep it available at all times!**

- The device is not intended for use by children.
- Children should be observed to ensure that they are not playing with the device.
- Keep this manual safely. When passing on/selling the device to a third party, the manual must be handed over along with the device.
- Every person using the device must follow the manual and consider the safety advice.
- The device is to be used indoors only.
- Safe operation is only guaranteed when using the device for its intended purpose. Any technical interference, as well as assembly and maintenance are to be made by qualified persons only. If tampered with, this will affect your warranty. This Citrus press is intended only for production of fruit juice.

## **2 CAUTION:**

- Never immerse the motor base in water, clean it with a damp cloth.
- Unplug the power supply when not in use, before putting on or tarts, and before cleaning.
- Close supervision is necessary when any appliance is used by or near children.
- Do not operate any appliance with a damaged cord, plug or after the appliance malfunctions, or is dropped or damaged in any manner. Return the appliance to the retailer for examination, repair, or electrical or mechanical adjustment.
- Do not let the cord hang over edge of table or worktop, or touch hot surfaces.
- Don't use the appliance if the rotating sieve is damaged.
- Switch off the appliance before changing accessories or parts which move in use.

## Technical Data

DESCRIPTION	CITRUS JUICER
ITEM NUMBER	CJ5
VOLTAGE	220-240V / 50 hz / 180 W
DIMENSIONS (WxDxH)	308 x 218 x 354 mm
WEIGHT	5.5 KG
ACCESSORIES	TWO PRESSING CONES

### OVERVIEW OF PARTS

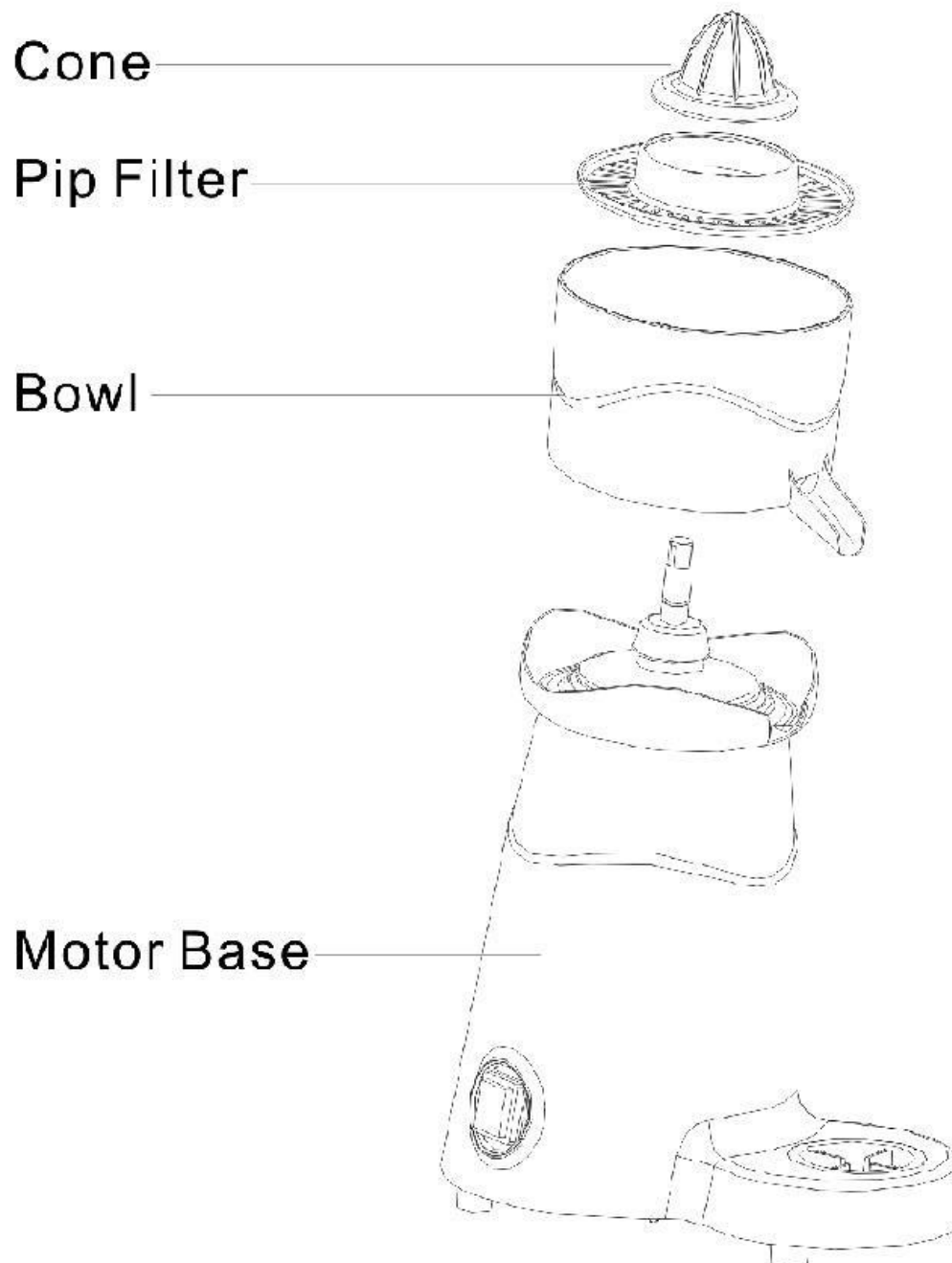

# Operation

## **1. Before Use:**

Before using, wash all the disassembled parts of the appliance (sieve, container for juice, a pressing cone) in warm water with the use of a delicate cleaning agent. Rinse with water and leave to dry.

- Put the container for the juice on the engine block and then put the sieve into the container.
- Place the relevant pressing cone on the engine drive. The biggest cone is used for pressing big oranges and grapefruits, the medium size cone is used for oranges and the smallest cone is used for lemons and limes.

## **3 How to operate:**

1. Position the cone.
2. Cut the fruit to be squeezed into two halves.
3. Switch on the appliance by putting the on/off switch to "1".
4. Squeeze the fruit halves.
5. Switch off the appliance by putting the on/off switch to "0".

## **Cleaning and Maintenance**

1. Always switch off the motor and unplug the juicer first.
2. Never immerse the motor base in water, wipe with a damp cloth to clean it.
3. The appliance is easily cleaned by removing all parts -cone, pip filter, bowl, removeable drip tray.
4. Rinse all parts immediately after use.

## **Safety instructions for maintenance:**

- Check the mains connection cable for damage from time to time. Never operate the device when the cable is damaged. A damaged cable must immediately be replaced by customer service or a qualified electrician to avoid dangers.
- In the event of damage or malfunction, please contact your stockist
- Only a qualified technician using original spare parts and accessories should carry out repairs and maintenance. Do not attempt to repair the device yourself. Doing so will affect your warranty.

## **Waste disposal:**

At the end of its life the device has to be disposed in accordance with the national regulations. It is advisable to contact a company which specialises in waste disposal, or contact the local disposal service in your community.

- Always make the device unfit for use before disposal. For that purpose, disconnect the device from mains supply and remove the mains connection cable from the device.

## **CAUTION!**

For the disposal of the device please consider and act according to the national and local rules and regulations.

# WARRANTY

**WARRANTY** Hamoki Ltd warrants the original purchaser of every new product (under normal and proper use and maintenance service as specified by Hamoki Ltd and upon proper installation and start-up in accordance with the instruction packet supplied with each unit) a one year parts warranty.

Hamoki Ltd's obligation under this warranty is limited to a period of one (1) year from the date of original installation.

## **WARRANTY CLAIMS:**

All claims for parts must be made **directly through the retailer** in the first instance. All claims raised with the retailer should include:

Your name:

Model number:

Your company:

Serial number of the product:

Address: Date of purchase:

Email: Proof of purchase :

Phone:

Information supporting the alleged defect.(A video/photo)

Photo of the dataplate.