

## AIR PURIFIER

Thank you for choosing Morento air purifier.  
Read the user manual before using.

# MORENTO

Air Purifier

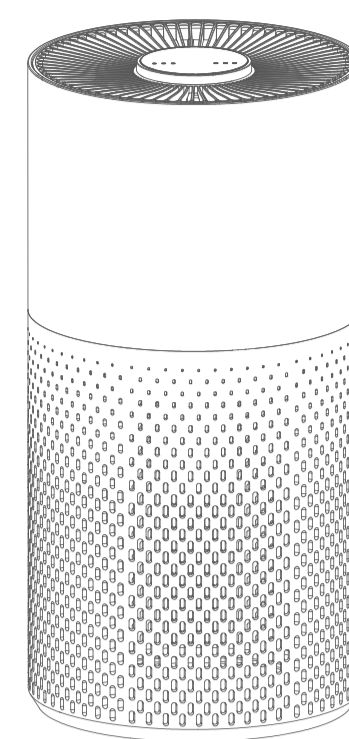

## CONTENT

Warning .....	01
Product Overview .....	02
Specifications .....	03
Filter installation .....	04
Function .....	05
Maintenance .....	06
Warranty .....	07

### WARNING

1. Do not get any liquids or flammable detergents into the product to prevent an electrical shock or fire.
2. Do not spray insecticide, perfume or other flammable spray around the product.
3. Check if the voltage is consistent with the local power supply voltage before plugging it in.
4. This product cannot replace normal ventilation, daily dust collection or oil pumping.
5. Use the product on a stable and horizontal surface.
6. The product works optimally with 30cm of free space around and 50cm of free space above it.
7. Ensure the filter and its cover are installed before operating.
8. Do not place any objects into the air inlet/outlet to prevent damage to the product.
9. Power off the product before unplugging it. Do not unplug it while it is operating as doing so may damage the product.
10. Grasp the plug(not the wire) to unplug the power cord to prevent damage to the wire.
11. Unplug the product if idle for a long time.
12. If any problems exist, please contact your supplier or sales representative for testing and repairs. You are not supposed to disassemble or attempt any repairs on your own.

01

### PRODUCT OVERVIEW

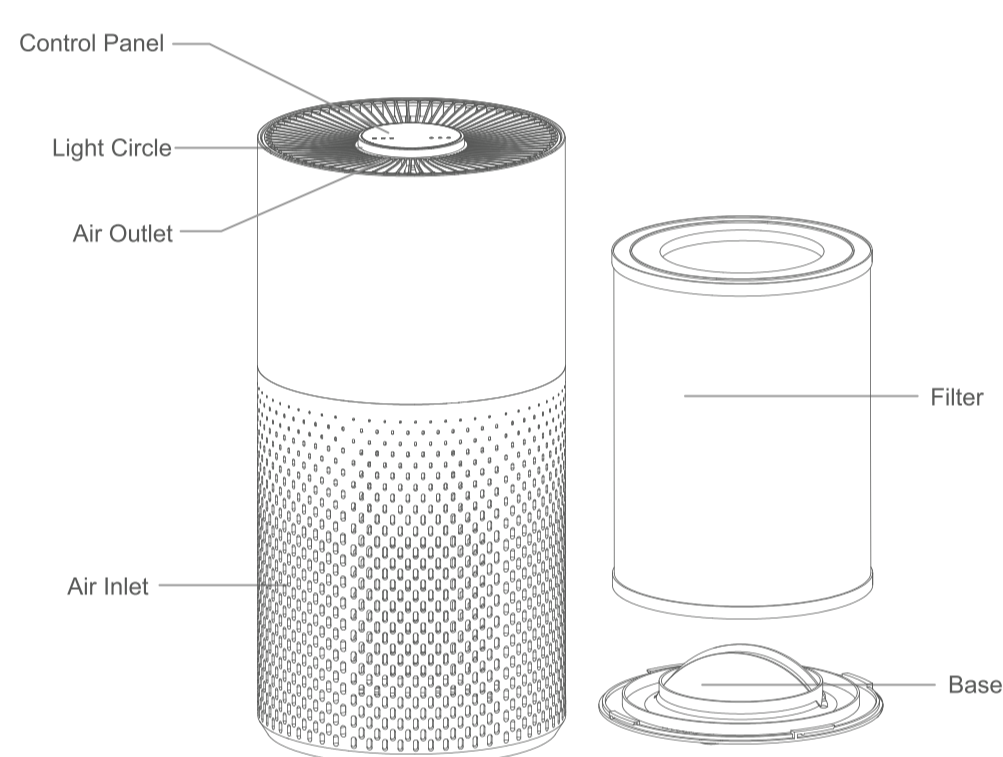

02

### Control Panel

	Power button
	Timer button
	Wind speed button
	Light control button

### SPECIFICATIONS

Model	MR-Kilo
Size	7.68*7.68*15.28 inch
Net weight	4.41 lb
Adapter	Input : 100-240V 50Hz/60Hz; Output : 24V 1.2A
Power	23W
CADR	300m <sup>3</sup> /h
Coverage area	≤387ft <sup>2</sup> /36m <sup>2</sup>

03

### FILTER INSTALLATION

Replace the filter when the red light is on. After replacement, long press the power button for 7 seconds or more to reset, otherwise the red light will stay on.

#### Notice:

1. Unpack the filter.
2. The purifier must be unplugged when replacing the filter. Install or replace the filter with the purifier powered off.
3. A flashing red light ring means the filter needs to be replaced.
4. Wipe down the surface of the filter regularly, but do not attempt to wash or reuse it.
5. Use only certified filters.

#### Replace steps:

1. Power off the product before replacing or installing the filter.
2. Invert the product and rotate the base to open.
3. Remove the used filter.
4. Unpack the new filter.
5. Install the filter.
6. Reinstall the base and rotate the base to close.

04

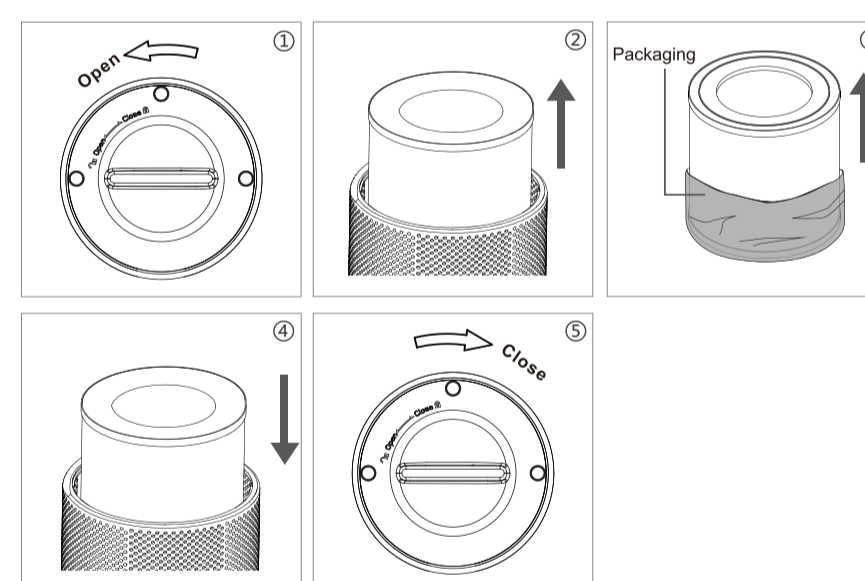

### FUNCTION

When plugged in, the buzzer will ring for 1 second.

#### Power Button

1. Touch the power button to power on the product. The buzzer will ring once and the wind speed indicator will light up.
2. Touch the power button again to power off the product. The buzzer will ring once and all lights will switch off.

05

#### Wind Speed Button

Touch the SLEEP/MID/HIGH button to change the wind speed. The corresponding speed will light up.

**Notice:**In sleep mode, all lights will switch off after 5 seconds. Press any button to switch on the lights.

#### Timer Button

1. Touch the Timer button to cycle between 2/4/8H and cancel. If a duration was selected, the corresponding light will switch on.
2. The fan stops working and all lights turn off when the timer runs out.

**Notice:**The night light will turn on for about 3 seconds when you touch the timer button.

#### Night Light Button

1. Touch the light button to change to night light mode. The buzzer will ring and the light ring will cycle through the available colors (blue, cyan, green, yellow, orange, red, purple). Touch the light button when the desired color appears to set the night light color.
2. Touch the light button again to switch off the light ring.

### MAINTENANCE

#### Note:

1. Unplug the product before maintenance.
2. Do not immerse the product into water or any liquid.
3. Do not use abrasive, corrosive or flammable cleansers (such as bleach or alcohol) to clean the product.

06

4. Do not use a vacuum to clean the product.
5. Sterilize the product under sunlight regularly.

#### Cleaning & Storage

1. Power off and unplug the machine before cleaning.
2. Use a soft cloth to clean the surface and air inlet/outlet of the product.
3. Power on the product regularly to ensure long-lasting performance, even if you do not require any purification.

**Notice:**Do not pour or spray water on the product.

### WARRANTY

Morento offers an extensive warranty for all products that extends through 1 YEAR of the order date. This warranty covers quality related issues and product defects.

If you are past the 30-day return period on Amazon, contact us directly via the "Contact seller" option on your Order Details. If the product is not working properly, we can send you a replacement product.

This warranty does not apply in cases of abuse, mishandling, or unauthorized repair of the product.

If you have any question about this warranty or would like additional information, please contact us via the "Contact Seller" option or directly via e-mail at support@morento.net Please keep the original box, packing materials and all documentation in the event that service is required.

07