

USING KARA PURE 2

1

Unboxing

Follow the unboxing video for the quickest and easiest unboxing experience. Click Here
www.youtube.com/watch?v=ioxfnZPxhe4



2

Power Connection

Your main power is located near the power cord inlet. Plug in and turn on Kara Pure.

3

Connect to Wi-fi

Follow on-screen instruction

4

Prime Your Filters

Follow on-screen instructions

5

Complete Setup

Upon first use, allow up to 48 hours for Kara Pure to generate water

6

Enjoy your Kara Pure 2!

NOTE: We regularly push updates to improve your Kara Pure experience. Please ensure to enable “Automatic Updates” so that we can continue to provide you with the best possible experience and receive new and exciting features as they are released!

4



KARA WATER, INC.
260 Madison Ave.
8th Floor
New York, NY 10016

Illustrations may differ from actual product. We are constantly striving to improve our products, therefore the specifications contained herein are subject to change without notice.

This product may be covered by one or more U.S. patents.
See karawater.com for more information.

karawater.com



Kara Pure 2

USER SETUP GUIDE

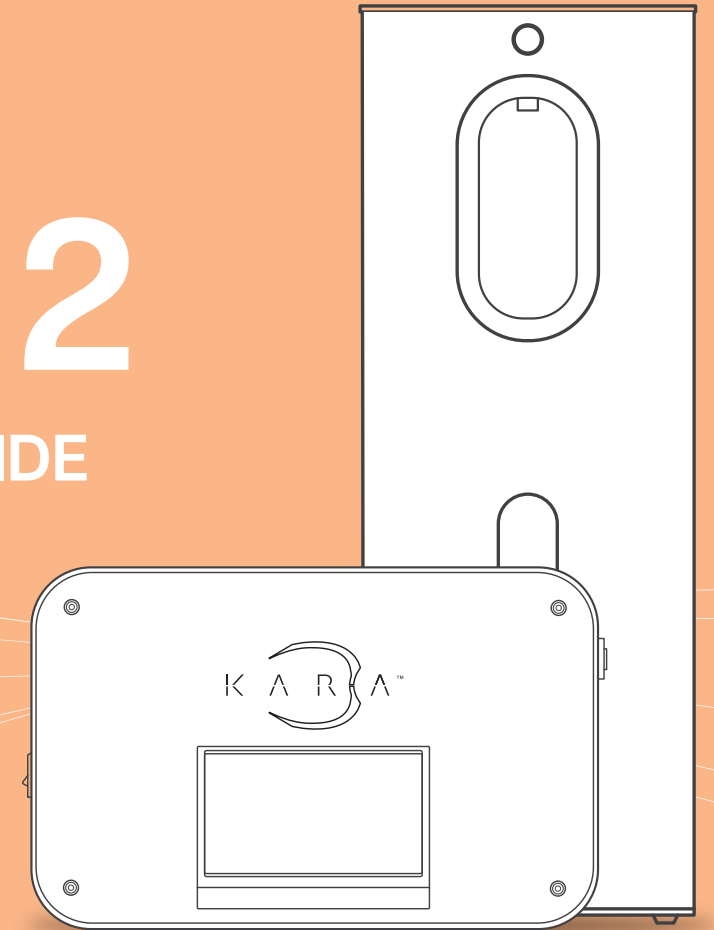

Congratulations on becoming an owner of Kara Pure™ 2

Your water independence is now here!

Kara Pure™ 2 is an advanced device that turns the air around you, into **Premium 9.2pH Alkaline, Mineral-Rich Drinking water!**

Now you can enjoy the reliability, convenience, and quality of water made from air with **Kara Pure™ 2!**

For the best experience, please read the instructions before operating Kara Pure™ 2.



For the full
setup guide /
video instruction
Scan the qr code here

1

MUST READ BEFORE FIRST USE

IMPORTANT: Review all warnings before proceeding.

NOTE: Kara Pure has built-in UV lamps in all water storage areas. To ensure the quality of the water, please keep Kara Pure on at all times to ensure that the UV lamps are continuously functioning.

Warning: DO NOT USE HOT WATER DURING SETUP, PRIMING OR DURING FILTER CHANGES

1. You must follow the unboxing instructions to ensure you retain the integrity of your shipping packaging in case a return is necessary. Returns will not be accepted without the original packaging as it is specifically designed for Kara Pure 2. Unboxing instructions can be found on page 4
2. Unboxing may require 2 people.
3. Do not lay Kara Pure down. You must unbox vertically.
4. Place Kara Pure at least 6 inches away from walls or obstructing surfaces on all sides
5. Kara Pure must remain upright at all times, especially during transport.
6. Do not operate without filters
7. Do not open the water tank while Kara Pure is on
8. Do not place cups or any other object directly on the LCD screen
9. Kara Pure requires regular filter, air filter, and possibly other maintenance. Please refer to the Full User Manual for more information on required maintenance.

Contact our customer support if you have any question

2

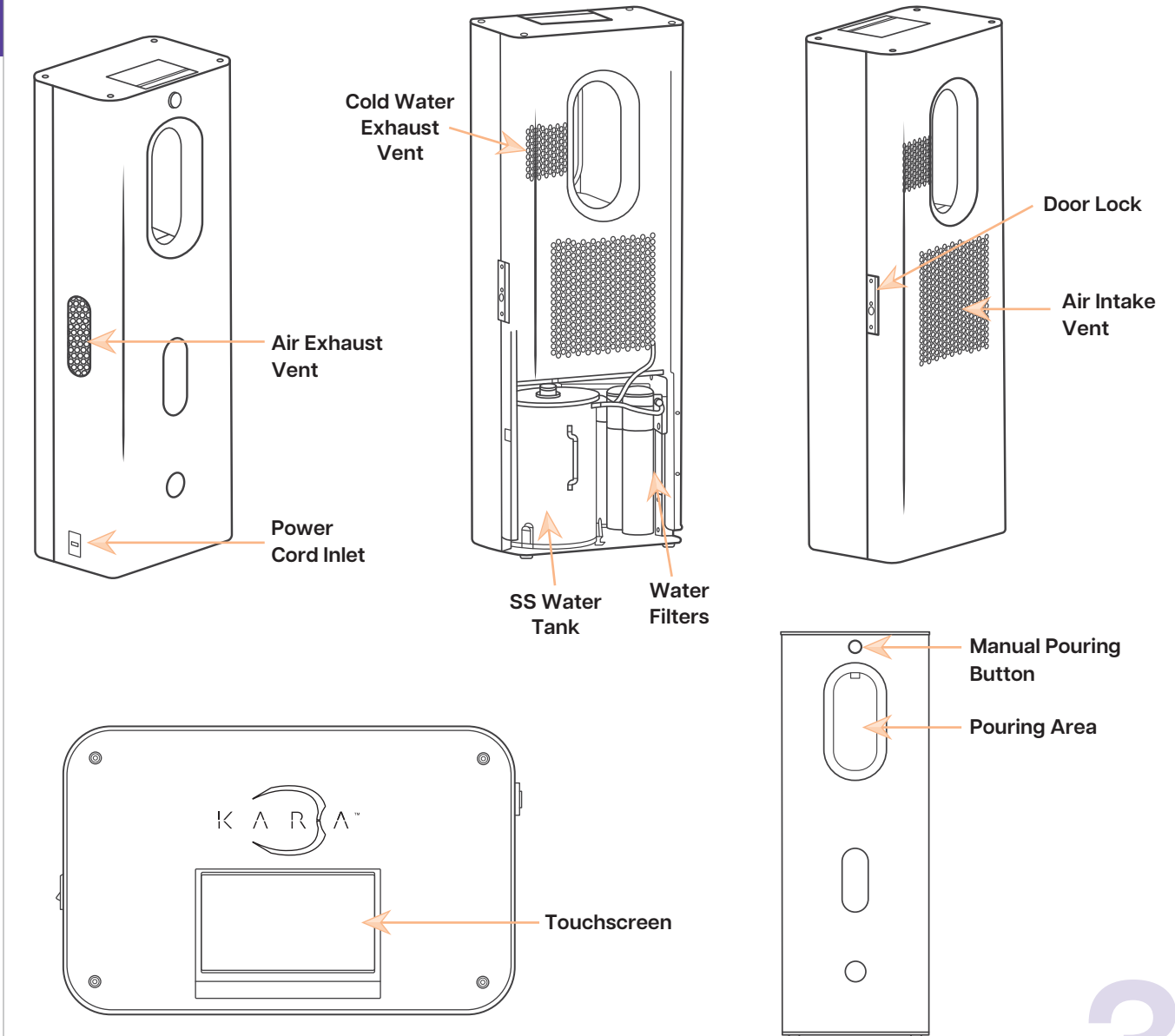

3