

JACK

China No.1

Shanghai stock
listed



**Short thread remaining
Light and Heavy quick adjustable
More efficiency and durable**

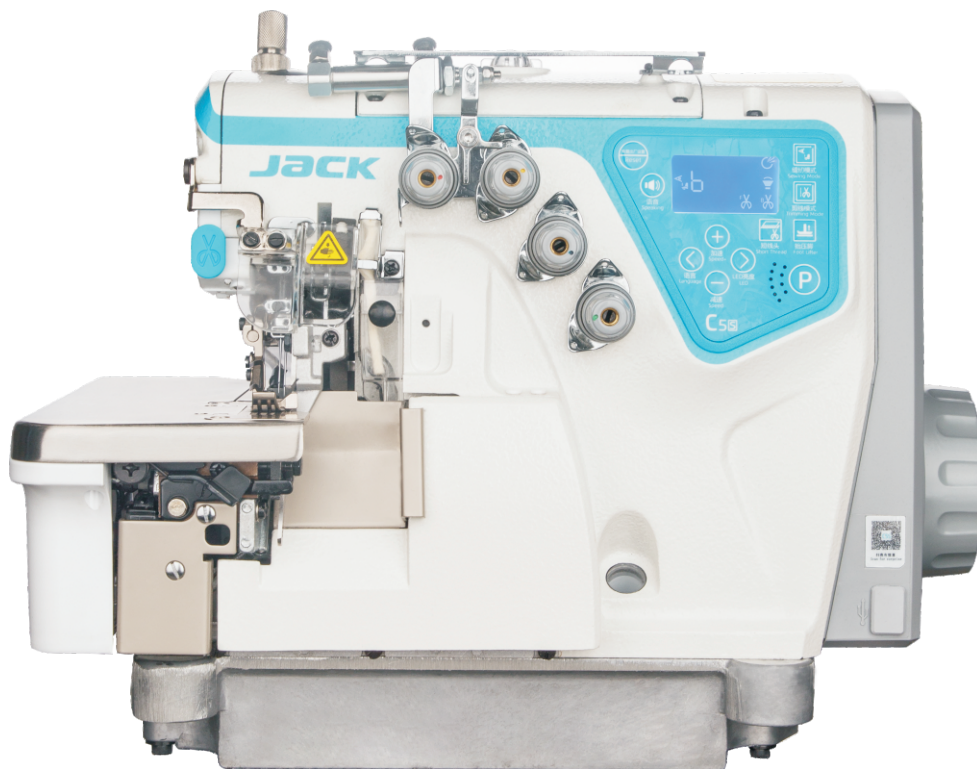

C5S/KS(pneumatic)

C5S/KS(pneumatic)

Item: Short Thread Remaining Pneumatic Automatic Overlock
Features: Short Thread Remaining ,Light And Heavy
Quick Adjustable ,More Efficiency And Durable

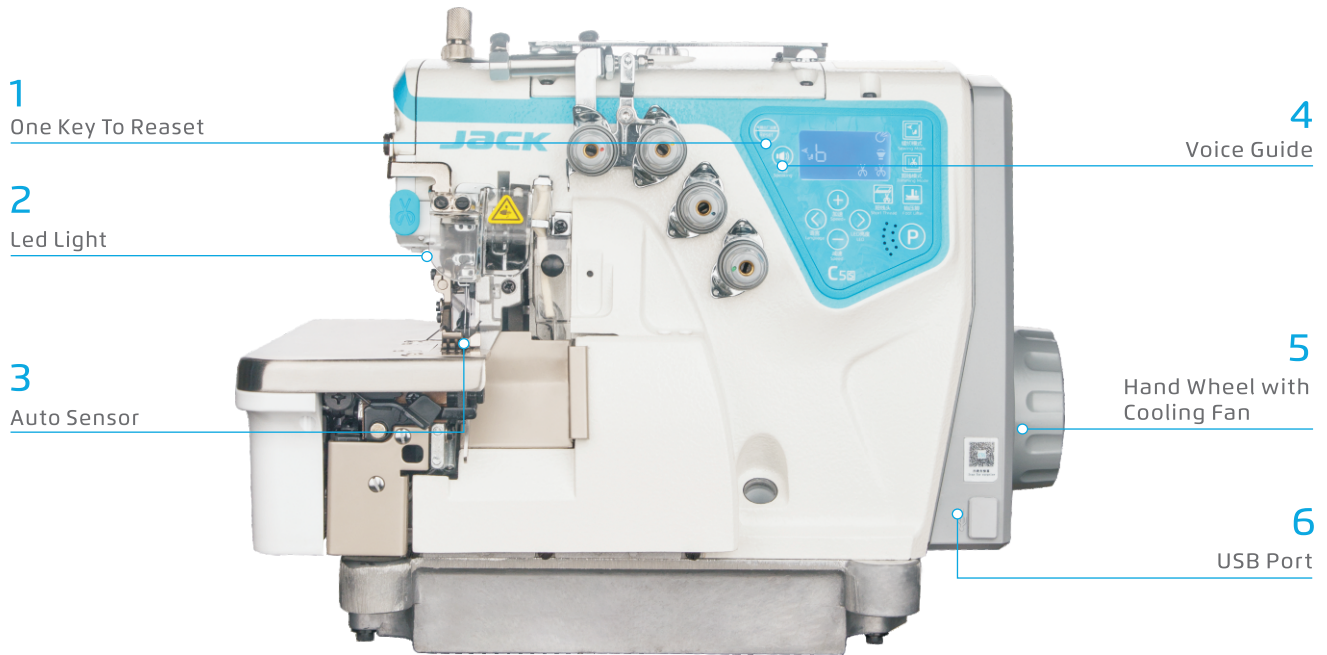

Voice guide, voice alarm easy to operate

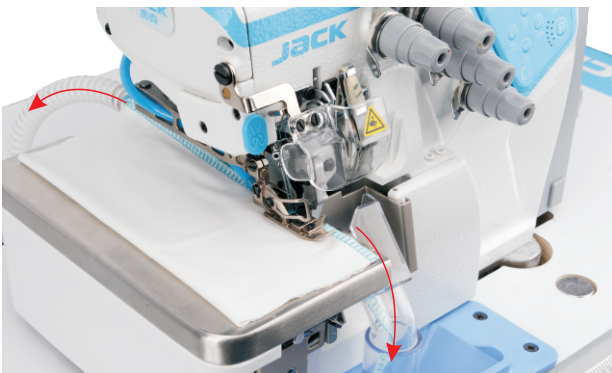

1 Front and Back suction. Clean sewing

The front suction for rags ,The back suction for thread tail ,Keep clean sewing

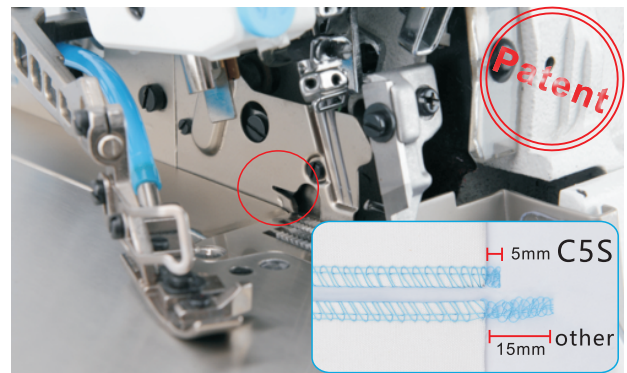

2 Short thread remaining, No need extra trimming

Suction trimming, Can control the remaining thread to be within 5MM, No need extra trimming

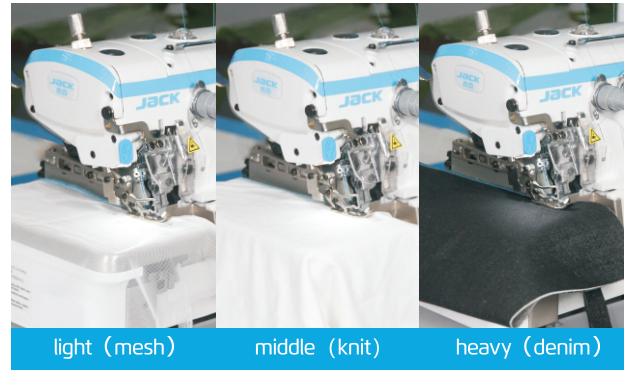
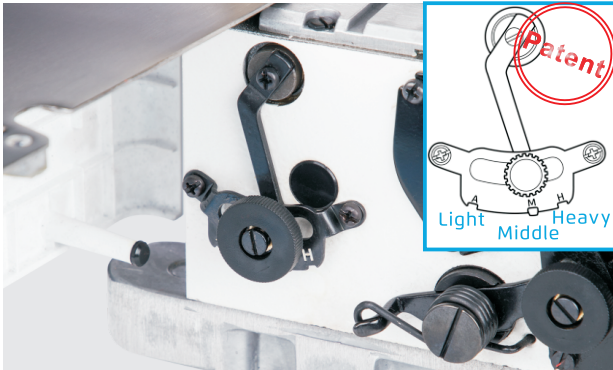

3 Light to medium to heavy adjustable, Widely range

Light to medium to heavy adjustable easily. Suitable for yarn, knit, Jeans different fabric and process

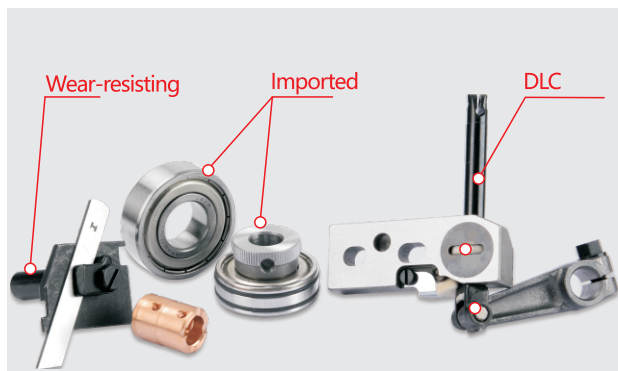

More efficiency Durable and Stable

Main moving parts used wearproof parts, Make sure durable and long lifespan during high speed running

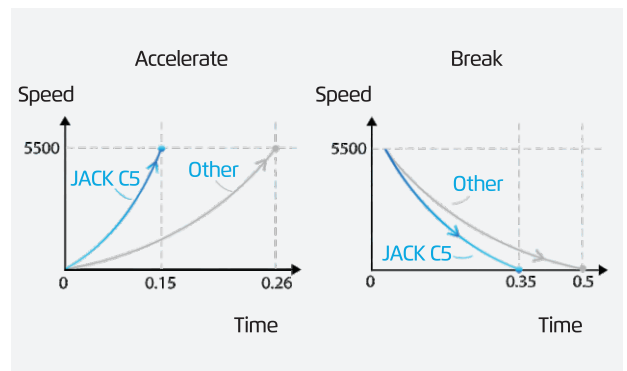

5 Fast start and stop, Strong power

Start -Stop response shortened time to 50%, Matching 7000RPM, Improving efficiency more than 35%, Calculate workers salary as 4000RMB/month. Monthly salary increased 1400RMB.

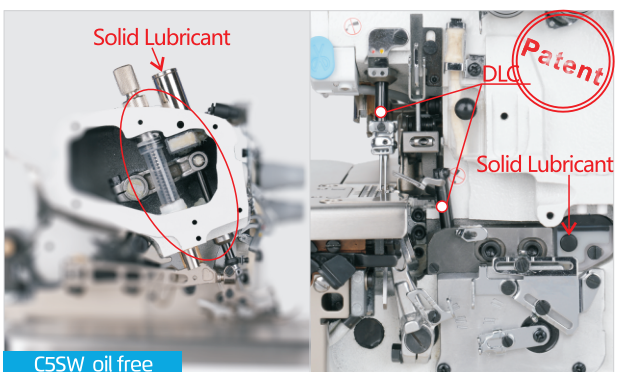

6 No oil no trouble, Clean and durable

Unique grease lubrication system, DLC needle bar and slide bar, Avoid oil damage the fabric. Clean and durable

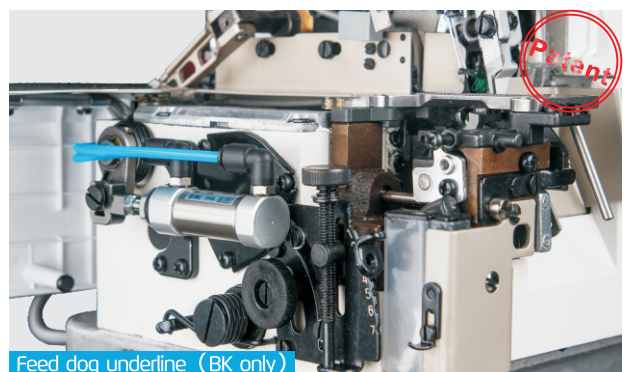

7 Feed dog underline, Feeding easily

Presser foot lifting up then feeding, Feed dog moving (under needle plate surface), Avoid Feed dog damage fabric and feeding easily

Specification

Model	Functions	Needle	Needle No.	Thread No.	Needle Distance (mm)	Stitch Width (mm)	Stitch Length (mm)	Differential Ratio	Presser Foot Lifting Height (mm)	Max. Speed (s.p.m)	Volume (mm)	Weight (kg)
C5S-02×250/AT	Pocket Binding	DC×27 14#	2	4	5	—	4	0.7-2	3.5	7000	525×360×630	33/44
C5S-3-02/233/KS	Plain Seaming	DC×27 11#	1	3	—	4	4	0.7-2	5	7000	525×360×630	33/44
C5S-3-32R2/223/KS	Condense seaming	DC×27 9#	1	3	—	1.5	4	0.7-2	5	7000	525×360×630	33/44
C5SWF-3-02/213/AT	Non-Woven	DC×27 14#	1	3	—	4	8.5	—	5.5	7000	525×360×630	33/44
C5S-4-M03/333/KS	Plain Seaming	DC×27 11#	2	4	2	4	4.6	0.7-2	5.5	7000	525×360×630	33/44
C5S-4-M03/333/H/M/KS	Heavy Duty	DC×27 11#	2	4	2	4	4.6	0.7-2	6	7000	525×360×630	33/44
C5S-4-83/323/BK	Pneumatic Back Latching	DC×27 11#	2	4	2	4	4.6	0.7-2	3.5	7000	525×360×630	33/44
C5SMJ-4-53/233/AT	Towel Ending	DC×27 11#	2	4	2	4	4	0.7-2	5	7000	525×360×630	33/44
C5S-5-53/233/AT	Strip Attaching	DC×27 14#	2	5	3	4	4	0.7-2	5	7000	525×360×630	33/44
C5S-5-03/233/KH	5×5 Stitch	DC×27 14#	2	5	5	5	4	0.7-2	5	7000	525×360×630	33/44
C5S-5-03/333/KH	3×4 Stitch	DC×27 14#	2	5	3	4	4	0.7-2	5	7000	525×360×630	33/44
C5S-5-A04/435/AT	Extra Heavy Duty	DC×27 19#	2	5	5	6	5	0.8-1.5	7	7000	525×360×630	33/44
C5S-5-M04/435/AT	Especially for Denim	DC×27 19#	2	5	5	6	5	0.8-1.5	7	7000	525×360×630	33/44
C5S-6-03/333/AT	Plain Seaming	DC×27 11#	3	6	3x2	4	4	0.7-2	5	7000	525×360×630	33/44
C5S-6-M04/435/AT	Especially for Denim	DC×27 19#	3	6	5x2.5	3.5	5	0.8-1.5	7	7000	525×360×630	33/44

Note:KS:Vertical suction device; KH:Horizontal suction device; AT:Pneumatic cutter trimming; H/M: Wide range for heavy duty; Optional C5SW (Semi-dry)



Jack Wechat



Jack Facebook