

## CMZ TA SERIES - opcije

### VELIKOST GLAVNEGA VRETENA

- TA-15
- TA-20
- TA-25
- TA-30

### OPCIJE REZKANJA

- Without driven tools
- M - with driven tools
- Y - with driven tools and Y axis

### VRSTA REVOLVERJA

- 12 position standard turret
- 15 positions N-55 turret disk
- Standard set of toolholders

### DOLŽINA POSTELJE

- Z=400 Short bed
- Z=640 Medium bed
- Z=1100 Long bed

### CNC OPCIJE

- CNC with 15" touch screen and new iHMI
  - Fanuc G codes type A
  - Fanuc G codes type B
  - Tool life management function
  - Tool load monitoring function

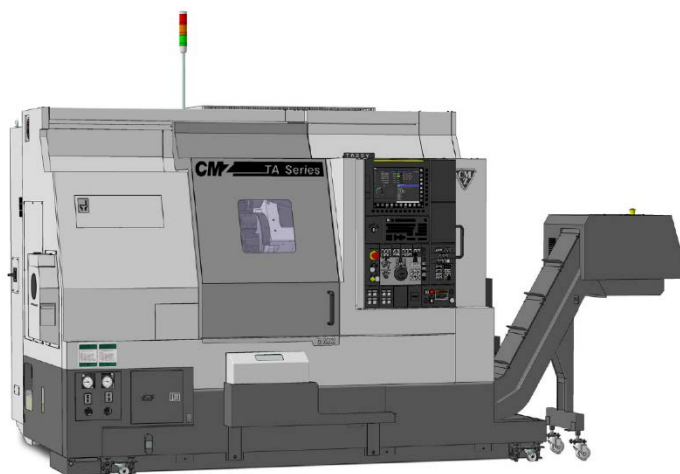

## OPCIJE KONJIČKA ALI DODATNEGA VRETENA (SUBSPINDLE)

- Without tailstock
- With subspindle
  - Dual pressure clamping facility on hydraulic in subspindle
  - 3 čeljustne glave/vpenjanje s stročnicami:
  - SMW Autoblok <https://www.smwautoblok.com/it/en/catalogs/turning/>
  - Hainbuch Spanntop <https://www.hainbuch.com/en/products/chucks/power-chucks/power-chuck-spanntop-nova/>
  - Bellegrandi <https://bellegrandi.com/en/>
- Servo tailstock
  - Tailstock body extended to the left side
  - MT-5 quill on tailstock
  - MT-3 quill with integrated bearings on tailstock
  - Drilling attachment for the servo tailstock
  - Double foot pedal for tailstock
  - Air blow through center of the tailstock

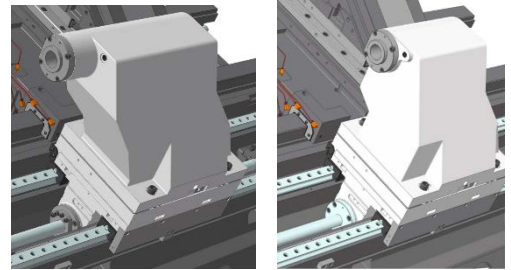

## VPENJANJE OBDELOVANCA NA GLAVNEM VRETENU

- Standard hydraulic cylinder on main spindle
- LPS (linear position sensor) in main spindle
- Axial stop in main spindle
- Coolant trough main spindle
- Reduction tube for main spindle
- Air blow over main spindle
- Dual pressure clamping facility on hydraulic in main spindle
- SMW Autoblok <https://www.smwautoblok.com/it/en/catalogs/turning/>
- Hainbuch Spanntop <https://www.hainbuch.com/en/products/chucks/power-chucks/power-chuck-spanntop-nova/>



## SISTEM ZA UMERJANJE ORODIJ (PRESSETER)

- Removable tool presetter
- Removable tool presetter (only the installation)

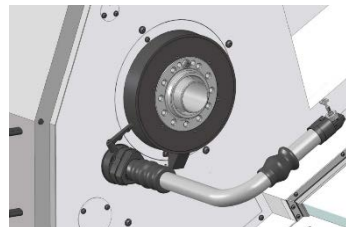

## TRANSPOTER ODREZKOV

- Side exit chip conveyor (standard type)
- Side exit chip conveyor (scraper type)
- Double chain rear exit chip conveyor
- Without chip conveyor

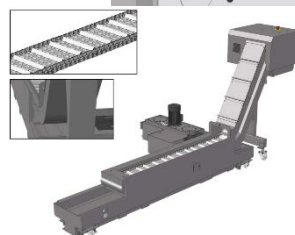

### OPCIJE HLAJENJA

- High pressure coolant pump (6 bar)
- High pressure coolant pumps (6 bar + 15 bar)
- High pressure coolant pump with 3 programmable settings (35, 15 & 6 bar). Includes a 75 µm replaceable filter
- 70 bar coolant pump, adjustable to 70-60-50-40-30-10 bar & auto cleaning filter system to 10 µm

### DODATNE OPCIJE HLAJENJA

- Coolant filter 250 µm with scraper type cleaning system
- Coolant wash gun
- Oil skimmer
- Minimum coolant level switch & alarm
- Coolant chiller

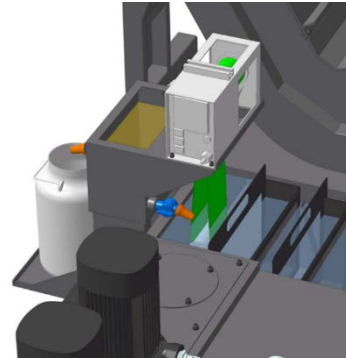

### INDIKATORSKA LUČ

- Machine status indicator light
- Machine status indicator light with buzzer

### OPCIJE ZA OBDELOVANJE IN PALICE

- Pneumatic, automatic, programmable parts catcher
- Pneumatic, automatic, programmable parts catcher with conveyor
- Barfeed interface – Unimag

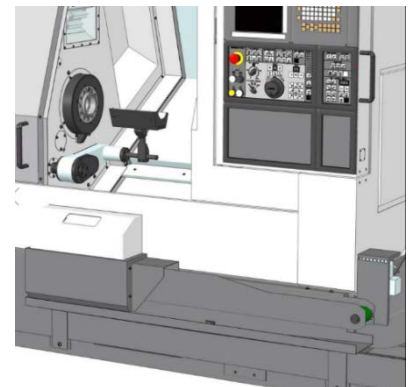
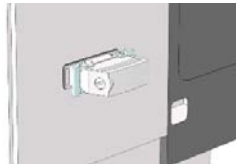

### OPCIJE LINETE (Steady)

- Base for mounting steadies
- SMW-Autoblok SLUX <https://www.smwautoblok.com/us/en/catalogs/turning/self-centering-steady-rests-for-turning/>
- 
- Coolant through the steady
- Automatic lubrication system for steady
- Pneumatic pressure on steady body to prevent dirt ingress

### OPCIJE VRAT

- Automatic door opening and closing (left door)

### OPCIJE PRIKLJUČKA ZA ODVAJANJE MEGLE

- Interface for mist collector tube Ø100
- Interface for mist collector tube Ø150
- Interface for mist collector tube Ø200



### MERILNE LETVE

- Linear encoder on X axis
- Linear encoder on Y axis
- Linear encoder on Z axis

### OSTALA OPREMA

- Reinshaw OLP40 infrared work probe
- Universal interface for connecting a robot to the machine

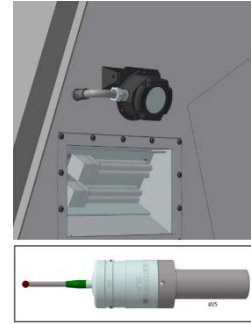

### CMZ ROBOTI

- Gantry covers
- GL6 2 axis CNC gantry loader with RH side loading (for 2 x 3kg parts)
- GL6 2 axis CNC gantry loader with LH side loading (for 2 x 3kg parts)
- GL6 2 axis CNC gantry loader with loading BOTH sides (for 2 x 3kg parts)
- GL20-II 3 axis CNC gantry loader with RH side loading (for 2 x 10kg parts)
- GL20-II 3 axis CNC gantry loader with LH side loading (for 2 x 10kg parts)
- GL20-II 3 axis CNC gantry loader with loading BOTH sides (for 2 x 10kg parts)

### DRŽALA ORODIJ

Optional tool holders