

Wi-Fi Smart Switch

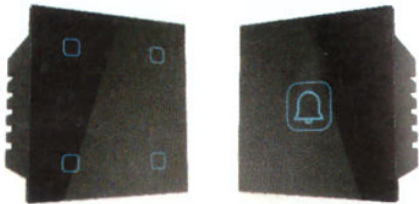

User Manual

Version. 4.0

PROUDLY MADE IN
INDIA

• TECHNICAL PARAMETERS

Input Voltage: 230V~50/60Hz
Wireless Type: Wi-Fi 2.4Ghz
(Signal Strength $\geq 75\%$)
Size: 2 Modular Roma Standard
Working temp.: -10°C to 70°C
Touch Surface ambient temp.: 30°C to 48°C
App Support: Android/iOS (Smart Life)
Warranty: 1 year manufacturing warranty

• INSTALLATION

1. Installation must be carried out by a qualified electrician in accordance with local regulations.
2. Keep the device away from water, damp or hot environment.
3. Install the device as per given instruction.

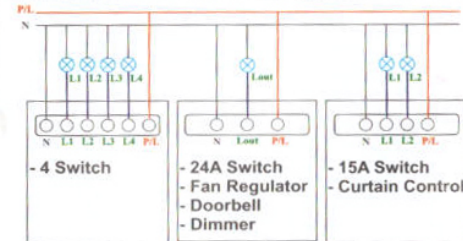

- Turn off the power supply before carrying out any electrical installation work.
- Connect wires according to the wiring diagram.
- Insert the module into the junction box.
- Connect the power supply and follow Wi-Fi switch module configurations instructions.

• DEVICE SET-UP

1. **Download & Register** "Smart Life"  App in your phone.
2. Switch **Configuration Mode**
 - Make sure Mobile **Bluetooth is Turn On** & connected to your home Wi-Fi network (2.4Ghz with internet).
 - 4 MBPS or Higher internet required
 - Signal Strength required '-70dbm' or More
3. **Long Touch** Any switch/fan for 20s until the center blue LED blinking continuously for pairing mode.

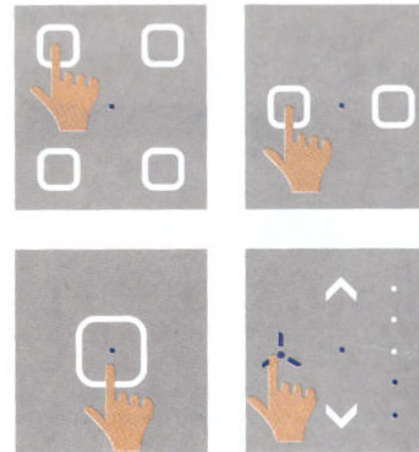

• ADD DEVICE

4. Make sure your smart phone and Wi-Fi switch module are under the same Wi-Fi network at 2.4GHz connection.

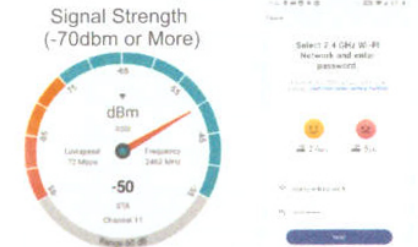

5. Open the App, selecting "+" on top right to **add device**. Choose the type of device, for ex. "Electrician", select switch(BLE) or "small home", select Fan(BLE).



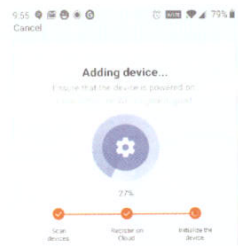

6. The pairing will take about 20-180 second to complete depending on your network condition.

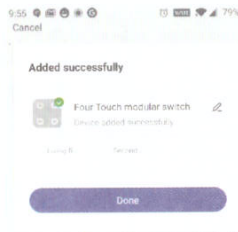

7. When pairing is done, the Wi-Fi switch will be shown on the App.

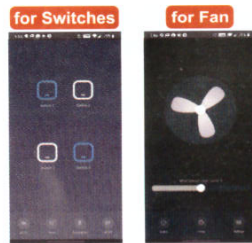

• ALEXA SET-UP

1. Download & Register Amazon Alexa app in your phone.
2. Select Skills & Games, search and linked with "Smart Life"

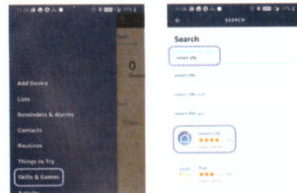

3. After Successful linking, ask "Alexa discover my devices" and Alexa will shows all discovered devices.

• Google SET-UP

1. Download Google home app in your mobile & Register.
2. Open the App, selecting "+" on top left to "set up device" and select "works with Google".

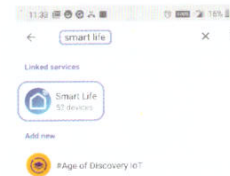
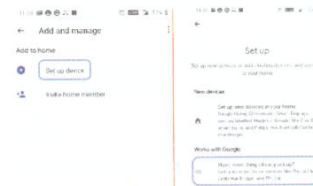

3. Search "Smart Life", linked your switches for voice control, or share the devices with your family or friends.

• Smart Wi-Fi Switches

