

Product Specifications

MODEL
24CFO
24CFO-B

CATEGORY
Circulation

DESCRIPTION

24" circulation fan with OSHA guards and 2-speed motor with pull chain switch, designed for agriculture, horticulture and industrial use.

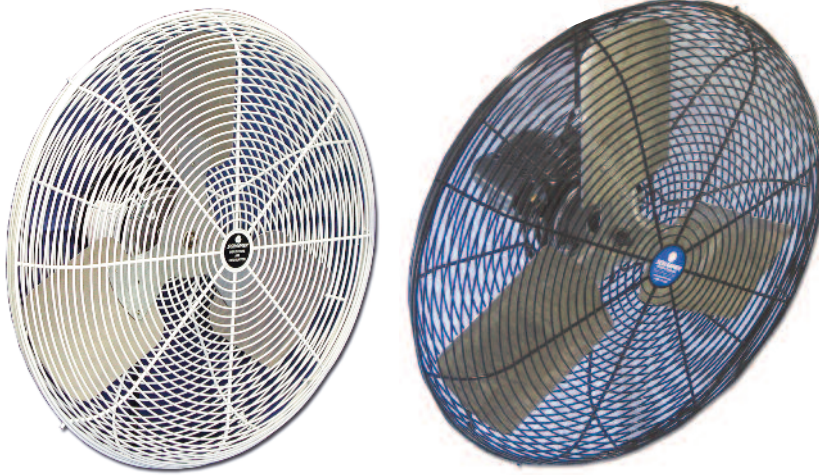

FEATURES

- Maintenance-free, totally enclosed, thermally protected motor with pre-lubricated ball bearings and two-speed pull chain switch.
- Durable powder coated zinc over steel fan guard meets OSHA requirements.
- Includes ten foot, 115 volt power cord.

DIMENSIONS

A = 26-1/2" B = 6-1/4" C = 12"

PERFORMANCE

CCFM 5281 / 3845
Test Number Schaefer 0092 / Schaefer 0093

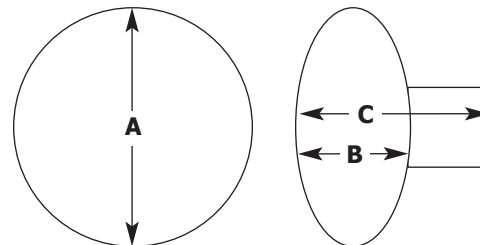

Drawing not to scale.

MOTOR

CS240	1/4 HP	2 Speed	60 Hz	1 Phase	115 Volts	2.9 Amps
Insul = B	CSA Certified	TEAO	1100 RPM	SF = 1	Max 40° C	

BLADE

AFB-2400SQ	3 Wings	1/2" Bore	Aluminum
------------	---------	-----------	----------

SHIPPING

34 lbs	27" x 27" x 13"	UPS = Yes	Pallet Quantity = 12
--------	-----------------	-----------	----------------------



800-779-3267

sales@schaeferfan.com • www.schaeferfan.com

Test data, performance, energy consumption and other specifications are based on results in a controlled environment. Actual results will vary. Product specifications subject to change. ©2010 Schaefer Ventilation Equipment 5-16-12